

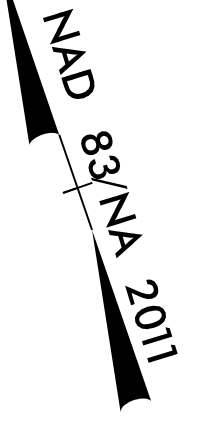

8521 SIX FORKS ROAD, SUITE 400
RALEIGH, NC 27615
NC FIRM LICENSE No: F-0493

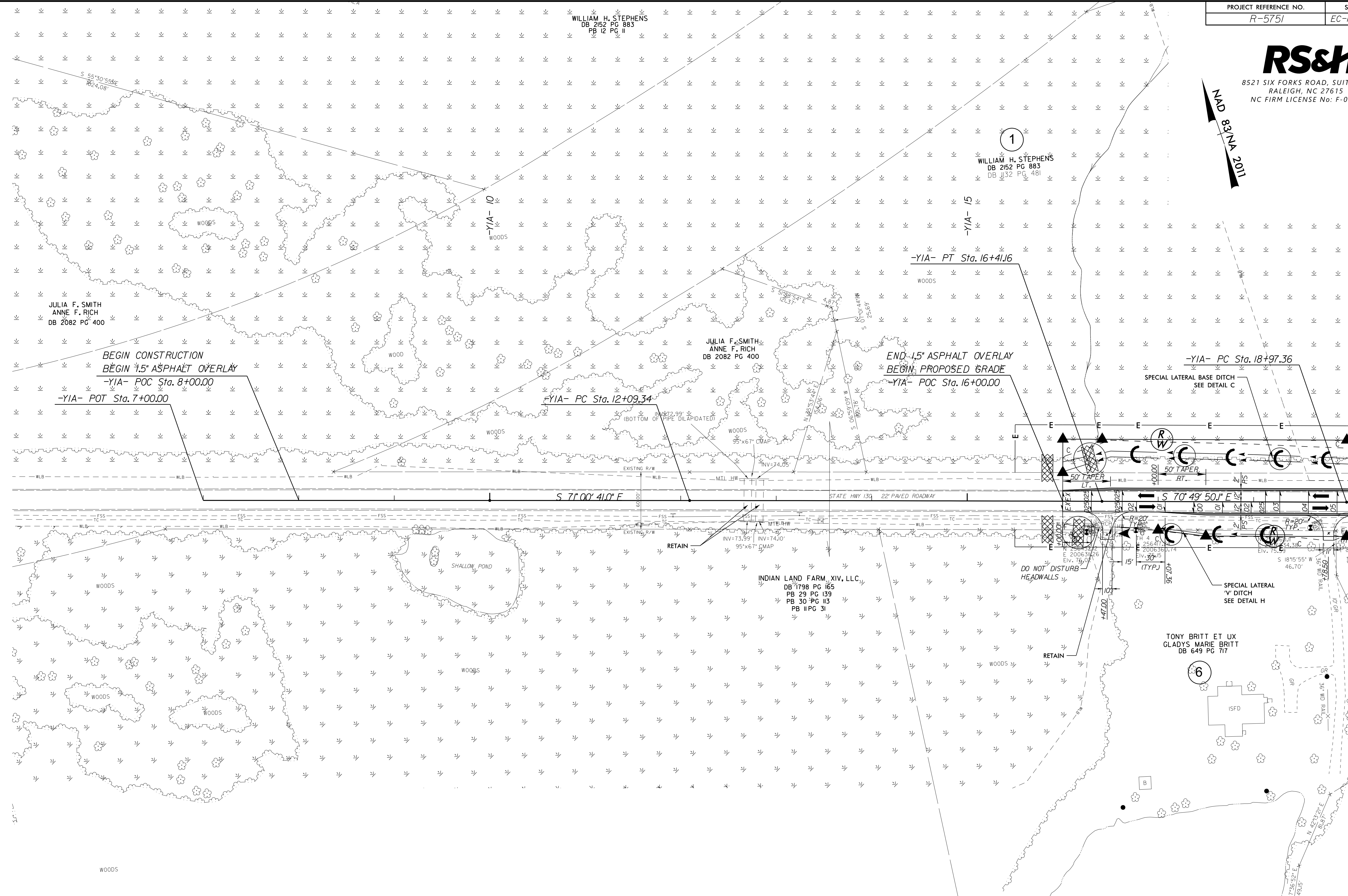

8/17/99
 REVISIONS
 OC-SEP-2022 09:59
 C:\Users\pccm\OneDrive\Transportation\1030036026 R-5751 US 74 NC 72 NC 130 Final Design\Environmental\Design\PSH\R5751_EC_PSH_EC-18.dgn
 \$\$\$SUBPLOTNAME\$\$\$



MATCHLINE SHEET 10 -YIA- STA. 19+00.00

EXISTING 2 @ 95"x67" CMAP APPEARED TO BE IN FAIR CONDITION. THE DILAPATED BOTTOM OF THE PIPE COULD NOT BE VERIFIED ON EITHER DATE OF SURVEY DUE TO SIGNIFICANT DEPTH OF WATER IN THE PIPES.

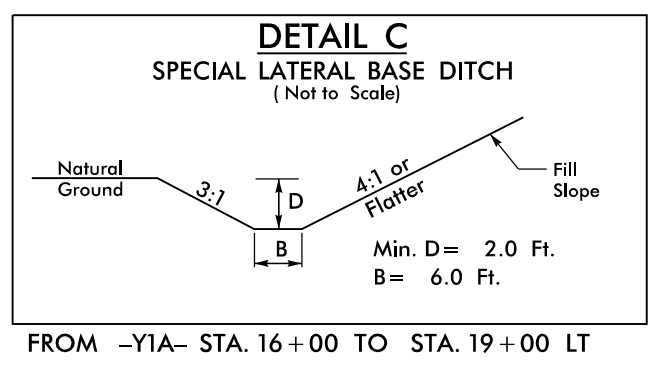
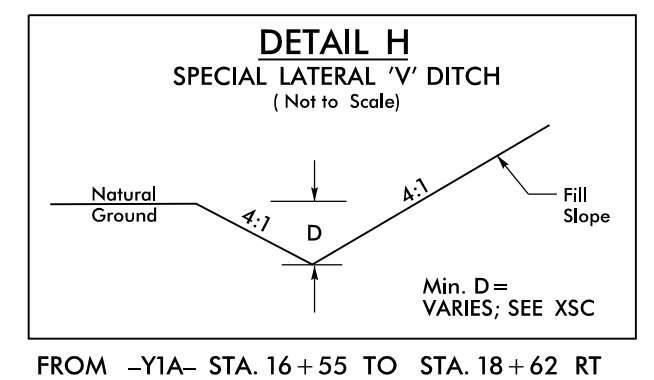

-YIA- CURVE DATA
 PI Sta 14+25.25
 $\Delta = 0^{\circ}10'51.0''$ (RT)
 $D = 0^{\circ}02'30.7''$
 $L = 431.82'$
 $T = 215.91'$
 $R = 136,828.22'$
 $SE = NC$

NOTES: ANY DEVIATION FROM OPTIONS GIVEN WILL REQUIRE PRIOR APPROVAL BY ENGINEER.

ADDITIONAL EROSION CONTROL DEVICES MAY NEED TO BE INSTALLED AS DIRECTED BY THE ENGINEER.