

Location and Surveys

NCDOT DIVISION 6
LOCATION AND SURVEYS
4834 US HWY 301 S
HOPE MILLS, NC 28348

PROJECT SURVEYOR

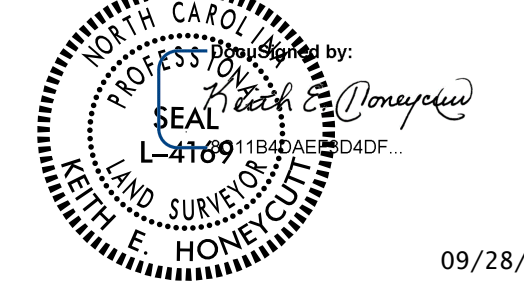

09/28/2022

DOCUMENT NOT CONSIDERED FINAL
UNLESS ALL SIGNATURES COMPLETED

I, Keith E Honeycutt, PLS, certify that the right of way and permanent easement monumentation for this project shown herein was completed under my direct and responsible charge from an actual survey made under my supervision; that all horizontal closures had a minimum ratio of precision of 1:10,000 (Class A). Field work was performed in March 2022, and all coordinates are based on NAD83/2011; That this survey was performed to meet the requirements of 21NCAC 56.1600 as applicable.
This 29th day of September, 2022.
DocuSigned by:
Keith E. Honeycutt
Professional Land Surveyor L-4169

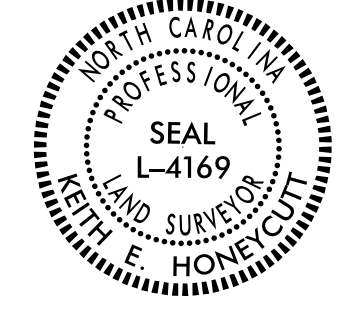

6/2/199
22-SEP-2022 15:46:00 PE MILLS_PROJ\PROJECTS\Control Sheets\5751\revision-220920\work\p5751.is_rw06.dgn
AT 1506-312626

REVISIONS

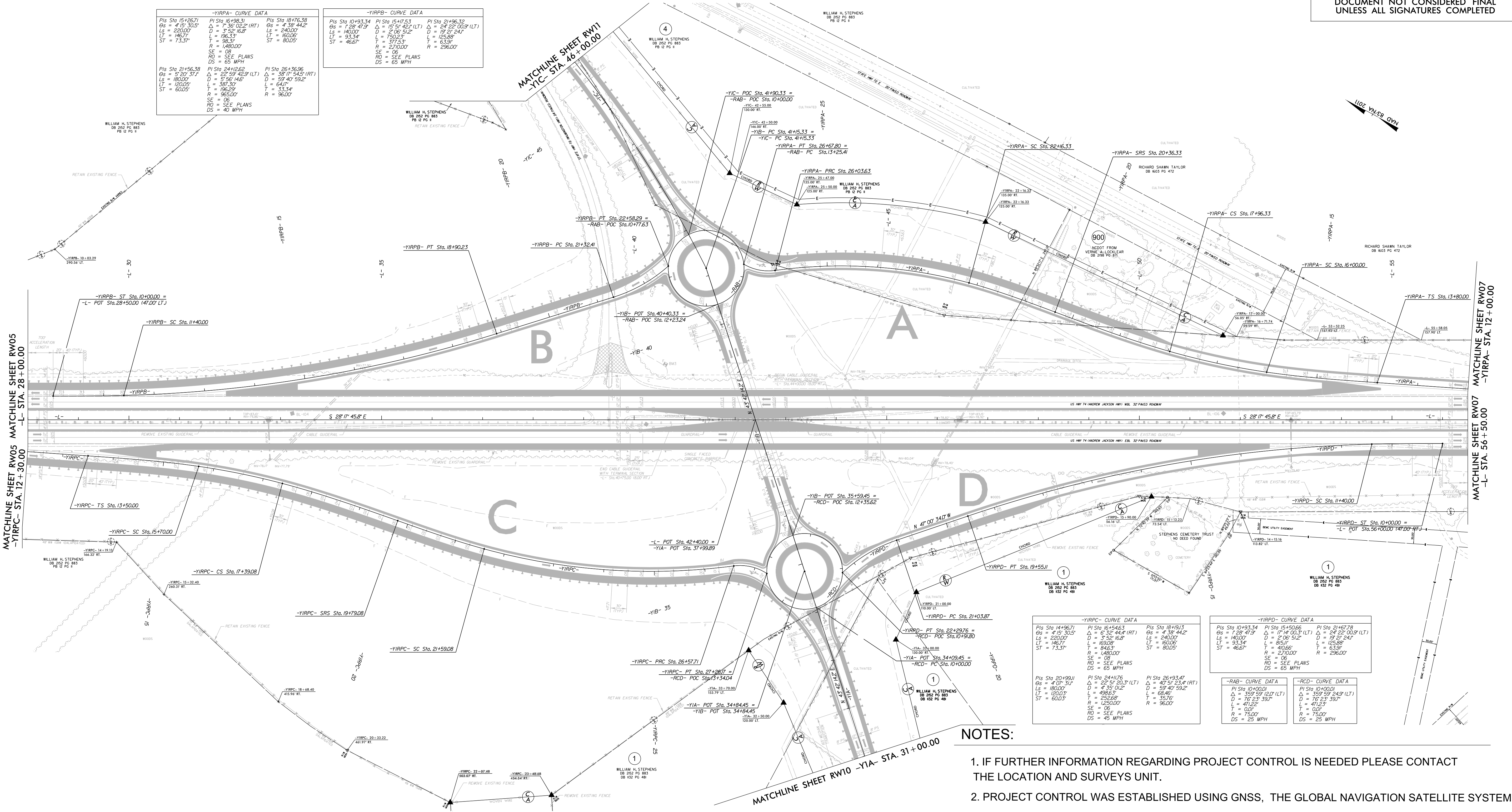

-YIRPA- CURVE DATA			-YIRPB- CURVE DATA		
PI Sta 15+2671	PI Sta 16+98.31	PI Sta 18+76.38	PI Sta 10+93.34	PI Sta 15+75.53	PI Sta 21+96.32
Os = 4°15'30.5"	Os = 7°36'02.2" (RT)	Os = 4°38'44.2"	Os = 1°28'47.9"	Os = 15°51'42.7" (LT)	Os = 2°42'00.9" (LT)
Ls = 620.00'	Ls = 375.92' (68)	Ls = 640.00'	Ls = 140.00'	Ls = 270.512'	Ls = 97.87' (24)
LT = 146.71'	LT = 196.33'	LT = 160.06'	LT = 93.34'	LT = 750.23'	LT = 125.88'
T = 73.37'	T = 98.31'	T = 80.05'	T = 46.67'	T = 371.53'	T = 63.99'
R = 1490.00'	R = 1490.00'	R = 1490.00'	R = 270.00'	R = 270.00'	R = 296.00'
SE = 08	SE = 08	SE = 08	SE = 08	SE = 08	SE = 08
RD = SEE PLANS	RD = SEE PLANS	RD = SEE PLANS	RD = SEE PLANS	RD = SEE PLANS	RD = SEE PLANS
DS = 65 MPH	DS = 65 MPH	DS = 65 MPH	DS = 65 MPH	DS = 65 MPH	DS = 65 MPH

-YIRPC- CURVE DATA			-YIRPD- CURVE DATA		
PI Sta 14+96.71	PI Sta 16+44.63	PI Sta 18+93.3	PI Sta 10+93.34	PI Sta 15+75.53	PI Sta 21+96.32
Os = 4°15'30.5"	Os = 6°32'44.4" (RT)	Os = 4°38'44.2"	Os = 1°28'47.9"	Os = 15°51'42.7" (LT)	Os = 2°42'00.9" (LT)
Ls = 220.00'	Ls = 375.92' (68)	Ls = 640.00'	Ls = 140.00'	Ls = 270.512'	Ls = 97.87' (24)
LT = 160.06'	LT = 196.33'	LT = 160.06'	LT = 93.34'	LT = 750.23'	LT = 125.88'
T = 73.37'	T = 98.31'	T = 80.05'	T = 46.67'	T = 371.53'	T = 63.99'
R = 1490.00'	R = 1490.00'	R = 1490.00'	R = 270.00'	R = 270.00'	R = 296.00'
SE = 08	SE = 08	SE = 08	SE = 08	SE = 08	SE = 08
RD = SEE PLANS	RD = SEE PLANS	RD = SEE PLANS	RD = SEE PLANS	RD = SEE PLANS	RD = SEE PLANS
DS = 65 MPH	DS = 65 MPH	DS = 65 MPH	DS = 65 MPH	DS = 65 MPH	DS = 65 MPH

- NOTES:**
1. IF FURTHER INFORMATION REGARDING PROJECT CONTROL IS NEEDED PLEASE CONTACT THE LOCATION AND SURVEYS UNIT.
 2. PROJECT CONTROL WAS ESTABLISHED USING GNSS, THE GLOBAL NAVIGATION SATELLITE SYSTEM.
 3. RIGHT OF WAY MONUMENTATION ESTABLISHED MARCH 2022.