

6/2/99

PROJECT REFERENCE NO. R-5751	SHEET NO. 2A-3
ROADWAY DESIGN ENGINEER 	PAVEMENT DESIGN ENGINEER

DOCUMENT NOT CONSIDERED FINAL UNLESS ALL SIGNATURES COMPLETED

RS&H 8521 SIX FORKS ROAD, SUITE 400 RALEIGH, NC 27615 NC FIRM LICENSE No: F-0493

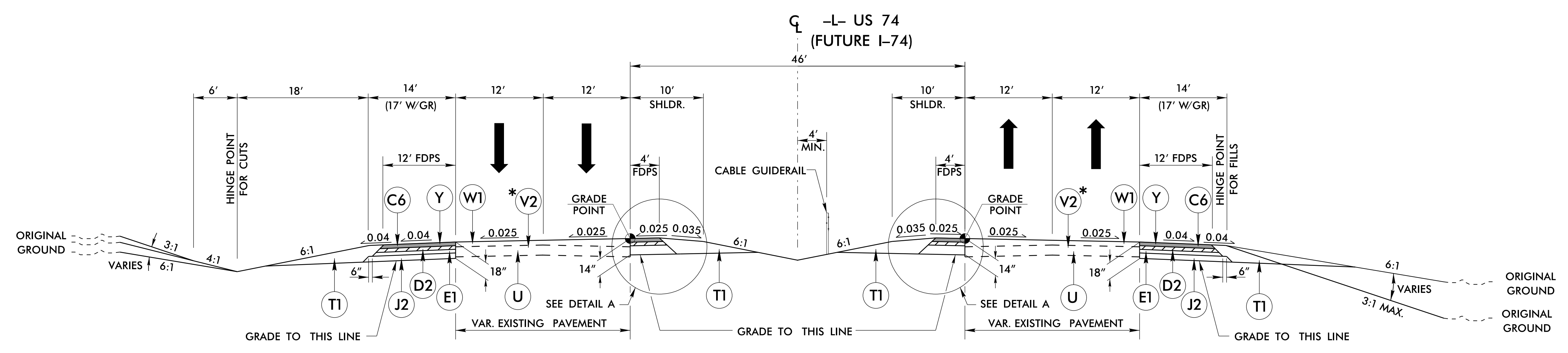

TYPICAL SECTION NO. 1
 -L- STA. 16+00.00 TO -L- STA. 42+18.97
 -L- STA. 42+61.03 TO -L- STA. 66+00.00

* NOTE:
 MILL EXISTING OUTSIDE TRAVEL LANE
 STA. -L- 53+00.00 RT. TO -L- STA. 55+00.00 RT.
 STA. -L- 56+00.00 LT. TO -L- STA. 59+00.00 LT.

 MILL EXISTING RIGHT TURN LANE
 STA. -L- STA. 55+00.00 RT. TO STA. 62+50.00 RT.

C6	3.0" S9.5C
D2	4.0" I19.0C
E1	3.0" B25.0C
E3	7.0" B25.0C
J2	8" AGG. BASE
R4	3" CONC. COVER
R5	CONC. BARRIER
T1	EARTH MATERIAL
U	EXIST. PAVEMENT
V2	1.5" MILLING
W1	WEDGING
Y	RUMBLE STRIPS

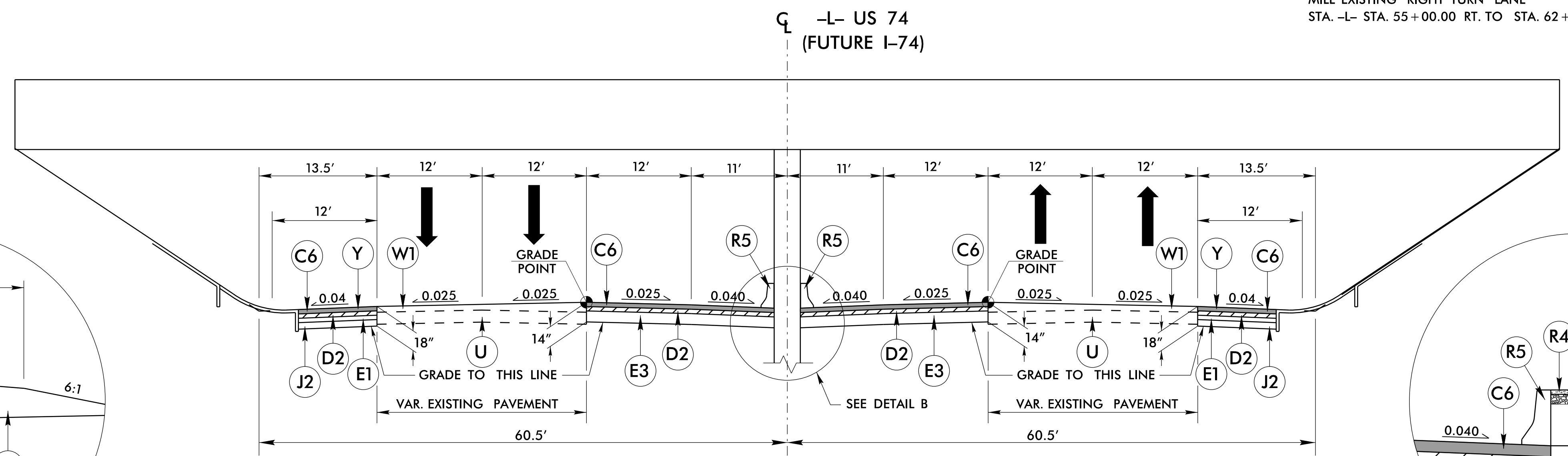

TYPICAL SECTION ON ROADWAY UNDER STRUCTURE
 -L- STA. 42+18.97 TO -L- STA. 42+61.03

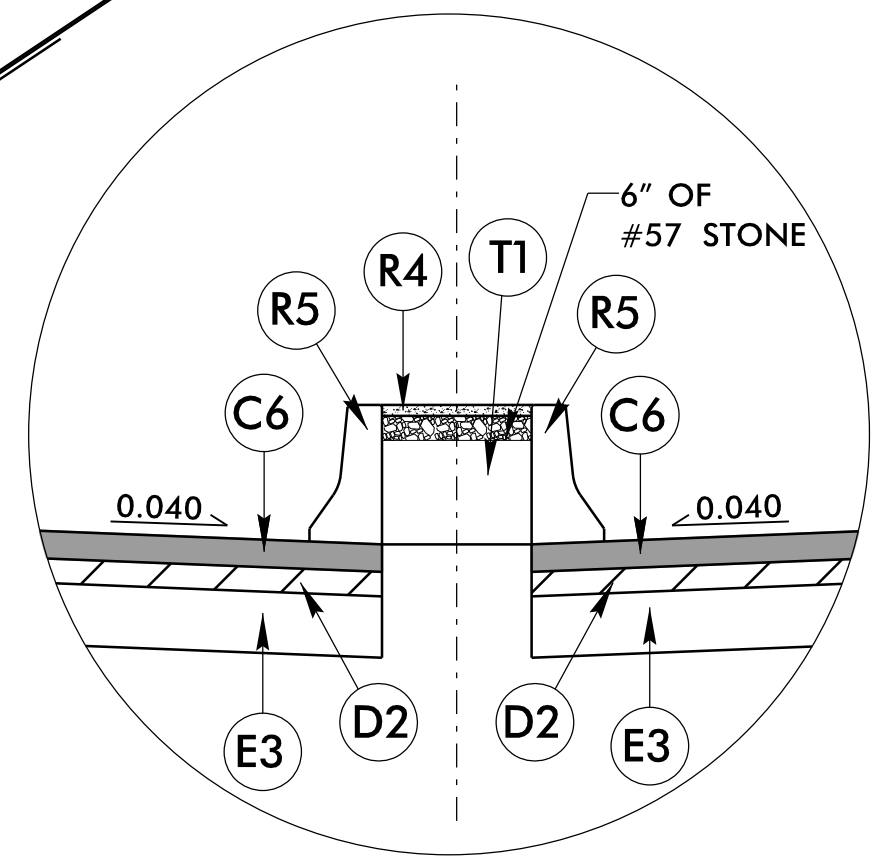

DETAIL B - FOR AREAS WITHOUT COLUMNS
 SEE SHEET 2C-1 FOR MORE INFORMATION ON MEDIAN HAZARD PROTECTION

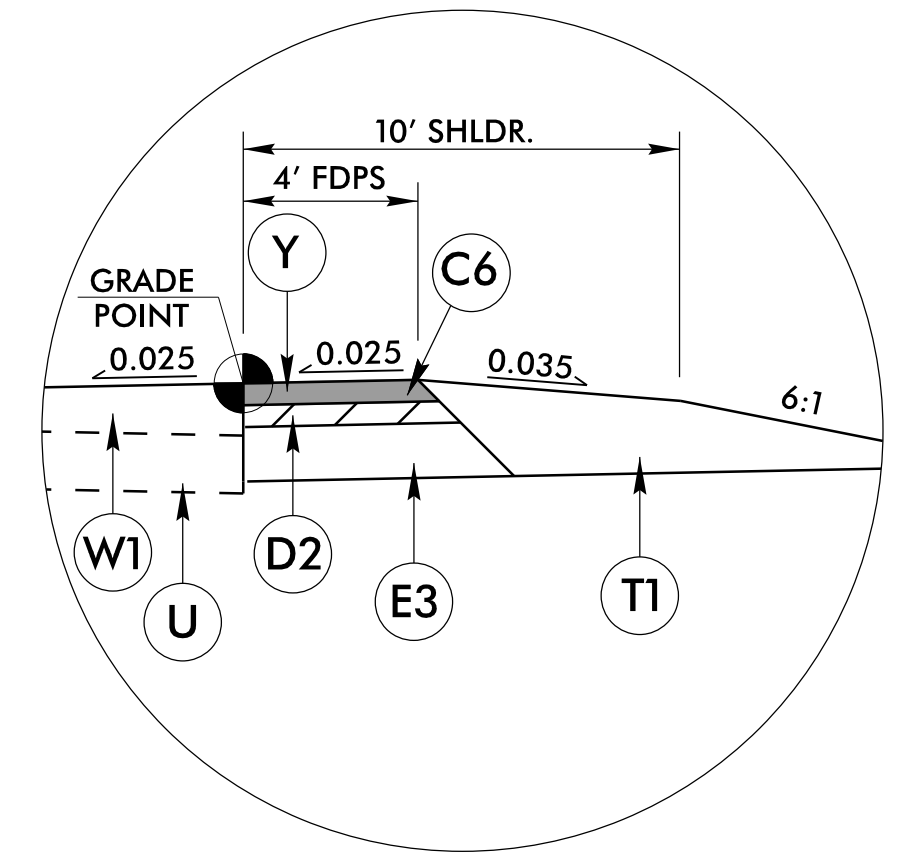

DETAIL A
 (MIRROR FOR RIGHT SIDE)

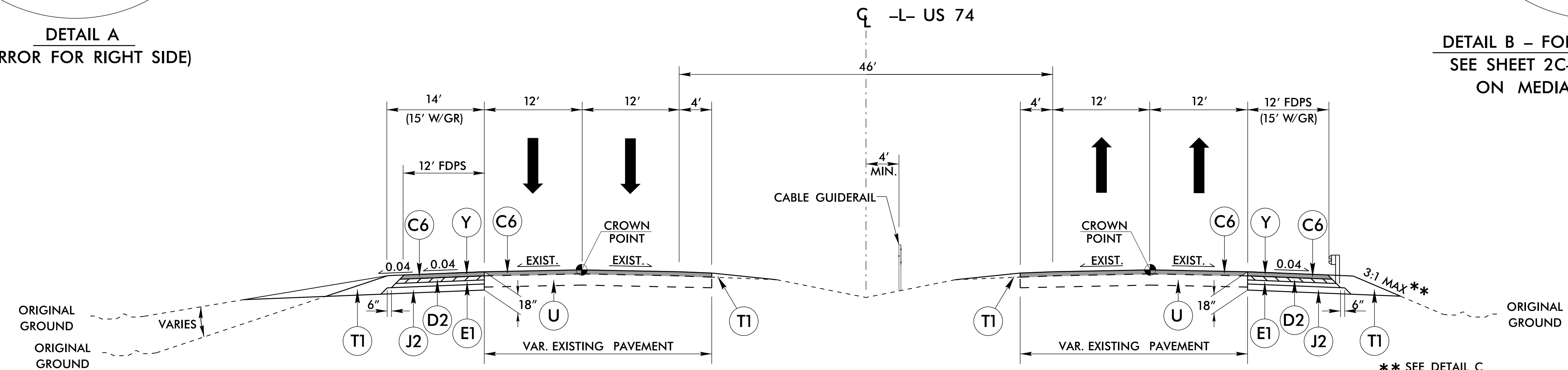

TYPICAL SECTION NO. 2
 -L- STA. 66+00.00 TO -L- STA. 74+36.00

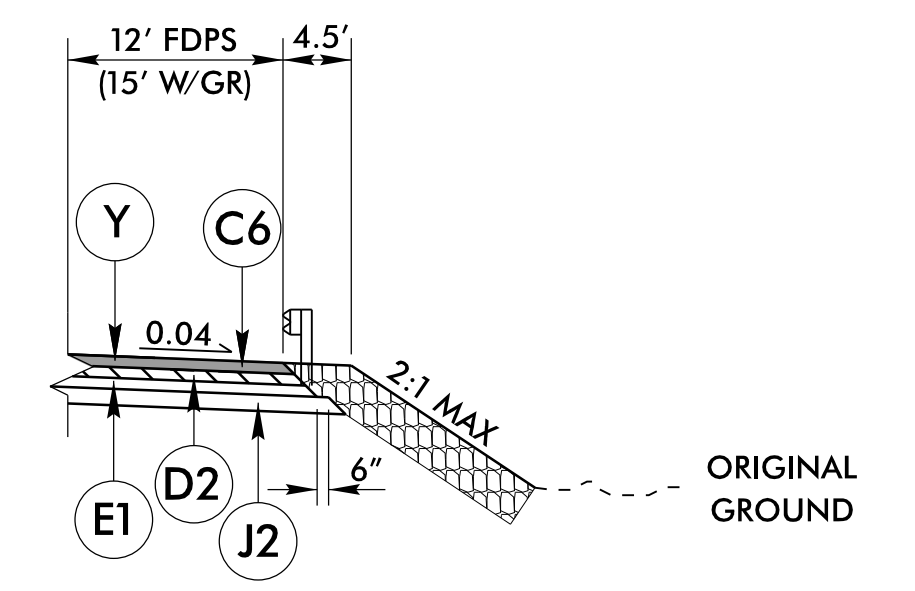

DETAIL C - ROCK PLATING
 -L- STA. 68+60.00 TO -L- STA. 69+25.00 RT.

07 JAN 2007 15:24 R:\RAN\0606\05751.Rd\..._tup.dgn