

# MONTGOMERY COUNTY RESURFACING

# Maps 1 and 2

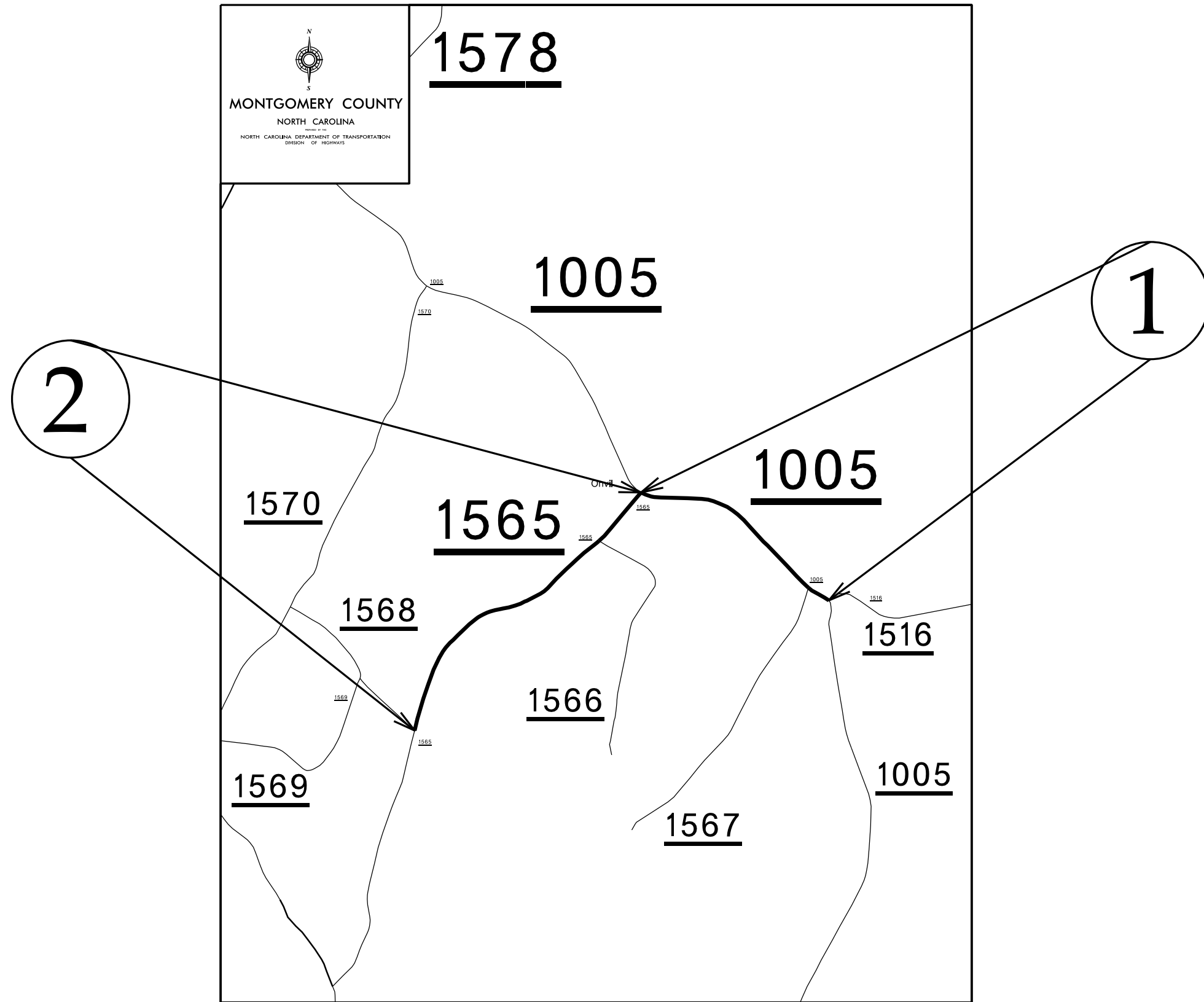

# Map 3

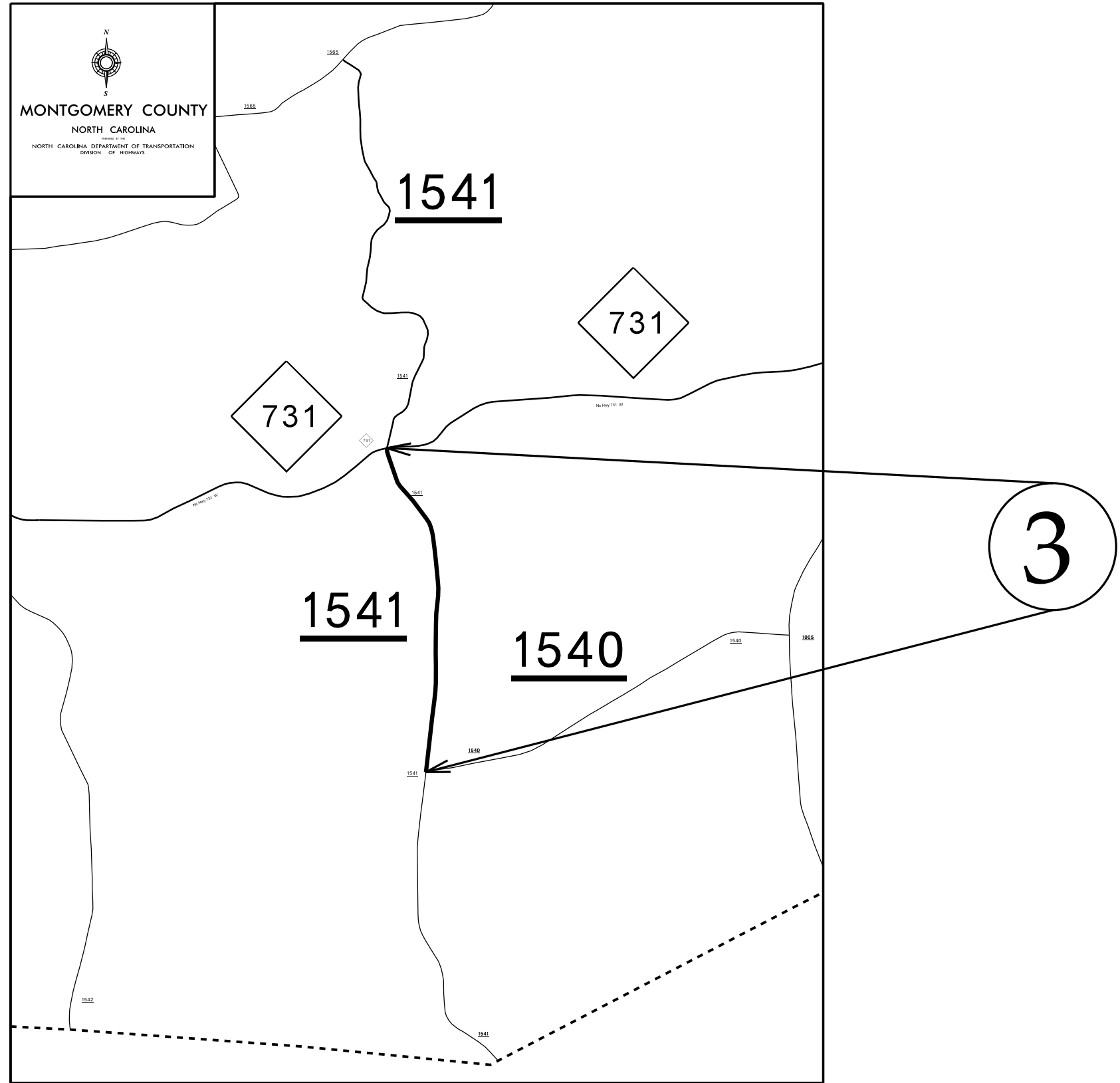

# Map 4

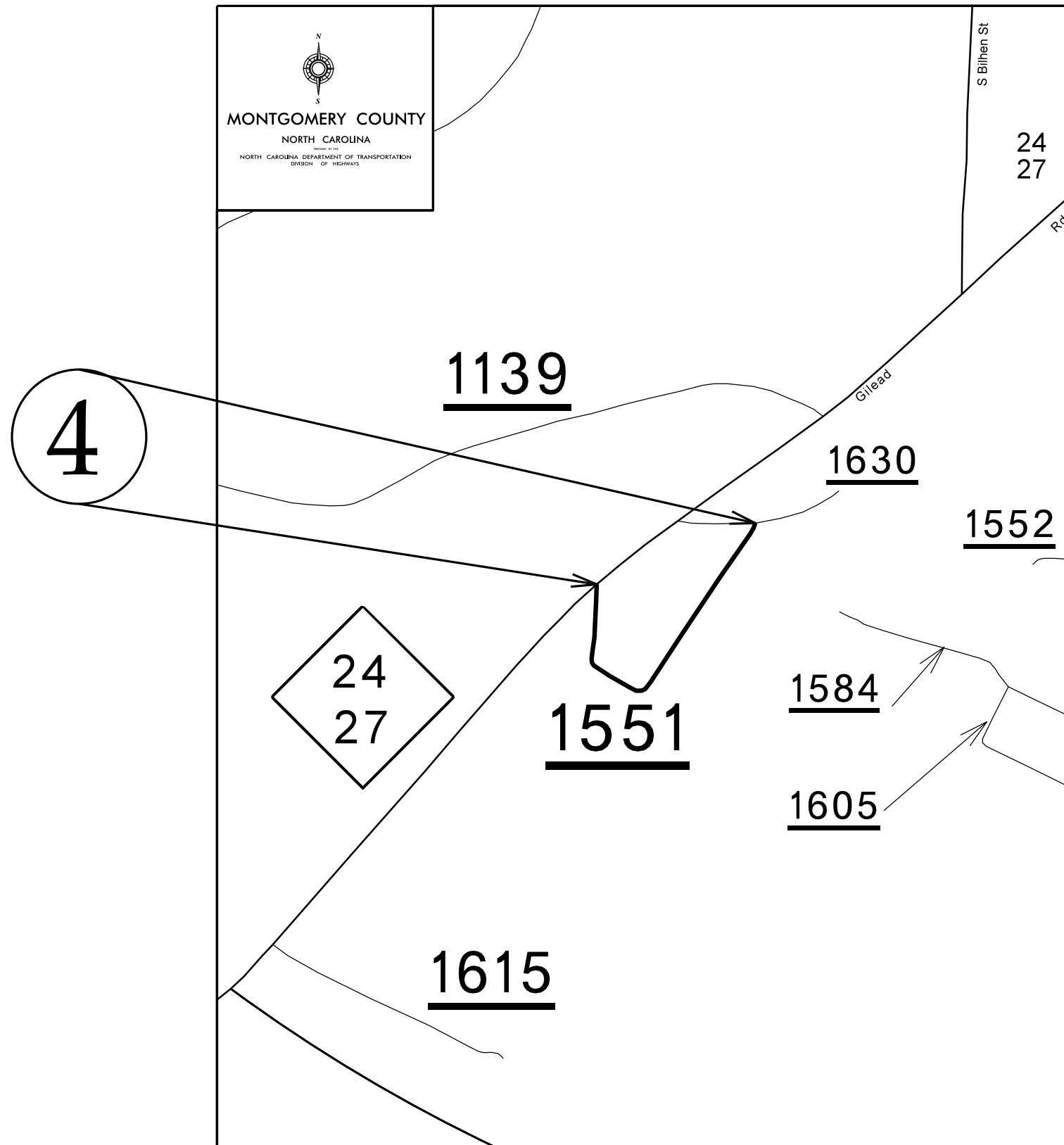

# Map 5

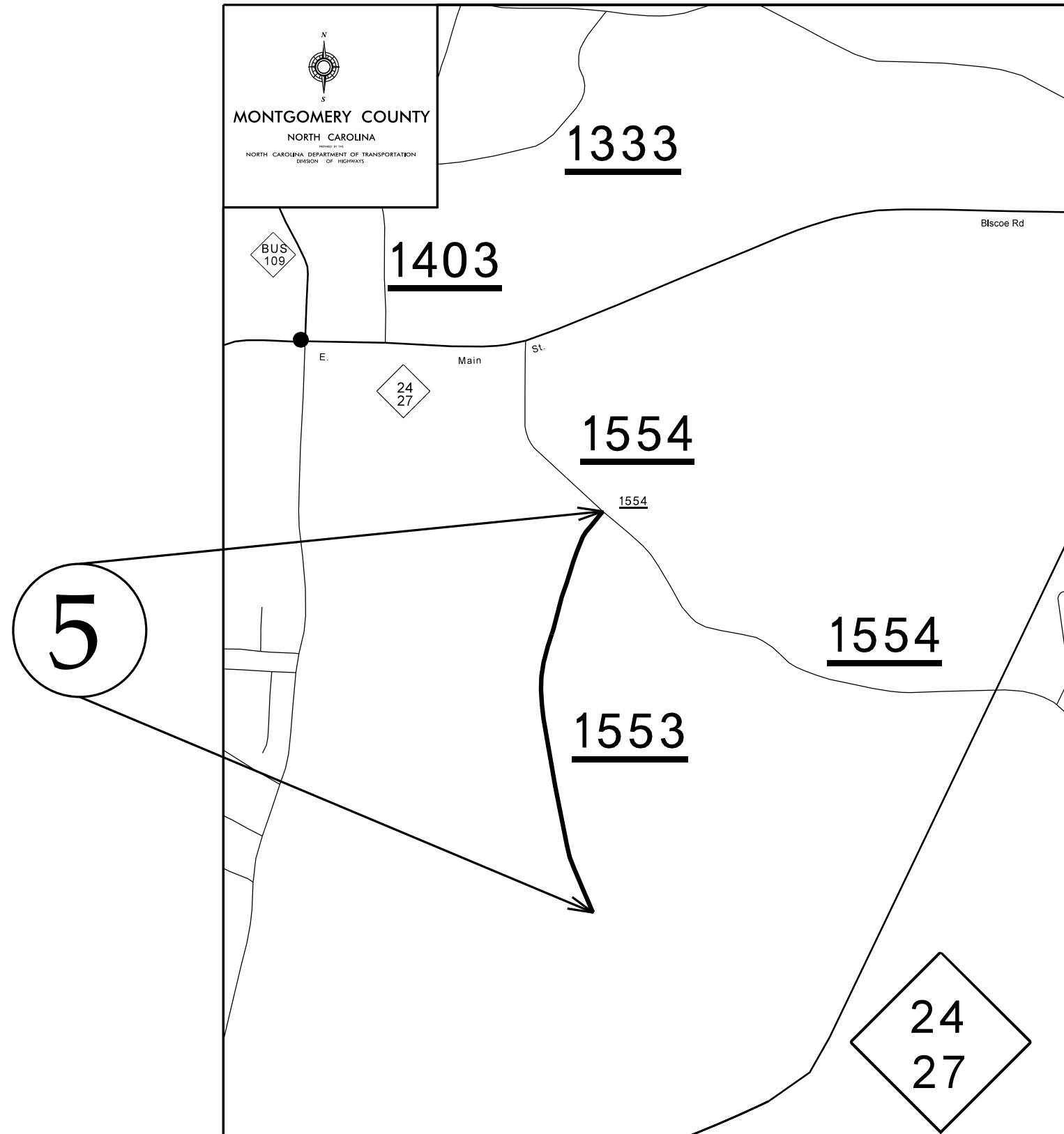

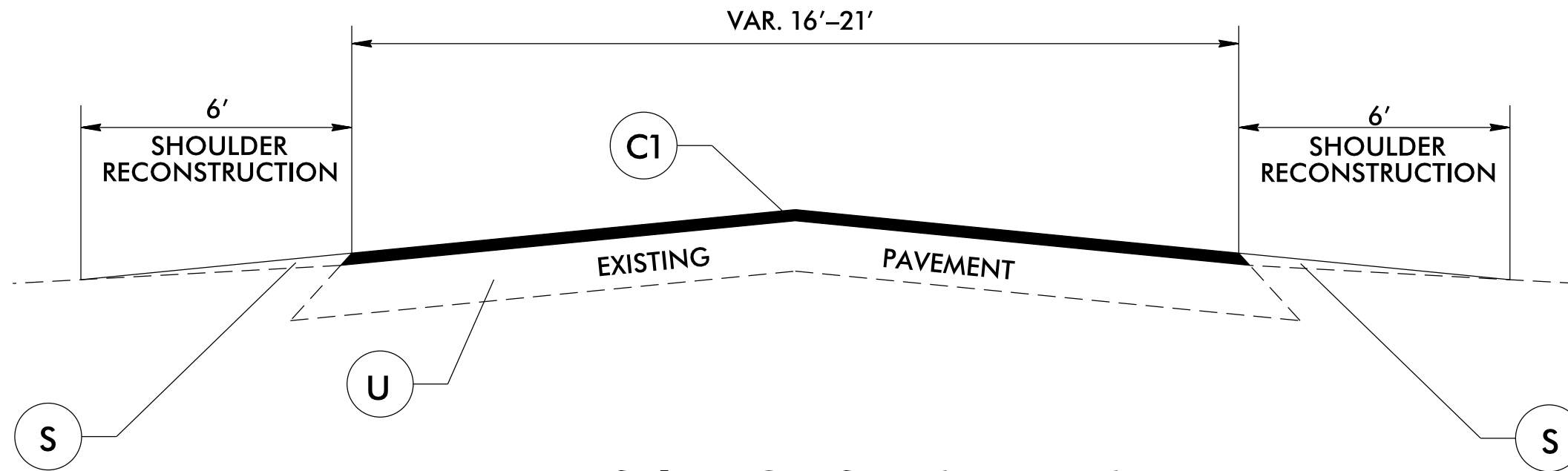

## ***TYPICAL SECTION NO. 1***

<b>PAVEMENT SCHEDULE</b>	
C1	PROP. APPROX. 1.5" ASPHALT CONCRETE SURFACE COURSE, TYPE S9.5B, AT AN AVERAGE RATE OF 165 LBS. PER SQ. YD.
S	AGGREGATE SHOULDER BORROW
U	EXISTING PAVEMENT.

# DETAILS AND NOTES

## PAVEMENT TIE-IN DETAIL

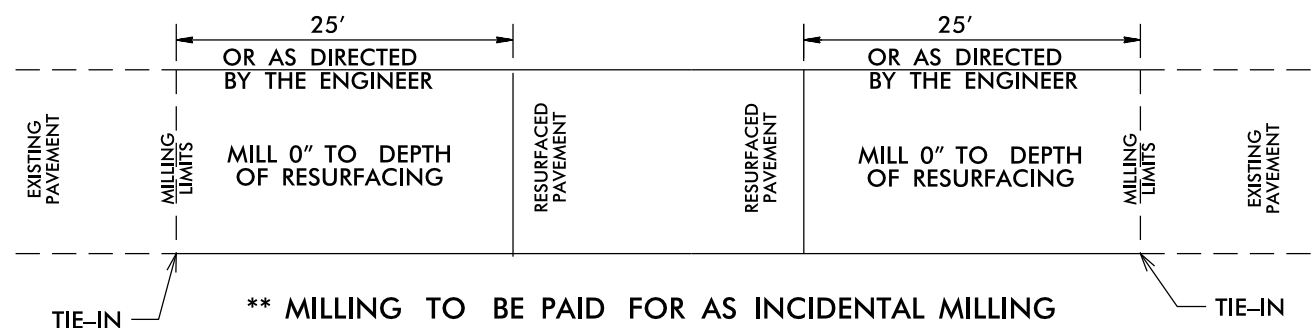

## DETAILS OF PATCHING EXISTING PAVEMENT PRIOR TO RESURFACING

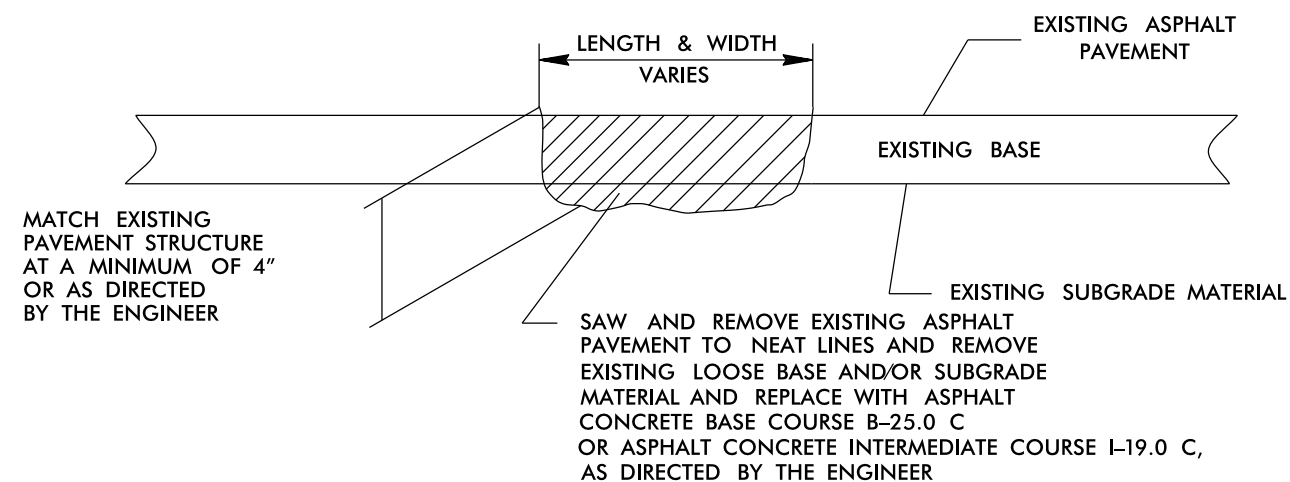

## PROJECT NOTES

- ONE COAT OF PAINT MARKINGS TO BE APPLIED ON MAPS 1,2, AND 3. PERMANENT MARKINGS TO BE HANDLED ON A LATER PROJECT.

**NOTES:**

- 1) DETAIL DOES NOT APPLY TO OGAFB AND ULTRA-THIN BONDED WEARING COURSE.
- 2) BACKFILL SHOULDER WITH APPROVED MATERIAL.
- 3) THE SHOULDER WEDGE DEVICE MAY BE DISENGAGED AT PAVED DRIVEWAYS, SIDE STREETS, HIGH SHOULDERS, AND OTHER LOCATIONS NOT FEASIBLE TO CONSTRUCT AS APPROVED BY THE ENGINEER.

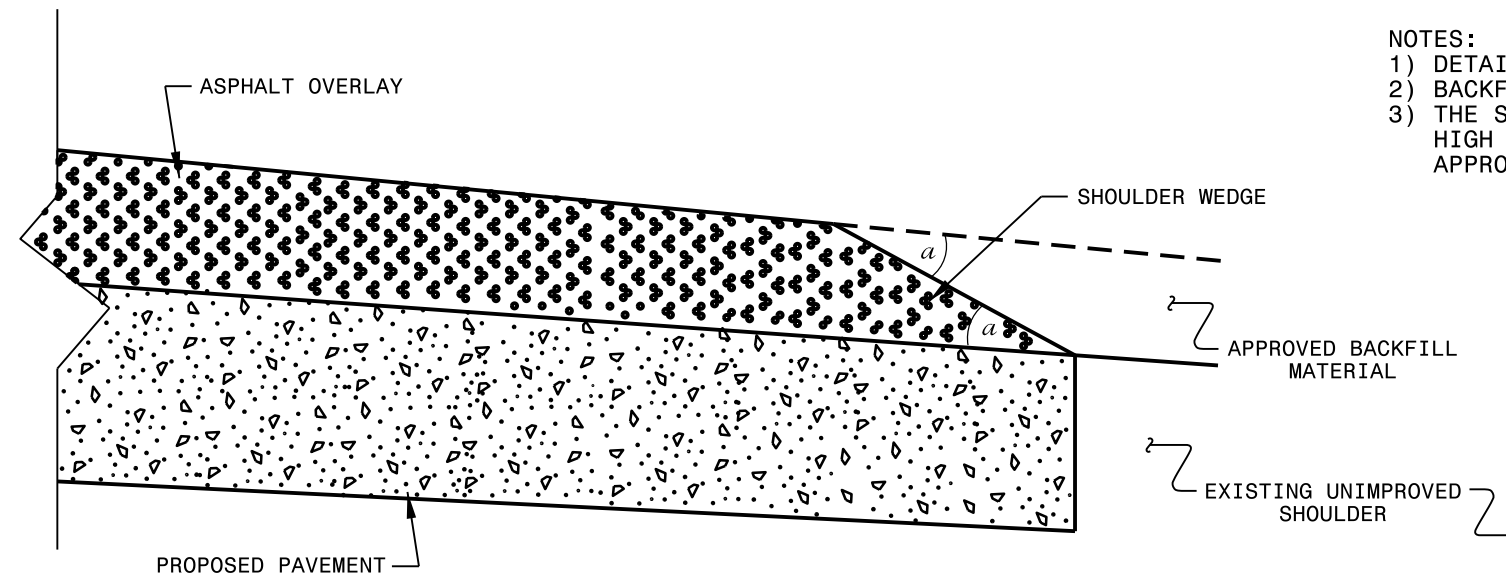

**SHOULDER WEDGE DETAIL**

(Resurfacing Projects w/ Widening or with Existing Paved Shoulder having no dropoffs)

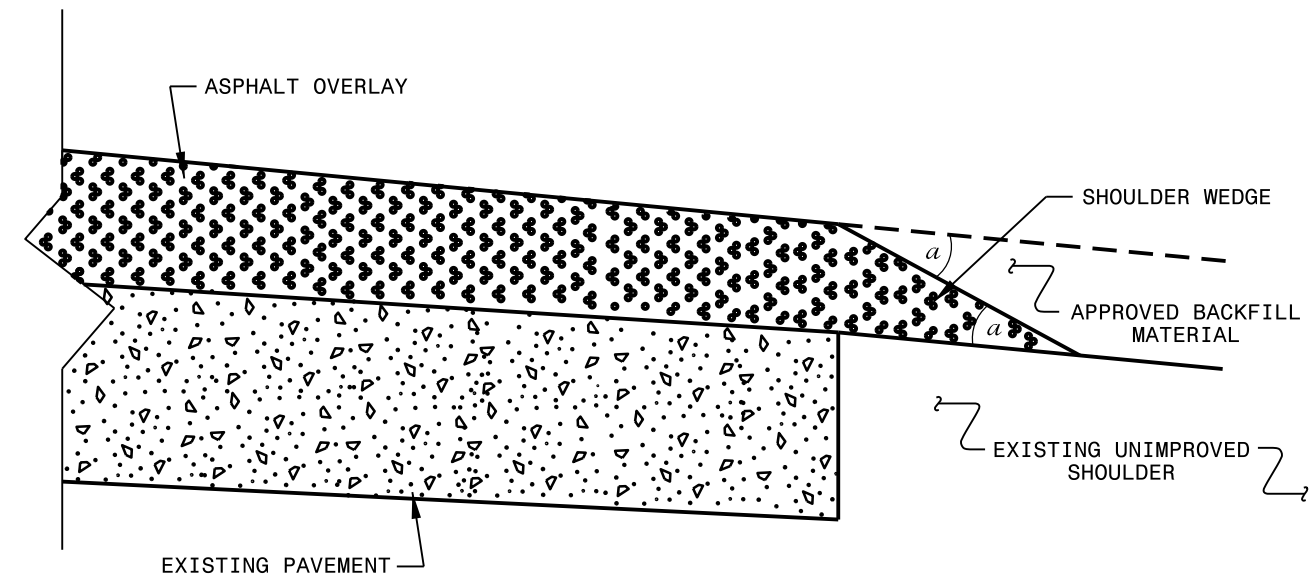

**SHOULDER WEDGE DETAIL**

(Resurfacing Projects w/ NO Widening)

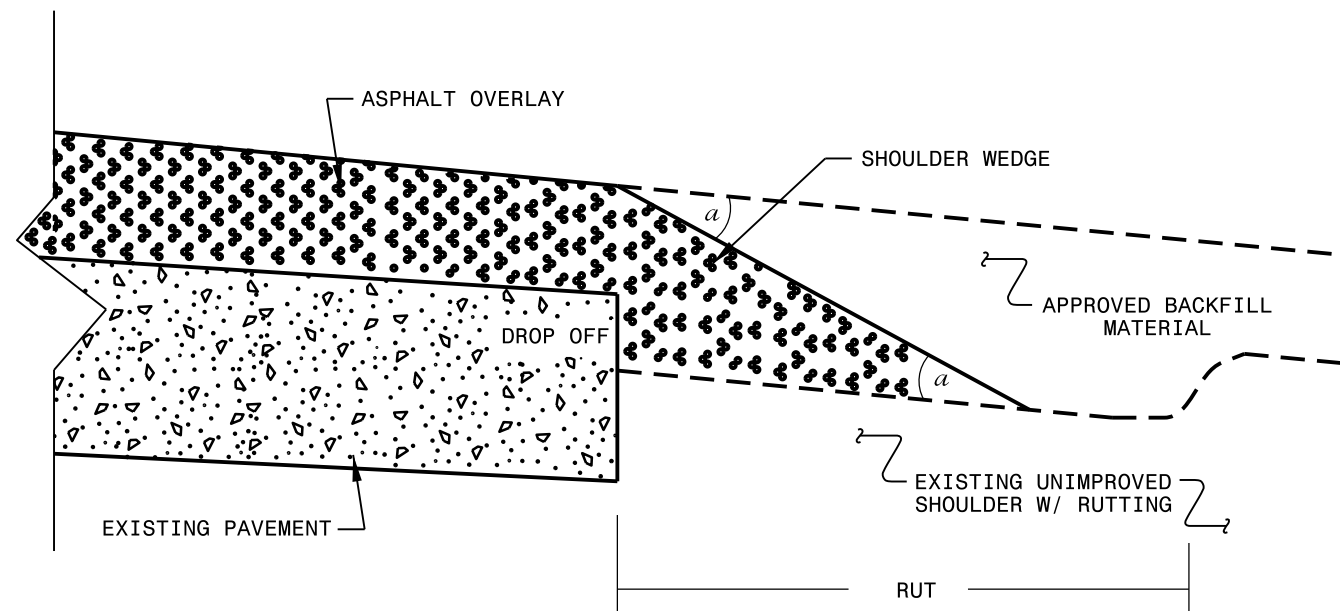

**SHOULDER WEDGE DETAIL**

(Resurfacing Adjacent to Rutted Shoulder)

- SHOULDER WEDGE ANGLE = 30°

<b>CONTRACT STANDARDS AND DEVELOPMENT UNIT</b>		
Office 919-707-6950 FAX 919-250-4119		
<b>SHOULDER WEDGE DETAILS</b>		
ORIGINAL BY: T.SPELL	DATE: 7-19-11	
MODIFIED BY:	DATE: 2/2/16	
CHECKED BY:	DATE:	
FILE SPEC.: szusr/details/stand/shoulderwedgedetail.dgn		



PROJECT NO.	SHEET NO.	TOTAL NO.
2023CPT.08.14.20621	9	

## SUMMARY OF QUANTITIES

PROJECT NO	COUNTY	MAP NO	ROUTE	DESCRIPTION	TYP NO	LANES	LANE TYPE	FINAL SURFACE TESTING REQUIRED	WARM MIX ASPHALT REQUIRED	LENGTH	WIDTH	1245000000-E	1260000000-E	1330000000-E	1519000000-E	1575000000-E	1704000000-E	2830000000-N	2845000000-N
												SHOULDER RECONSTRUCTION	AGGREGATE SHOULDER BORROW	INCIDENTAL MILLING	SURFACE COURSE, \$9.5B	ASPHALT BINDER FOR PLANT MIX	PATCHING EXISTING PAVEMENT	ADJUST MANHOLES	ADJUST METER OR VALVE BOX
												SMI	TON	SY	TONS	TONS	TONS	EA	EA
2023CPT.08.14.20621	Montgomery	1	SR 1005 (PEKIN RD)	FROM SR 1565 (ONVIL RD) TO SR SR 1516 (MCCALLUM RD)	1	2	2WU	NO	NO	0.82	20	1.64	230.00	333	879	60	15		
<b>TOTAL FOR MAP NO. 1</b>										<b>0.82</b>		<b>1.64</b>	<b>230.00</b>	<b>333</b>	<b>879</b>	<b>60</b>	<b>15</b>		
2023CPT.08.14.20621	Montgomery	2	SR 1565 (ONVIL RD)	FROM SR 1568 (BLAKE LOOP EXT.) TO SR 1005 (PEKIN RD)	1	2	2WU	NO	NO	1.35	21	2.70	378.00	642	1,518	104	40		
<b>TOTAL FOR MAP NO. 2</b>										<b>1.35</b>		<b>2.70</b>	<b>378.00</b>	<b>642</b>	<b>1,518</b>	<b>104</b>	<b>40</b>		
2023CPT.08.14.20621	Montgomery	3	SR 1541 (BOWLES RD)	FROM SR 1540 (VALLEY VIEW CHURCH RD) TO NC731	1	2	2WU	NO	NO	1.48	16	2.96	414.00	178	1,271	88	50		
<b>TOTAL FOR MAP NO. 3</b>										<b>1.48</b>		<b>2.96</b>	<b>414.00</b>	<b>178</b>	<b>1,271</b>	<b>88</b>	<b>50</b>		
2023CPT.08.14.20621	Montgomery	4	SR 1551 (OSCAR RD)	FROM SR 1630 (COVINGTON RD) TO NC 24/NC 109	1	2	2WU	NO	NO	0.43	18	0.86	120.00	200	415	29	15		1
<b>TOTAL FOR MAP NO. 4</b>										<b>0.43</b>		<b>0.86</b>	<b>120.00</b>	<b>200</b>	<b>415</b>	<b>29</b>	<b>15</b>		<b>1</b>
2023CPT.08.14.20621	Montgomery	5	SR 1553 (ROSLYN RD)	FROM SR 1554 (TAFT ST/TROY-CANDOR RD) TO END OF PAVEMENT	1	2	2WU	NO	NO	0.76	20	1.52	213.00	111	814	55	10	1	
<b>TOTAL FOR MAP NO. 5</b>										<b>0.76</b>		<b>1.52</b>	<b>213.00</b>	<b>111</b>	<b>814</b>	<b>55</b>	<b>10</b>	<b>1</b>	
<b>TOTAL FOR PROJ NO. 2023CPT.08.14.20621</b>										<b>4.84</b>		<b>9.68</b>	<b>1,355.00</b>	<b>1,464</b>	<b>4,897</b>	<b>336</b>	<b>130</b>	<b>1</b>	<b>1</b>
<b>GRAND TOTAL</b>										<b>4.84</b>		<b>9.68</b>	<b>1,355.00</b>	<b>1,464</b>	<b>4,897</b>	<b>336</b>	<b>130</b>	<b>1</b>	<b>1</b>

PROJECT NO.	SHEET NO.	TOTAL NO.
2023CPT.08.14.20621	10	

**THERMOPLASTIC AND PAINT QUANTITIES**

PROJECT NO	COUNTY	MAP NO	ROUTE	DESCRIPTION	TYP NO	LANES	LANE TYPE			4413000000-E	4457000000-N	4810000000-E	4810000000-E
								LENGTH	WIDTH	WORK ZONE ADVANCE/GENERAL WARNING SIGNING	TEMPORARY TRAFFIC CONTROL	4" WHITE PAINT	4" YELLOW PAINT
								MI	FT	SF	LS	LF	LF
2023CPT.08.14.20621	Montgomery	1	SR 1005 (PEKIN RD)	FROM SR 1565 (ONVIL RD) TO SR SR 1516 (MCCALLUM RD)	1	2	2WU	0.82	20	95		8,823	8,823
<b>TOTAL FOR MAP NO. 1</b>								<b>0.82</b>		<b>95</b>		<b>8,823</b>	<b>8,823</b>
2023CPT.08.14.20621	Montgomery	2	SR 1565 (ONVIL RD)	FROM SR 1568 (BLAKE LOOP EXT.) TO SR 1005 (PEKIN RD)	1	2	2WU	1.35	21	155		14,526	10,895
<b>TOTAL FOR MAP NO. 2</b>								<b>1.35</b>		<b>155</b>		<b>14,526</b>	<b>10,895</b>
2023CPT.08.14.20621	Montgomery	3	SR 1541 (BOWLES RD)	FROM SR 1540 (VALLEY VIEW CHURCH RD) TO NC731	1	2	2WU	1.48	16	170	*	15,925	15,925
<b>TOTAL FOR MAP NO. 3</b>								<b>1.48</b>		<b>170</b>		<b>15,925</b>	<b>15,925</b>
2023CPT.08.14.20621	Montgomery	4	SR 1551 (OSCAR RD)	FROM SR 1630 (COVINGTON RD) TO NC 24/NC 109	1	2	2WU	0.43	18	50			
<b>TOTAL FOR MAP NO. 4</b>								<b>0.43</b>		<b>50</b>			
2023CPT.08.14.20621	Montgomery	5	SR 1553 (ROSLYN RD)	FROM SR 1554 (TAFT ST/TROY-CANDOR RD) TO END OF PAVEMENT	1	2	2WU	0.76	20	90			
<b>TOTAL FOR MAP NO. 5</b>								<b>0.76</b>		<b>90</b>			
<b>TOTAL FOR PROJ NO. 2023CPT.08.14.20621</b>								<b>4.84</b>		<b>560</b>	<b>1</b>	<b>39,274</b>	<b>35,643</b>
<b>GRAND TOTAL</b>								<b>4.84</b>		<b>560</b>	<b>1</b>	<b>74,917</b>	

# SIGNING FOR RESURFACING PROJECTS

**LEGEND**  
 ┆ STATIONARY SIGN  
 ← DIRECTION OF TRAFFIC FLOW

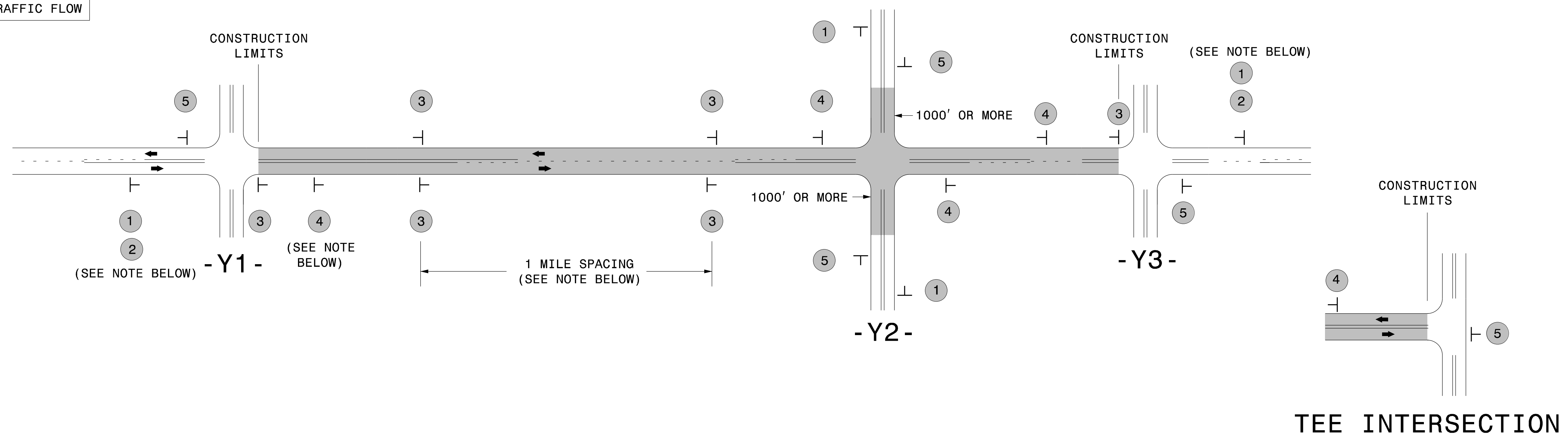

## MAINLINE (-L-) SIGNING

## -Y- LINE SIGNING

SIGNING NOTES AND PLACEMENT PER DIRECTION	1		PLACE 1000' PRIOR TO BEGINNING OF CONSTRUCTION LIMITS. ONLY USED ON -Y- LINES IF RESURFACING LIMITS EXTEND 1000' ALONG -Y- LINE.	<p>NO REQUIRED STATIONARY SIGNING FOR THE FOLLOWING -Y- LINE CONDITIONS:</p> <ol style="list-style-type: none"> <li>LESS THAN 1000' OF RESURFACING ALONG -Y- LINE</li> <li>SUBDIVISION ROADS</li> <li>DEAD END ROADS</li> </ol> <p>WHEN PAVING/CONSTRUCTION ACTIVITIES PROCEED ACROSS AN UNSIGNED -Y- LINE, PORTABLE ADVANCE WARNING SIGNS SHALL BE USED ALONG THE -Y- LINE AS SHOWN BELOW. REMOVE UPON COMPLETION OF WORK.</p> <div style="display: flex; justify-content: space-around;"> <div style="text-align: center;">             W20-1 48" X 48"            PLACED 500' IN ADVANCE OF FLAGGER.         </div> <div style="text-align: center;">             W20-7 A 48" X 48"            PLACED 250' IN ADVANCE OF FLAGGER.         </div> </div>
	2		#2 SIGN ONLY USED WHEN CONSTRUCTION LIMITS ARE 2 OR MORE MILES IN LENGTH. ROUND UP TO NEXT WHOLE NUMBER. (NO FRACTIONAL OR DECIMAL NUMBERS)	
	3		- PLACE INITIALLY AT THE CONSTRUCTION LIMITS AND SPACE 1 MILE APART THEREAFTER. - AT TEE INTERSECTIONS INSTALL INITIALLY 1/2 MILE FROM INTERSECTION AND SPACE 1 MILE APART THEREAFTER.	
	4		- THESE ARE FOR -Y- LINES THAT ARE "THROUGH" ROADWAYS. - DEAD END AND SUBDIVISION ROADS ARE NOT "THROUGH" ROADWAYS. - INSTALL 500' +/- FROM EACH -Y- LINE APPROACH AS SHOWN ABOVE. - FOR MULTIPLE -Y- LINES THAT ARE SEPARATED BY 0.25 MILES OR LESS, TREAT AS A SINGLE UNIT AND INSTALL WITHIN 500' OF EACH APPROACH. - A MAXIMUM OF 2 SIGN SETS PER MILE. DO NOT INSTALL WHEN -Y- LINES ARE WITHIN 0.5 MILES FROM "END ROAD WORK" SIGN. - FOR TEE INTERSECTIONS, INSTALL WITHIN 500' +/- OF THE INTERSECTION ALONG -L- LINE.	
	5		PLACE 500' FOLLOWING THE END OF CONSTRUCTION LIMITS OR AS SHOWN WHEN WORK ENDS AT A 3-WAY TEE INTERSECTION.	

THE ABOVE SIGNS ARE ALL THAT ARE REQUIRED FOR A CONTRACTOR TO BEGIN A RESURFACING CONTRACT. ANY ADDITIONAL SIGNS REQUESTED BY NCDOT DIVISIONS SHALL BE INSTALLED WITHIN 7 BUSINESS DAYS OF THE START OF CONTRACT WORK.

### MAPS LESS THAN 2 MILES

FOR RESURFACING MAPS WITH CONSTRUCTION LIMITS LESS THAN 2 MILES IN LENGTH, NO STATIONARY SIGNS ARE REQUIRED. USE PORTABLE "ROAD UNDER CONSTRUCTION" OR "ROAD WORK AHEAD" SIGNS IN LIEU OF STATIONARY ADVANCE WARNINGS SIGNS.

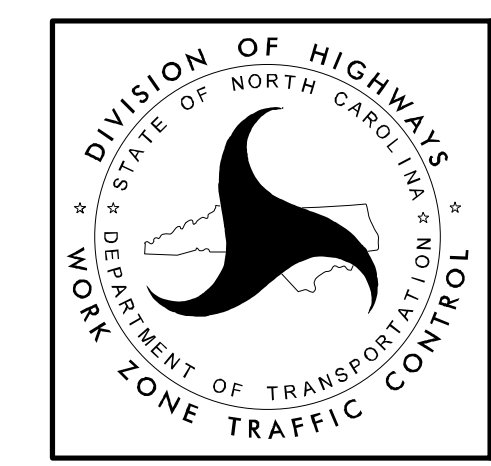

ADVANCE WARNING SIGNS FOR RURAL AND SUBURBAN 2-LANE ROADWAY RESURFACING

5/15/2017 S:\TMU\WZTC\Resurfacing\2L2W & AST Resurfacing Details\Resurfacing\_AdvWarn\_2Ln.dgn User:kadai