

PROJECT REFERENCE NO. U-5724	SHEET NO. PMP-2
R/W SHEET NO.	
ROADWAY DESIGN ENGINEER	
DOCUMENT NOT CONSIDERED FINAL UNLESS ALL SIGNATURES COMPLETED	

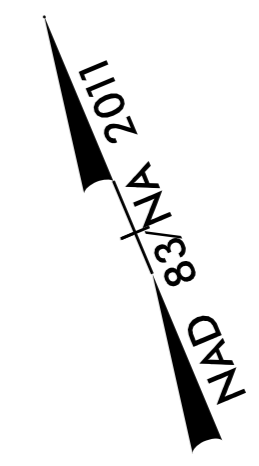

REVISIONS

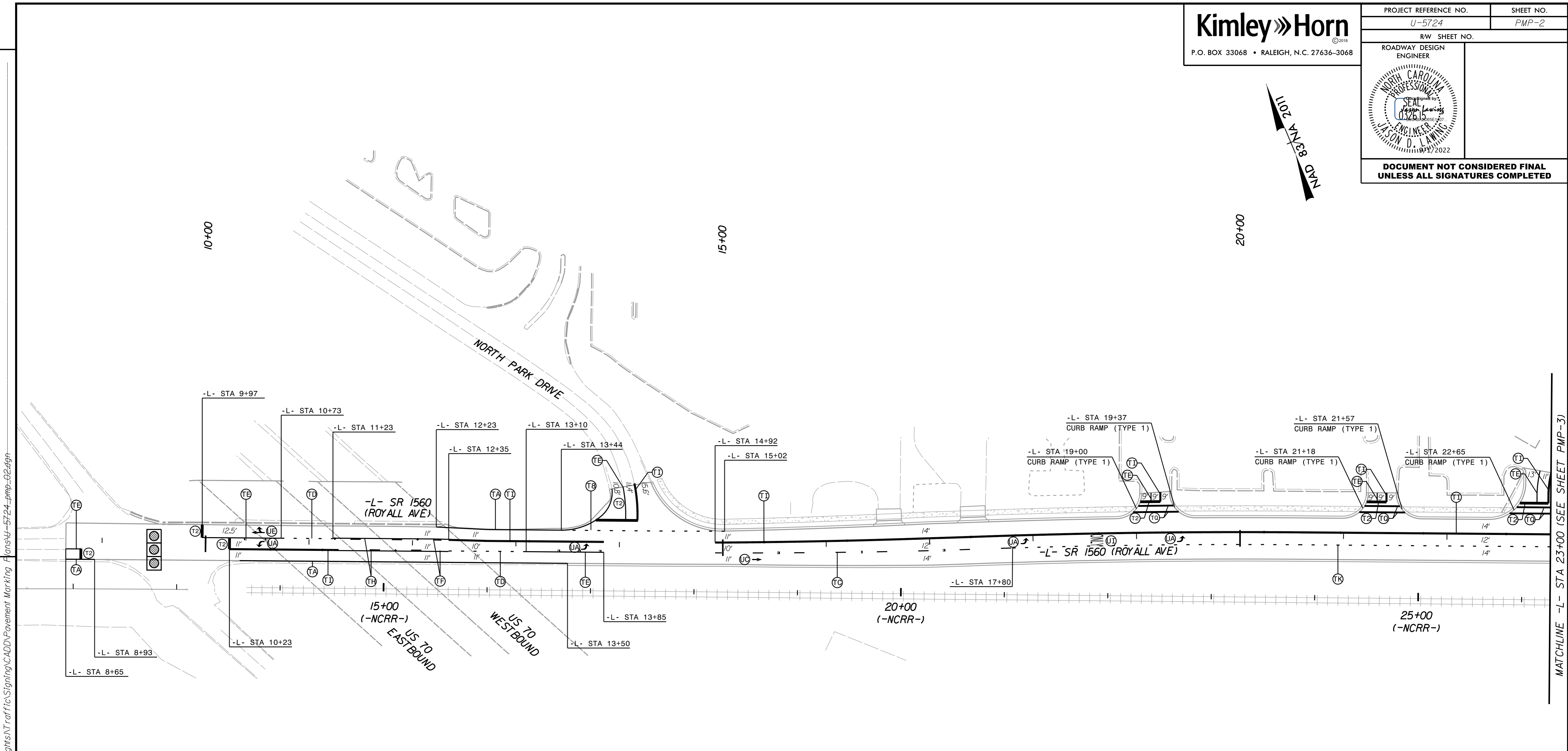

K:\RAL_Roadway\01036333 - U-5724 (Central Heights)\Traffic\Signing\CADD\Pavement Marking Plans\U-5724_pmp-02.dgn

2/20/2020

MATCHLINE -L- STA 23+00 (SEE SHEET PMP-3)

PAVEMENT MARKER LEGEND

- - CRYSTAL / RED PAVEMENT MARKER
- ◆ - YELLOW / YELLOW PAVEMENT MARKER

PAVEMENT MARKING LINES

- | | |
|---|----------------------|
| TA - THERMOPLASTIC (4" WHITE, 90 MILS) | EDGE LINE |
| TB - THERMOPLASTIC (4" YELLOW, 90 MILS) | EDGE LINE |
| TC - THERMOPLASTIC (4" WHITE, 90 MILS) | 10' SKIP |
| TD - THERMOPLASTIC (4" WHITE, 90 MILS) | 3' x 9"/SP MINI-SKIP |
| TE - THERMOPLASTIC (4" WHITE, 90 MILS) | SOLID LANE LINE |
| TF - THERMOPLASTIC (4" YELLOW, 90 MILS) | 10' SKIP |
| TH - THERMOPLASTIC (4" YELLOW, 90 MILS) | SINGLE CENTER LINE |
| TI - THERMOPLASTIC (4" YELLOW, 90 MILS) | DOUBLE CENTER LINE |
| TK - THERMOPLASTIC (6" WHITE, 90 MILS) | 3' x 9"/SP MINI-SKIP |
| TL - THERMOPLASTIC (6" WHITE, 90 MILS) | SOLID LANE LINE |
| TP - THERMOPLASTIC (8" YELLOW, 90 MILS) | DIAGONAL LINE |
| TQ - THERMOPLASTIC (8" WHITE, 90 MILS) | CROSSWALK LINE |
| T1 - THERMOPLASTIC (16" WHITE, 90 MILS) | RR X |
| T2 - THERMOPLASTIC (24" WHITE, 90 MILS) | STOP BAR |
| T8 - THERMOPLASTIC (4" WHITE, 90 MILS) | 2'-6"/SP MINI-SKIP |
| T9 - THERMOPLASTIC (4" YELLOW, 90 MILS) | 2'-6"/SP MINI-SKIP |

PAVEMENT MARKING SYMBOLS/CHARACTERS

- | | |
|-------------------------------------|----------------------------|
| UA - THERMOPLASTIC (WHITE, 90 MILS) | LEFT TURN ARROW |
| UB - THERMOPLASTIC (WHITE, 90 MILS) | RIGHT TURN ARROW |
| UC - THERMOPLASTIC (WHITE, 90 MILS) | STRAIGHT ARROW |
| UD - THERMOPLASTIC (WHITE, 90 MILS) | COMBO LEFT/STRAIGHT ARROW |
| UE - THERMOPLASTIC (WHITE, 90 MILS) | COMBO RIGHT/STRAIGHT ARROW |
| UI - THERMOPLASTIC (WHITE, 90 MILS) | ALPHANUMERIC CHARACTER |

