

**This electronic collection of documents is provided
for the convenience of the user
and is Not a Certified Document –**

**The documents contained herein were originally issued
and sealed by the individuals whose names and license
numbers appear on each page, on the dates appearing
with their signature on that page.**

**This file or an individual page
shall not be considered a certified document.**

B-5318
REPLACE BRIDGE #126 OVER SMITH CREEK
ON SR 2044 (LIGON MILL ROAD)
CROSS-SECTIONS

INDEX OF SHEETS

<u>TITLE</u>	<u>SHEET NO.</u>
CROSS SECTION SUMMARY	X-0 THRU X-0A
-L-	X-1 THRU X-8
-Y1-	X-9
-DRW1-	X-10
-DRW2-	X-11
-DET-	X-12 THRU X-16
-MUT1-	X-17

STATE OF NORTH CAROLINA DIVISION OF HIGHWAYS

Note: Approximate quantities only. Unclassified excavation, borrow excavation, shoulder borrow, fine grading, clearing and grubbing, breaking of existing pavement, and removal of existing pavement will be paid for at the contract lump sum price for grading.

NOTE: EMBANKMENT COLUMN DOES NOT INCLUDE BACKFILL FOR UNDERCUT

CROSS-SECTION SUMMARY

Station	Uncl. Exc.	Embt	Station	Uncl. Exc.	Embt														
L	(cu. yd.)	(cu. yd.)	Y1	(cu. yd.)	(cu. yd.)														
10+25.00	0	0	12+80.00	0	0														
10+50.00	34	9	13+00.00	8	0														
11+00.00	59	22	13+16.00	12	0														
11+50.00	52	29	13+50.00	11	6														
12+00.00	39	28	14+00.00	0	79														
12+50.00	14	52	14+29.72	0	84														
13+00.00	1	159																	
13+50.00	0	343	Station	Uncl. Exc.	Embt														
14+00.00	0	700																	
14+50.00	0	1176	DRW1	(cu. yd.)	(cu. yd.)														
15+00.00	0	1515	10+32.54	0	0														
15+50.00	0	1762	10+50.00	0	145														
16+00.00	0	2249	11+00.00	0	301														
16+50.00	0	2613	11+50.00	0	102														
17+00.00	0	2609	12+00.00	5	9														
17+50.00	0	2556																	
18+00.00	0	2470	Station	Uncl. Exc.	Embt														
18+50.00	0	2287																	
18+73.00	0	990	DRW2	(cu. yd.)	(cu. yd.)														
			10+32.50	0	0														
Station	Uncl. Exc.	Embt	10+50.00	0	505														
L	(cu. yd.)	(cu. yd.)	11+00.00	0	1051														
			11+50.00	0	391														
20+73.00	0	0	12+00.00	10	61														
21+00.00	0	1095																	
21+50.00	0	2043	Station	Uncl. Exc.	Embt														
22+00.00	0	1546																	
22+50.00	0	696	DET	(cu. yd.)	(cu. yd.)														
23+00.00	0	231	11+00.00	0	0														
23+50.00	87	94	11+50.00	1	1														
24+00.00	184	131	12+00.00	2	14														
24+50.00	251	100	12+50.00	2	44														
25+00.00	492	12	13+00.00	2	57														
25+50.00	698	0	13+50.00	7	25														
26+00.00	714	0	14+00.00	11	0														
26+50.00	694	0	14+50.00	5	12														
27+00.00	609	0	15+00.00	3	12														
27+50.00	445	0	15+50.00	2	0														
28+00.00	284	6																	
28+50.00	161	26	Station	Uncl. Exc.	Embt														
29+00.00	84	106																	
29+50.00	32	85	MUT1	(cu. yd.)	(cu. yd.)														
			10+50.00	0	0														
			11+00.00	130	0														
			11+50.00	157	0														
			11+90.00	360	0														

6/23/16

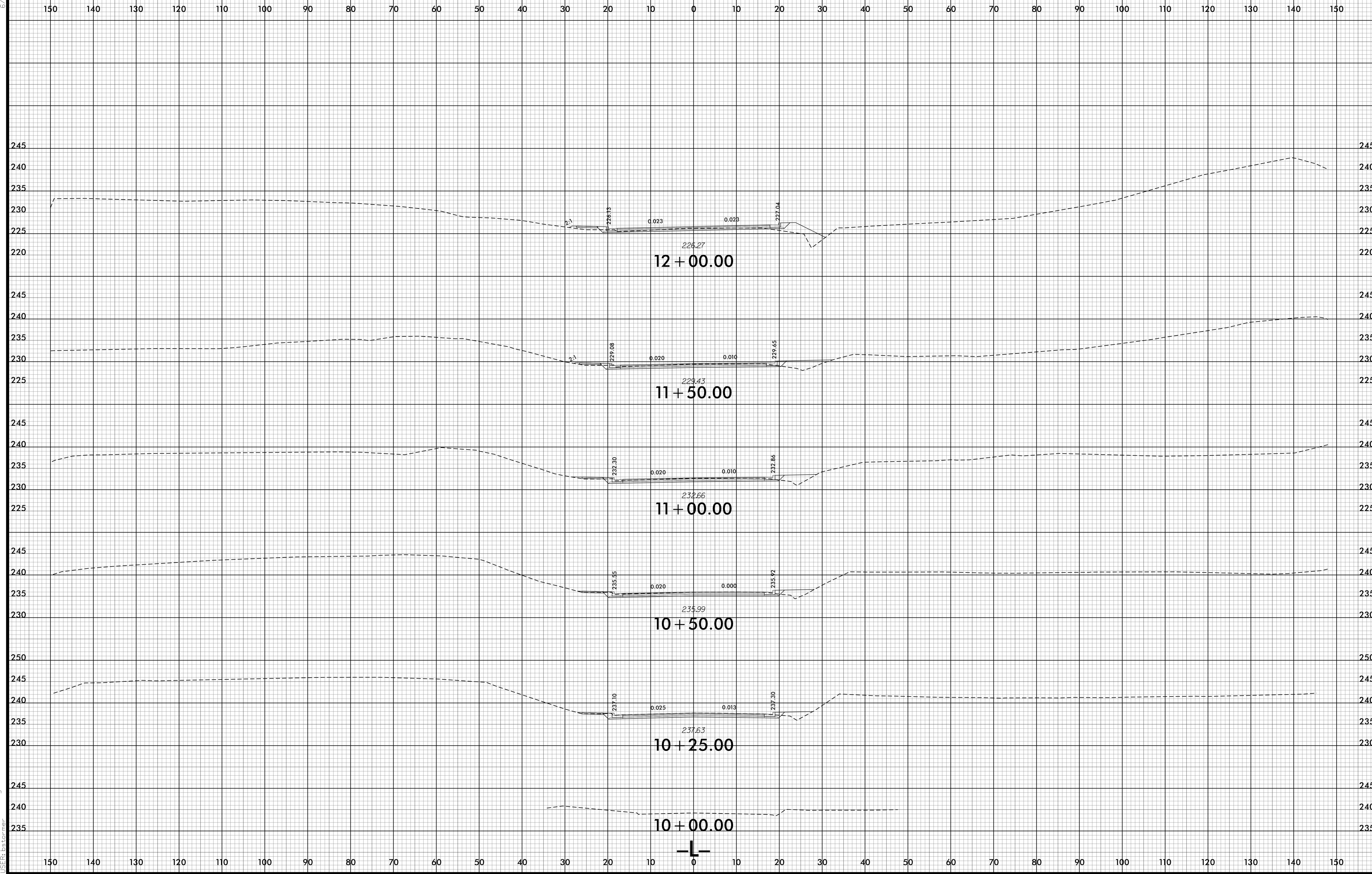

8/3/2022 11:46:12 AM
i:\B5318-RDY_XPL\1.dgn

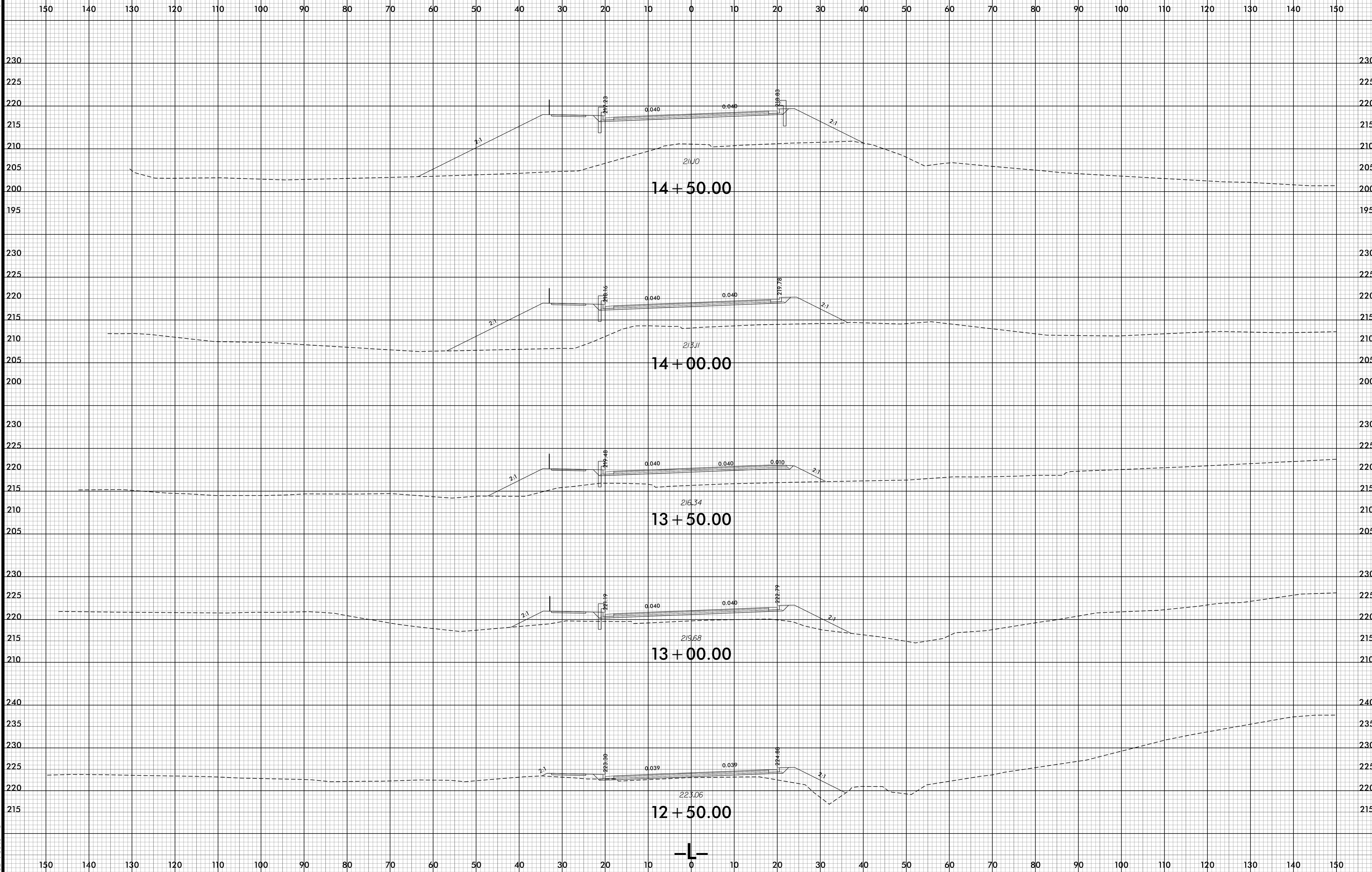

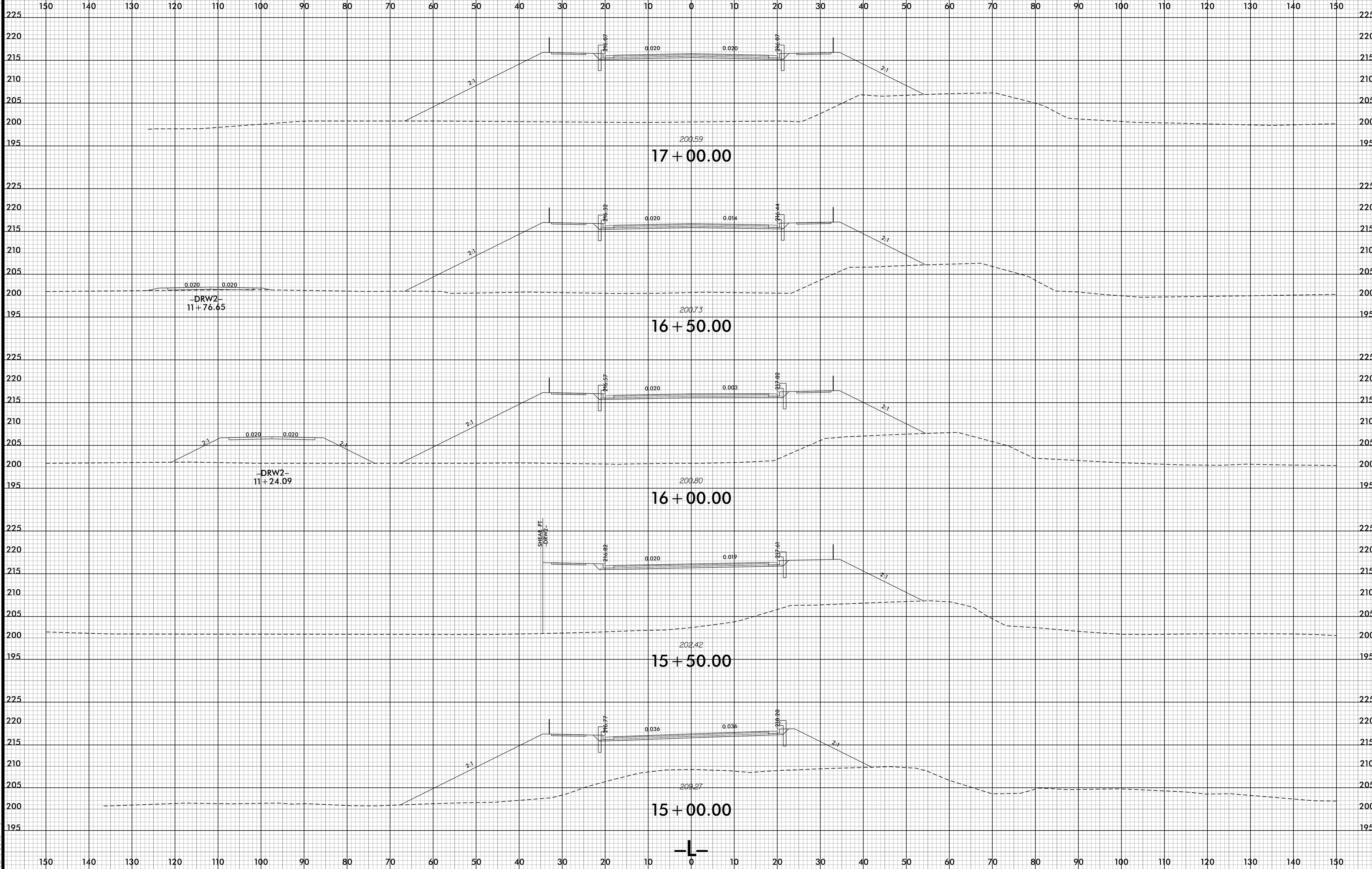

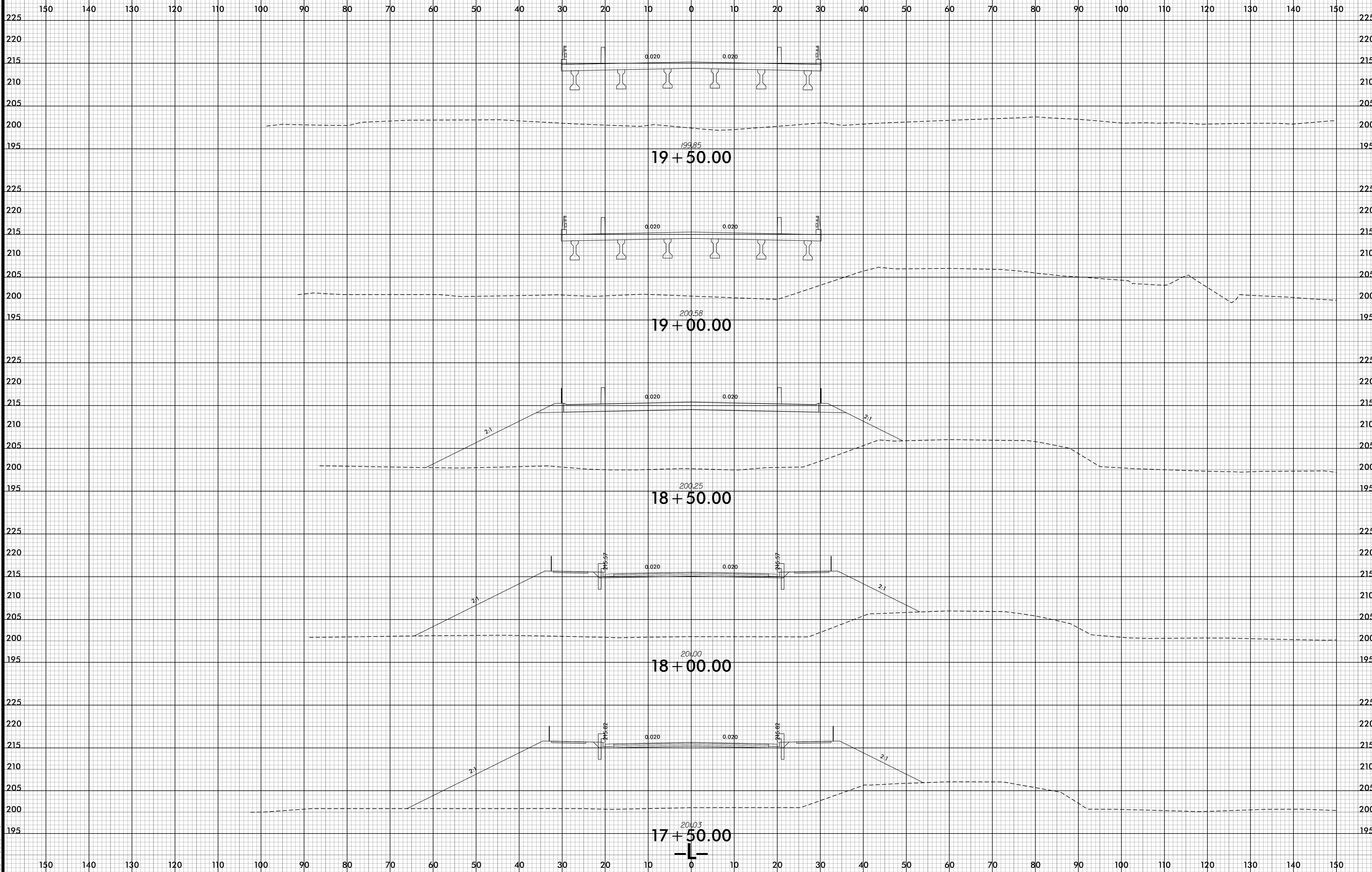

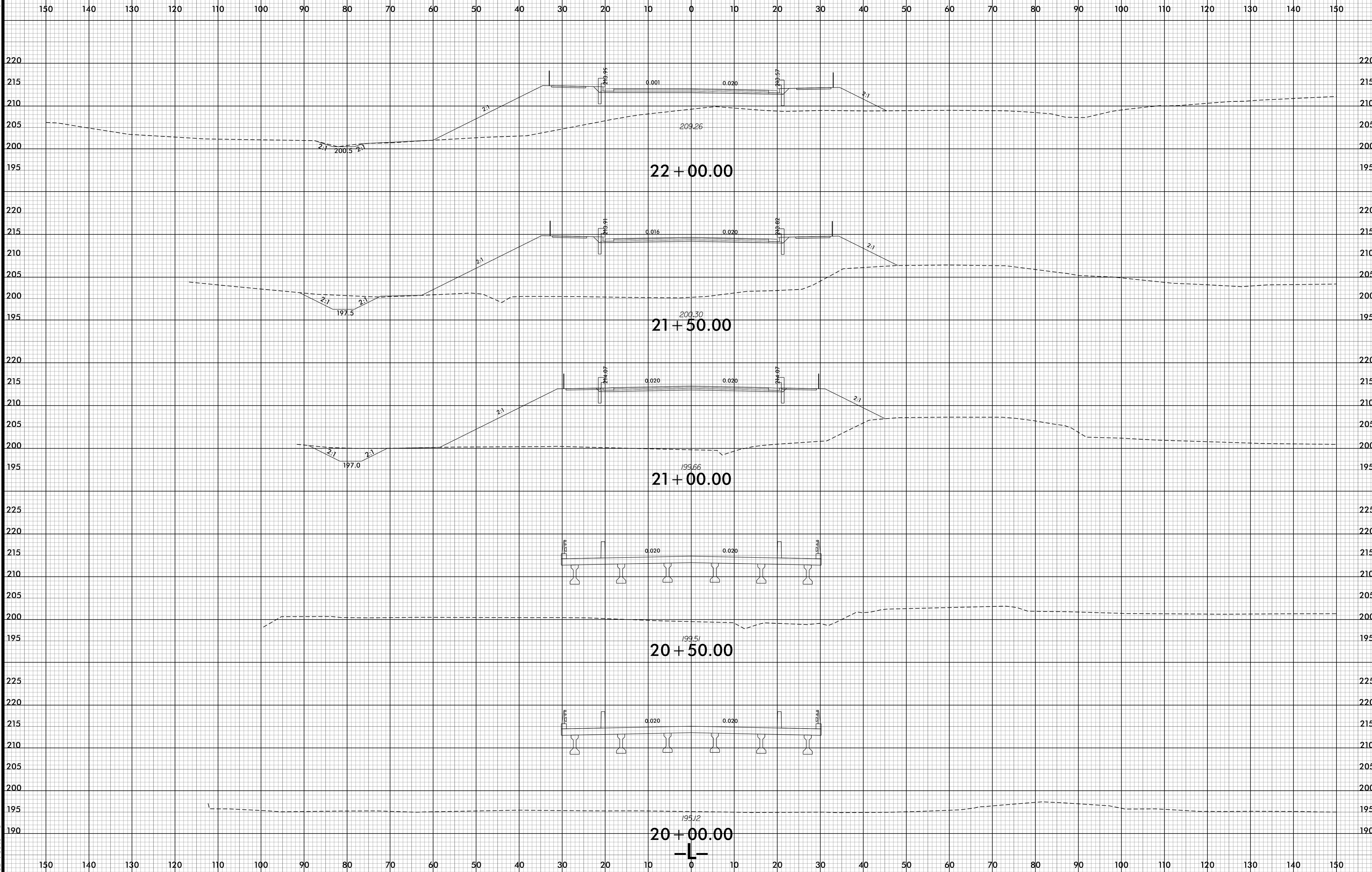

6/23/16

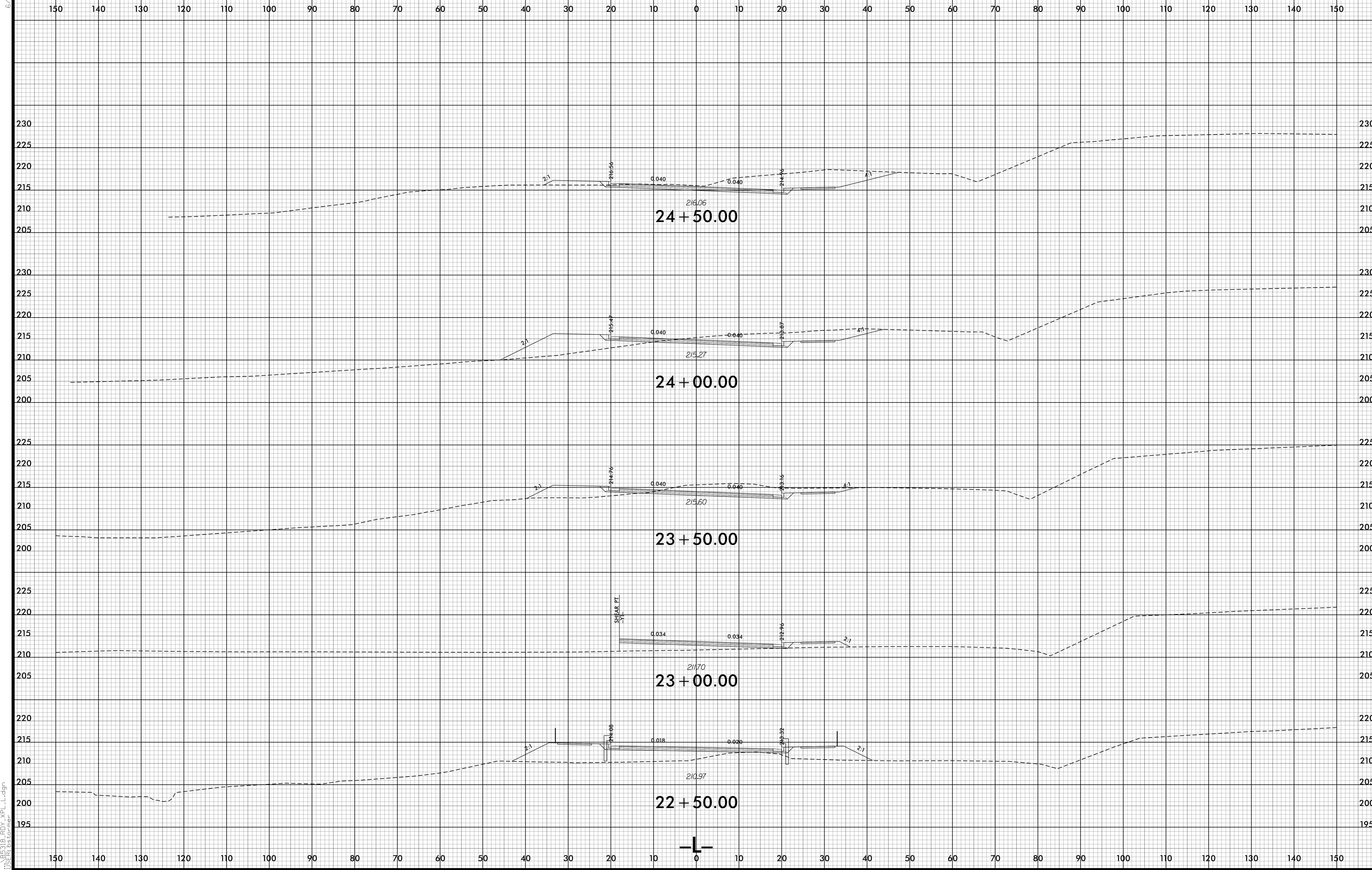

8/3/2022 11:46:22 AM
I:\B5318_RDY_XPL\LL.dgn
I:\B5318\form

6/23/16

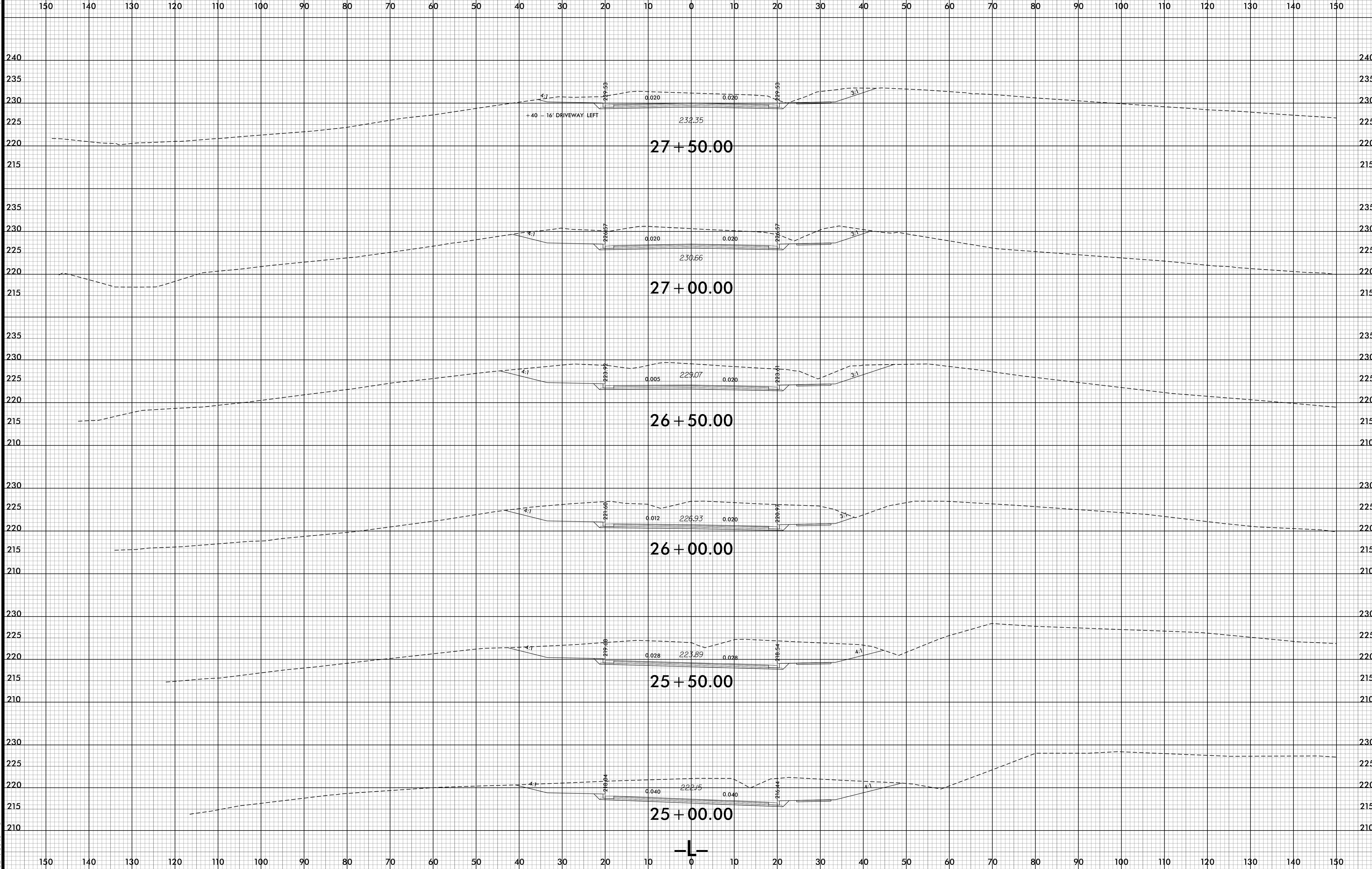

8/3/2022 11:46:23 AM
I:\B5318_RDY_XPL_L.dgn

6/23/16

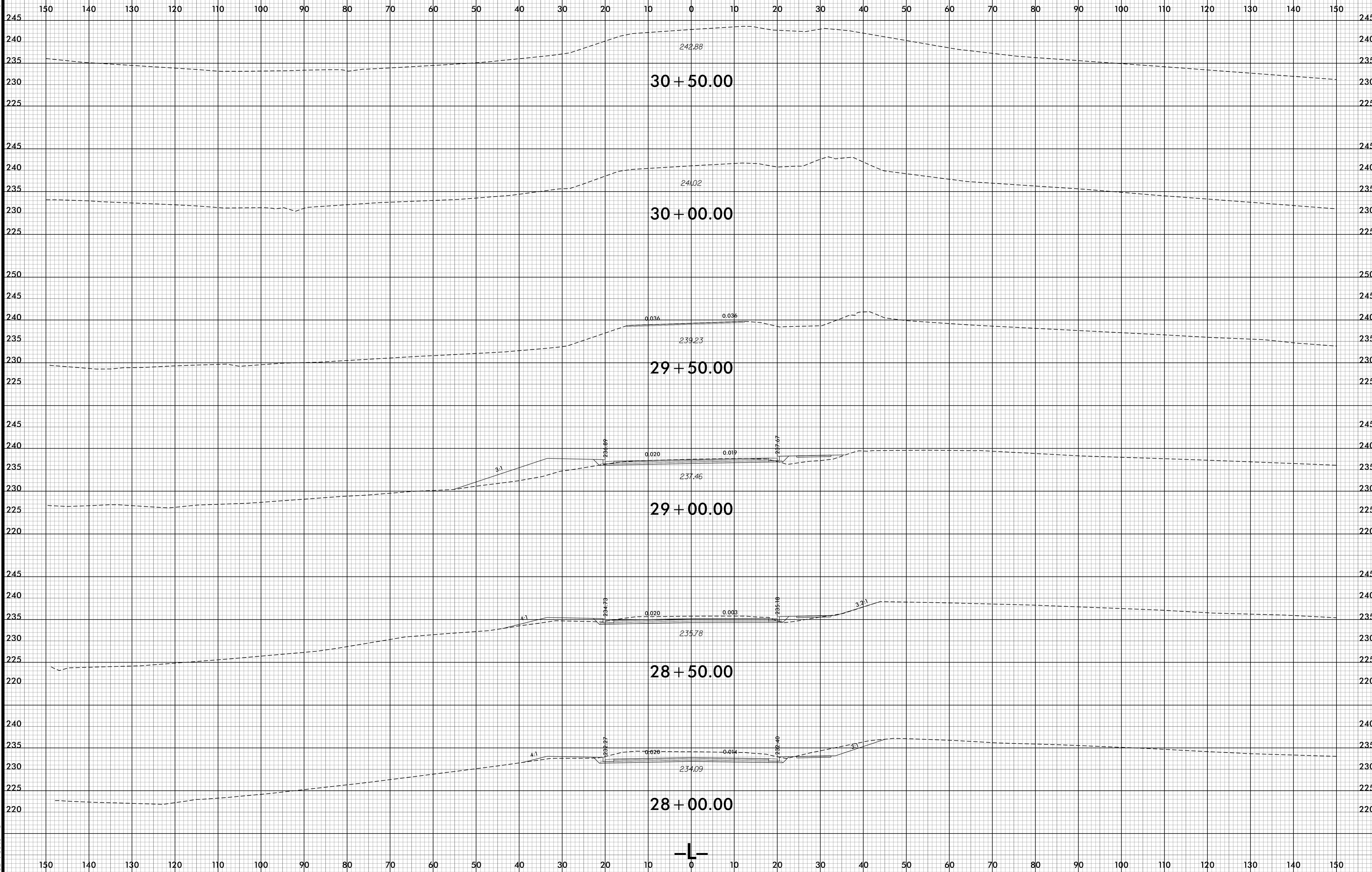

8/3/2022 11:46:25 AM
I:\B5318_RDY_XPL_L.dgn

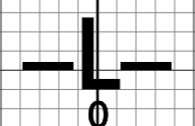

6/23/16

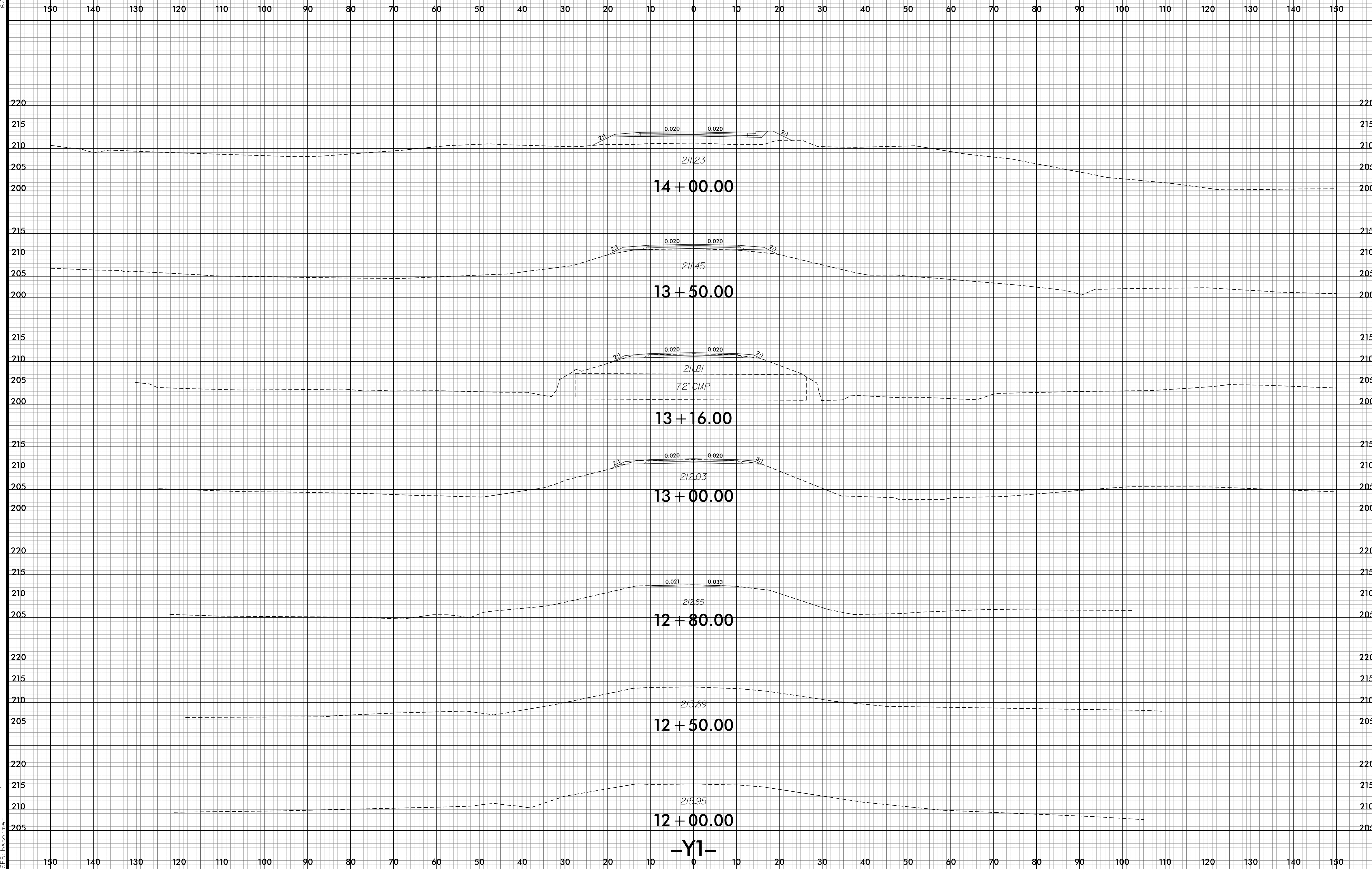

8/3/2022 11:46:28 AM
I:\B5318_RDY_XPL_Y1.dgn
User: rds

-Y1-

6/23/16

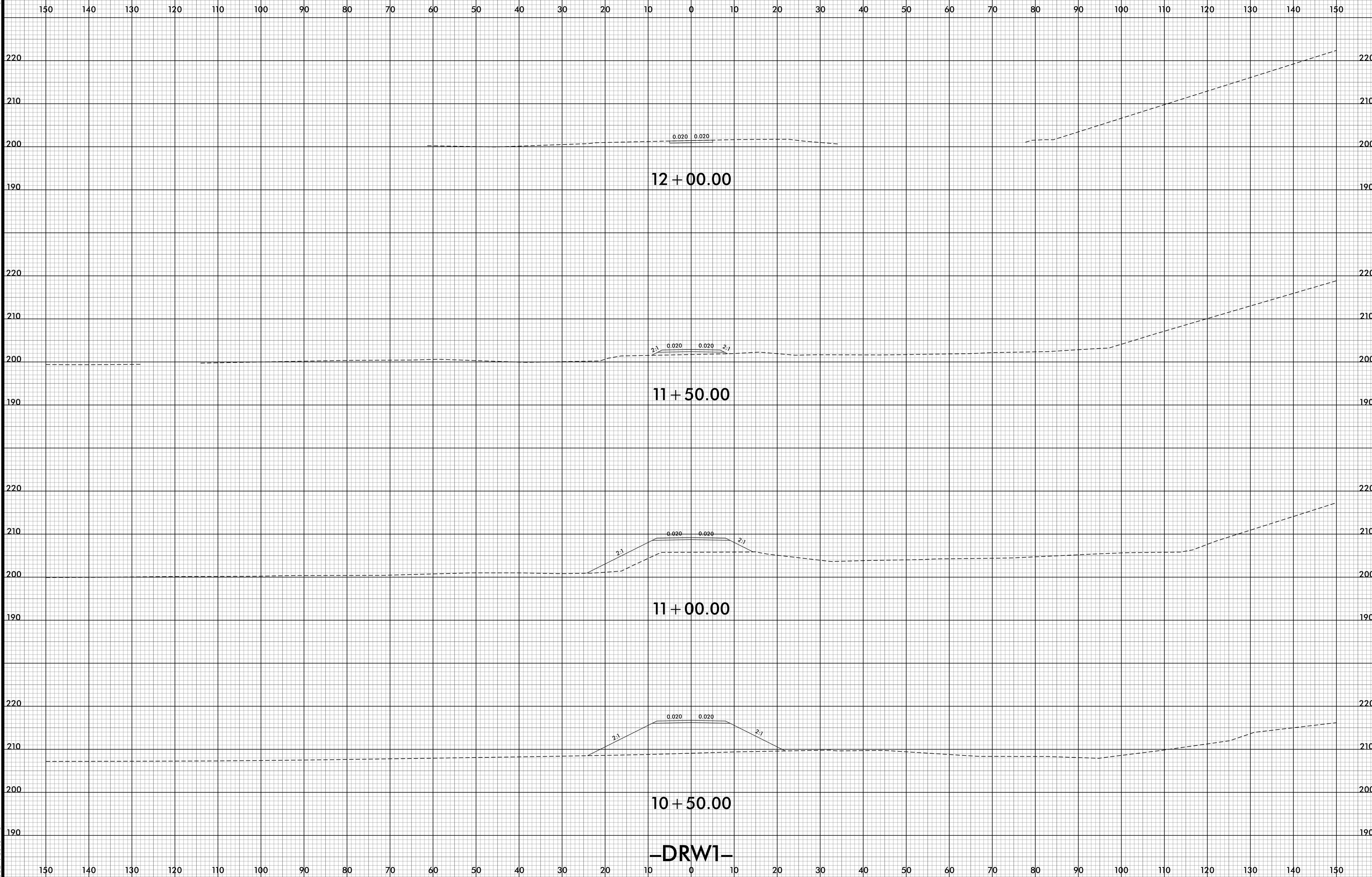

-DRW1-

8/3/2022 11:46:38 AM
I:\B5318-RDY_XPL_DRW1.dgn
JSE:RLS

6/23/16

0 5 10	PROJ. REFERENCE NO.	SHEET NO.
	B-5318	X-11

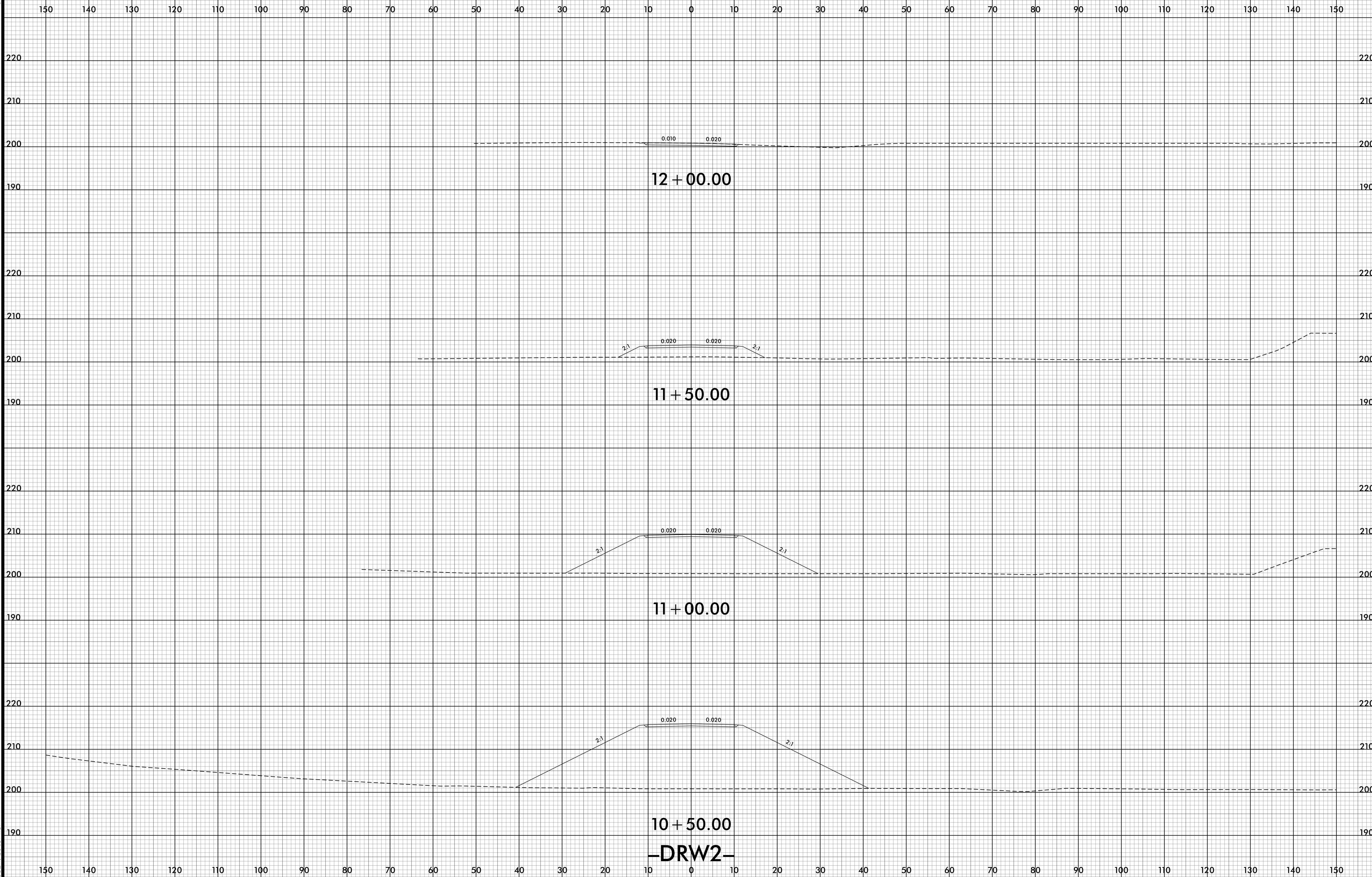

-DRW2-

8/3/2022 11:46:47 AM
I:\B5318-RDY_XPL_DRW2.dgn
USER:bst

6/23/16

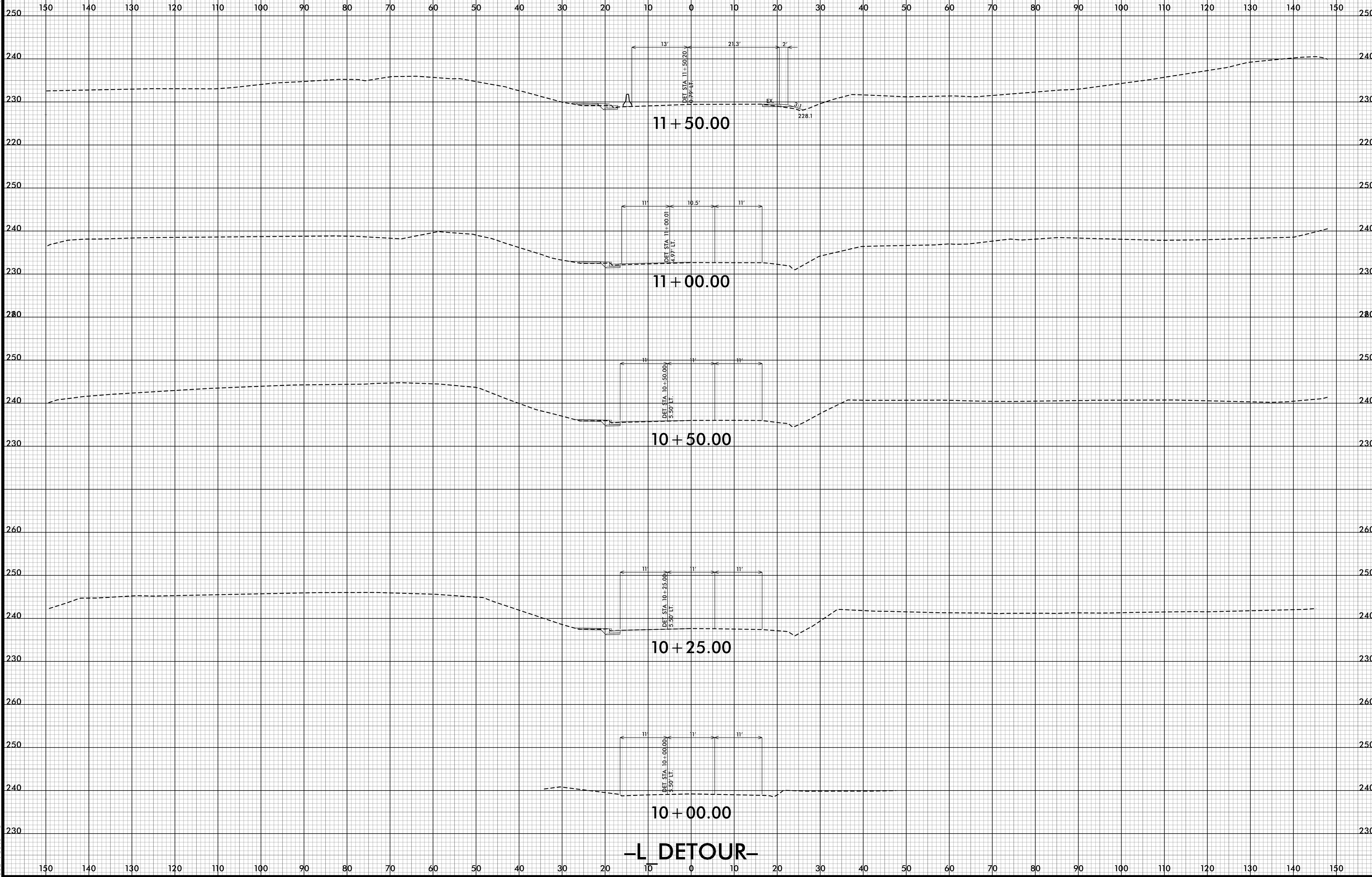

8/3/2022 11:46:58 AM
I:\B-5318-RDY_XPL_DE T.dgn
I:\B-5318-RDY_XPL_DE T.dgn

6/23/16

0 5 10	PROJ. REFERENCE NO.	SHEET NO.
	B-5318	X-13

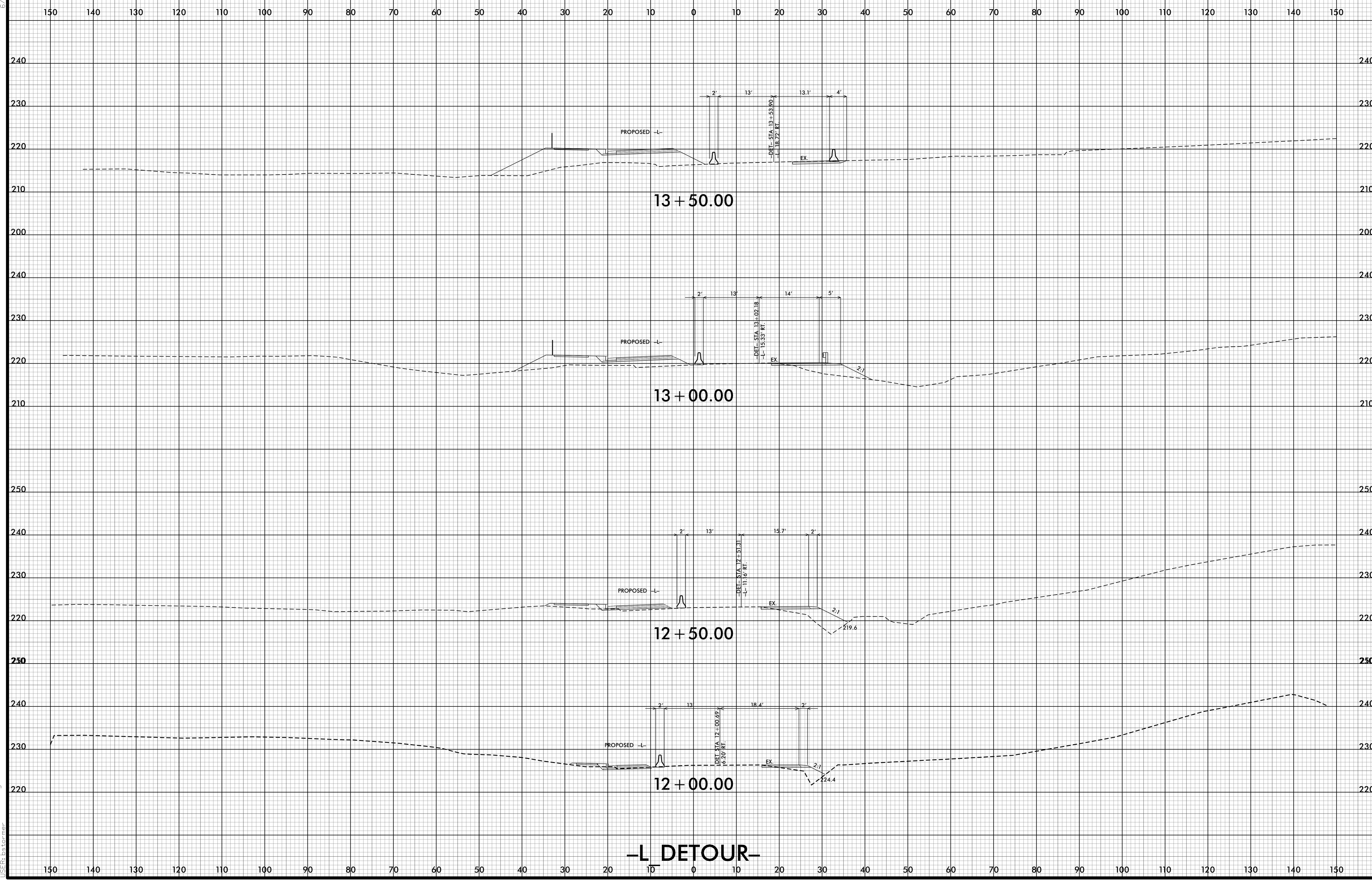

-L DETOUR-

8/18/2022 3:28:53 PM
I:\B5318_RDY_XPL_DE T.dgn
I:\B5318\formet

6/23/16

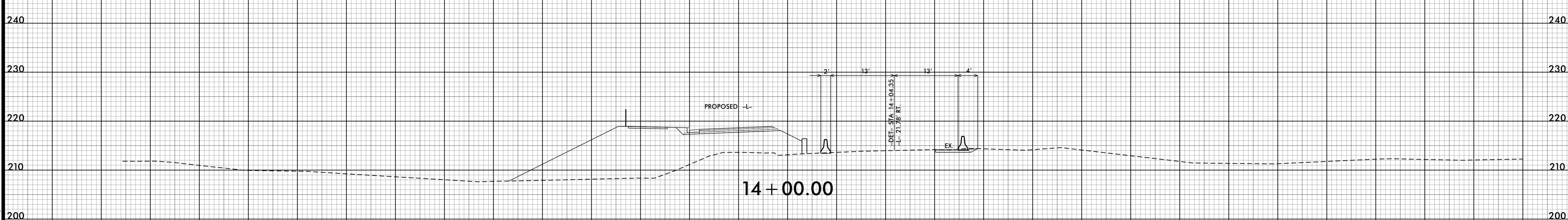
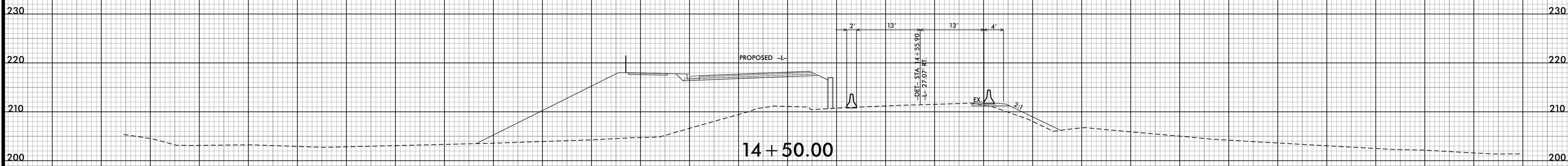
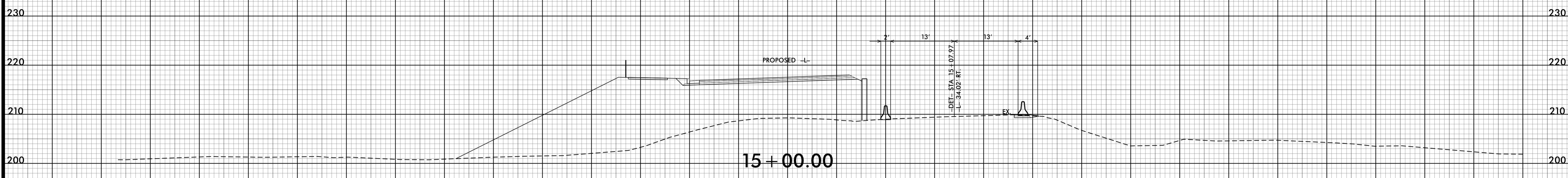
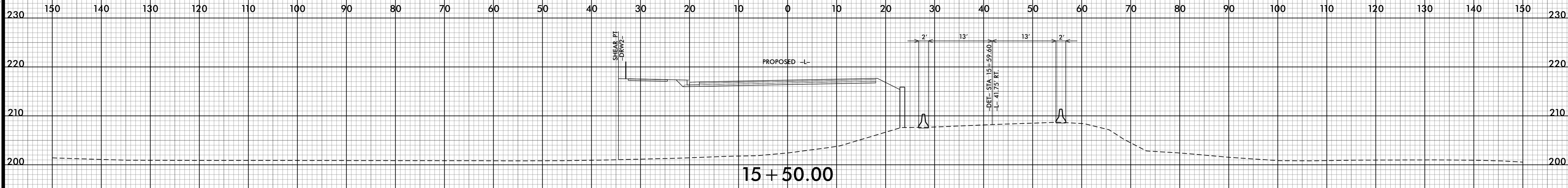

-L DETOUR-

8/25/2022 10:41:02 AM
I:\B5318-RDY_XPL_DET.dgn
User: R5318

6/23/16

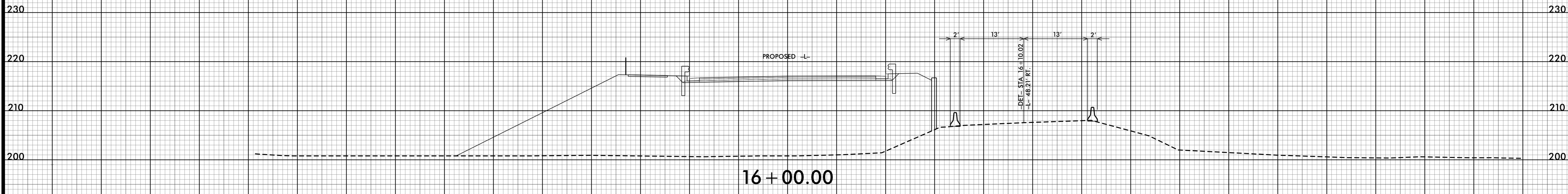
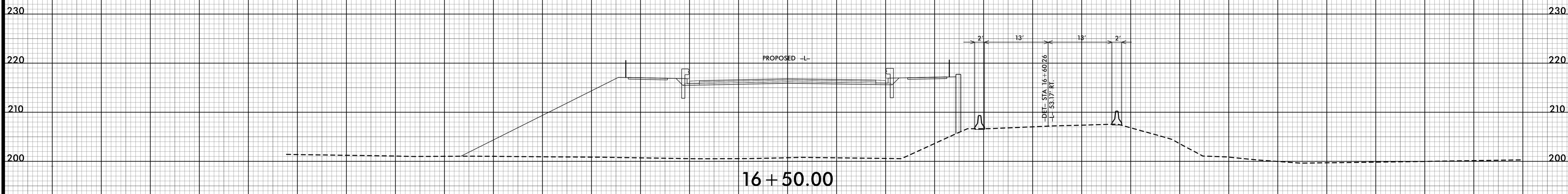
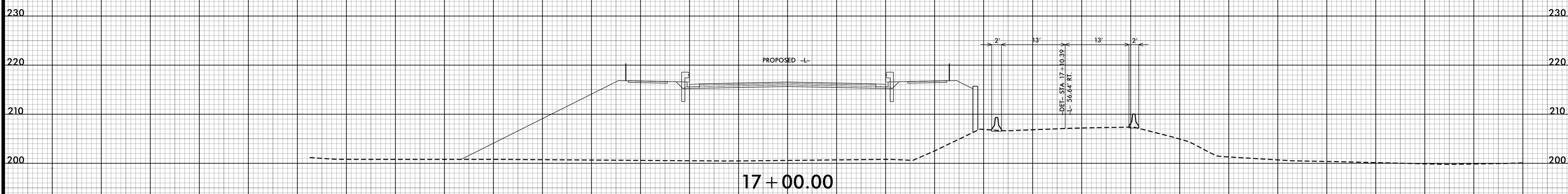
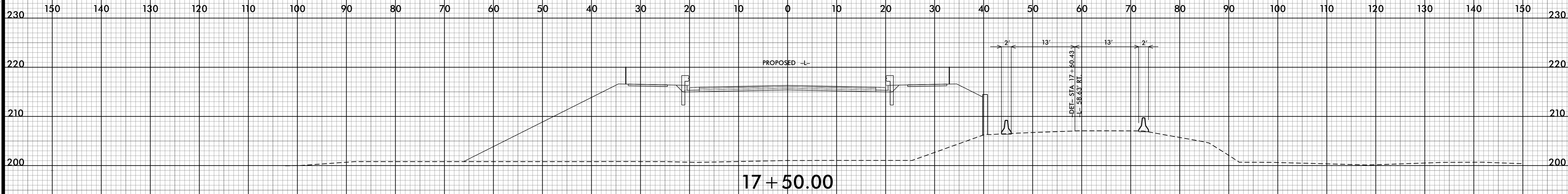

-L DETOUR-

8/18/2022 3:28:51 PM
I:\B-5318-RDY_XPL_DE T.dgn
User: R. J. Forner

6/23/16

0 5 10	PROJ. REFERENCE NO.	SHEET NO.
	B-5318	X-16

150 140 130 120 110 100 90 80 70 60 50 40 30 20 10 0 10 20 30 40 50 60 70 80 90 100 110 120 130 140 150

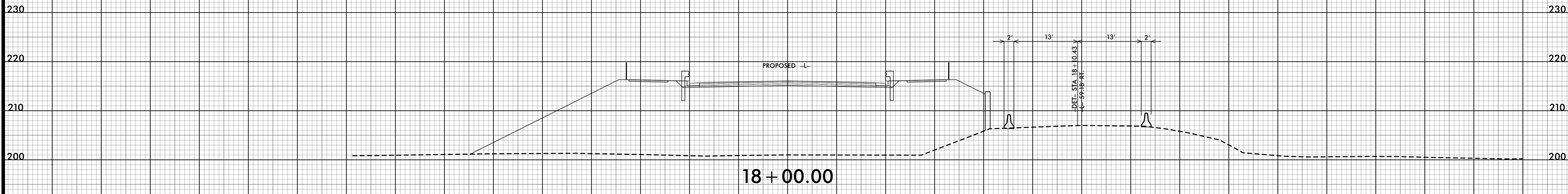
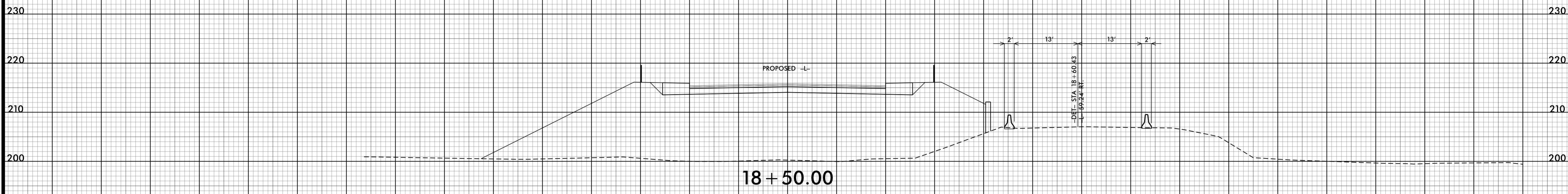
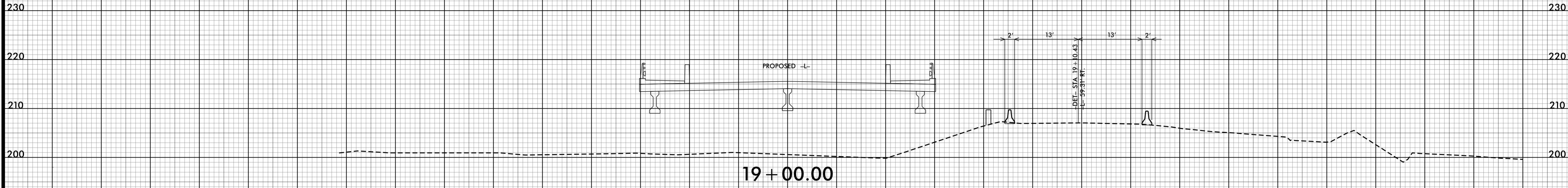

-L DETOUR-

8/18/2022 3:28:59 PM
I:\B5318-RDY_XPL_DE T.dgn
User: b5318

6/23/16

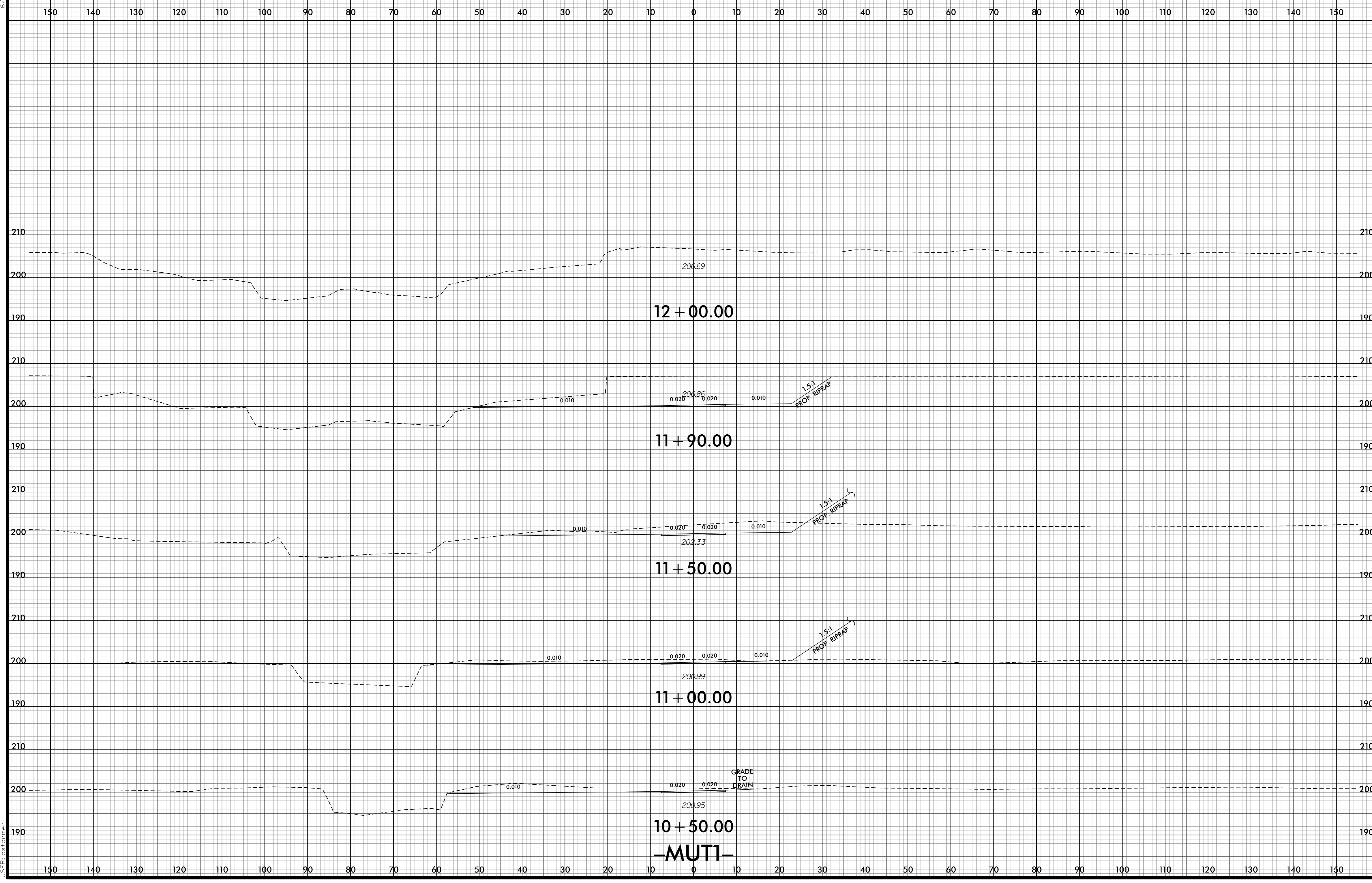

8/18/2022 3:29:13 PM
I:\B-5318-RDY_XPL\MULTI.dgn
I:\B-5318-RDY_XPL\MULTI.dgn