

09, 08, 1999

TIP PROJECT: U-5738

STATE OF NORTH CAROLINA
DIVISION OF HIGHWAYS

T.I.P. NO.	SHEET NO.
U-5738	UO-1

NOTE:
ALL UTILITY WORK SHOWN ON THIS SHEET IS DONE BY OTHERS.
NO PAYMENT WILL BE MADE TO THE CONTRACTOR FOR UTILITY WORK SHOWN ON THIS SHEET.

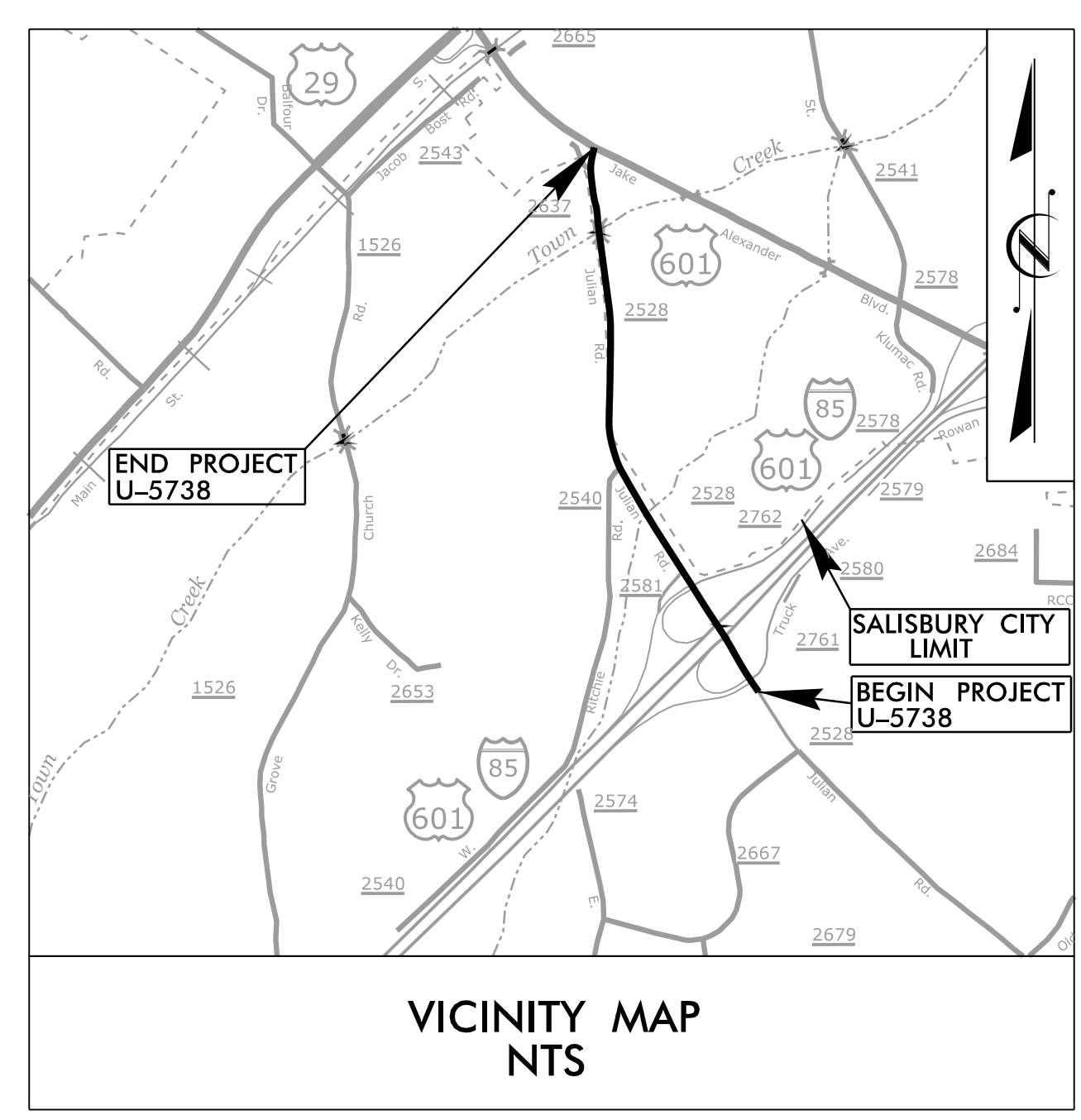

**UTILITIES BY OTHERS PLANS
ROWAN COUNTY**

**LOCATION: SR 2528 (JULIAN ROAD) FROM
SR 2667 (SUMMIT PARK DRIVE) TO
US 601 (JAKE ALEXANDER BOULEVARD) IN SALISBURY**

TYPE OF WORK: POWER, GAS, AND COMMUNICATIONS

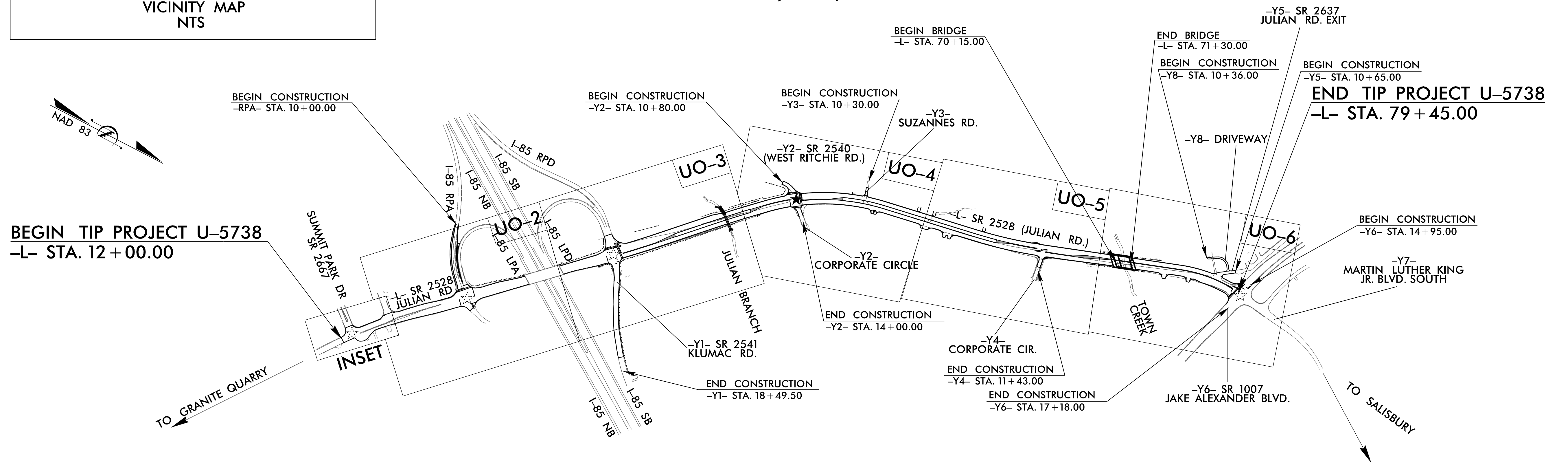

PRELIMINARY PLANS
DO NOT USE FOR CONSTRUCTION

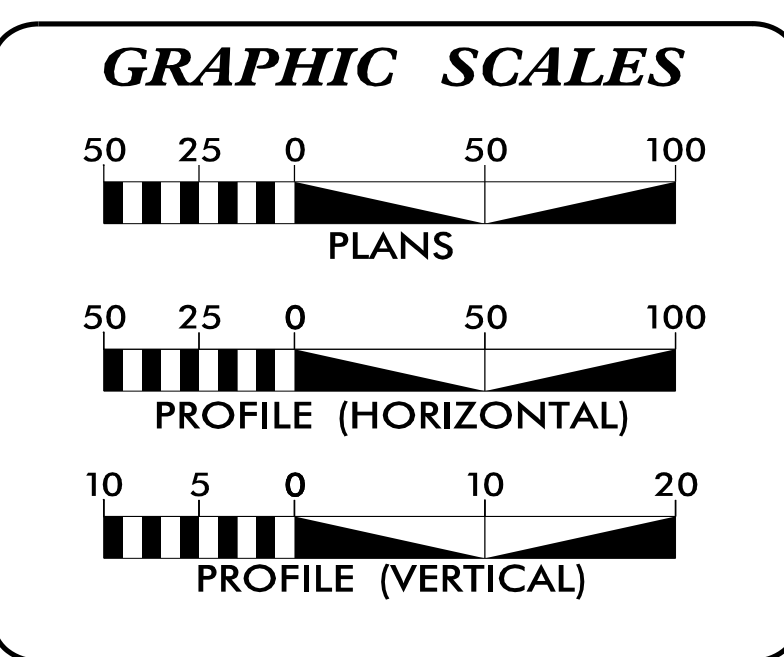

INDEX OF SHEETS

SHEET NO.:	DESCRIPTION:
UO-1	TITLE SHEET
UO-2 THRU UO-6	UBO PLAN SHEETS

- UTILITY OWNERS WITH CONFLICTS**
- (A) DUKE ENERGY (DISTRIBUTION)
 - (B) DUKE ENERGY (TRANSMISSION)
 - (C) PIEDMONT NATURAL GAS (DISTRIBUTION)
 - (D) AT&T (COMMUNICATIONS)
 - (E) SPECTRUM (COMMUNICATIONS)
 - (F) HOTWIRE (COMMUNICATIONS)
 - (G) LUMEN (COMMUNICATIONS)

PREPARED IN THE OFFICE OF:

SEPI
Engineering & Construction, Inc.

1 Glenwood Avenue
Raleigh, NC 27603
Tel: 919.789.9977
Fax: 919.789.9591
License: C-2197

MICHAEL TAYLOR, PE UTILITY PROJECT MANAGER
WILLIAM POPE, PE PROJECT UTILITY COORDINATOR

**DIVISION OF HIGHWAYS
UTILITIES UNIT**
1555 MAIL SERVICES CENTER
RALEIGH, NC 27699-1555
PHONE (919) 707-6690
FAX (919) 250-4151

DAVID TRANTHAM UTILITIES ENGINEER
LYNN BASINGER UTILITIES COORDINATOR

11/2/2021 11:21:00 AM U:\5738_Ut - fsh - UO1 - psh.dgn
USER: WPOPE

UTILITIES BY OTHERS

NOTE:
 ALL UTILITY WORK SHOWN ON THIS SHEET WILL BE DONE BY OTHERS. NO PAYMENT WILL BE MADE TO THE CONTRACTOR FOR UTILITY WORK SHOWN ON THIS SHEET.

SEPI
 Engineering & Construction, Inc.

1 Glenwood Avenue
 Raleigh, NC 27603
 Tel: 919.789.9977
 Fax: 919.789.9591
 License: C-2197

5/14/99
 I:\G6688\proj\U5738_Ut_U02.dgn
 LISTED

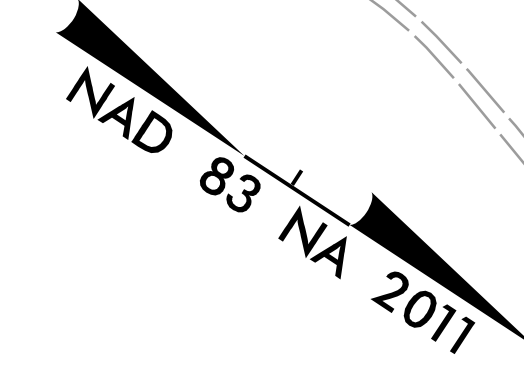
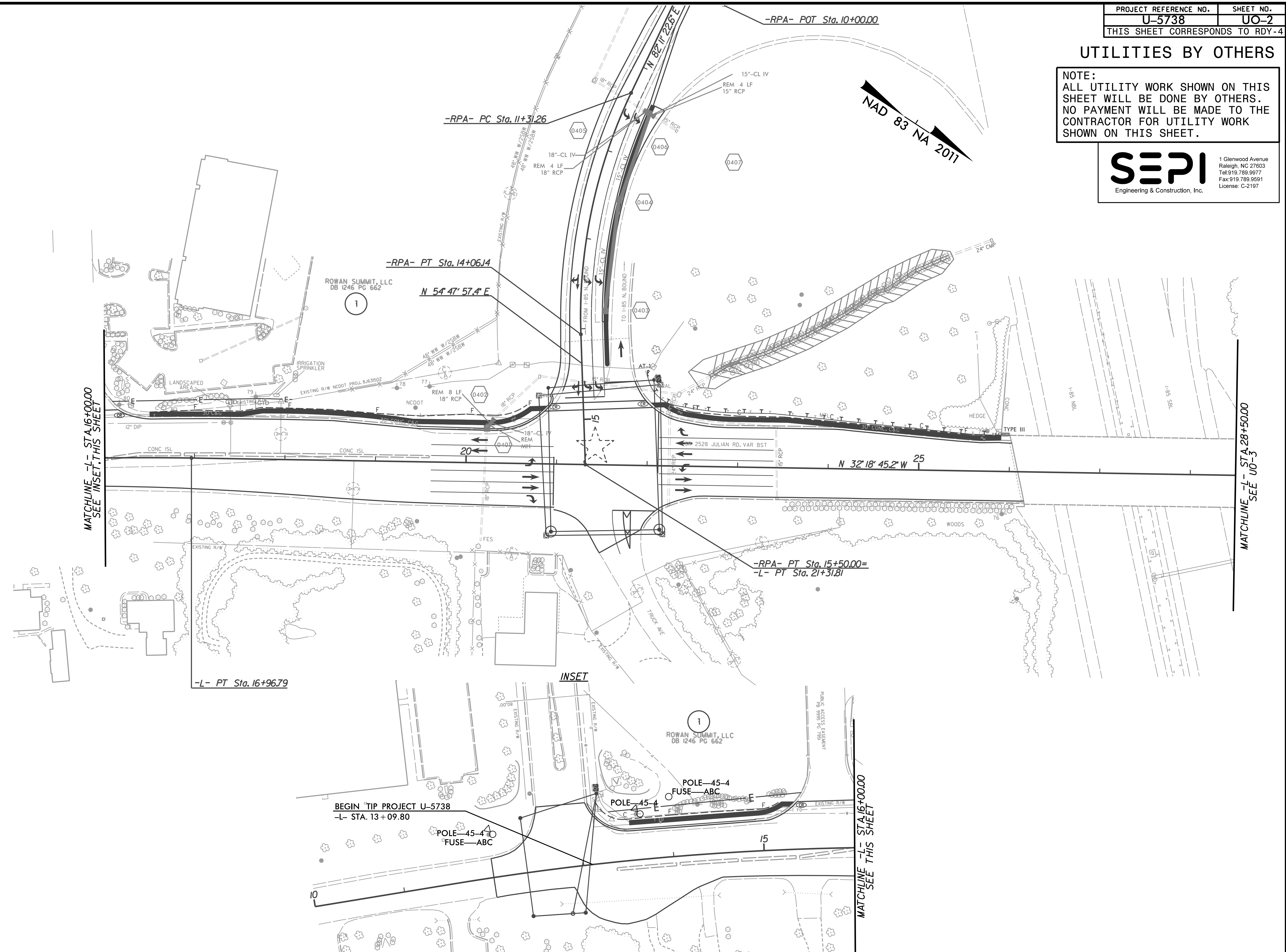

MATCHLINE -L- STA. 16+00.00
 SEE INSET THIS SHEET

MATCHLINE -L- STA. 28+50.00
 SEE UO-3

INSET

MATCHLINE -L- STA. 16+00.00
 SEE THIS SHEET

UTILITIES BY OTHERS

NOTE:
ALL UTILITY WORK SHOWN ON THIS SHEET WILL BE DONE BY OTHERS. NO PAYMENT WILL BE MADE TO THE CONTRACTOR FOR UTILITY WORK SHOWN ON THIS SHEET.

SEPI
Engineering & Construction, Inc.

1 Glenwood Avenue
Raleigh, NC 27603
Tel: 919.789.9977
Fax: 919.789.9591
License: C-2197

JEFFREY L. RICHIE ETAL
DB 545 PG 95

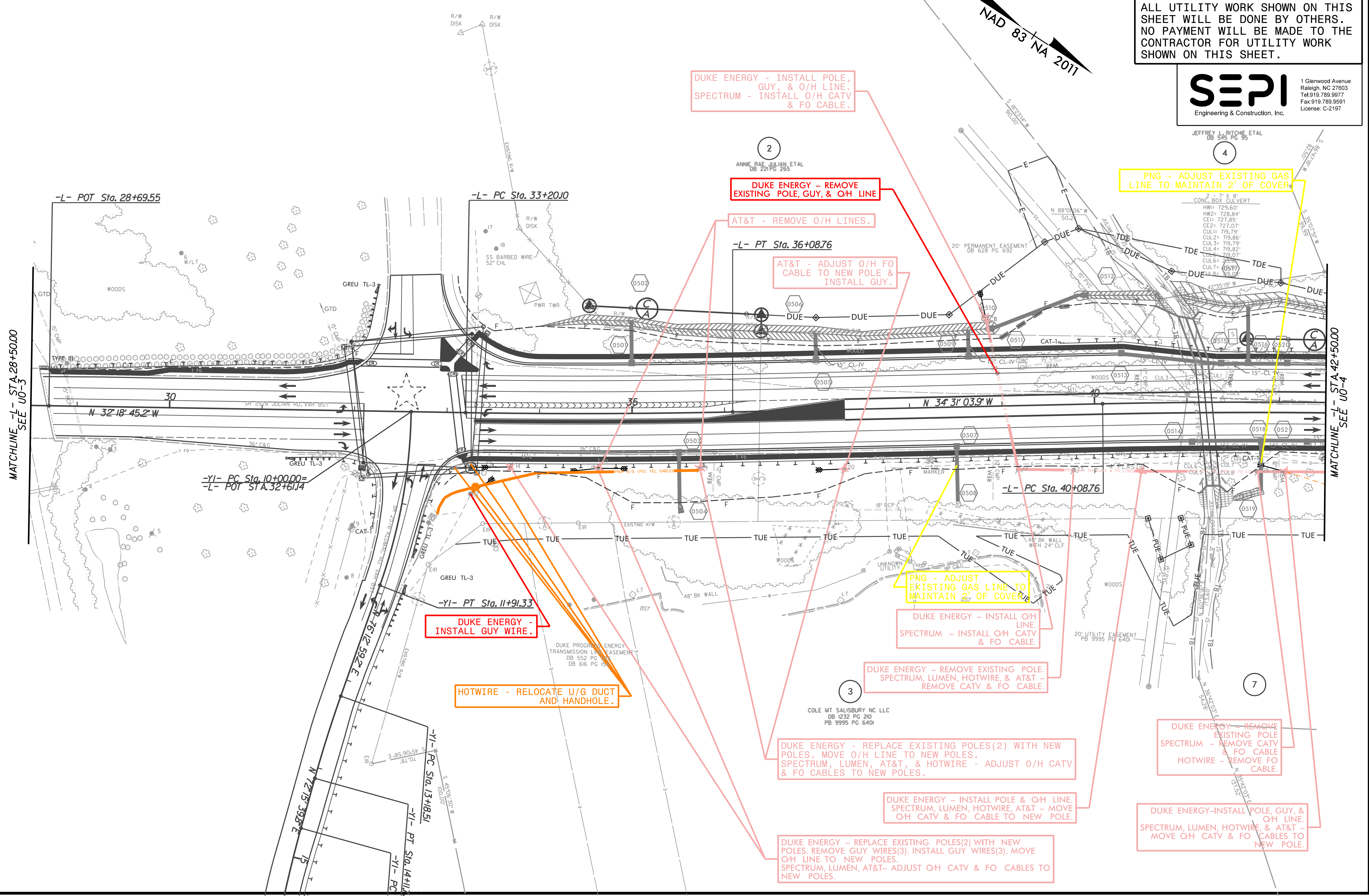
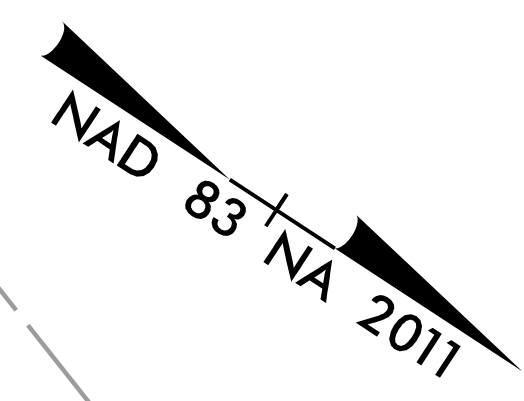

DUKE ENERGY - INSTALL POLE, GUY, & O/H LINE.
SPECTRUM - INSTALL O/H CATV & FO CABLE.

DUKE ENERGY - REMOVE EXISTING POLE, GUY, & O/H LINE

AT&T - REMOVE O/H LINES.

AT&T - ADJUST O/H FO CABLE TO NEW POLE & INSTALL GUY.

PNG - ADJUST EXISTING GAS LINE TO MAINTAIN 2' OF COVER.

PNG - ADJUST EXISTING GAS LINE TO MAINTAIN 2' OF COVER.

DUKE ENERGY - INSTALL O/H LINE.
SPECTRUM - INSTALL O/H CATV & FO CABLE.

DUKE ENERGY - REMOVE EXISTING POLE.
SPECTRUM, LUMEN, HOTWIRE, & AT&T - REMOVE CATV & FO CABLE.

DUKE ENERGY - REPLACE EXISTING POLES(2) WITH NEW POLES. MOVE O/H LINE TO NEW POLES.
SPECTRUM, LUMEN, AT&T, & HOTWIRE - ADJUST O/H CATV & FO CABLES TO NEW POLES.

DUKE ENERGY - INSTALL POLE & O/H LINE.
SPECTRUM, LUMEN, HOTWIRE, AT&T - MOVE O/H CATV & FO CABLE TO NEW POLE.

DUKE ENERGY - REPLACE EXISTING POLES(2) WITH NEW POLES. REMOVE GUY WIRES(3). INSTALL GUY WIRES(3). MOVE O/H LINE TO NEW POLES.
SPECTRUM, LUMEN, AT&T- ADJUST O/H CATV & FO CABLES TO NEW POLES.

DUKE ENERGY - REMOVE EXISTING POLE
SPECTRUM - REMOVE CATV & FO CABLE
HOTWIRE - REMOVE FO CABLE.

DUKE ENERGY-INSTALL POLE, GUY, & O/H LINE.
SPECTRUM, LUMEN, HOTWIRE, & AT&T- MOVE O/H CATV & FO CABLES TO NEW POLE.

DUKE ENERGY - INSTALL GUY WIRE.

HOTWIRE - RELOCATE U/G DUCT AND HANDHOLE.

MATCHLINE -L- STA. 28+50.00
SEE UO-3

MATCHLINE -L- STA. 42+50.00
SEE UO-4

5/14/99
I:\2008\Projects\U5738-Ut-U03.dgn

UTILITIES BY OTHERS

NOTE:
ALL UTILITY WORK SHOWN ON THIS SHEET WILL BE DONE BY OTHERS. NO PAYMENT WILL BE MADE TO THE CONTRACTOR FOR UTILITY WORK SHOWN ON THIS SHEET.

SEPI
Engineering & Construction, Inc.

1 Glenwood Avenue
Raleigh, NC 27603
Tel: 919.789.9977
Fax: 919.789.9591
License: C-2197

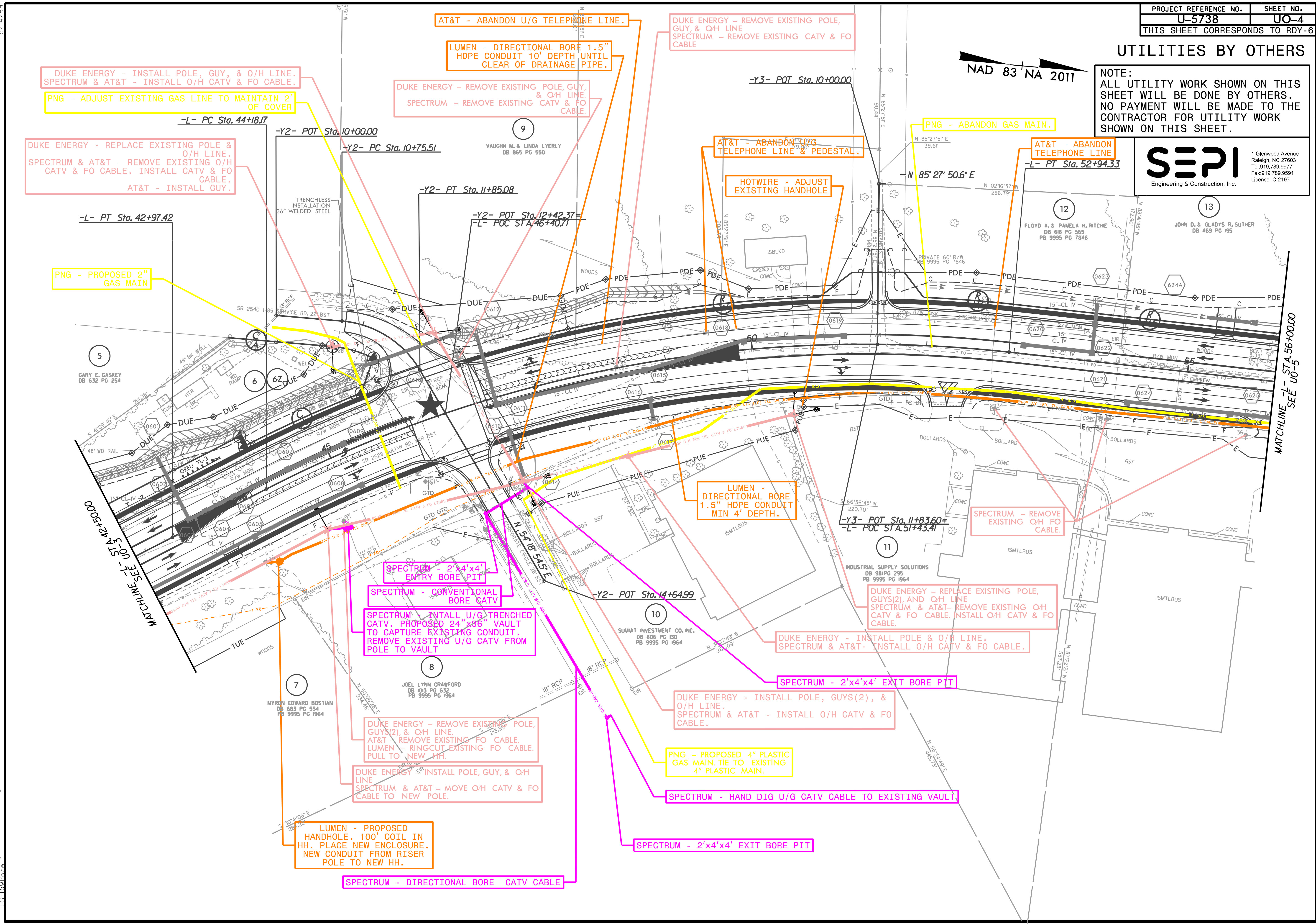

DUKE ENERGY - INSTALL POLE, GUY, & O/H LINE. SPECTRUM & AT&T - INSTALL O/H CATV & FO CABLE.

PNG - ADJUST EXISTING GAS LINE TO MAINTAIN 2' OF COVER

DUKE ENERGY - REPLACE EXISTING POLE & O/H LINE. SPECTRUM & AT&T - REMOVE EXISTING O/H CATV & FO CABLE. INSTALL CATV & FO CABLE. AT&T - INSTALL GUY.

PNG - PROPOSED 2" GAS MAIN

AT&T - ABANDON U/G TELEPHONE LINE.

LUMEN - DIRECTIONAL BORE 1.5" HDPE CONDUIT 10' DEPTH UNTIL CLEAR OF DRAINAGE PIPE.

DUKE ENERGY - REMOVE EXISTING POLE, GUY, & O/H LINE. SPECTRUM - REMOVE EXISTING CATV & FO CABLE.

DUKE ENERGY - REMOVE EXISTING POLE, GUY, & O/H LINE. SPECTRUM - REMOVE EXISTING CATV & FO CABLE

AT&T - ABANDON TELEPHONE LINE & PEDESTAL.

HOTWIRE - ADJUST EXISTING HANDHOLE

PNG - ABANDON GAS MAIN.

AT&T - ABANDON TELEPHONE LINE

LUMEN - DIRECTIONAL BORE 1.5" HDPE CONDUIT MIN 4' DEPTH.

SPECTRUM - REMOVE EXISTING O/H FO CABLE.

SPECTRUM - 2'x4'x4' ENTRY BORE PIT

SPECTRUM - CONVENTIONAL BORE CATV

SPECTRUM - INTALL U/G TRENCHED CATV. PROPOSED 24"x36" VAULT TO CAPTURE EXISTING CONDUIT. REMOVE EXISTING U/G CATV FROM POLE TO VAULT

DUKE ENERGY - REPLACE EXISTING POLE, GUYS(2), AND O/H LINE. SPECTRUM & AT&T - REMOVE EXISTING O/H CATV & FO CABLE. INSTALL O/H CATV & FO CABLE.

DUKE ENERGY - INSTALL POLE & O/H LINE. SPECTRUM & AT&T - INSTALL O/H CATV & FO CABLE.

SPECTRUM - 2'x4'x4' EXIT BORE PIT

DUKE ENERGY - INSTALL POLE, GUYS(2), & O/H LINE. SPECTRUM & AT&T - INSTALL O/H CATV & FO CABLE.

PNG - PROPOSED 4" PLASTIC GAS MAIN. TIE TO EXISTING 4" PLASTIC MAIN.

SPECTRUM - HAND DIG U/G CATV CABLE TO EXISTING VAULT

SPECTRUM - 2'x4'x4' EXIT BORE PIT

DUKE ENERGY - REMOVE EXISTING POLE, GUYS(2), & O/H LINE. AT&T REMOVE EXISTING FO CABLE. LUMEN - RINGCUT EXISTING FO CABLE. PULL TO NEW HH.

DUKE ENERGY - INSTALL POLE, GUY, & O/H LINE. SPECTRUM & AT&T - MOVE O/H CATV & FO CABLE TO NEW POLE.

LUMEN - PROPOSED HANDHOLE. 100' COIL IN HH. PLACE NEW ENCLOSURE. NEW CONDUIT FROM RISER POLE TO NEW HH.

SPECTRUM - DIRECTIONAL BORE CATV CABLE

5/14/99
I:\2008\Projects\U5738_Ut_U04.dgn

UTILITIES BY OTHERS

NOTE:
ALL UTILITY WORK SHOWN ON THIS SHEET WILL BE DONE BY OTHERS. NO PAYMENT WILL BE MADE TO THE CONTRACTOR FOR UTILITY WORK SHOWN ON THIS SHEET.

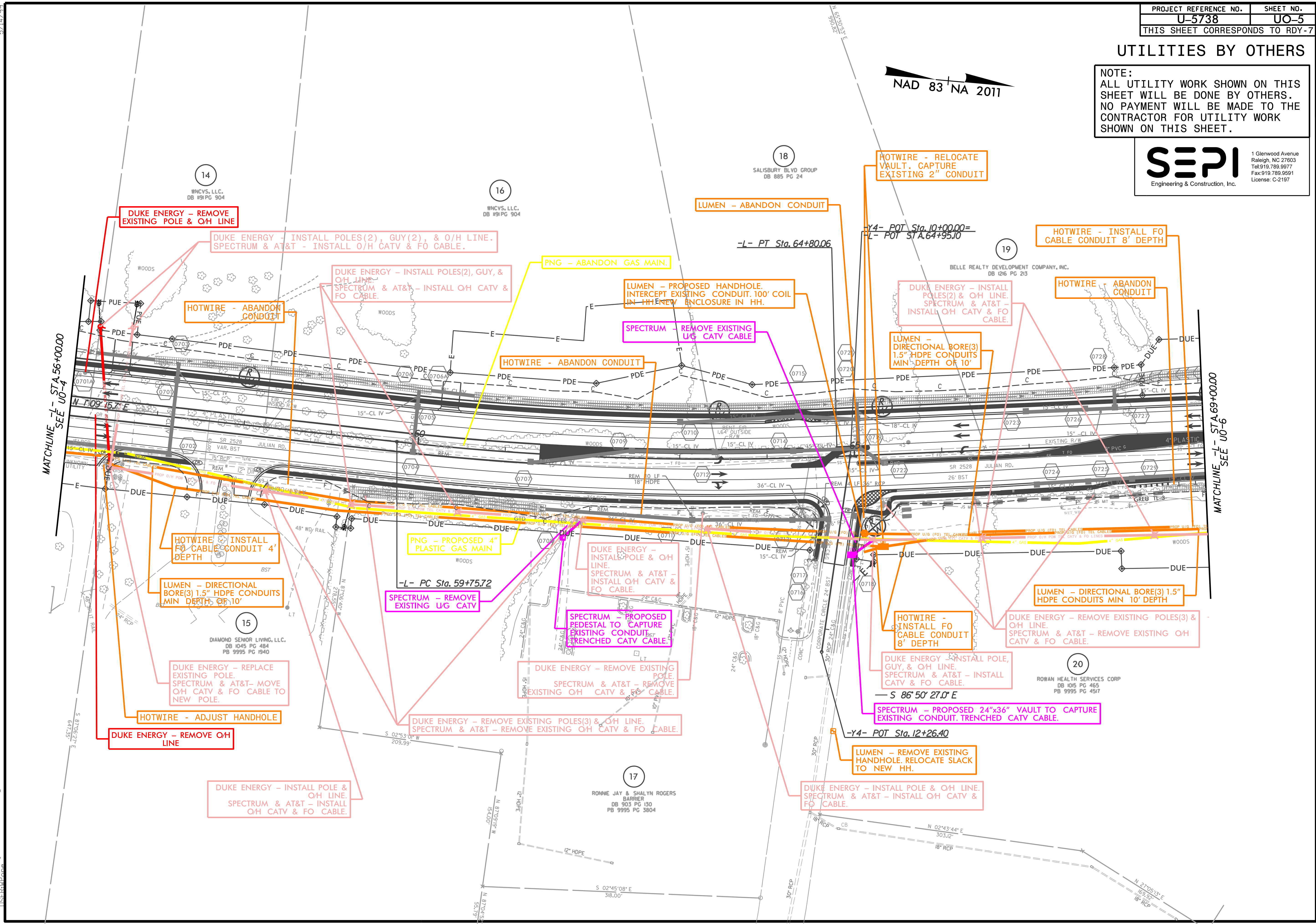

5/14/2019
 I:\2018\Projects\U5738-Ut_U05.dgn
 J:\2018\Projects\U5738-Ut_U05.dgn

UTILITIES BY OTHERS

NOTE:
ALL UTILITY WORK SHOWN ON THIS SHEET WILL BE DONE BY OTHERS. NO PAYMENT WILL BE MADE TO THE CONTRACTOR FOR UTILITY WORK SHOWN ON THIS SHEET.

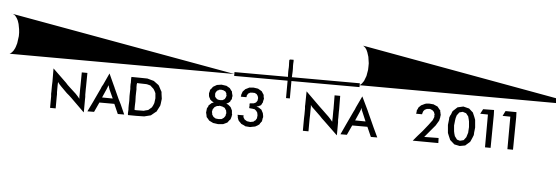

MATCHLINE - SEE UO-5 STA. 69+00.00

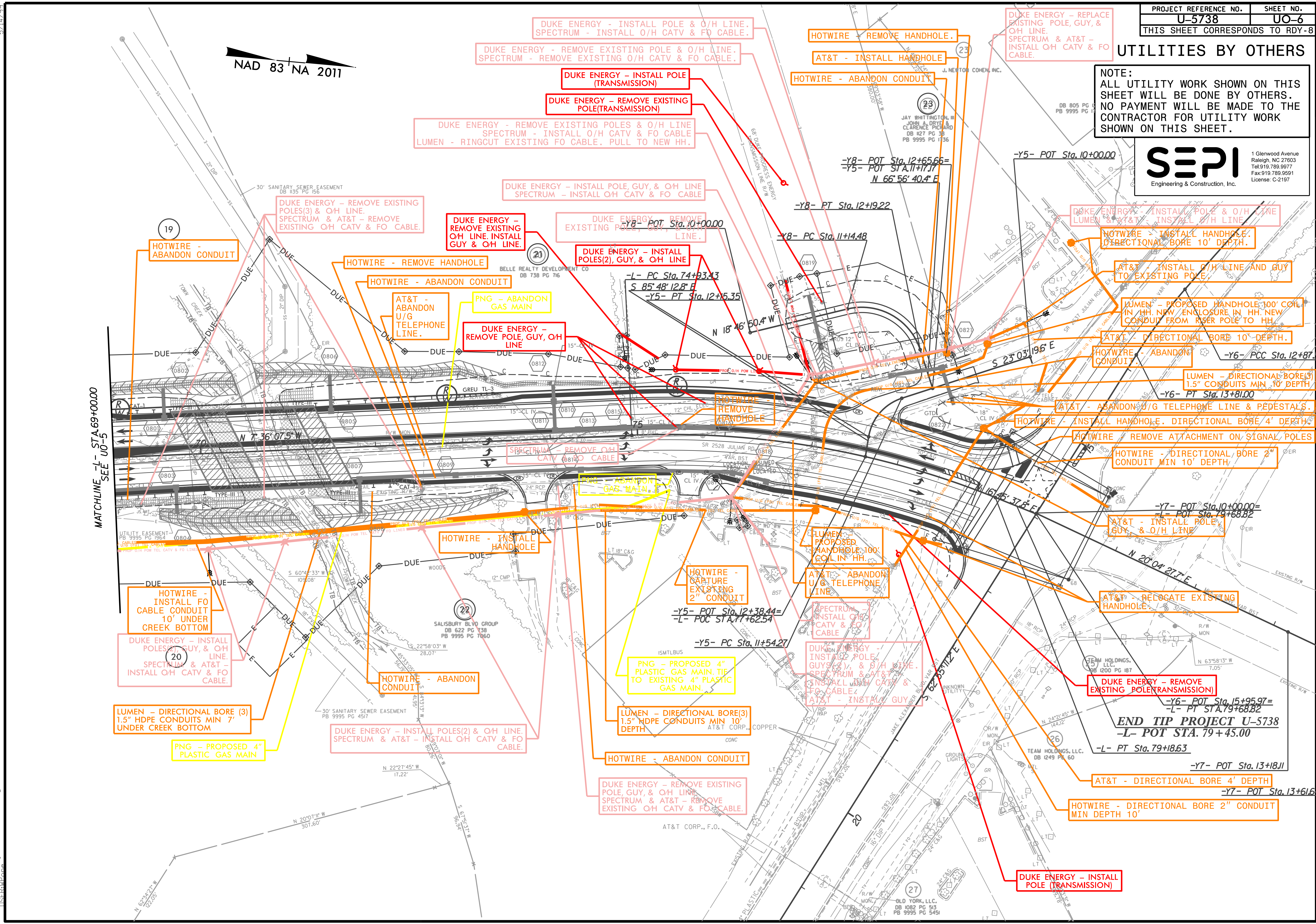

DUKE ENERGY - INSTALL POLE & O/H LINE.
SPECTRUM - INSTALL O/H CATV & FO CABLE.

DUKE ENERGY - REMOVE EXISTING POLE & O/H LINE.
SPECTRUM - REMOVE EXISTING O/H CATV & FO CABLE.

DUKE ENERGY - INSTALL POLE (TRANSMISSION)

DUKE ENERGY - REMOVE EXISTING POLE (TRANSMISSION)

DUKE ENERGY - REMOVE EXISTING POLES & O/H LINE
SPECTRUM - INSTALL O/H CATV & FO CABLE
LUMEN - RINGCUT EXISTING FO CABLE. PULL TO NEW HH.

DUKE ENERGY - INSTALL POLE, GUY, & O/H LINE
SPECTRUM - INSTALL O/H CATV & FO CABLE

DUKE ENERGY - REMOVE EXISTING POLE & O/H LINE

DUKE ENERGY - INSTALL POLES(2), GUY, & O/H LINE

DUKE ENERGY - REMOVE EXISTING O/H LINE. INSTALL GUY & O/H LINE.

DUKE ENERGY - REMOVE EXISTING POLES(3) & O/H LINE.
SPECTRUM & AT&T - REMOVE EXISTING O/H CATV & FO CABLE.

HOTWIRE - ABANDON CONDUIT

HOTWIRE - REMOVE HANDHOLE

HOTWIRE - ABANDON CONDUIT

AT&T - ABANDON U/G TELEPHONE LINE.

DUKE ENERGY - REMOVE POLE, GUY, O/H LINE

DUKE ENERGY - REMOVE EXISTING POLE & O/H LINE

SPECTRUM - REMOVE O/H CATV & FO CABLE

PNG - ABANDON GAS MAIN

HOTWIRE - INSTALL HANDHOLE

HOTWIRE - INSTALL FO CABLE CONDUIT 10' UNDER CREEK BOTTOM

DUKE ENERGY - INSTALL POLES(2), GUY, & O/H LINE.
SPECTRUM & AT&T - INSTALL O/H CATV & FO CABLE.

LUMEN - DIRECTIONAL BORE (3) 1.5" HDPE CONDUITS MIN 7' UNDER CREEK BOTTOM.

PNG - PROPOSED 4" PLASTIC GAS MAIN

DUKE ENERGY - INSTALL POLES(2) & O/H LINE.
SPECTRUM & AT&T - INSTALL O/H CATV & FO CABLE.

HOTWIRE - ABANDON CONDUIT

PNG - PROPOSED 4" PLASTIC GAS MAIN. TIE TO EXISTING 4" PLASTIC GAS MAIN.

LUMEN - DIRECTIONAL BORE(3) 1.5" HDPE CONDUITS MIN 10' DEPTH

HOTWIRE - ABANDON CONDUIT

DUKE ENERGY - REMOVE EXISTING POLE, GUY, & O/H LINE.
SPECTRUM & AT&T - REMOVE EXISTING O/H CATV & FO CABLE.

HOTWIRE - REMOVE HANDHOLE.

AT&T - INSTALL HANDHOLE

HOTWIRE - ABANDON CONDUIT

DUKE ENERGY - REMOVE EXISTING POLE & O/H LINE

DUKE ENERGY - REMOVE EXISTING POLE & O/H LINE

DUKE ENERGY - REMOVE EXISTING POLE & O/H LINE

DUKE ENERGY - REMOVE EXISTING POLE & O/H LINE

DUKE ENERGY - REMOVE EXISTING POLE & O/H LINE

DUKE ENERGY - REMOVE EXISTING POLE & O/H LINE

DUKE ENERGY - REMOVE EXISTING POLE & O/H LINE

DUKE ENERGY - REMOVE EXISTING POLE & O/H LINE

DUKE ENERGY - REMOVE EXISTING POLE & O/H LINE

DUKE ENERGY - REMOVE EXISTING POLE & O/H LINE

DUKE ENERGY - REMOVE EXISTING POLE & O/H LINE

DUKE ENERGY - REMOVE EXISTING POLE & O/H LINE

DUKE ENERGY - REMOVE EXISTING POLE & O/H LINE

DUKE ENERGY - REMOVE EXISTING POLE & O/H LINE

DUKE ENERGY - REMOVE EXISTING POLE & O/H LINE

DUKE ENERGY - REMOVE EXISTING POLE & O/H LINE

DUKE ENERGY - REMOVE EXISTING POLE & O/H LINE

DUKE ENERGY - REMOVE EXISTING POLE & O/H LINE

DUKE ENERGY - REMOVE EXISTING POLE & O/H LINE

DUKE ENERGY - REMOVE EXISTING POLE & O/H LINE

DUKE ENERGY - REMOVE EXISTING POLE & O/H LINE

DUKE ENERGY - REMOVE EXISTING POLE & O/H LINE

DUKE ENERGY - REMOVE EXISTING POLE & O/H LINE

DUKE ENERGY - REMOVE EXISTING POLE & O/H LINE

DUKE ENERGY - REMOVE EXISTING POLE & O/H LINE

DUKE ENERGY - REMOVE EXISTING POLE & O/H LINE

DUKE ENERGY - REMOVE EXISTING POLE & O/H LINE

DUKE ENERGY - REMOVE EXISTING POLE & O/H LINE

DUKE ENERGY - REMOVE EXISTING POLE & O/H LINE

DUKE ENERGY - INSTALL POLE & O/H LINE
LUMEN & AT&T - INSTALL O/H LINE

HOTWIRE - INSTALL HANDHOLE. DIRECTIONAL BORE 10' DEPTH.

AT&T - INSTALL O/H LINE AND GUY TO EXISTING POLE

LUMEN - PROPOSED HANDHOLE 100' COIL IN HH. NEW ENCLOSURE IN HH. NEW CONDUIT FROM RISER POLE TO HH.

AT&T - DIRECTIONAL BORE 10' DEPTH.

HOTWIRE - ABANDON CONDUIT

-Y6- PCC Sta. 12+87.1

LUMEN - DIRECTIONAL BORE(3) 1.5" CONDUITS MIN 10' DEPTH

-Y6- PT Sta. 13+81.00

AT&T - ABANDON U/G TELEPHONE LINE & PEDESTALS.

HOTWIRE - INSTALL HANDHOLE. DIRECTIONAL BORE 4' DEPTH

HOTWIRE - REMOVE ATTACHMENT ON SIGNAL POLES

HOTWIRE - DIRECTIONAL BORE 2" CONDUIT MIN 10' DEPTH

-Y7- POT Sta. 10+00.00 =
-L- POT Sta. 19+68.82

AT&T - INSTALL POLE, GUY, & O/H LINE

AT&T - RELOCATE EXISTING HANDHOLE

DUKE ENERGY - REMOVE EXISTING POLE (TRANSMISSION)

-Y6- POT Sta. 15+95.97 =
-L- PT STA. 19+68.82

END TIP PROJECT U-5738
-L- POT STA. 79+45.00

-L- PT Sta. 79+18.63

-Y7- POT Sta. 13+18.11

AT&T - DIRECTIONAL BORE 4' DEPTH

-Y7- POT Sta. 13+61.6

HOTWIRE - DIRECTIONAL BORE 2" CONDUIT MIN DEPTH 10'

DUKE ENERGY - INSTALL POLE (TRANSMISSION)

I:\2008\Projects\U5738-Ut_U06.dgn