

09.08/99

26-MAY-2020 11:39 Y:\Projects\NCDOT\Utility On-Call Contract\BR-0035 Moore County\Utilities\BR0035_ut_tsh_U01_psh.dgn C:\Users\at_caryl\OneDrive\AT_CARYL\NCSOME

TIP PROJECT: BR-0035

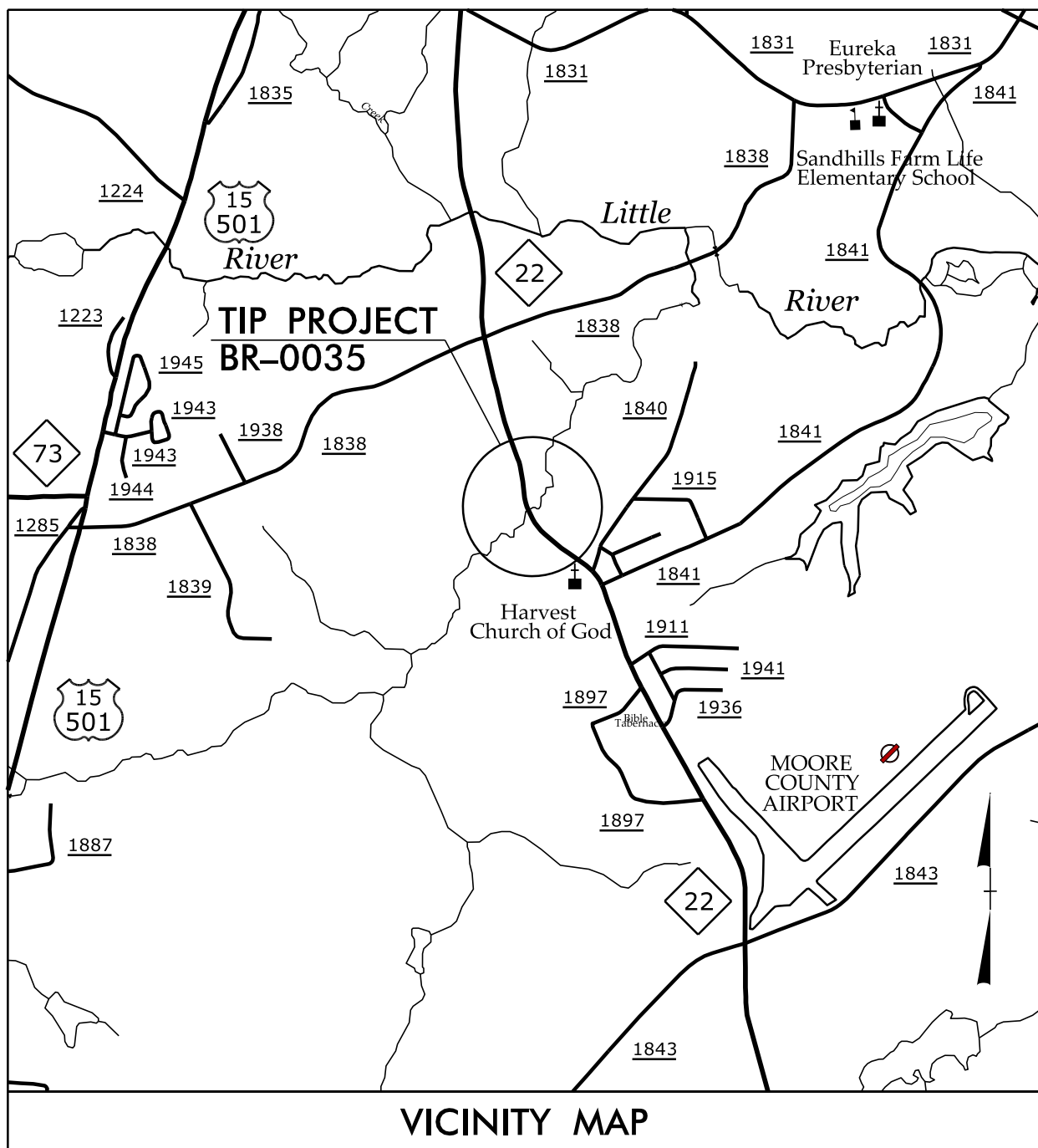

VICINITY MAP

STATE OF NORTH CAROLINA
DIVISION OF HIGHWAYS

**UTILITIES BY OTHERS PLANS
MOORE COUNTY**

LOCATION: BRIDGE NO. 24 ON NC 22 OVER NICKS CREEK

TYPE OF WORK: POWER AND COMMUNICATIONS RELOCATION

T.I.P. NO.	SHEET NO.
BR-0035	UO-1

NOTE:
ALL UTILITY WORK SHOWN ON THIS SHEET WILL BE DONE BY OTHERS. NO PAYMENT WILL BE MADE TO THE CONTRACTOR FOR UTILITY WORK SHOWN ON THIS SHEET.

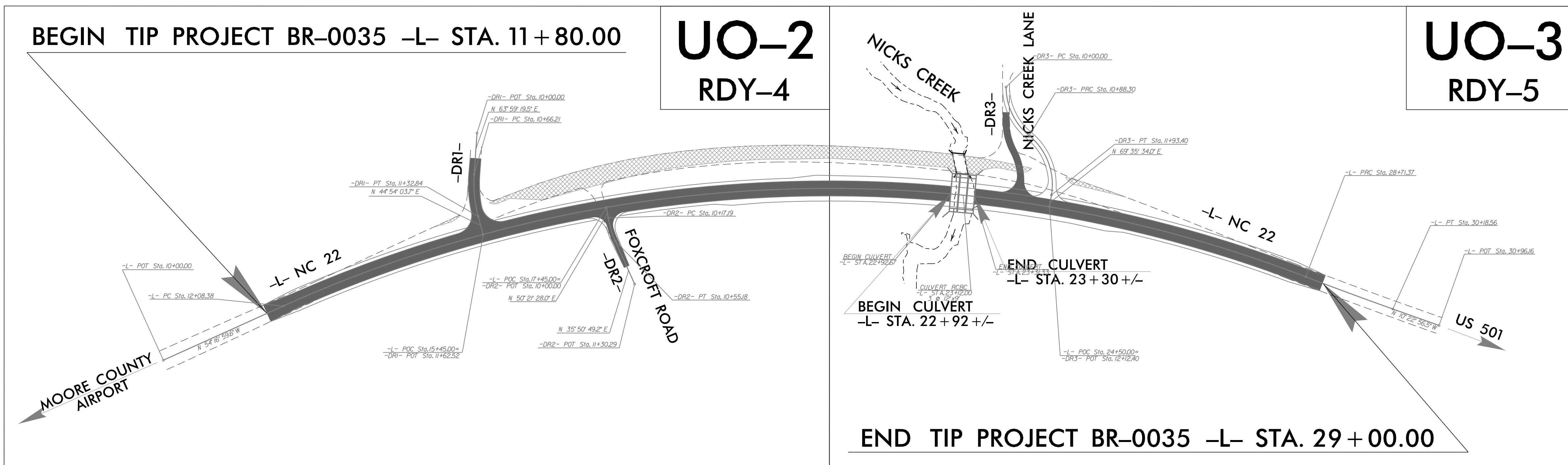
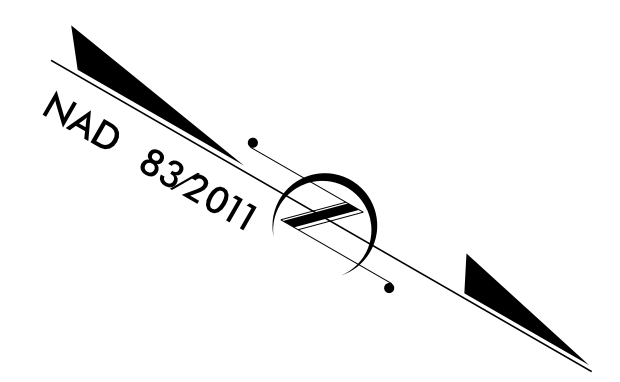

PRELIMINARY PLANS
DO NOT USE FOR CONSTRUCTION

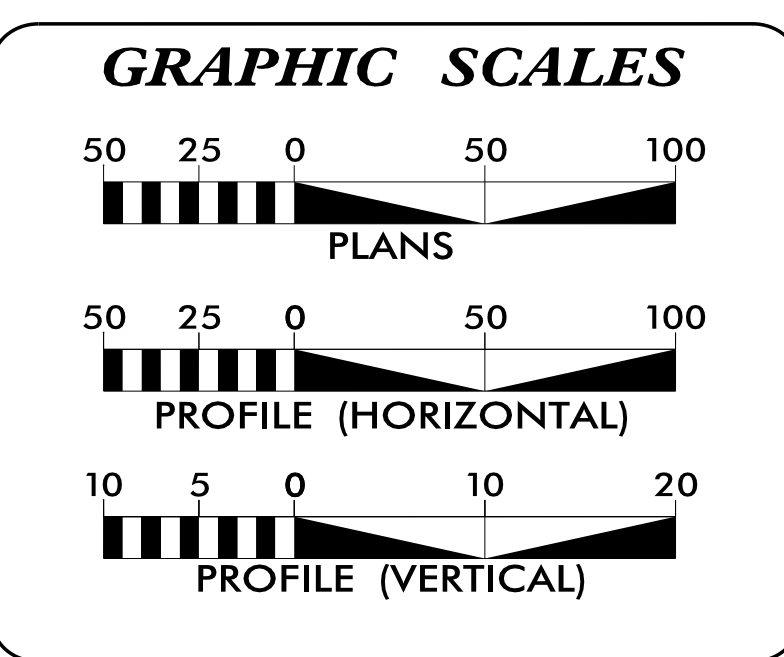

INDEX OF SHEETS

SHEET NO.:	DESCRIPTION:
UO-1	TITLE SHEET
UO-2, UO-3	UBO PLAN SHEETS

UTILITY OWNERS WITH CONFLICTS

(A) POWER (DISTRIBUTION) - DUKE ENERGY
(B) COMMUNICATIONS - CENTURYLINK
(C) COMMUNICATIONS - CONTERRA

PREPARED IN THE OFFICE OF:
Michael Baker INTERNATIONAL
Michael Baker Engineering, Inc.
8000 Regency Parkway, Suite 600
Cary, NC 27518
919-463-5488

Daniel Oliver	UTILITY PROJECT MANAGER
Daniel Oliver	PROJECT UTILITY COORDINATOR
Christina Newsome	PROJECT UTILITY TECHNICIAN

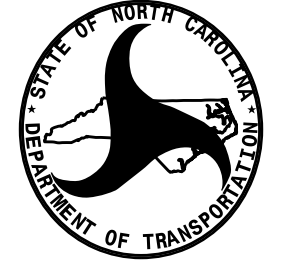

**DIVISION OF HIGHWAYS
UTILITIES UNIT**
1555 MAIL SERVICES CENTER
RALEIGH, NC 27699-1555
PHONE (919) 707-6690
FAX (919) 250-4151

Tucker R. Martin, PE	UTILITIES REGIONAL ENGINEER
Jon Loughry	UTILITIES ENGINEER
Jon E. Gaillard	UTILITIES COORDINATOR

UTILITIES BY OTHERS

ALL PROPOSED UTILITY WORK SHOWN ON THIS SHEET WILL BE DONE BY OTHERS. NO PAYMENT WILL BE MADE TO THE CONTRACTOR FOR PROPOSED UTILITY WORK SHOWN ON THIS SHEET.

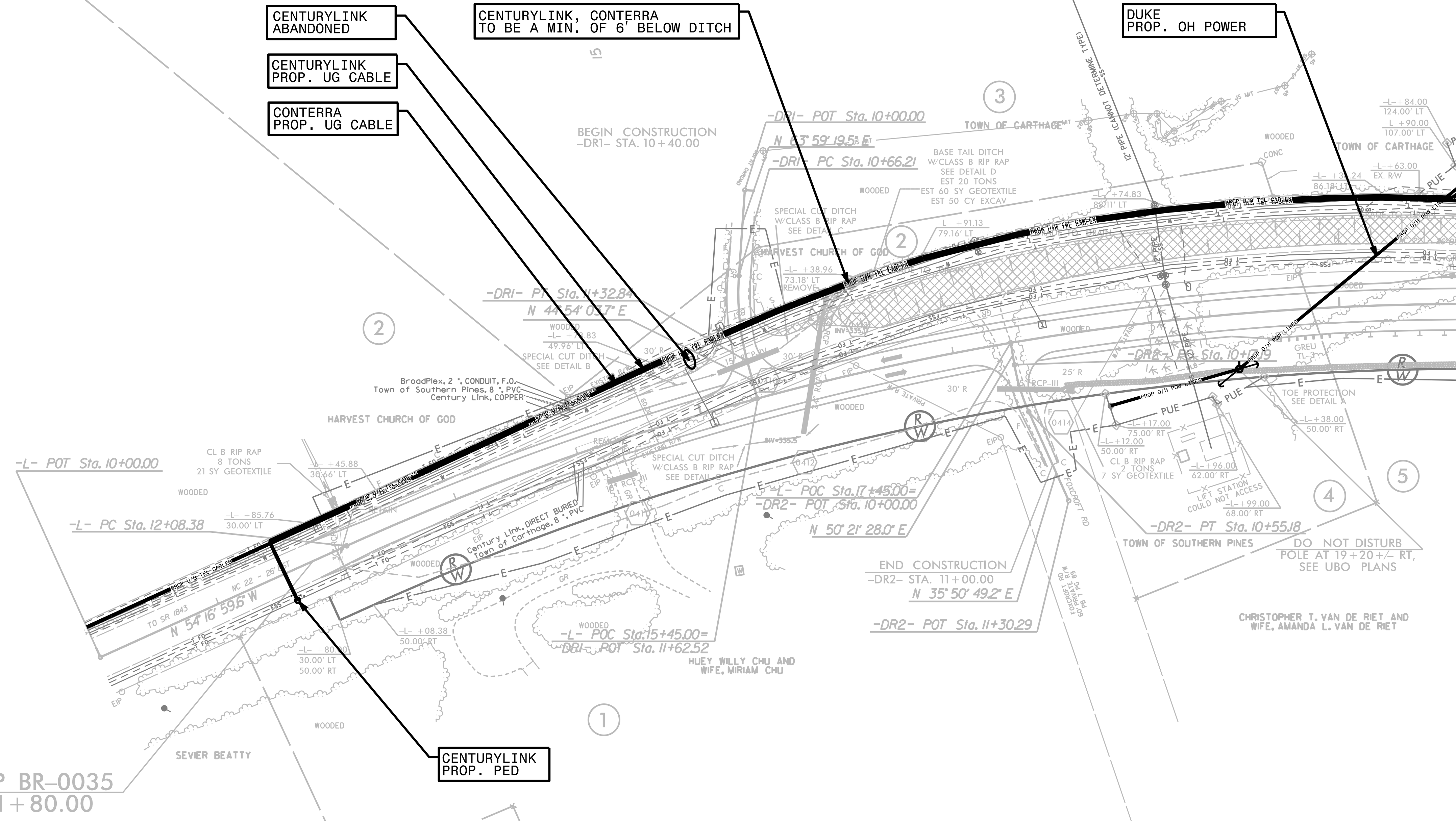
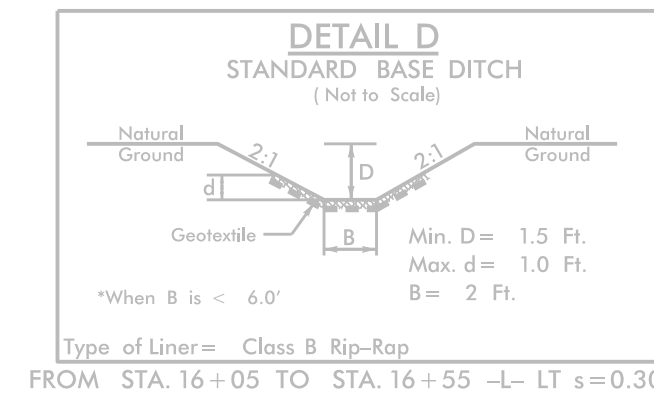
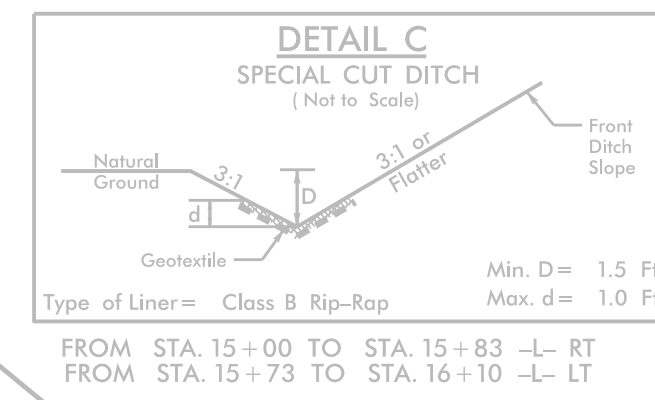
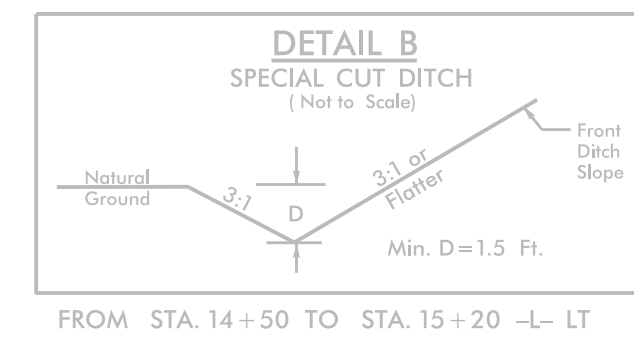
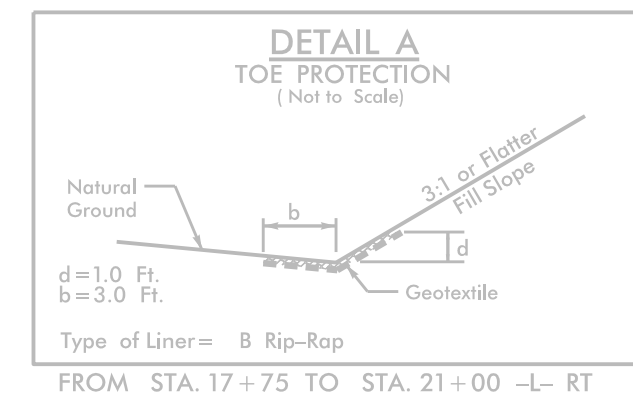
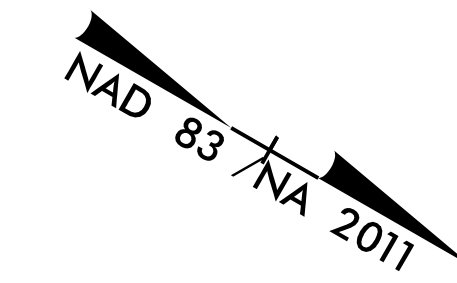

MATCHLINE -L- STA. 21+00.00 SEE SHEET UO-3

5/14/99
 44
 45
 46
 47
 48
 49
 50
 51
 52
 53
 54
 55
 56
 57
 58
 59
 60
 61
 62
 63
 64
 65
 66
 67
 68
 69
 70
 71
 72
 73
 74
 75
 76
 77
 78
 79
 80
 81
 82
 83
 84
 85
 86
 87
 88
 89
 90
 91
 92
 93
 94
 95
 96
 97
 98
 99
 100

UTILITIES BY OTHERS

ALL PROPOSED UTILITY WORK SHOWN ON THIS SHEET WILL BE DONE BY OTHERS. NO PAYMENT WILL BE MADE TO THE CONTRACTOR FOR PROPOSED UTILITY WORK SHOWN ON THIS SHEET.

-L-	
PI Sta 20+86.24 Δ = 45° 22' 21.6" (RT) D = 2' 43' 42.1" L = 1663.00' T = 877.86' R = 2100.00' RO = SEE PLANS SE = .06	PI Sta 29+44.97 Δ = 1' 28' 18.5" (LT) D = 1' 00' 00.0" L = 147.18' T = 73.59' R = 5729.58'
-DR3-	
PI Sta 10+47.26 Δ = 50° 35' 24.0" (LT) D = 57' 17" 44.8" L = 88.30' T = 47.26' R = 100.00'	PI Sta 11+46.29 Δ = 60° 13' 20.5" (RT) D = 57' 17" 44.8" L = 105.11' T = 57.99' R = 100.00'

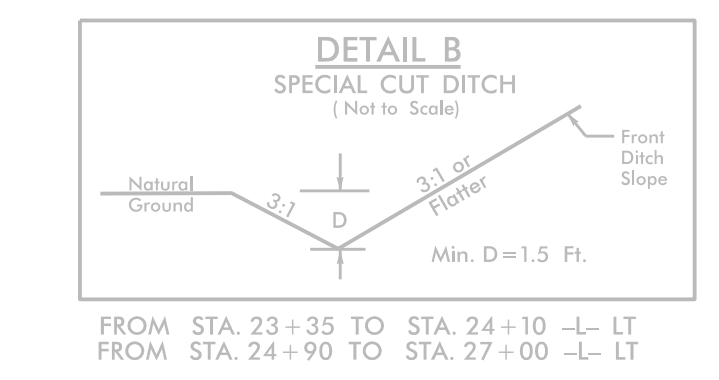
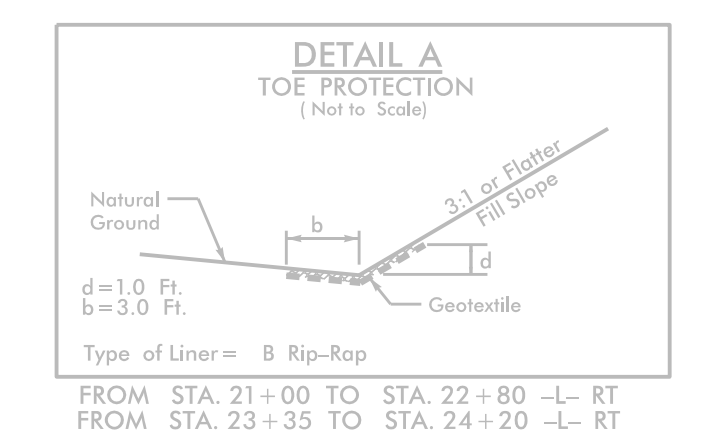
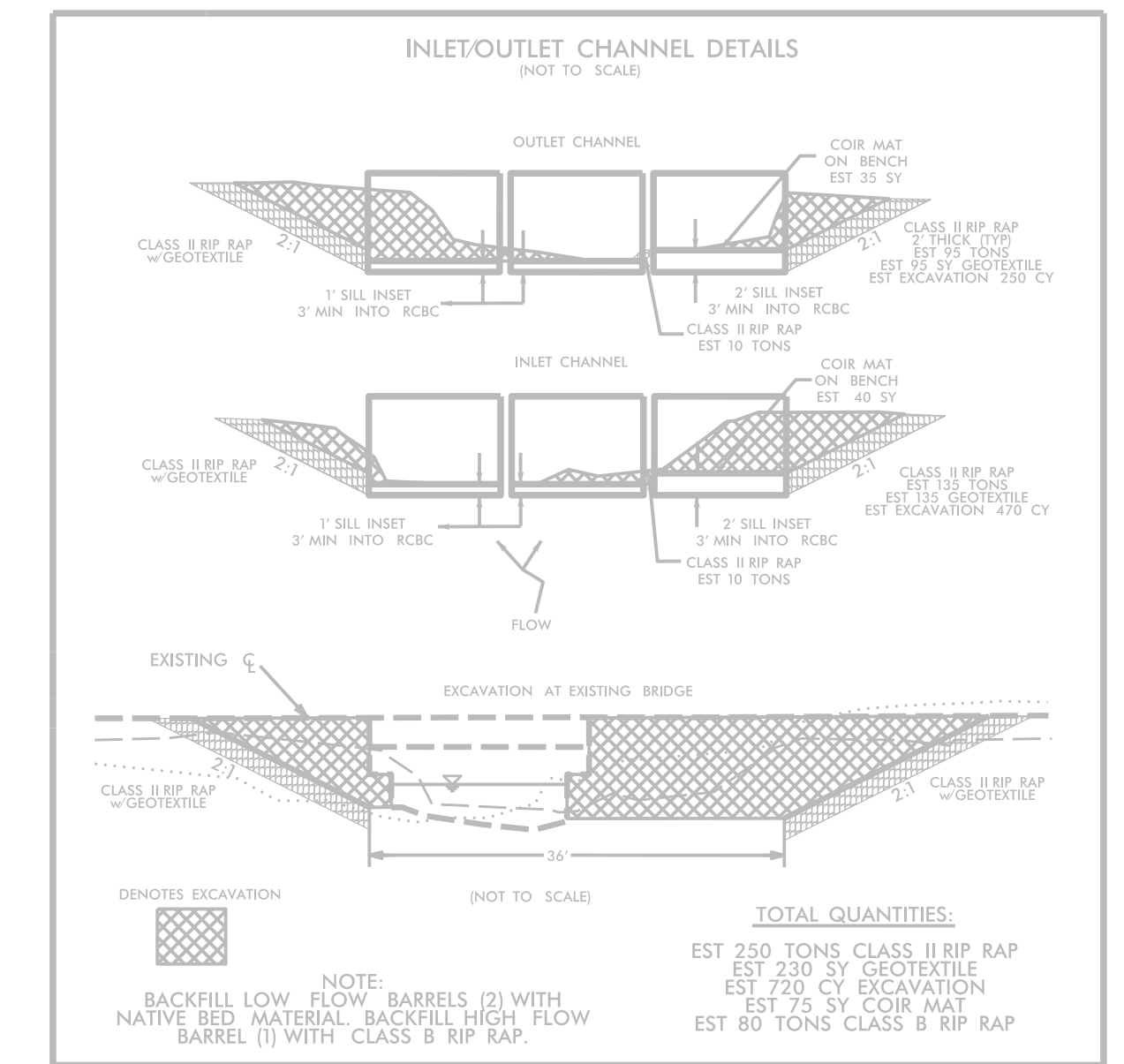
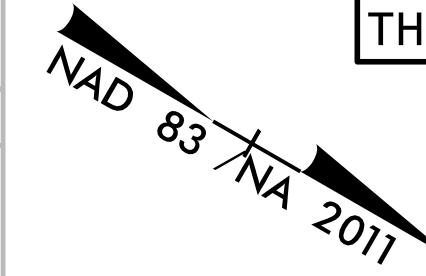

CENTURYLINK
PROP. UG CABLE
DIRECTIONAL BORE
10' BELOW CREEK BED

CONTERRA
PROP. UG CABLE
DIRECTIONAL BORE
10' BELOW CREEK BED

MATCHLINE -L- STA. 21+00.00 SEE SHEET UO-2

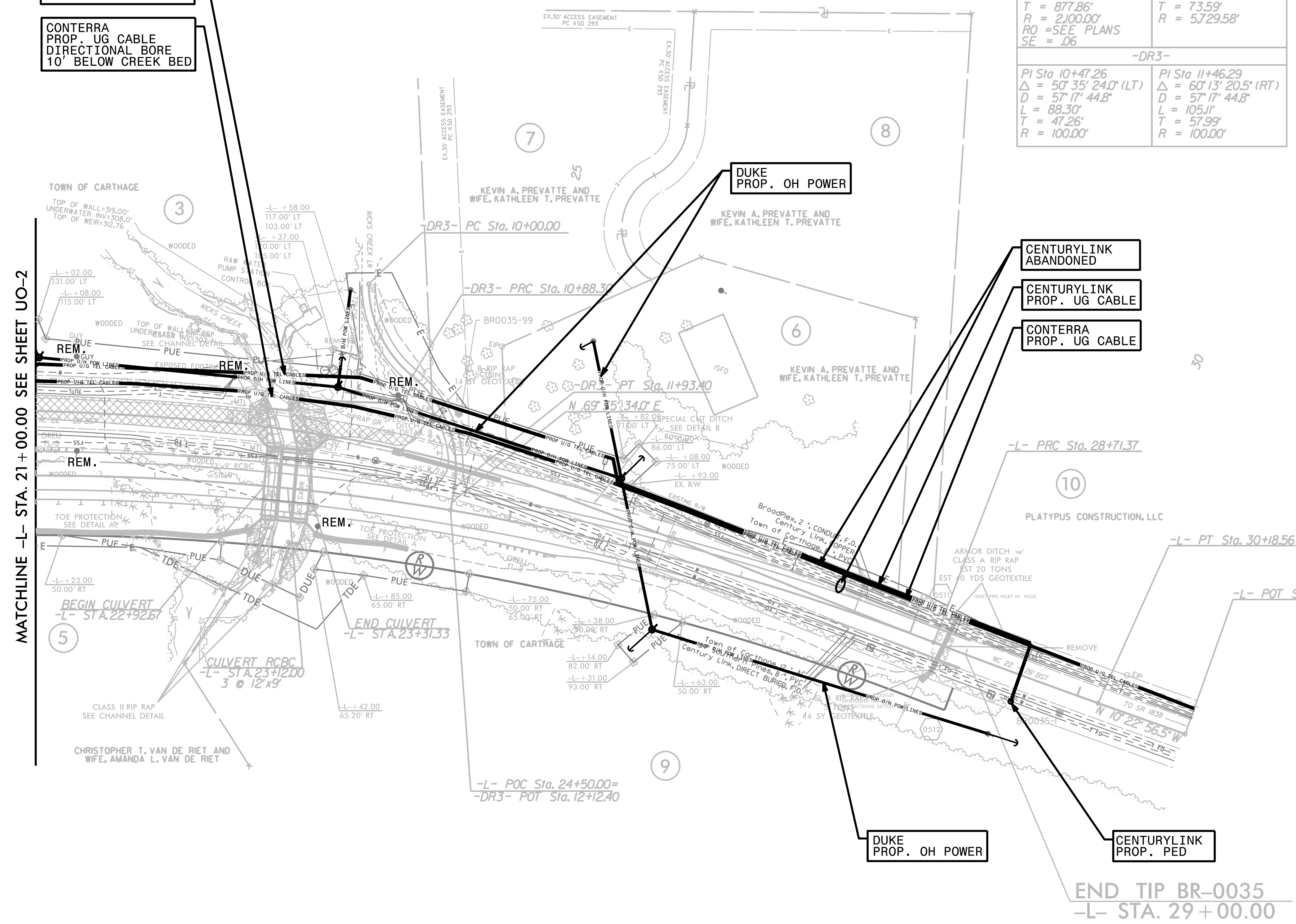

5/14/2019