

DEFAULT PHASING DIAGRAM

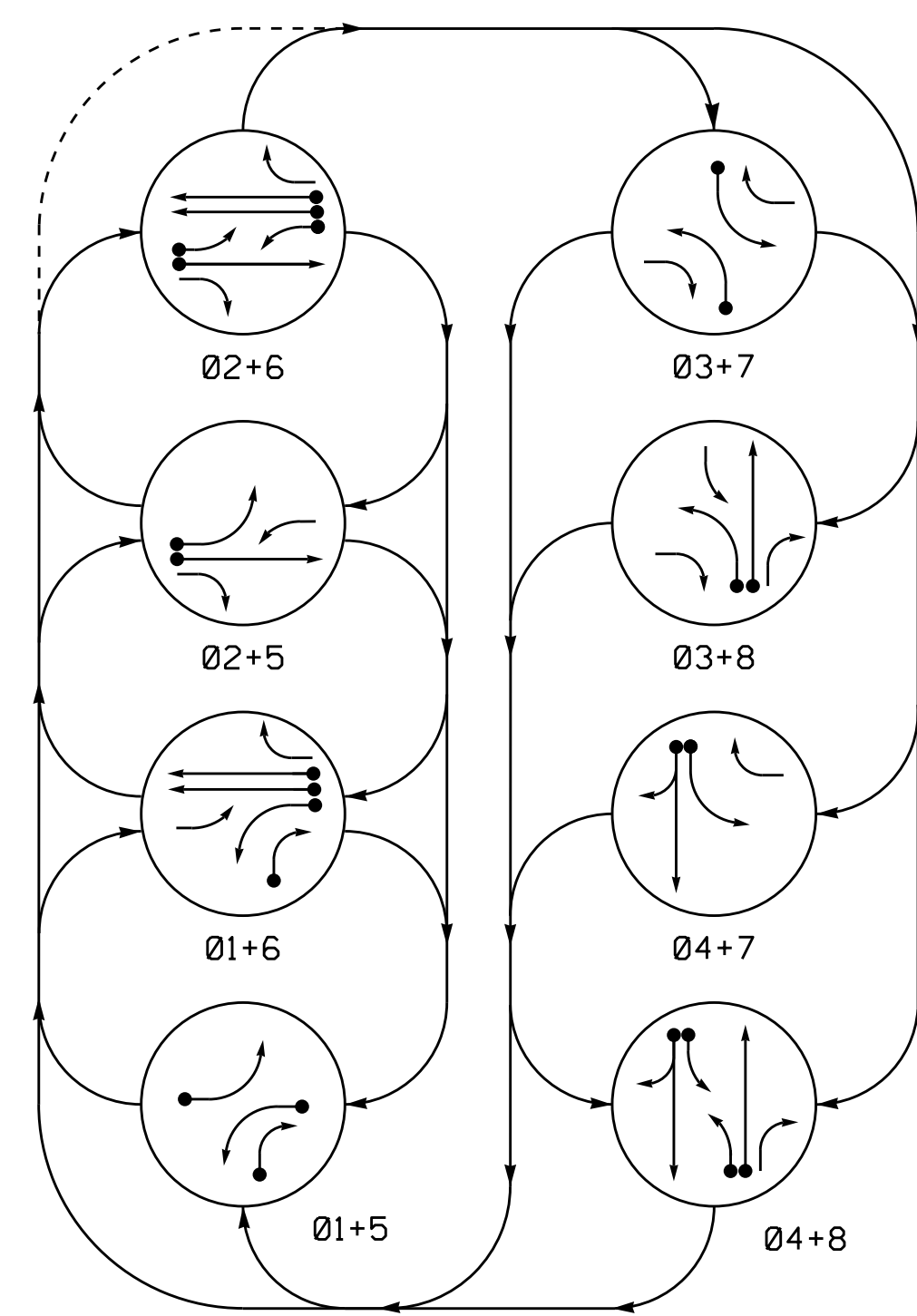

DEFAULT PHASING TABLE OF OPERATION

SIGNAL FACE	PHASE							
	01+5	01+6	02+5	02+6	03+7	03+8	04+7	04+8
11	←	←	←	←	←	←	←	←
21	R	R	G	G	R	R	R	Y
22	R	R	G	G	R	R	R	Y
31	←	←	←	←	←	←	←	←
41, 42, 43	R	R	R	R	R	R	G	G
51	←	←	←	←	←	←	←	←
61	R	G	R	G	R	R	R	Y
62	R	G	R	G	R	R	R	Y
71	←	←	←	←	←	←	←	←
81	R	R	R	R	R	G	R	G
82	R	R	R	R	R	G	R	G

ALTERNATE PHASING TABLE OF OPERATION

SIGNAL FACE	PHASE							
	01+5	01+6	02+5	02+6	03+7	03+8	04+7	04+8
11	←	←	←	←	←	←	←	←
21	R	R	G	G	R	R	R	Y
22	R	R	G	G	R	R	R	Y
31	←	←	←	←	←	←	←	←
41, 42, 43	R	R	R	R	R	R	G	G
51	←	←	←	←	←	←	←	←
61	R	G	R	G	R	R	R	Y
62	R	G	R	G	R	R	R	Y
71	←	←	←	←	←	←	←	←
81	R	R	R	R	R	G	R	G
82	R	R	R	R	R	G	R	G

ALTERNATE PHASING DIAGRAM

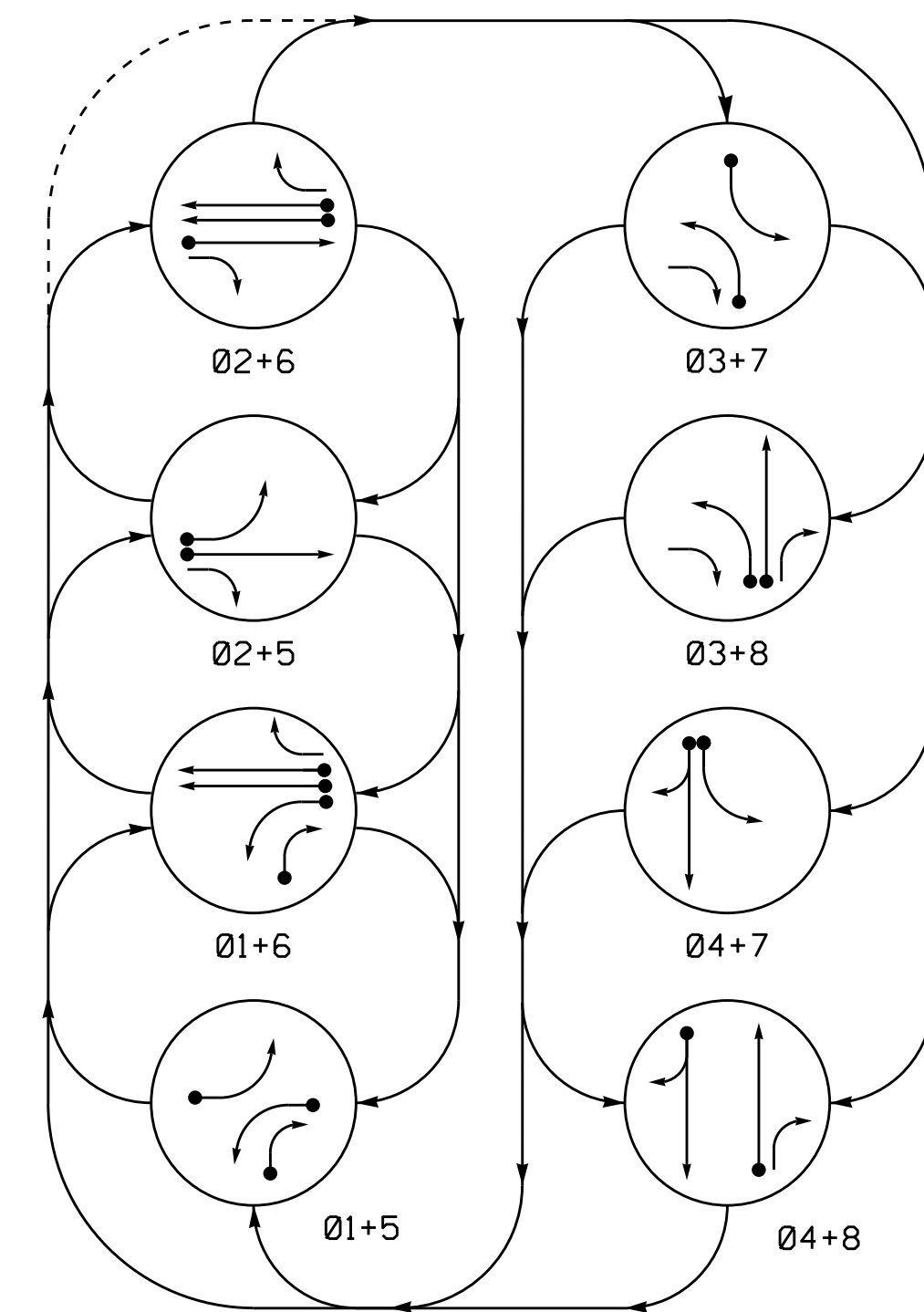

8 Phase Fully Actuated (Winston-Salem Signal System)

NOTES

1. Refer to "Roadway Standard Drawings NCDOT" dated January 2018 and "Standard Specifications for Roads and Structures" dated January 2018.
2. Do not program signal for late night flashing operation unless otherwise directed by the Engineer.
3. Phase 1 and/or phase 5 may be lagged.
4. Phase 3 and/or phase 7 may be lagged.
5. Reposition existing signal heads 21, 41, 42, 61, 62 and 71.
6. Set all detector units to presence mode.
7. This intersection uses video detection. Install detectors according to the manufacturer's instructions to achieve the desired detection.
8. The Division (City) Traffic Engineer will determine the hours of use for each phasing plan.
9. Maximum times shown in timing chart are for free-run operation only. Coordinated signal system timing values supersede these values.

PHASING DIAGRAM DETECTION LEGEND

- DETECTED MOVEMENT
- ◄ UNDETECTED MOVEMENT (OVERLAP)
- UNSIGNALIZED MOVEMENT
- PEDESTRIAN MOVEMENT

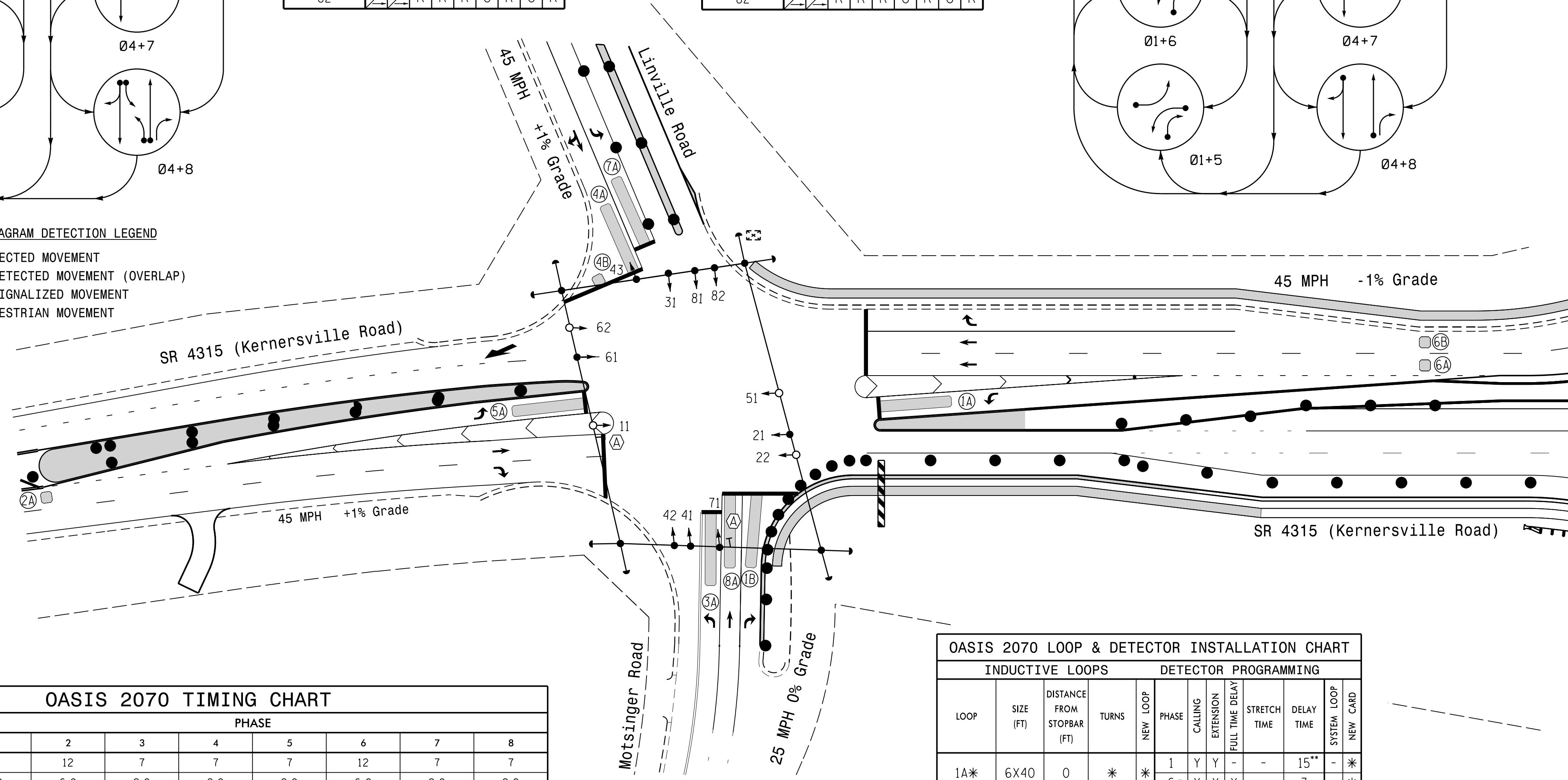

OASIS 2070 TIMING CHART

FEATURE	PHASE							
	1	2	3	4	5	6	7	8
Min Green 1*	7	12	7	7	7	12	7	7
Extension 1*	2.0	6.0	2.0	2.0	2.0	6.0	2.0	2.0
Max Green 1*	20	90	20	20	20	90	20	20
Yellow Clearance	3.0	4.6	3.0	4.4	3.0	4.6	3.0	4.4
Red Clearance	3.3	2.2	3.1	2.9	2.8	2.2	3.7	2.9
Red Revert	2.0	2.0	2.0	2.0	2.0	2.0	2.0	2.0
Walk 1*	-	-	-	-	-	-	-	-
Don't Walk 1	-	-	-	-	-	-	-	-
Seconds Per Actuation*	-	2.5	-	-	-	1.5	-	-
Max Variable Initial*	-	34	-	-	-	34	-	-
Time Before Reduction*	-	15	-	-	-	15	-	-
Time To Reduce*	-	30	-	-	-	30	-	-
Minimum Gap	-	3.0	-	-	-	3.0	-	-
Recall Mode	-	SOFT RECALL	-	-	-	SOFT RECALL	-	-
Vehicle Call Memory	-	YELLOW	-	-	-	YELLOW	-	-
Dual Entry	-	-	-	ON	-	-	-	ON
Simultaneous Gap	ON	ON	ON	ON	ON	ON	ON	ON

SIGNAL FACE I.D.

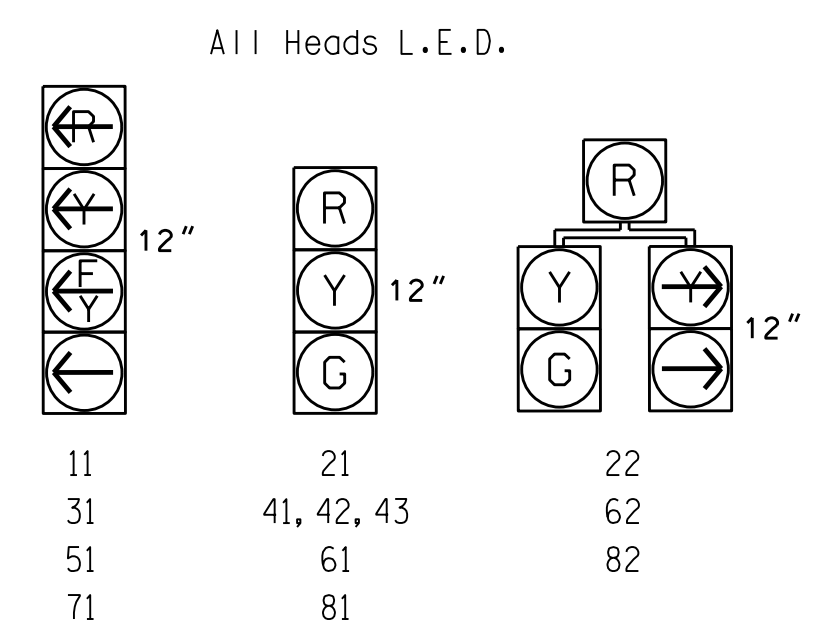

OASIS 2070 LOOP & DETECTOR INSTALLATION CHART

LOOP	SIZE (FT)	DISTANCE FROM STOPBAR (FT)	TURNS	NEW LOOP	DETECTOR PROGRAMMING							
					PHASE	CALLING	EXTENSION	FULL TIME DELAY	STRETCH TIME	DELAY TIME	SYSTEM LOOP	NEW CARD
1A*	6X40	0	*	*	1	Y	Y	-	-	15**	-	*
1B*	6X40	0	*	*	6#	Y	Y	Y	-	3	-	*
2A*	6X6	300	*	*	2	Y	Y	-	-	-	-	*
3A*	6X40	0	*	*	3	Y	Y	-	-	15@	-	*
3B*	6X40	0	*	*	8#	Y	Y	-	-	3	-	*
4A*	6X40	0	*	*	4	Y	Y	-	-	10	-	*
4B*	6X40	0	*	*	4	Y	Y	-	-	15	-	*
5A*	6X40	0	*	*	5	Y	Y	-	-	15**	-	*
5B*	6X40	0	*	*	2#	Y	Y	-	-	3	-	*
6A*	6X6	300	*	*	6	Y	Y	-	-	-	-	*
6B*	6X6	300	*	*	6	Y	Y	-	-	-	-	*
7A*	6X40	0	*	*	7	Y	Y	-	-	15**	-	*
7B*	6X40	0	*	*	4#	Y	Y	-	-	-	-	*
8A*	6X40	0	*	*	8	Y	Y	-	-	-	-	*

* Video Detection Zone
 ** Disable Delay during Alternate Phasing operation.
 @ Reduce Delay to 3 seconds during Alternate Phasing operation.
 # Disable phase call for loop during Alternate Phasing operation.

LEGEND

- | PROPOSED | EXISTING |
|--|--|
| ○ → Traffic Signal Head | ● → Traffic Signal Head |
| ○ → Modified Signal Head | ○ → Modified Signal Head |
| ⊥ Sign | ⊥ Sign |
| ⊥ Pedestrian Signal Head With Push Button & Sign | ⊥ Pedestrian Signal Head With Push Button & Sign |
| ⊥ Signal Pole with Guy | ⊥ Signal Pole with Guy |
| ⊥ Signal Pole with Sidewalk Guy | ⊥ Signal Pole with Sidewalk Guy |
| ⊠ Inductive Loop Detector | ⊠ Inductive Loop Detector |
| ⊠ Controller & Cabinet Junction Box | ⊠ Controller & Cabinet Junction Box |
| ⊠ 2-in Underground Conduit | ⊠ 2-in Underground Conduit |
| → Right of Way | → Right of Way |
| → Directional Arrow | → Directional Arrow |
| ● Construction Zone Drums | ● Construction Zone Drums |
| ■ Construction Zone | ■ Construction Zone |
| ⊠ "U-TURN YIELD TO RIGHT TURN" Sign (R10-16) | ⊠ "U-TURN YIELD TO RIGHT TURN" Sign (R10-16) |

Signal Upgrade - Temporary Design 3 (TMP Area 3, Phase 3)

SR 4315 (Kernersville Road) at Livville Rd./Motsinger Rd.

Division 9 Forsyth County Winston-Salem

PLAN DATE: May 2021 REVIEWED BY: [Signature]

PREPARED BY: I. O. Umzurike REVIEWED BY: [Signature]

REVISIONS: [Table]

SCALE: 1" = 40'

750 N. Greenfield Pkwy, Garner, NC 27529

DOCUMENT NOT CONSIDERED FINAL UNLESS ALL SIGNATURES COMPLETED

SEAL: [Professional Engineer Seal]

DATE: 7/9/2021

SIG. INVENTORY NO. 09-066013

19-AUG-2021 11:38
 P:\IT\Projects\2579AB\Drawings\Signal\Signal\03-066013.dwg
 P:\IT\Projects\2579AB\Drawings\Signal\Signal\03-066013.dwg
 P:\IT\Projects\2579AB\Drawings\Signal\Signal\03-066013.dwg
 P:\IT\Projects\2579AB\Drawings\Signal\Signal\03-066013.dwg