

Location and Surveys

INSERT CONSULTANT'S NAME

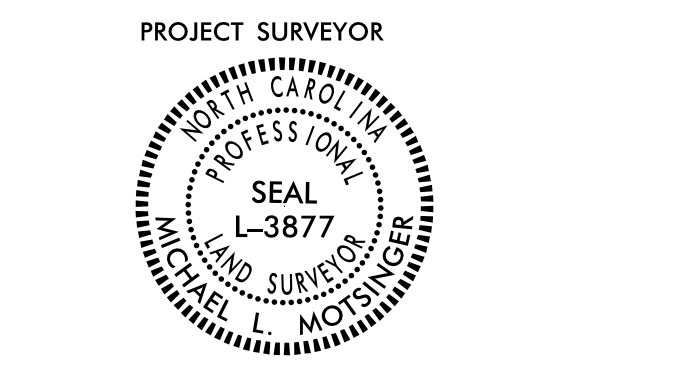

DOCUMENT NOT CONSIDERED FINAL UNLESS ALL SIGNATURES COMPLETED

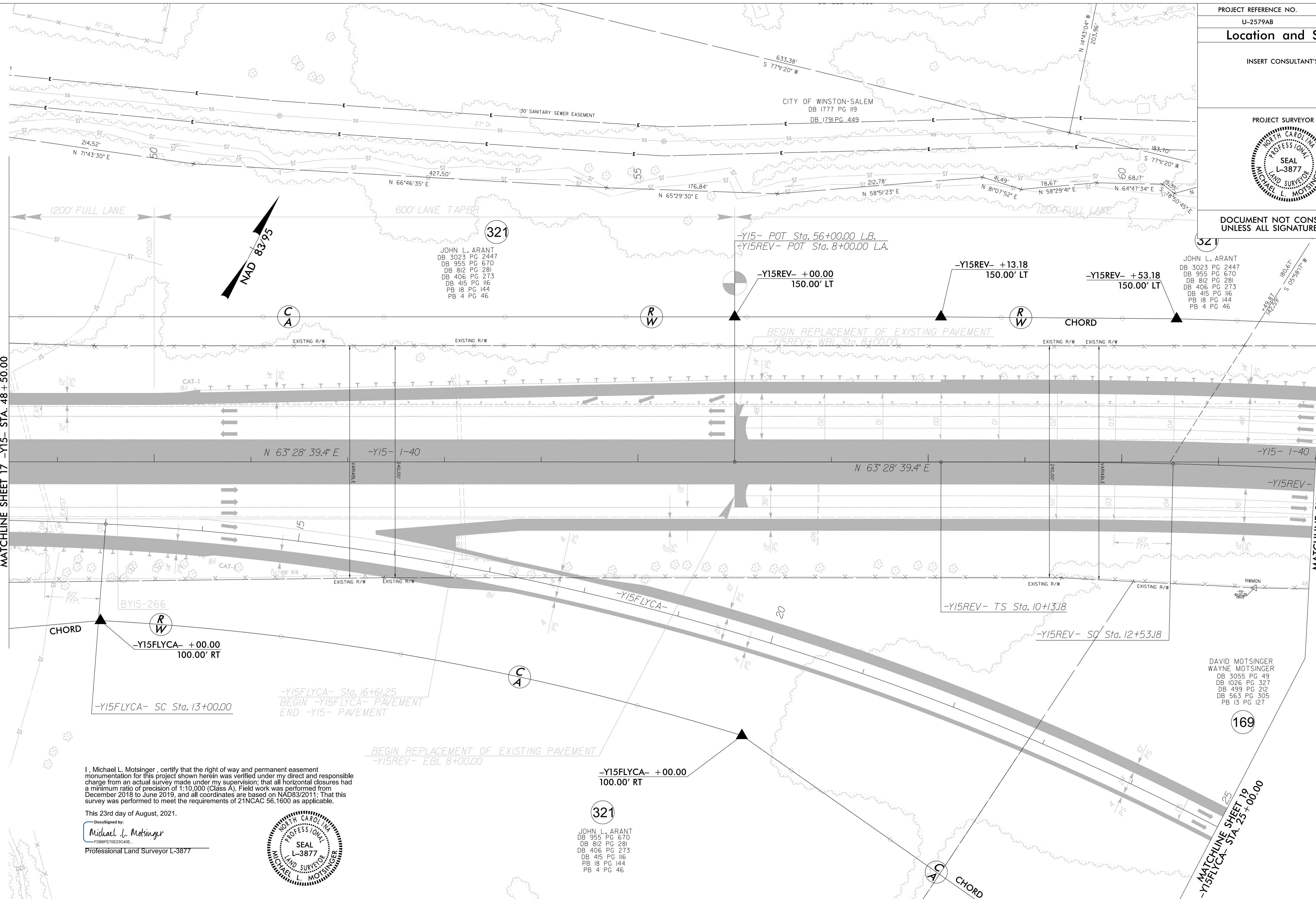

JOHN L. ARANT
DB 3023 PG 2447
DB 955 PG 670
DB 812 PG 281
DB 406 PG 273
DB 415 PG 116
PB 18 PG 144
PB 4 PG 46

JOHN L. ARANT
DB 3023 PG 2447
DB 955 PG 670
DB 812 PG 281
DB 406 PG 273
DB 415 PG 116
PB 18 PG 144
PB 4 PG 46

DAVID MOTSINGER
WAYNE MOTSINGER
DB 3055 PG 49
DB 1026 PG 327
DB 499 PG 212
DB 563 PG 305
PB 13 PG 127

I, Michael L. Motsinger, certify that the right of way and permanent easement monumentation for this project shown herein was verified under my direct and responsible charge from an actual survey made under my supervision; that all horizontal closures had a minimum ratio of precision of 1:10,000 (Class A). Field work was performed from December 2018 to June 2019, and all coordinates are based on NAD83/2011; That this survey was performed to meet the requirements of 21NCAC 56.1600 as applicable.

This 23rd day of August, 2021.
DocuSigned by:
Michael L. Motsinger
FDB9F79E293C40E
Professional Land Surveyor L-3877



-Y15FLYCA- (FLYOVER)

PIs Sta. 12+00.03	PI Sta. 21+26.72
Os = 3° 02' 51.5"	Δ = 32° 40' 42.7" (RT)
Ls = 300.00'	D = 2° 01' 54.4"
LT = 200.03'	L = 1,608.38'
ST = 100.03'	T = 826.72'
INC = 60.00'	R = 2,820.00'
	SE = 05

-Y15REV- (RELOCATED I-40 BYPASS)

PIs Sta. 11+73.18	PI Sta. 21+08.35
Os = 1° 21' 41.3"	Δ = 19° 13' 21.3" (RT)
Ls = 240.00'	D = 1° 08' 04.5"
LT = 160.00'	L = 1,694.26'
ST = 80.00'	T = 855.17'
INC = 60.00'	R = 5,050.00'
	SE = 04

NOTES:

1. IF FURTHER INFORMATION REGARDING PROJECT CONTROL IS NEEDED PLEASE CONTACT THE LOCATION AND SURVEYS UNIT.
2. PROJECT CONTROL WAS ESTABLISHED USING GNSS, THE GLOBAL NAVIGATION SATELLITE SYSTEM.
3. RIGHT OF WAY MONUMENTATION ESTABLISHED _____ TO _____.

REVISIONS

6/2/19

S:\JUG-2020\0833\Winston\CL\Its Computer\Urban\U-2579ab\Right of Way\RW Ctl Sheets 2020\Julie\to be checked\U-2579ab.ls_rwl8.dgn
 AT 11:53:25 AM
 8/1/2020 10:08:33 AM
 3/1/2020 10:08:33 AM