

STATE OF NORTH CAROLINA
DIVISION OF HIGHWAYS

TRANSPORTATION MANAGEMENT PLAN
BRUNSWICK COUNTY

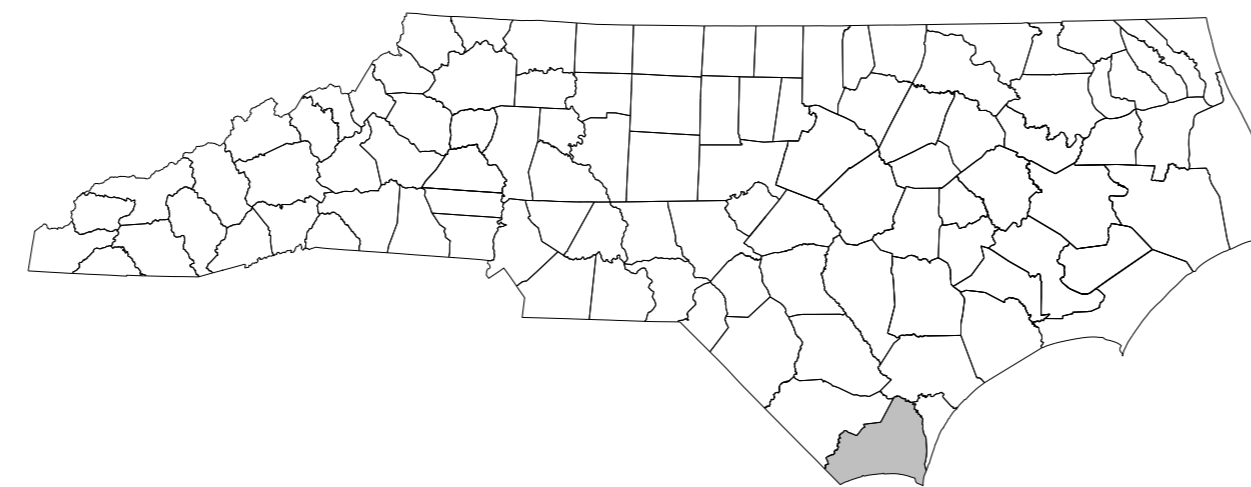

**LOCATION: REPLACE BRIDGE NO. 65 OVER BATARORA BRANCH
ON NC 87 (MACO ROAD)**

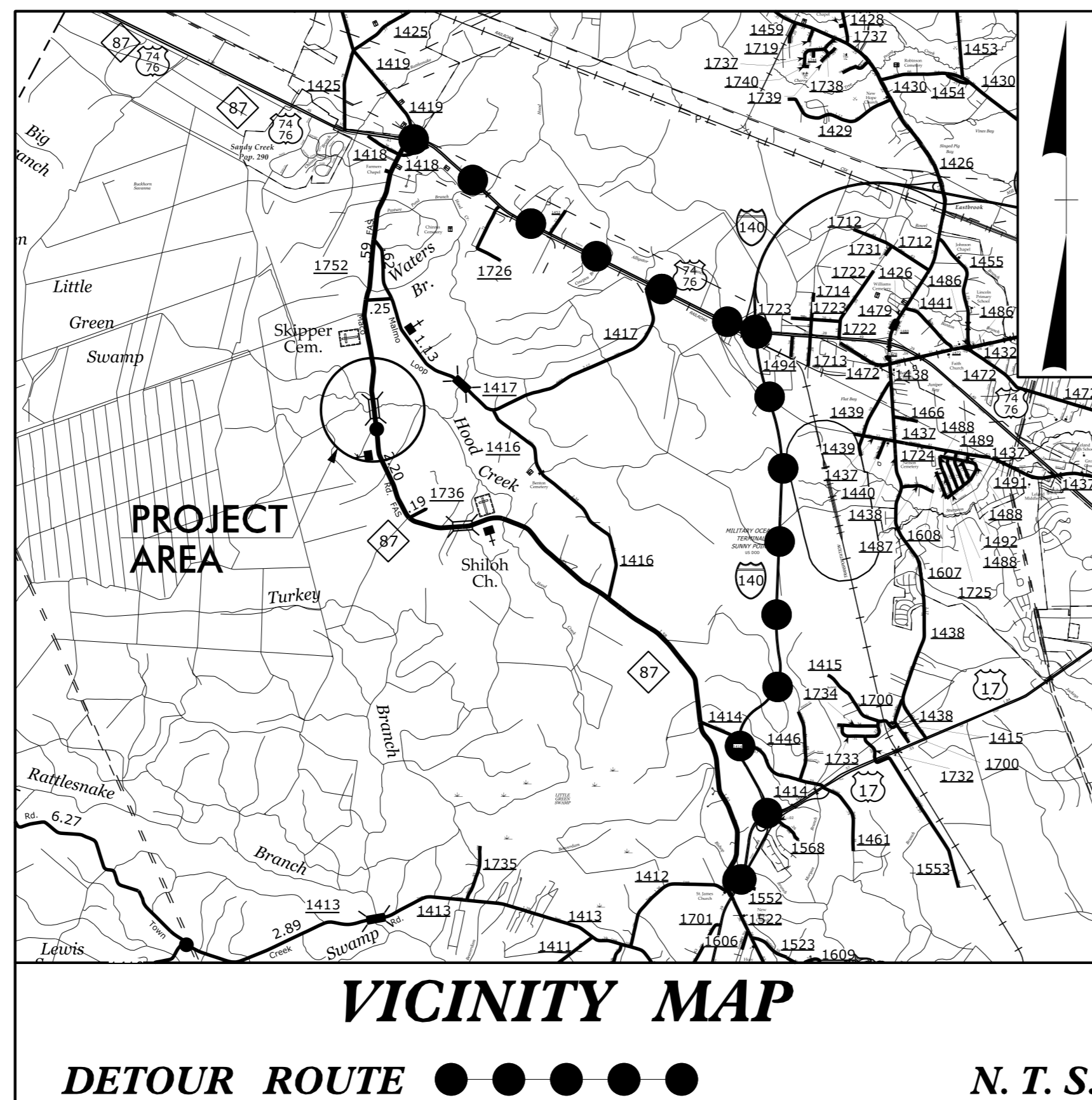

INDEX OF SHEETS

SHEET NO.	TITLE
TMP-1	TITLE SHEET, VICINITY MAP, AND INDEX OF SHEETS
TMP-1A	LIST OF APPLICABLE ROADWAY STANDARD DRAWINGS, AND LEGEND
TMP-1B	TRANSPORTATION OPERATIONS PLAN: (MANAGEMENT STRATEGIES, GENERAL NOTES, AND LOCAL NOTES)
TMP-2	OFF-SITE DETOUR

SHEET NO.
TMP-1

2/3/2021 10:02:00 AM User: JGANTMAN

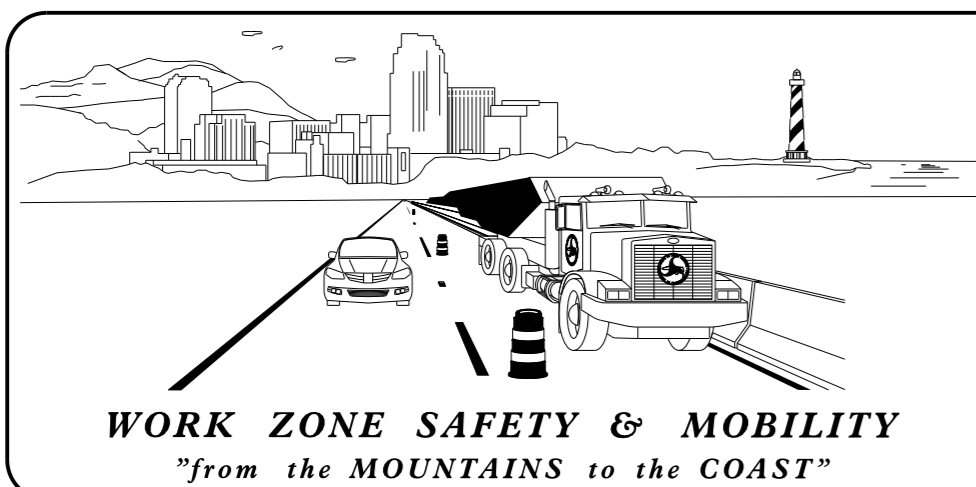

PLANS PREPARED BY:

ADAM CONRAD, P.E.
PROJECT ENGINEER

MONIQUE GYANT, E.I.
PROJECT DESIGN ENGINEER

NCDOT CONTACTS:

KEN THORNEWELL, P.E.
PROJECT ENGINEER

SPENCER JENNINGS
PROJECT DESIGN ENGINEER

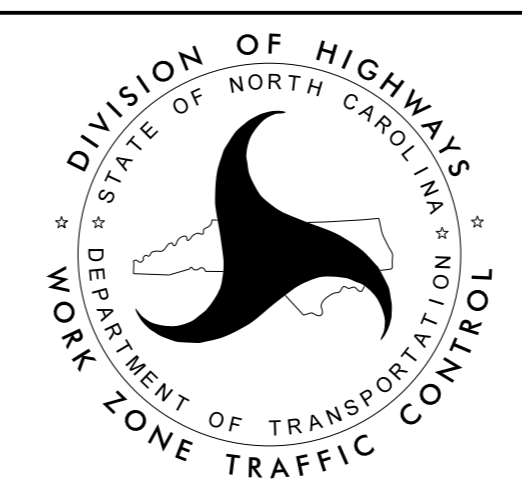

CDM Smith
CDM Smith Inc.
5400 Glenwood Avenue
Suite 400
Raleigh, NC 27612-3228
NC COA No. F-1255

**DOCUMENT NOT CONSIDERED FINAL
UNLESS ALL SIGNATURES COMPLETED**

APPROVED: *Adam M. Conrad, P.E., P.H.P.*
DATE: 4/6/2021

SEAL

TIP PROJECT: B-5642

ROADWAY STANDARD DRAWINGS

THE FOLLOWING ROADWAY STANDARDS AS SHOWN IN "ROADWAY STANDARD DRAWINGS" - N.C. DEPARTMENT OF TRANSPORTATION - RALEIGH, N.C., DATED JANUARY 2018 ARE APPLICABLE TO THIS PROJECT AND BY REFERENCE HEREBY ARE CONSIDERED A PART OF THESE PLANS:

STD. NO.	TITLE
1101.03	TEMPORARY ROAD CLOSURES
1101.11	TRAFFIC CONTROL DESIGN TABLES
1110.01	STATIONARY WORK ZONE SIGNS
1145.01	BARRICADES

LEGEND

GENERAL

- DIRECTION OF TRAFFIC FLOW
- DIRECTION OF PEDESTRIAN TRAFFIC FLOW
- EXIST. PVMT.
- NORTH ARROW
- PROPOSED PVMT.
- TEMP. SHORING (LOCATION PURPOSES ONLY)

SIGNALS

- EXISTING
- PROPOSED
- TEMPORARY

PAVEMENT MARKINGS

- EXISTING LINES
- TEMPORARY LINES

TRAFFIC CONTROL DEVICES

- BARRICADE (TYPE III)
- CONE
- DRUM
- SKINNY DRUM
- TUBULAR MARKER
- TEMPORARY CRASH CUSHION
- FLASHING ARROW BOARD
- FLAGGER
- LAW ENFORCEMENT
- TRUCK MOUNTED ATTENUATOR (TMA)
- CHANGEABLE MESSAGE SIGN

TEMPORARY SIGNING

- PORTABLE SIGN
- STATIONARY SIGN
- STATIONARY OR PORTABLE SIGN

PAVEMENT MARKERS

- CRYSTAL/CRYSTAL
- CRYSTAL/RED
- YELLOW/YELLOW

PAVEMENT MARKING SYMBOLS

- PAVEMENT MARKING SYMBOLS

2/3/2021 10:02:00 AM User: F:\CANTMN\pw\csm\smith-az02-pw.bentley.com\FW_PL\Documents\17240\235077\0 Transportation\04 Client Folder Structure\B-5642\TrafficControl\TCP\B5642_TMP_TC01A.dgn

CDM Smith
 CDM Smith Inc.
 5400 Glenwood Avenue
 Suite 400
 Raleigh, NC 27612-3228
 NC COA No. F-1255

APPROVED: *Adam M. Conrod, P.E., PMP*
 DATE: 4/6/2021
 SEAL
 NORTH CAROLINA PROFESSIONAL ENGINEER
 ADAM M. CONROD
 043767

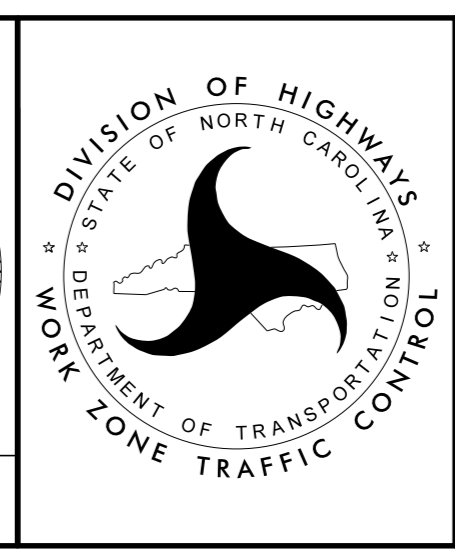

ROADWAY STANDARD DRAWINGS & LEGEND

DOCUMENT NOT CONSIDERED FINAL UNLESS ALL SIGNATURES COMPLETED

MANAGEMENT STRATEGIES

1. CLOSE NC 87 (MACO ROAD) TO TRAFFIC AND DETOUR TRAFFIC OFF-SITE.
2. LOCAL ACCESS TO ALL RESIDENCES AND BUSINESSES WILL BE MAINTAINED BETWEEN CLOSURE POINTS AT ALL TIMES DURING CONSTRUCTION.

GENERAL NOTES

CHANGES MAY BE REQUIRED WHEN PHYSICAL DIMENSIONS IN THE DETAIL DRAWINGS, STANDARD DETAILS, AND ROADWAY DETAILS ARE NOT ATTAINABLE TO MEET FIELD CONDITIONS OR RESULT IN DUPLICATE OR UNDESIRED OVERLAPPING OF DEVICES. MODIFICATION MAY INCLUDE: MOVING, SUPPLEMENTING, COVERING, OR REMOVAL OF DEVICES AS DIRECTED BY THE ENGINEER.

THE FOLLOWING GENERAL NOTES APPLY AT ALL TIMES FOR THE DURATION OF THE CONSTRUCTION PROJECT EXCEPT WHEN OTHERWISE NOTED IN THE PLAN OR DIRECTED BY THE ENGINEER.

TRAFFIC PATTERN ALTERATIONS

- A) NOTIFY THE ENGINEER THIRTY (30) CALENDAR DAYS PRIOR TO ANY TRAFFIC PATTERN ALTERATION.

SIGNING

- B) INSTALL ADVANCE WORK ZONE WARNING SIGNS WHEN WORK IS WITHIN 40 FT FROM THE EDGE OF TRAVEL LANE AND NO MORE THAN THREE (3) DAYS PRIOR TO THE BEGINNING OF CONSTRUCTION.
- C) PROVIDE SIGNING AND DEVICES REQUIRED TO CLOSE THE ROAD ACCORDING TO THE ROADWAY STANDARD DRAWINGS AND TRAFFIC CONTROL PLANS.

PROVIDE SIGNING REQUIRED FOR THE OFF-SITE DETOUR ROUTE AS SHOWN IN THE TRAFFIC CONTROL PLANS.

- D) COVER OR REMOVE ALL SIGNS AND DEVICES REQUIRED TO CLOSE THE ROAD WHEN ROAD CLOSURE IS NOT IN OPERATION.

COVER OR REMOVE ALL SIGNS REQUIRED FOR THE OFF-SITE DETOUR WHEN THE DETOUR IS NOT IN OPERATION.

- E) ENSURE ALL NECESSARY SIGNING IS IN PLACE PRIOR TO ALTERING ANY TRAFFIC PATTERN.

TRAFFIC CONTROL DEVICES

- F) PLACE TYPE III BARRICADES, WITH "ROAD CLOSED" SIGN R11-2 ATTACHED, OF SUFFICIENT LENGTH TO CLOSE ENTIRE ROADWAY.

PHASING

- STEP 1: USING SHEET TMP-2 AND RSD 1101.03 (SHEET 1 OF 9), INSTALL DETOUR ROUTE SIGNING TO CLOSE NC 87 (MACO ROAD) ON PROPOSED -L- FROM STA. 14+00+/- TO STA. 22+50+/-.
- STEP 2: AWAY FROM TRAFFIC, COMPLETE CONSTRUCTION OF PROPOSED BRIDGE AND ROADWAY APPROACHES, INCLUDING DRAINAGE, GUARDRAIL, FINAL PAVEMENT MARKINGS AND MARKERS ON PROPOSED -L- FROM STA. 14+00+/- TO STA. 22+50+/-.
- STEP 3: REMOVE TEMPORARY TRAFFIC CONTROL DEVICES AND OPEN -L- TO PROPOSED 2-LANE, 2-WAY TRAFFIC PATTERN.

LOCAL NOTES

1. NOTIFY BRUNSWICK COUNTY EMERGENCY SERVICES AND PUBLIC SCHOOLS AT LEAST ONE MONTH PRIOR TO ROAD CLOSURE.

2/3/2021 10:02:00 AM pw:\cdmsmith-az02-pw.bentley.com:PW_PLN\Documents\17240\235077\0 Transportation\04 Client Folder Structure\B-5642\TrafficControl\CP\B5642_TMP_IC01B.dgn User:GANTMN



APPROVED: Aden M. Conrad, P.E., P.H.P.
00000FFAFD0440

DATE: 4/6/2021

SEAL

DOCUMENT NOT CONSIDERED FINAL UNLESS ALL SIGNATURES COMPLETED

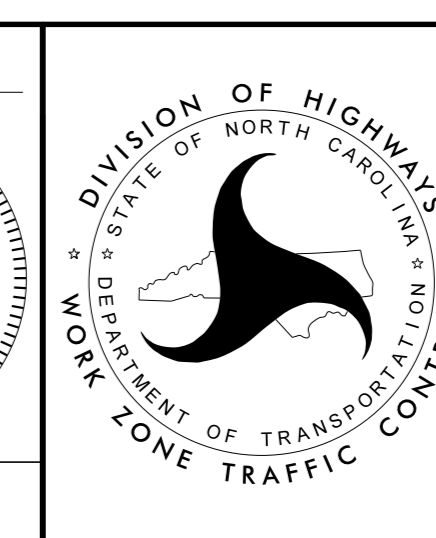

TRANSPORTATION OPERATIONS PLAN

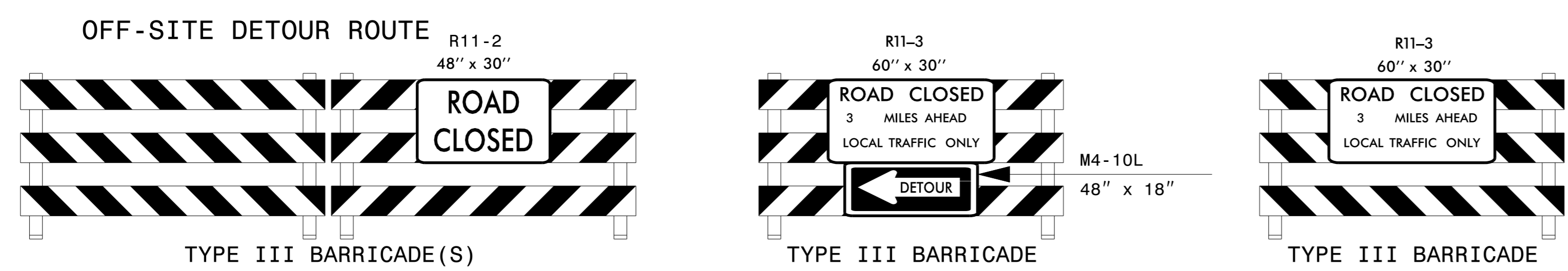
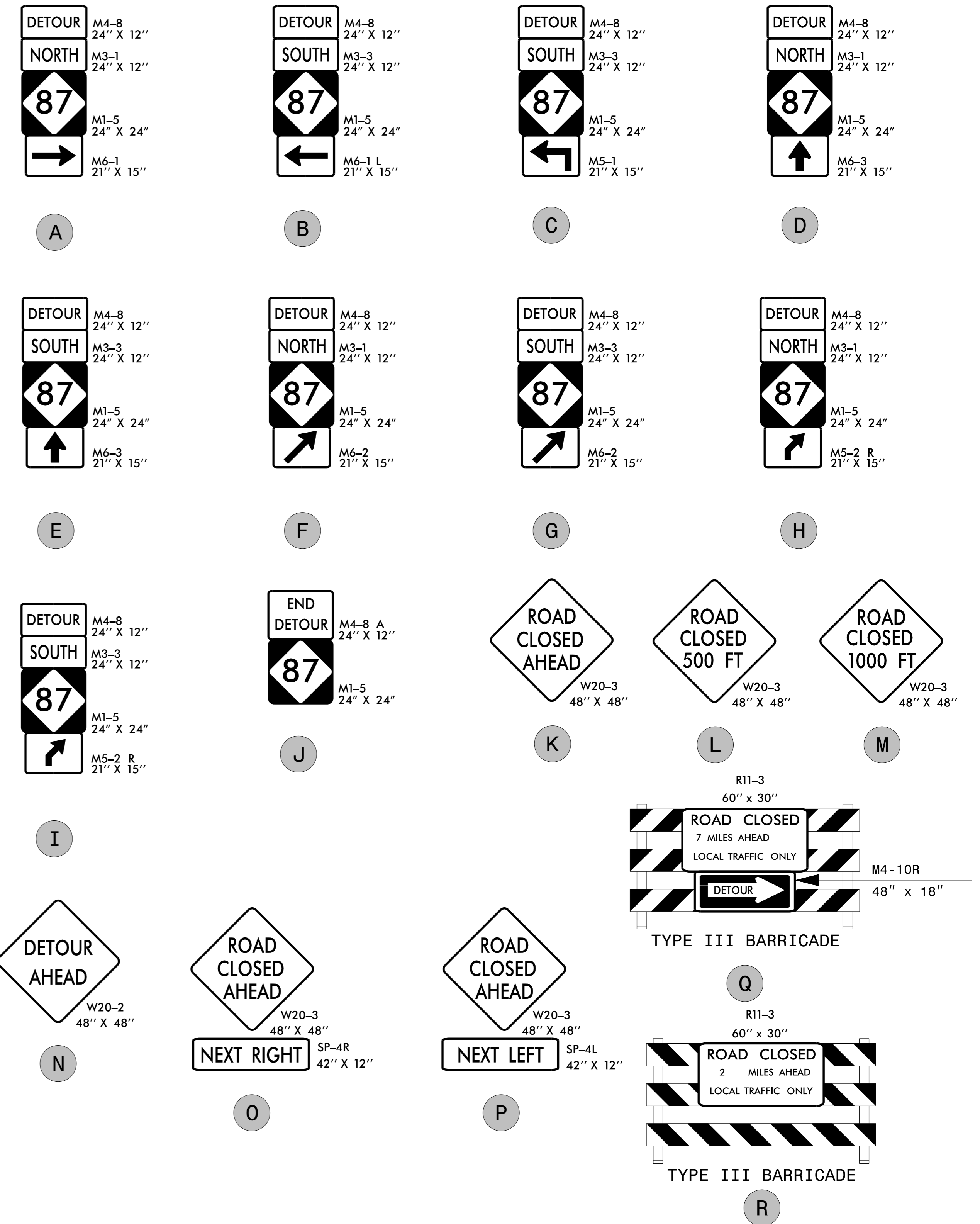
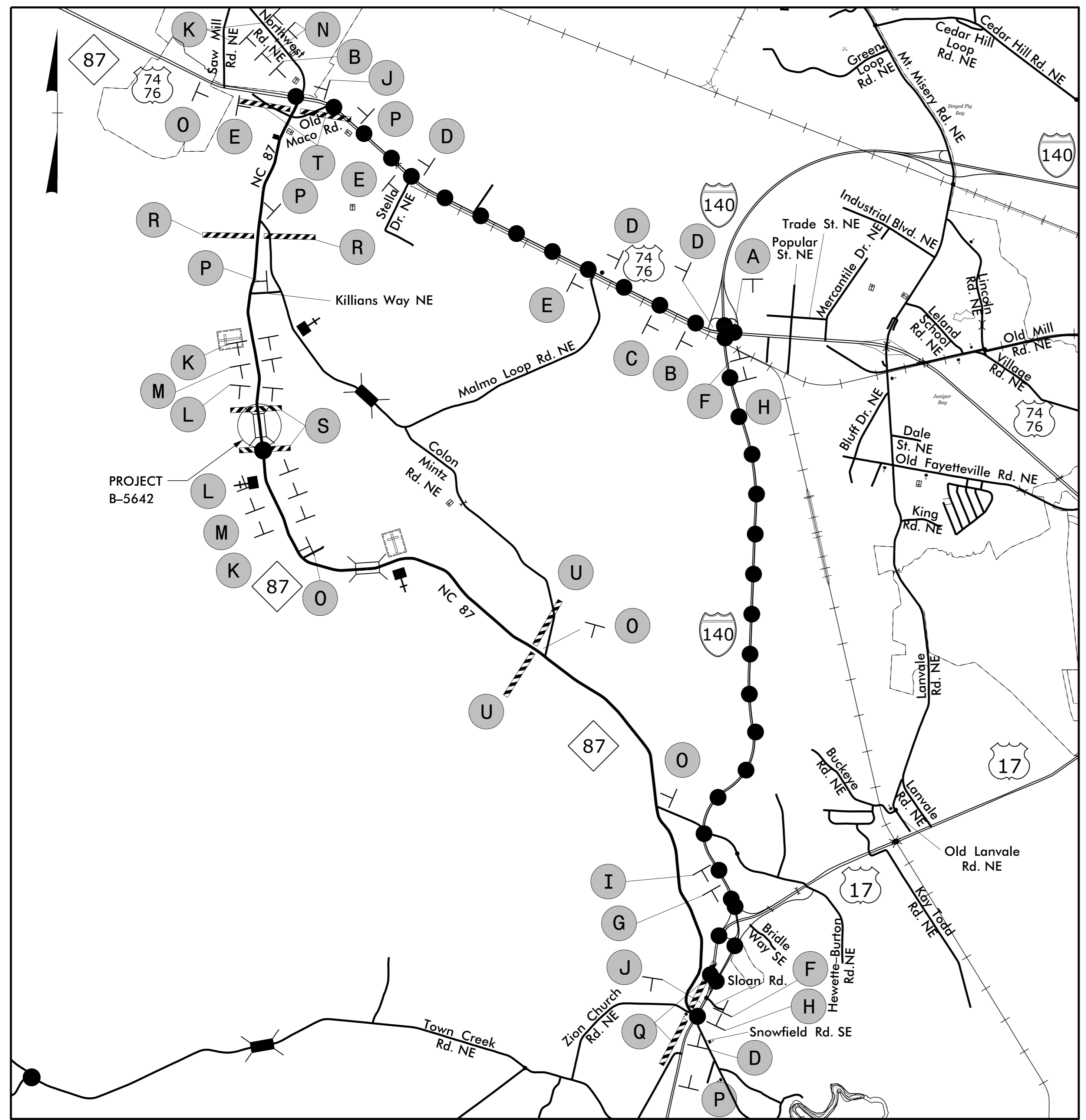

2/3/2021
 pw:\csm\smith-az02-pw.bentley.com\FW_PLN\Documents\17240\235077\0 Transportation\04 Client Folder Structure\B-5642\TrafficControl\CP\B5642_TMP_IC02.dgn
 User:GANTMN

CDM Smith
 CDM Smith Inc.
 5400 Glenwood Avenue
 Suite 400
 Raleigh, NC 27612-3228
 NC COA No. F-1255

APPROVED: *Adam M. Conrad, P.E., PMP*
 DATE: 4/6/2021
 SEAL
 NORTH CAROLINA PROFESSIONAL ENGINEER
 SEAL
 043767
 ADAM M. CONRAD

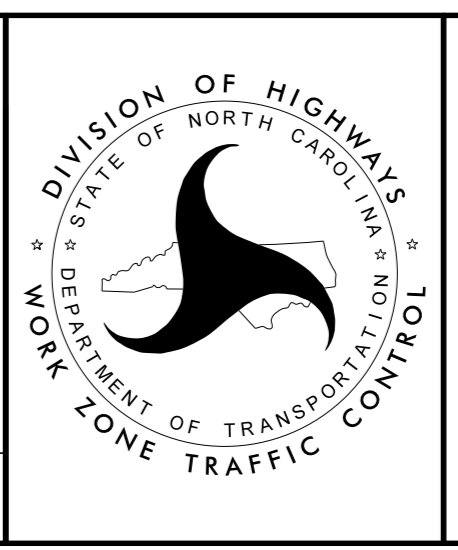

OFF-SITE DETOUR
 DOCUMENT NOT CONSIDERED FINAL
 UNLESS ALL SIGNATURES COMPLETED