

2 Phase Fully Acutated D03-12 Leland US 17 (Ocean Hwy)-Leland Superstreet

NOTES

1. Refer to "Roadway Standard Drawings NCDOT" dated January 2018 and "Standard Specifications for Roads and Structures" dated January 2018.
2. Do not program signal for late night flashing operation unless otherwise directed by the Engineer.
3. Set all detector units to presence mode.
4. Maximum times shown in timing chart are for free-run operation only. Coordinated signal system timing values supersede these values.
5. Closed loop system data: Controller Asset #:1002.

SIGNAL FACE	PHASE	
	Ø 3 + 8	Ø 6 FLASH
31, 32	G R R	
33	← -R -R	
61, 62	R G Y	
81, 82	← R R	

LOOP	SIZE (FT)	DISTANCE FROM STOPBAR (FT)	TURNS	NEW LOOP	DETECTOR PROGRAMMING						
					PHASE	CALLING	EXTENSION	STRETCH TIME	DELAY TIME	SYSTEM LOOP	NEW CARD
3A	6X40	0	2-4-2	Y	3	Y	Y	-	-	-	-
6A/S41	6X6	420	5	Y	6	Y	Y	-	-	-	Y
6B/S42	6X6	420	5	Y	6	Y	Y	-	-	-	Y
8A	6X40	0	2-4-2	Y	8	Y	Y	-	-	15	-
S34	6X6	75	4	Y	-	Y	Y	-	-	-	Y
S40	6X6	75	4	Y	-	Y	Y	-	-	-	Y

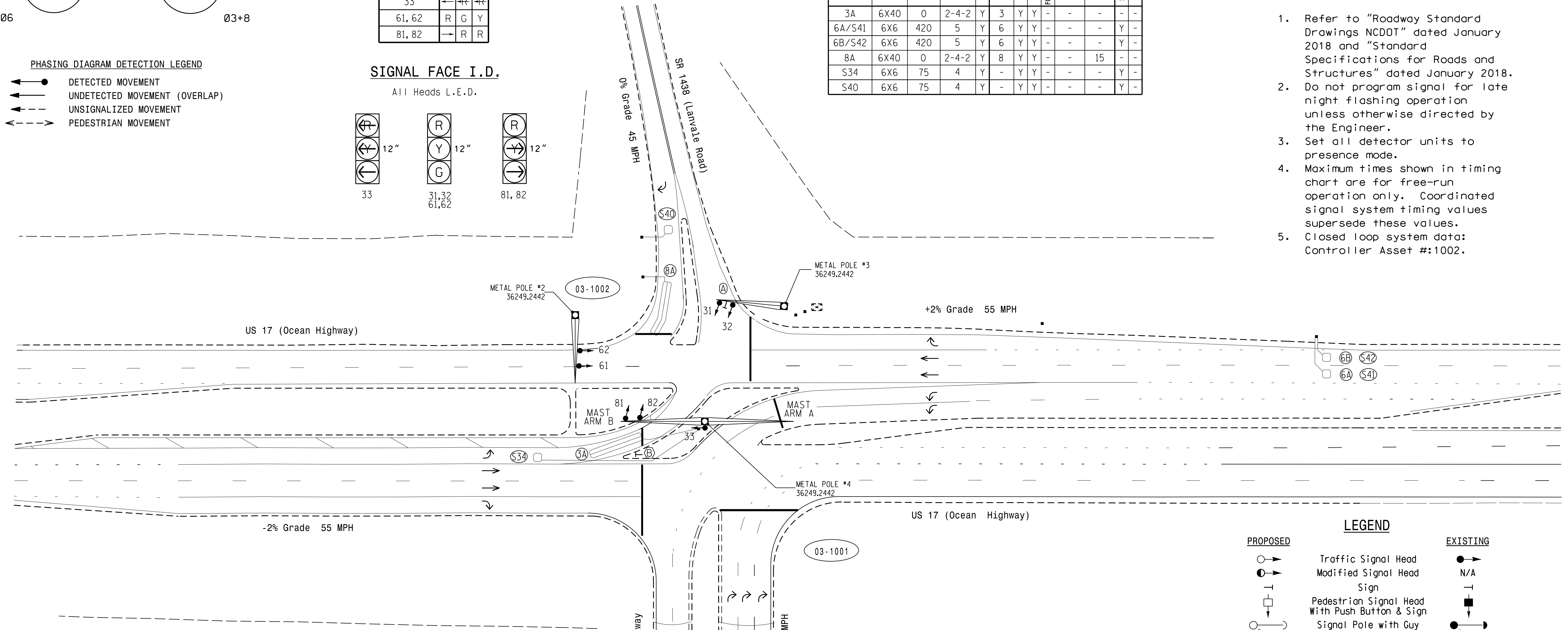
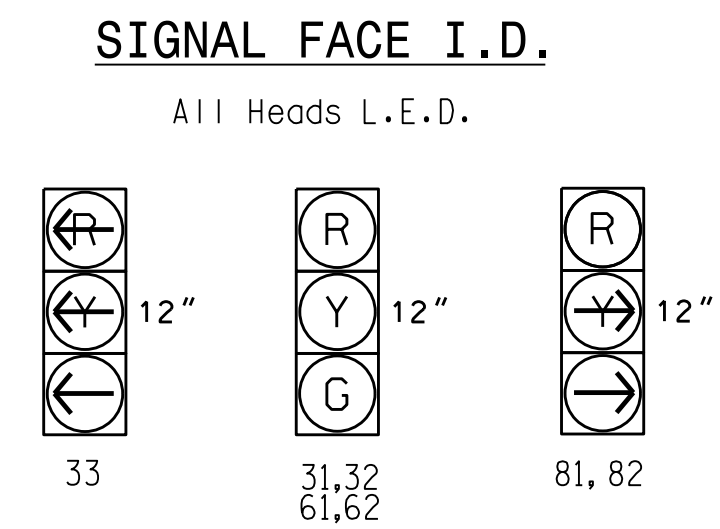
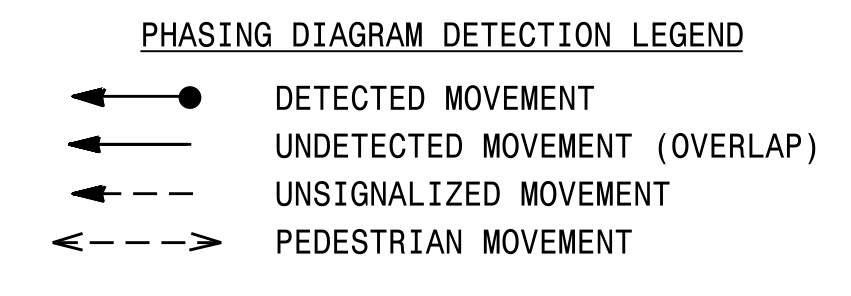
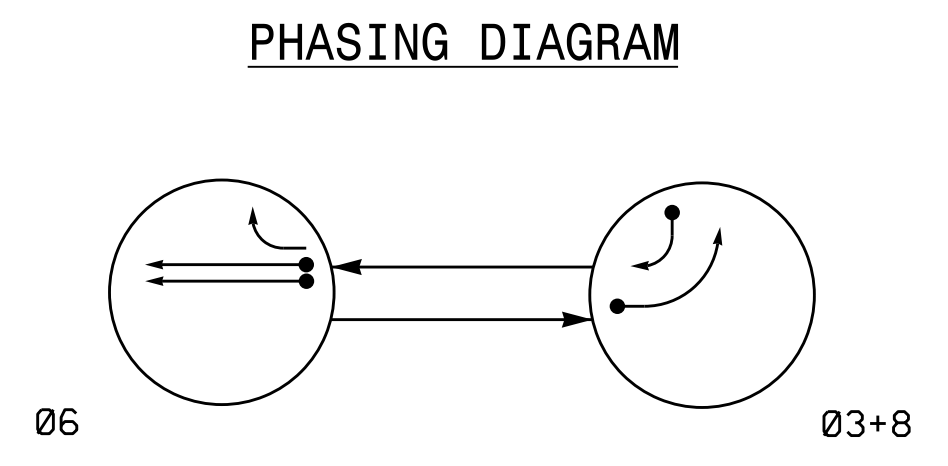

FEATURE	PHASE		
	3	6	8
Min Green 1 *	7	14	7
Extension 1 *	2.0	6.0	2.0
Max Green 1 *	30	90	30
Yellow Clearance	3.0	5.0	3.0
Red Clearance	3.7	1.2	3.7
Walk 1 *	-	-	-
Don't Walk 1	-	-	-
Seconds Per Actuation *	-	1.5	-
Max Variable Initial *	-	46	-
Time Before Reduction *	-	15	-
Time To Reduce *	-	50	-
Minimum Gap	-	3.4	-
Recall Mode	-	MIN RECALL	-
Vehicle Call Memory	-	YELLOW	-
Dual Entry	ON	-	ON
Simultaneous Gap	ON	ON	ON

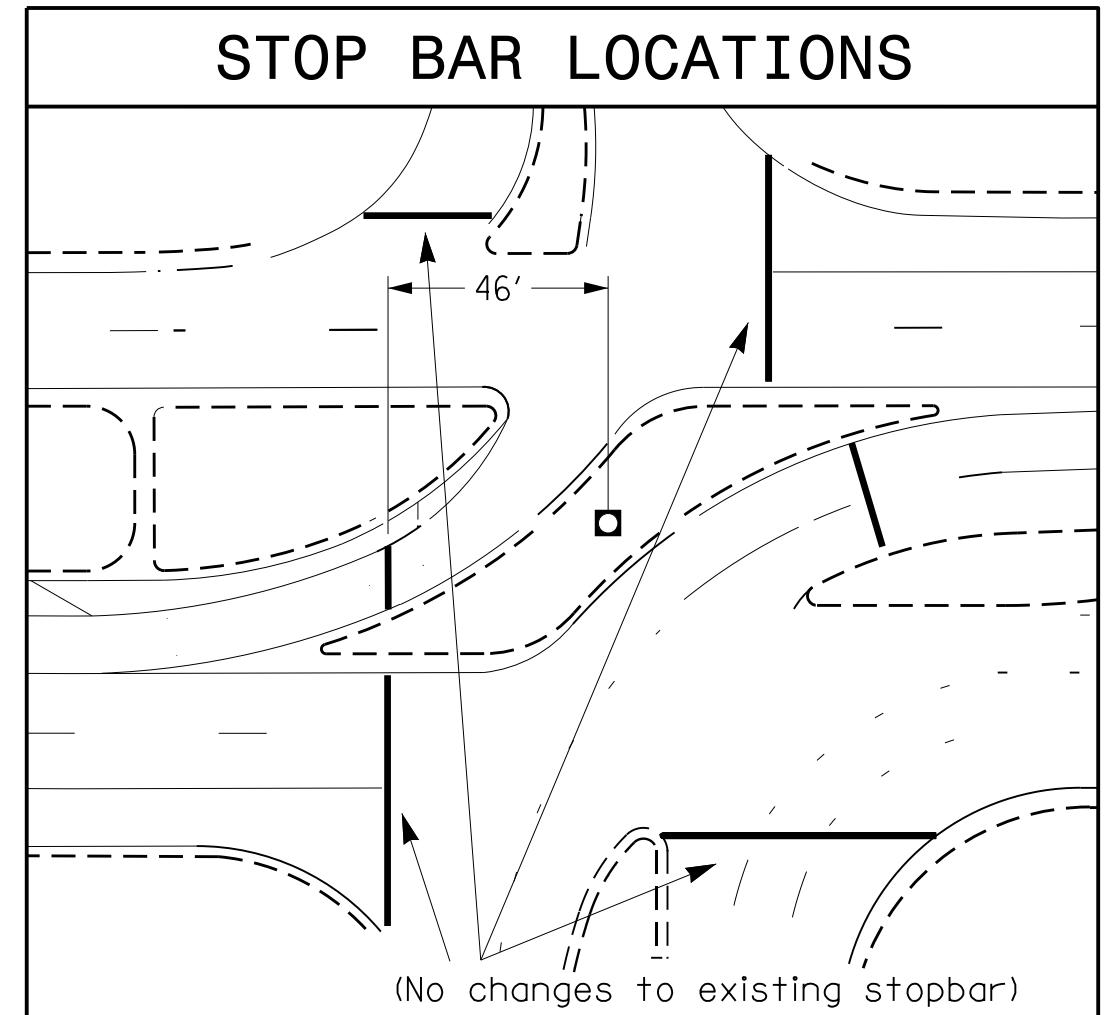

LEGEND

PROPOSED	EXISTING
	N/A
	N/A
	N/A
	N/A
	N/A
	N/A
	N/A
	N/A
	N/A
	N/A
	N/A
	N/A
	N/A
	N/A

* These values may be field adjusted. Do not adjust Min Green and Extension times for phase 6 lower than what is shown. Min Green for all other phases should not be lower than 4 seconds.

Signal Upgrade

US 17 (Ocean Highway) at SR 1438 (Lanvale Road)

Division 3 Brunswick County Leland

PLAN DATE: October 2021 REVISIONS: X. Han REVIEWED BY: MEL

PREPARED BY: X. Han REVIEWED BY: MEL

SCALE: 1" = 40'

DOCUMENT NOT CONSIDERED FINAL UNLESS ALL SIGNATURES COMPLETED

SEAL: NORTH CAROLINA PROFESSIONAL ENGINEER 042608

MECHAN E. LESBINE

DATE: 10/27/2021

SIG. INVENTORY NO. 03-1002