

DEFAULT PHASING DIAGRAM

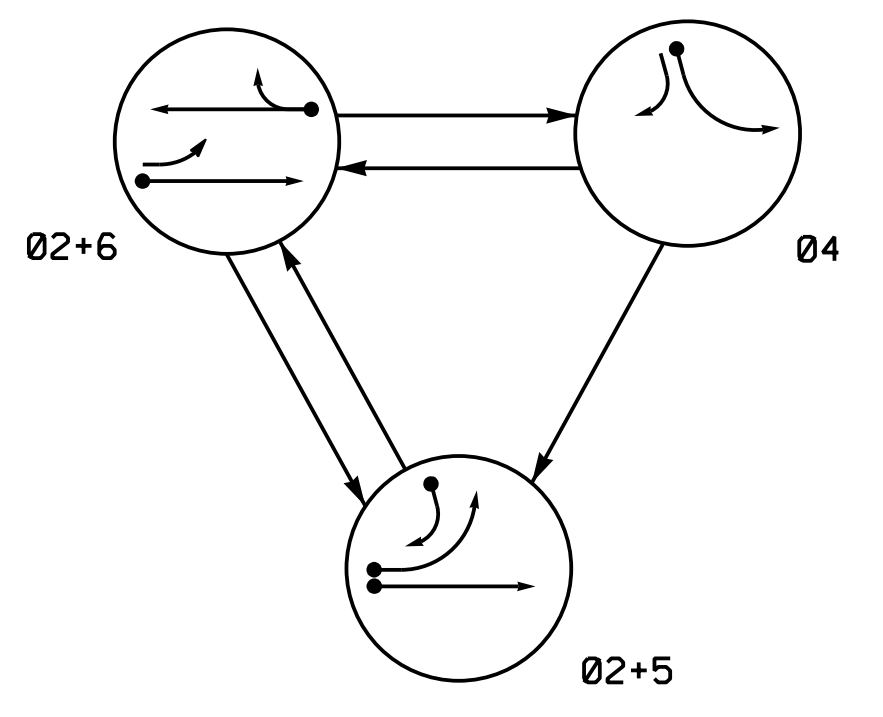

ALTERNATE PHASING DIAGRAM

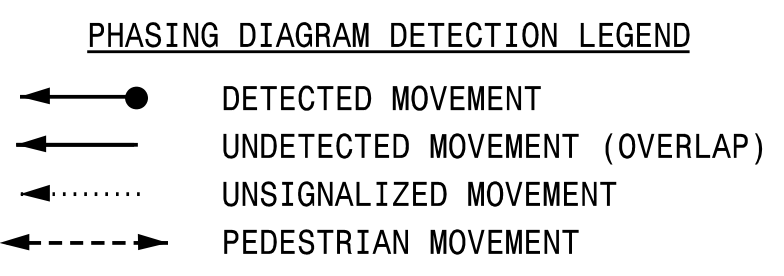
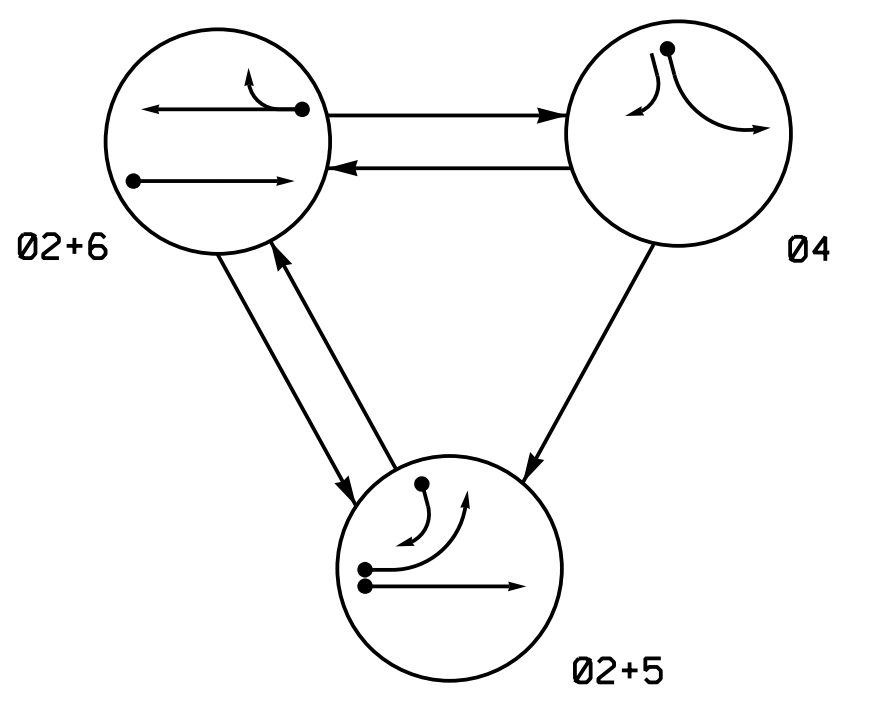

DEFAULT PHASING TABLE OF OPERATION

SIGNAL FACE	PHASE			
	02+5	02+6	04	F
21,22	G	G	R	Y
41,42	R	R	G	R
43	-	R	-	R
51	-	-	-	-
61,62	R	G	R	Y

ALTERNATE PHASING TABLE OF OPERATION

SIGNAL FACE	PHASE			
	02+5	02+6	04	F
21,22	G	G	R	Y
41,42	R	R	G	R
43	-	R	-	R
51	-	-	-	-
61,62	R	G	R	Y

OASIS 2070 LOOP & DETECTOR INSTALLATION CHART

LOOP	SIZE (FT)	DISTANCE FROM STOPBAR (FT)	TURNS	NEW LOOP	DETECTOR PROGRAMMING					SYSTEM LOOP	NEW CARD	
					PHASE	CALLING	EXTENSION	FULL TIME DELAY	STRETCH TIME			DELAY TIME
2A	6X6	300	*	*	2	Y	Y	-	-	-	-	Y
4A	6X40	0	*	*	4	Y	Y	-	-	3	-	Y
5A	6X40	0	*	*	5	Y	Y	-	-	***15	-	Y
5B	6X40	0	*	*	**2	Y	Y	-	-	3	-	Y
6A	6X6	300	*	*	6	Y	Y	-	-	-	-	Y

\* Multizone Microwave Detection.  
 \*\* Disable phase 2 call for 5A during alternate phasing operation.  
 \*\*\* Reduce delay to 3 seconds during alternate phasing operation.

SIGNAL FACE I.D.

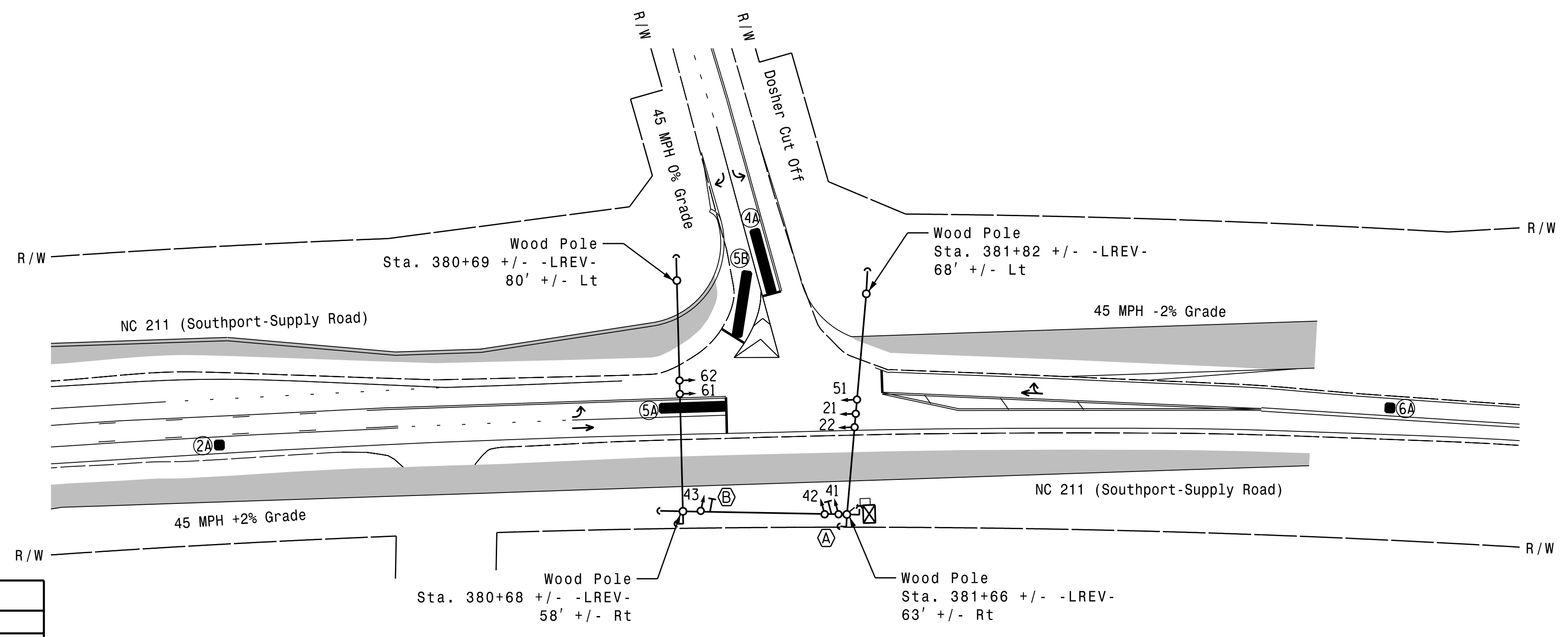
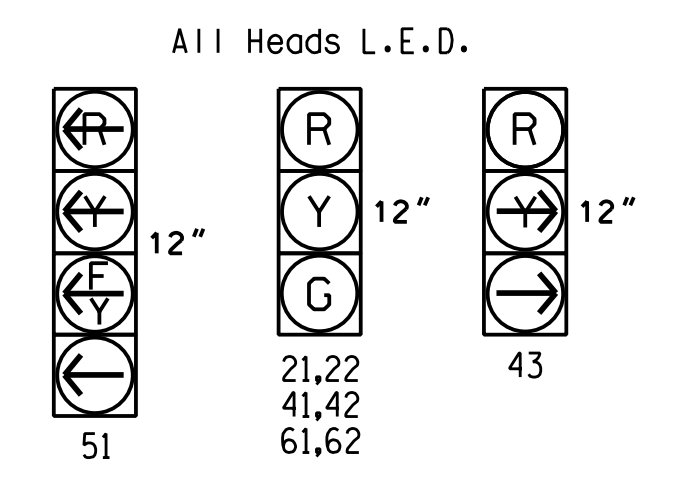

OASIS 2070 TIMING CHART

FEATURE	PHASE			
	2	4	5	6
Min Green 1 *	12	7	7	12
Extension 1 *	6.0	2.0	2.0	6.0
Max Green 1 *	90	30	20	90
Yellow Clearance	4.7	3.0	3.0	4.7
Red Clearance	1.5	2.9	1.9	1.5
Red Revert	2.0	2.0	2.0	2.0
Walk 1 *	-	-	-	-
Don't Walk 1	-	-	-	-
Seconds Per Actuation *	2.5	-	-	2.5
Max Variable Initial *	34	-	-	34
Time Before Reduction *	20	-	-	20
Time To Reduce *	30	-	-	30
Minimum Gap	3.0	-	-	3.0
Recall Mode	MIN RECALL	-	-	MIN RECALL
Vehicle Call Memory	YELLOW	-	-	YELLOW
Dual Entry	-	-	-	-
Simultaneous Gap	ON	ON	ON	ON

\* These values may be field adjusted. Do not adjust Min Green and Extension times for phases 2 and 6 lower than what is shown. Min Green for all other phases should not be lower than 4 seconds.

3 Phase Fully Actuated (NC 133 Closed Loop System)

NOTES

- Refer to "Roadway Standard Drawings NCDOT" dated January 2018 and "Standard Specifications for Roads and Structures" dated January 2018.
- Do not program signal for late night flashing operation unless otherwise directed by the Engineer.
- Phase 5 may be lagged.
- Set all detector units to presence mode.
- Locate new cabinet so as not to obstruct sight distance of vehicles turning right on red.
- Incorporate Microwave Detection system for vehicle detection.
- Provide the Engineer with the Manufacturer's approved Microwave Detection locations and mounting heights to obtain detection zones as shown.
- Maximum times shown in timing chart are for free-run operation only. Coordinated signal system timing values supersede these values.
- Closed loop system data: Controller Asset #: 0267.

LEGEND

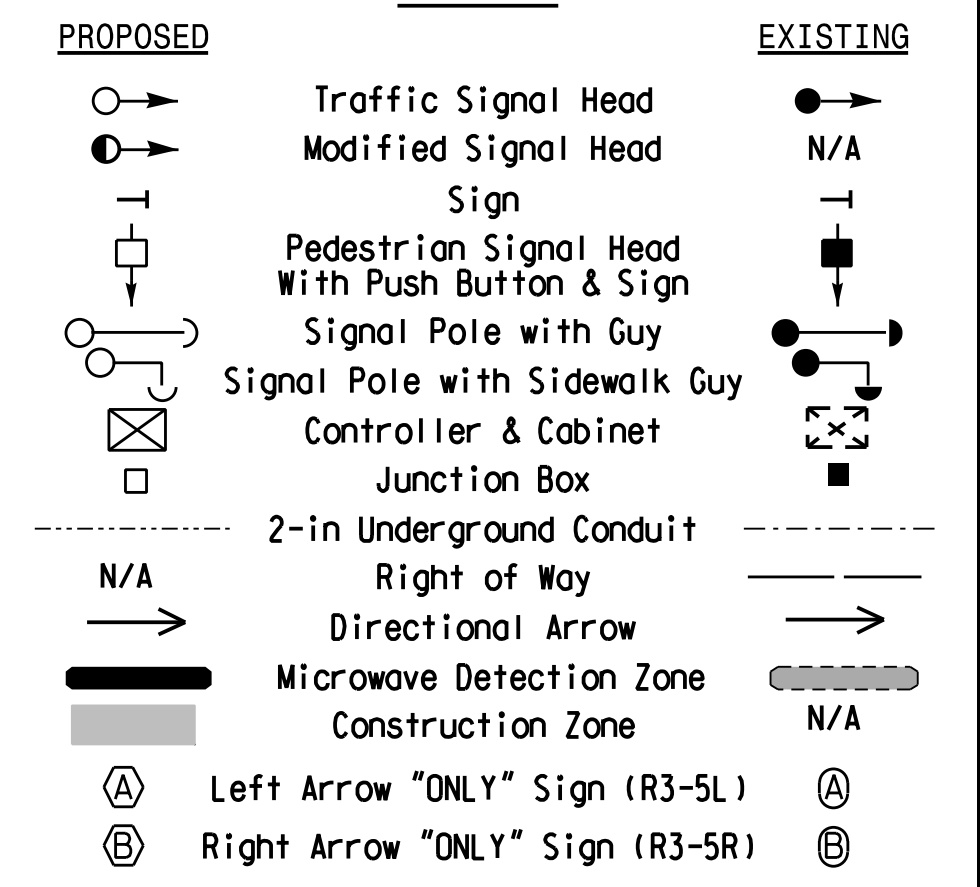

Signal Upgrade  
 Temporary Design 1  
 Construction Phase 1

DOCUMENT NOT CONSIDERED FINAL UNLESS ALL SIGNATURES COMPLETED

Prepared for: **TRANSPORTATION MOBILITY AND SAFETY DIVISION**  
 STATE OF NORTH CAROLINA  
 DEPARTMENT OF TRANSPORTATION  
 Signal Design Section

750 N. Greenfield Pkwy, Garner, NC 27529

NC 211 (Southport-Supply Road) at Doshier Cut Off

Division 03 Brunswick Co. Southport

PLAN DATE: June 2017 REVIEWED BY: A.D. Klinksiek

PREPARED BY: A.H. Thornburg REVIEWED BY: N.R. Simmons

Signature: *Notasha Simmons* DATE: 9/10/2021

SIG. INVENTORY NO. 03-0267T1

**HNTB** HNTB NORTH CAROLINA, P.C.  
 343 E. Six Forks Road, Suite 200  
 Raleigh, North Carolina 27609  
 NC License No: C-1554  
 (919) 546-8997

