

DEFAULT PHASING DIAGRAM

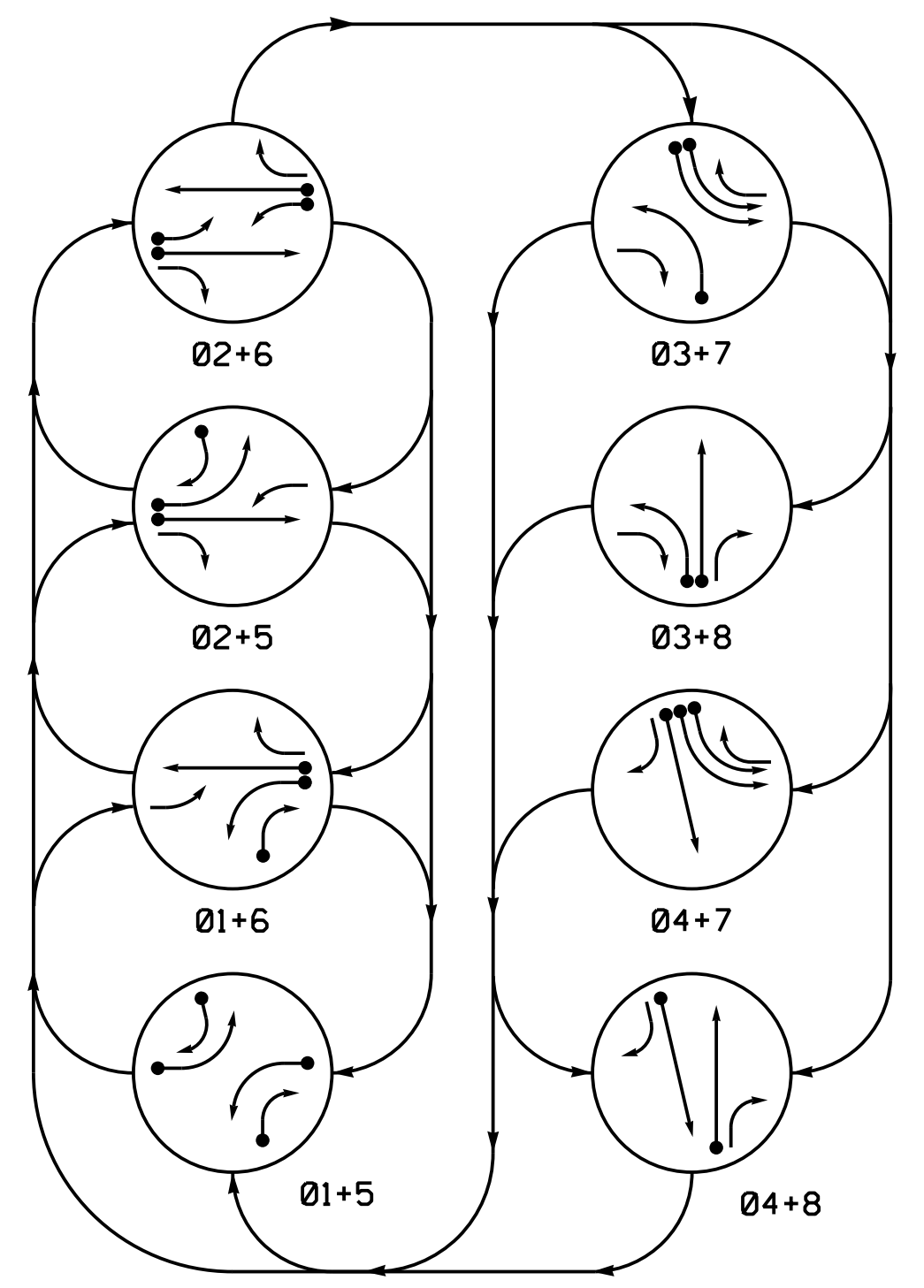

PHASING DIAGRAM DETECTION LEGEND

- DETECTED MOVEMENT
- UNDETECTED MOVEMENT (OVERLAP)
- UNSIGNALIZED MOVEMENT
- PEDESTRIAN MOVEMENT

DEFAULT PHASING TABLE OF OPERATION

SIGNAL FACE	PHASE							
	01+5	01+6	02+5	02+6	03+7	03+8	04+7	04+8
11	-	-	F	F	R	R	R	Y
21	R	R	G	G	R	R	R	Y
22	R	R	G	G	R	R	R	Y
31	R	R	R	R	-	-	-	R
41	R	R	R	R	R	G	G	R
42	R	R	R	R	R	G	G	R
51	-	-	F	F	R	R	R	Y
61	R	G	R	G	R	R	R	Y
62	R	G	R	G	R	R	R	Y
71,72	R	R	R	R	R	-	-	R
81	R	R	R	R	R	G	G	R
82	R	R	R	R	G	R	G	R

SIGNAL FACE I.D.

All Heads L.E.D.

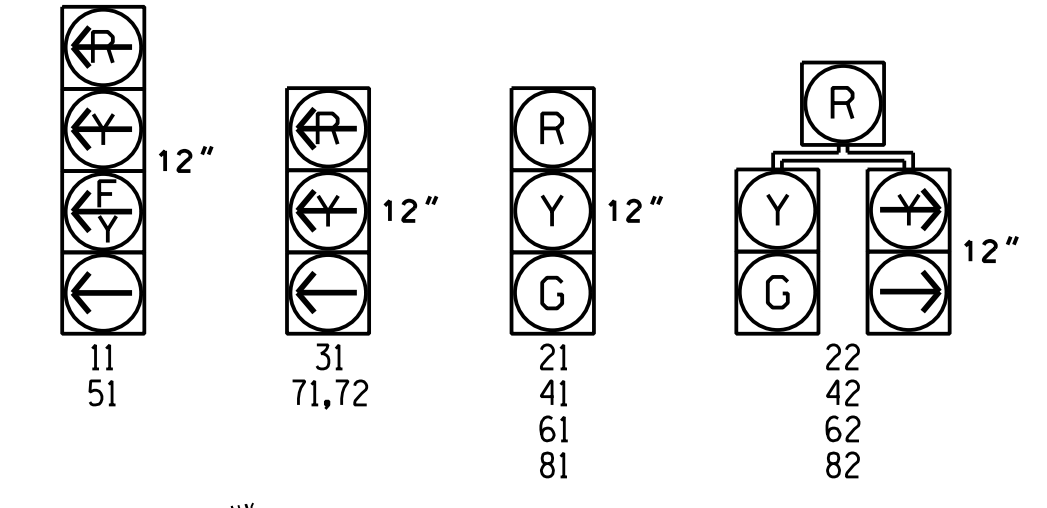

OASIS 2070 LOOP & DETECTOR INSTALLATION CHART

LOOP	SIZE (FT)	DISTANCE FROM STOPBAR (FT)	TURNS	NEW LOOP	DETECTOR PROGRAMMING				SYSTEM LOOP	NEW CARD	
					PHASE	CALLING	EXTENSION	STRETCH TIME			DELAY TIME
1A	6X40	0	*	*	1	Y	Y	-	-	***15	-
1B	6X40	0	*	*	**6	Y	Y	-	-	3	-
2A	6X6	420	*	*	1	Y	Y	-	-	15	-
3A	6X40	0	*	*	3	Y	Y	-	-	3	-
4A	6X6	300	*	*	4	-	Y	-	-	-	-
4B	6X40	0	*	*	4	Y	Y	2.0	5	-	-
5A	6X40	0	*	*	5	Y	Y	-	-	***15	-
5B	6X40	0	*	*	5	Y	Y	-	-	15	-
6A	6X6	420	*	*	6	Y	Y	-	-	-	-
7A	6X40	0	*	*	7	Y	Y	-	-	3	-
7B	6X40	0	*	*	7	Y	Y	-	-	-	-
8A	6X6	420	*	*	8	-	Y	-	-	-	-
8B	6X40	0	*	*	8	Y	Y	2.0	5	-	-

- * Multizone Microwave Detection.
- ** Disable phase 2 and 6 call for 1A and 5A during alternate phasing operation.
- *** Reduce delay to 3 seconds during alternate phasing operation.

8 Phase Fully Actuated Isolated

NOTES

- Refer to "Roadway Standard Drawings NCDOT" dated January 2018 and "Standard Specifications for Roads and Structures" dated January 2018.
- Do not program signal for late night flashing operation unless otherwise directed by the Engineer.
- Phase 1 and/or phase 5 may be lagged.
- Phase 3 and/or phase 7 may be lagged.
- Reposition existing signal heads numbered 11,21,22,31,41,42,51,61, 62,71,72,81,and 82.
- Set all detector units to presence mode.
- The Division Traffic Engineer will determine the hours of use for each phasing plan.
- Incorporate Microwave Detection system for vehicle detection.
- Provide the Engineer with the Manufacturer's approved Microwave Detection locations and mounting heights to obtain detection zones as shown.

LEGEND

- | PROPOSED | EXISTING |
|----------|----------|
| | |
| | |
| | |
| | |
| | |
| | |
| | |
| | |
| | |
| | |
| | |
| | |
| | |
| | |
| | |
| | |

OASIS 2070 TIMING CHART

FEATURE	PHASE							
	1	2	3	4	5	6	7	8
Min Green 1 *	7	14	7	7	7	14	7	7
Extension 1 *	2.0	6.0	2.0	6.0	2.0	6.0	2.0	6.0
Max Green 1 *	20	90	20	30	20	90	20	30
Yellow Clearance	3.0	5.2	3.0	4.5	3.0	5.2	3.0	5.2
Red Clearance	3.3	1.4	2.9	1.1	3.3	1.4	3.3	1.2
Red Revert	2.0	2.0	2.0	2.0	2.0	2.0	2.0	2.0
Walk 1 *	-	-	-	-	-	-	-	-
Don't Walk 1	-	-	-	-	-	-	-	-
Seconds Per Actuation *	-	2.5	-	-	-	2.5	-	-
Max Variable Initial *	-	46	-	-	-	46	-	-
Time Before Reduction *	-	15	-	0	-	15	-	0
Time To Reduce *	-	45	-	15	-	45	-	15
Minimum Gap	-	3.4	-	3.0	-	3.4	-	3.4
Recall Mode	-	MIN RECALL	-	-	-	MIN RECALL	-	-
Vehicle Call Memory	-	YELLOW	-	-	-	YELLOW	-	-
Dual Entry	-	-	-	-	-	-	-	-
Simultaneous Gap	ON	ON	ON	ON	ON	ON	ON	ON

* These values may be field adjusted. Do not adjust Min Green and Extension times for phases 2 and 6 lower than what is shown. Min Green for all other phases should not be lower than 4 seconds.

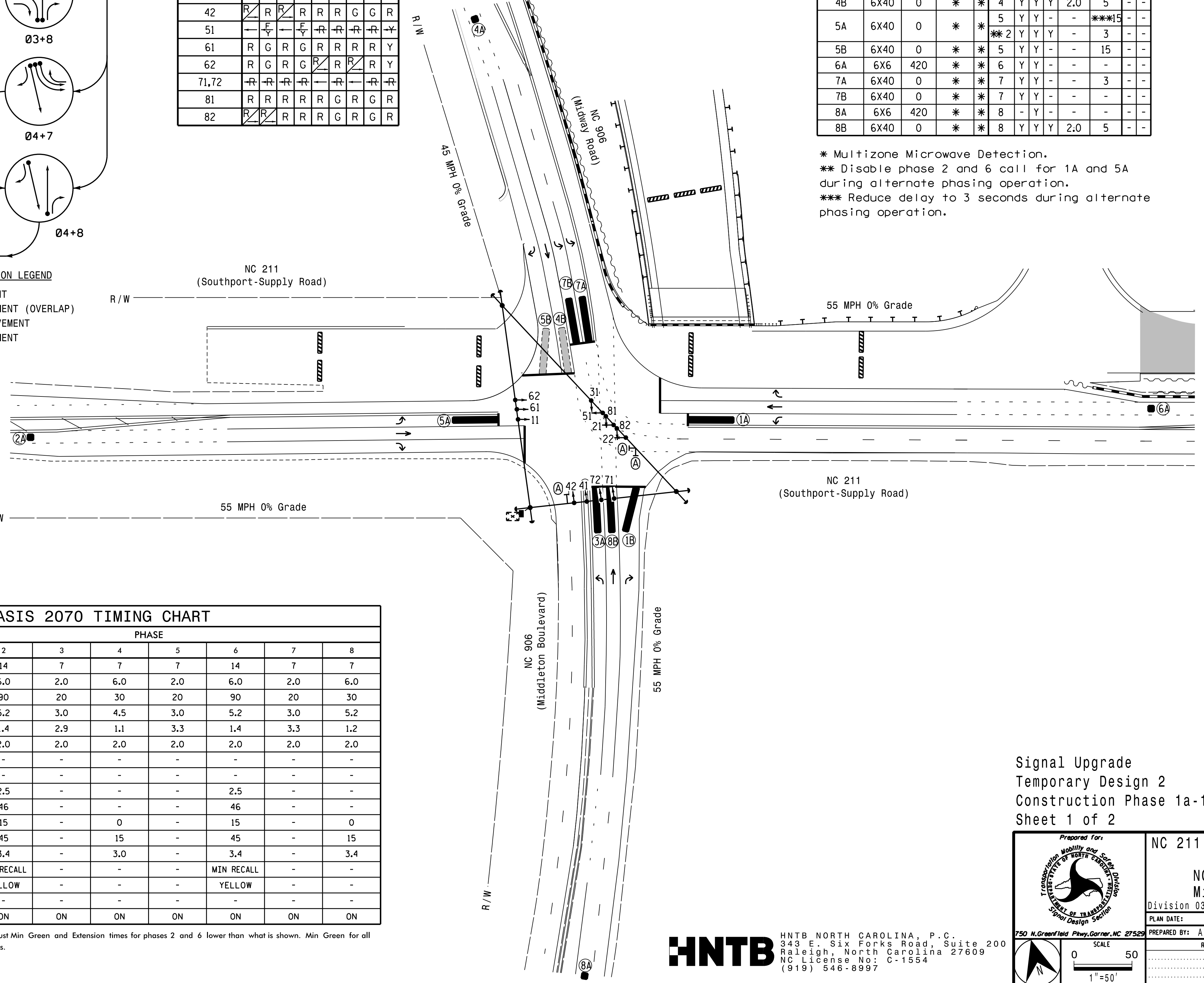

Signal Upgrade
 Temporary Design 2
 Construction Phase 1a-1b
 Sheet 1 of 2

DOCUMENT NOT CONSIDERED FINAL UNLESS ALL SIGNATURES COMPLETED

	Prepared for: TRANSPORTATION MOBILITY AND SAFETY DIVISION NORTH CAROLINA DEPARTMENT OF TRANSPORTATION SIGNAL DESIGN SECTION	NC 211 (Southport-Supply Road) at NC 906 (Midway Road/ Middleton Boulevard)	SEAL
	750 N. Greenfield Pkwy, Corner, NC 27526 HNTB NORTH CAROLINA, P.C. 343 E. Six Forks Road, Suite 200 Raleigh, North Carolina 27609 NC License No: C-1554 (919) 546-8997	Division 03 Brunswick Co. Southport PLAN DATE: June 2017 REVIEWED BY: A.D. Klinskiak PREPARED BY: A.H. Thornburg REVIEWED BY: N.R. Simmons	REVIEWED BY: N.R. Simmons DATE: 9/10/2021 SIGNATURE: _____ DATE: _____ SIG. INVENTORY NO. 03-090172