

**This electronic collection of documents is provided  
for the convenience of the user  
and is Not a Certified Document –**

**The documents contained herein were originally issued  
and sealed by the individuals whose names and license  
numbers appear on each page, on the dates appearing  
with their signature on that page.**

**This file or an individual page  
shall not be considered a certified document.**



6/23/16



PROJ. REFERENCE NO.	SHEET NO.
17BP.2.R.92	X-1

Approximate quantities only. Clearing and Grubbing, Unclassified Excavation, Fine Grading, and Removal of Existing Asphalt Pavement will be paid for at the contract lump sum price for "Grading".

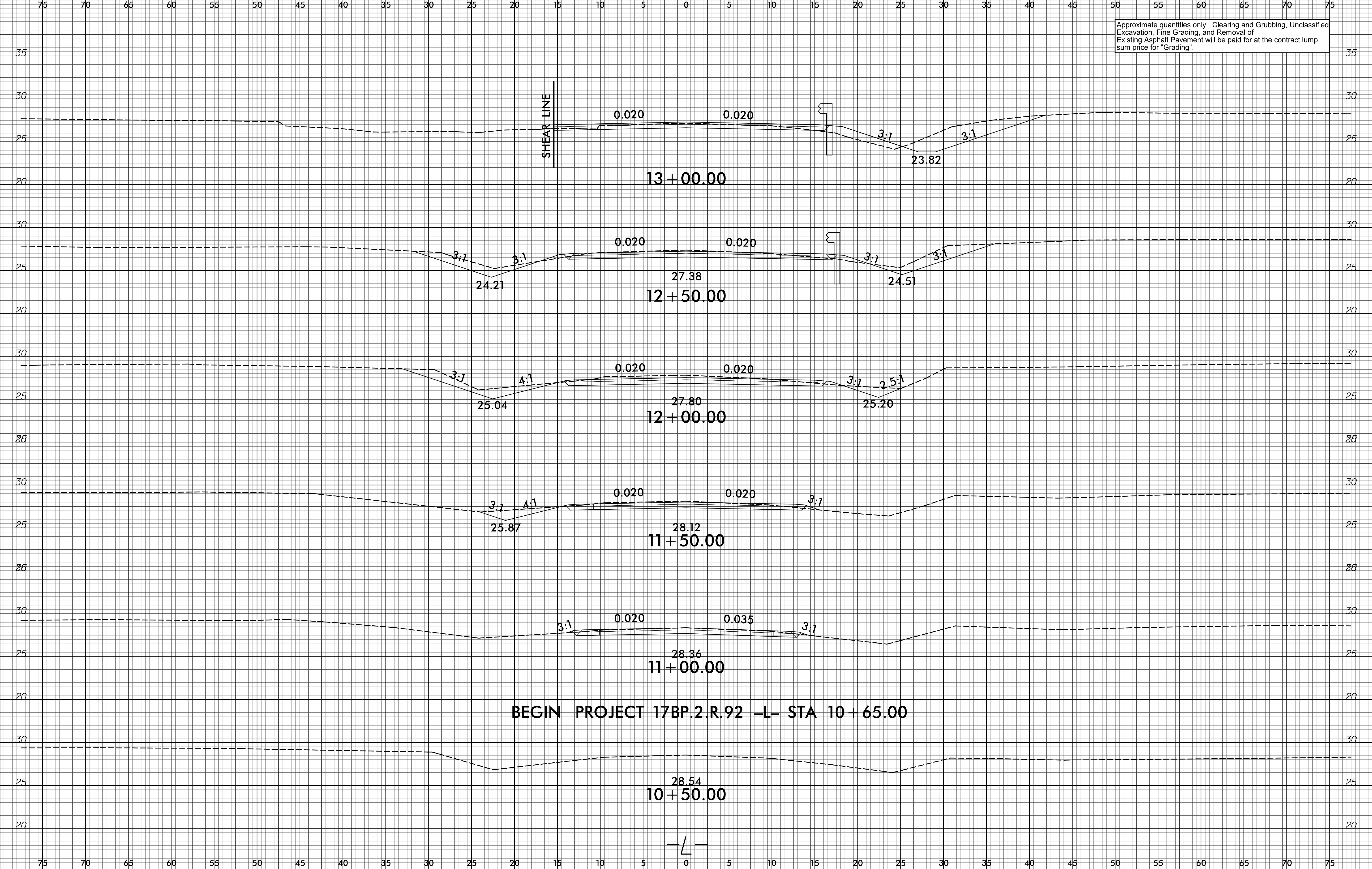

2/14/2019  
 X:\NCDD\B-4788\Roadway\CorridorModeling\B4788.Rdy\_xpl.dgn  
 User:rlower

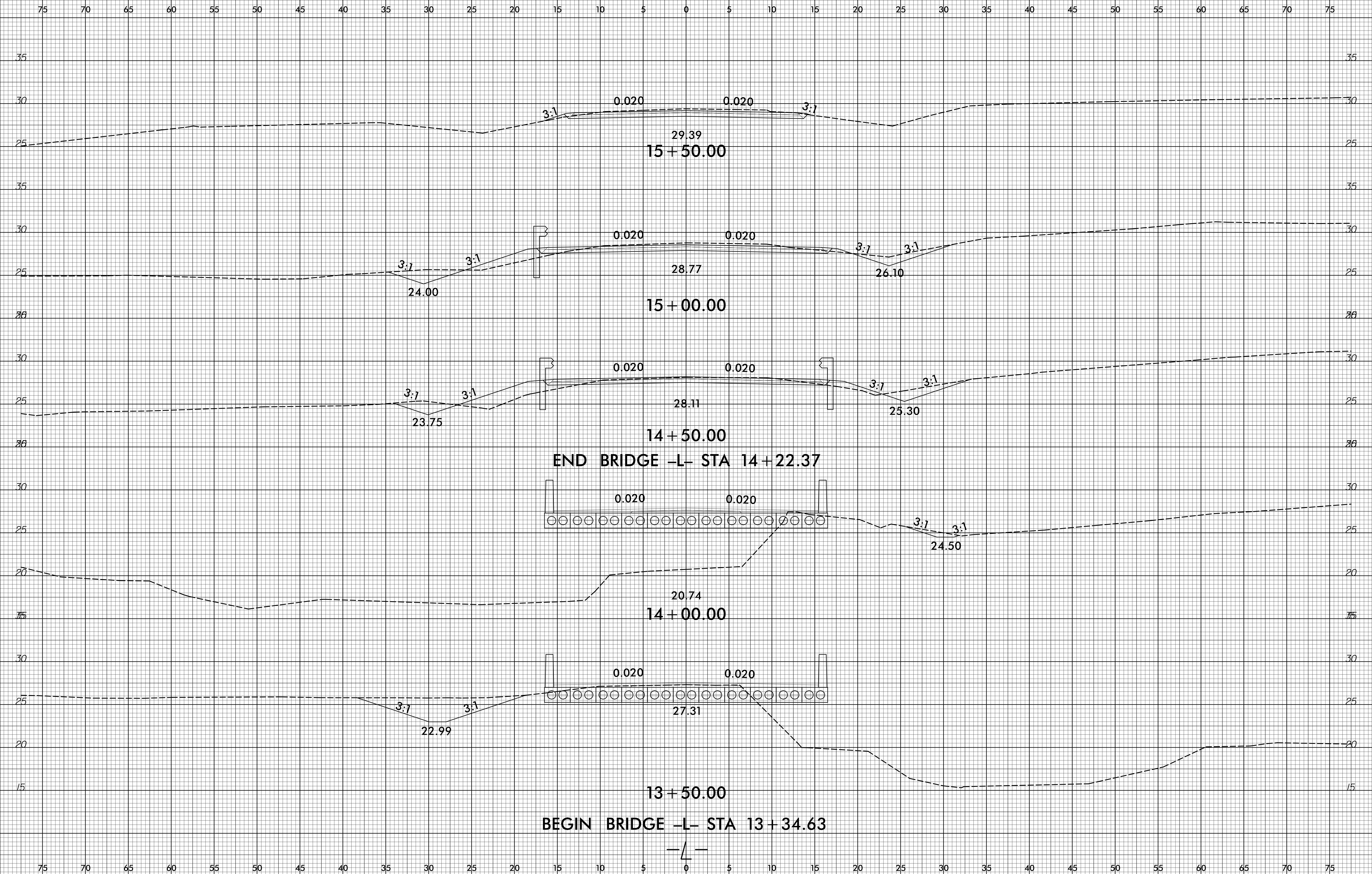



75 70 65 60 55 50 45 40 35 30 25 20 15 10 5 0 5 10 15 20 25 30 35 40 45 50 55 60 65 70 75

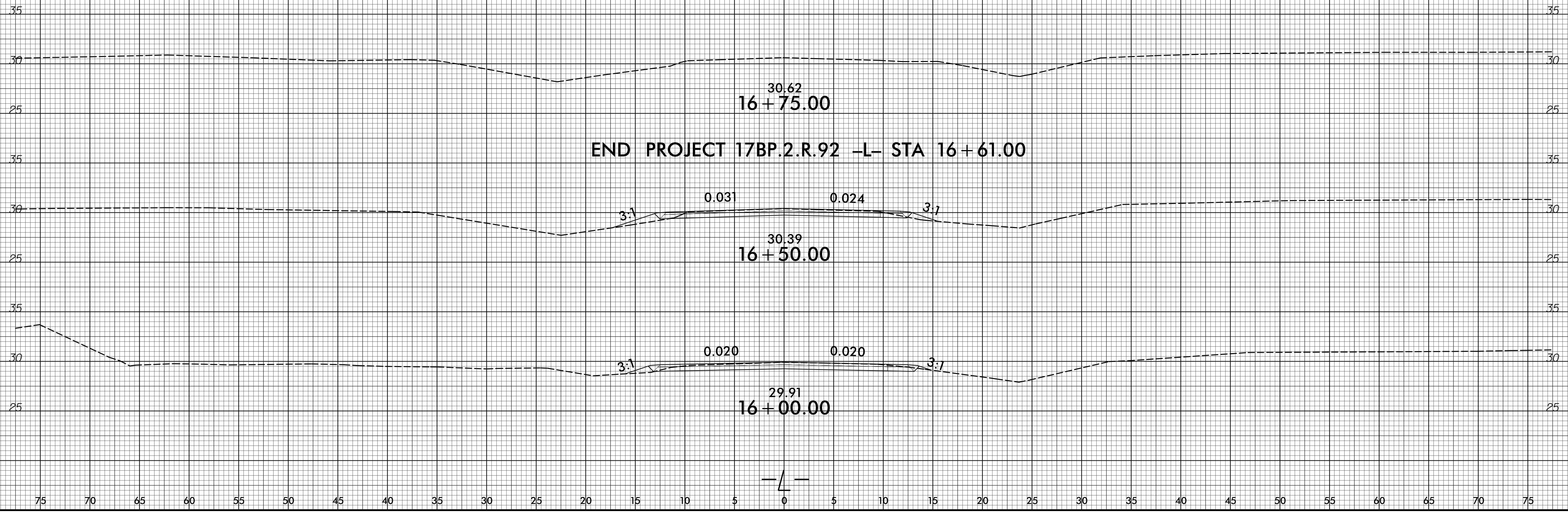

75 70 65 60 55 50 45 40 35 30 25 20 15 10 5 0 5 10 15 20 25 30 35 40 45 50 55 60 65 70 75

6/23/16



PROJ. REFERENCE NO.  
17BP.2.R.92

SHEET NO.  
X-4

75 70 65 60 55 50 45 40 35 30 25 20 15 10 5 0 5 10 15 20 25 30 35 40 45 50 55 60 65 70 75

END CONSTRUCTION -DRV- STA 11+00.00

EX. 0.020

28.54  
11+00.00

0.020 0.020

3:1 3:1

27.45

28.61  
10+75.00

27.45

0.020 0.020

3:1 3:1

27.00

28.67  
10+50.00

27.00

0.020 0.020

3:1

25.85  
10+25.00

3:1

25.15

BEGIN CONSTRUCTION -DRV- STA 10+16.42

-DRV-

75 70 65 60 55 50 45 40 35 30 25 20 15 10 5 0 5 10 15 20 25 30 35 40 45 50 55 60 65 70 75

I:\2019\17BP\17BP-4788-Roadway\CorridorModeling\B4788-Rdy\_xpl\_DRV.dgn  
User:rlower