

PHASING DIAGRAM

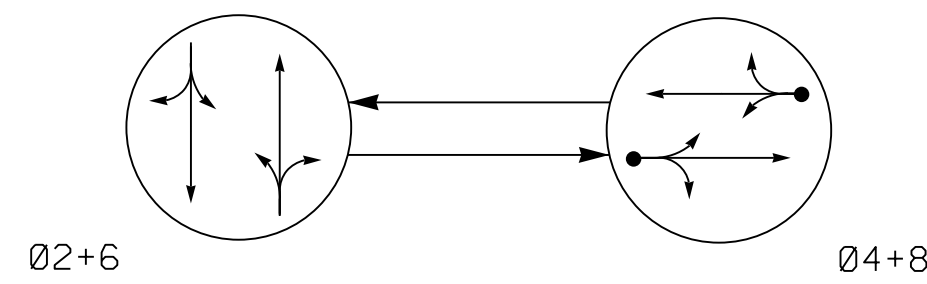

PHASING DIAGRAM DETECTION LEGEND

- ← DETECTED MOVEMENT
- ← UNDETECTED MOVEMENT (OVERLAP)
- ← UNSIGNALIZED MOVEMENT
- ← - - - PEDESTRIAN MOVEMENT

TABLE OF OPERATION

| SIGNAL FACE | PHASE |       |       |
|-------------|-------|-------|-------|
|             | Ø 2+6 | Ø 4+8 | FLASH |
| 21, 22      | G     | R     | Y     |
| 41, 42      | R     | G     | R     |
| 61, 62      | G     | R     | Y     |
| 81, 82      | R     | G     | R     |

SIGNAL FACE I.D.

All Heads L.E.D.

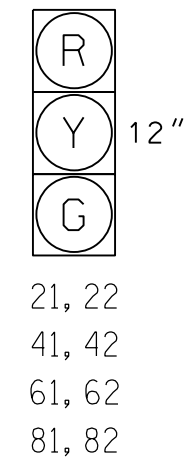

| ASC/3 DETECTOR INSTALLATION CHART |           |                            |       |          |             |         |             |            |                   |      |             |          |
|-----------------------------------|-----------|----------------------------|-------|----------|-------------|---------|-------------|------------|-------------------|------|-------------|----------|
| DETECTOR                          |           |                            |       |          | PROGRAMMING |         |             |            |                   |      |             |          |
| LOOP                              | SIZE (FT) | DISTANCE FROM STOPBAR (FT) | TURNS | NEW LOOP | PHASE       | CALLING | EXTEND TIME | DELAY TIME | USE ADDED INITIAL | TYPE | LOOP SYSTEM | NEW CARD |
| 4A                                | 6X60      | 0                          | 2-4-2 | -        | 4           | Yes     | -           | 10         | -                 | N    | -           | -        |
| 8A                                | 6X60      | 0                          | 2-4-2 | -        | 8           | Yes     | -           | 10         | -                 | N    | -           | -        |
| S22                               | 6X6       | +100                       | EXIST | -        | -           | No      | -           | -          | -                 | N    | X           | -        |

2 Phase Semi-Actuated System # 10605

NOTES

- Refer to "Roadway Standard Drawings NCDOT" dated January 2018 and "Standard Specifications for Roads and Structures" dated January 2018.
- Do not program signal for late night flashing operation unless otherwise directed by the Engineer.
- Set all detector units to presence mode.
- Pavement markings are existing.
- Maximum times shown in timing chart are for free-run operation only. Coordinated signal system timing values

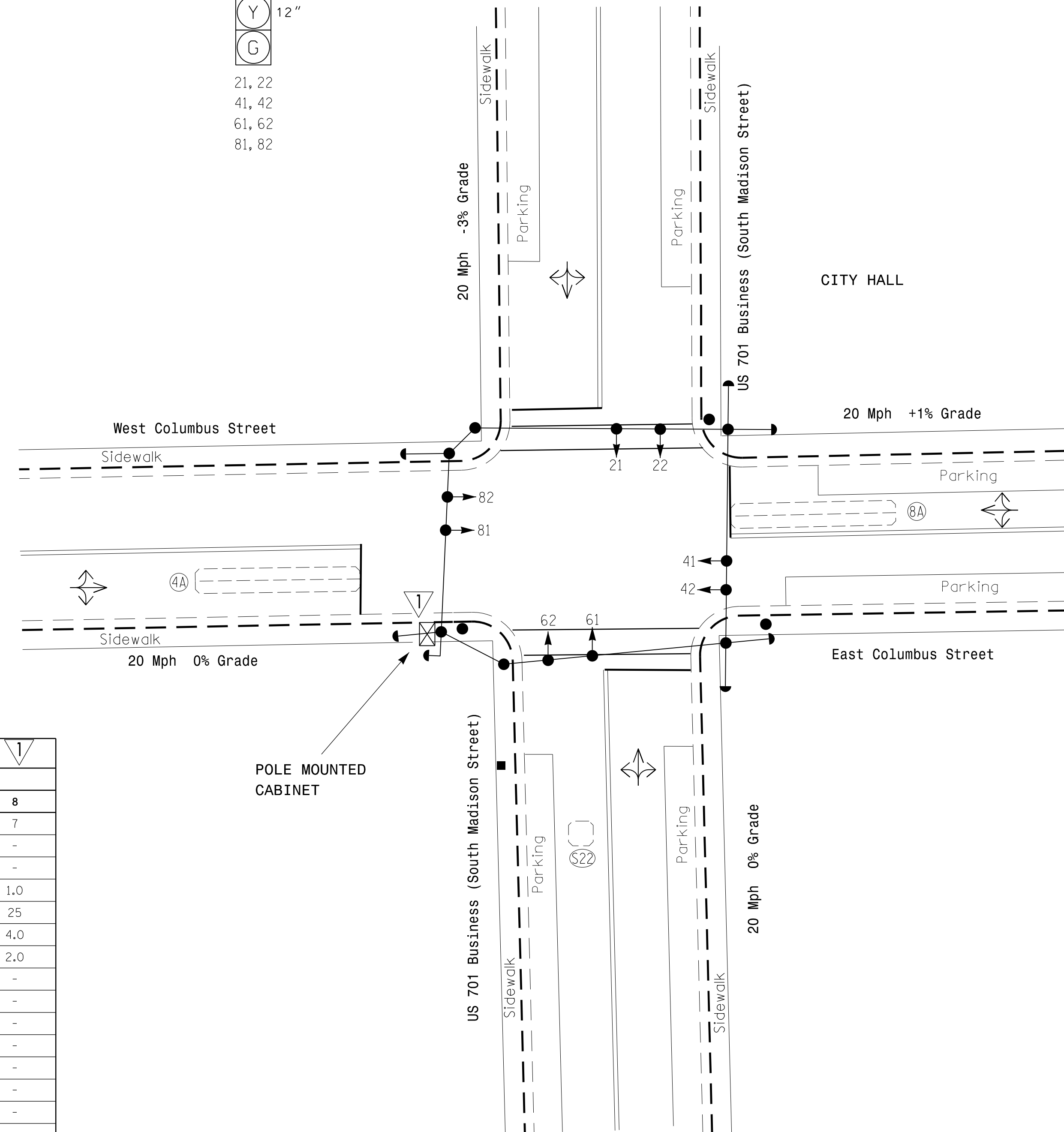

| FEATURE                 | PHASE      |     |            |     |
|-------------------------|------------|-----|------------|-----|
|                         | 2          | 4   | 6          | 8   |
| Min Green *             | 10         | 7   | 10         | 7   |
| Walk *                  | -          | -   | -          | -   |
| Ped Clear               | -          | -   | -          | -   |
| Veh. Extension *        | -          | 1.0 | -          | 1.0 |
| Max 1 *                 | 45         | 25  | 45         | 25  |
| Yellow                  | 4.0        | 4.0 | 4.0        | 4.0 |
| Red Clear               | 1.5        | 2.0 | 1.5        | 2.0 |
| Actuations B4 Add *     | -          | -   | -          | -   |
| Seconds / Actuation *   | -          | -   | -          | -   |
| Max Initial *           | -          | -   | -          | -   |
| Time Before Reduction * | -          | -   | -          | -   |
| Time To Reduce *        | -          | -   | -          | -   |
| Minimum Gap             | -          | -   | -          | -   |
| Locking Detector        | -          | -   | -          | -   |
| Recall Position         | MAX RECALL | -   | MAX RECALL | -   |
| Dual Entry              | -          | X   | -          | X   |
| Simultaneous Gap        | X          | X   | X          | X   |

\* These values may be field adjusted. Do not adjust Min Green and Extension times for phases 2 and 6 lower than what is shown. Min Green for all other phases should not be lower than 4 seconds.

| LEGEND   |                                   |
|--|-----------------------------------|
| PROPOSED   | EXISTING                          |
| ○ → Traffic Signal Head                            | ● → N/A                           |
| ● → Modified Signal Head                           | -                                 |
| □ → Sign   | -                                 |
| □ → Pedestrian Signal Head With Push Button & Sign | -                                 |
| ○ → Signal Pole with Guy                           | ● → Signal Pole with Sidewalk Guy |
| □ → Inductive Loop Detector                        | □ → Junction Box                  |
| □ → Controller & Cabinet                           | □ → 2-in Underground Conduit      |
| □ → Junction Box                                   | -                                 |
| - - - Right of Way                                 | - - -                             |
| → Directional Arrow                                | →                                 |
| → Pavement Marking Arrow                           | →                                 |

Signal Revision

DOCUMENT NOT CONSIDERED FINAL UNLESS ALL SIGNATURES COMPLETED

Revision Seal  
 NORTH CAROLINA PROFESSIONAL ENGINEER  
 SEAL 14543  
 C. G. MURPHY, JR.  
 Documented by: Gene H. Murray, Jr.  
 DATE: 05/15/20

Prepared in the Offices of:  
 TRANSPORTATION MOBILITY AND SAFETY DIVISION  
 NORTH CAROLINA DEPARTMENT OF TRANSPORTATION  
 SIGNAL DESIGN SECTION  
 750 N. Greenfield Pkwy, Garner, NC 27529  
 SCALE: 1" = 20'

US 701 Business (South Madison Street) at Columbus Street  
 Division 6 Columbus County Whiteville  
 PLAN DATE: August 2003 REVIEWED BY: R.J. Ziemba  
 PREPARED BY: Carter/Hambright REVIEWED BY:  
 REVISIONS: Controller changed to ASC/3 with new cabinet. GGM 05/15/20

SEAL  
 Not a certified document. This document originally Issued and sealed by Timothy J. Williams, 24393 on 11/4/03. This document shall not be considered a certified document.  
 DATE: 05/15/20  
 SIG. INVENTORY NO. 06-0480

SEPI Engineering & Construction, Inc.  
 1 Glenwood Avenue  
 Raleigh, NC 27603  
 Tel: 919.789.9977  
 Fax: 919.789.9591  
 License: C-2197