

PHASING DIAGRAM

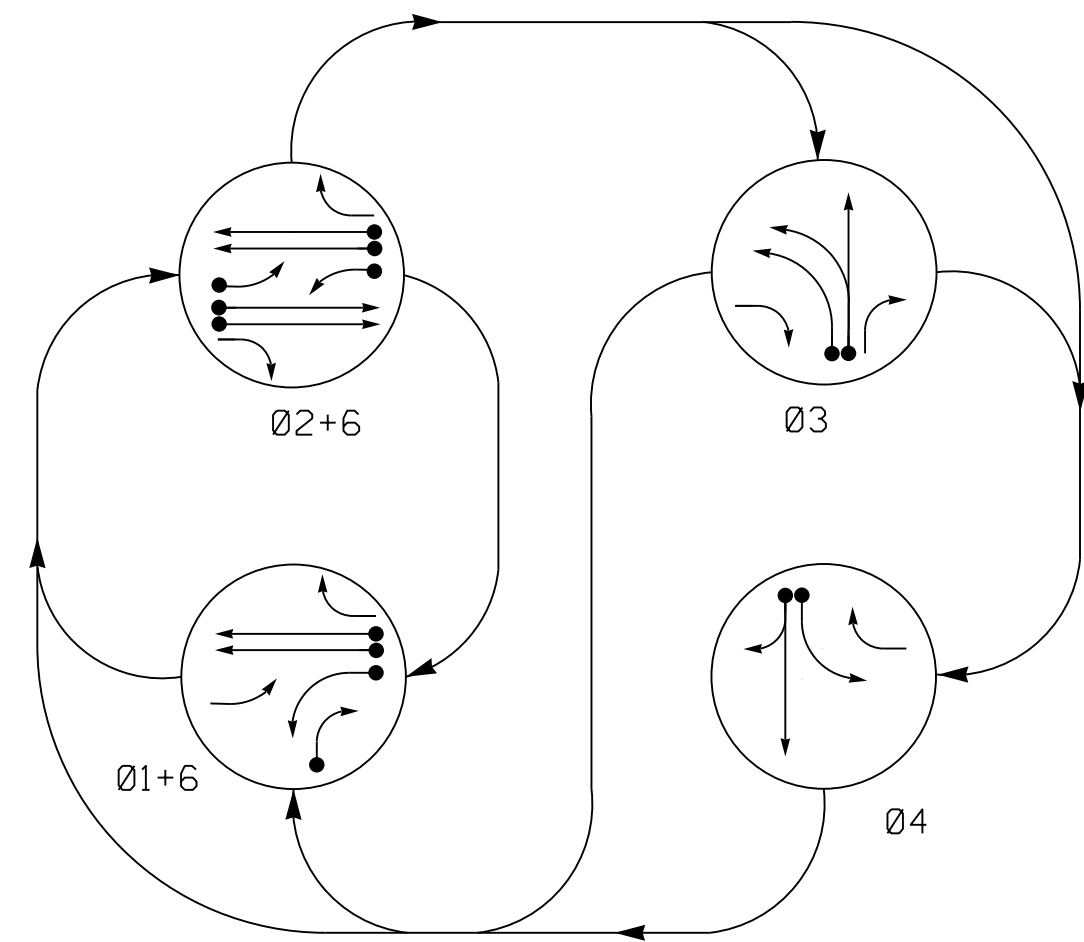

PHASING DIAGRAM DETECTION LEGEND

- DETECTED MOVEMENT
- UNDETECTED MOVEMENT (OVERLAP)
- UNSIGNALIZED MOVEMENT
- ⇄ PEDESTRIAN MOVEMENT

TABLE OF OPERATION

SIGNAL FACE	PHASE				FL	L	R	Y
	Ø 1+6	Ø 2+6	Ø 3	Ø 4				
11	←	←	←	←	Y			
21	←	←	←	←	Y			
22	R	G	R	R	Y			
23	R	G	R	R	Y			
31	R	R	G	R	R			
32	R	R	G	R	R			
41	R	R	R	G	R			
42	R	R	R	G	R			
61	G	G	R	R	Y			
62	G	G	R	R	Y			

SIGNAL FACE I.D.

All Heads L.E.D.

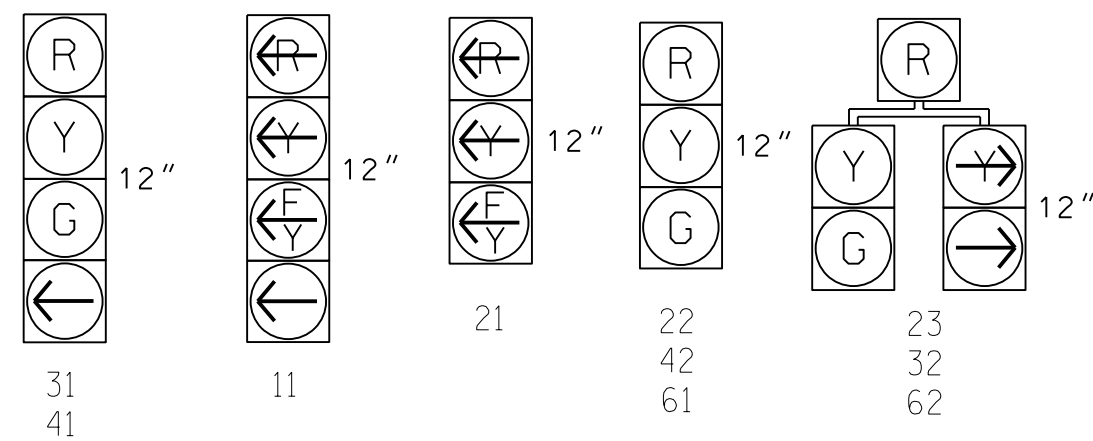

ASC/3 DETECTOR INSTALLATION CHART

LOOP	SIZE (FT)	DISTANCE FROM STOPBAR (FT)	TURNS	NEW LOOP	PROGRAMMING							
					PHASE	CALLING	EXTEND TIME	DELAY TIME	USE ADDED INITIAL	TYPE	SYSTEM LOOP	NEW CARD
1A	6x40	0	2-4-2	-	1	Yes	-	15	-	N	-	-
1B	6x40	0	2-4-2	-	6	Yes	-	3	-	G	-	-
2A	6x6	300	EXIST	-	1	Yes	-	15	-	N	-	-
2B	6x6	300	EXIST	-	2	Yes	-	-	X	N	-	-
2C	6x40	0	2-4-2	-	2	Yes	-	3	-	N	-	-
3A	6x40	0	2-4-2	-	3	Yes	-	3	-	N	-	-
3B	6x40	0	2-4-2	-	3	Yes	-	-	-	N	-	-
4A	6x40	0	2-4-2	-	4	Yes	-	2	-	N	-	-
4B	6x40	0	2-4-2	-	4	Yes	-	5	-	N	-	-
4C	6x6	0	EXIST	-	4	Yes	-	15	-	N	-	-
6A/S13	6x6	300	EXIST	-	6	Yes	-	-	X	N	X	-
6B/S14	6x6	300	EXIST	-	6	Yes	-	-	X	N	X	-
S15	6x6	+190	EXIST	-	-	-	-	-	-	N	X	-
S16	6x6	+190	EXIST	-	-	-	-	-	-	N	X	-

4 Phase Fully Actuated System #10605

NOTES

1. Refer to "Roadway Standard Drawings NCDOT" dated January 2018 and "Standard Specifications for Roads and Structures" dated January 2018.
2. Do not program signal for late night flashing operation unless otherwise directed by the Engineer.
3. Disable Backup Protect for phase 6.
4. Phase 1 may be lagged.
5. The order of phase 3 and phase 4 may be reversed.
6. Set all detector units to presence mode.
7. Pavement markings are existing.
8. Maximum times shown in timing chart are for free-run operation only. Coordinated signal system timing values supersede these values.

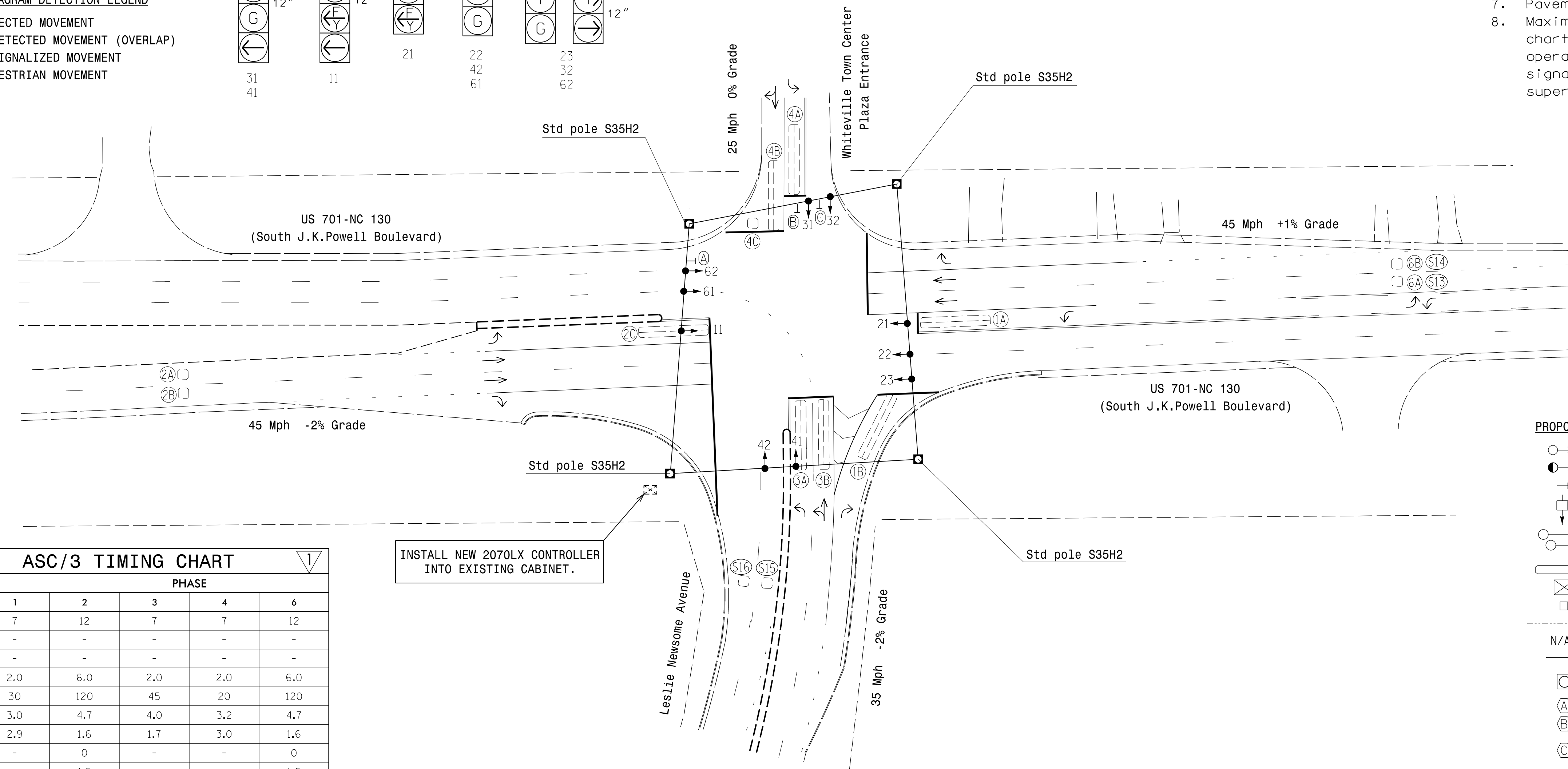

ASC/3 TIMING CHART

FEATURE	PHASE				
	1	2	3	4	6
Min Green *	7	12	7	7	12
Walk *	-	-	-	-	-
Ped Clear	-	-	-	-	-
Veh. Extension *	2.0	6.0	2.0	2.0	6.0
Max 1 *	30	120	45	20	120
Yellow	3.0	4.7	4.0	3.2	4.7
Red Clear	2.9	1.6	1.7	3.0	1.6
Actuations B4 Add *	-	0	-	-	0
Seconds / Actuation *	-	1.5	-	-	1.5
Max Initial *	-	34	-	-	34
Time Before Reduction *	-	15	-	-	15
Time To Reduce *	-	30	-	-	30
Minimum Gap	-	3.2	-	-	3.2
Locking Detector	-	X	-	-	X
Recall Position	-	VEH. RECALL	-	-	VEH. RECALL
Dual Entry	-	-	-	-	-
Simultaneous Gap	X	X	X	X	X

* These values may be field adjusted. Do not adjust Min Green and Extension times for phases 2 and 6 lower than what is shown. Min Green for all other phases should not be lower than 4 seconds.

INSTALL NEW 2070LX CONTROLLER INTO EXISTING CABINET.

LEGEND

- | PROPOSED | EXISTING |
|--|--|
| ○ → Traffic Signal Head | ● → Traffic Signal Head |
| ○ → Modified Signal Head | ○ → Modified Signal Head |
| ⊥ Sign | ⊥ Sign |
| ⊥ Pedestrian Signal Head With Push Button & Sign | ⊥ Pedestrian Signal Head With Push Button & Sign |
| ⊥ Signal Pole with Guy | ⊥ Signal Pole with Guy |
| ⊥ Signal Pole with Sidewalk Guy | ⊥ Signal Pole with Sidewalk Guy |
| ⊥ Inductive Loop Detector | ⊥ Inductive Loop Detector |
| ⊥ Controller & Cabinet | ⊥ Controller & Cabinet |
| ⊥ Junction Box | ⊥ Junction Box |
| --- 2-in Underground Conduit | --- 2-in Underground Conduit |
| N/A Right of Way | --- Right of Way |
| → Directional Arrow | → Directional Arrow |
| ○ Metal Strain Pole | ○ Metal Strain Pole |
| Ⓐ Right Arrow "ONLY" Sign (R3-5R) | Ⓐ Right Arrow "ONLY" Sign (R3-5R) |
| Ⓑ Left Arrow "ONLY" Sign (R3-5L) | Ⓑ Left Arrow "ONLY" Sign (R3-5L) |
| Ⓒ Combined Through and Left Arrow Sign (R3-6L) | Ⓒ Combined Through and Left Arrow Sign (R3-6L) |

Signal Revision

DOCUMENT NOT CONSIDERED FINAL UNLESS ALL SIGNATURES COMPLETED

Revision Seal

Prepared for:

US 701-NC 130
 (South J.K. Powell Blvd.) at
 Leslie Newsome Ave. /
 Whiteville Town Centre Entrance
 Division 06 Columbus County Whiteville

PLAN DATE: February 2013 REVIEWED BY:
 PREPARED BY: Jeff Spence REVIEWED BY:
 REVISIONS: Controller changed to ASC/3
 SCALE: 1" = 40'

SEAL
 Not a certified document.
 This document originally
 issued and sealed by
 Pamela L. Alexander, P.E.
 no. 23489
 on (3/15/13)
 This document shall not be
 considered a certified
 document.

SIGNATURE: DATE: SIG. INVENTORY NO. 06-1271

SEPI
 Engineering & Construction, Inc.
 1 Glenwood Avenue
 Raleigh, NC 27603
 Tel: 919.789.9977
 Fax: 919.789.9591
 License: C-2197