

PROJECT REFERENCE NO.	SHEET NO.
R-5020B	EC-19/CONST.08
RW SHEET NO.	
ROADWAY DESIGN ENGINEER	HYDRAULICS ENGINEER

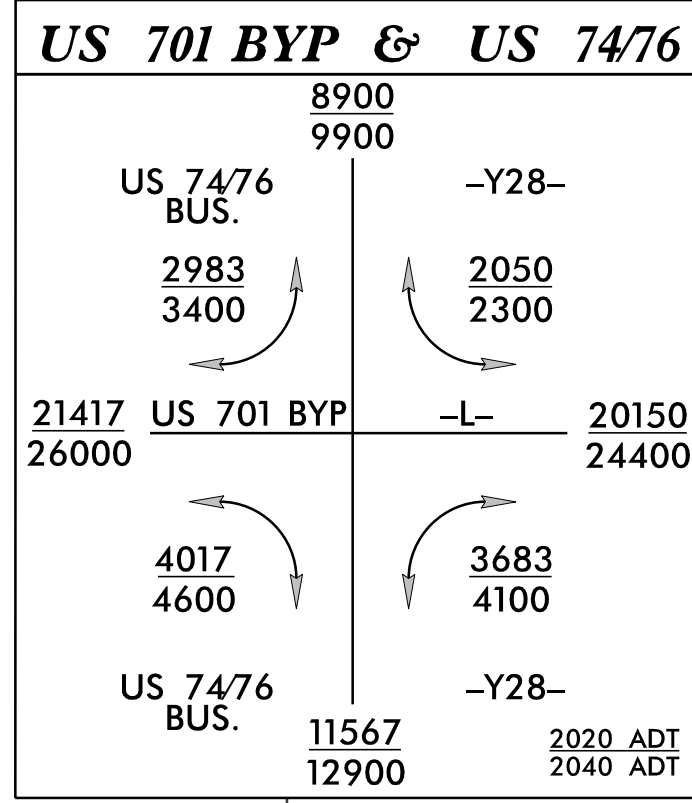

-Y28-  
 PI Sta 12+83.25  
 $\Delta = 8^{\circ}56'07.0''$  (RT)  
 $D = 2^{\circ}23'14.4''$   
 $L = 374.28'$   
 $T = 187.52'$   
 $R = 2,400.00'$

WILLIAMSON HOUSE  
 NATIONAL REGISTER ELIGIBLE

FINAL GRADING  
 EROSION CONTROL FOR  
 CONSTRUCTION SHEET 08

MATCHLINE -L- STA. 221+55 SEE SHEET 7

MATCHLINE -L- STA. 235+40 SEE SHEET 9

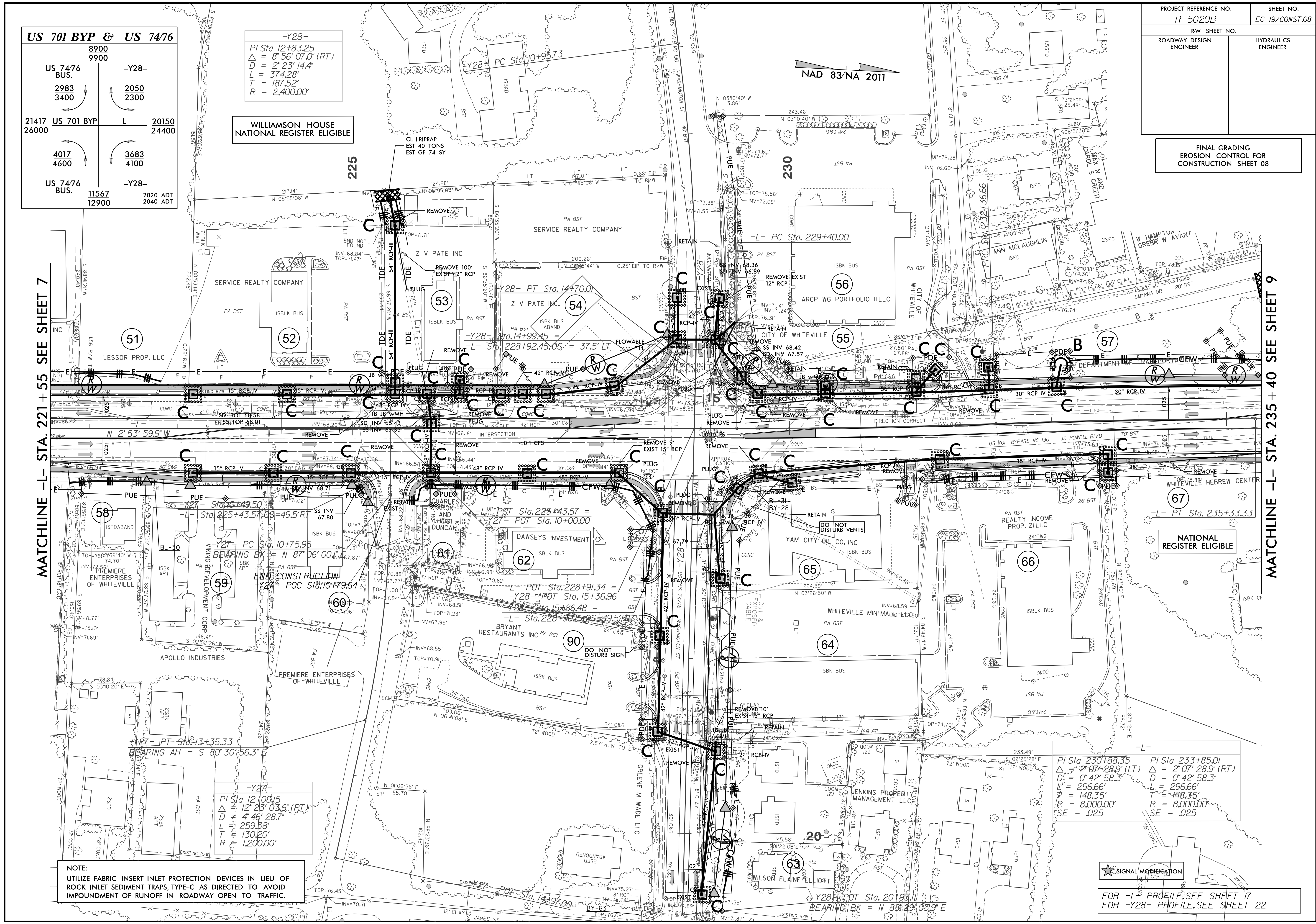

NOTE:  
 UTILIZE FABRIC INSERT INLET PROTECTION DEVICES IN LIEU OF  
 ROCK INLET SEDIMENT TRAPS, TYPE-C AS DIRECTED TO AVOID  
 IMPOUNDMENT OF RUNOFF IN ROADWAY OPEN TO TRAFFIC.

-L-  
 PI Sta 230+88.35  
 $\Delta = 2^{\circ}07'28.9''$  (LT)  
 $D = 0^{\circ}42'58.3''$   
 $L = 296.66'$   
 $T = 148.35'$   
 $R = 8,000.00'$   
 $SE = .025$

-L-  
 PI Sta 233+85.01  
 $\Delta = 2^{\circ}07'28.9''$  (RT)  
 $D = 0^{\circ}42'58.3''$   
 $L = 296.66'$   
 $T = 148.35'$   
 $R = 8,000.00'$   
 $SE = .025$

★ SIGNAL MODIFICATION

FOR -L- PROFILE SEE SHEET 17  
 FOR -Y28- PROFILE SEE SHEET 22