

STATE OF NORTH CAROLINA
DIVISION OF HIGHWAYS

TRANSPORTATION MANAGEMENT PLAN

WILKES COUNTY

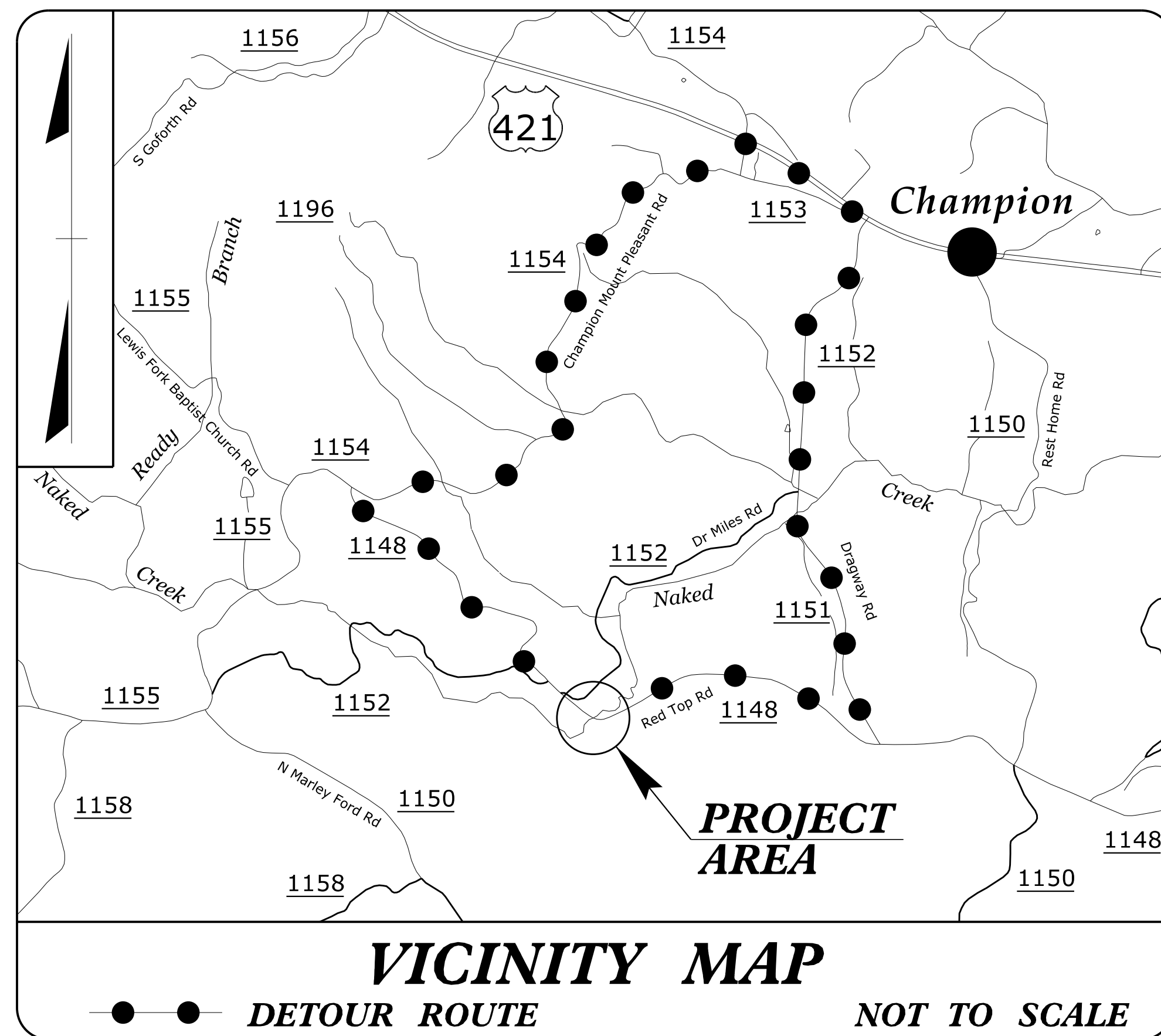
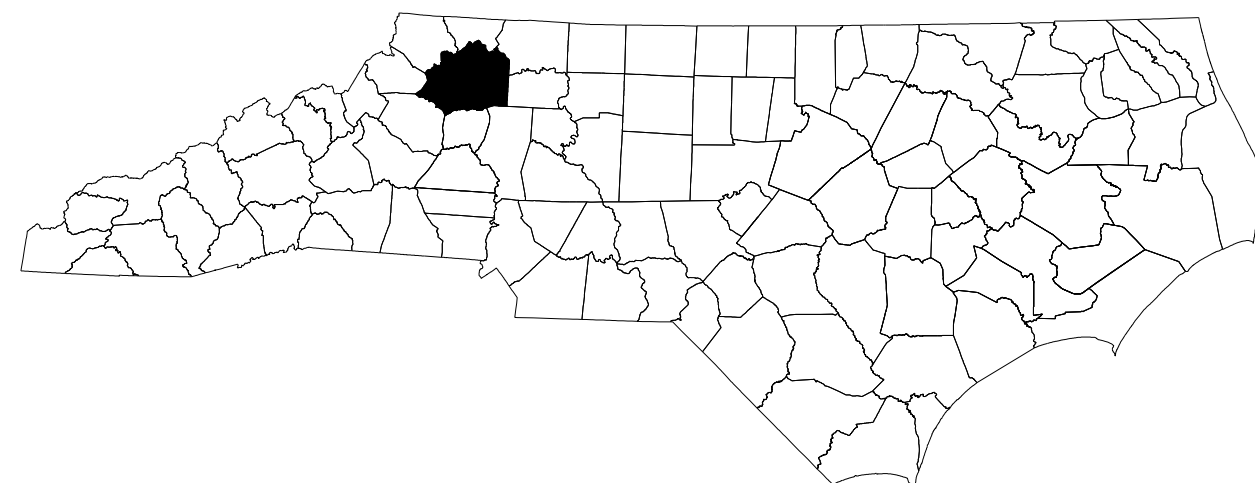

INDEX OF SHEETS

SHEET NO.	TITLE
TMP-1	TITLE SHEET, VICINITY MAP, AND INDEX OF SHEETS
TMP-1A	LIST OF APPLICABLE ROADWAY STANDARD DRAWINGS, GENERAL NOTES, PHASING, AND LEGEND
TMP-2	DETOUR ROUTE AND SIGNS

SHEET NO.
TMP-1

17BP.11.R.153

TIP PROJECT:

DOCUMENT NOT CONSIDERED FINAL
UNLESS ALL SIGNATURES COMPLETED

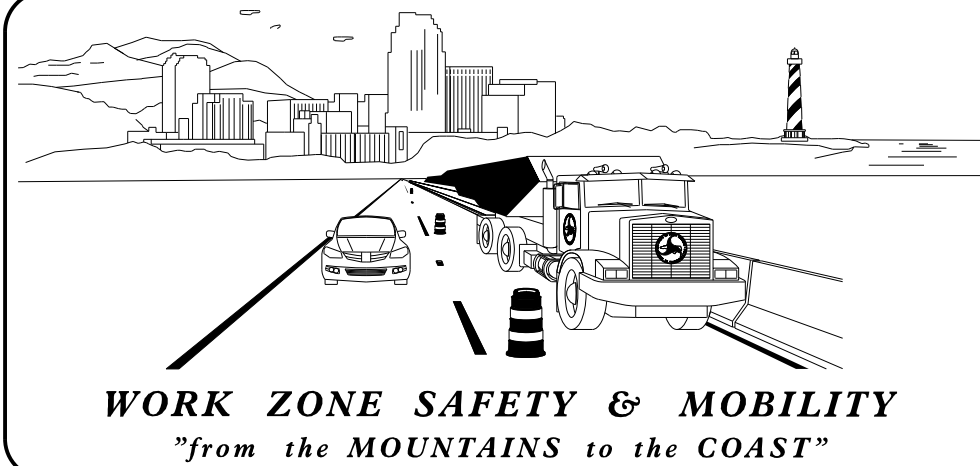

PLANS PREPARED BY:
 TYSON A. GRAVES, PE
 PAYTON L. NELSON

NCDOT CONTACTS:
 DON PARKER, PE
 PROJECT ENGINEER
 PROJECT DESIGN ENGINEER

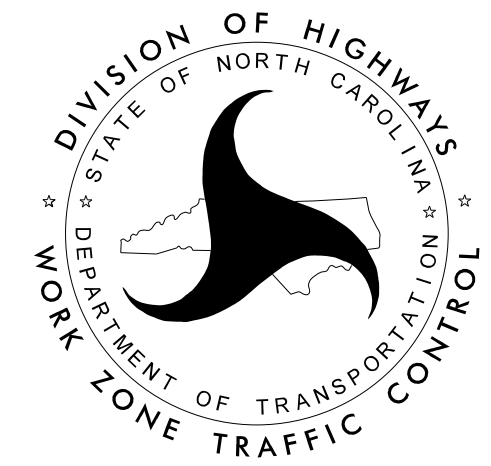

ms consultants, inc.
 5444 Wade Park Blvd.
 Suite 160
 Raleigh, NC 27607
 NC License Number : C-3239

APPROVED: [Signature]
DATE: 4-26-2021
 SEAL
 NORTH CAROLINA PROFESSIONAL ENGINEER
 TYSON A. GRAVES
 SEAL 021080

4/27/2021 N:\D0160\08339-06_17BP.11.R.153 NCDOT WILKES 419 OVER NAKED CREEK\TrafficControl\TCP\17BP.11.R.153_TMP_111e.dgn User:tygraves

ROADWAY STANDARD DRAWINGS

THE FOLLOWING ROADWAY STANDARDS AS SHOWN IN "ROADWAY STANDARD DRAWINGS" - N.C. DEPARTMENT OF TRANSPORTATION - RALEIGH, N.C., DATED JANUARY 2018 ARE APPLICABLE TO THIS PROJECT AND BY REFERENCE HEREBY ARE CONSIDERED A PART OF THESE PLANS:

STD. NO.	TITLE
1101.01	WORK ZONE WARNING SIGNS
1101.03	TEMPORARY ROAD CLOSURES
1101.11	TRAFFIC CONTROL DESIGN STANDARDS
1110.01	STATIONARY WORK ZONE SIGNS
1110.02	PORTABLE WORK ZONE SIGNS
1130.01	DRUMS
1135.01	CONES
1145.01	BARRICADES

GENERAL NOTES

CHANGES MAY BE REQUIRED WHEN PHYSICAL DIMENSIONS IN THE DETAIL DRAWINGS, STANDARD DETAILS, AND ROADWAY DETAILS ARE NOT ATTAINABLE TO MEET FIELD CONDITIONS OR RESULT IN DUPLICATE OR UNDESIRED OVERLAPPING OF DEVICES. MODIFICATION MAY INCLUDE: MOVING, SUPPLEMENTING, COVERING, OR REMOVAL OF DEVICES AS DIRECTED BY THE ENGINEER.

THE FOLLOWING GENERAL NOTES APPLY AT ALL TIMES FOR THE DURATION OF THE CONSTRUCTION PROJECT EXCEPT WHEN OTHERWISE NOTED IN THE PLAN OR DIRECTED BY THE ENGINEER.

TRAFFIC PATTERN ALTERATIONS

- A) NOTIFY THE ENGINEER THIRTY (30) CALENDAR DAYS PRIOR TO ANY TRAFFIC PATTERN ALTERATION.

SIGNING

- B) INSTALL ADVANCE WORK ZONE WARNING SIGNS WHEN WORK IS WITHIN 10 FT FROM THE EDGE OF TRAVEL LANE AND NO MORE THAN THREE (3) DAYS PRIOR TO THE BEGINNING OF CONSTRUCTION.
- C) PROVIDE SIGNING AND DEVICES REQUIRED TO CLOSE THE ROAD ACCORDING TO THE ROADWAY STANDARD DRAWINGS AND TRAFFIC CONTROL PLANS.
- D) COVER OR REMOVE ALL SIGNS AND DEVICES REQUIRED TO CLOSE THE ROAD WHEN ROAD CLOSURE IS NOT IN OPERATION. COVER OR REMOVE ALL SIGNS REQUIRED FOR THE OFF-SITE DETOUR WHEN THE DETOUR IS NOT IN OPERATION.
- E) ENSURE ALL NECESSARY SIGNING IS IN PLACE PRIOR TO ALTERING ANY TRAFFIC PATTERN.

TRAFFIC CONTROL DEVICES



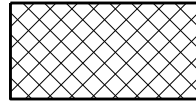

- F) PLACE TYPE III BARRICADES, WITH "ROAD CLOSED" SIGN R11-2 ATTACHED, OF SUFFICIENT LENGTH TO CLOSE ENTIRE ROADWAY.

LEGEND



GENERAL

-  WORK AREA
-  REMOVAL

TRAFFIC CONTROL DEVICES

-  BARRICADE (TYPE III)
-  CONE
-  DRUM
-  SKINNY DRUM
-  TUBULAR MARKER

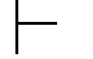
TEMPORARY SIGNING

-  PORTABLE SIGN
-  STATIONARY SIGN
-  STATIONARY OR PORTABLE SIGN

PHASING

- STEP 1 - INSTALL ADVANCE WARNING SIGNS ACCORDING TO ROADWAY STANDARD DRAWING 1101.01 (SHEET 3 OF 3).
- STEP 2 - INSTALL DETOUR SIGNS AS SHOWN ON TMP-2, AND COVER.
- STEP 3 - USING ROADWAY STANDARD DRAWING 1101.03 (SHEET 1 OF 9) , INSTALL TYPE III BARRICADES AS SHOWN ON TMP-2, UNCOVER DETOUR SIGNS, AND CLOSE ROAD.
- STEP 4 - CONSTRUCT BRIDGE AND APPROACHES.
- STEP 5 - INSTALL PERMANENT PAVEMENT MARKINGS AND MARKERS.
- STEP 6 - REMOVE ALL TEMPORARY TRAFFIC CONTROL DEVICES AND ADVANCE WARNING SIGNS, AND OPEN ROAD TO TRAFFIC.

5/11/2021 11:06:16 AM 17BP.11.R.153 NCDOT WILKES 419 OVER NAKED CREEK \TrafficControl\TCR\17BP.11.R.153_TMP_11a.dgn User:traves

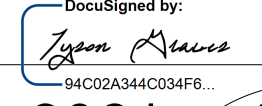
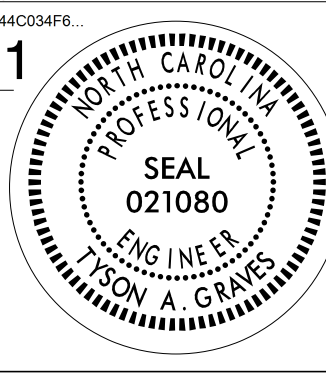
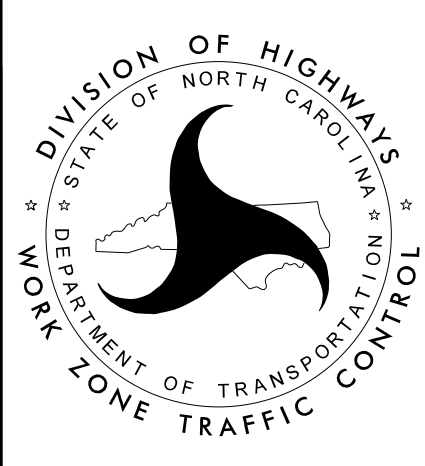

ms consultants, inc.
5444 Wake Park Blvd.
Suite 160
Raleigh, NC 27607
NC License Number : C-3239

APPROVED:  DATE: 4-26-2021 SEAL DOCUMENT NOT CONSIDERED FINAL UNLESS ALL SIGNATURES COMPLETED	 	ROADWAY STANDARD DRAWINGS, LEGEND, GENERAL NOTES, & PHASING
--	---	--

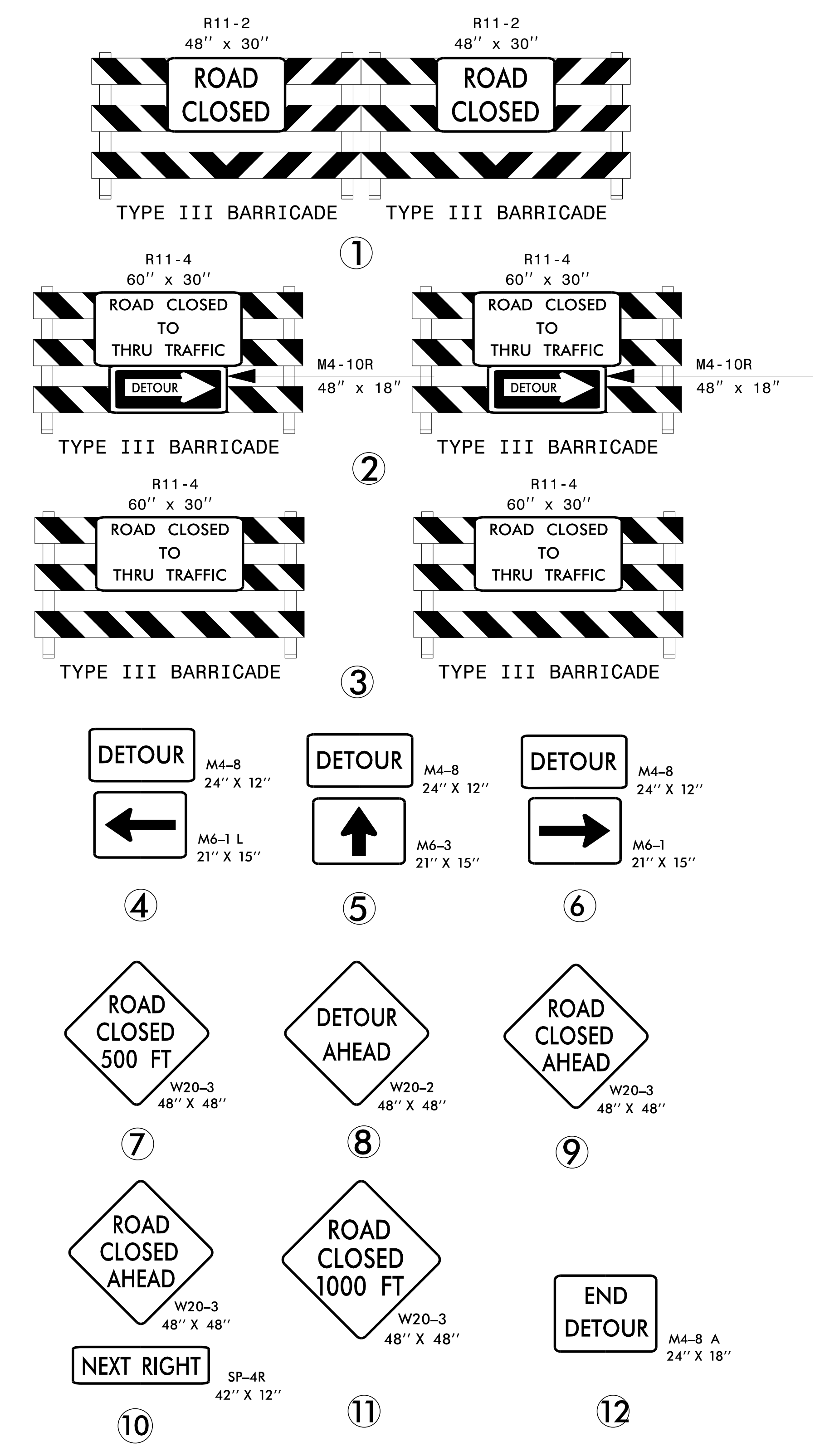
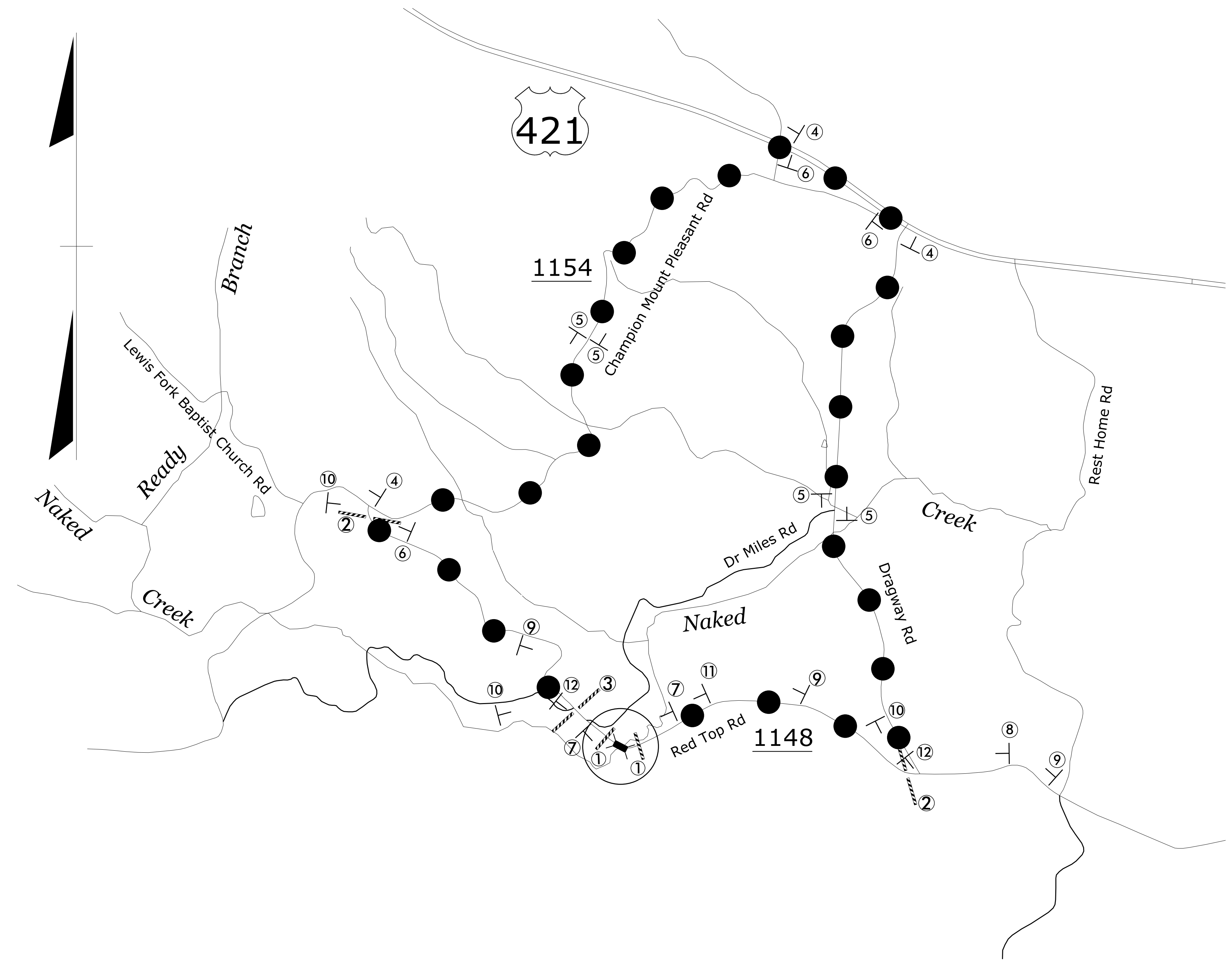

● ● **DETOUR ROUTE**

SR 1148
SR 1154
US 421
SR 1152
SR 1151

ms consultants, inc.
 5444 Wake Park Blvd.
 Suite 160
 Raleigh, NC 27607
 NC License Number : C-3239

APPROVED:
 DATE: 4-26-2021
 SEAL

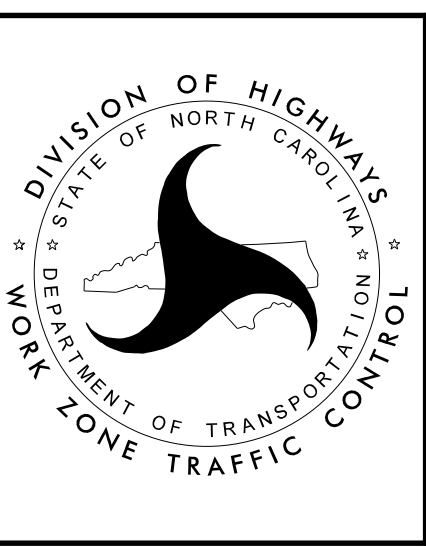

DETOUR ROUTE AND SIGNS

4/27/2021 N:\D0160\08339-06 17BP.11.R.153 NCDOT WILKES 419 OVER NAKED CREEK \TrafficControl\TCP\17BP.11.R.153 - TMP - 2.dgn User: tgraves

DOCUMENT NOT CONSIDERED FINAL UNLESS ALL SIGNATURES COMPLETED