

LOCATE APPROX.
1/2 MILE IN ADVANCE
OF DETOUR

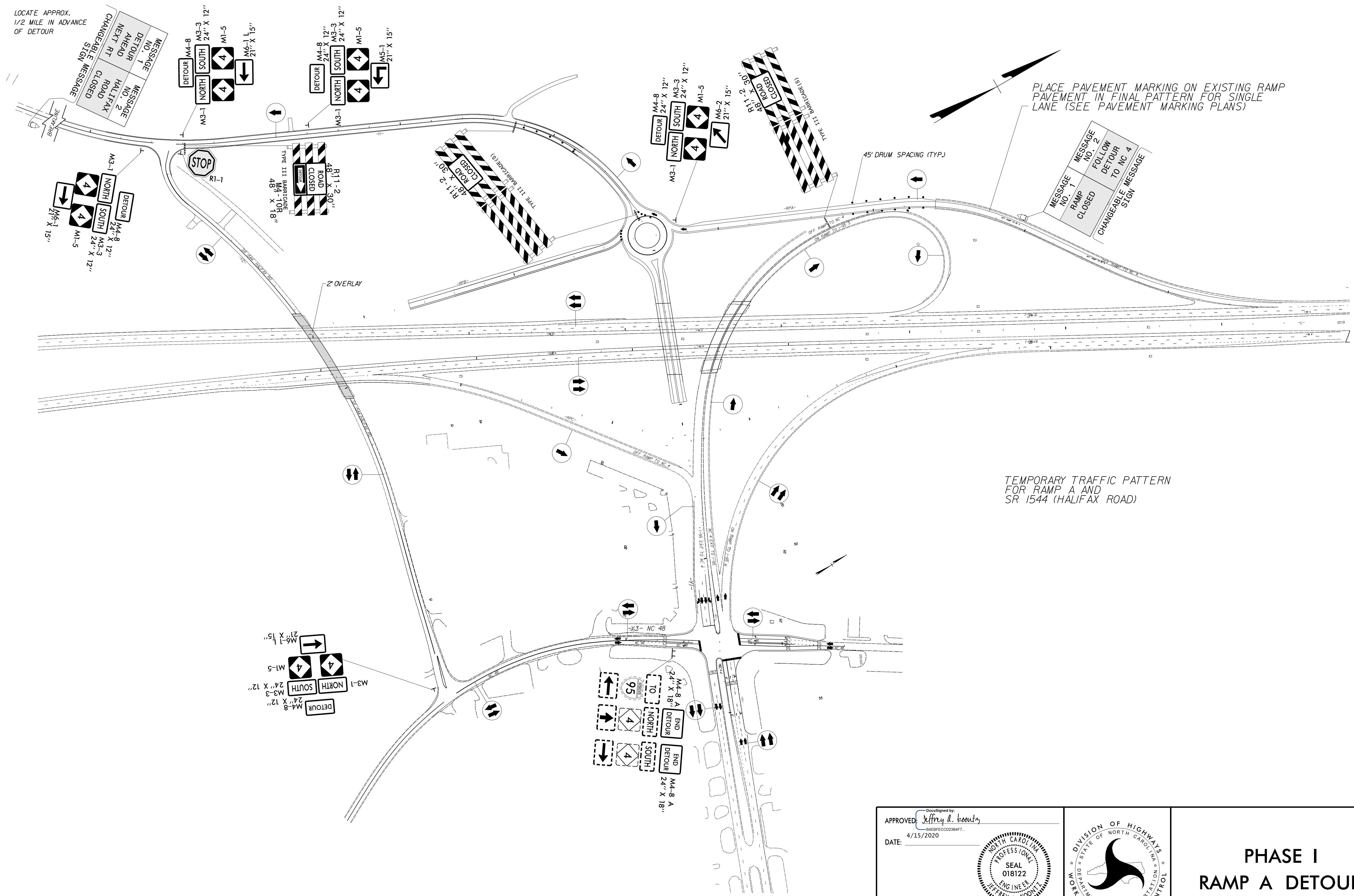

PLACE PAVEMENT MARKING ON EXISTING RAMP
PAVEMENT IN FINAL PATTERN FOR SINGLE
LANE (SEE PAVEMENT MARKING PLANS)

TEMPORARY TRAFFIC PATTERN
FOR RAMP A AND
SR 1544 (HALIFAX ROAD)

2/21/2020
R:\TrafficControl\CPA\B5980.TC_TMP_12_Phase I RPA Dtr.dgn
User:jeff.koontz

APPROVED: *Jeffrey D. Koontz*
DATE: 4/15/2020

DocuSigned by:
Jeffrey D. Koontz
B4EBFECC2384F7...

SEAL
018122
ENGINEER
JEFFREY D. KOONTZ

**DOCUMENT NOT CONSIDERED FINAL
UNLESS ALL SIGNATURES COMPLETED**

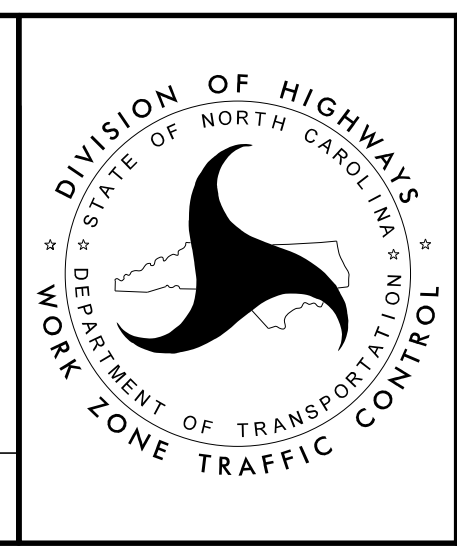

PHASE I RAMP A DETOUR