

**STATE OF NORTH CAROLINA
DEPARTMENT OF TRANSPORTATION**

TIP NO. U-5887	SHEET NO. PMP-1
APPROVED: DATE: 7/21/2020	
DOCUMENT NOT CONSIDERED FINAL UNLESS ALL SIGNATURES COMPLETED	

PAVEMENT MARKING PLAN

HENDERSON COUNTY

**LOCATION: SR 1783 (NORTH HIGHLAND LAKE ROAD) FROM NC 225 TO
WEST OF US 176**

ROADWAY STANDARD DRAWING

THE FOLLOWING ROADWAY STANDARDS AS APPEAR IN "ROADWAY STANDARD DRAWINGS" - PROJECT SERVICES UNIT - N.C. DEPARTMENT OF TRANSPORTATION - RALEIGH, N.C., DATED JANUARY 2018 ARE APPLICABLE TO THIS PROJECT AND BY REFERENCE HEREBY ARE CONSIDERED A PART OF THESE PLANS:

STD. NO.	TITLE
1205.01	PAVEMENT MARKINGS - LINE TYPES AND OFFSETS
1205.02	PAVEMENT MARKINGS - TWO-LANE AND MULTILANE ROADWAYS
1205.04	PAVEMENT MARKINGS - INTERSECTIONS
1205.05	PAVEMENT MARKINGS - TURN LANES
1205.06	PAVEMENT MARKINGS - THRU LANE DROPS
1205.07	PAVEMENT MARKINGS - PEDESTRIAN CROSSWALK
1205.08	PAVEMENT MARKINGS - SYMBOLS AND WORD MESSAGES
1205.09	PAVEMENT MARKINGS - PAINTED ISLANDS
1205.11	PAVEMENT MARKINGS - RAILROAD CROSSINGS
1250.01	RAISED PAVEMENT MARKERS - INSTALLATION SPACING
1253.01	RAISED PAVEMENT MARKERS - SNOWPLOWABLE
1261.01	GUARDRAIL & BARRIER DELINEATORS - INSTALLATION SPACING
1261.02	GUARDRAIL & BARRIER DELINEATORS - TYPES AND MOUNTING
1262.01	GUARDRAIL END DELINEATION

INDEX

SHEET NO.	DESCRIPTION
PMP-1	PAVEMENT MARKING PLAN COVER SHEET & PAVMENT MARKING SCHEDULE
PMP-1A	REVISED PAVEMENT MARKING ROADWAY STANDARD DRAWINGS
PMP-2 THRU PMP-6	PAVEMENT MARKING DETAILS

PAVEMENT MARKING SCHEDULE

SYMBOL	DESCRIPTION	MATERIAL
T1	WHITE EDGELINE (4",90 MIL)	THERMOPLASTIC
T2	WHITE SOLID LANE LINE (4",90 MIL)	THERMOPLASTIC
T4	3FT. - 9 FT./SP WHITE MINISKIP (4",90 MIL)	THERMOPLASTIC
T5	2FT. - 6 FT./SP WHITE MINISKIP(4",90 MIL)	THERMOPLASTIC
T10	YELLOW EDGELINE (4",90 MIL)	THERMOPLASTIC
T11	YELLOW SINGLE CENTER (4", 90 MIL)	THERMOPLASTIC
T12	10 FT. YELLOW SKIP (4",90 MIL)	THERMOPLASTIC
T13	YELLOW DOUBLE CENTER (4",90 MIL)	THERMOPLASTIC
T42	YELLOW DIAGONAL (8",90 MIL)	THERMOPLASTIC
T43	WHITE SOLID LANE LINE (8",90 MIL)	THERMOPLASTIC
T44	3FT. - 9 FT./SP WHITE MINISKIP(8",90 MIL)	THERMOPLASTIC
T46	WHITE CROSSWALK LINE (8",90 MIL)	THERMOPLASTIC
T60	WHITE LINE, RR X (16", 90 MIL)	THERMOPLASTIC
T61	WHITE STOPBAR (24",90 MIL)	THERMOPLASTIC
T62	WHITE CROSSWALK (24",90 MIL)	THERMOPLASTIC
T70	LEFT TURN ARROW (90 MIL)	THERMOPLASTIC
T71	RIGHT TURN ARROW (90 MIL)	THERMOPLASTIC
T72	STRAIGHT ARROW (90 MIL)	THERMOPLASTIC
T74	COMBO. RIGHT/STRAIGHT ARROW (90 MIL)	THERMOPLASTIC
T90	BICYCLE SYMBOL (90 MIL)	THERMOPLASTIC
T100	ALPHANUMERIC CHARACTER (90 MIL)	THERMOPLASTIC

GENERAL NOTES

THE FOLLOWING GENERAL NOTES APPLY AT ALL TIMES FOR THE DURATION OF THE CONSTRUCTION PROJECT, EXCEPT WHEN OTHERWISE NOTED IN THE PLAN, OR DIRECTED BY THE ENGINEER.

A) INSTALL PAVEMENT MARKINGS AND PAVEMENT MARKERS ON THE FINAL SURFACE AS FOLLOWS:

ROAD NAME	MARKING	MARKER
ALL ROADS	THERMOPLASTIC	SNOWPLOWABLE/ REFLECTIVE

- B) TIE PROPOSED PAVEMENT MARKING LINES TO EXISTING PAVEMENT MARKING LINES.
- C) REMOVE/REPLACE ANY CONFLICTING/DAMAGED PAVEMENT MARKINGS AND MARKERS.
- D) PASSING ZONES WILL BE DETERMINED IN THE FIELD AND MUST BE APPROVED BY THE ENGINEER.
- E) STOP BAR LOCATION AT NON-SIGNALIZED INTERSECTIONS MAY BE ADJUSTED AS DIRECTED BY THE ENGINEER.
- F) UNLESS OTHERWISE SPECIFIED, HEATED-IN-PLACE THERMOPLASTIC MAY BE USED IN LIEU OF EXTRUDED THERMOPLASTIC FOR STOP BARS, SYMBOLS, CHARACTERS AND DIAGONALS. IF HEATED-IN-PLACE IS USED, IT SHALL BE PAID FOR USING THE EXTRUDED THERMOPLASTIC PAY ITEM.

PLAN REVIEWED BY: N.C.D.O.T. SIGNING AND DELINEATION UNIT

DIVISION TRAFFIC ENGINEER

SIGNING & DELINEATION PROJECT DESIGN ENGINEER

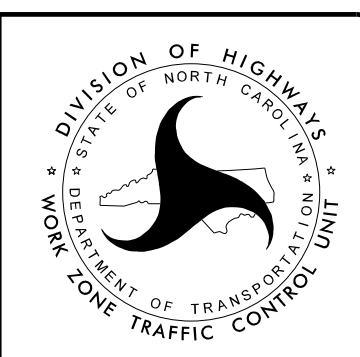

PLAN PREPARED BY: Vaughn & Melton Consulting Engineers, INC.

REECE SCHULER, P.E. PROJECT ENGINEER

JARED PHILPOT, E.I. PROJECT DESIGN ENGINEER

Raleigh, NC 919-377-9455
 Charlotte, NC 704-351-0488
 Boone, NC 828-255-9333
 Tri-Cities, TN 423-461-8400
 Tri-Cities, TN 423-461-8400
 Knoxville, TN 865-546-5800
 Charleston, SC 843-774-9500
 Milledgeboro, KY 606-248-6600
 Atlanta, GA 770-421-3509
 Spartanburg, SC 864-574-4775

Copyright © 2006 Vaughn & Melton, Inc. All Rights Reserved.

TIP PROJECT : U-5887

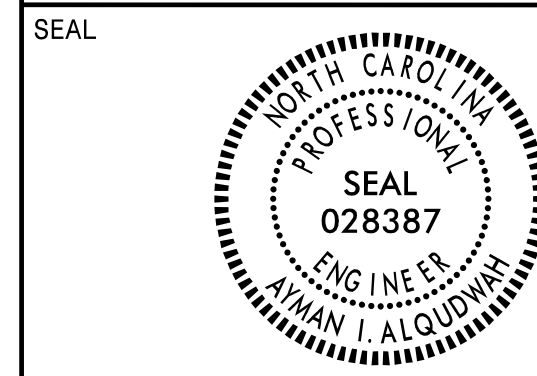

STATE OF NORTH CAROLINA
DEPT. OF TRANSPORTATION
DIVISION OF HIGHWAYS
RALEIGH, N.C.

6-19 ENGLISH DETAIL DRAWING FOR
PAVEMENT MARKINGS
INTERSECTIONS

STATE OF NORTH CAROLINA
DEPT. OF TRANSPORTATION
DIVISION OF HIGHWAYS
RALEIGH, N.C.

6-19 ENGLISH DETAIL DRAWING FOR
PAVEMENT MARKINGS
INTERSECTIONS

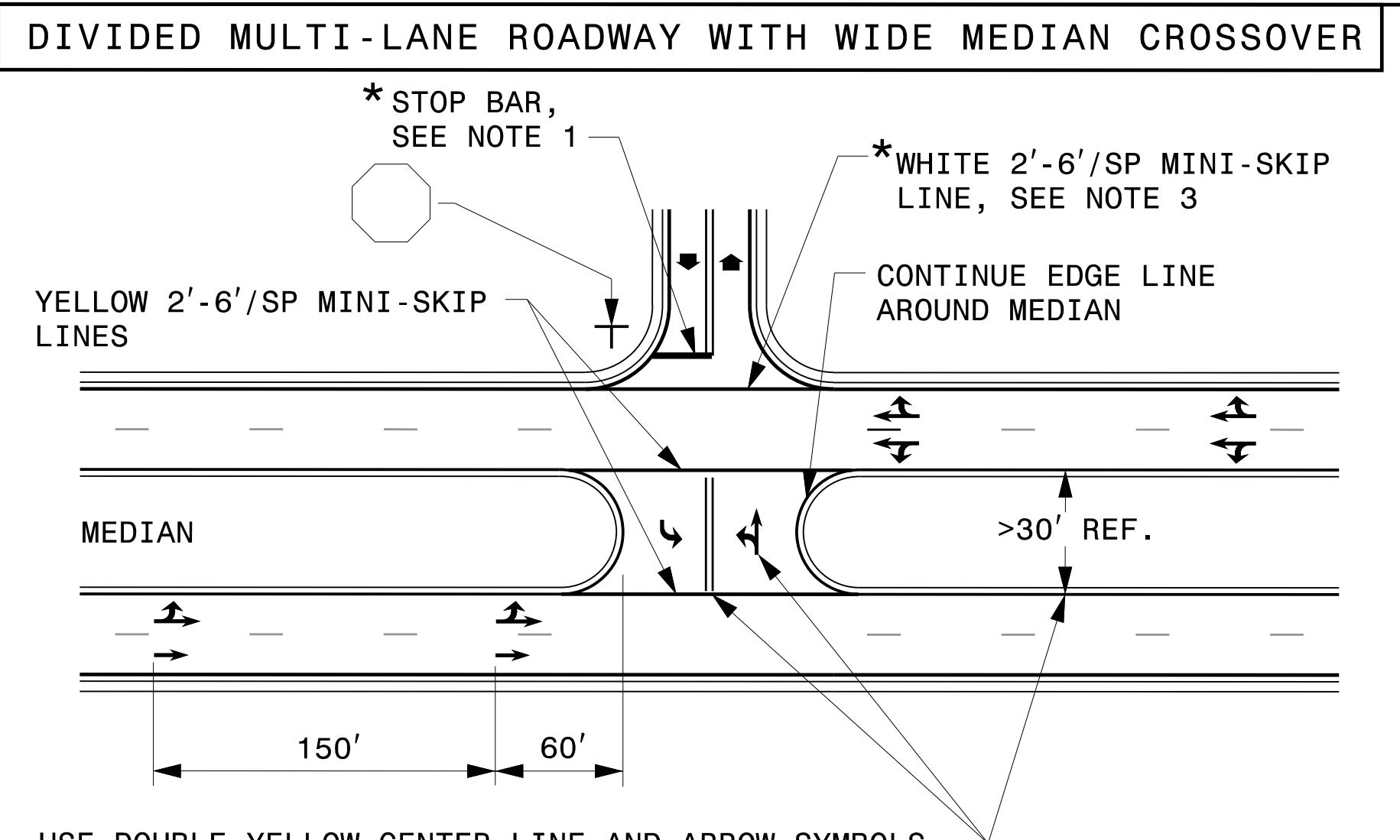
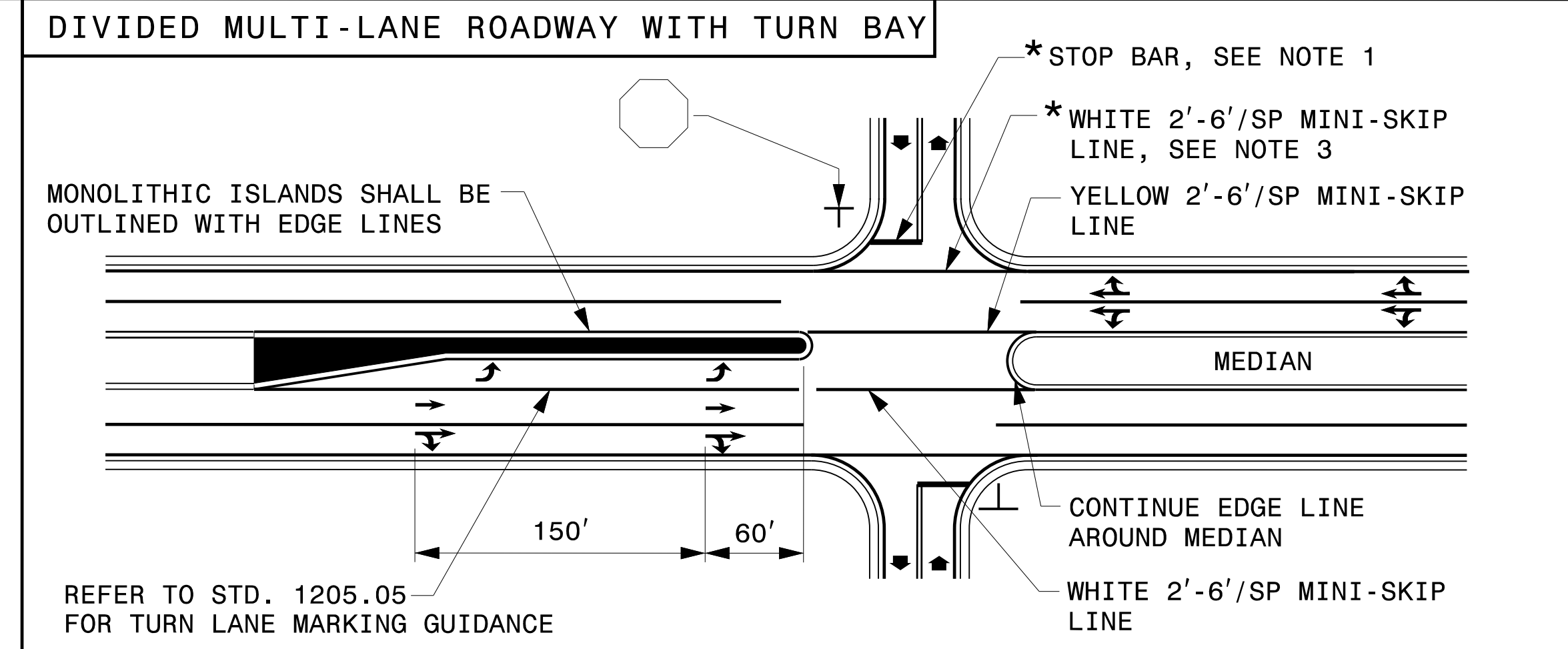
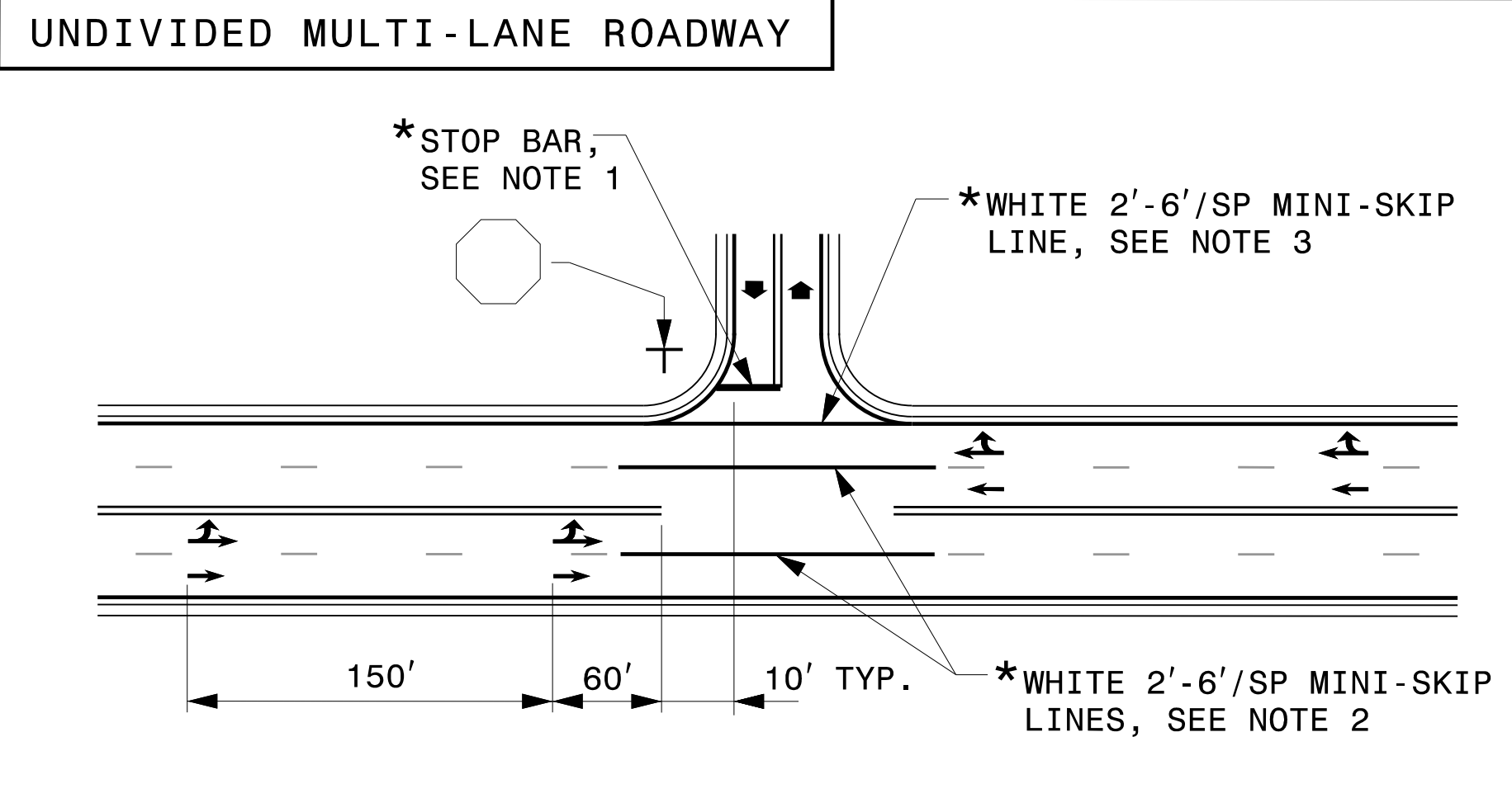
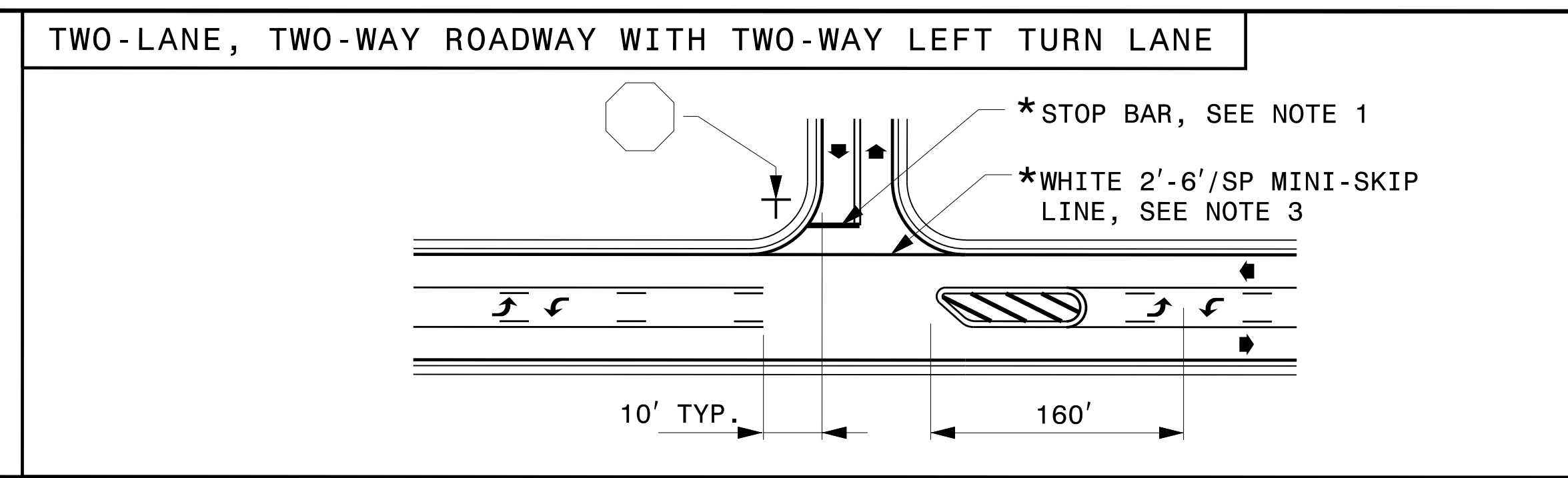
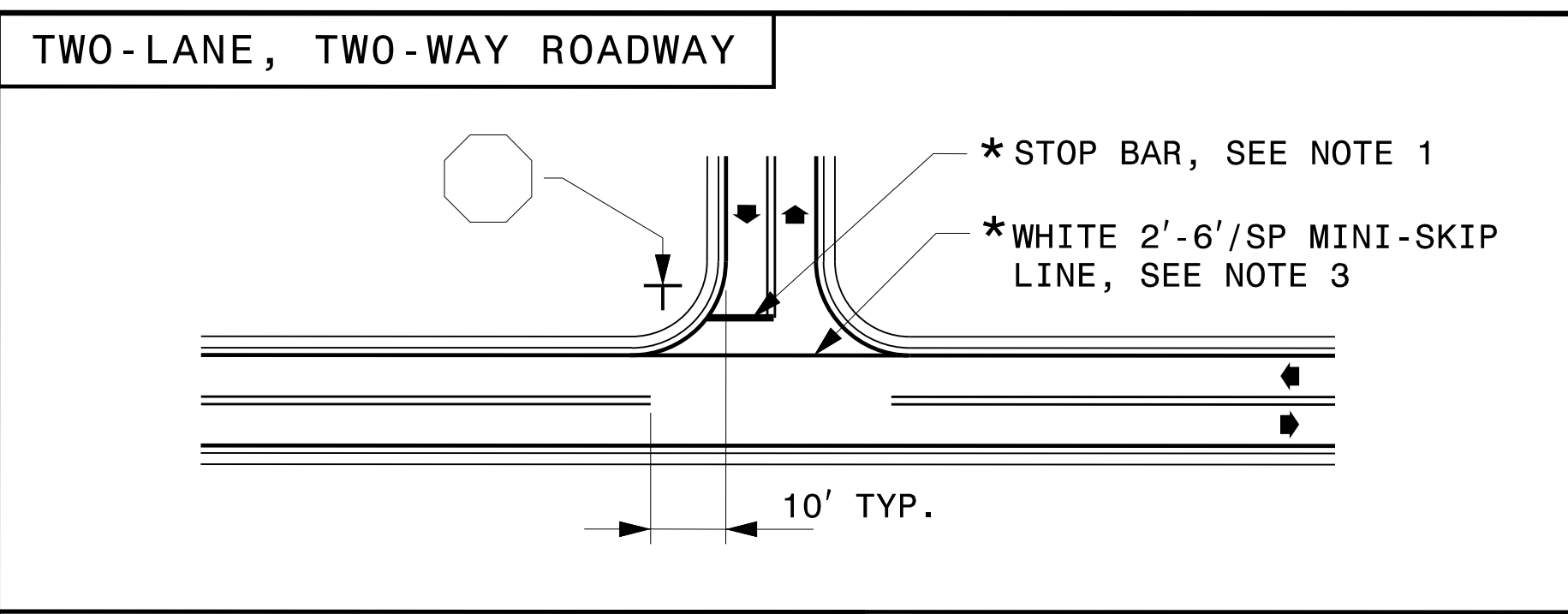

- GENERAL NOTES:
- 1- PLACEMENT OF STOP BARS AT NON-SIGNALIZED INTERSECTIONS IS OPTIONAL AND USED WHERE IT IS IMPORTANT TO INDICATE THE POINT WHICH VEHICLES ARE REQUIRED TO STOP. PLACE STOP BARS NO LESS THAN 4 FEET AND NO MORE THAN 30 FEET FROM THE NEAREST EDGE OF THE INTERSECTING ROADWAY. USE 10 FEET AS THE TYPICAL SETBACK DISTANCE OR AS DIRECTED BY THE ENGINEER.
 - 2- MINI-SKIP LANE LINE EXTENSIONS SHOULD BE USED AT INTERSECTIONS THAT HAVE REDUCED VISIBILITY CONDITIONS SUCH AS OFFSET, SKEWED, OR CURVED ROADWAYS.
 - 3- MINI-SKIP EDGE LINE EXTENSIONS MAY BE PLACED THROUGH INTERSECTIONS AND MAJOR DRIVEWAYS.
 - 4- REFER TO ROADWAY STANDARD DRAWINGS 1205.01, 1205.02, 1205.05, 1205.08 AND 1205.09 FOR ADDITIONAL PAVEMENT MARKING GUIDANCE.

LEGEND	
	STOP SIGN
	STATIONARY SIGN
	DIRECTION OF TRAFFIC FLOW
	PAVEMENT MARKING SYMBOLS
	OPTIONAL

USE DOUBLE YELLOW CENTER LINE AND ARROW SYMBOLS IN MEDIAN CROSSOVER WHEN WIDTH OF MEDIAN EXCEEDS 30 FT, OTHERWISE THEY ARE NOT REQUIRED.

7/21/2020
I:\Asheville\Transportation\31535-06 U-5887\Traffic\TrafficControl\TCP\U-5887_PMP1A.dgn
User:scjmartell

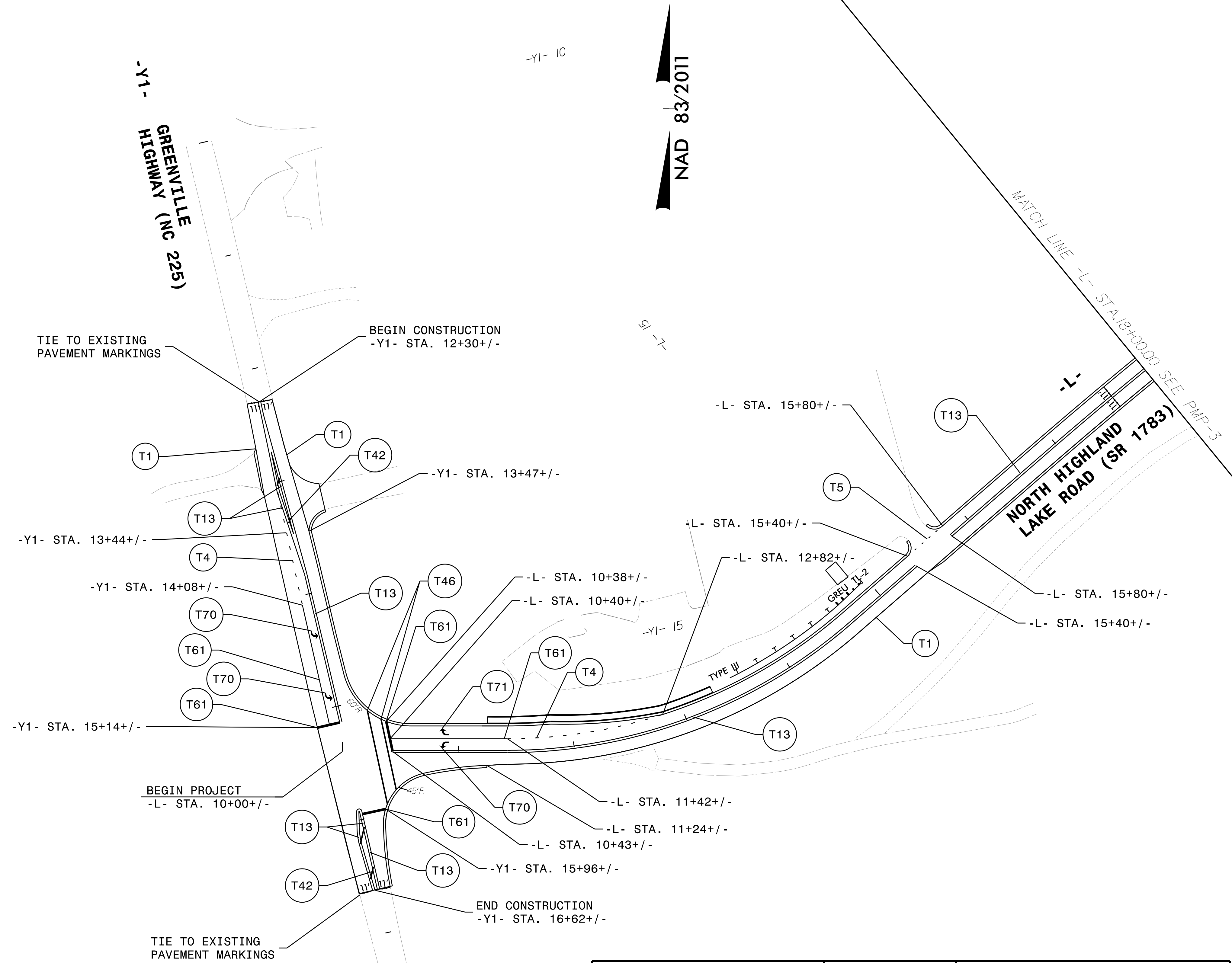

7/21/2020
 V:\Asheville\Transportation\31535-06 U-5887\TrafficControl\TCP\U-5887_PMP2.dgn
 User:tcimar\ell

APPROVED: *Reece M. Schuler*
 DATE: 7/21/2020
 SEAL
 NORTH CAROLINA
 PROFESSIONAL
 SEAL
 26960
 ENGINEER
 REECE M. SCHULER

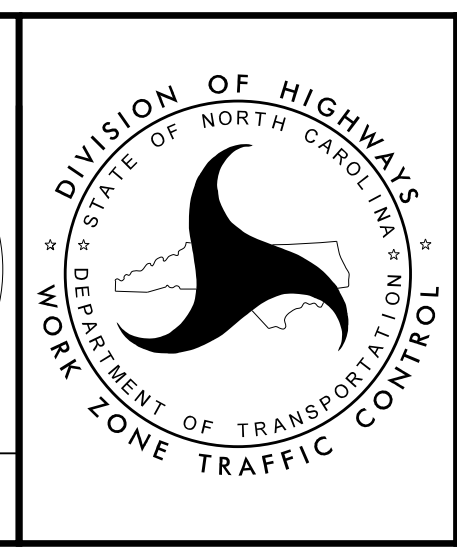

**PAVEMENT
 MARKING
 PLAN**

**DOCUMENT NOT CONSIDERED FINAL
 UNLESS ALL SIGNATURES COMPLETED**

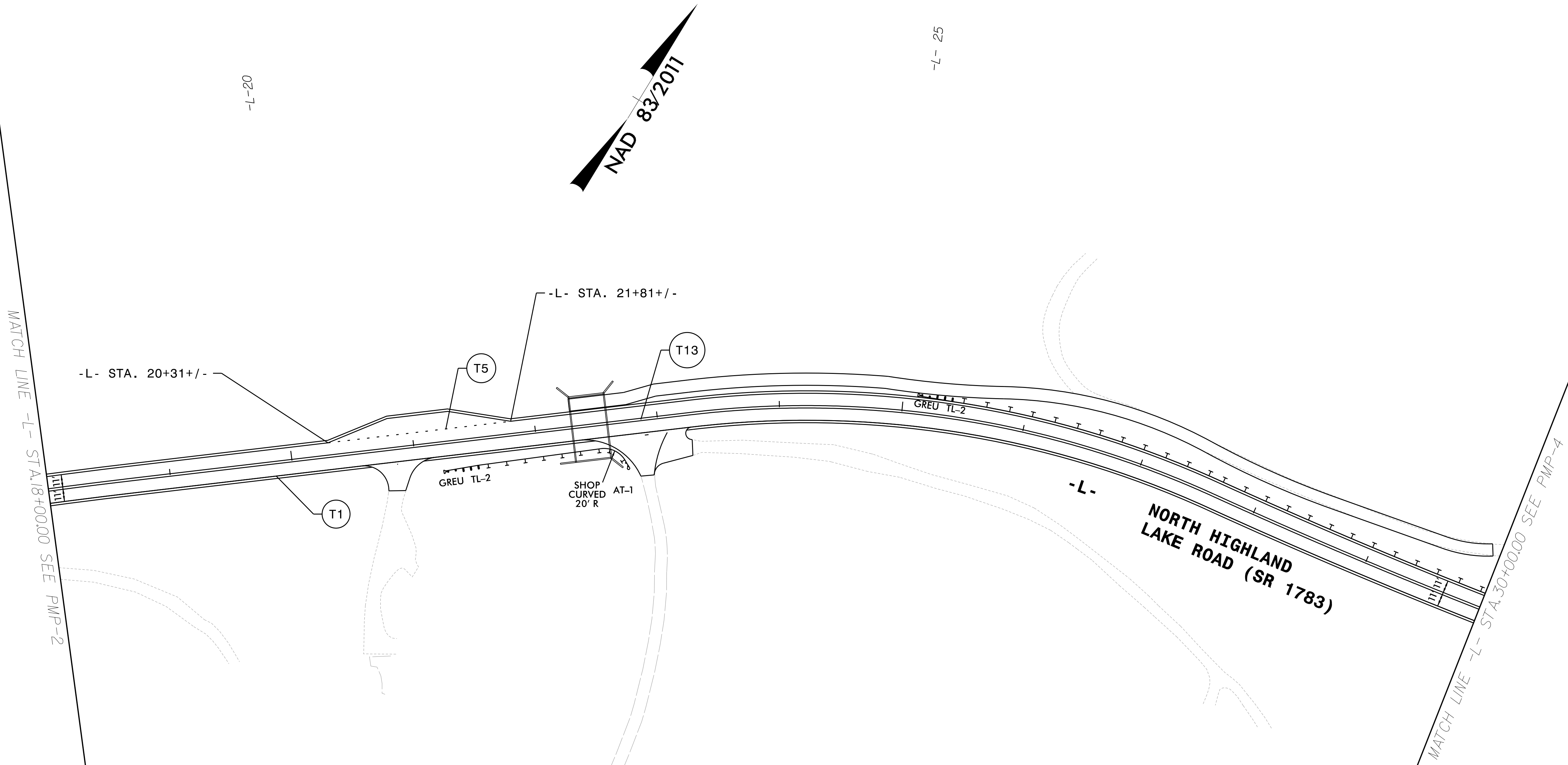

7/21/2020
 V:\Asheville\Transportation\31535-06_U-5887\TrafficControl\TCP\U-5887_PMP3.dgn
 User:tcjmar-tell

APPROVED: *Reece M. Schuler*
DocuSigned by:
10634024C7824FC...

DATE: 7/21/2020

SEAL

**DOCUMENT NOT CONSIDERED FINAL
UNLESS ALL SIGNATURES COMPLETED**

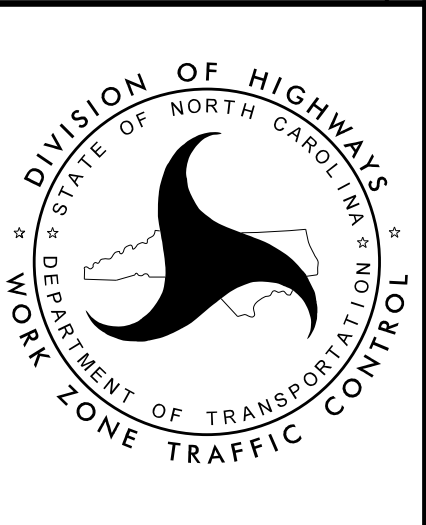

**PAVEMENT
MARKING
PLAN**

NAD 83/2011

MATCH LINE -L- STA. 30+00.00 SEE PMP-3

MATCH LINE -L- STA. 42+00.00 SEE PMP-5

NORTH HIGHLAND LAKE ROAD (SR 1783)

HIGHLAND LAKE DRIVE (SR 1825)

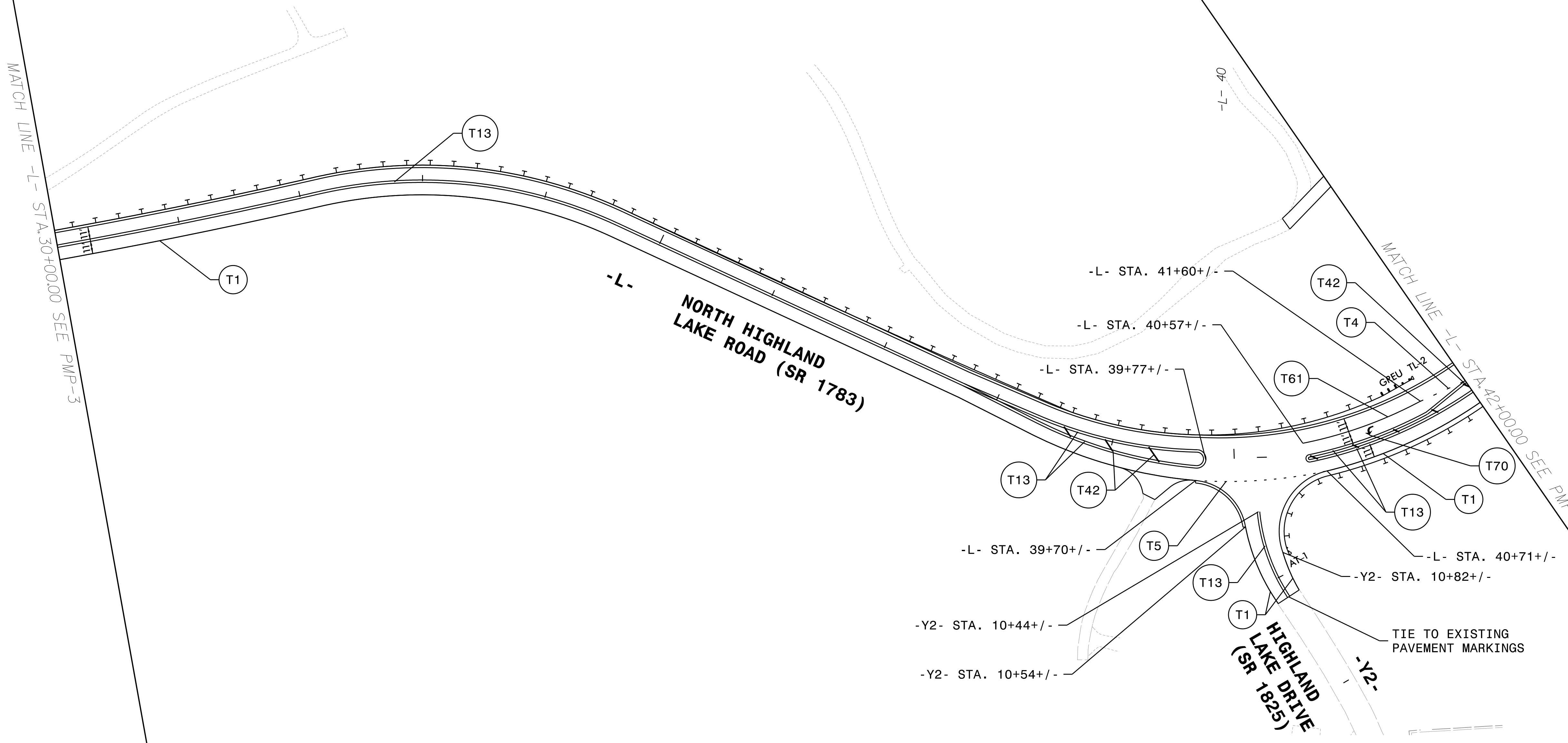

7/21/2020
 V:\Asheville\Transportation\31535-06 U-5887\TrafficControl\TCP\U-5887_PMP4.dgn
 User:tcjmarfell

APPROVED: *Reece M. Schuler*
 DATE: 7/21/2020

SEAL

**DOCUMENT NOT CONSIDERED FINAL
 UNLESS ALL SIGNATURES COMPLETED**

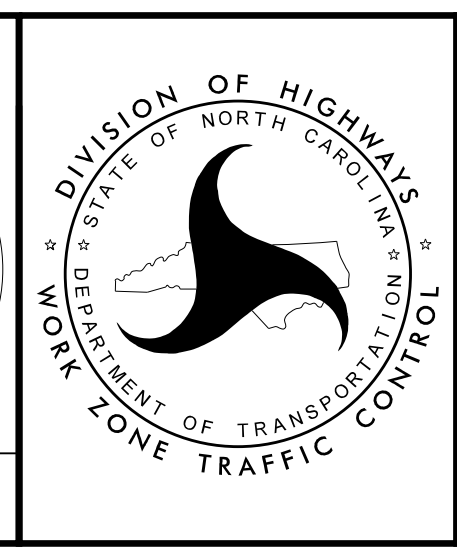

PAVEMENT MARKING PLAN

PROJ. REFERENCE NO.	SHEET NO.
U-5887	PMP-5

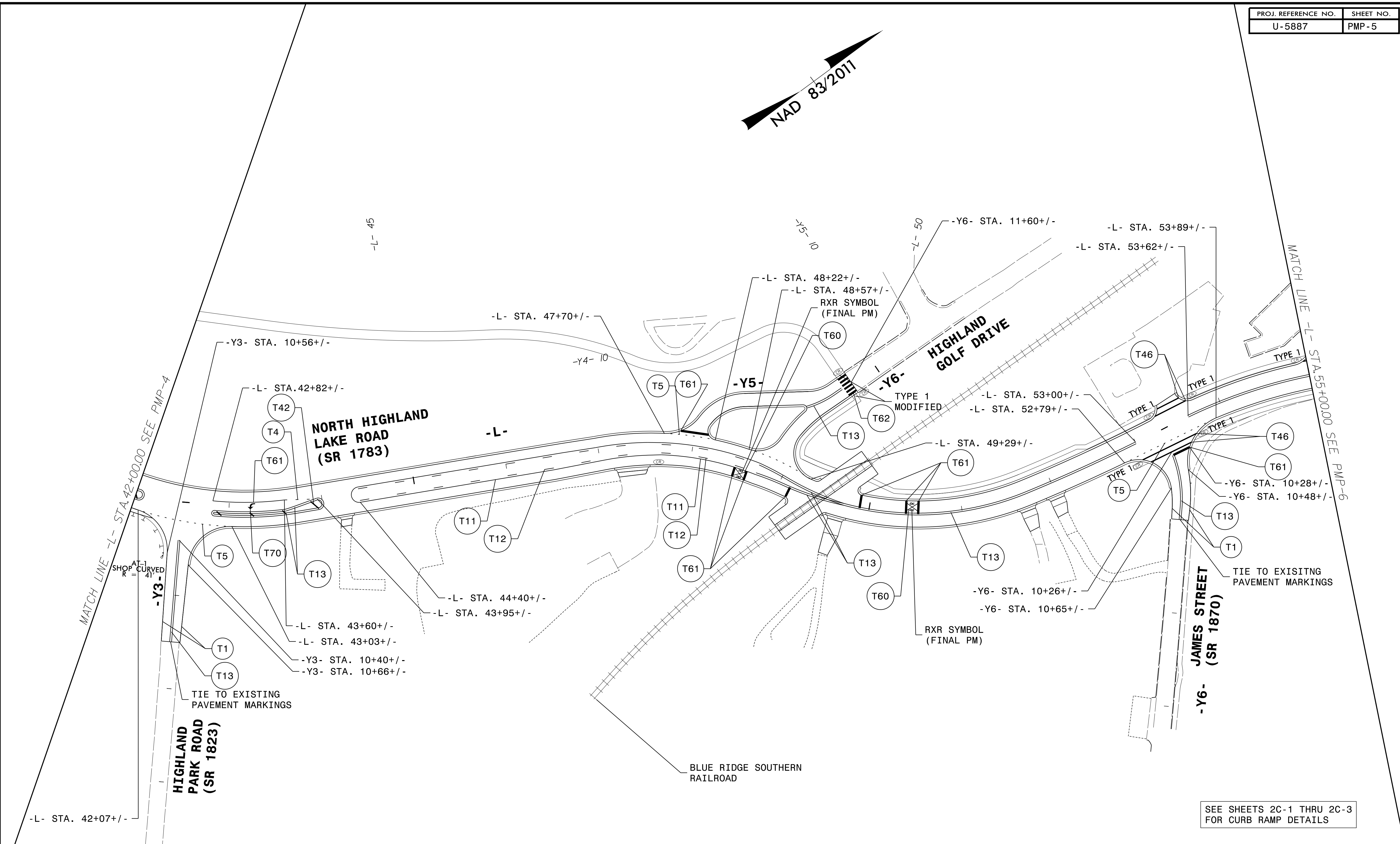

MATCH LINE -L- STA. 42+00.00 SEE PMP-4

MATCH LINE -L- STA. 55+00.00 SEE PMP-6

SEE SHEETS 2C-1 THRU 2C-3 FOR CURB RAMP DETAILS

12/17/2020 12:06:17 PM
 \\TCPU\U-5887_PMP5.dgn
 User:icphibot

APPROVED: _____
 DATE: _____

SEAL

**DOCUMENT NOT CONSIDERED FINAL
 UNLESS ALL SIGNATURES COMPLETED**

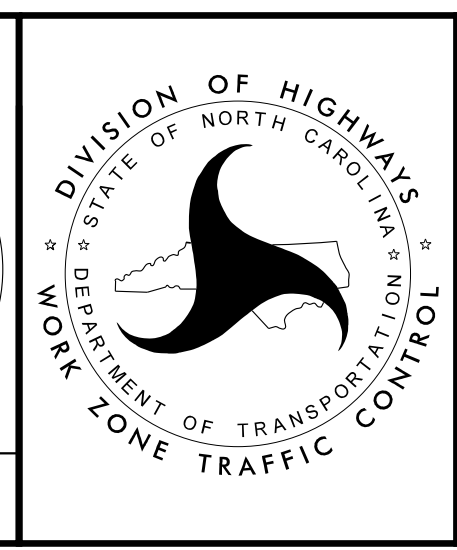

**PAVEMENT
 MARKING
 PLAN**

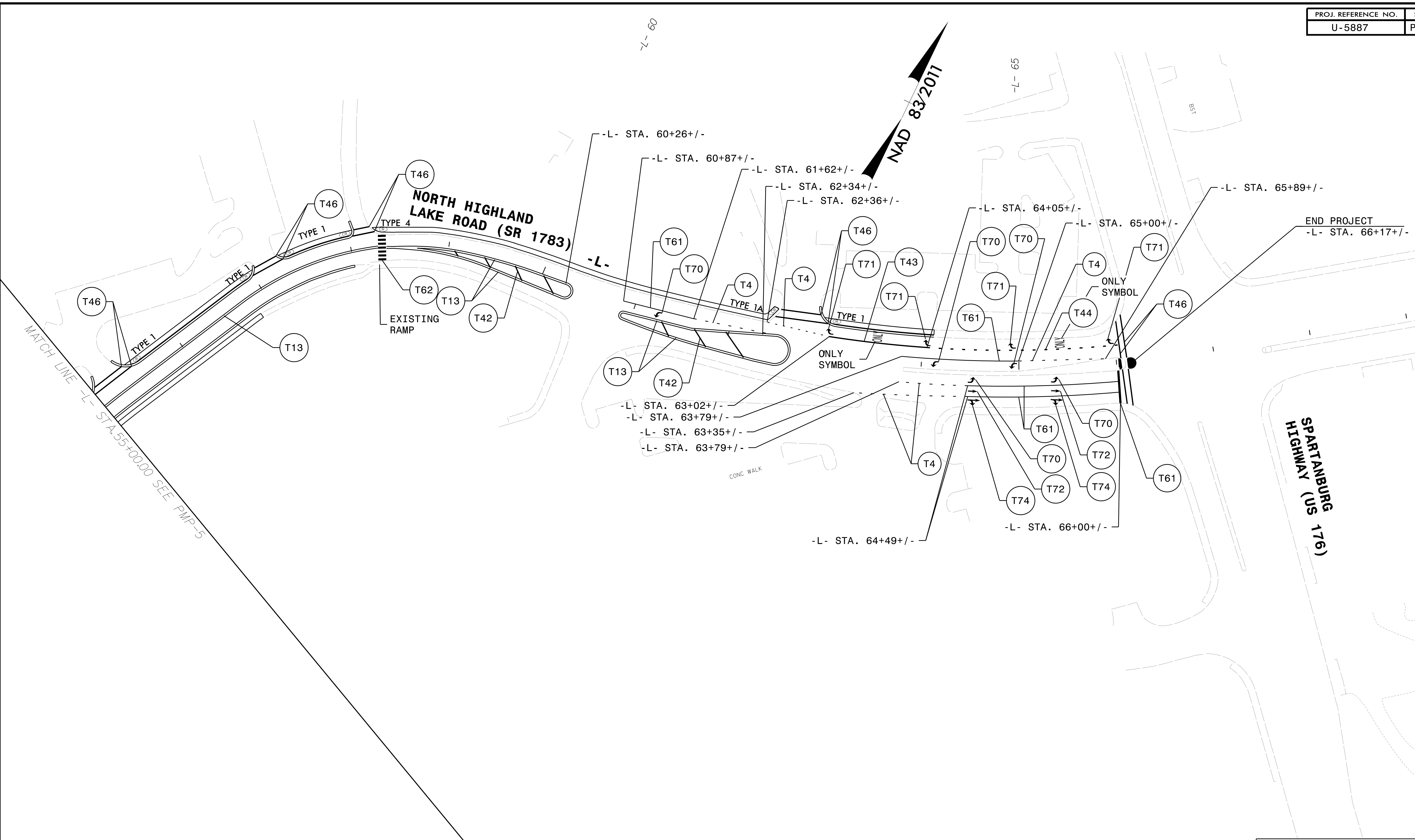

SEE SHEETS 2C-1 THRU 2C-3 FOR CURB RAMP DETAILS

7/21/2020
 V:\Asheville\Transportation\31535-06 U-5887\TrafficControl\TCP\U-5887_PMP6.dgn
 User:tcimar\ell

APPROVED: *Reece M. Schuler*
 DATE: 7/21/2020

SEAL

DOCUMENT NOT CONSIDERED FINAL
 UNLESS ALL SIGNATURES COMPLETED

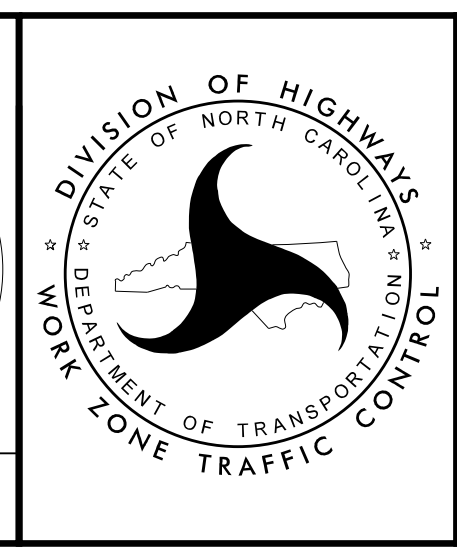

DIVISION OF HIGHWAYS
 NORTH CAROLINA
 DEPARTMENT OF TRANSPORTATION
 WORK ZONE TRAFFIC CONTROL

PAVEMENT MARKING PLAN