

09/08/99

**TIP PROJECT: R-5020B**

STATE OF NORTH CAROLINA  
DIVISION OF HIGHWAYS

|            |           |
|------------|-----------|
| T.I.P. NO. | SHEET NO. |
| R-5020B    | UO-1      |

**NOTE:**  
ALL UTILITY WORK SHOWN ON THIS SHEET IS DONE BY OTHERS.  
NO PAYMENT WILL BE MADE TO THE CONTRACTOR FOR UTILITY WORK SHOWN ON THIS SHEET.

# UTILITIES BY OTHERS PLANS COLUMBUS COUNTY

**LOCATION: US 701 BYPASS (MADISON STREET-JK POWELL BLVD.)  
FROM SR 1437 (VIRGIL AVENUE) TO US 7476**

**TYPE OF WORK: AERIAL/BURIED POWER (DISTRIBUTION),  
AERIAL/BURIED COMMUNICATION & GAS RELOCATIONS**

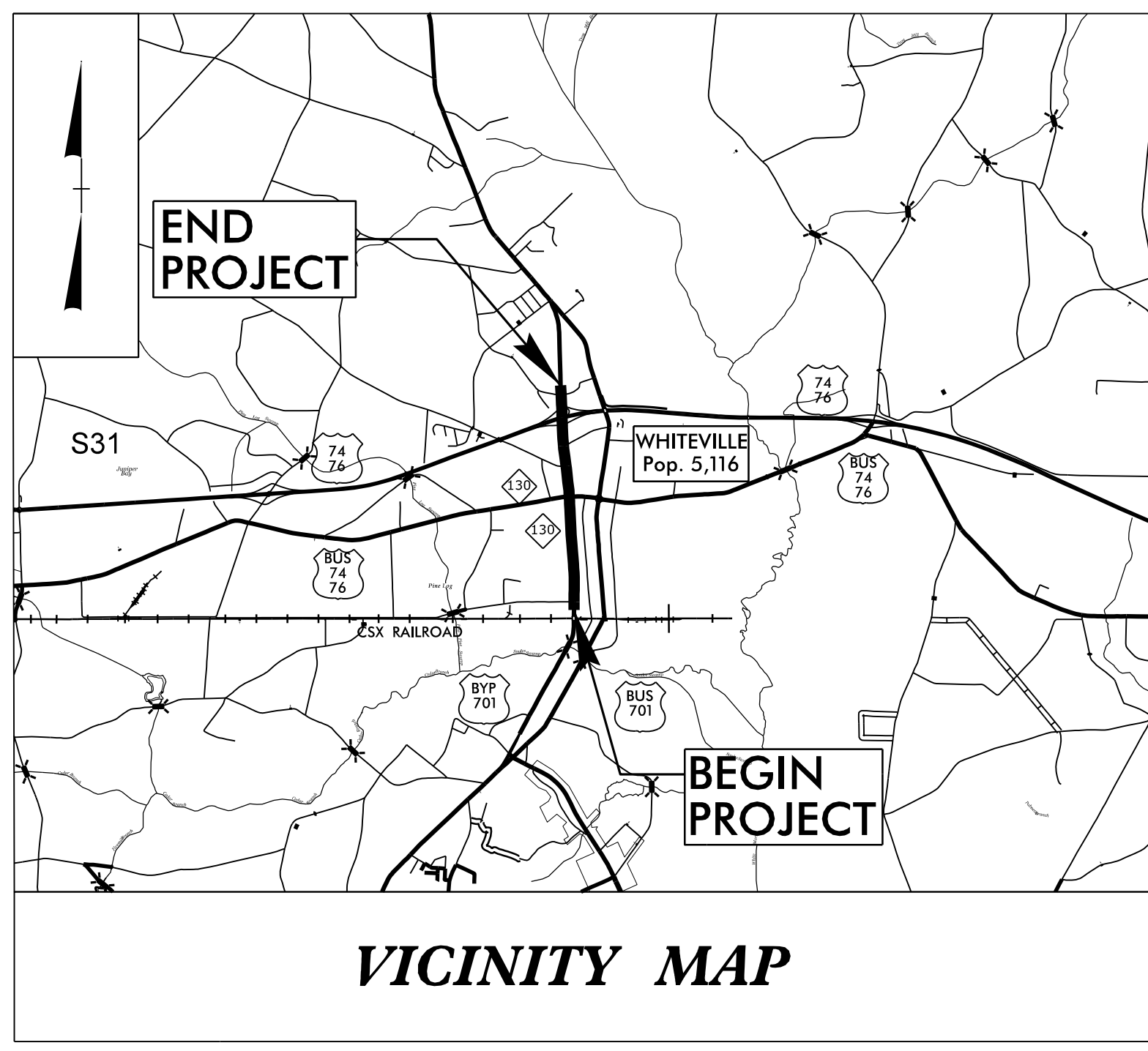

**END TIP PROJECT R-5020B  
-L- POT STA 289+75.00**

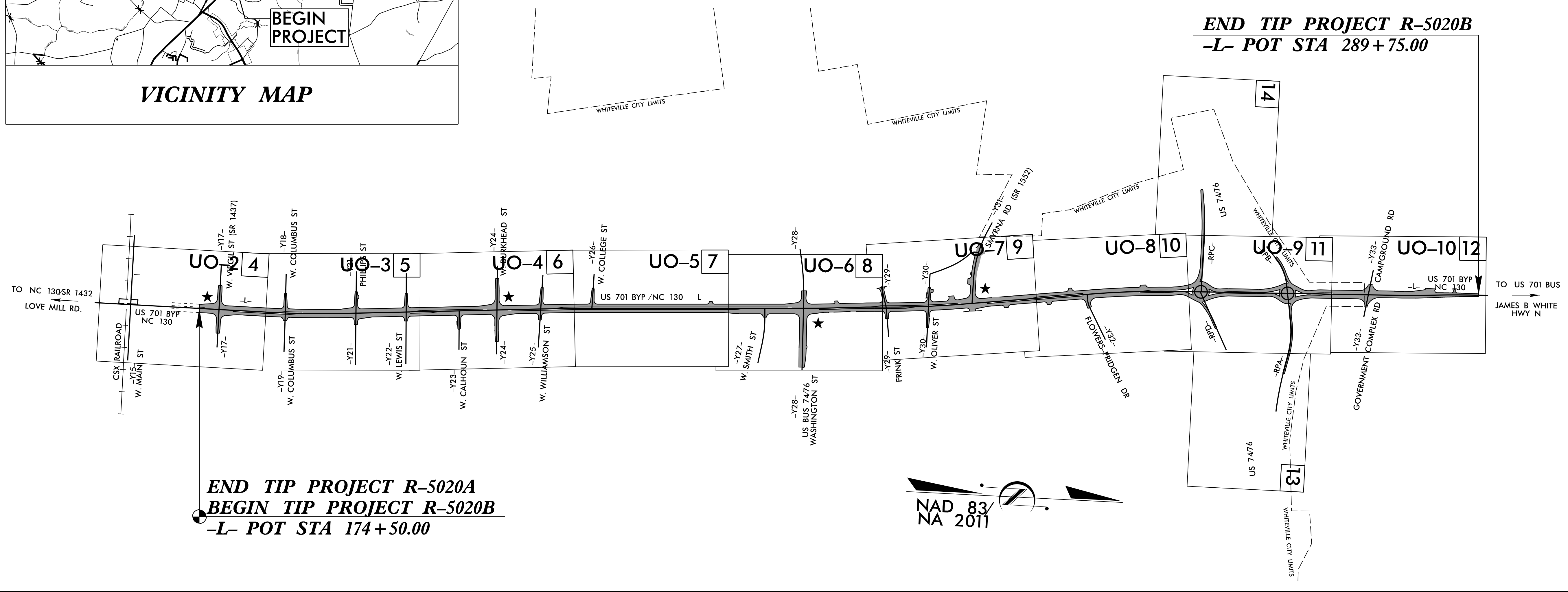

**END TIP PROJECT R-5020A  
BEGIN TIP PROJECT R-5020B  
-L- POT STA 174+50.00**

NAD 83  
NA 2011

**GRAPHIC SCALES**

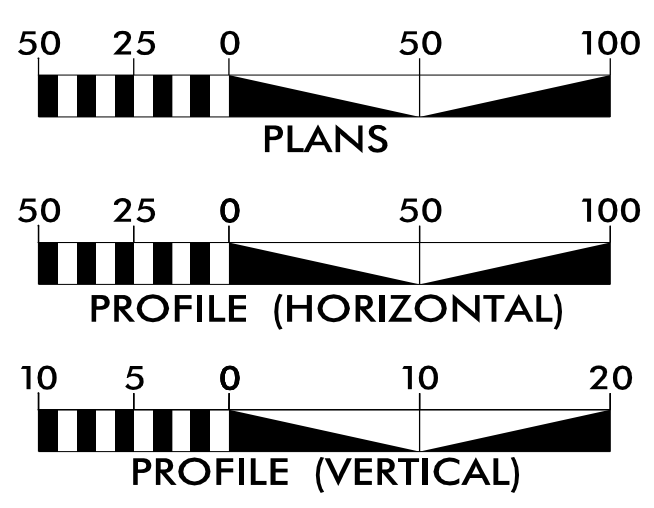

**INDEX OF SHEETS**

| SHEET NO.:      | DESCRIPTION:    |
|-----------------|-----------------|
| UO-1            | TITLE SHEET     |
| UO-2 THRU UO-10 | UBO PLAN SHEETS |

**UTILITY OWNERS WITH CONFLICTS**

- (A) POWER (DISTRIBUTION) - DUKE ENERGY
- (B) COMMUNICATIONS - SPECTRUM
- (C) COMMUNICATIONS - CENTURYLINK
- (D) GAS - PIEDMONT NATURAL GAS
- (E) COMMUNICATIONS - MCNC

PREPARED IN THE OFFICE OF:

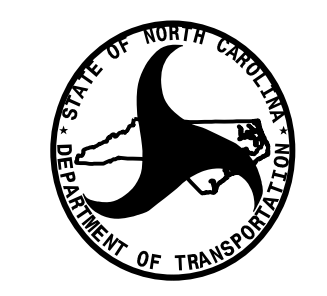

**DIVISION OF HIGHWAYS  
DIVISION 6**  
558 GILLESPIE ST.  
FAYETTEVILLE, NC 28301

**JOHN FAISON** UTILITY PROJECT MANAGER  
**JOHN FAISON** PROJECT UTILITY COORDINATOR  
**DANIEL ALLEN** PROJECT UTILITY DESIGNER

**RANDY ROGERS** DIV. UTILITY COORDINATOR  
**RICK HANDLIN** DIV. UTILITY ENGINEER  
**STEVEN KENDALL, P.E.** PROJECT ENGINEER

11-JUN-2020 08:21  
M:\2016\22161889\_NCDOT R-5020B\Utilities\290\_00L\_R5020B\_ut\_tsh\_U001.psh.dgn  
\$\$\$\$\$SERVNAME\$\$\$\$\$



### UTILITIES BY OTHERS

**NOTE:**  
 ALL UTILITY WORK SHOWN ON THIS SHEET IS DONE BY OTHERS.  
 NO PAYMENT WILL BE MADE TO THE CONTRACTOR FOR UTILITY WORK SHOWN ON THIS SHEET.

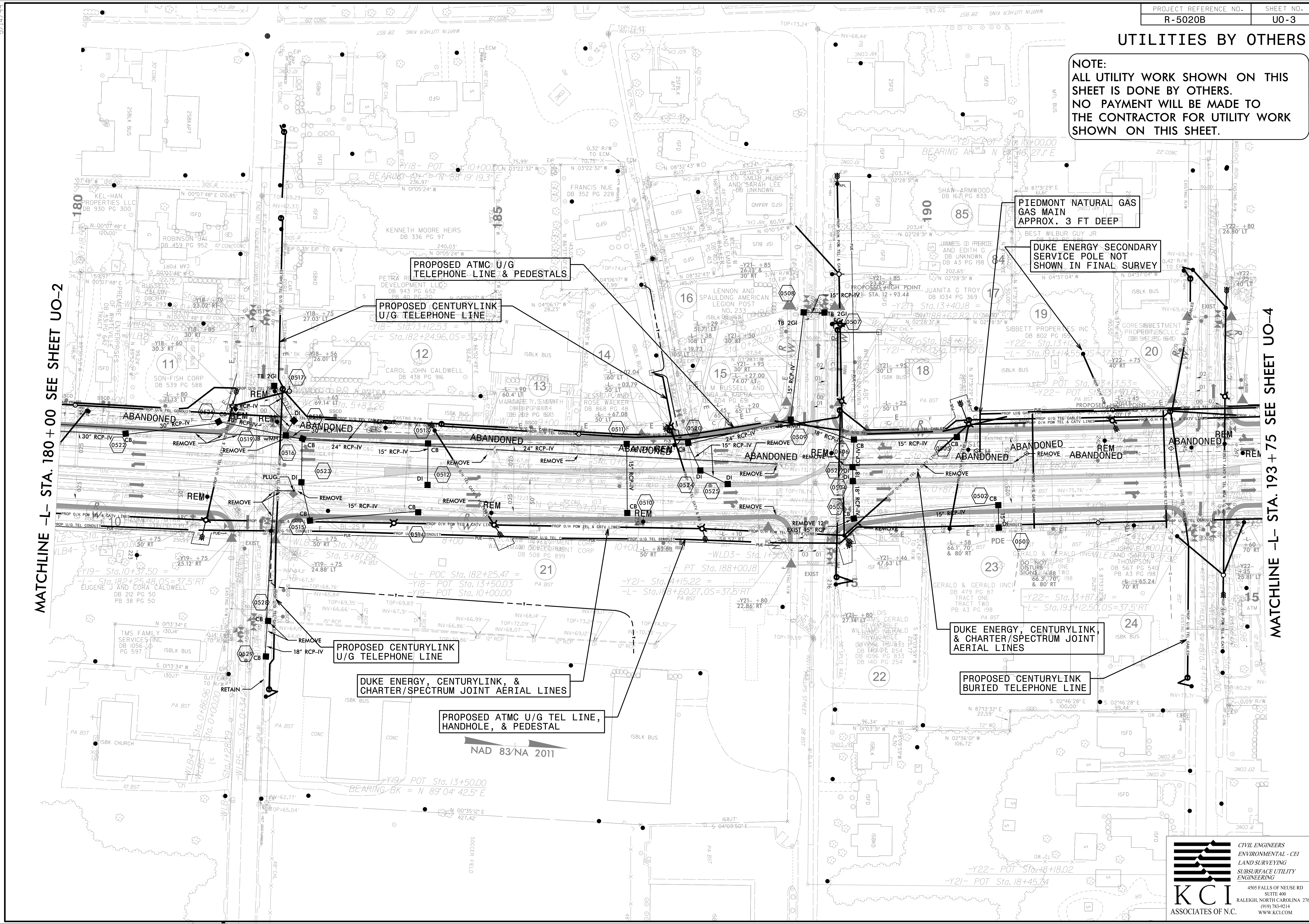

### UTILITIES BY OTHERS

**NOTE:**  
 ALL UTILITY WORK SHOWN ON THIS SHEET IS DONE BY OTHERS.  
 NO PAYMENT WILL BE MADE TO THE CONTRACTOR FOR UTILITY WORK SHOWN ON THIS SHEET.

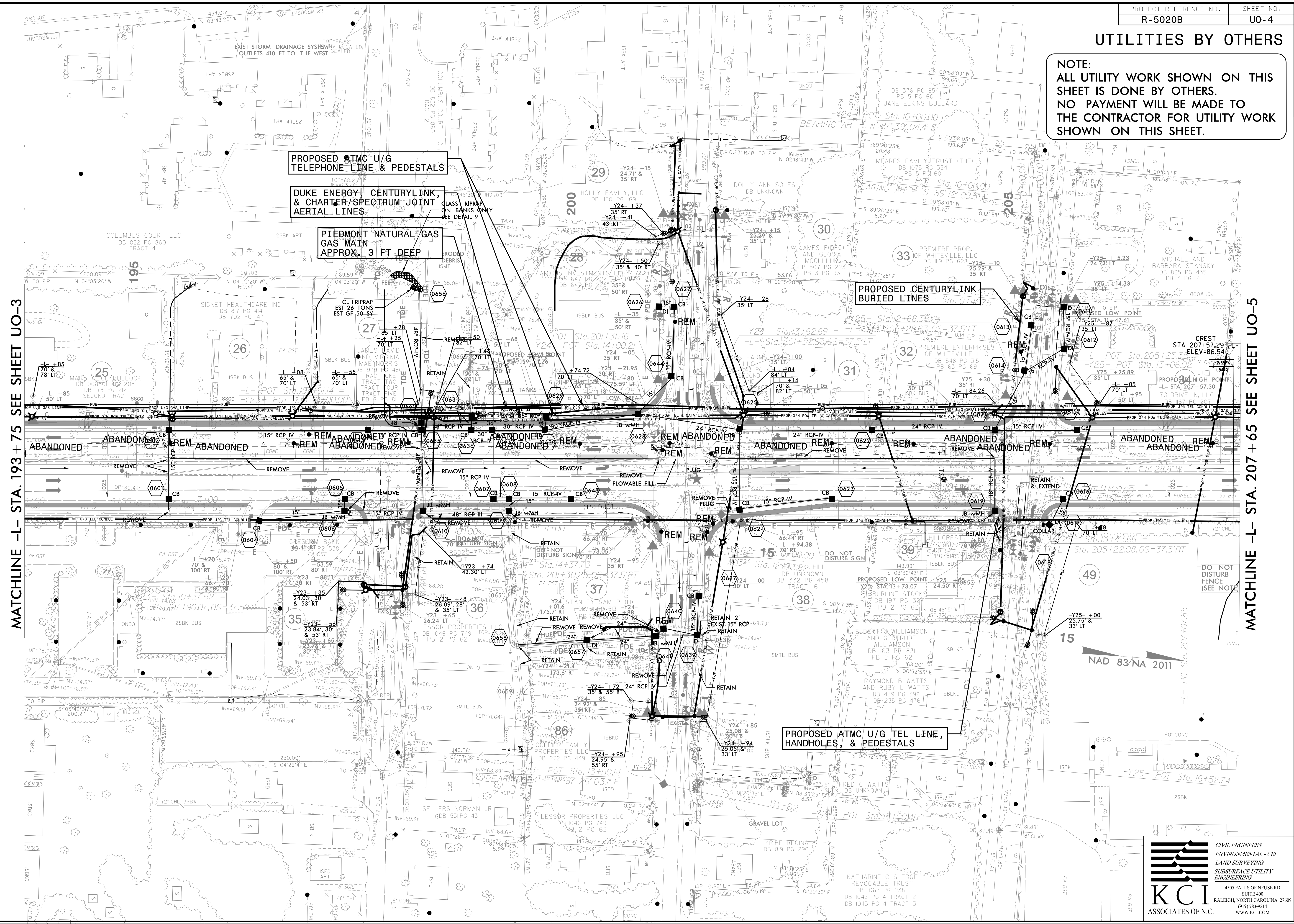

MATCHLINE -L- STA. 193 + 75 SEE SHEET UO-3

MATCHLINE -L- STA. 207 + 65 SEE SHEET UO-5

NAD 83/NA 2011

5/14/09  
 R-5020B.dwg  
 20110502  
 R:\Projects\2011\5020B\Utilities\20110502\_004\_R5020B.dwg  
 ut\_rdy6\_u004\_psh.dgn

### UTILITIES BY OTHERS

**NOTE:**  
 ALL UTILITY WORK SHOWN ON THIS SHEET IS DONE BY OTHERS.  
 NO PAYMENT WILL BE MADE TO THE CONTRACTOR FOR UTILITY WORK SHOWN ON THIS SHEET.

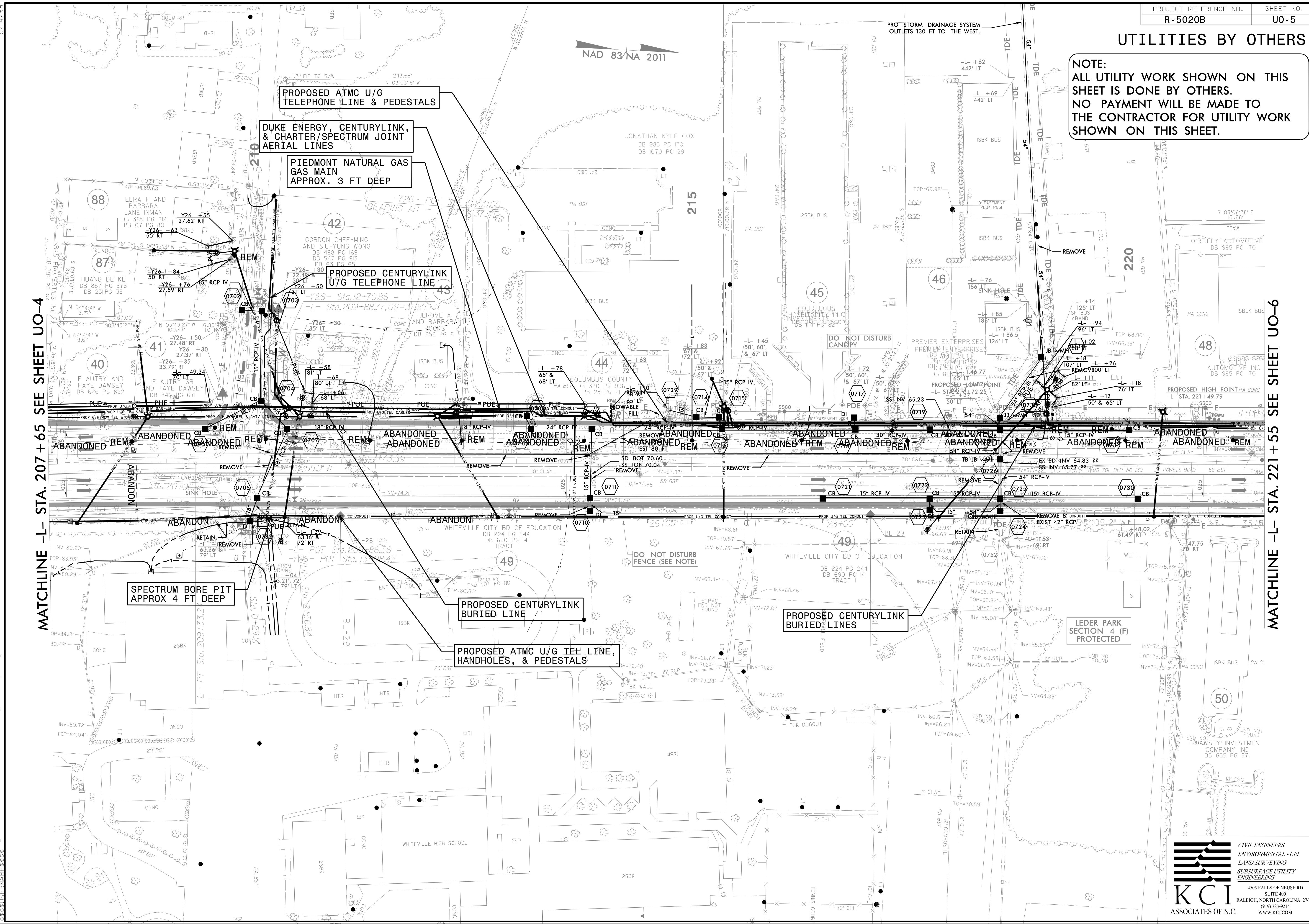

MATCHLINE -L- STA. 207 + 65 SEE SHEET UO-4

MATCHLINE -L- STA. 221 + 55 SEE SHEET UO-6

NAD 83/NA 2011

5/14/99  
 24-FEB-2015 13:33:33 R-5020B.dwg  
 T:\R-5020B\Drawings\Utilities\230-005-R5020B.ut\_r.dwg  
 T:\R-5020B\Drawings\Utilities\230-005-R5020B.ut\_r.dwg  
 T:\R-5020B\Drawings\Utilities\230-005-R5020B.ut\_r.dwg

### UTILITIES BY OTHERS

**NOTE:**  
ALL UTILITY WORK SHOWN ON THIS SHEET IS DONE BY OTHERS.  
NO PAYMENT WILL BE MADE TO THE CONTRACTOR FOR UTILITY WORK SHOWN ON THIS SHEET.



MATCHLINE -L- STA. 221+55 SEE SHEET UO-5

MATCHLINE -L- STA. 235+40 SEE SHEET UO-7

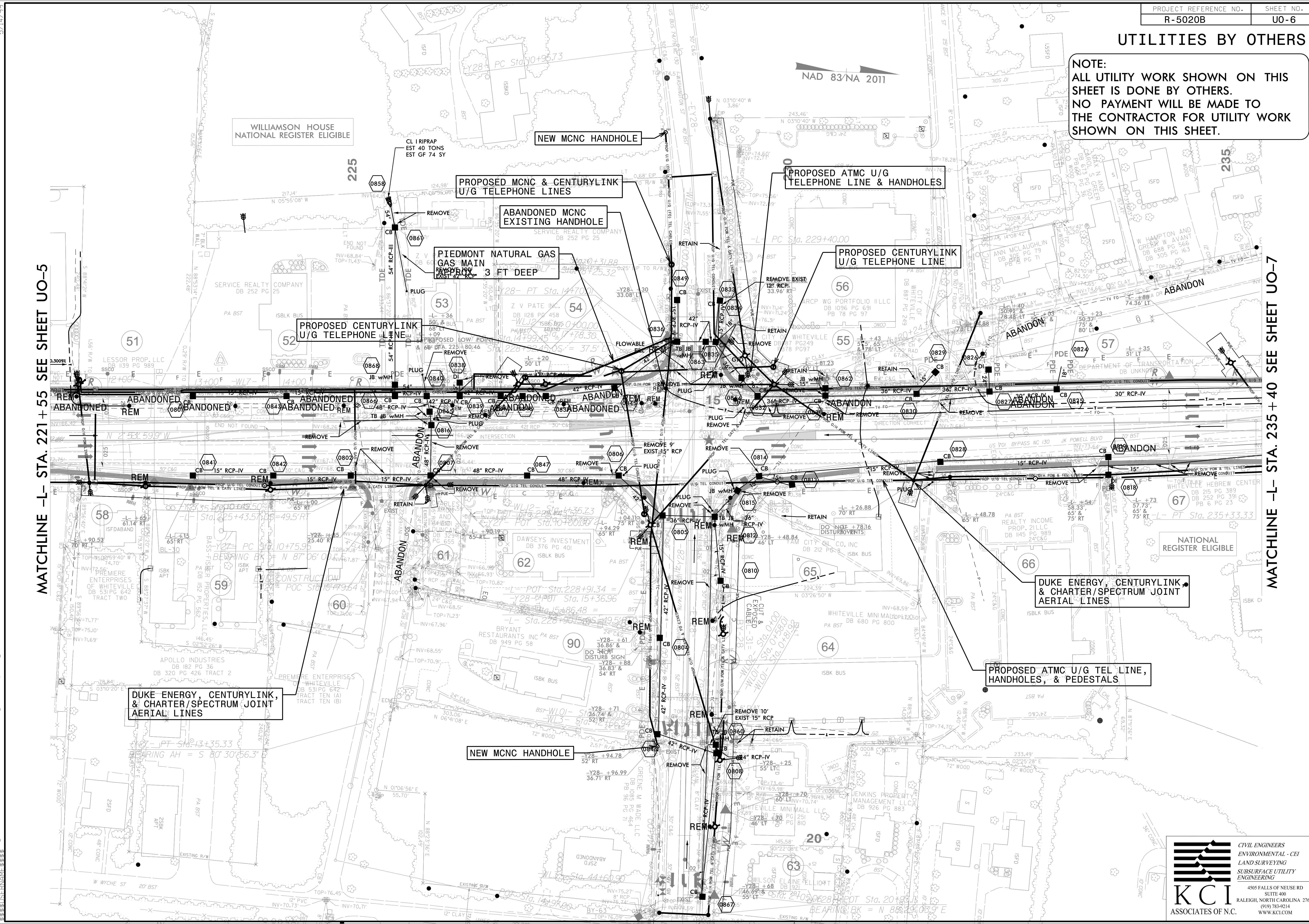

**DUKE ENERGY, CENTURYLINK, & CHARTER/SPECTRUM JOINT AERIAL LINES**

**NEW MCNC HANDHOLE**

**PROPOSED ATMC U/G TEL LINE, HANDHOLES, & PEDESTALS**

**DUKE ENERGY, CENTURYLINK & CHARTER/SPECTRUM JOINT AERIAL LINES**

**PROPOSED ATMC U/G TELEPHONE LINE & HANDHOLES**

**PROPOSED MCNC & CENTURYLINK U/G TELEPHONE LINES**

**ABANDONED MCNC EXISTING HANDHOLE**

**PIEDMONT NATURAL GAS GAS MAIN 3 FT DEEP**

**PROPOSED CENTURYLINK U/G TELEPHONE LINE**

**CIVIL ENGINEERS  
ENVIRONMENTAL - CEI  
LAND SURVEYING  
SUBSURFACE UTILITY  
ENGINEERING**

**KCI**  
ASSOCIATES OF N.C.

4505 FALLS OF NEUSE RD  
SUITE 400  
RALEIGH, NORTH CAROLINA 27609  
(919) 783-9214  
WWW.KCI.COM

5/14/99  
24-FEB-2015 17:00:00  
T:\R-5020B\Drawings\Utilities\230\_006\_R5020B.ut\_rdy8\_U006.psh.dgn



### UTILITIES BY OTHERS

**NOTE:**  
 ALL UTILITY WORK SHOWN ON THIS SHEET IS DONE BY OTHERS.  
 NO PAYMENT WILL BE MADE TO THE CONTRACTOR FOR UTILITY WORK SHOWN ON THIS SHEET.

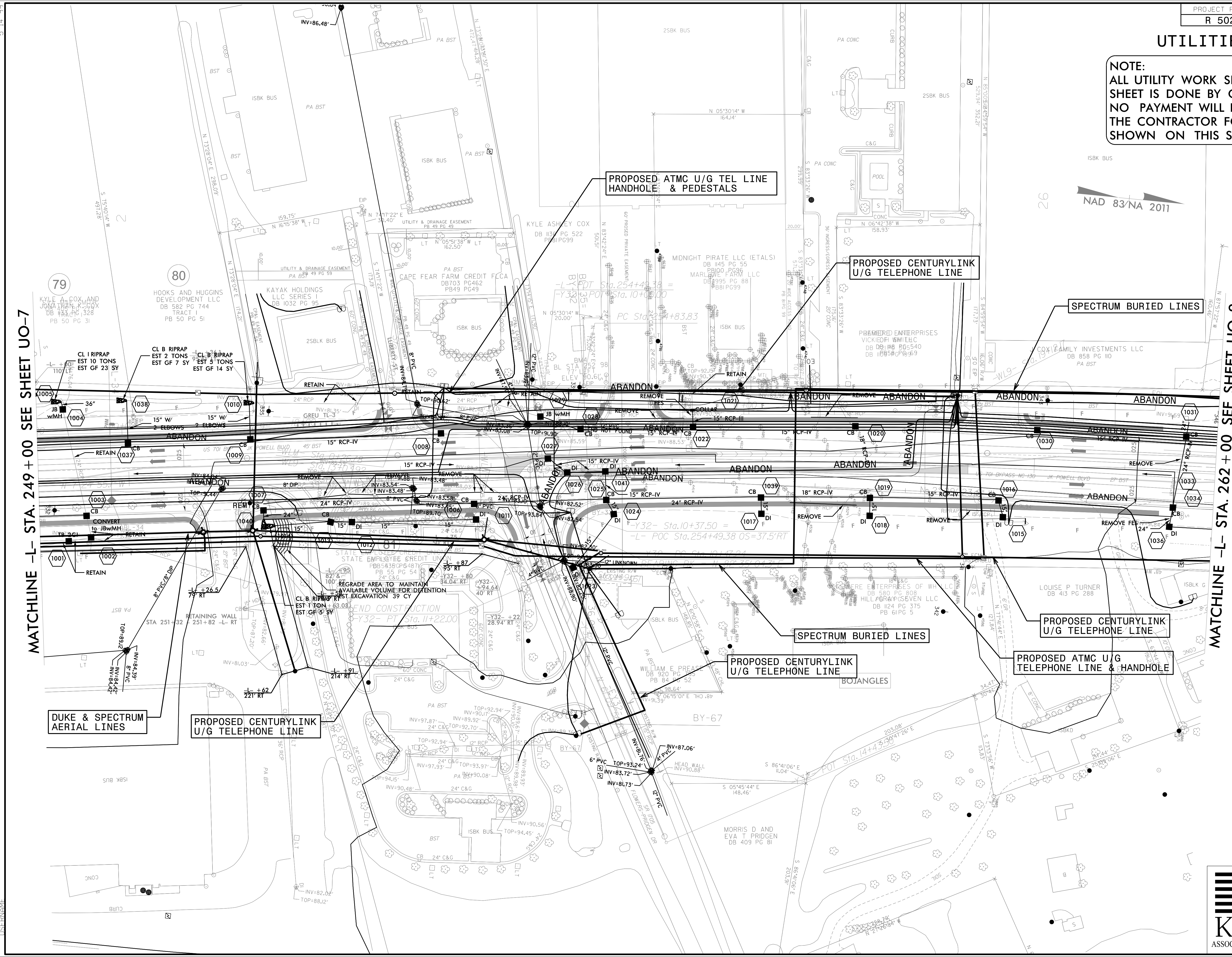

MATCHLINE -L- STA. 249 + 00 SEE SHEET UO-7

MATCHLINE -L- STA. 262 + 00 SEE SHEET UO-9

NAD 83/NA 2011

5.14.99  
 10 U 08  
 290 008 R5020B  
 U  
 JAN 20 2014 33  
 R-5020B  
 USE NAME



### UTILITIES BY OTHERS

**NOTE:**  
 ALL UTILITY WORK SHOWN ON THIS SHEET IS DONE BY OTHERS.  
 NO PAYMENT WILL BE MADE TO THE CONTRACTOR FOR UTILITY WORK SHOWN ON THIS SHEET.

MATCHLINE -RPC- STA. 19+50 SEE SHEET 14

MATCHLINE -L- STA. 262+00 SEE SHEET UO-8

MATCHLINE -L- STA. 275+90 SEE SHEET UO-10

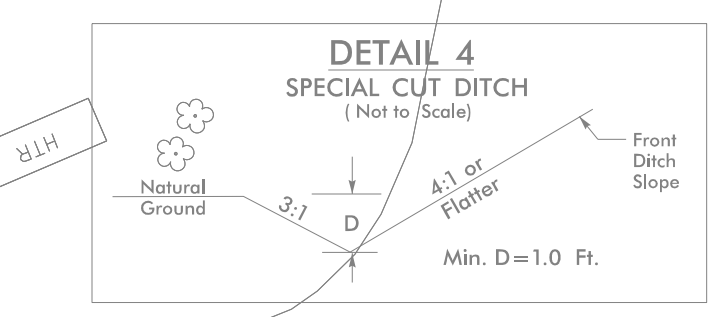
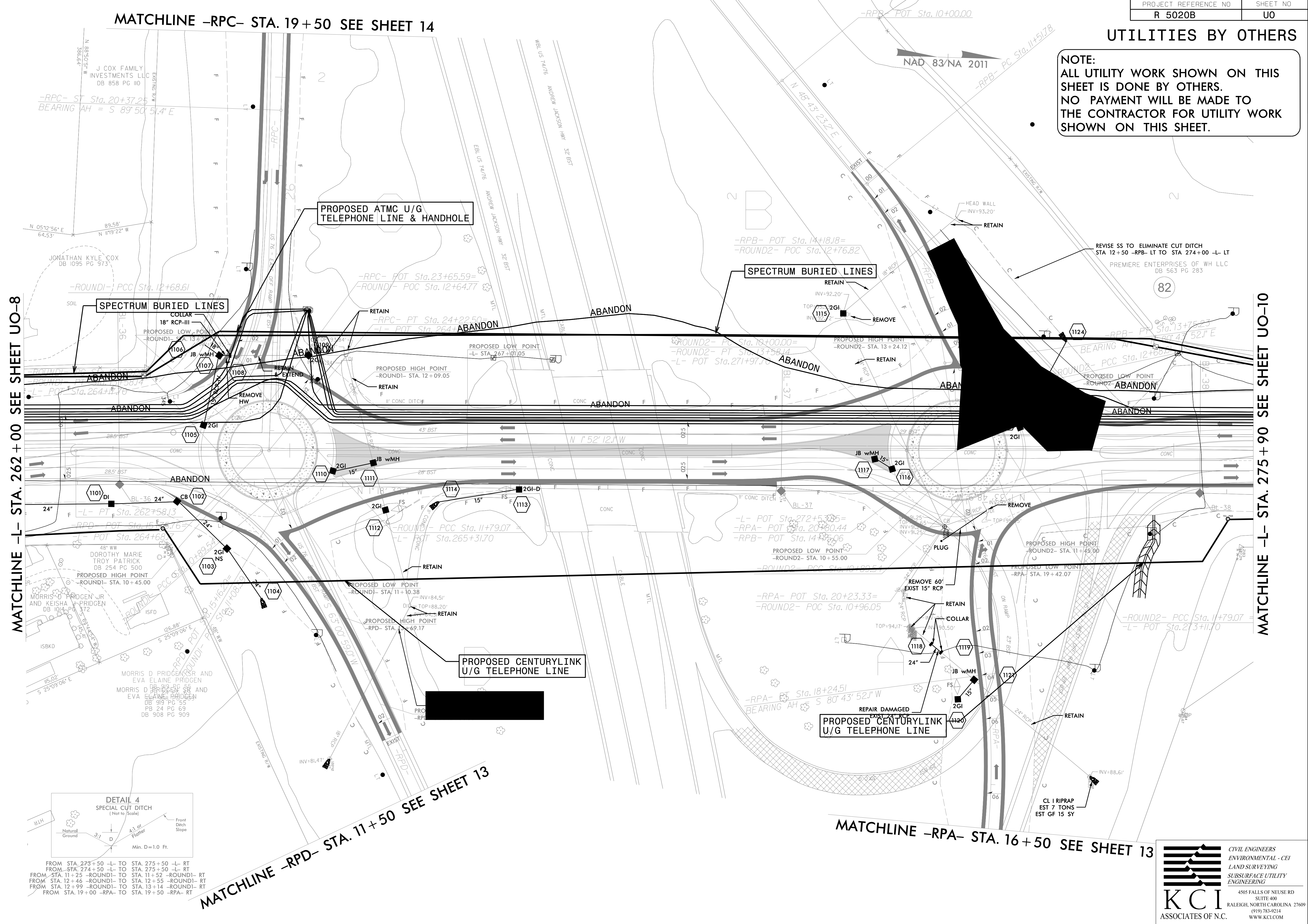

FROM STA. 273+50 -L- TO STA. 275+50 -L- RT  
 FROM STA. 274+50 -L- TO STA. 275+50 -L- RT  
 FROM STA. 11+25 -ROUND1- TO STA. 11+52 -ROUND1- RT  
 FROM STA. 12+46 -ROUND1- TO STA. 12+55 -ROUND1- RT  
 FROM STA. 12+99 -ROUND1- TO STA. 13+14 -ROUND1- RT  
 FROM STA. 19+00 -RPA- TO STA. 19+50 -RPA- RT

MATCHLINE -RPD- STA. 11+50 SEE SHEET 13

MATCHLINE -RPA- STA. 16+50 SEE SHEET 13

**CIVIL ENGINEERS**  
**ENVIRONMENTAL - CEI**  
**LAND SURVEYING**  
**SUBSURFACE UTILITY ENGINEERING**

4505 FALLS OF NEUSE RD  
 SUITE 400  
 RALEIGH, NORTH CAROLINA 27609  
 (919) 783-9214  
 WWW.KCI.COM

5.14.99  
 11 U 09  
 290.009 R5020B  
 U  
 JUN-2014 35  
 R-5020B USE ENGINEERING

