

STATE OF NORTH CAROLINA
DIVISION OF HIGHWAYS

TRANSPORTATION MANAGEMENT PLAN

**BEAUFORT COUNTY
BRIDGE #060043**

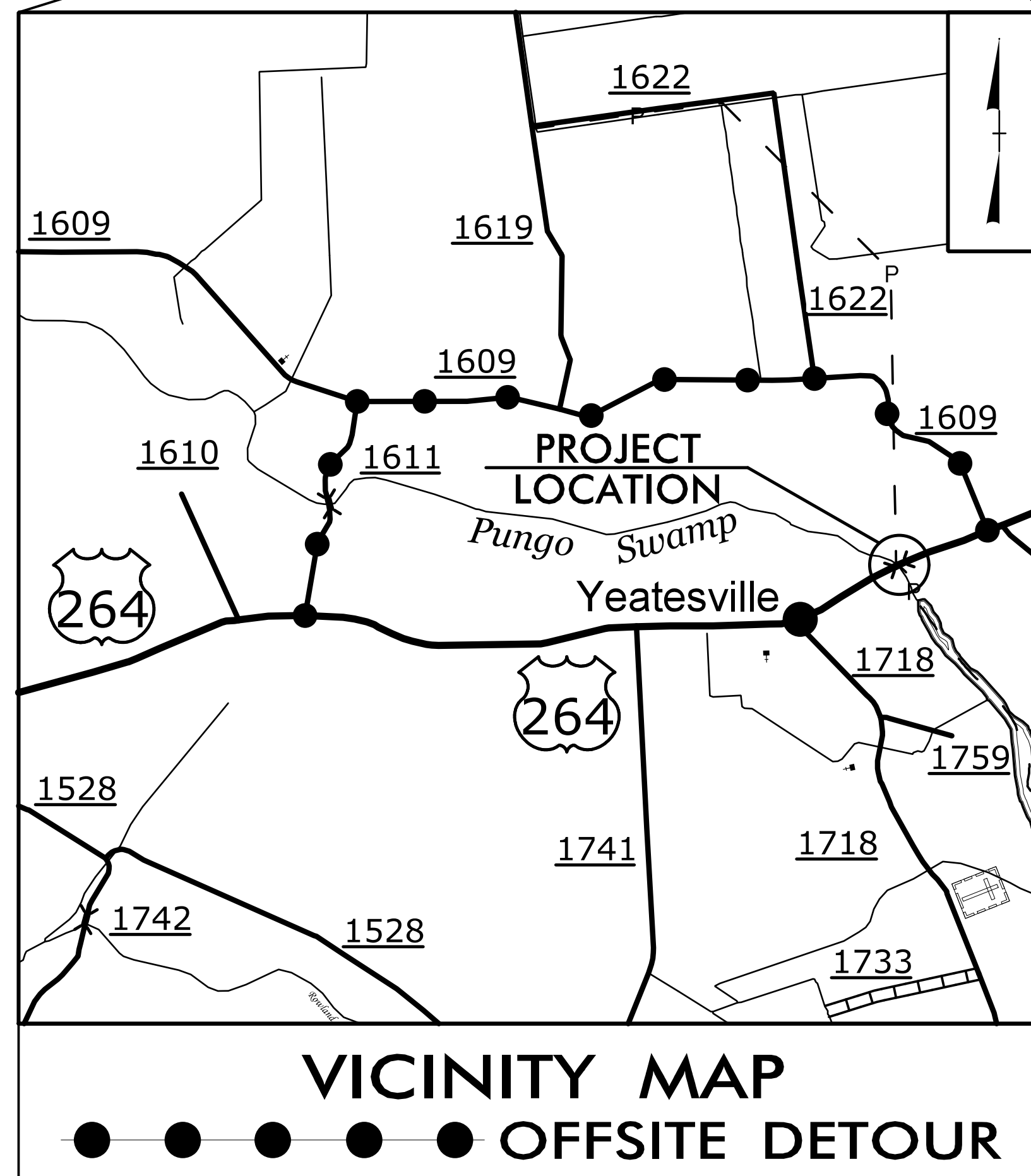
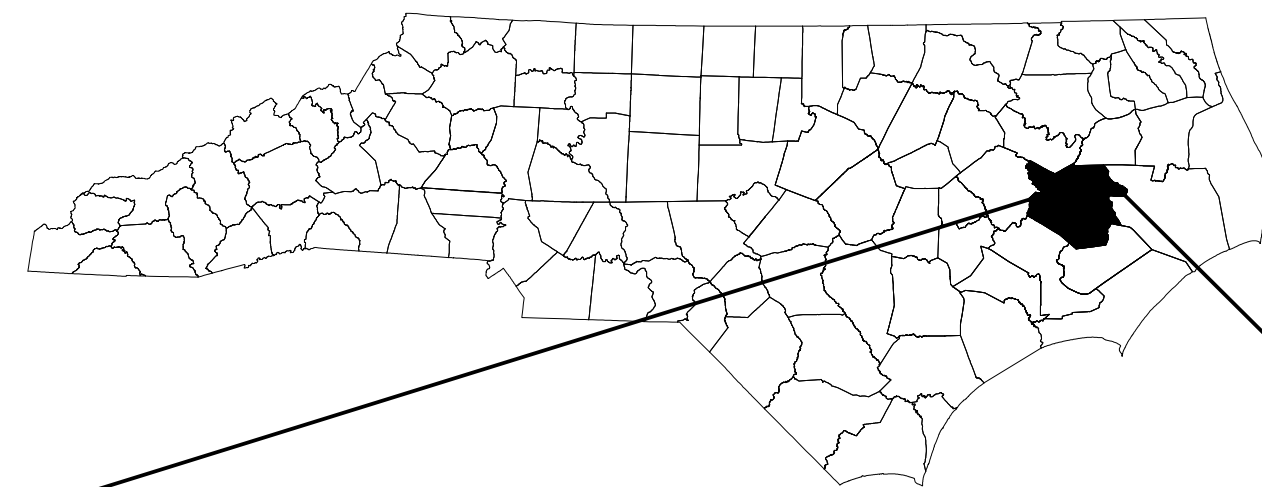

NCDOT CONTACT INFORMATION:
Phone: 919 707 6442 Fax: 919 250 4082
DAVID STUTTS, PE
Project Engineer - PEF/Program Mgmt.

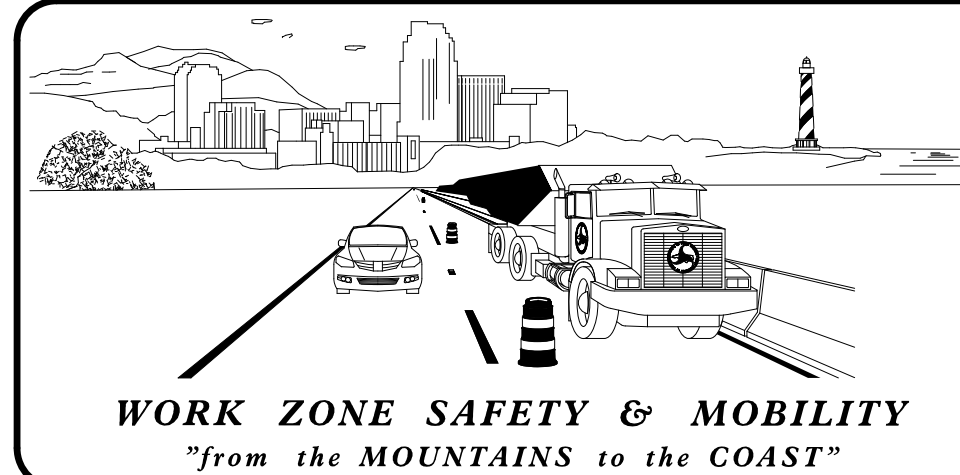

PLAN PREPARED FOR N.C.D.O.T. BY:

TGS ENGINEERS
706 HILLSBOROUGH ST.
SUITE 200
RALEIGH, NC 27603
PH (919) 773-8887
CORP. LICENSE NO. : C-0275

TOMMY REGISTER, PE PROJECT ENGINEER
DESIGN ENGINEER

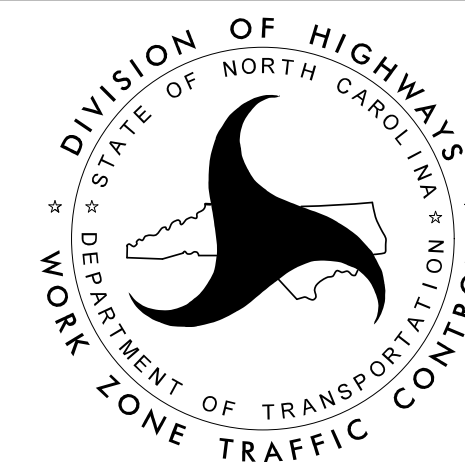

**DOCUMENT NOT CONSIDERED FINAL
UNLESS ALL SIGNATURES COMPLETED**

APPROVED: *Tommy Register, PE*
DATE: 1/26/2021 | 9:29 AM PST

SEAL



INDEX OF SHEETS

SHEET NO.	TITLE
TMP-1	TITLE SHEET, VICINITY MAP, AND INDEX OF SHEETS
TMP-1A	LIST OF APPLICABLE ROADWAY STANDARD DRAWINGS, AND LEGEND
TMP-1B	TRANSPORTATION OPERATIONS PLAN: (MANAGEMENT STRATEGIES, GENERAL NOTES, AND LOCAL NOTES)
TMP-2	OVERVIEW AND PHASING
TMP-3	OFFSITE DETOUR LOCATION AND BARRICADE PLACEMENT

SHEET NO.
TMP-1

PROJECT: B-4414

ROADWAY STANDARD DRAWINGS

THE FOLLOWING ROADWAY STANDARDS AS SHOWN IN "ROADWAY STANDARD DRAWINGS" - PROJECT SERVICES UNIT - N.C. DEPARTMENT OF TRANSPORTATION - RALEIGH, N.C., DATED JANUARY 2018 ARE APPLICABLE TO THIS PROJECT AND BY REFERENCE HEREBY ARE CONSIDERED A PART OF THESE PLANS:

STD. NO.	TITLE
1205.01	PAVEMENT MARKINGS - LINE TYPES AND OFFSETS
1205.02	PAVEMENT MARKINGS - TWO-LANE AND MULTI-LANE ROADWAYS
1205.12	PAVEMENT MARKINGS - BRIDGES

NOTE: NCDOT DIVISION 2 WILL PROVIDE AND MAINTAIN ALL TEMPORARY ROAD CLOSURE AND DETOUR SIGNING AND DEVICES.

LEGEND

GENERAL

- DIRECTION OF TRAFFIC FLOW
- DIRECTION OF PEDESTRIAN TRAFFIC FLOW
- EXIST. PVMT.
- NORTH ARROW
- PROPOSED PVMT.
- TEMP. SHORING (LOCATION PURPOSES ONLY)

WORK AREA

REMOVAL

SIGNALS

- EXISTING
- PROPOSED
- TEMPORARY

PAVEMENT MARKINGS

- EXISTING LINES
- TEMPORARY LINES

TRAFFIC CONTROL DEVICES

- BARRICADE (TYPE III)
- CONE
- DRUM SKINNY DRUM TUBULAR MARKER
- TEMPORARY CRASH CUSHION
- FLASHING ARROW BOARD
- FLAGGER
- LAW ENFORCEMENT
- TRUCK MOUNTED ATTENUATOR (TMA)
- CHANGEABLE MESSAGE SIGN

TEMPORARY SIGNING

- PORTABLE SIGN
- STATIONARY SIGN
- STATIONARY OR PORTABLE SIGN

PAVEMENT MARKERS

- CRYSTAL/CRYSTAL
- CRYSTAL/RED
- YELLOW/YELLOW

PAVEMENT MARKING SYMBOLS

- PAVEMENT MARKING SYMBOLS

I:\1\2021\11\11\ncdot\B-4414\TrafficControl\Top\B-4414_TC_TMP_01A\STA & Legend.dgn User: bbevans

APPROVED: DATE: 1/26/2021 9:29 AM SEAL			ROADWAY STANDARD DRAWINGS & LEGEND
DOCUMENT NOT CONSIDERED FINAL UNLESS ALL SIGNATURES COMPLETED			

PROJ. REFERENCE NO.	SHEET NO.
B-4414	TMP-1B

TGS ENGINEERS
 706 HILLSBOROUGH ST.
 SUITE 200
 RALEIGH, NC 27603
 PH (919) 773-8887
 CORP. LICENSE NO.: C-0275

GENERAL NOTES

CHANGES MAY BE REQUIRED WHEN PHYSICAL DIMENSIONS IN THE DETAIL DRAWINGS, STANDARD DETAILS, AND ROADWAY DETAILS ARE NOT ATTAINABLE TO MEET FIELD CONDITIONS OR RESULT IN DUPLICATE OR UNDESIRE OVERLAPPING OF DEVICES. MODIFICATION MAY INCLUDE: MOVING, SUPPLEMENTING, COVERING, OR REMOVAL OF DEVICES AS DIRECTED BY THE ENGINEER.

THE FOLLOWING GENERAL NOTES APPLY AT ALL TIMES FOR THE DURATION OF THE CONSTRUCTION PROJECT EXCEPT WHEN OTHERWISE NOTED IN THE PLAN OR DIRECTED BY THE ENGINEER.

TRAFFIC PATTERN ALTERATIONS

- A) NOTIFY THE ENGINEER, COUNTY EMS, AND COUNTY SCHOOL OFFICIALS THIRTY (30) DAYS PRIOR TO ANY TRAFFIC PATTERN ALTERATION.

SIGNING

- B) ENSURE ALL NECESSARY SIGNING IS IN PLACE PRIOR TO ALTERING ANY TRAFFIC PATTERN.



MANAGEMENT STRATEGIES

DURING CONSTRUCTION OF THE PROPOSED STRUCTURE, US 264 WILL BE CLOSED TO THROUGH TRAFFIC. US 264 TRAFFIC WILL BE MAINTAINED ON THE FOLLOWING DETOUR: FROM SR 1609 (FREE UNION CHURCH RD) TO SR 1611 (JONES BRIDGE RD).

LOCAL NOTES

- 1) ACCESS TO ALL DRIVEWAYS MUST BE PROVIDED AT ALL TIMES WITHIN THE PROJECT LIMITS.
- 2) IN ORDER TO HAVE TIME TO ADEQUATELY REROUTE SCHOOL BUSES, BEAUFORT COUNTY SCHOOLS WILL BE CONTACTED AT LEAST ONE MONTH PRIOR TO ROAD CLOSURE AT (252)946-6209
- 3) BEAUFORT COUNTY EMERGENCY SERVICES WILL BE CONTACTED AT LEAST ONE MONTH PRIOR TO ROAD CLOSURE TO MAKE THE NECESSARY TEMPORARY REASSIGNMENTS TO PRIMARY RESPONSE UNITS AT (252) 946-2046

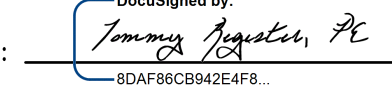
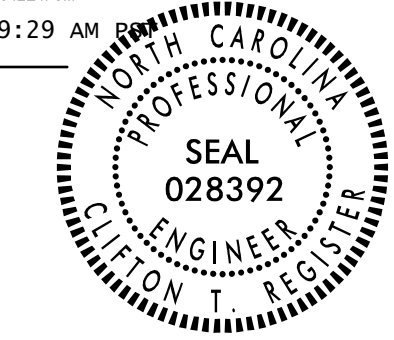
1/11/2021
 xx:\ncdo\4414\traffic\trafficcontrol\top\B-4414_TC_TMP_01B(TOP).dgn
 User: bbevans

APPROVED:  <small>8DAF86CB42E4F8...</small> DATE: 1/26/2021 9:29 AM <div style="text-align: center;">  SEAL </div>		<h1 style="margin: 0;">TRANSPORTATION OPERATIONS PLAN</h1>
DOCUMENT NOT CONSIDERED FINAL UNLESS ALL SIGNATURES COMPLETED		

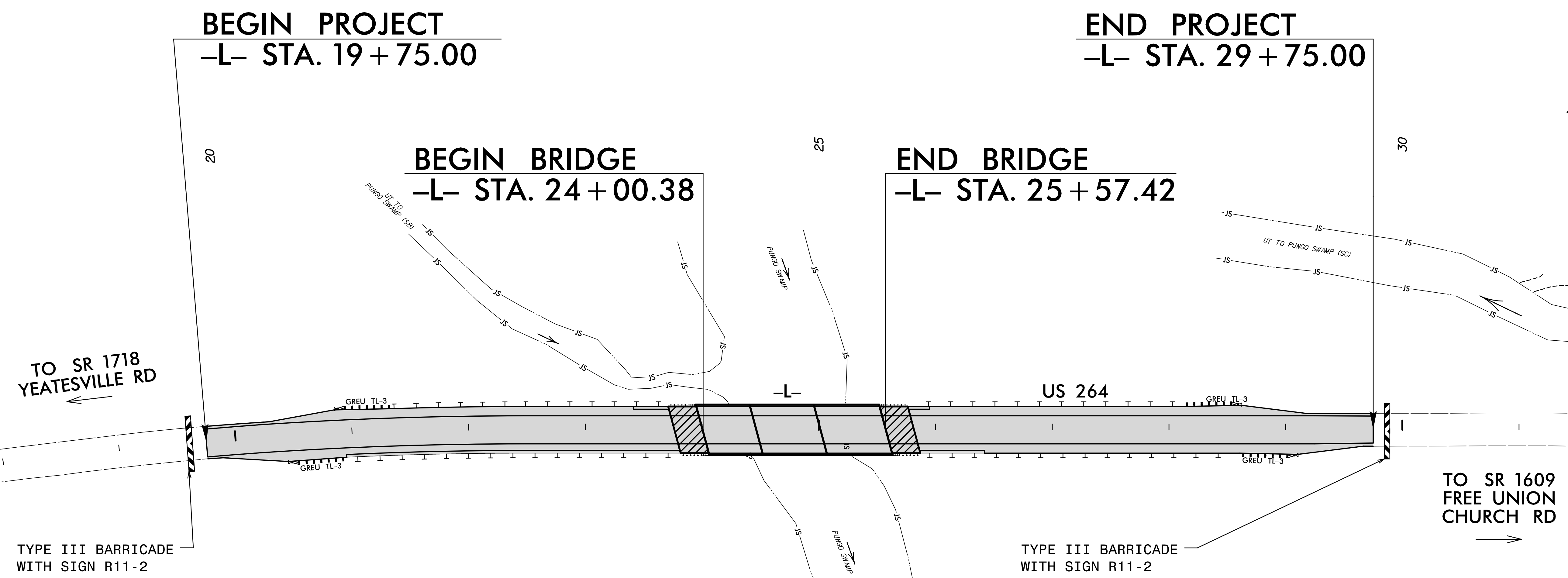
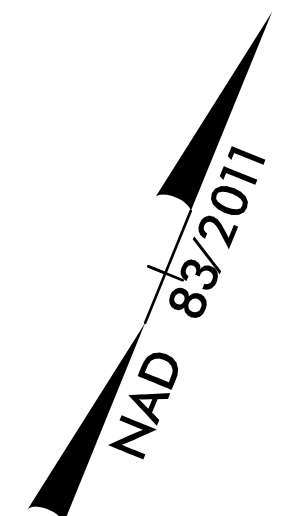

THE HISTORIC HIGH WATER MARK COULD NOT BE DETERMINED BY PHYSICAL OR PAROLE EVIDENCE

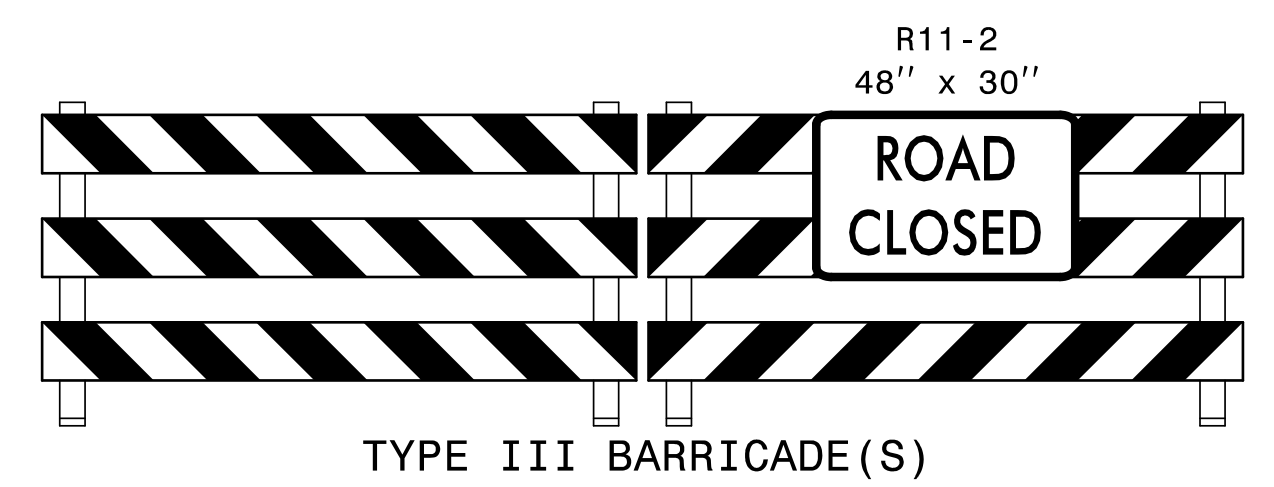

PHASING NOTES

- STEP 1: NCDOT DIVISION 2 WILL INSTALL CMS MESSAGE BOARD AND INSTALL ALL DETOUR ROUTE SIGNS AS SHOWN ON SHEET TMP-3.
- STEP 2: NCDOT DIVISION 2 WILL INSTALL TYPE III BARRICADES AND SIGNS, AND CLOSE US 264 TO TRAFFIC AS SHOWN IN ROADWAY STANDARD DRAWING 1101.03 (SHEET 1 OF 9) AND TMP-2 AND TMP-3.
 NCDOT DIVISION 2 WILL PLACE TRAFFIC ON DETOUR.
- STEP 3: DEMOLISH AND REMOVE THE EXISTING BRIDGE OVER PUNGO SWAMP.
 CONSTRUCT THE NEW BRIDGE OVER PUNGO SWAMP FROM -L- STA. 24+00.38 TO 25+57.42.
 CONSTRUCT THE ROADWAY ON US 264 FROM -L- STA. 19+75.00 TO -L- STA. 24+00.38 (BEGIN BRIDGE) AND FROM -L- STA. 25+57.42 (END BRIDGE) TO 29+75.00 UP TO AND INCLUDING THE FINAL LAYER OF SURFACE COURSE.
- STEP 4: REFERRING TO SHEET PMP-2, PLACE PERMANENT PAVEMENT MARKINGS ON THE FOLLOWING: US 264 FROM STA. 19+75.00 TO STA. 29+75.00.
- STEP 5: NCDOT DIVISION 2 WILL REMOVE BARRICADES, SIGNS, AND ALL OTHER WORK ZONE TRAFFIC CONTROL DEVICES AND OPEN US 264 TO TRAFFIC IN FINAL PATTERN.

APPROVED: *Thomas Aquilino, PE*
 DATE: 1/26/2021 | 9:29 AM
 SEAL
 NORTH CAROLINA PROFESSIONAL ENGINEER
 CLAYTON T. REGISTER
 SEAL 028392

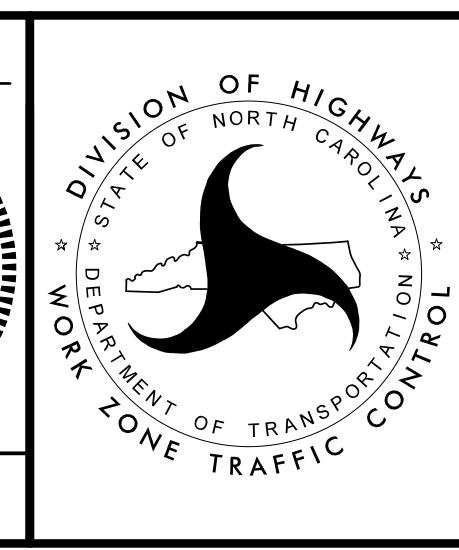

OVERVIEW AND PHASING

DOCUMENT NOT CONSIDERED FINAL UNLESS ALL SIGNATURES COMPLETED

L:\2021\11\26\pmp\4414\trafficcontrol\pmp-2\PHASING.dgn
 User: TGS\evans

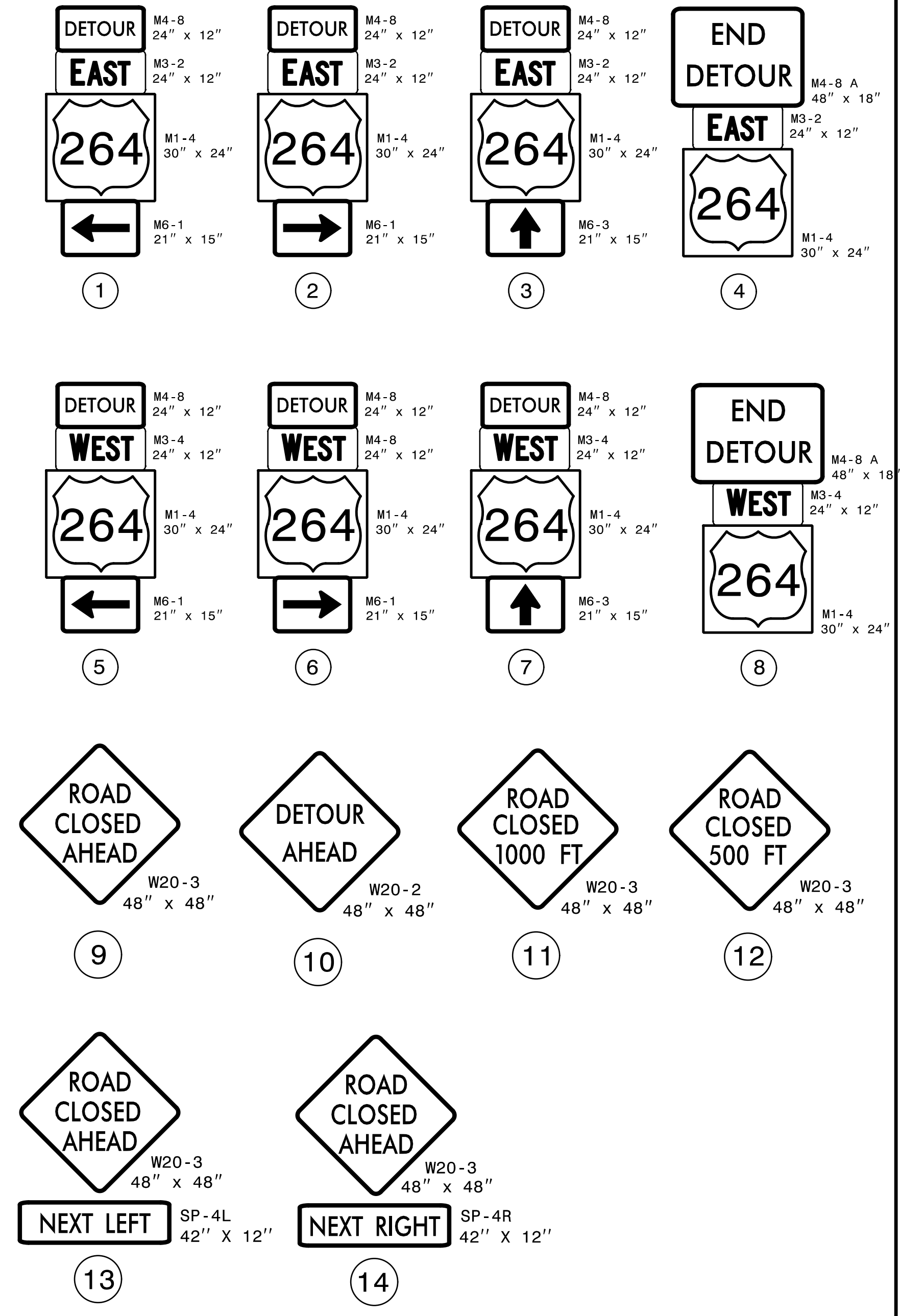
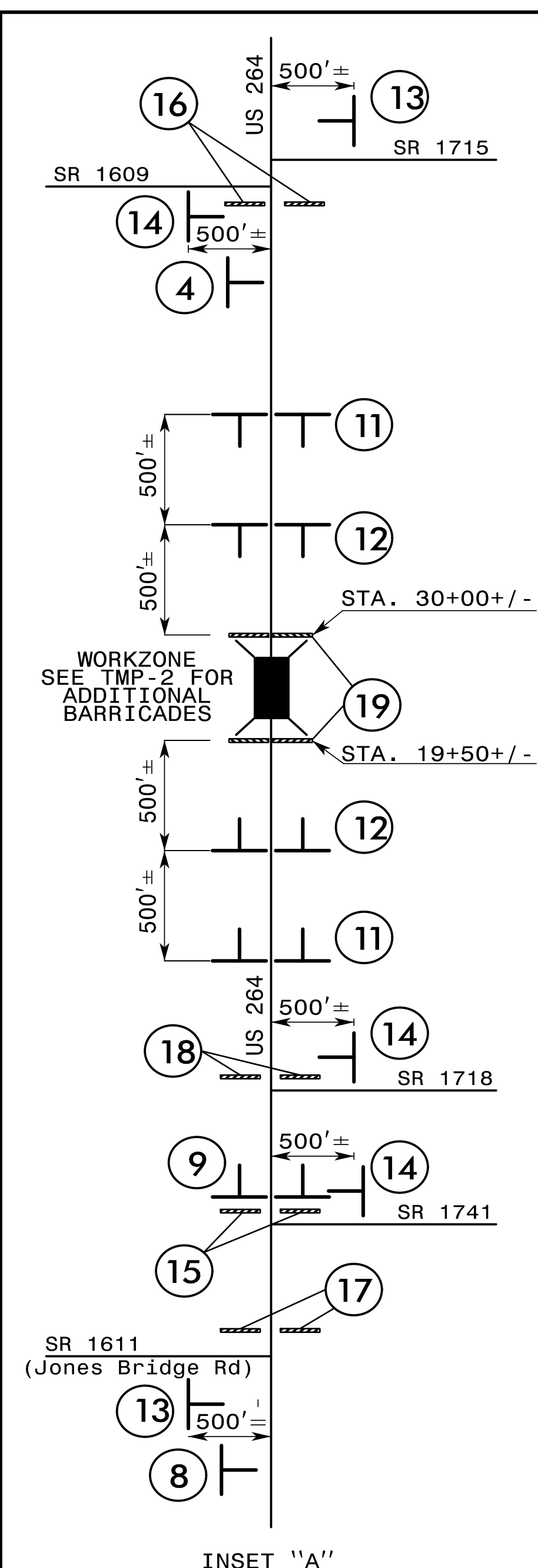
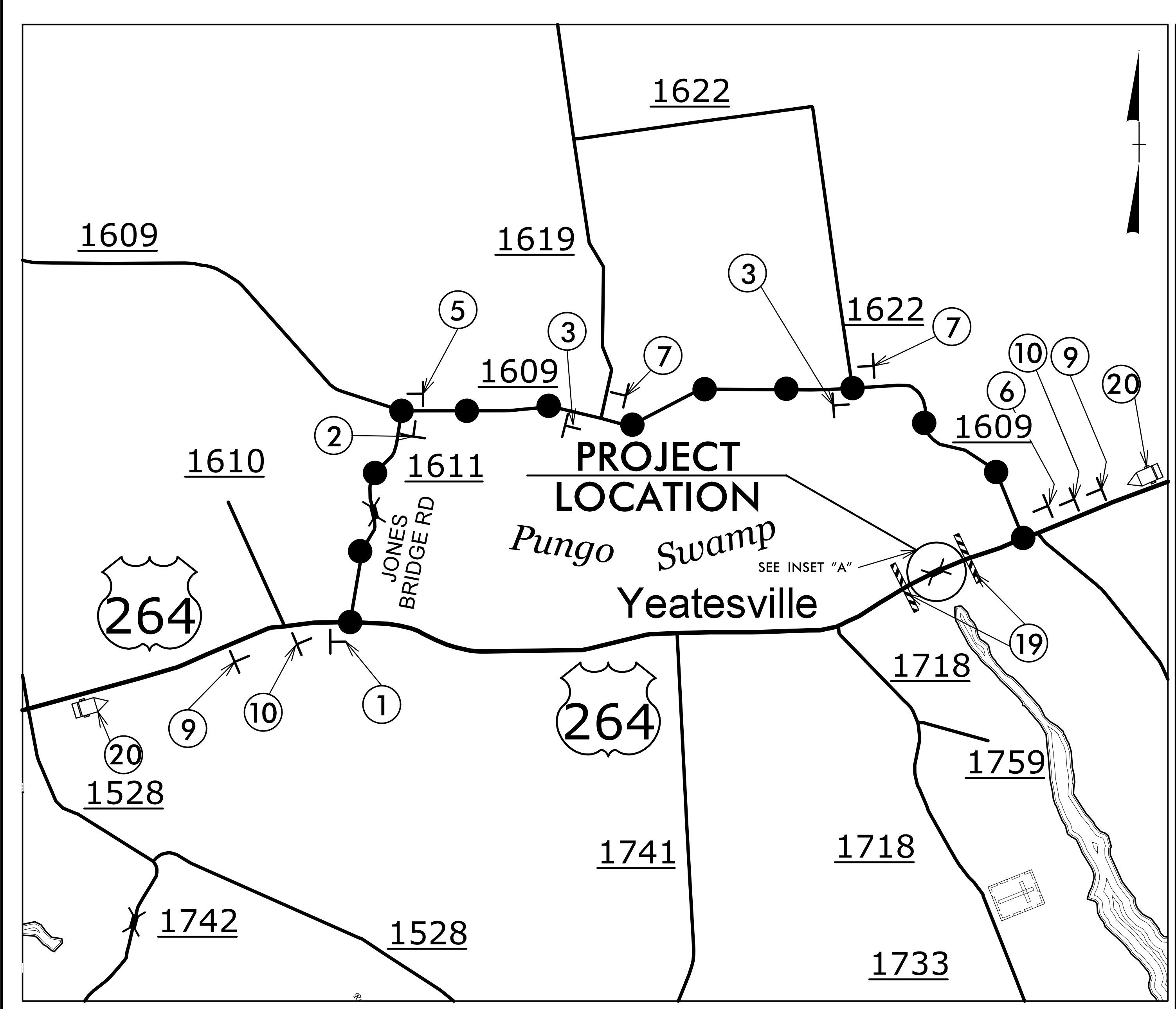

DETOUR ROUTE

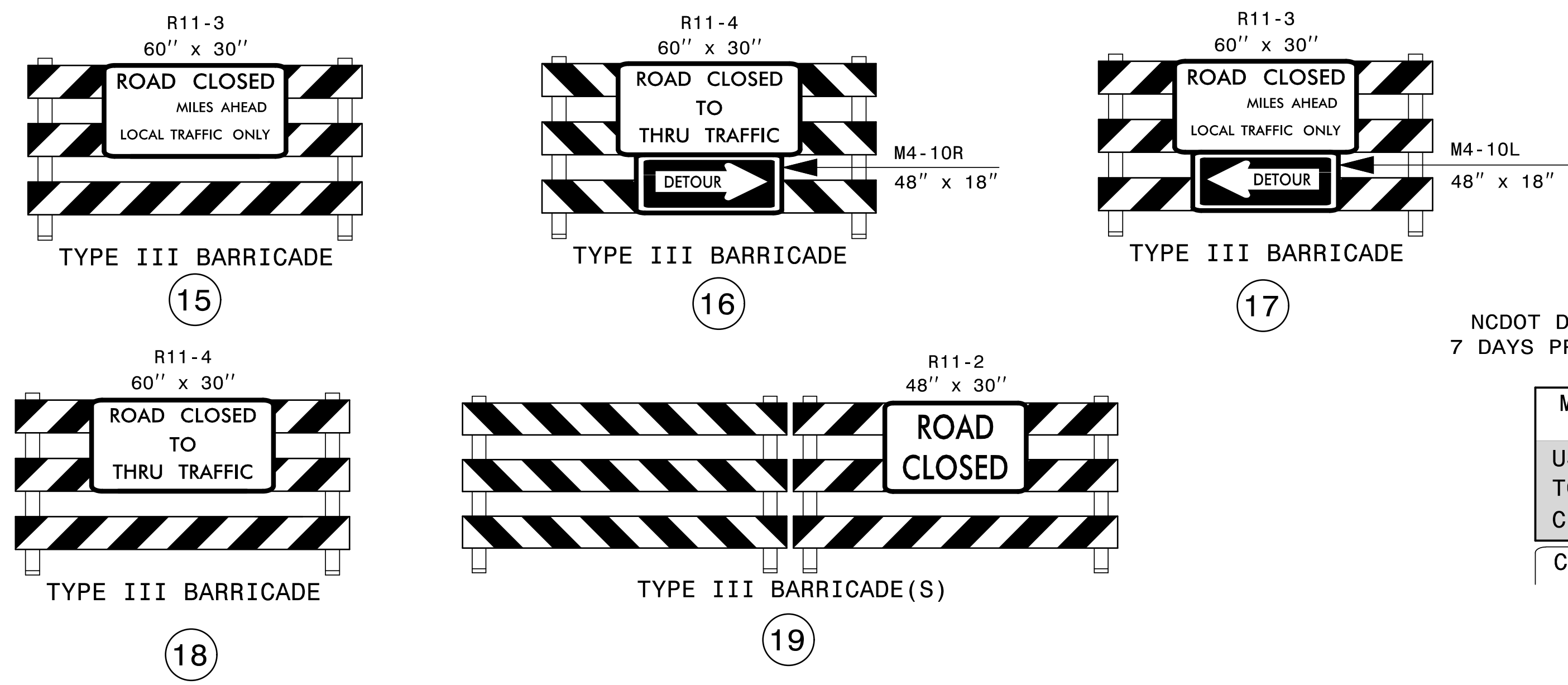

REFER TO ROADWAY STANDARD DRAWING 1101.03, SHEET 1 OF 9 FOR APPLICABLE NOTES.

NCDOT DIVISION 2 TO INSTALL CMS 7 DAYS PRIOR TO ROAD BEING CLOSED.

MESSAGE NO. 1	MESSAGE NO. 2
US 264	(DAY)
TO BE	(DATE)
CLOSED	
CHANGEABLE MESSAGE SIGN	

APPROVED: *Tommy Aguilera, PE*
 DATE: 1/26/2021 | 9:29 AM
 SEAL
DOCUMENT NOT CONSIDERED FINAL UNLESS ALL SIGNATURES COMPLETED

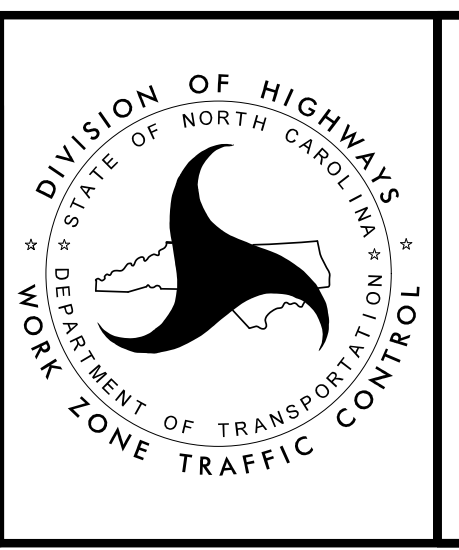

OFFSITE DETOUR ROUTE AND BARRICADE PLACEMENT

I:\2021\12\26\4414\Traffic\TrafficControl\Top\B-4414_TC_TMP_03\DETOUR.dgn
 User: tbevans