

MAP #12 SR 3106  
WYNBROOK WAY

MAP #11 SR 3105  
LESLIE DRIVE

STATE	PROJECT NO.	SHEET NO.	TOTAL SHEETS
N.C.	2021CPT.10.13.10901 2021CPT.10.13.20901 2021CPT.10.13.20902	4	
F.A. PROJECT NO.			

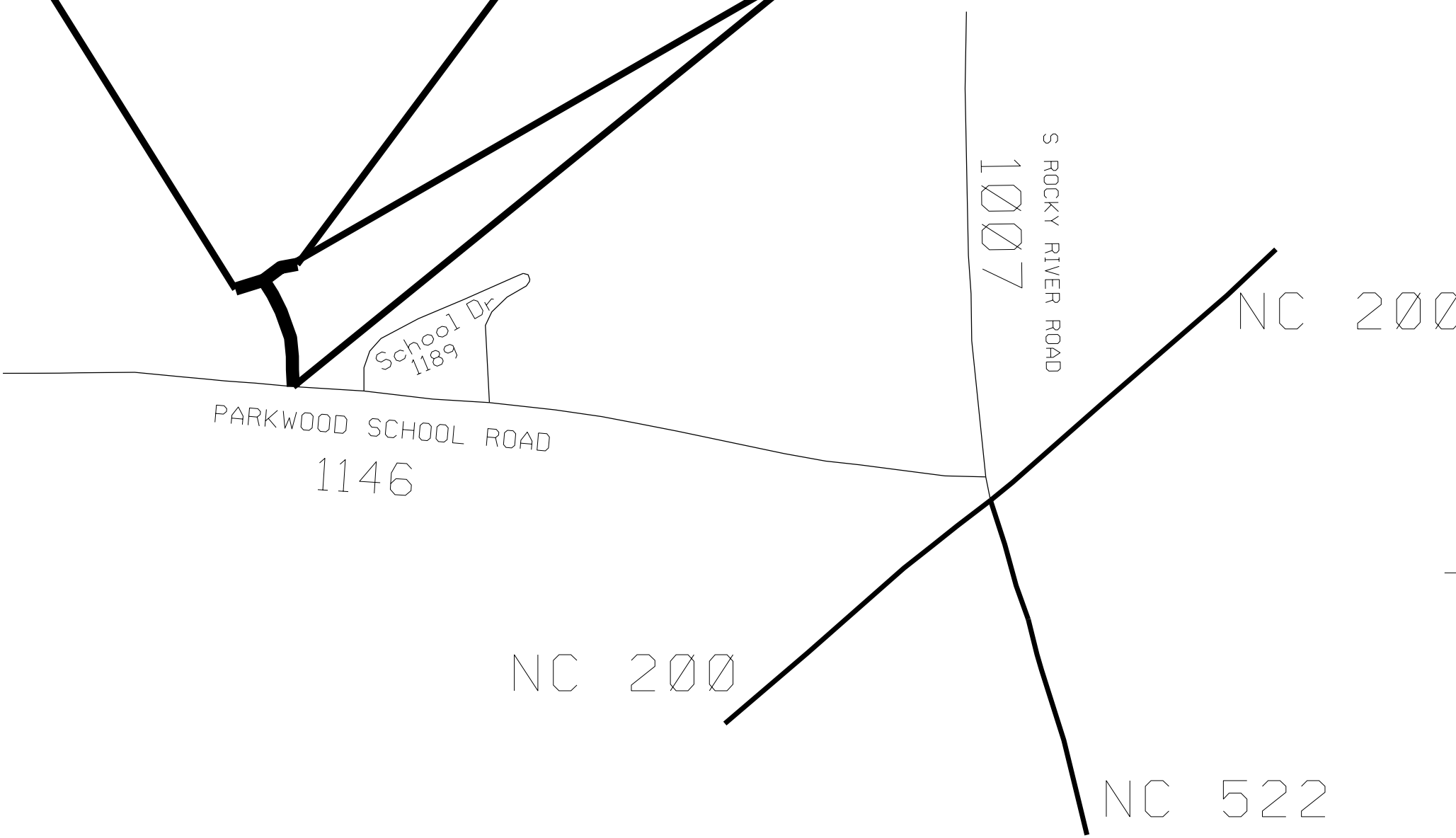

ENLARGED MUNICIPAL AND SUBURBAN AREAS  
**UNION COUNTY**  
NORTH CAROLINA  
PREPARED BY THE  
NORTH CAROLINA DEPARTMENT OF TRANSPORTATION  
DIVISION OF HIGHWAYS - DIVISION 10 DISTRICT 3

MAP #11 SR 3105 LESLIE DRIVE  
0.08 MILES  
FROM SR 1146 PARKWOOD SCHOOL ROAD  
TO SR SR 3106 WYNBROOK WAY

MAP #12 SR 3106 WYNBROOK WAY  
0.05 MILES  
FROM END OF MAINTANANCE  
TO END OF MAINTANANCE