

DATE: 5/27/2020  
TIME: 12:55:42 PM

USER: \\usaf\p001\Users\jmorris\Projects\0517086 - BR-0042\900\_CAD\_6151910\_CAD\01\_TIP\Structures\04 Drawings\001\_51\_S26\_BR-0042\_SML\_SF.dgn

BRIDGE @ 19+56.99 -L-	4" SLOPE PROTECTION	WELDED WIRE FABRIC 60 INCHES WIDE
	SQ. YDS.	APPROX. LF
END BENT 1	18.1	56
END BENT 2	18.1	56
TOTAL	36.2	112

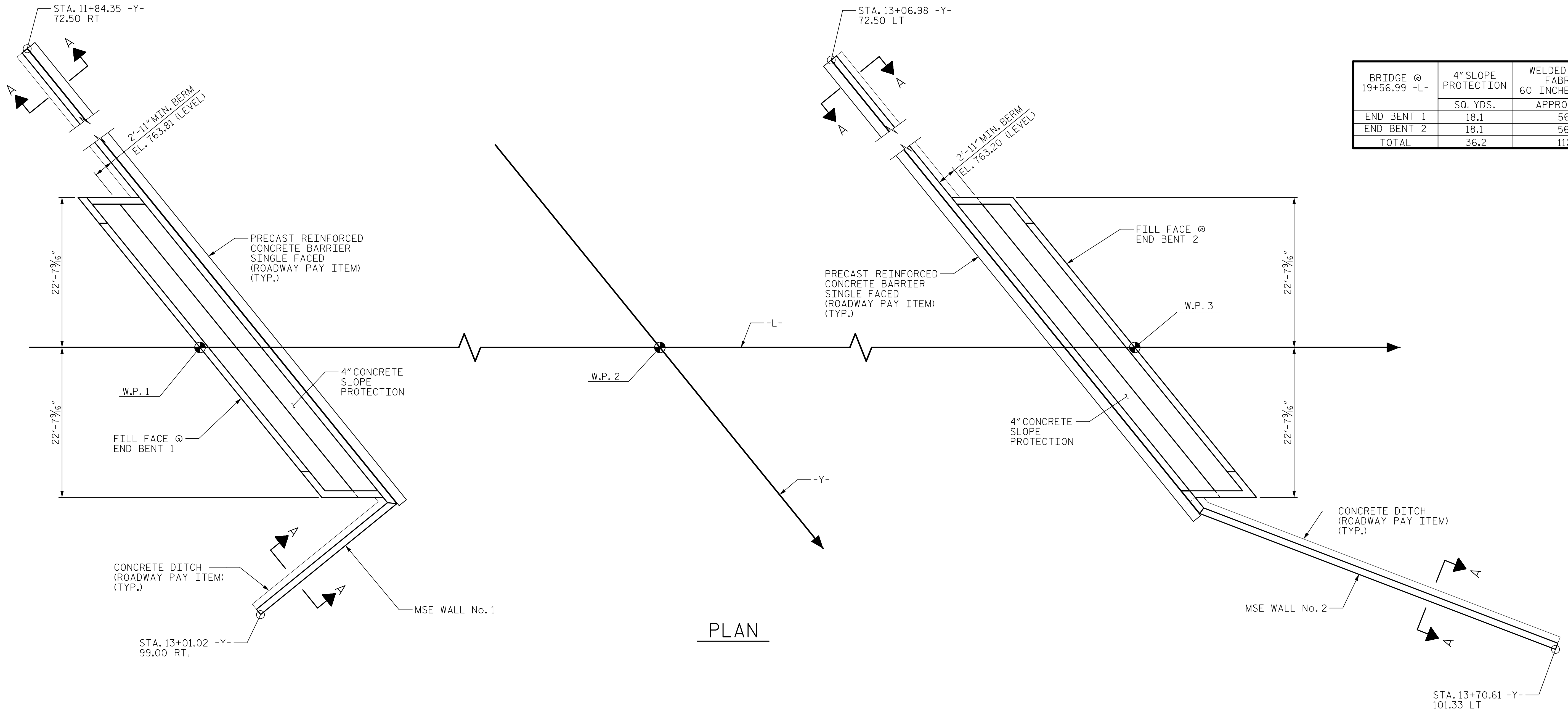

PLAN

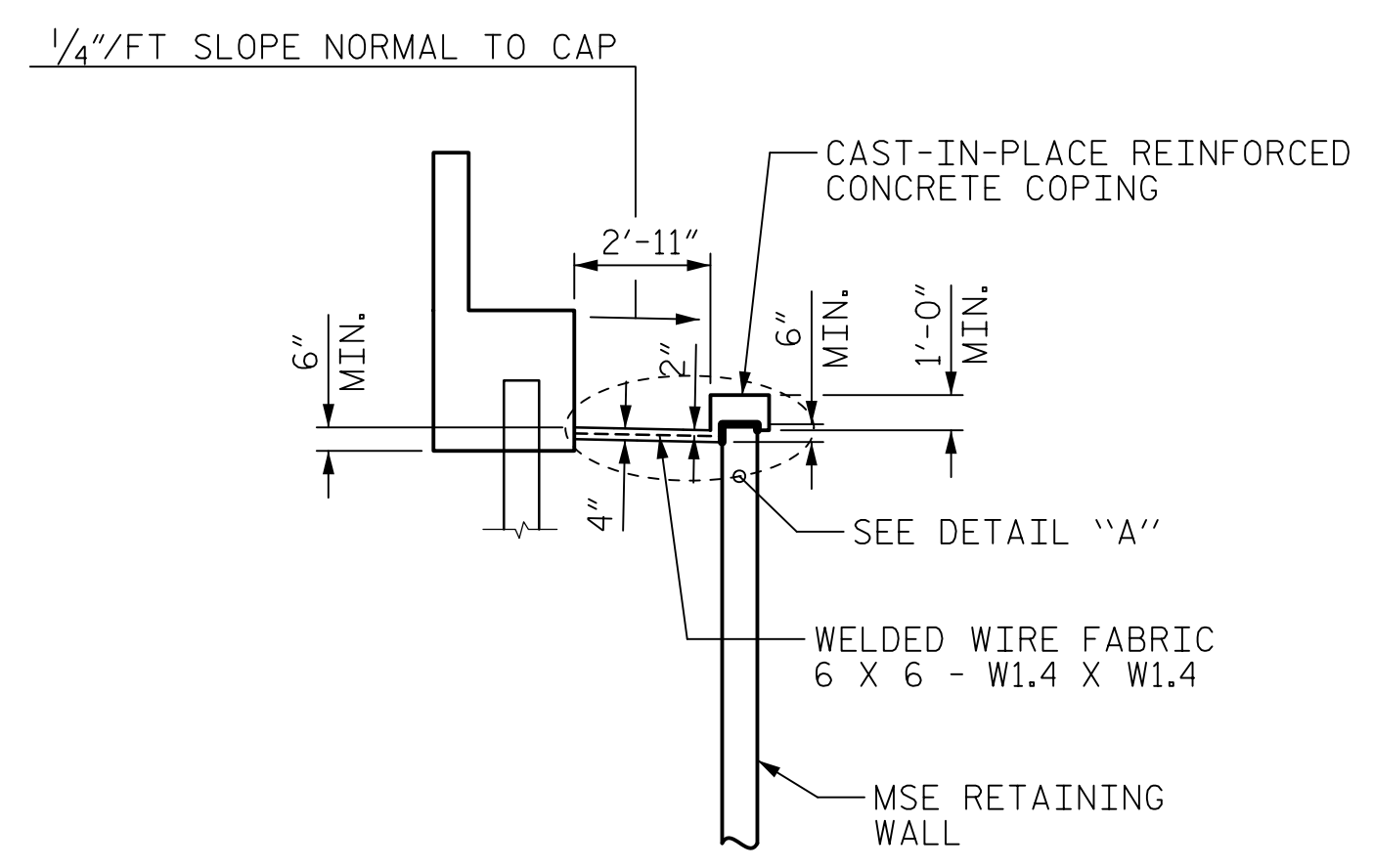

SECTION ALONG C ROADWAY

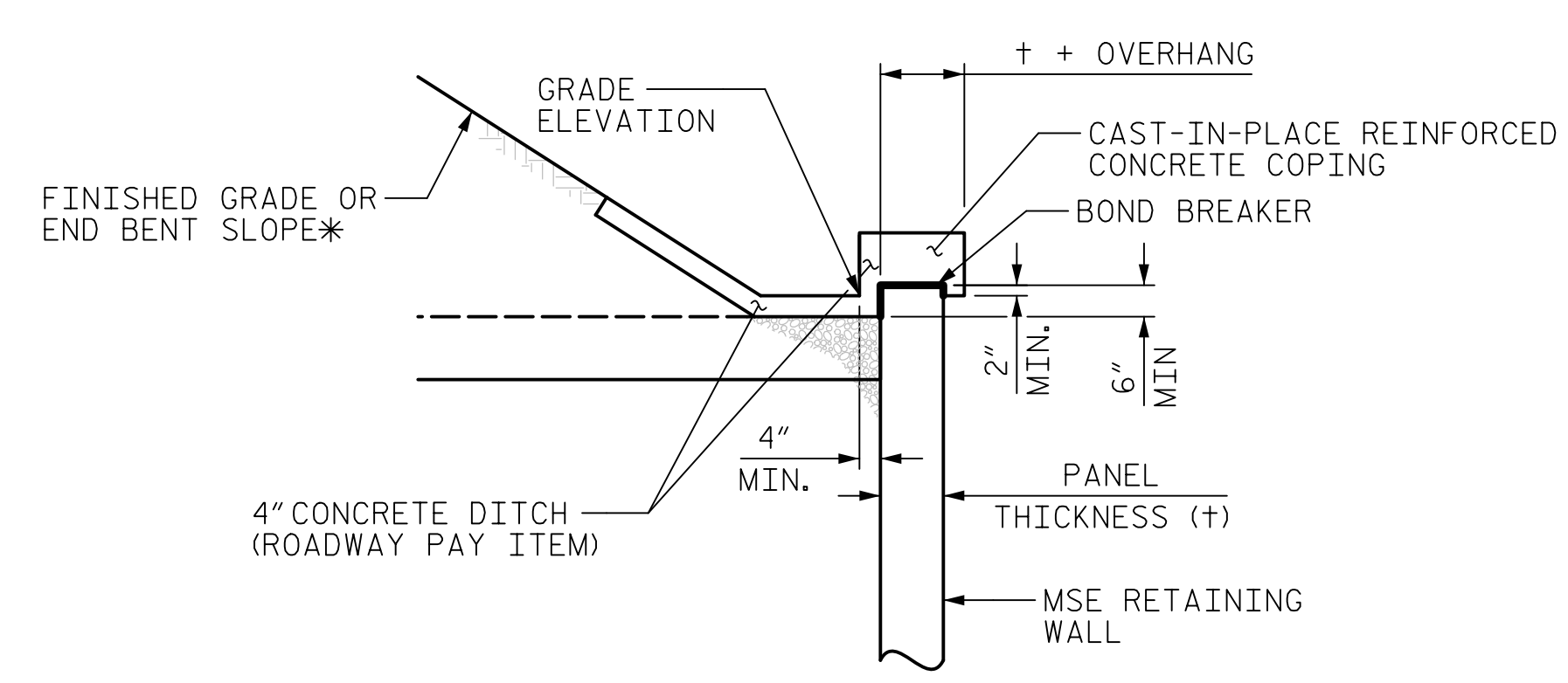

SECTION A-A

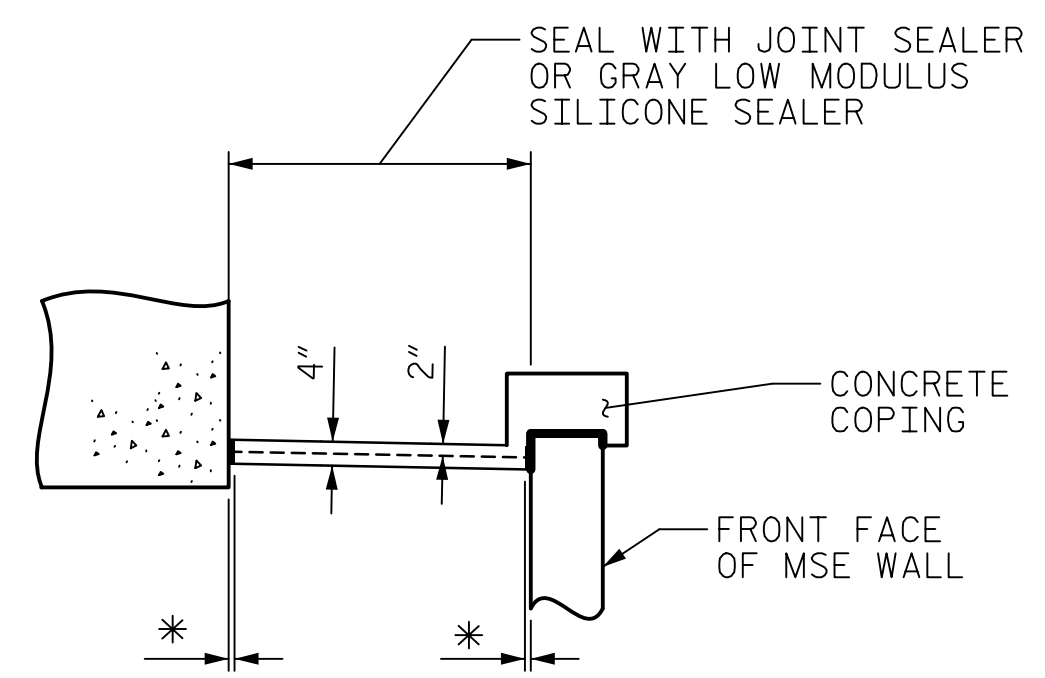

DETAIL "A"

\* 1" EXP. JT. MAT'L.  
(PLACE DEBONDING TAPE  
ON TOP OF EXP. JT. MAT'L.)

PROJECT NO. BR-0042  
ROCKINGHAM COUNTY  
STATION: 19+56.99 -L-

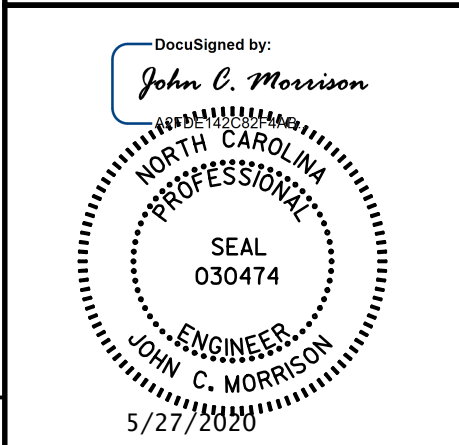

STATE OF NORTH CAROLINA  
DEPARTMENT OF TRANSPORTATION  
RALEIGH  
GENERAL DRAWING  
SLOPE PROTECTION  
DETAILS

DRAWN BY : H.T. ROSEMOND	DATE : 07/2019
CHECKED BY : J.C. MORRISON	DATE : 07/2019
DESIGNED BY : H.T. ROSEMOND	DATE : 07/2019
DESIGN CHECKED BY : J.C. MORRISON	DATE : 07/2019

DOCUMENT NOT CONSIDERED  
FINAL UNLESS ALL  
SIGNATURES COMPLETED

REVISIONS						SHEET NO.
NO.	BY:	DATE:	NO.	BY:	DATE:	S-26
1			3			TOTAL SHEETS
2			4			28