

REFER TO THE FINAL PAVEMENT MARKING PLANS WHEN PLACING THE MARKINGS SHOWN ON THIS SHEET. UTILIZE TEMPORARY WORK ZONE PERFORMANCE MARKINGS INSTEAD OF THE THERMOPLASTIC MARKINGS SHOWN IN THE FINAL PM PLANS.

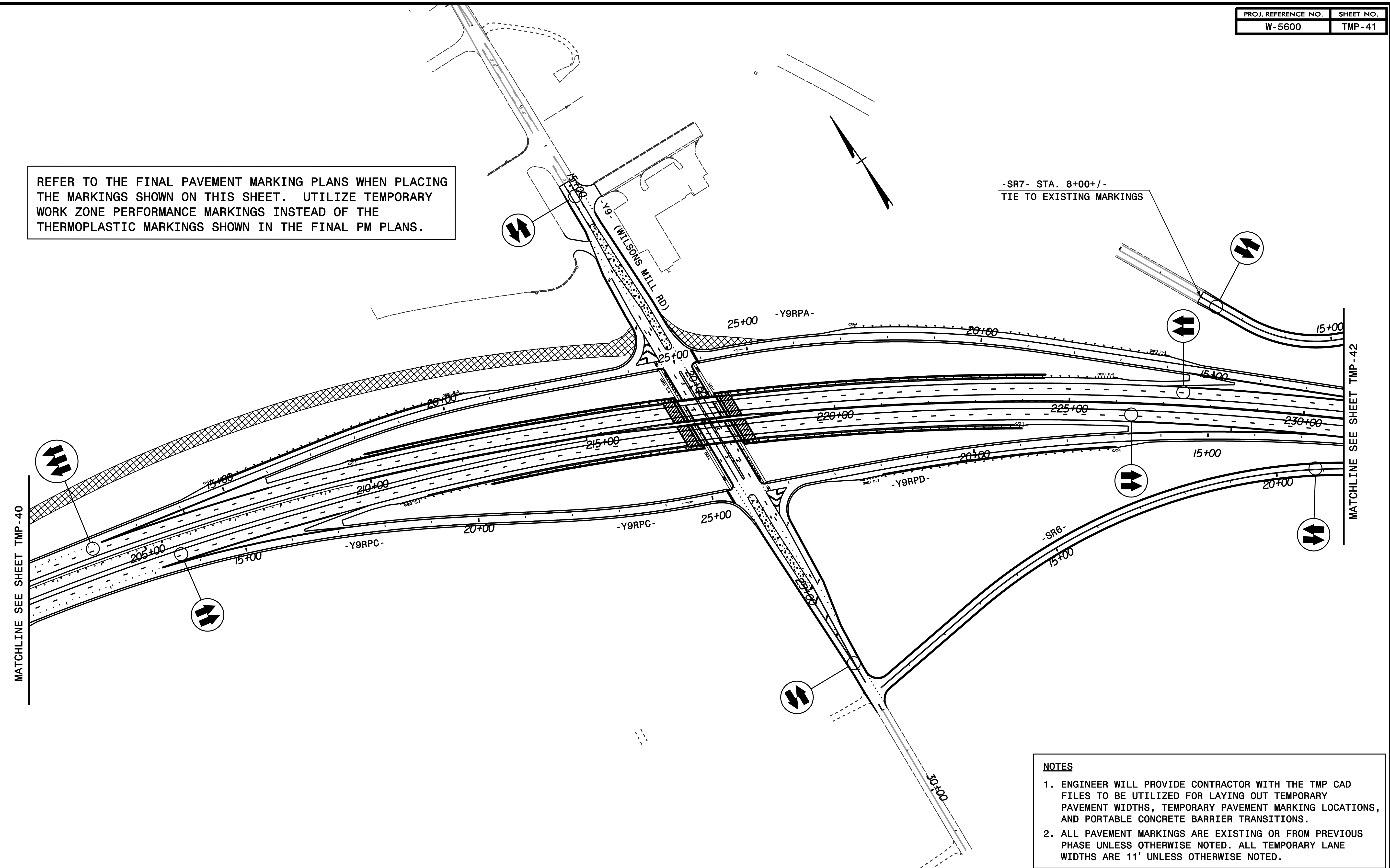

-SR7- STA. 8+00+/-
TIE TO EXISTING MARKINGS

- NOTES**
- ENGINEER WILL PROVIDE CONTRACTOR WITH THE TMP CAD FILES TO BE UTILIZED FOR LAYING OUT TEMPORARY PAVEMENT WIDTHS, TEMPORARY PAVEMENT MARKING LOCATIONS, AND PORTABLE CONCRETE BARRIER TRANSITIONS.
 - ALL PAVEMENT MARKINGS ARE EXISTING OR FROM PREVIOUS PHASE UNLESS OTHERWISE NOTED. ALL TEMPORARY LANE WIDTHS ARE 11' UNLESS OTHERWISE NOTED.

WETHERILL ENGINEERING

1223 Jones Franklin Rd.
Raleigh, N.C. 27606
License No. F-0377
Bus: 919 851 8077
Fax: 919 851 8107

TRANSPORTATION PLANNING/DESIGN - BRIDGE/STRUCTURE DESIGN
CIVIL/SITE DESIGN - GIS/GPS - CONSTRUCTION OBSERVATION

PLAN PREPARED IN THE OFFICE OF:

PROGRESSIVE DESIGN GROUP, INC.

ENGINEERS • CONSULTANTS

APPROVED: *Tim Stey* DATE: 5/5/2020

SEAL

TRANSPORTATION
MANAGEMENT PLAN
AREA 2 PHASE III DETAIL