

USE FOR LIGHTING CONSTRUCTION ONLY

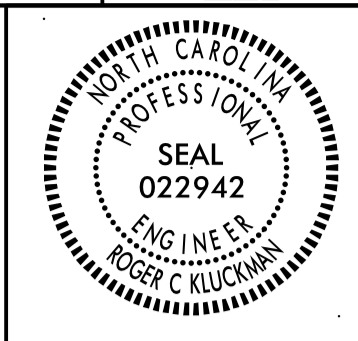

DocuSigned by: Roger K. Kuckman 2021

DOCUMENT NOT CONSIDERED FINAL UNLESS ALL SIGNATURES COMPLETED

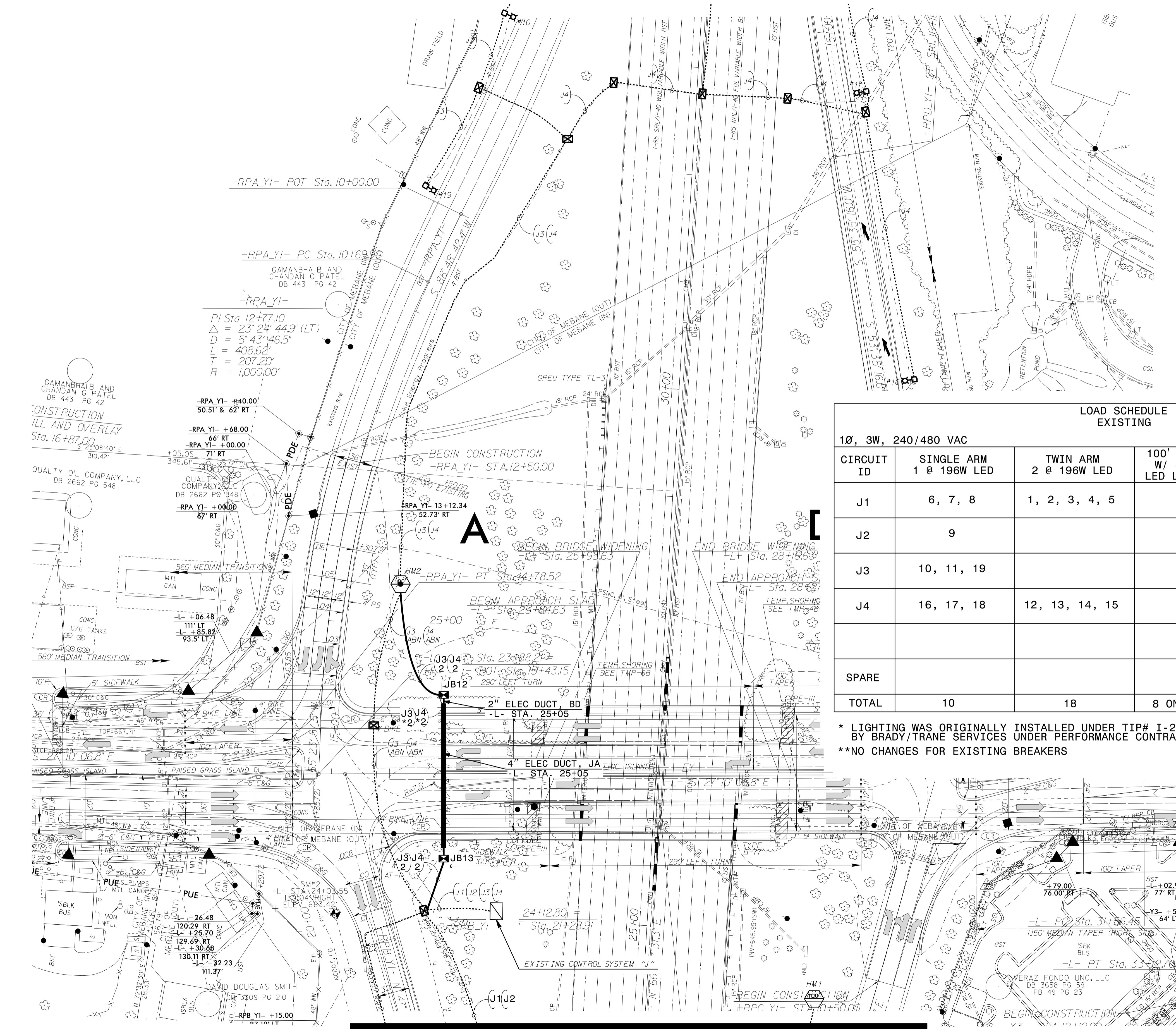

LOAD SCHEDULE EXISTING				CONTROL SYSTEM "J"		
1Ø, 3W, 240/480 VAC						
CIRCUIT ID	SINGLE ARM 1 @ 196W LED	TWIN ARM 2 @ 196W LED	100' HIGH MAST W/ 4 @ 475W LED LUMINAIRES	AMPS @ 480V	KW LOAD	BREAKER ** SIZE (AMPS)
J1	6, 7, 8	1, 2, 3, 4, 5		5.3	2.6	50
J2	9		1	4.4	2.1	50
J3	10, 11, 19		2	9.1	4.4	50
J4	16, 17, 18	12, 13, 14, 15		4.5	2.2	50
SPARE						
TOTAL	10	18	8 ON TWO HM	23.3	11.3	

* LIGHTING WAS ORIGINALLY INSTALLED UNDER TIP# I-2306A/I-304E AND HAS BEEN UPGRADED BY BRADY/TRANE SERVICES UNDER PERFORMANCE CONTRACT IN 2018
 **NO CHANGES FOR EXISTING BREAKERS

SEE SHEET "E1" FOR LEGEND & Δ NOTES

2			
1			
Rev.	Date	Description	Approved
NORTH CAROLINA DEPARTMENT OF TRANSPORTATION ROADWAY DESIGN LIGHTING/ELECTRICAL SECTION LIGHTING LAYOUT I-85/SR 1007 (MEBANE OAKS RD) INTERCHANGE ALAMANCE COUNTY			
Drawn By:	SAM	Approved By:	GH
Dwg No.:			

04-JAN-2021 09:22
 R:\Lighting Design\Lighting Files\1-5711.LE.PSH.E2.dgn
 somehtk AT PD-307555