

TIP PROJECT: B-5825

STATE OF NORTH CAROLINA
DIVISION OF HIGHWAYS

T.I.P. NO.	SHEET NO.
B-5825	UO-1

NOTE:
ALL UTILITY WORK SHOWN ON THIS SHEET IS DONE BY OTHERS.
NO PAYMENT WILL BE MADE TO THE CONTRACTOR FOR UTILITY WORK SHOWN ON THIS SHEET.

UBO PLANS ARE FOR INFORMATION ONLY AND ARE NOT TO BE USED FOR CONSTRUCTION. ALL PROPOSED RELOCATION INFORMATION SHOWN ON THE UBO PLANS WAS PROVIDED BY 3RD PARTIES. HINDE ENGINEERING, INC. ASSUMES NO RESPONSIBILITY OR LIABILITY FOR THE ACCURACY OR VALIDITY OF 3RD PARTY INFORMATION PROVIDED.

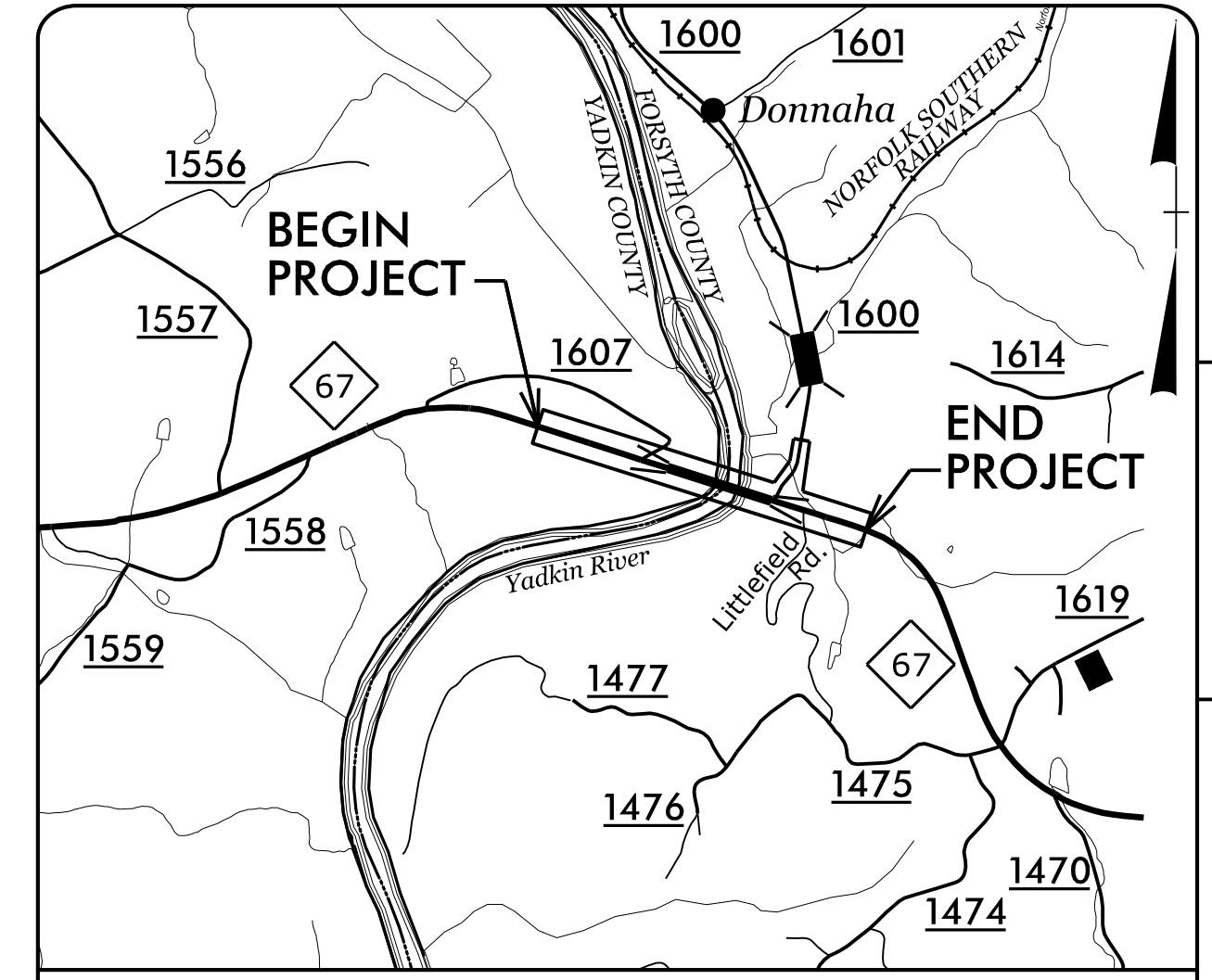

VICINITY MAP

FINAL PLANS

**UTILITIES BY OTHERS PLANS
YADKIN & FORSYTH COUNTY**

**LOCATION: REPLACE BRIDGE NO. 35 OVER
THE YADKIN RIVER ON NC 67**

TYPE OF WORK: UTILITIES BY OTHER RELOCATIONS

BEGIN TIP PROJECT B-5825
-L- STA. 14 + 00.00

END TIP PROJECT B-5825
-L- STA. 54 + 00.00

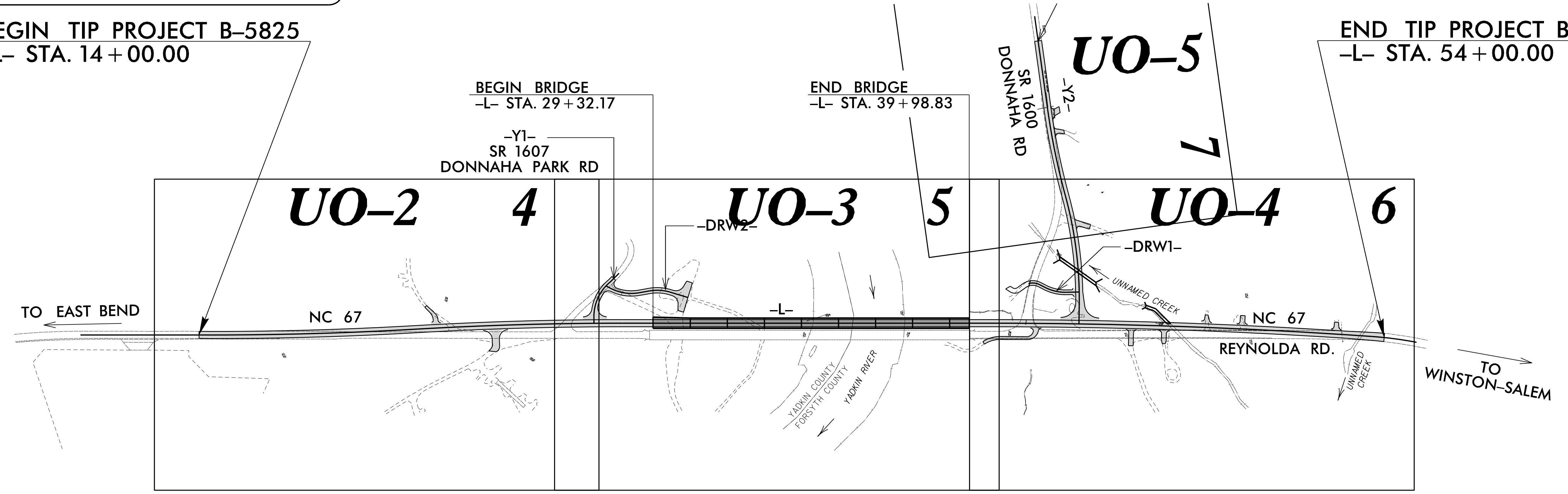

DESIGN EXCEPTION
-L- LINE PAVEMENT CROSS SLOPE ON ROADWAY APPROACHES AND BRIDGE DECK

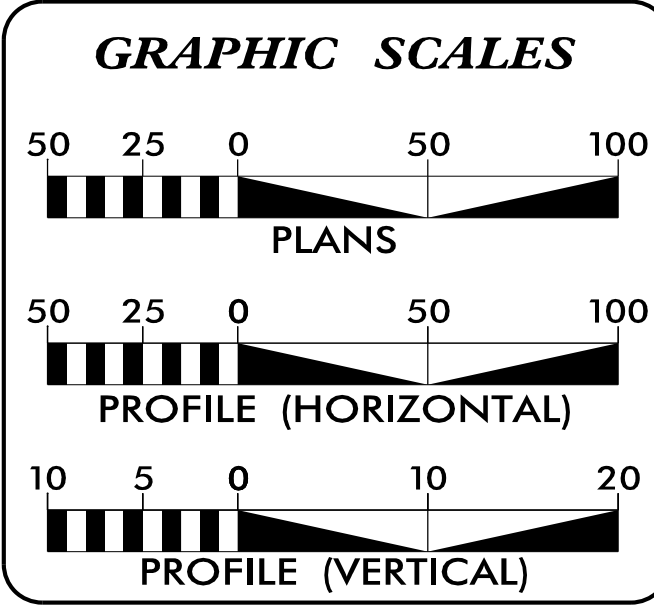

INDEX OF SHEETS

SHEET NO.	DESCRIPTION
UO-1	TITLE SHEET
UO-2 THRU UO-5	UBO PLAN SHEETS

UTILITY OWNERS WITH CONFLICTS

(A) POWER - DUKE ENERGY
(B) POWER - SURRY/YADKIN EMC
(C) TELECOM - WINDSTREAM
(D) TELECOM - SPECTRUM

PREPARED IN THE OFFICE OF:

HINDE ENGINEERING

License No. C-2639
10815 Sikes Place, Suite 210, Charlotte, NC 28277
(704) 814-4407

Michael E. Davis UTILITY COORDINATION PROJECT MANAGER
Todd E. Butner PROJECT UTILITY COORDINATOR
Jordan K. Chapman PROJECT UTILITY DESIGNER

**DIVISION OF HIGHWAYS
UTILITIES UNIT**
1555 MAIL SERVICES CENTER
RALEIGH, NC 27699-1555
PHONE (919) 707-6690
FAX (919) 250-4151

Trent Beaver, PE DIVISION CONTACT #1
Susan Huffman DIVISION CONTACT #2
DIVISION CONTACT #3
DIVISION CONTACT #4

04-MAY-2020 17:24 S:\Server_Files\PROJECTS\2018\2018800.00_TCS_B-5825\Design\Utilities\Engineering\UBO\Proj\B-5825_Ut_1.sh_UO1.psh.dgn \$\$\$USERNAME\$\$\$

UTILITIES BY OTHERS

NOTE:
 ALL UTILITY WORK SHOWN ON THIS SHEET WILL BE DONE BY OTHERS. NO PAYMENT WILL BE MADE TO THE CONTRACTOR FOR UTILITY WORK SHOWN ON THIS SHEET.

BEGIN TIP PROJECT B-5825
 -L- POT Sta. 14+00.00

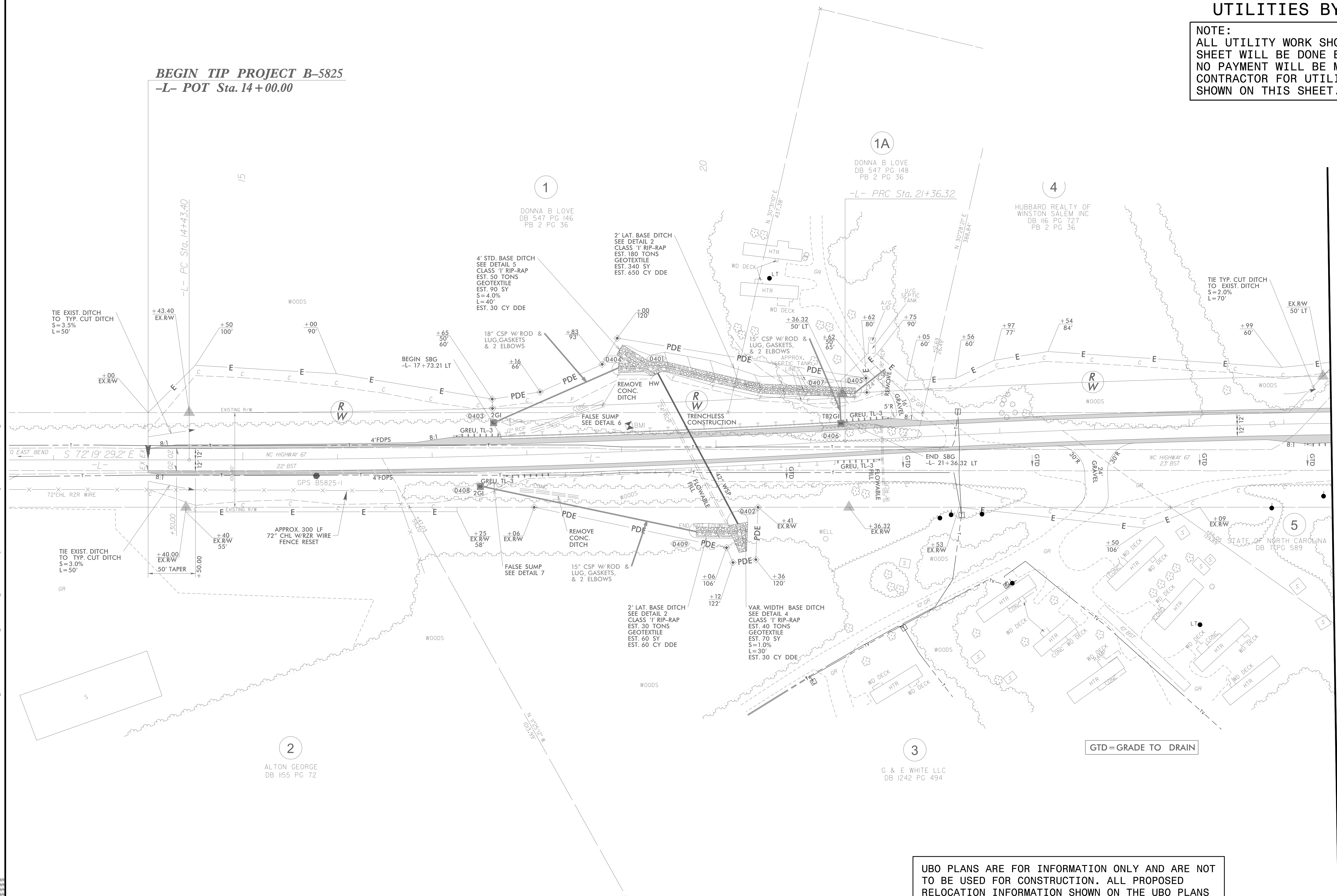

MATCHLINE -L- STA. 26+50.00
SEE SHEET U0-3

GTD = GRADE TO DRAIN

UBO PLANS ARE FOR INFORMATION ONLY AND ARE NOT TO BE USED FOR CONSTRUCTION. ALL PROPOSED RELOCATION INFORMATION SHOWN ON THE UBO PLANS WAS PROVIDED BY 3RD PARTIES. HINDE ENGINEERING, INC. ASSUMES NO RESPONSIBILITY OR LIABILITY FOR THE ACCURACY OR VALIDITY OF 3RD PARTY INFORMATION PROVIDED.



C:\MAY-2020\PROJECTS\2018\A2018000\00_TCS-B-5825\Design\Utilities\Engineering\UBO\Proj\B-5825_U0-2.psh.dgn

UTILITIES BY OTHERS

NOTE:
 ALL UTILITY WORK SHOWN ON THIS SHEET WILL BE DONE BY OTHERS. NO PAYMENT WILL BE MADE TO THE CONTRACTOR FOR UTILITY WORK SHOWN ON THIS SHEET.

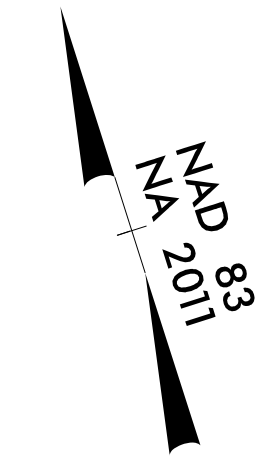

6
 M. KEITH BUTNER
 DB 2829 PG 2942
 DB 2829 PG 2936

7
 STEPHEN A HUBBARD
 SUSAN K HUBBARD
 DB 1822 PG 2457

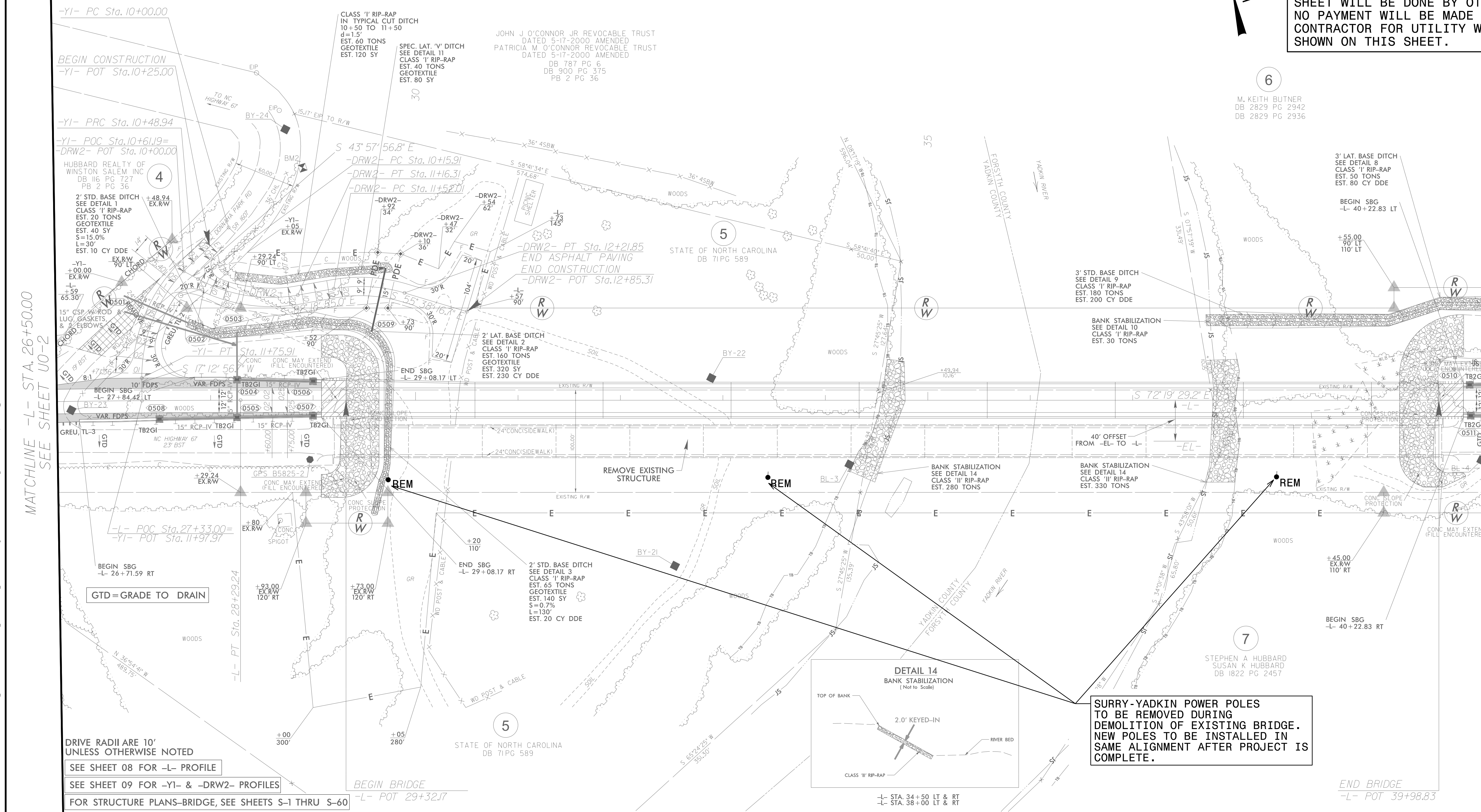

MATCHLINE -L- STA. 26+50.00
SEE SHEET U0-2

MATCHLINE -L- STA. 40+50.00
SEE SHEET U0-4

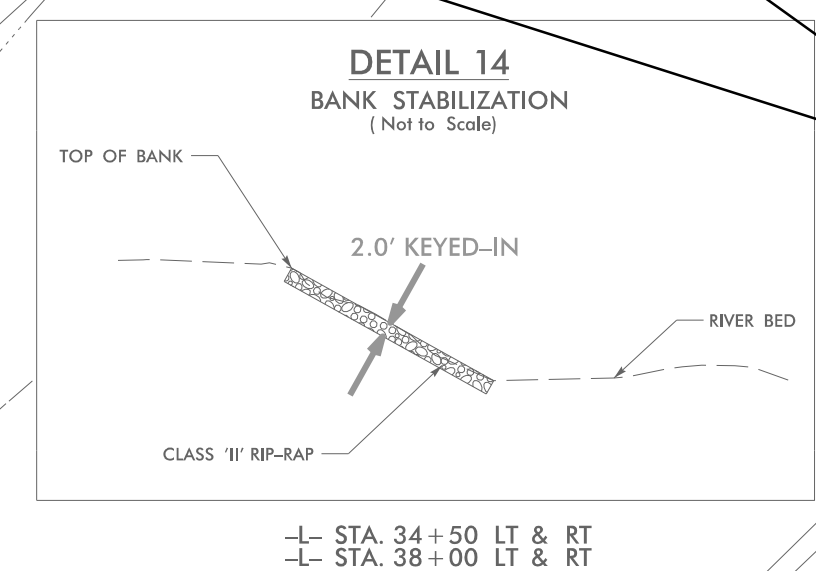

SURRY-YADKIN POWER POLES TO BE REMOVED DURING DEMOLITION OF EXISTING BRIDGE. NEW POLES TO BE INSTALLED IN SAME ALIGNMENT AFTER PROJECT IS COMPLETE.

DRIVE RADII ARE 10' UNLESS OTHERWISE NOTED
 SEE SHEET 08 FOR -L- PROFILE
 SEE SHEET 09 FOR -YI- & -DRW2- PROFILES
 FOR STRUCTURE PLANS-BRIDGE, SEE SHEETS S-1 THRU S-60

UBO PLANS ARE FOR INFORMATION ONLY AND ARE NOT TO BE USED FOR CONSTRUCTION. ALL PROPOSED RELOCATION INFORMATION SHOWN ON THE UBO PLANS WAS PROVIDED BY 3RD PARTIES. HINDE ENGINEERING, INC. ASSUMES NO RESPONSIBILITY OR LIABILITY FOR THE ACCURACY OR VALIDITY OF 3RD PARTY INFORMATION PROVIDED.

24 MAY 2020 11:24
 C:\S\PROJECTS\2018\A2018800\00_TCS-B-5825\Design\Utilities\Engineering\UBO\Proj\B-5825_Ut_rdy05_U003_psh.dgn
 3388

UTILITIES BY OTHERS

NOTE:
ALL UTILITY WORK SHOWN ON THIS SHEET WILL BE DONE BY OTHERS. NO PAYMENT WILL BE MADE TO THE CONTRACTOR FOR UTILITY WORK SHOWN ON THIS SHEET.

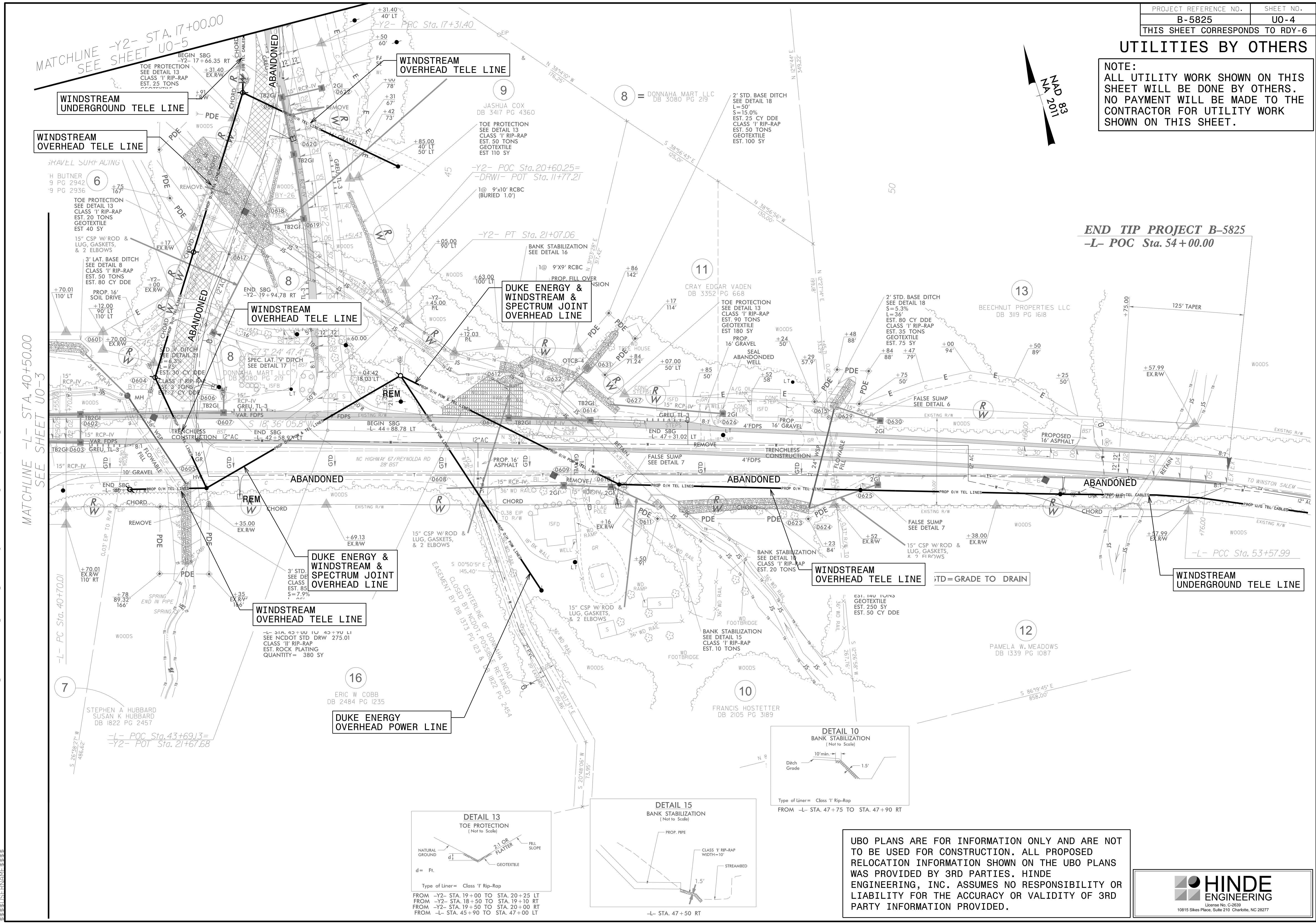

MATCHLINE -Y2- STA. 17+00.00
SEE SHEET U0-5

MATCHLINE -L- STA. 40+50.00
SEE SHEET U0-3

END TIP PROJECT B-5825
-L- POC Sta. 54+00.00

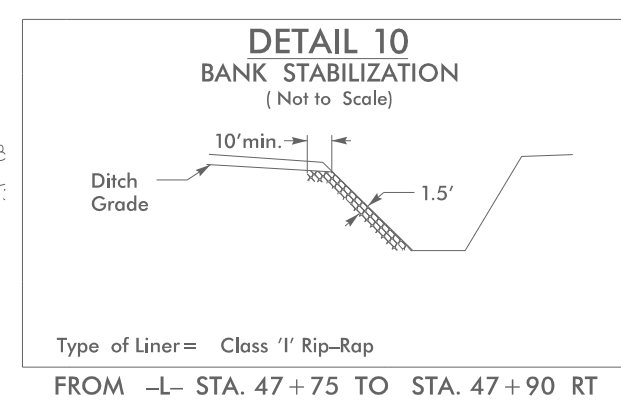
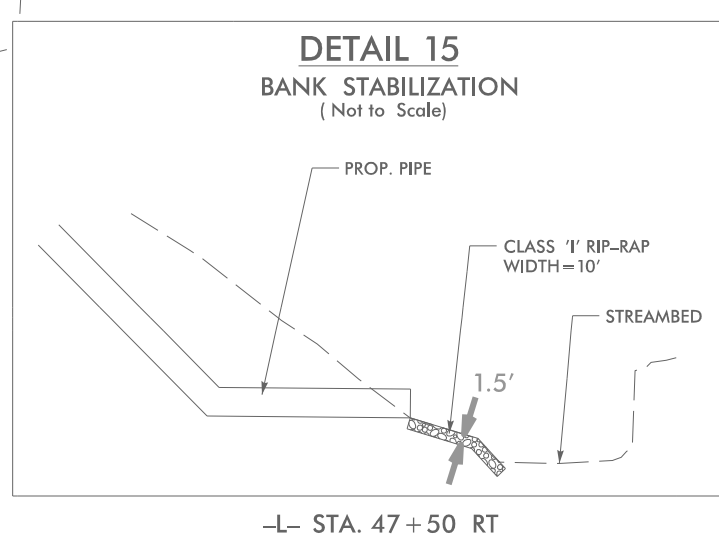
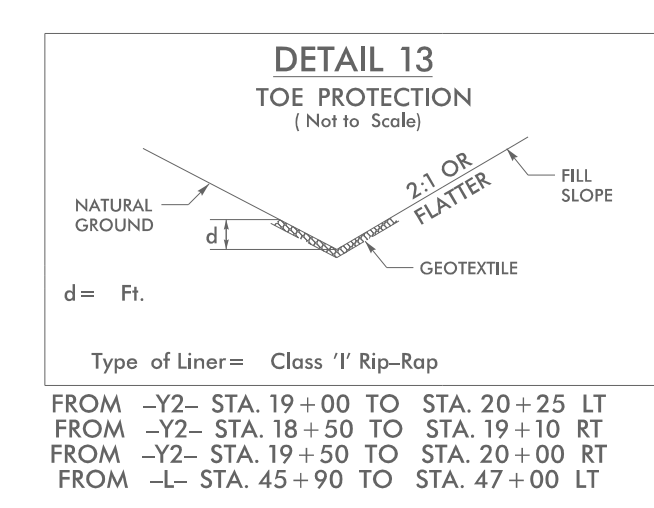
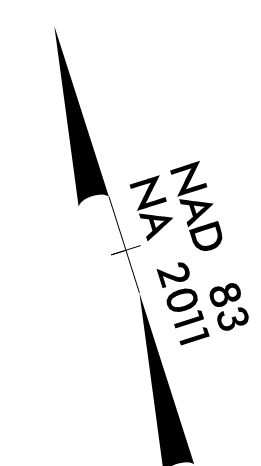

UBO PLANS ARE FOR INFORMATION ONLY AND ARE NOT TO BE USED FOR CONSTRUCTION. ALL PROPOSED RELOCATION INFORMATION SHOWN ON THE UBO PLANS WAS PROVIDED BY 3RD PARTIES. HINDE ENGINEERING, INC. ASSUMES NO RESPONSIBILITY OR LIABILITY FOR THE ACCURACY OR VALIDITY OF 3RD PARTY INFORMATION PROVIDED.

25-MAY-2020 13:44 C:\PROJECTS\2018\A20188000\00_TGS-B-5825\Design\Utilities\Engineering\UBO\Proj\B-5825_U0-4.psh.dgn
 2018\A20188000\00_TGS-B-5825\Design\Utilities\Engineering\UBO\Proj\B-5825_U0-4.psh.dgn

