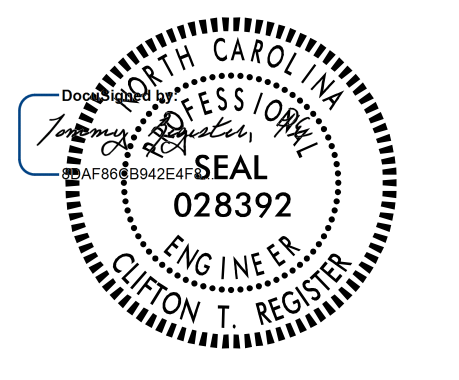

T.I.P.: B-5825

STATE OF NORTH CAROLINA
DEPARTMENT OF TRANSPORTATION

TIP NO. B-5825	SHEET NO. SIGN-1
APPROVED: _____	
DATE: 3/23/2020 10:59 AM PDT	
SEAL 	
DOCUMENT NOT CONSIDERED FINAL UNLESS ALL SIGNATURES COMPLETED	

SIGNING PLAN
YADKIN /FORSYTH COUNTY
LOCATION: REPLACE BRIDGE NO. 35 OVER THE
YADKIN RIVER ON NC 67

PAY ITEM NOTES

- 1 DISPOSAL OF SIGN SYSTEM, U-CHANNEL
- 2 DISPOSAL OF SUPPORT, WOOD
- 3 DISPOSAL OF SUPPORT, U-CHANNEL
- 4 RELOCATE SIGN ON NEW SUPPORTS (MATCH EXISTING)

GENERAL NOTES

- . SIGNS FURNISHED BY STATE
- . IF REMOVAL OR RELOCATION OF SIGNS ON PRIVATE STREET (NON-STATE MAINTAINED) IS REQUIRED DUE TO CONSTRUCTION, THE CONTRACTOR SHALL INFORM THE ENGINEER. THE WORK WILL BE COMPLETED BY OTHERS.
- . WHEN NOT STATIONED OR DIMENSIONED ON PLANS, ALL 'E' AND 'F' SIGNS SHALL BE FIELD LOCATED BY THE ENGINEER
- . ALL EXISTING SIGNS ON "U" CHANNEL POST WITHIN THE PROJECT LIMITS SHALL BE REMOVED AND DISPOSED OF UNLESS OTHERWISE NOTED ON PLANS.
- . WHEN EXISTING SIGNS ARE REMOVED AND INSTALLED ON NEW SUPPORTS, THE RE-ERECTION SHALL IMMEDIATELY FOLLOW THE REMOVAL.
- . THE BACKGROUND FOR TYPE E & F SIGNS SHALL BE TYPE C REFLECTIVE SHEETING.

SUMMARY OF QUANTITIES

ITEM NO.		ITEM DESCRIPTION	QUANTITY	UNIT
DESC. NO.	SECT. NO.			
4072000000	903	SUPPORTS, 3 LB STEEL U-CHANNEL	270	LF
4082000000	903	SUPPORTS, WOOD	50	LF
4102000000	904	SIGN ERECTION, TYPE E	11	EA
4108000000	904	SIGN ERECTION, TYPE F	1	EA
4116100000	904	SIGN ERECTION, RELOCATE SIGN TYPE D (GROUND MOUNTED)	6	EA
4141000000	907	DISPOSAL OF SUPPORT, WOOD	2	EA
4155000000	907	DISPOSAL OF SIGN SYSTEM, U-CHANNEL	17	EA
4192000000	907	DISPOSAL OF SUPPORT, U-CHANNEL	4	EA

ROADWAY STANDARD DRAWING

THE FOLLOWING ROADWAY STANDARDS AS APPEAR IN "ROADWAY STANDARD DRAWINGS" - PROJECT SERVICES UNIT - N.C. DEPARTMENT OF TRANSPORTATION - RALEIGH, N.C., DATED JANUARY 2018 ARE APPLICABLE TO THIS PROJECT AND BY REFERENCE HEREBY ARE CONSIDERED A PART OF THESE PLANS:

STD. NO.	TITLE
903.10	GROUND MOUNTED SIGN SUPPORTS
903.20	WOOD SIGN SUPPORTS
904.10	ORIENTATION OF GROUND MOUNTED SIGNS
904.50	MOUNTING OF TYPE 'D', 'E' AND 'F' SIGNS ON 'U' CHANNEL POSTS

INDEX

SHEET NO.	DESCRIPTION
SIGN-1	TITLE SHEET
SIGN-2	TYPE E & F SIGNS
SIGN-2A	SPECIAL SIGN DESIGN
SIGN-3-8	SIGNING PLAN DETAIL

PLAN PREPARED FOR N.C.D.O.T. BY:

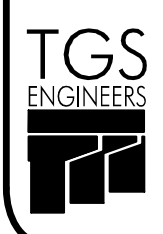
	TGS ENGINEERS 706 HILLSBOROUGH ST. SUITE 200 RALEIGH, NC 27603 PH (919) 773-8887 CORP. LICENSE NO. : C-0275	TOMMY REGISTER, PE PROJECT ENGINEER
		DAVID WHITTINGTON, PE DESIGN TECHNICIAN

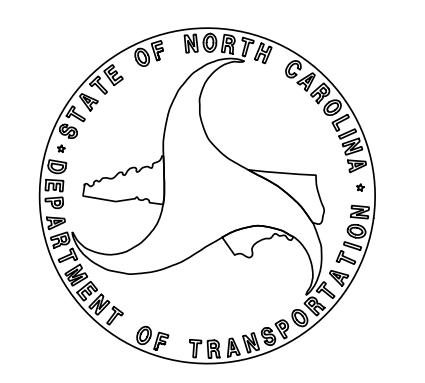

3/23/2020
347cc001b-5825-tr-ef-fic\signing\cadd\signing_layout_plans\250_003_B-5825_Sgn_SGN_01(T)sh.dgn
I:\cadd\transportation

APPROVED: _____
 DATE: 3/23/2020 | 10:59 AM PDT

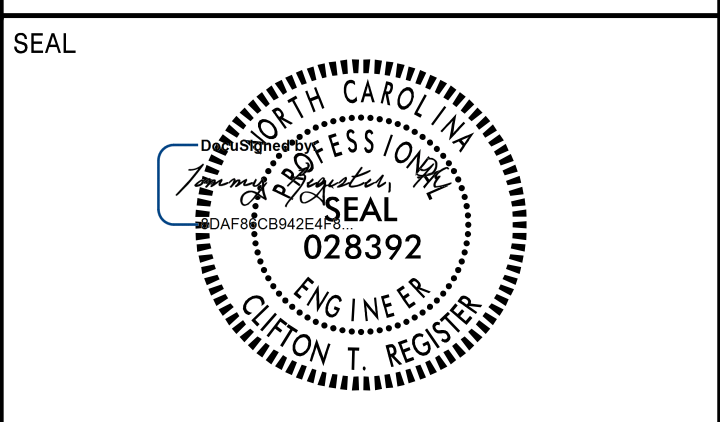

**DOCUMENT NOT CONSIDERED FINAL
UNLESS ALL SIGNATURES COMPLETED**

TGS ENGINEERS
 708 HILLSBOROUGH ST. SUITE 200
 RALEIGH, NC 27603
 PH (919) 773-8887
 CORP. LICENSE NO.: C-0275

TYPE "E"

(401) QUANTITY REQ'D 2

ONE "U" POST PER SIGN

(402) QUANTITY REQ'D 3

ONE "U" POST PER SIGN

(403) QUANTITY REQ'D 1

ONE "U" POST PER SIGN

(404) QUANTITY REQ'D 1

ONE "U" POST PER SIGN

(405) QUANTITY REQ'D 1

ONE "U" POST PER SIGN

(406) QUANTITY REQ'D 1

ONE "U" POST PER SIGN

(407) QUANTITY REQ'D 1

ONE "U" POST PER SIGN

(408) QUANTITY REQ'D 1

MOUNT BELOW SIGN 409
IN ONE INSTALLATION

TYPE "F"

(501) QUANTITY REQ'D 1

ONE "U" POST PER SIGN

TYPE "E" & "F" SIGNS

3/23/2020
 C:\Users\jacob_b-5825\OneDrive\work\projects\2020\006_B-5825_Sgn_Sgn_02\Type_E&F.dgn
 Clifton T. Register

APPROVED: _____
 DATE: 3/23/2020 | 10:59 AM PDT

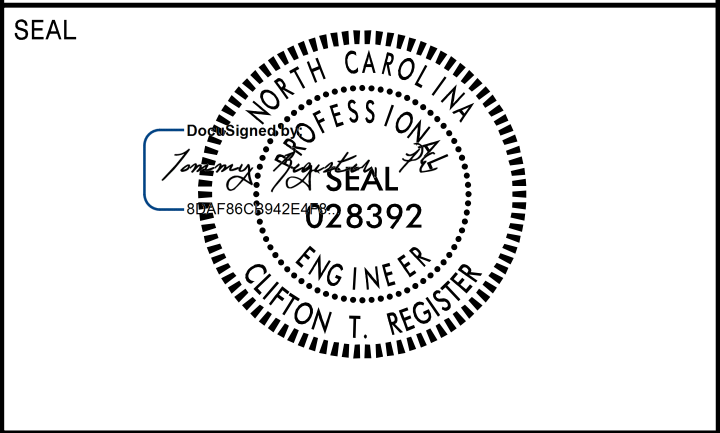

**DOCUMENT NOT CONSIDERED FINAL
 UNLESS ALL SIGNATURES COMPLETED**

TGS ENGINEERS
 706 HILLSBOROUGH ST. SUITE 200
 RALEIGH, NC 27603
 PH (919) 773-8887
 CORP. LICENSE NO.: C-0275

SIGN NUMBER: 301 TYPE: D QUANTITY: 1 SIGN WIDTH: 5'-0" HEIGHT: 2'-6" TOTAL AREA: 12.5 Sq.Ft. BORDER TYPE: FLUSH RECESS: 0" WIDTH: 0.75" RADII: 3" NO. Z BARS: _____ LENGTH: _____	BACKG COLOR: Green COPY COLOR: White <table border="1" style="width:100%; border-collapse: collapse;"> <tr><th>SYMBOL</th><th>X</th><th>Y</th><th>WID</th><th>HT</th></tr> <tr><td> </td><td> </td><td> </td><td> </td><td> </td></tr> <tr><td> </td><td> </td><td> </td><td> </td><td> </td></tr> <tr><td> </td><td> </td><td> </td><td> </td><td> </td></tr> <tr><td> </td><td> </td><td> </td><td> </td><td> </td></tr> <tr><td> </td><td> </td><td> </td><td> </td><td> </td></tr> <tr><td> </td><td> </td><td> </td><td> </td><td> </td></tr> <tr><td> </td><td> </td><td> </td><td> </td><td> </td></tr> <tr><td> </td><td> </td><td> </td><td> </td><td> </td></tr> <tr><td> </td><td> </td><td> </td><td> </td><td> </td></tr> </table> MAT'L: 0.125" (3.2 mm) ALUMINUM	SYMBOL	X	Y	WID	HT																																														DESIGN BY: SGM PROJECT ID: B-5825 LOCATION: YADKIN/FORSYTH COUNTIES CHECKED BY: _____ Mar 23, 2020 DIV: 11 & 9	<p style="text-align: center;">Spacing Factor is 1 unless specified otherwise</p>
SYMBOL	X	Y	WID	HT																																																	

USE NOTES: 1,2

- Legend and border(except those that are colored black) shall be direct applied Grade C sheeting.
- Background shall be Grade C reflective sheeting.

Letter locations are panel edge to lower left corner											Series/Size
W	e	l	c	o	m	e	T	o			Text Length
20.1	22.6	24.5	25.4	27.2	29.1	32.1	33.6	36.6	38.4		C 2000
											19.9
Y	A	D	K	I	N	C	O				D 2000
11.6	16.2	21.2	25.7	30.1	32.1	35.5	40.5	44.9			36.8
L	e	a	v	i	n	g					C 2000
24.1	25.9	27.6	29.4	31.5	32.4	34.4					11.9
F	O	R	S	Y	T	H	C	O			D 2000
9.6	13.3	18	21.9	25.7	30.3	34.1	37.5	42.5	46.9		40.9

FILENAME: R-25888_Sgn_SGN_TYPE_D NORTH CAROLINA D.O.T. SIGN DETAIL

SIGN NUMBER: 302 TYPE: D QUANTITY: 1 SIGN WIDTH: 5'-0" HEIGHT: 2'-6" TOTAL AREA: 12.5 Sq.Ft. BORDER TYPE: FLUSH RECESS: 0" WIDTH: 0.75" RADII: 3" NO. Z BARS: _____ LENGTH: _____	BACKG COLOR: Green COPY COLOR: White <table border="1" style="width:100%; border-collapse: collapse;"> <tr><th>SYMBOL</th><th>X</th><th>Y</th><th>WID</th><th>HT</th></tr> <tr><td> </td><td> </td><td> </td><td> </td><td> </td></tr> <tr><td> </td><td> </td><td> </td><td> </td><td> </td></tr> <tr><td> </td><td> </td><td> </td><td> </td><td> </td></tr> <tr><td> </td><td> </td><td> </td><td> </td><td> </td></tr> <tr><td> </td><td> </td><td> </td><td> </td><td> </td></tr> <tr><td> </td><td> </td><td> </td><td> </td><td> </td></tr> <tr><td> </td><td> </td><td> </td><td> </td><td> </td></tr> <tr><td> </td><td> </td><td> </td><td> </td><td> </td></tr> <tr><td> </td><td> </td><td> </td><td> </td><td> </td></tr> </table> MAT'L: 0.125" (3.2 mm) ALUMINUM	SYMBOL	X	Y	WID	HT																																														DESIGN BY: SGM PROJECT ID: B-5825 LOCATION: YADKIN/FORSYTH COUNTIES CHECKED BY: _____ Mar 23, 2020 DIV: 11 & 9	<p style="text-align: center;">Spacing Factor is 1 unless specified otherwise</p>
SYMBOL	X	Y	WID	HT																																																	

USE NOTES: 1,2

- Legend and border(except those that are colored black) shall be direct applied Grade C sheeting.
- Background shall be Grade C reflective sheeting.

Letter locations are panel edge to lower left corner											Series/Size
W	e	l	c	o	m	e	T	o			Text Length
20.1	22.6	24.5	25.4	27.2	29.1	32.1	33.6	36.6	38.4		C 2000
											19.9
F	O	R	S	Y	T	H	C	O			D 2000
11.6	15.4	20	23.9	27.7	32.3	36.2	39.6	44.6	49		40.9
L	e	a	v	i	n	g					C 2000
24.1	25.9	27.6	29.4	31.5	32.4	34.4					11.9
Y	A	D	K	I	N	C	O			D 2000	
9.6	14.2	19.2	23.7	28	30	33.4	38.4	42.8			36.8

FILENAME: R-25888_Sgn_SGN_TYPE_D NORTH CAROLINA D.O.T. SIGN DETAIL

SIGN NUMBER: 303,304 TYPE: D QUANTITY: 2 SIGN WIDTH: 5'-6" HEIGHT: 1'-6" TOTAL AREA: 8.3 Sq.Ft. BORDER TYPE: FLUSH RECESS: 0" WIDTH: 1" RADII: 3" NO. Z BARS: _____ LENGTH: _____	BACKG COLOR: Green COPY COLOR: White <table border="1" style="width:100%; border-collapse: collapse;"> <tr><th>SYMBOL</th><th>X</th><th>Y</th><th>WID</th><th>HT</th></tr> <tr><td> </td><td> </td><td> </td><td> </td><td> </td></tr> <tr><td> </td><td> </td><td> </td><td> </td><td> </td></tr> <tr><td> </td><td> </td><td> </td><td> </td><td> </td></tr> <tr><td> </td><td> </td><td> </td><td> </td><td> </td></tr> <tr><td> </td><td> </td><td> </td><td> </td><td> </td></tr> <tr><td> </td><td> </td><td> </td><td> </td><td> </td></tr> <tr><td> </td><td> </td><td> </td><td> </td><td> </td></tr> <tr><td> </td><td> </td><td> </td><td> </td><td> </td></tr> <tr><td> </td><td> </td><td> </td><td> </td><td> </td></tr> </table> MAT'L: 0.125" (3.2 mm) ALUMINUM	SYMBOL	X	Y	WID	HT																																														DESIGN BY: SGM PROJECT ID: B-5825 LOCATION: YADKIN/FORSYTH COUNTIES CHECKED BY: _____ Mar 23, 2020 DIV: 11 & 9	<p style="text-align: center;">Spacing Factor is 1 unless specified otherwise</p>
SYMBOL	X	Y	WID	HT																																																	

USE NOTES: 1,2

- Legend and border(except those that are colored black) shall be direct applied Grade C sheeting.
- Background shall be Grade C reflective sheeting.



Letter locations are panel edge to lower left corner											Series/Size
Y	a	d	k	i	n	R	i	v	e	r	Text Length
8.5	14.1	18.4	23.2	27.8	29.9	33.5	39.5	44.5	46.1	50.9	D 2000
										49.1	

FILENAME: R-25888_Sgn_SGN_TYPE_D NORTH CAROLINA D.O.T. SIGN DETAIL

3/23/2020
 X:\NC\001\B-5825\Traffic\Signing\CADD\Signing_Layout_Plans\250_006_B-5825_Sgn_SGN_02A(Special).dgn
 User:tdwhittington

SPECIAL SIGN DESIGN

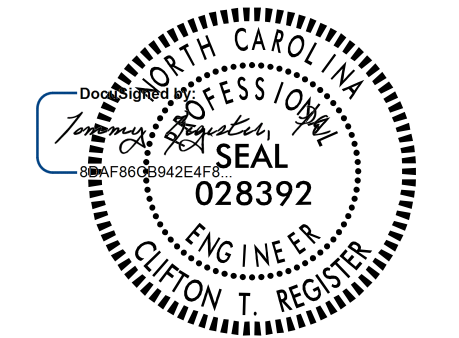
8/17/99

TIP NO. B-5825	SHEET NO. SIGN-3
APPROVED: _____	
DATE: 3/23/2020 10:59 AM PDT	
SEAL	
	
DOCUMENT NOT CONSIDERED FINAL UNLESS ALL SIGNATURES COMPLETED	
 TGS ENGINEERS 706 HILLSBOROUGH ST., SUITE 200 RALEIGH, NC 27603 PH (919) 773-8887 CORP. LICENSE NO.: C-0275	

BEGIN TIP PROJECT B-5825
-L- POT Sta. 14+00.00

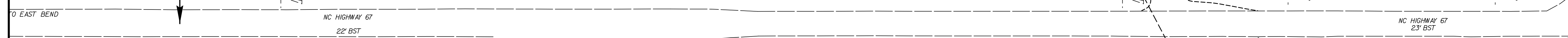

**SPEED
LIMIT
55**

SEE NOTE 1

SEE NOTE 1
**WEST
67**

SEE NOTE 1
FORBUSH HIGH SCHOOL
LADIES VOLEYBALL
STATE CHAMPS

SEE NOTES 2 & 4
**WELCOME TO
YADKIN
COUNTY**
Entering the
YADKIN VALLEY

SEE NOTE 1
STOP
SEE NOTE 1

PROJECT NOTES

- 1 DISPOSAL OF SIGN SYSTEM, U-CHANNEL
- 2 DISPOSAL OF SUPPORT, WOOD
- 3 DISPOSAL OF SUPPORT, U-CHANNEL
- 4 RELOCATE SIGN ON NEW SUPPORTS
(MATCH EXISTING)

EXISTING SIGNS

3/23/2020 10:59:59 AM C:\projects\B-5825\traffic\signing\cadd\signing_layout\plans\250_009_B-5825_Sgn_SGN_03.dgn

TIP NO. B-5825	SHEET NO. SIGN-4
APPROVED: _____	
DATE: 3/23/2020 10:59 AM PDT	
SEAL	
DOCUMENT NOT CONSIDERED FINAL UNLESS ALL SIGNATURES COMPLETED	
TGS ENGINEERS TGS ENGINEERS 706 HILLSBOROUGH ST., SUITE 200 RALEIGH, NC 27603 PH (919) 773-8887 CORP. LICENSE NO.: C-0275	

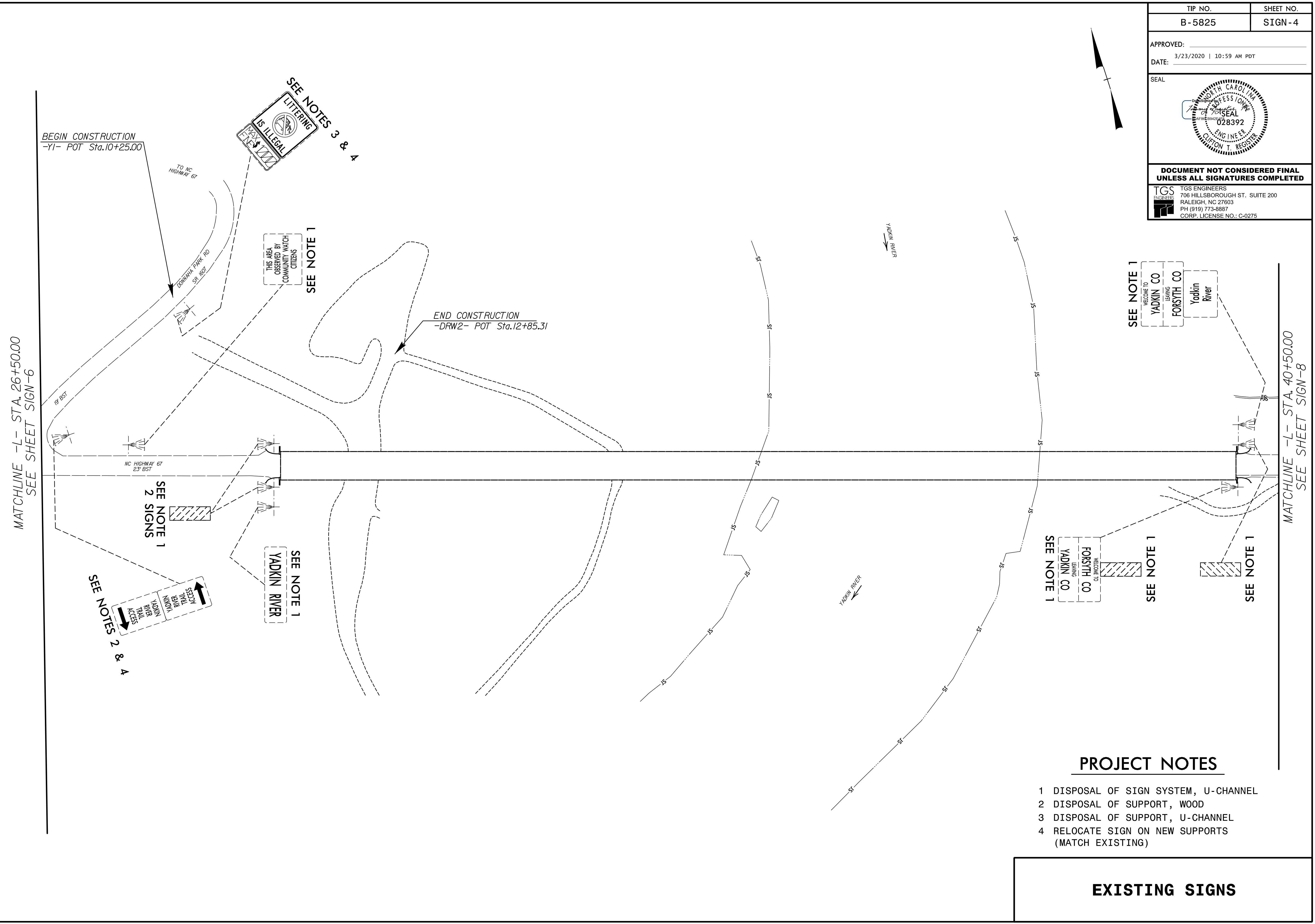
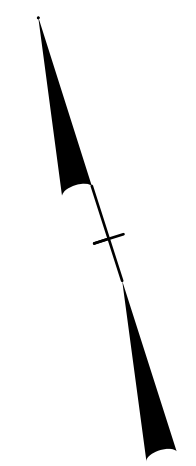

MATCHLINE -L- STA. 26+50.00
SEE SHEET SIGN-6

MATCHLINE -L- STA. 40+50.00
SEE SHEET SIGN-8

BEGIN CONSTRUCTION
-Y1- POT Sta.10+25.00

END CONSTRUCTION
-DRW2- POT Sta.12+85.31

SEE NOTES 2 & 4

SEE NOTE 1

SEE NOTE 1

SEE NOTE 1

SEE NOTE 1

SEE NOTES 3 & 4

THIS AREA
OBSERVED BY
COMMUNITY WATCH
CITIZENS

SEE NOTE 1

SEE NOTE 1

SEE NOTE 1

SEE NOTE 1

PROJECT NOTES

- 1 DISPOSAL OF SIGN SYSTEM, U-CHANNEL
- 2 DISPOSAL OF SUPPORT, WOOD
- 3 DISPOSAL OF SUPPORT, U-CHANNEL
- 4 RELOCATE SIGN ON NEW SUPPORTS (MATCH EXISTING)

EXISTING SIGNS

8/17/99

MATCHLINE -Y2- STA. 17+00.00

MATCHLINE -L- STA. 40+50.00
SEE SHEET SIGN-7

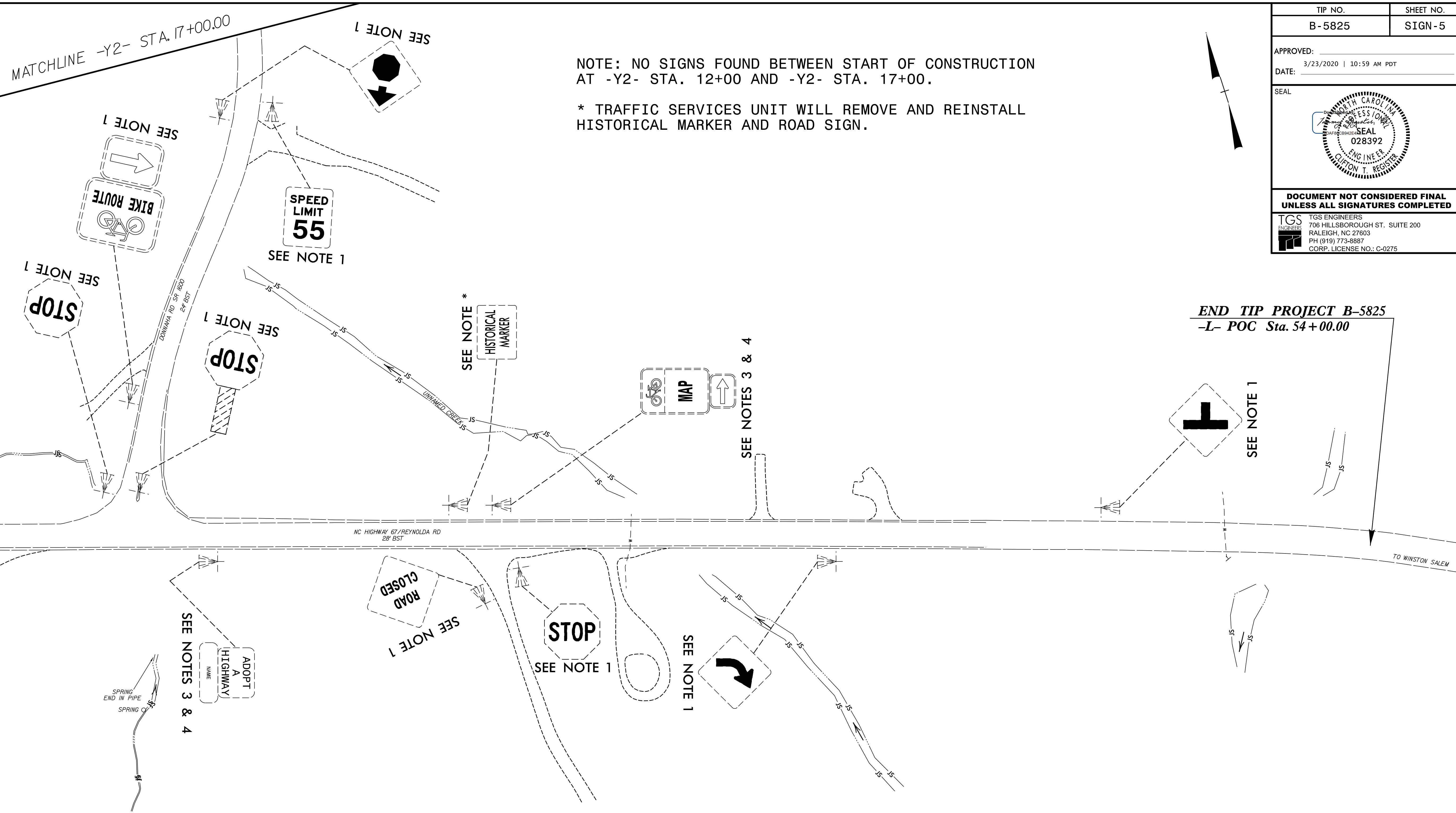

TIP NO. B-5825	SHEET NO. SIGN-5
APPROVED: _____ DATE: 3/23/2020 10:59 AM PDT	
SEAL 	
DOCUMENT NOT CONSIDERED FINAL UNLESS ALL SIGNATURES COMPLETED	
TGS ENGINEERS 706 HILLSBOROUGH ST., SUITE 200 RALEIGH, NC 27603 PH (919) 773-8887 CORP. LICENSE NO.: C-0275	

PROJECT NOTES

- 1 DISPOSAL OF SIGN SYSTEM, U-CHANNEL
- 2 DISPOSAL OF SUPPORT, WOOD
- 3 DISPOSAL OF SUPPORT, U-CHANNEL
- 4 RELOCATE SIGN ON NEW SUPPORTS (MATCH EXISTING)

EXISTING SIGNS

3/23/2020_5825\traffic\signing\cadd\signing_layout\plans\250_015_B-5825_Sgn_SON_05.dgn
M:\cadd\traffic\signing\cadd\signing_layout\plans\250_015_B-5825_Sgn_SON_05.dgn

8/17/99

TIP NO. B-5825	SHEET NO. SIGN-6
-------------------	---------------------

APPROVED: _____
 DATE: 3/23/2020 | 10:59 AM PDT

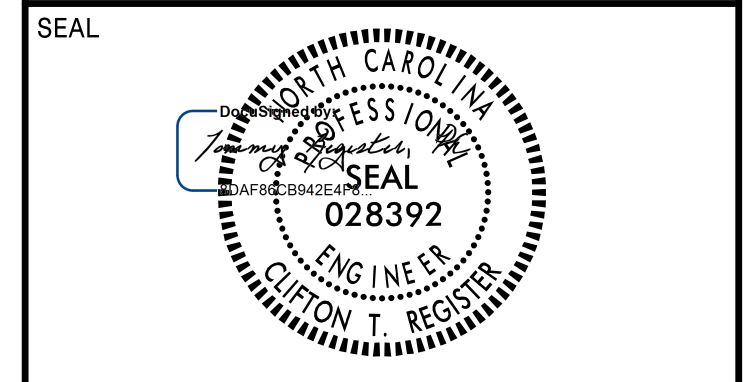

**DOCUMENT NOT CONSIDERED FINAL
UNLESS ALL SIGNATURES COMPLETED**

TGS ENGINEERS
 706 HILLSBOROUGH ST., SUITE 200
 RALEIGH, NC 27603
 PH (919) 773-8887
 CORP. LICENSE NO.: C-0275

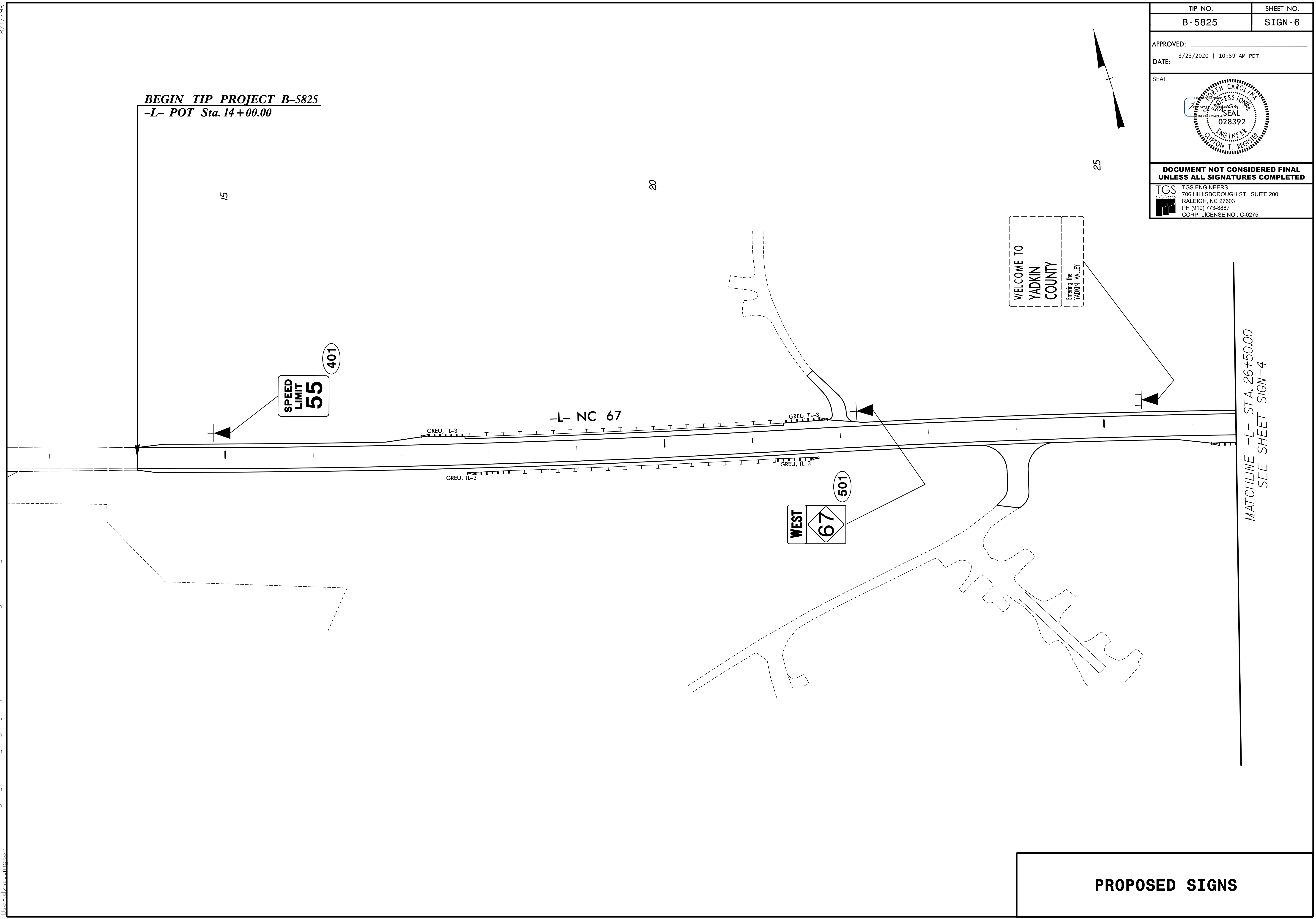

PROPOSED SIGNS

3/23/2020 10:59 AM TGS\traffic\signing\cadd\signing_layout\plans\250_018_B-5825_Sgn_SON_06.dgn

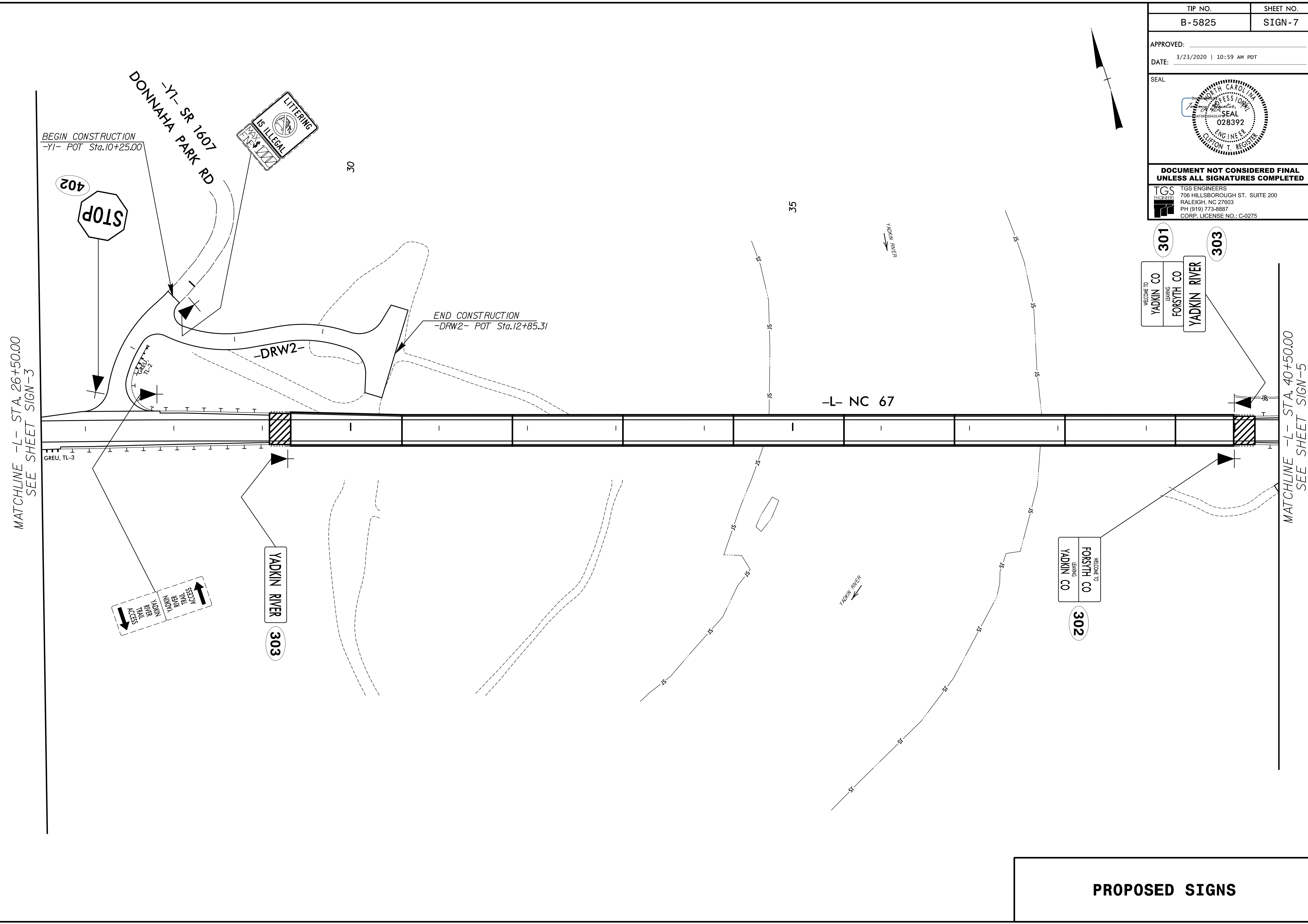

TIP NO. B-5825	SHEET NO. SIGN-7
APPROVED: _____	
DATE: 3/23/2020 10:59 AM PDT	
SEAL	
DOCUMENT NOT CONSIDERED FINAL UNLESS ALL SIGNATURES COMPLETED	
TGS ENGINEERS 706 HILLSBOROUGH ST., SUITE 200 RALEIGH, NC 27603 PH (919) 773-8887 CORP. LICENSE NO.: C-0275	

PROPOSED SIGNS

8/17/99

MATCHLINE -Y2- STA. 17+00.00

NOTE: NO SIGNS FOUND BETWEEN START OF CONSTRUCTION AT -Y2- STA. 12+00 AND -Y2- STA. 17+00.

TIP NO. B-5825	SHEET NO. SIGN-8
APPROVED: _____	
DATE: 3/23/2020 10:59 AM PDT	
SEAL	
DOCUMENT NOT CONSIDERED FINAL UNLESS ALL SIGNATURES COMPLETED	
TGS ENGINEERS 706 HILLSBOROUGH ST., SUITE 200 RALEIGH, NC 27603 PH (919) 773-8887 CORP. LICENSE NO.: C-0275	

MATCHLINE -L- STA. 40+50.00
SEE SHEET SIGN-4

3/23/2020 5:58:25 PM traffic\signing\cadd\signing_layout\plans\250_024_B-5825_Sgn_SGN_08.dgn

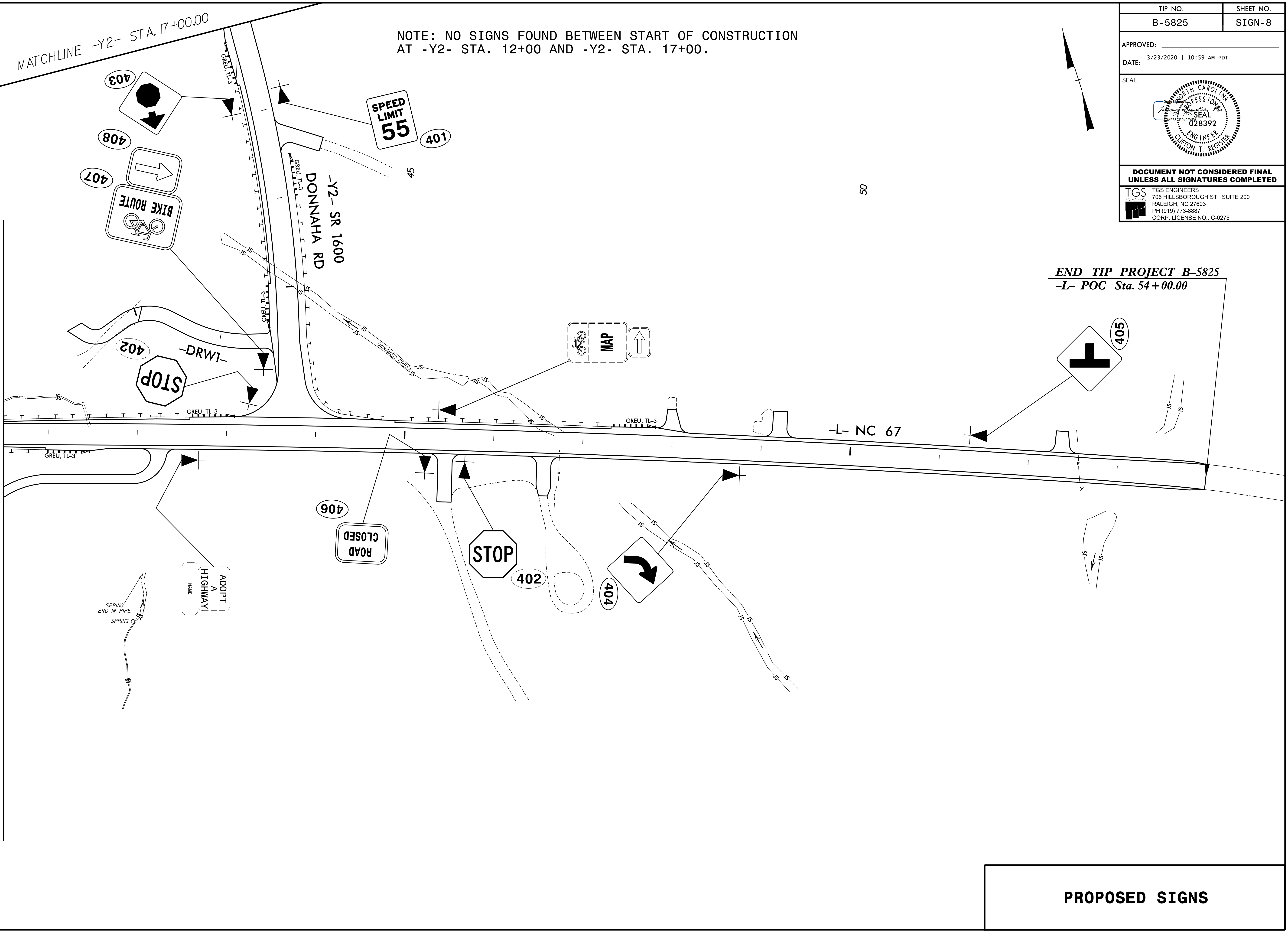

PROPOSED SIGNS