

REINFORCING STEEL BAR SCHEDULE

BAR No.	SIZE	TYPE	LENGTH	WEIGHT	BAR No.	SIZE	TYPE	LENGTH	WEIGHT	BAR No.	SIZE	TYPE	LENGTH	WEIGHT	BAR No.	SIZE	TYPE	LENGTH	WEIGHT				
A1	416	#5	4	5'-8"	2459	A200	191	#6	STR	10'-2"	2917	A300	96	#4	STR	10'-2"	652	A400	96	#4	STR	10'-2"	652
A2	416	#5	4	5'-8"	2459	A201	1	#6	STR	9'-10"	15	A301	1	#4	STR	9'-4"	6	A401	1	#4	STR	9'-4"	6
A100	191	#6	STR	10'-2"	2917	A202	1	#6	STR	9'-4"	14	A302	1	#4	STR	8'-3"	6	A402	1	#4	STR	8'-3"	6
A101	1	#6	STR	9'-10"	15	A203	1	#6	STR	8'-9"	13	A303	1	#4	STR	7'-2"	5	A403	1	#4	STR	7'-2"	5
A102	1	#6	STR	9'-4"	14	A204	1	#6	STR	8'-3"	12	A304	1	#4	STR	6'-1"	4	A404	1	#4	STR	6'-1"	4
A103	1	#6	STR	8'-9"	13	A205	1	#6	STR	7'-9"	12	A305	1	#4	STR	5'-0"	3	A405	1	#4	STR	5'-0"	3
A104	1	#6	STR	8'-3"	12	A206	1	#6	STR	7'-2"	11	A306	1	#4	STR	4'-0"	3	A406	1	#4	STR	4'-0"	3
A105	1	#6	STR	7'-9"	12	A207	1	#6	STR	6'-8"	10	A307	1	#4	STR	2'-11"	2	A407	1	#4	STR	2'-11"	2
A106	1	#6	STR	7'-2"	11	A208	1	#6	STR	6'-1"	9	A308	4	#4	STR	1'-5"	4	A408	4	#4	STR	1'-5"	4
A107	1	#6	STR	6'-8"	10	A209	1	#6	STR	5'-7"	8	A309	2	#4	STR	5'-10"	8	A409	2	#4	STR	5'-10"	8
A108	1	#6	STR	6'-1"	9	A210	1	#6	STR	5'-0"	8						B1	416	#4	STR	9'-6"	2640	
A109	1	#6	STR	5'-7"	8	A211	1	#6	STR	4'-6"	7						B2	416	#4	STR	9'-0"	2501	
A110	1	#6	STR	5'-0"	8	A212	1	#6	STR	4'-0"	6						C1	150	#4	STR	37'-8"	3774	
A111	1	#6	STR	4'-6"	7	A213	1	#6	STR	3'-5"	5						G1	2	#4	STR	10'-2"	14	
A112	1	#6	STR	4'-0"	6	A214	1	#6	STR	2'-11"	4						S2	6	#6	STR	13'-8"	123	
A113	1	#6	STR	3'-5"	5	A215	6	#6	STR	3'-8"	33						S3	6	#6	STR	10'-2"	92	
A114	1	#6	STR	2'-11"	4	A216	4	#6	STR	8'-5"	51						E1	16	#5	STR	4'-7"	76	
A115	6	#6	STR	3'-8"	33											D1	28	#6	STR	2'-6"	105		
A116	4	#6	STR	8'-5"	51											TOTAL REINFORCING STEEL				21,899 LBS.			

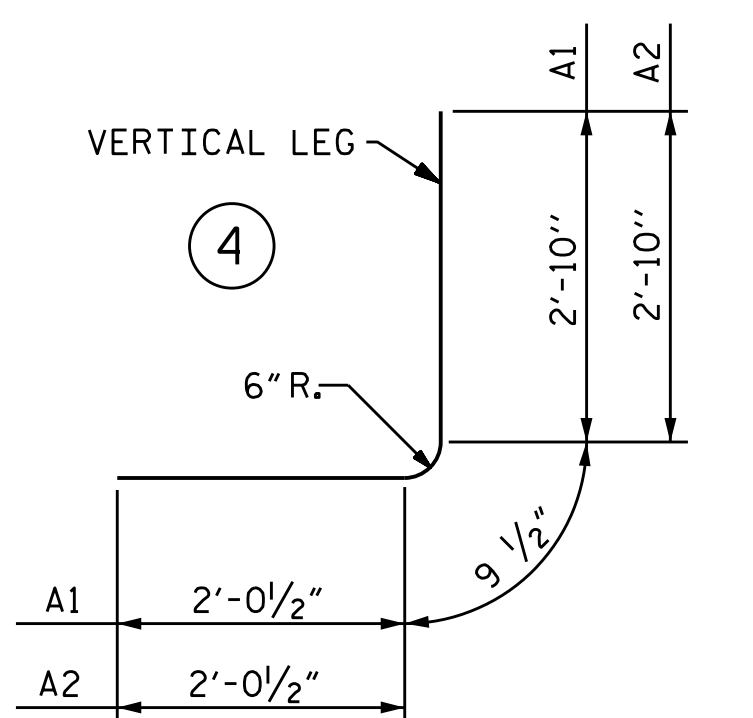

BAR TYPE

BAR DIMENSIONS ARE OUT TO OUT

BAR	SIZE	SPLICE LENGTH
C1	#4	2'-5"
B1	#4	2'-5"

PROJECT NO. B-5825
YADKIN/FORSYTH COUNTY
 STATION: 46+80.60 -L-

SHEET 6 OF 7

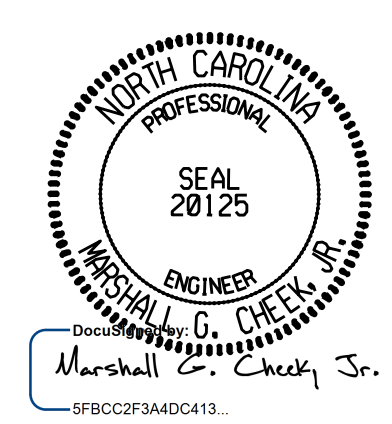

STATE OF NORTH CAROLINA
 DEPARTMENT OF TRANSPORTATION
 RALEIGH
 SINGLE 9 FT. X 9 FT.
 CONCRETE BOX CULVERT
 EXTENSION

DOCUMENT NOT CONSIDERED FINAL UNLESS ALL SIGNATURES COMPLETED						REVISIONS			SHEET NO.			
TCS ENGINEERS 706 HILLSBOROUGH STREET SUITE 200 RALEIGH, NC 27603 PH (919) 773-8887 CORP. LICENSE NO.: C-0275						NO.	BY:	DATE:	NO.	BY:	DATE:	C1-6
						1			3			TOTAL SHEETS
						2			4			13

DRAWN BY : ZCS	DATE : 10/19
CHECKED BY : MGC	DATE : 12/19
DESIGN ENGINEER OF RECORD: ZCS	DATE : 12/19