

8/17/99

| | |
|--|--------------------------|
| PROJECT REFERENCE NO. <i>BR-0047</i> | SHEET NO. <i>X-1A</i> |
| ROADWAY DESIGN ENGINEER | |
|  | |
| DOCUMENT NOT CONSIDERED FINAL UNLESS ALL SIGNATURES COMPLETED | |
|  PARRISH & PARTNERS 11325 N COMMUNITY HOUSE RD SUITE 260 CHARLOTTE, NC 28277 | |

| CROSS SECTION INDEX OF SHEETS | | |
|-------------------------------|-----------|-----------------|
| ALIGNMENT | SHEET NO. | SHEET SUBTOTALS |
| -L- | X1 - X10 | 10 |
| -Y1- | X11 | 1 |
| -Y2- | X12-X14 | 3 |
| -Y3- | X15 | 1 |
| TOTAL CROSS SECTION SHEETS | | 15 |

2/26/2020 2:58:10 PM XS_Index_SHEET.dgn

STATE OF NORTH CAROLINA DIVISION OF HIGHWAYS

Approximate quantities only. Unclassified Excavation, Borrow Excavation, Fine Grading, Clearing and Grubbing, Breaking of Existing Pavement and Removal of Existing Pavement will be paid for at the lump sum price for "Grading".

NOTE: EMBANKMENT COLUMN DOES NOT INCLUDE BACKFILL FOR UNDERCUT

CROSS-SECTION SUMMARY

| Station | Uncl. Exc. | Embt | Station | Uncl. Exc. | Embt | | | | | | | | | | |
|----------|------------|-----------|----------|------------|-----------|--|--|--|--|--|--|--|--|--|--|
| L | (cu. yd.) | (cu. yd.) | Y2 (LT) | (cu. yd.) | (cu. yd.) | | | | | | | | | | |
| 11+00.00 | 0 | 0 | 12+00.00 | 0 | 0 | | | | | | | | | | |
| 11+50.00 | 13 | 5 | 12+50.00 | 347 | 0 | | | | | | | | | | |
| 12+00.00 | 9 | 94 | 13+00.00 | 394 | 3 | | | | | | | | | | |
| 12+50.00 | 7 | 301 | 13+50.00 | 209 | 5 | | | | | | | | | | |
| 13+00.00 | 5 | 542 | 14+00.00 | 77 | 5 | | | | | | | | | | |
| 13+50.00 | 2 | 709 | 14+50.00 | 106 | 8 | | | | | | | | | | |
| 14+00.00 | 0 | 856 | 15+00.00 | 88 | 8 | | | | | | | | | | |
| 14+50.00 | 0 | 1060 | 15+50.00 | 68 | 4 | | | | | | | | | | |
| 15+00.00 | 0 | 1232 | 16+00.00 | 68 | 6 | | | | | | | | | | |
| 15+50.00 | 0 | 1365 | 16+50.00 | 46 | 15 | | | | | | | | | | |
| 16+00.00 | 0 | 1306 | | | | | | | | | | | | | |
| 16+50.00 | 0 | 1231 | | | | | | | | | | | | | |
| 17+00.00 | 0 | 1483 | | | | | | | | | | | | | |
| Station | Uncl. Exc. | Embt | Station | Uncl. Exc. | Embt | | | | | | | | | | |
| L | (cu. yd.) | (cu. yd.) | Y2 (RT) | (cu. yd.) | (cu. yd.) | | | | | | | | | | |
| 19+50.00 | 0 | 0 | 10+50.00 | 0 | 0 | | | | | | | | | | |
| 20+00.00 | 0 | 581 | 11+00.00 | 25 | 9 | | | | | | | | | | |
| 20+50.00 | 0 | 992 | 11+50.00 | 48 | 29 | | | | | | | | | | |
| 21+00.00 | 0 | 1249 | 12+00.00 | 46 | 54 | | | | | | | | | | |
| 21+50.00 | 0 | 1385 | 12+50.00 | 67 | 36 | | | | | | | | | | |
| 22+00.00 | 0 | 1210 | 13+00.00 | 102 | 10 | | | | | | | | | | |
| 22+50.00 | 0 | 1058 | 13+50.00 | 62 | 15 | | | | | | | | | | |
| 23+00.00 | 6 | 829 | 14+00.00 | 29 | 13 | | | | | | | | | | |
| 23+50.00 | 35 | 608 | 14+50.00 | 70 | 101 | | | | | | | | | | |
| 24+00.00 | 93 | 450 | 15+00.00 | 90 | 153 | | | | | | | | | | |
| 24+50.00 | 163 | 256 | | | | | | | | | | | | | |
| 25+00.00 | 181 | 119 | | | | | | | | | | | | | |
| 25+50.00 | 85 | 81 | | | | | | | | | | | | | |
| Station | Uncl. Exc. | Embt | | | | | | | | | | | | | |
| Y1 | (cu. yd.) | (cu. yd.) | | | | | | | | | | | | | |
| 12+10.00 | 0 | 0 | | | | | | | | | | | | | |
| 12+20.00 | 0 | 0 | | | | | | | | | | | | | |
| 12+30.00 | 0 | 0 | | | | | | | | | | | | | |
| 12+40.00 | 0 | 1 | | | | | | | | | | | | | |
| 12+50.00 | 0 | 1 | | | | | | | | | | | | | |
| 12+60.00 | 0 | 1 | | | | | | | | | | | | | |
| 12+70.00 | 0 | 2 | | | | | | | | | | | | | |
| 12+80.00 | 0 | 4 | | | | | | | | | | | | | |
| Station | Uncl. Exc. | Embt | | | | | | | | | | | | | |
| Y3 | (cu. yd.) | (cu. yd.) | | | | | | | | | | | | | |
| 12+60.00 | 0 | 0 | | | | | | | | | | | | | |
| 12+70.00 | 5 | 1 | | | | | | | | | | | | | |
| 12+80.00 | 5 | 2 | | | | | | | | | | | | | |
| 12+90.00 | 4 | 2 | | | | | | | | | | | | | |
| 13+00.00 | 2 | 2 | | | | | | | | | | | | | |
| 13+10.00 | 1 | 2 | | | | | | | | | | | | | |
| 13+20.00 | 0 | 4 | | | | | | | | | | | | | |

6/23/16

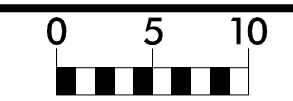

| | |
|---------------------|-----------|
| PROJ. REFERENCE NO. | SHEET NO. |
| BR-0047 | X-1 |

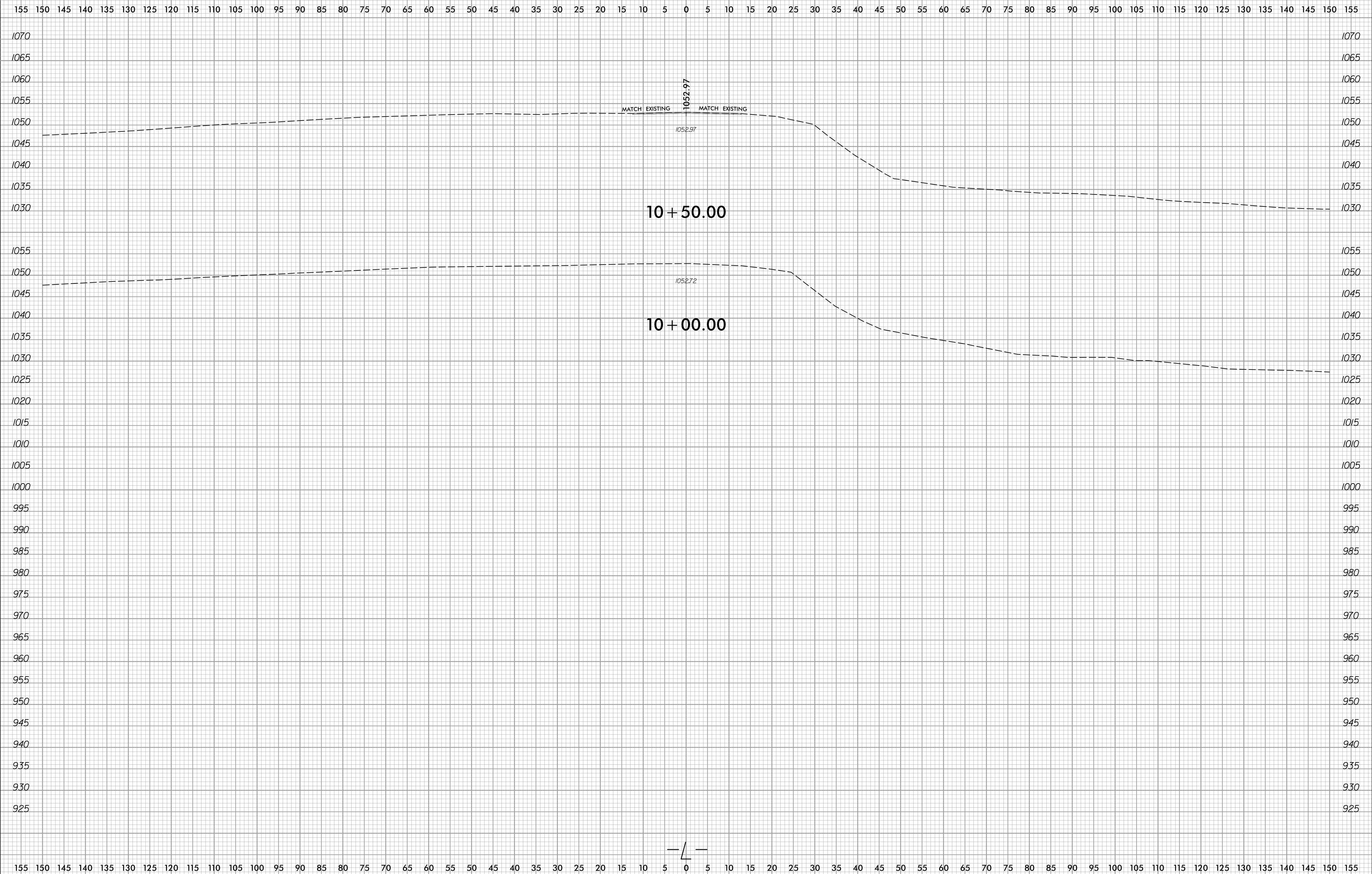

2/25/2020 3:10:21 PM \\s:\projects\160047_RDY.L_XPL.dgn

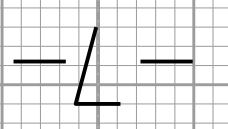

6/23/16

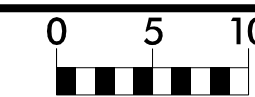

| | |
|---------------------|-----------|
| PROJ. REFERENCE NO. | SHEET NO. |
| BR-0047 | X-3 |

155 150 145 140 135 130 125 120 115 110 105 100 95 90 85 80 75 70 65 60 55 50 45 40 35 30 25 20 15 10 5 0 5 10 15 20 25 30 35 40 45 50 55 60 65 70 75 80 85 90 95 100 105 110 115 120 125 130 135 140 145 150 155

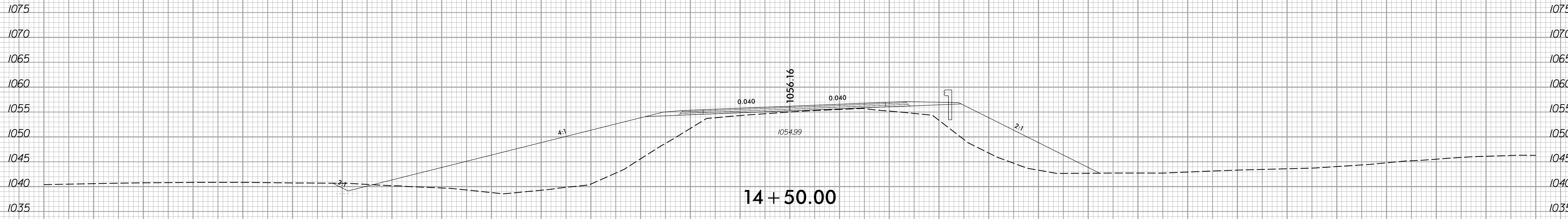

14 + 50.00

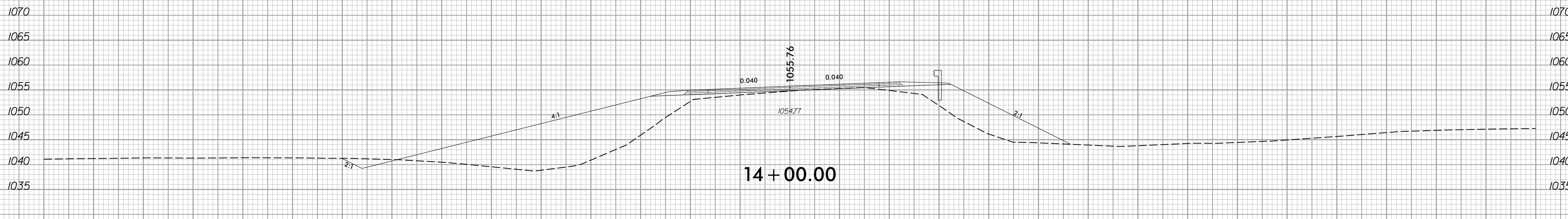

14 + 00.00

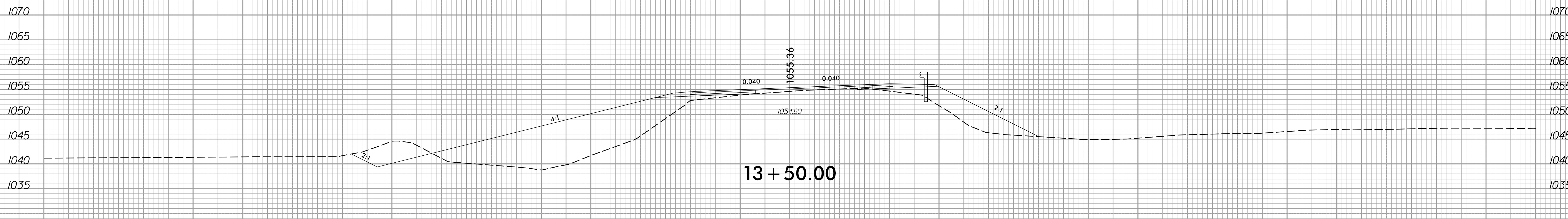

13 + 50.00

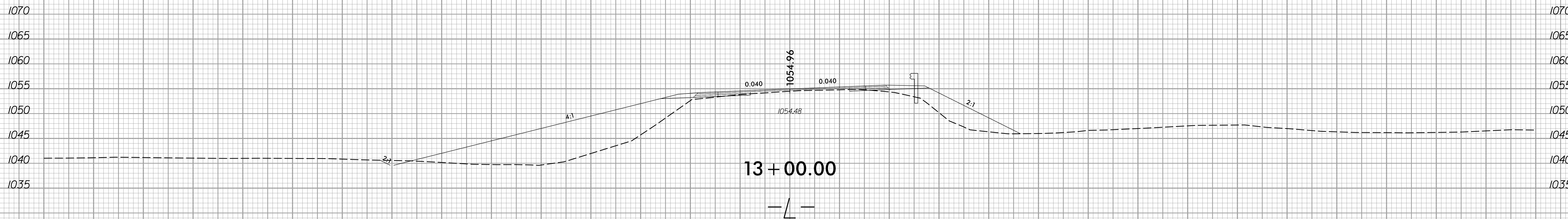

13 + 00.00

155 150 145 140 135 130 125 120 115 110 105 100 95 90 85 80 75 70 65 60 55 50 45 40 35 30 25 20 15 10 5 0 5 10 15 20 25 30 35 40 45 50 55 60 65 70 75 80 85 90 95 100 105 110 115 120 125 130 135 140 145 150 155

2/25/2020 11:02:34 AM 3:10:23 PM 140047_RDY_L_XPL.dgn

6/23/16

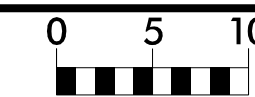

| | |
|---------------------|-----------|
| PROJ. REFERENCE NO. | SHEET NO. |
| BR-0047 | X-4 |

155 150 145 140 135 130 125 120 115 110 105 100 95 90 85 80 75 70 65 60 55 50 45 40 35 30 25 20 15 10 5 0 5 10 15 20 25 30 35 40 45 50 55 60 65 70 75 80 85 90 95 100 105 110 115 120 125 130 135 140 145 150 155

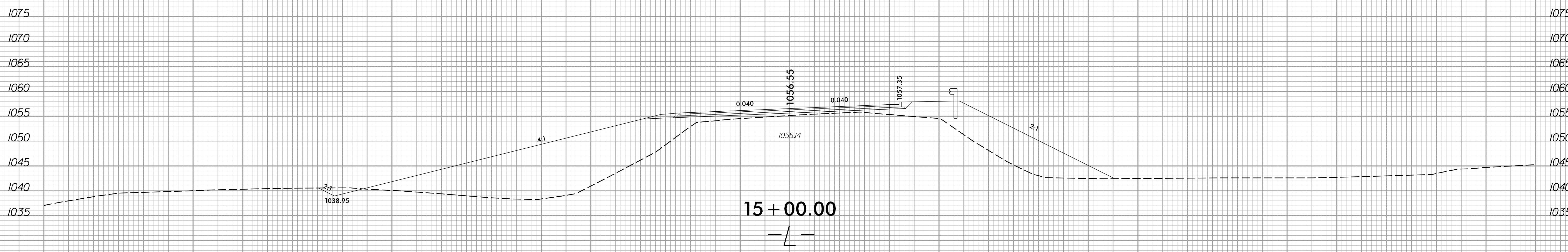
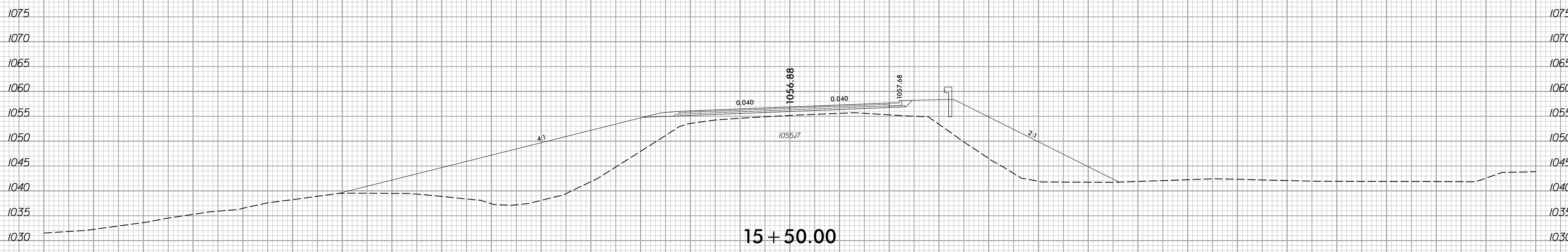
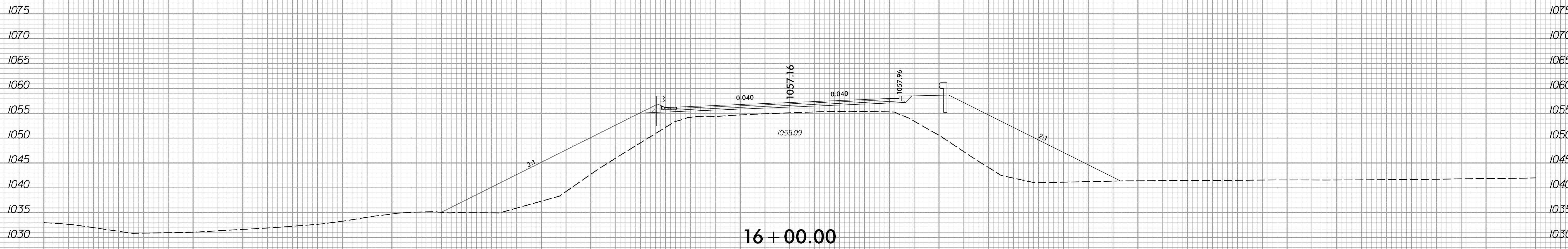

155 150 145 140 135 130 125 120 115 110 105 100 95 90 85 80 75 70 65 60 55 50 45 40 35 30 25 20 15 10 5 0 5 10 15 20 25 30 35 40 45 50 55 60 65 70 75 80 85 90 95 100 105 110 115 120 125 130 135 140 145 150 155

2/25/2020 3:10:23 PM 3:10:23 PM BR-0047_RDY_L_XPL.dgn

6/23/16

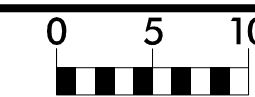

PROJ. REFERENCE NO.
BR-0047

SHEET NO.
X-5

155 150 145 140 135 130 125 120 115 110 105 100 95 90 85 80 75 70 65 60 55 50 45 40 35 30 25 20 15 10 5 0 5 10 15 20 25 30 35 40 45 50 55 60 65 70 75 80 85 90 95 100 105 110 115 120 125 130 135 140 145 150 155

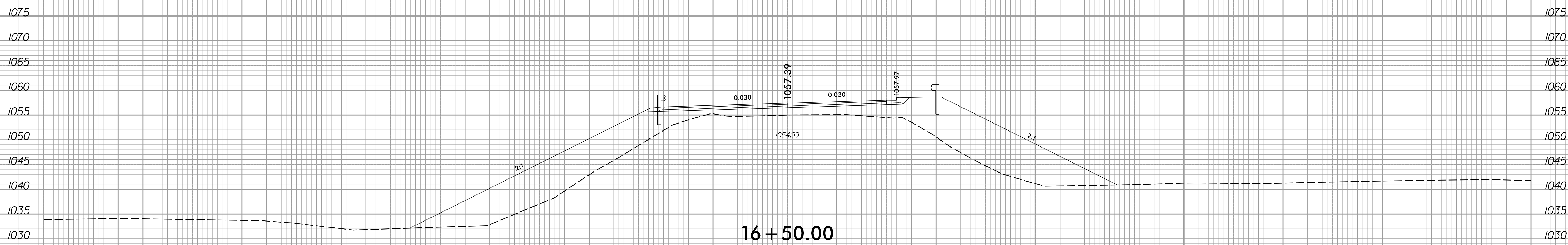
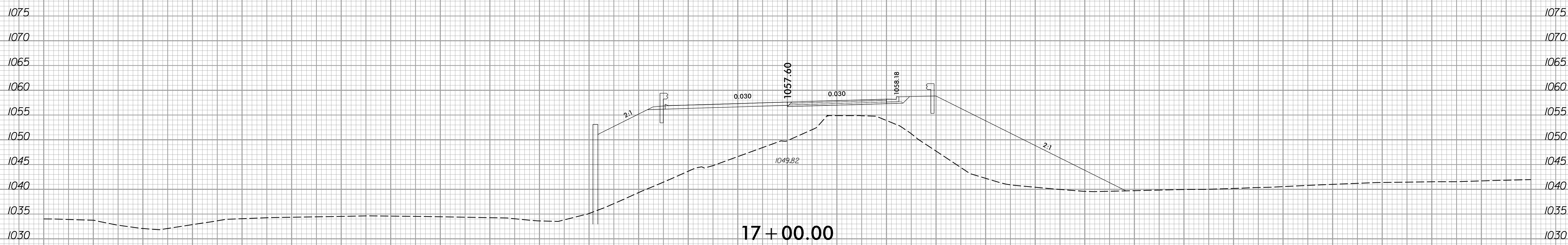
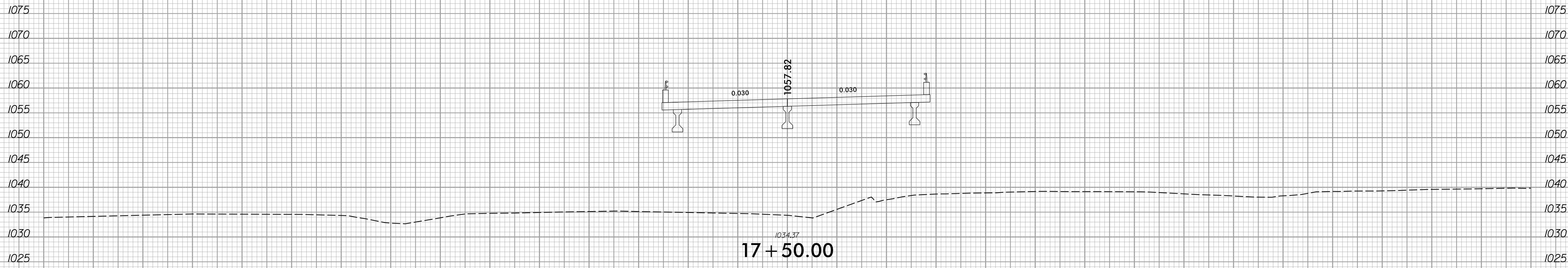

155 150 145 140 135 130 125 120 115 110 105 100 95 90 85 80 75 70 65 60 55 50 45 40 35 30 25 20 15 10 5 0 5 10 15 20 25 30 35 40 45 50 55 60 65 70 75 80 85 90 95 100 105 110 115 120 125 130 135 140 145 150 155

2/25/2020 11:30 AM
3:10:30 PM
2020047_P0Y_L_XPL.dgn

155 150 145 140 135 130 125 120 115 110 105 100 95 90 85 80 75 70 65 60 55 50 45 40 35 30 25 20 15 10 5 0 5 10 15 20 25 30 35 40 45 50 55 60 65 70 75 80 85 90 95 100 105 110 115 120 125 130 135 140 145 150 155

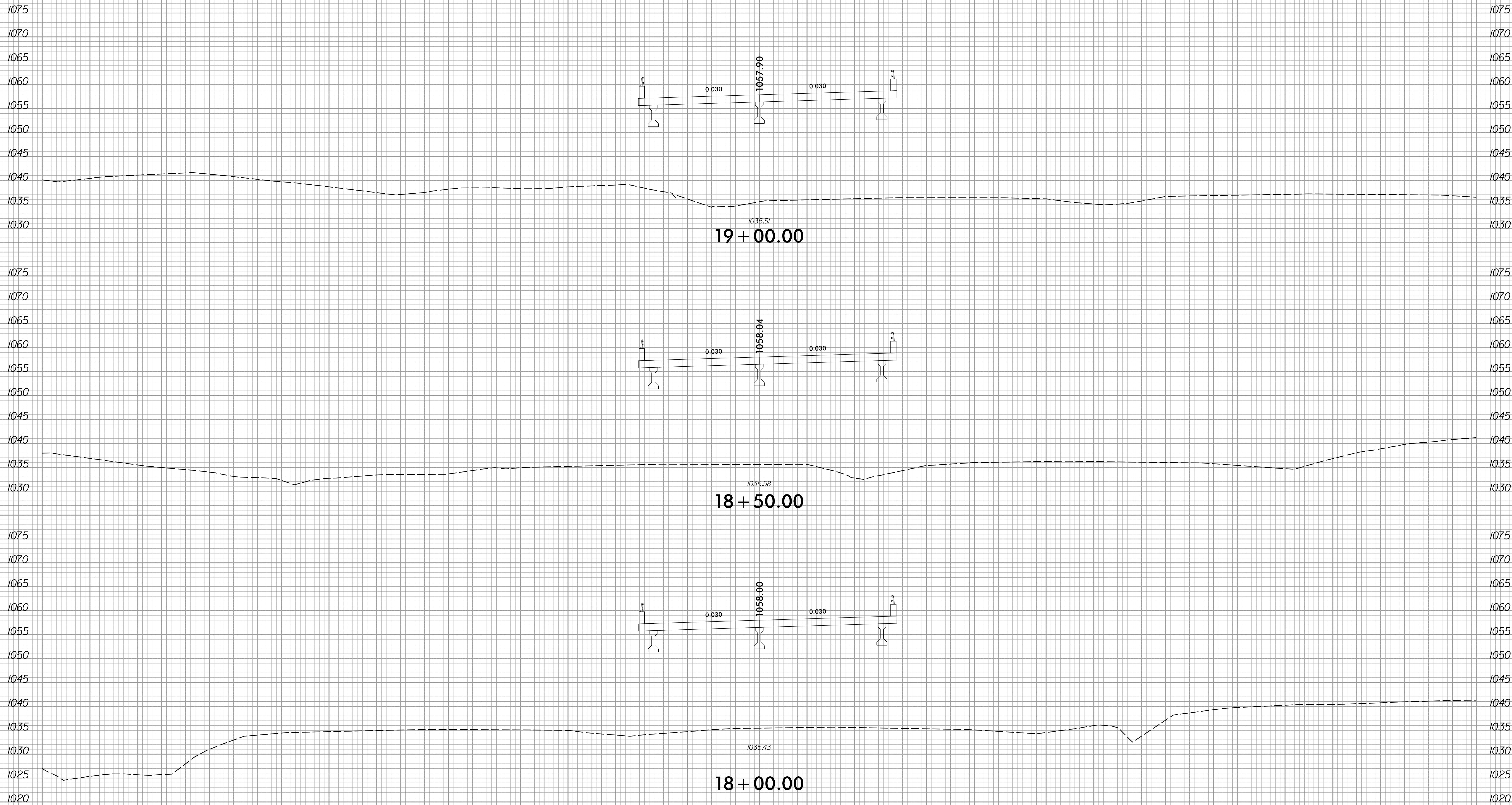

155 150 145 140 135 130 125 120 115 110 105 100 95 90 85 80 75 70 65 60 55 50 45 40 35 30 25 20 15 10 5 0 5 10 15 20 25 30 35 40 45 50 55 60 65 70 75 80 85 90 95 100 105 110 115 120 125 130 135 140 145 150 155

6/23/16

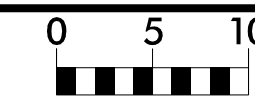

| | |
|---------------------|-----------|
| PROJ. REFERENCE NO. | SHEET NO. |
| BR-0047 | X-7 |

155 150 145 140 135 130 125 120 115 110 105 100 95 90 85 80 75 70 65 60 55 50 45 40 35 30 25 20 15 10 5 0 5 10 15 20 25 30 35 40 45 50 55 60 65 70 75 80 85 90 95 100 105 110 115 120 125 130 135 140 145 150 155

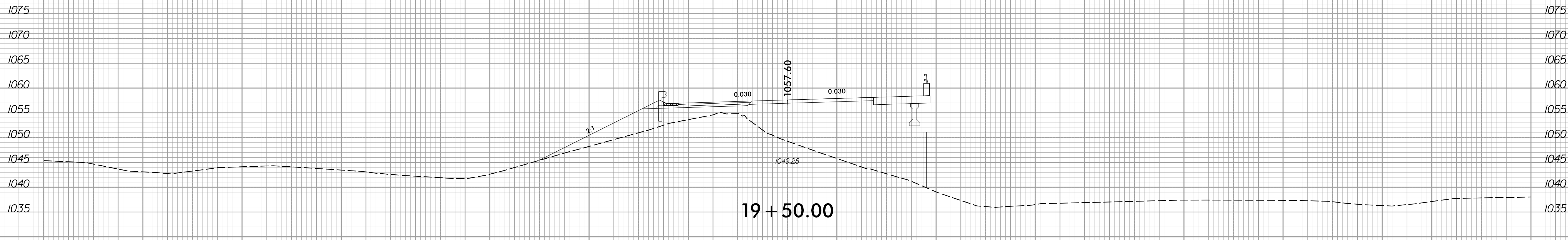
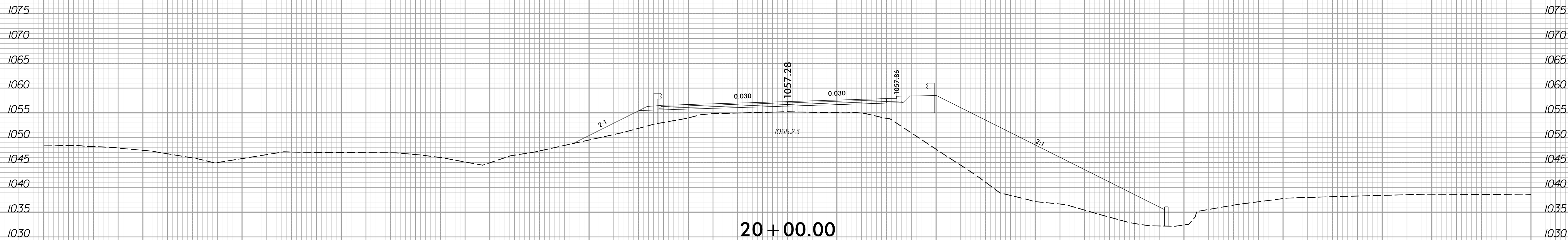
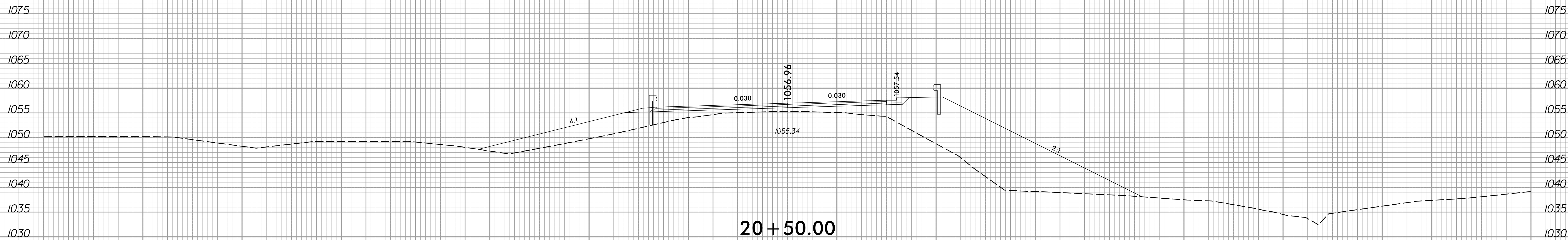

155 150 145 140 135 130 125 120 115 110 105 100 95 90 85 80 75 70 65 60 55 50 45 40 35 30 25 20 15 10 5 0 5 10 15 20 25 30 35 40 45 50 55 60 65 70 75 80 85 90 95 100 105 110 115 120 125 130 135 140 145 150 155

2/25/2020 11:30 AM
33:10:52 PM
2020047_R0Y_L_XPL.dgn

6/23/16

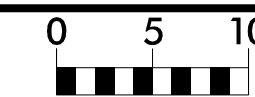

PROJ. REFERENCE NO.
BR-0047

SHEET NO.
X-8

155 150 145 140 135 130 125 120 115 110 105 100 95 90 85 80 75 70 65 60 55 50 45 40 35 30 25 20 15 10 5 0 5 10 15 20 25 30 35 40 45 50 55 60 65 70 75 80 85 90 95 100 105 110 115 120 125 130 135 140 145 150 155

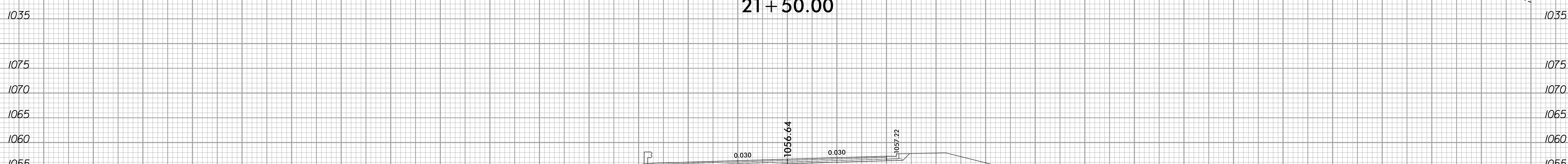
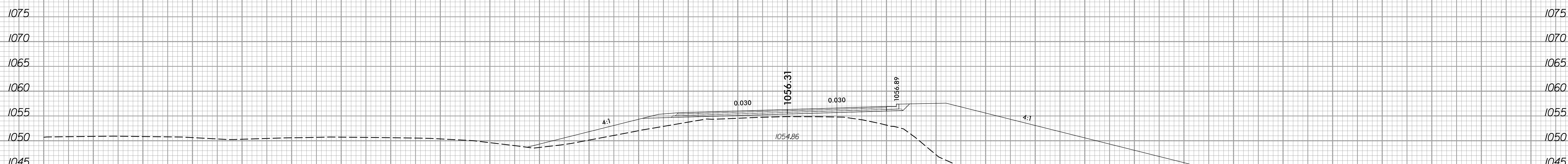
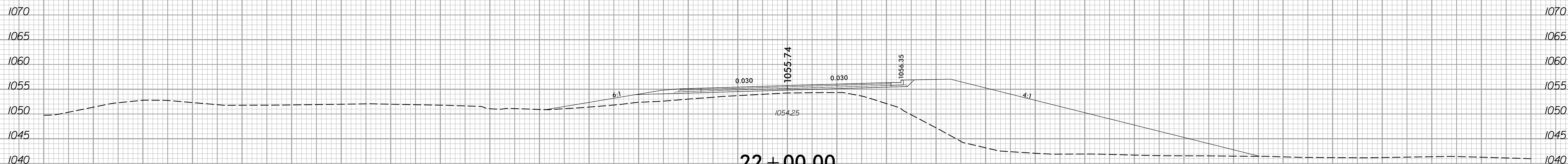
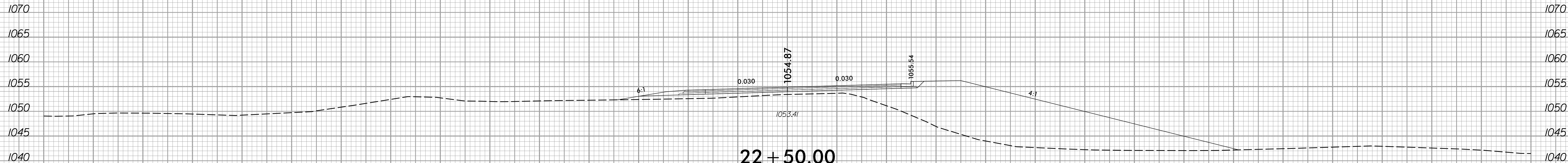

155 150 145 140 135 130 125 120 115 110 105 100 95 90 85 80 75 70 65 60 55 50 45 40 35 30 25 20 15 10 5 0 5 10 15 20 25 30 35 40 45 50 55 60 65 70 75 80 85 90 95 100 105 110 115 120 125 130 135 140 145 150 155

2/25/2020 11:35:14 AM
3:10:35 PM
210047_RDY_L_XPL.dgn

6/23/16

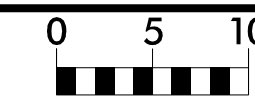

PROJ. REFERENCE NO.
BR-0047

SHEET NO.
X-9

155 150 145 140 135 130 125 120 115 110 105 100 95 90 85 80 75 70 65 60 55 50 45 40 35 30 25 20 15 10 5 0 5 10 15 20 25 30 35 40 45 50 55 60 65 70 75 80 85 90 95 100 105 110 115 120 125 130 135 140 145 150 155

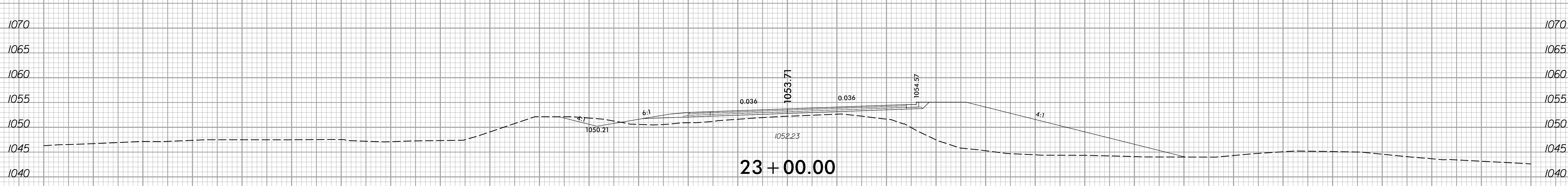
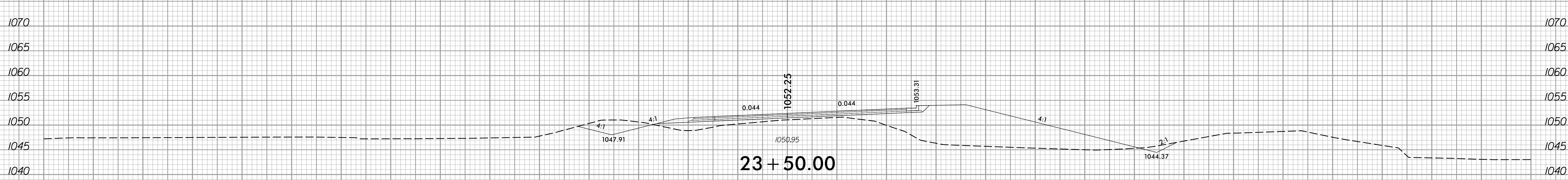
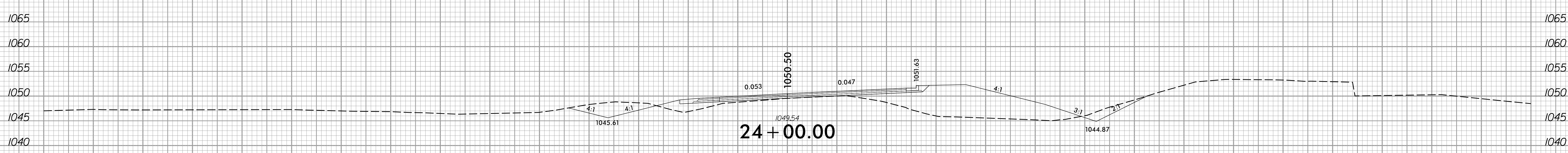
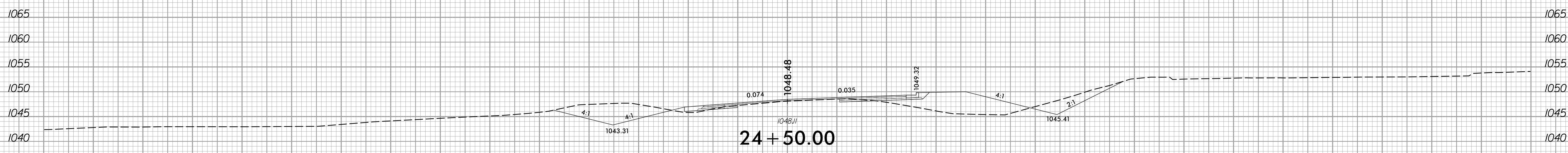
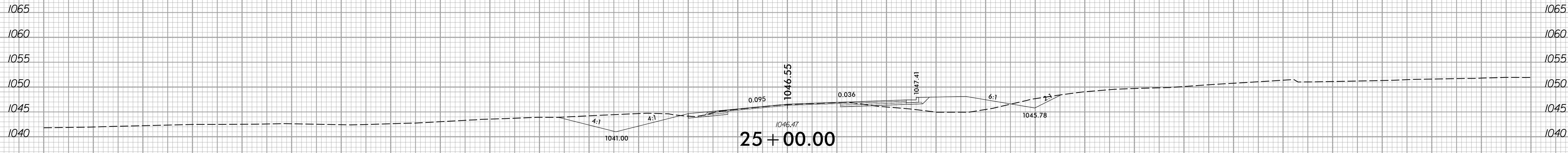

155 150 145 140 135 130 125 120 115 110 105 100 95 90 85 80 75 70 65 60 55 50 45 40 35 30 25 20 15 10 5 0 5 10 15 20 25 30 35 40 45 50 55 60 65 70 75 80 85 90 95 100 105 110 115 120 125 130 135 140 145 150 155

2/25/2020
3:10:53 PM
33:10:53 PM
24+00.00.dgn

6/23/16

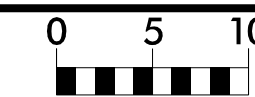

| | |
|---------------------|-----------|
| PROJ. REFERENCE NO. | SHEET NO. |
| BR-0047 | X-10 |

| | |
|---------------------|-----------|
| PROJ. REFERENCE NO. | SHEET NO. |
| BR-0047 | X-10 |

155 150 145 140 135 130 125 120 115 110 105 100 95 90 85 80 75 70 65 60 55 50 45 40 35 30 25 20 15 10 5 0 5 10 15 20 25 30 35 40 45 50 55 60 65 70 75 80 85 90 95 100 105 110 115 120 125 130 135 140 145 150 155

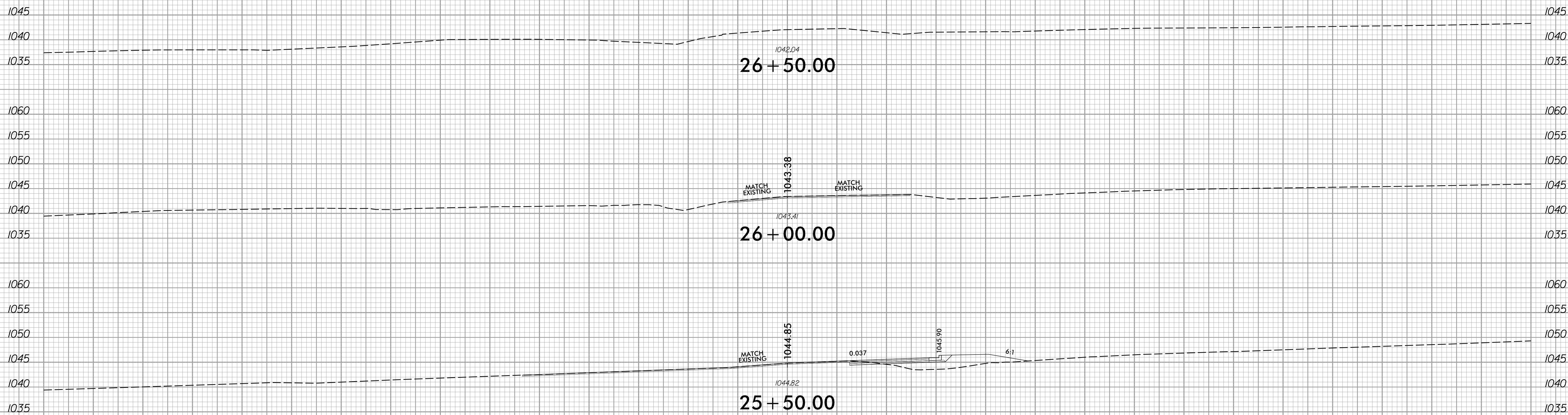

155 150 145 140 135 130 125 120 115 110 105 100 95 90 85 80 75 70 65 60 55 50 45 40 35 30 25 20 15 10 5 0 5 10 15 20 25 30 35 40 45 50 55 60 65 70 75 80 85 90 95 100 105 110 115 120 125 130 135 140 145 150 155

2/25/2020 3:10:34 PM \\s:\proj\16\BR-0047_P047_L_XPL.dgn

6/23/16

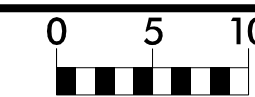

PROJ. REFERENCE NO.
BR-0047

SHEET NO.
X-11

155 150 145 140 135 130 125 120 115 110 105 100 95 90 85 80 75 70 65 60 55 50 45 40 35 30 25 20 15 10 5 0 5 10 15 20 25 30 35 40 45 50 55 60 65 70 75 80 85 90 95 100 105 110 115 120 125 130 135 140 145 150 155

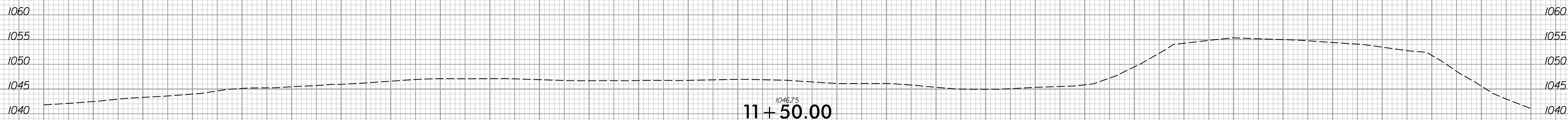
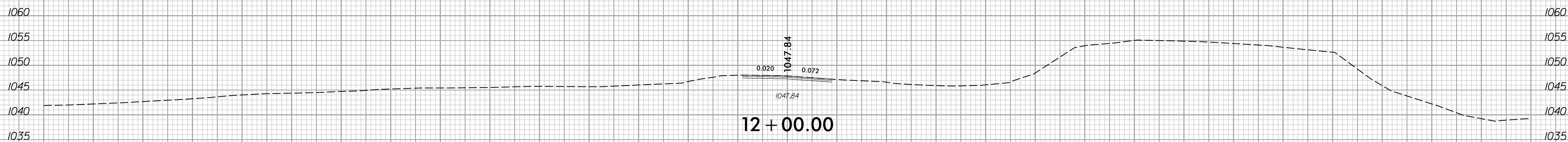
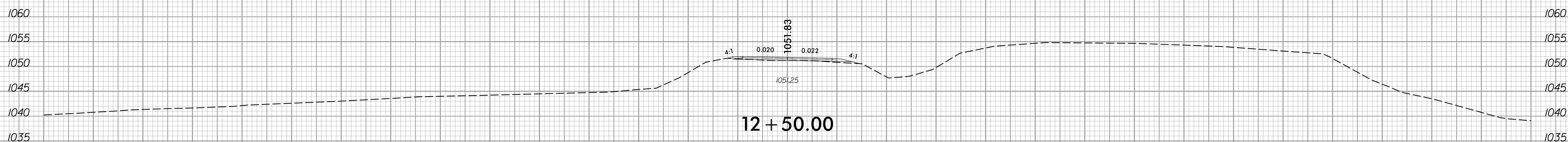

-Y/-

2/25/2020
3:11:01 PM
S:\XGC\BR0047_R0Y_V1_XPL.dgn

155 150 145 140 135 130 125 120 115 110 105 100 95 90 85 80 75 70 65 60 55 50 45 40 35 30 25 20 15 10 5 0 5 10 15 20 25 30 35 40 45 50 55 60 65 70 75 80 85 90 95 100 105 110 115 120 125 130 135 140 145 150 155

6/23/16

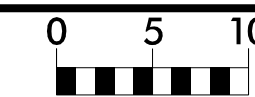

PROJ. REFERENCE NO.
BR-0047

SHEET NO.
X-12

155 150 145 140 135 130 125 120 115 110 105 100 95 90 85 80 75 70 65 60 55 50 45 40 35 30 25 20 15 10 5 0 5 10 15 20 25 30 35 40 45 50 55 60 65 70 75 80 85 90 95 100 105 110 115 120 125 130 135 140 145 150 155

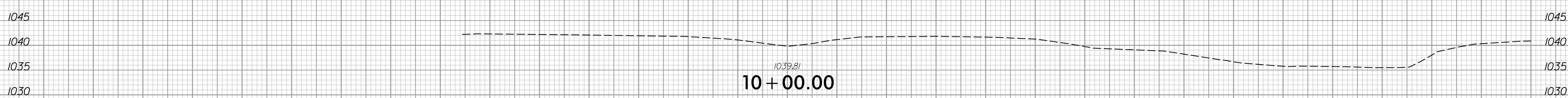
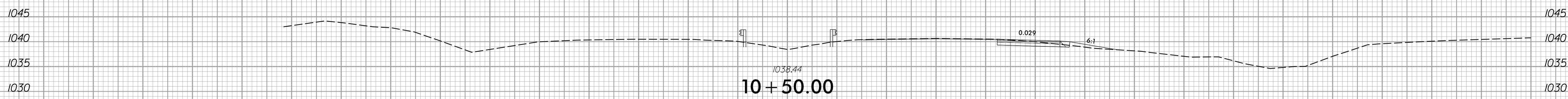
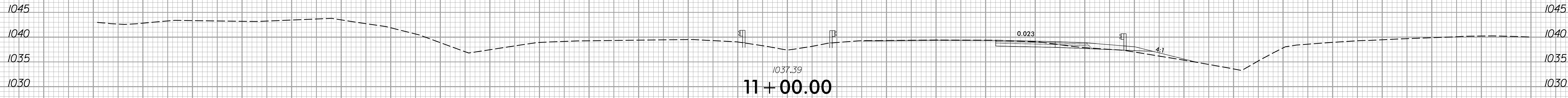
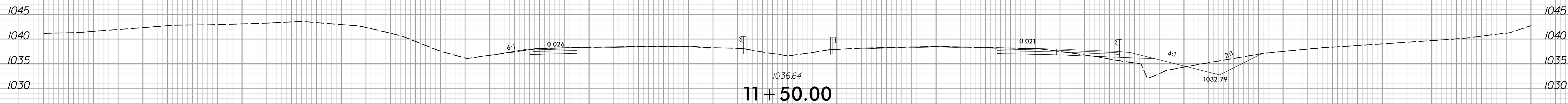

-Y2-

155 150 145 140 135 130 125 120 115 110 105 100 95 90 85 80 75 70 65 60 55 50 45 40 35 30 25 20 15 10 5 0 5 10 15 20 25 30 35 40 45 50 55 60 65 70 75 80 85 90 95 100 105 110 115 120 125 130 135 140 145 150 155

2/25/2020 3:11:56 PM \\X:\S\BR\0047_RDY_Y2_XPL.dgn

6/23/16

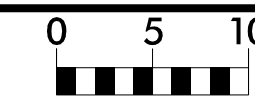

PROJ. REFERENCE NO.
BR-0047

SHEET NO.
X-13

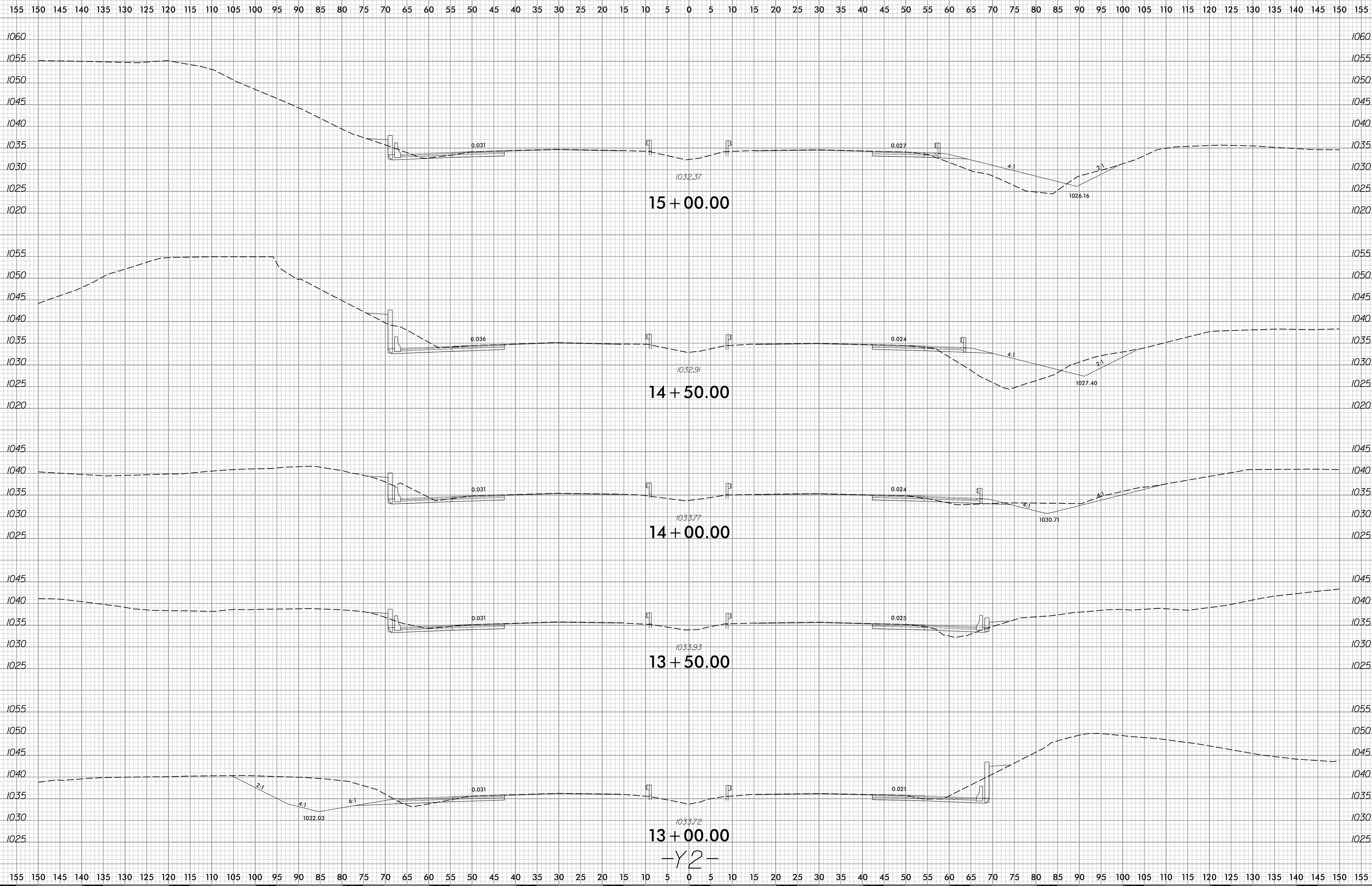

2/25/2020
3:11:56 PM
33:11:56 PM
BR-0047_RDY_V2_XPL.dgn

6/23/16

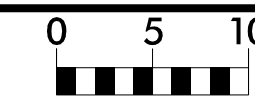

PROJ. REFERENCE NO.
BR-0047

SHEET NO.
X-14

155 150 145 140 135 130 125 120 115 110 105 100 95 90 85 80 75 70 65 60 55 50 45 40 35 30 25 20 15 10 5 0 5 10 15 20 25 30 35 40 45 50 55 60 65 70 75 80 85 90 95 100 105 110 115 120 125 130 135 140 145 150 155

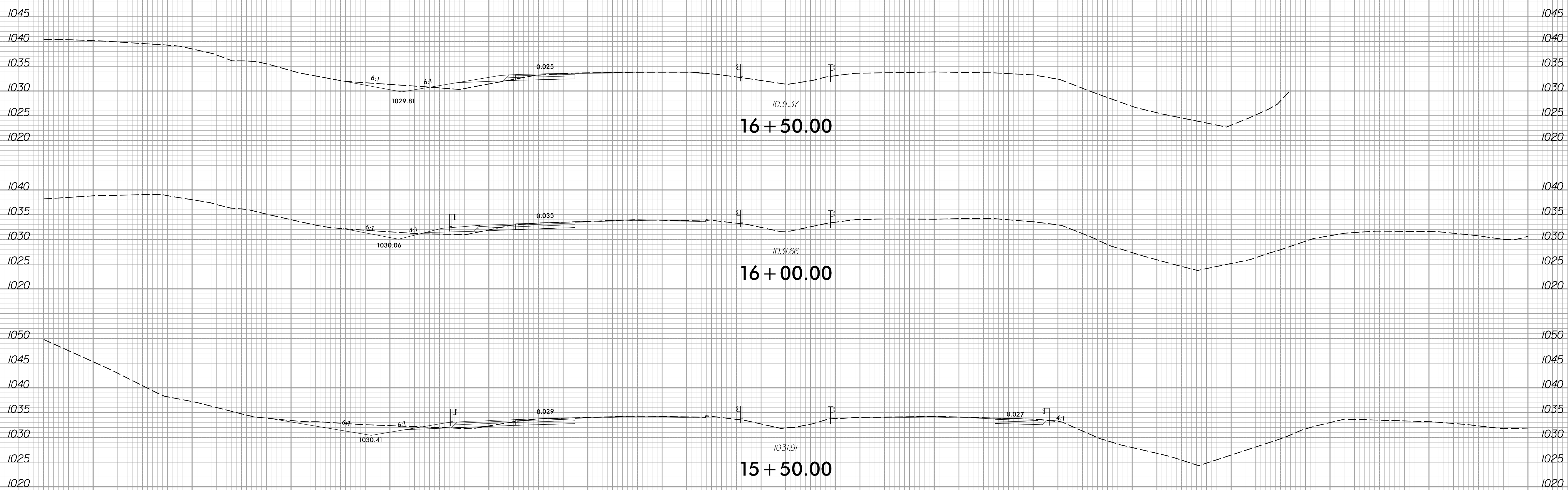

155 150 145 140 135 130 125 120 115 110 105 100 95 90 85 80 75 70 65 60 55 50 45 40 35 30 25 20 15 10 5 0 5 10 15 20 25 30 35 40 45 50 55 60 65 70 75 80 85 90 95 100 105 110 115 120 125 130 135 140 145 150 155

2/25/2020 11:56 AM
S:\X\30\14\0047_R0Y_V2_XPL.dgn

-Y2-

6/23/16

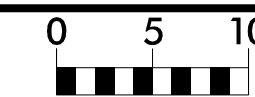

PROJ. REFERENCE NO.
BR-0047

SHEET NO.
X-15

155 150 145 140 135 130 125 120 115 110 105 100 95 90 85 80 75 70 65 60 55 50 45 40 35 30 25 20 15 10 5 0 5 10 15 20 25 30 35 40 45 50 55 60 65 70 75 80 85 90 95 100 105 110 115 120 125 130 135 140 145 150 155

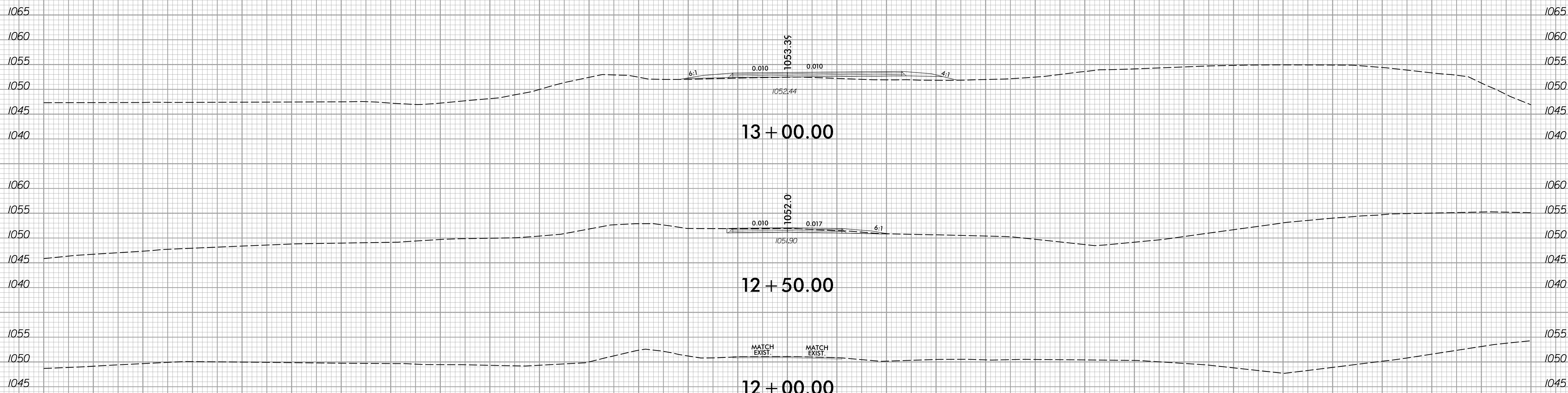

155 150 145 140 135 130 125 120 115 110 105 100 95 90 85 80 75 70 65 60 55 50 45 40 35 30 25 20 15 10 5 0 5 10 15 20 25 30 35 40 45 50 55 60 65 70 75 80 85 90 95 100 105 110 115 120 125 130 135 140 145 150 155

2/25/2020 3:11:53 PM \\X:\S\BR\0047_R0Y_Y3_XPL.dgn

-Y3-