

GEOTECHNICAL ENGINEER

ENGINEER

SEAL 029869

SHANE C. CLARK

DocuSigned by: Shane C. Clark 4/27/2020

DOCUMENT NOT CONSIDERED FINAL UNLESS ALL SIGNATURES COMPLETED

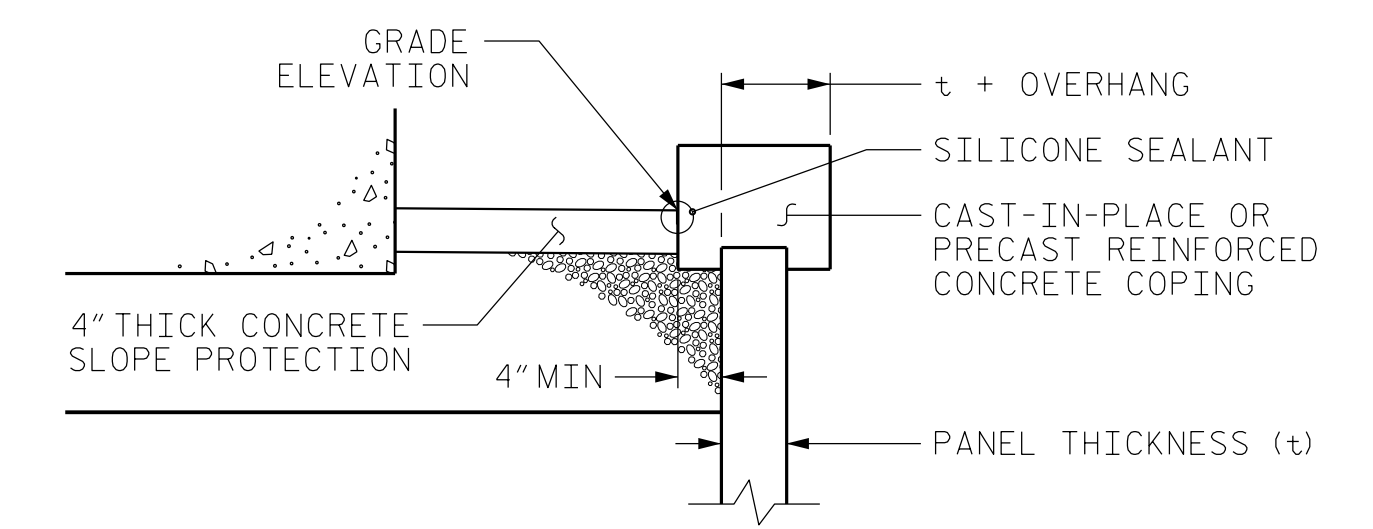
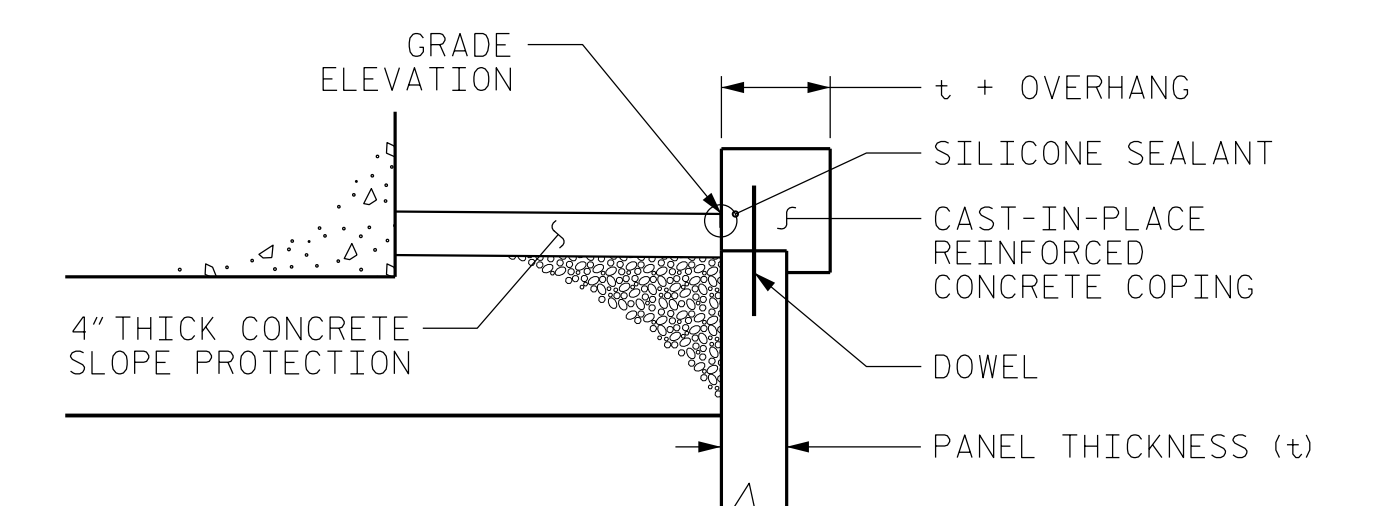
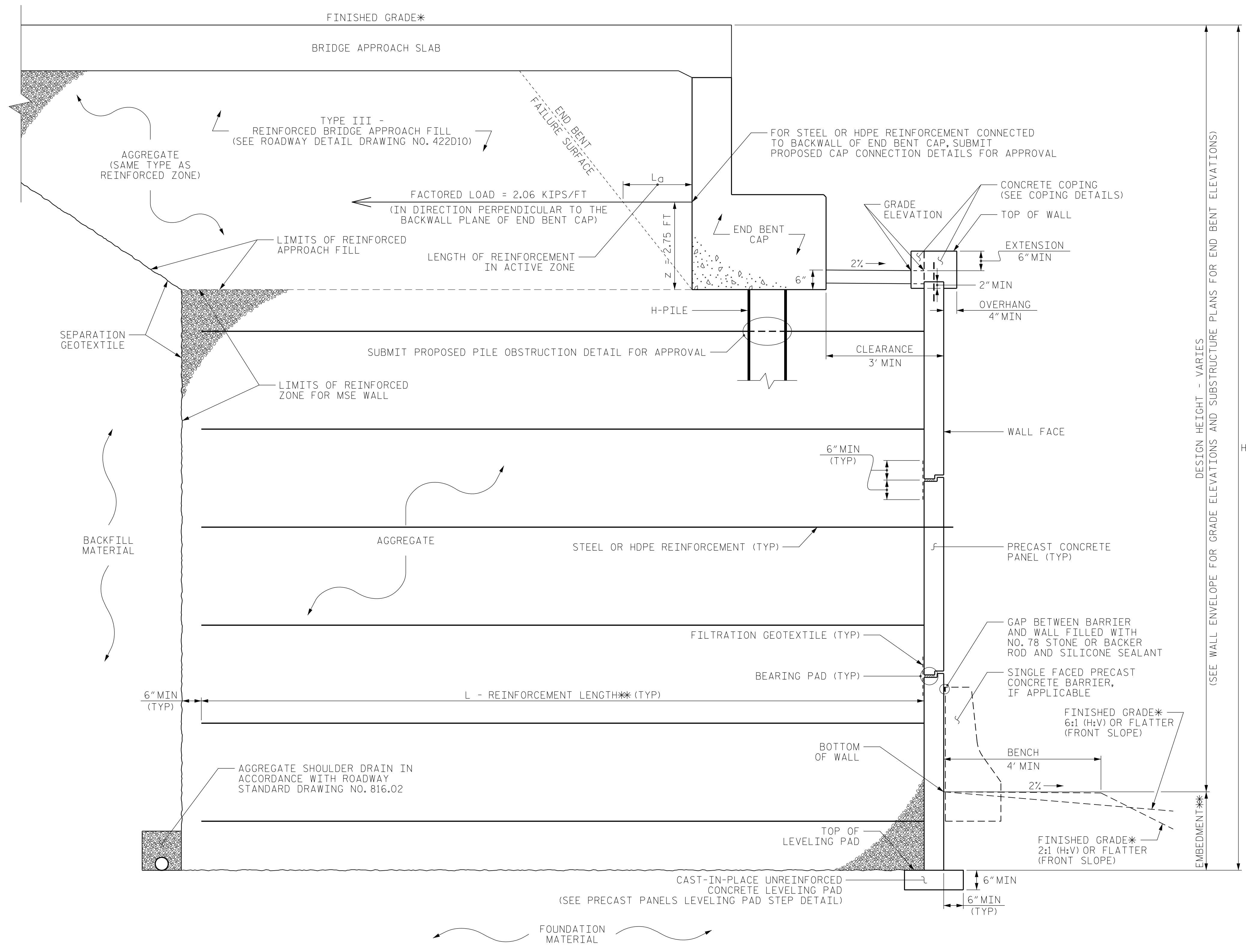

COPING DETAILS

AT THE CONTRACTOR'S OPTION, CONNECT COPING TO PANELS WITH DOWELS OR EXTEND COPING DOWN BACK OF PANELS.

MSE ABUTMENT WALL WITH PRECAST PANELS - TYPICAL SECTION

*SEE ROADWAY PLANS FOR FINISHED GRADE DETAILS.
 **SEE MSE RETAINING WALLS PROVISION AND IF APPLICABLE, MSE WALL NOTES FOR EMBEDMENT AND REINFORCEMENT LENGTH REQUIREMENTS.

PROJECT NO.: 67047 (BR-0047)
 STOKES COUNTY
 STATION: 13+57.28 -Y2-
 SHEET 3 OF 5

NORTH CAROLINA DEPARTMENT OF TRANSPORTATION DIVISION OF HIGHWAYS

GEOTECHNICAL ENGINEERING UNIT

REVISIONS						SHEET NO.
NO.	BY	DATE	NO.	BY	DATE	
1	-	-	3	-	-	W-3
2	-	-	4	-	-	

PREPARED BY: SCC	DATE: 4/20/20
REVIEWED BY: ENW	DATE: 4/24/20