

09/06/2011

See Sheet 1A For Index of Sheets

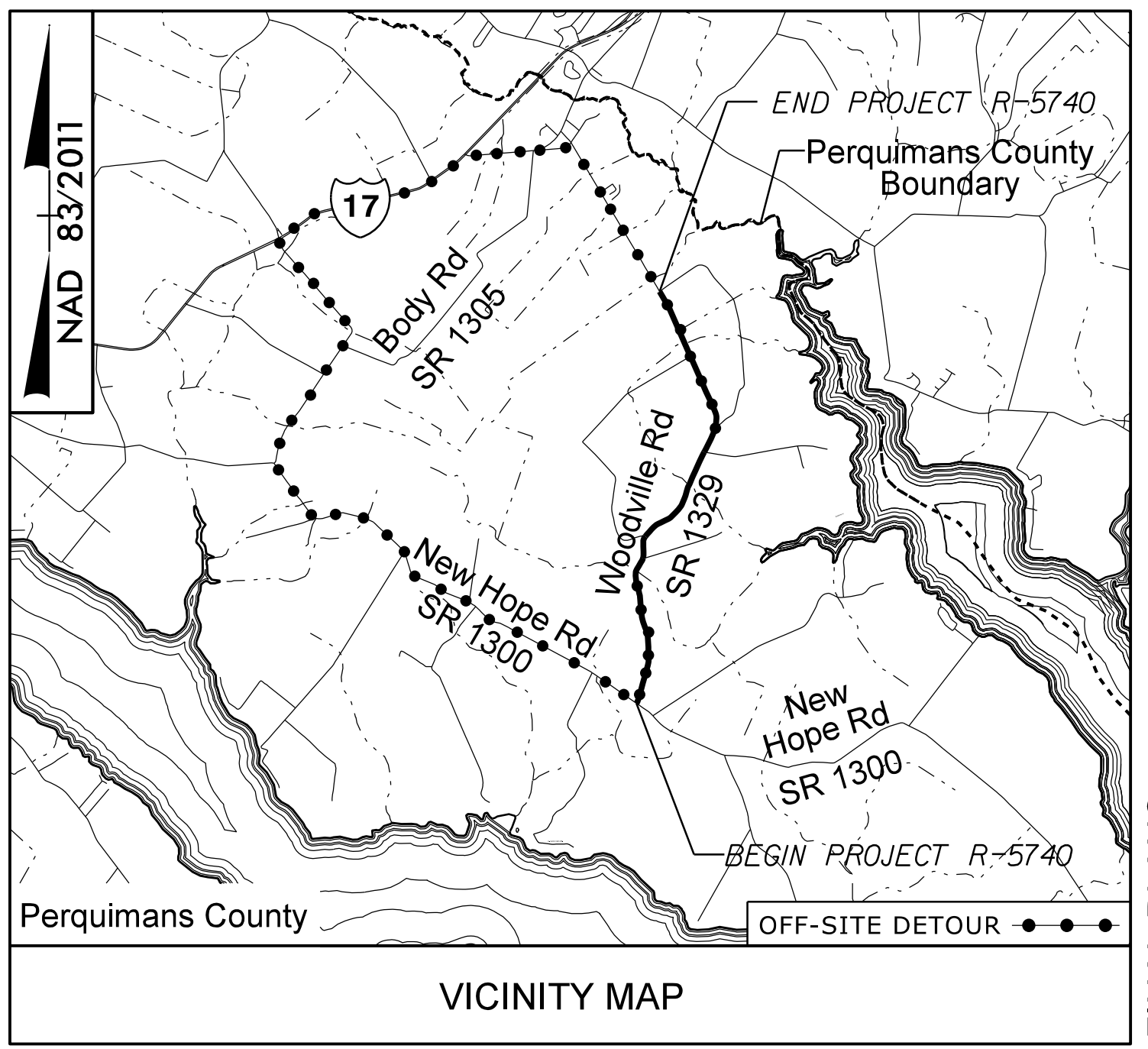

VICINITY MAP

FINAL PLANS

STATE OF NORTH CAROLINA  
DIVISION OF HIGHWAYS

**PERQUIMANS COUNTY**

**LOCATION: SR 1329 (WOODVILLE ROAD) FROM SR 1300 (NEW HOPE ROAD)  
TO SR 1331 (RED BANKS ROAD - NORTH END)**

**TYPE OF WORK: GRADING, PAVING, DRAINAGE, AND CULVERTS**

STATE	STATE PROJECT REFERENCE NO.	SHEET NO.	TOTAL SHEETS
N.C.	R-5740	C-1	
STATE PROJ. NO.	F.A. PROJ. NO.	DESCRIPTION	
50198.1.1		PE	
50198.2.1		RAW	
50198.2.2		UTILITIES	
50198.3.1		CONSTRUCTION	

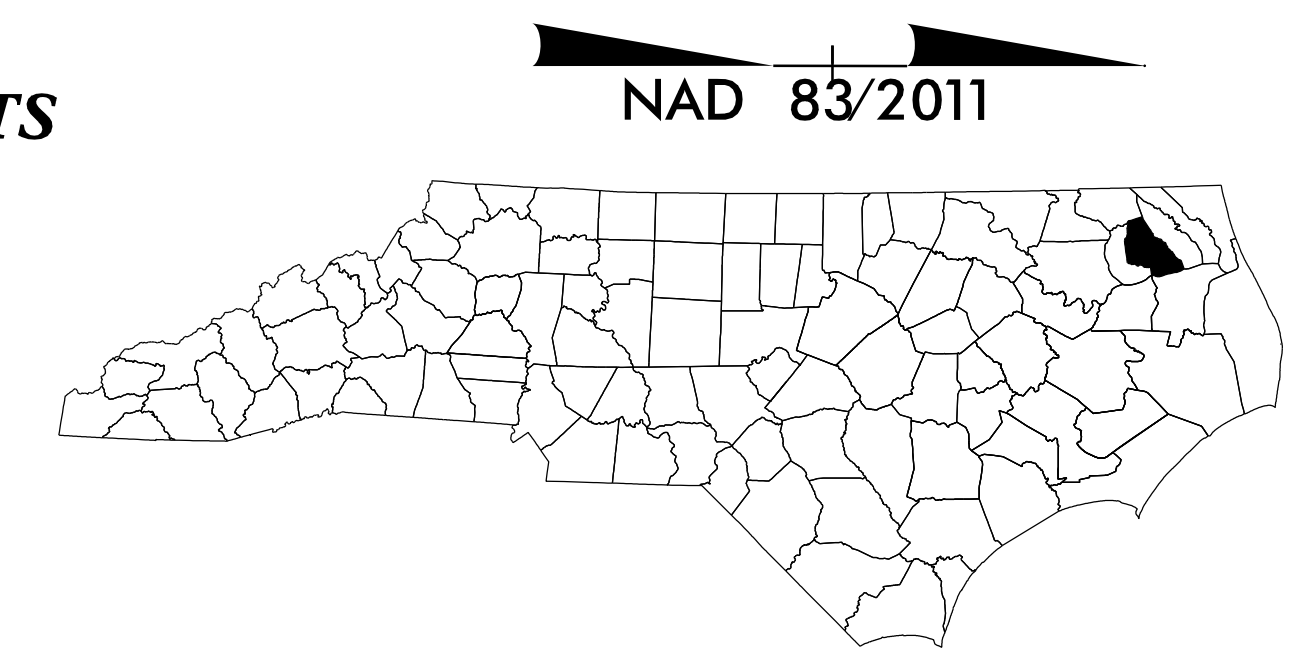

**TIP PROJECT: R-5740**

**CONTRACT: C204593**

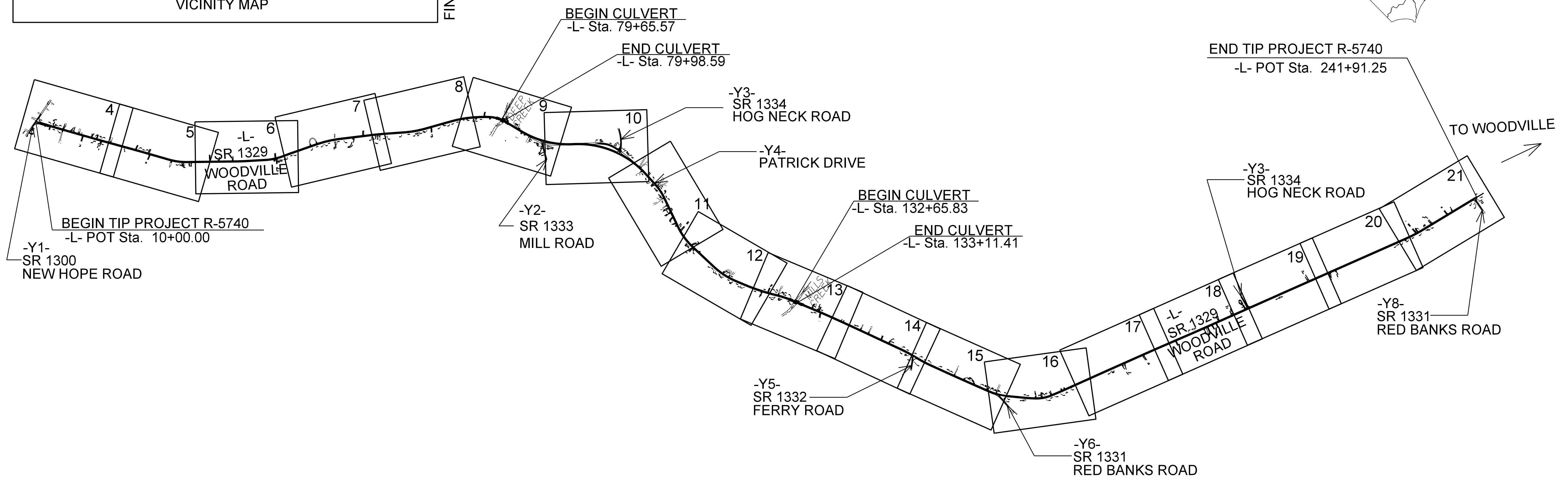

**\*\* HORIZONTAL DESIGN EXCEPTION IS REQUIRED**

**DOCUMENT NOT CONSIDERED FINAL  
UNLESS ALL SIGNATURES COMPLETED**

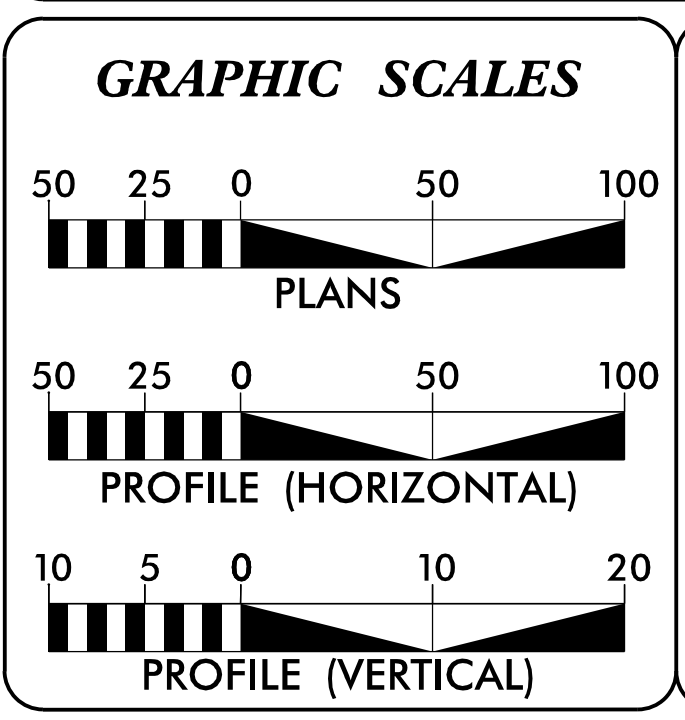

**DESIGN DATA**  
ADT 2016 = 1,400  
V = 60 MPH \*\*

**PROJECT LENGTH**  
LENGTH ROADWAY TIP PROJECT R-5740 = 4.377 MILES  
LENGTH STRUCTURE TIP PROJECT R-5740 = 0.015 MILES  
TOTAL LENGTH TIP PROJECT R-5740 = 4.392 MILES

NCDOT CONTACT: BARRY HOBBS, PE, DIVISION PROJECT MANAGER

Prepared in the Office of:

**ATKINS** 1616 EAST MILLBROOK ROAD, SUITE 160  
RALEIGH, NORTH CAROLINA 27609  
(919) 876-6888 NCBEE #F-0326

2018 STANDARD SPECIFICATIONS

**RIGHT OF WAY DATE:** JULY 2017

**LETTING DATE:** FEBRUARY 16, 2021

**VIRGINIA T. SCHAAR, PE**  
PROJECT ENGINEER

**BRYCE REID, EI**  
PROJECT DESIGN ENGINEER

**HYDRAULICS ENGINEER**

*(Signature)* 11/6/2020 P.E.

**ROADWAY DESIGN ENGINEER**

*(Signature)* 11/5/2020 P.E.



04-NOV-2020 17:28 R:\Roadway\p101\410-R5740\_rdy\_tsh.dgn \$\$\$\$SERNAME\$\$\$\$