

5/14/19

PROJECT REFERENCE NO. <b>R-5740</b>	SHEET NO. <b>21</b>
RW SHEET NO.	
ROADWAY DESIGN ENGINEER	HYDRAULICS ENGINEER
<b>DOCUMENT NOT CONSIDERED FINAL UNLESS ALL SIGNATURES COMPLETED</b>	

-L-

PI Sta 231+33.34  
 $\Delta = 6'57.499'$  (LT)  
 $D = 2'51.532''$   
 $L = 243.08'$   
 $T = 121.69'$   
 $R = 2,000.00'$   
 $SE = 0.05$

MATCHLINE SEE SHEET 20  
-L- STA 230+00

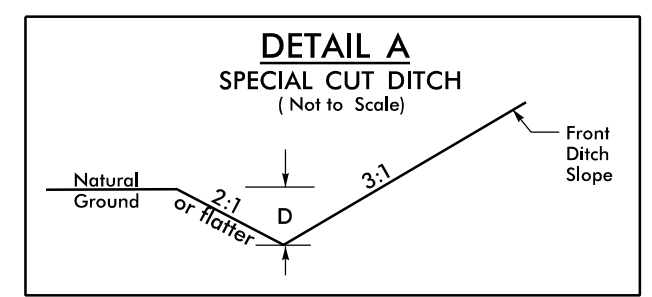
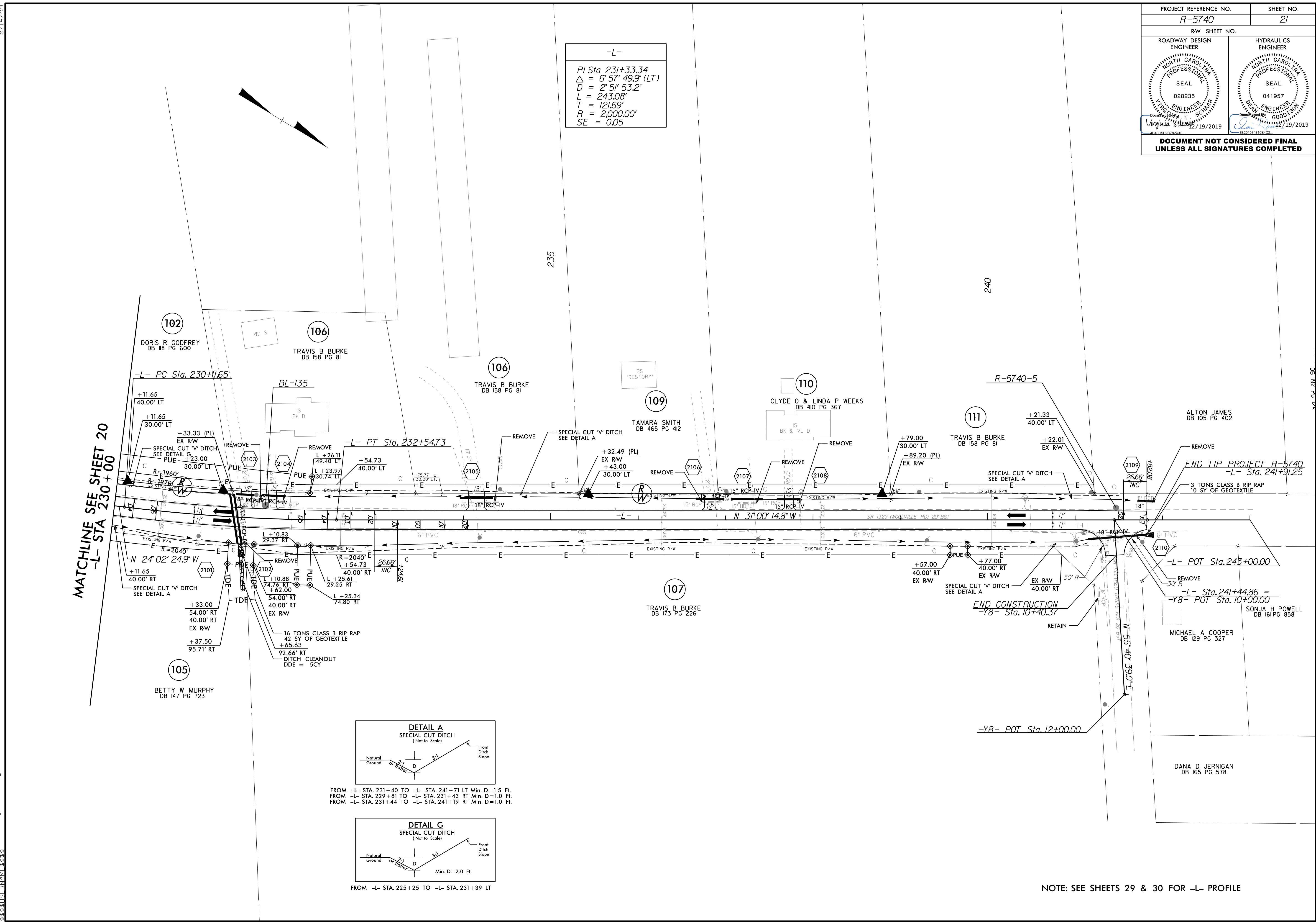

FROM -L- STA. 231+40 TO -L- STA. 241+71 LT Min. D=1.5 Ft.  
 FROM -L- STA. 229+81 TO -L- STA. 231+43 RT Min. D=1.0 Ft.  
 FROM -L- STA. 231+44 TO -L- STA. 241+19 RT Min. D=1.0 Ft.

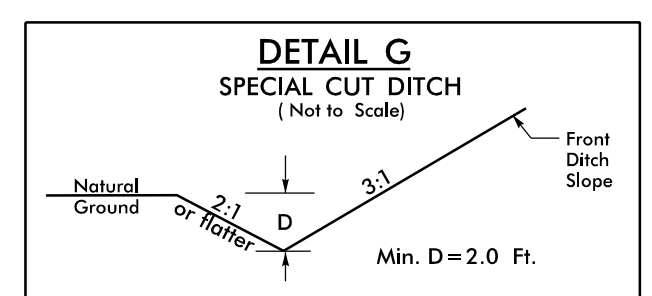

FROM -L- STA. 225+25 TO -L- STA. 231+39 LT

NOTE: SEE SHEETS 29 & 30 FOR -L- PROFILE

R16-DEC-2019 16:39 R5740\_L-rd-j\_PSH-21.dgn  
 \$\$\$\$\$\$