

5/14/19

PROJECT REFERENCE NO. R-5740		SHEET NO. 18	
RW SHEET NO.			
ROADWAY DESIGN ENGINEER		HYDRAULICS ENGINEER	
DOCUMENT NOT CONSIDERED FINAL UNLESS ALL SIGNATURES COMPLETED			

-L-

PI Sta 195+77.30
 $\Delta = 0^\circ 33' 01.2" (LT)$
 $D = 0^\circ 17' 11.3"$
 $L = 192.10'$
 $T = 96.05'$
 $R = 20,000.00'$
 SE = EXIST

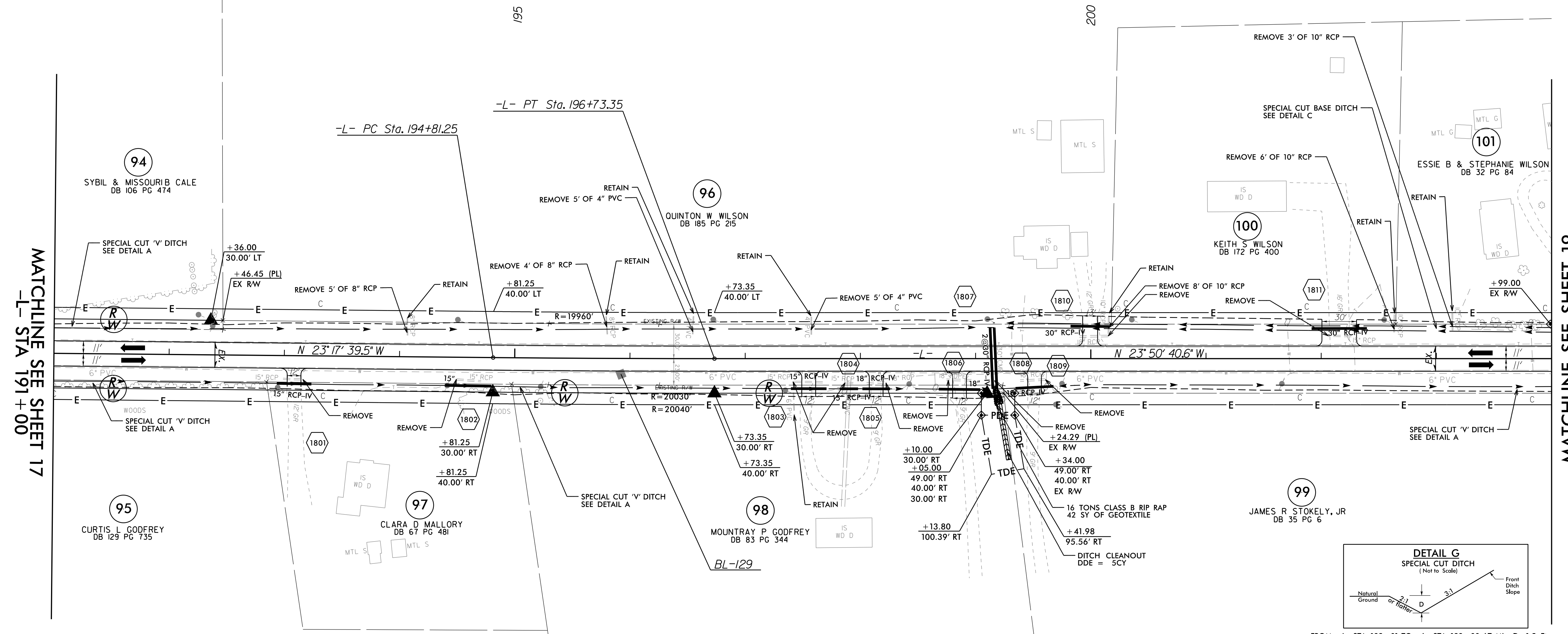

MATCHLINE SEE SHEET 17
-L- STA 191+00

MATCHLINE SEE SHEET 19
-L- STA 204+00

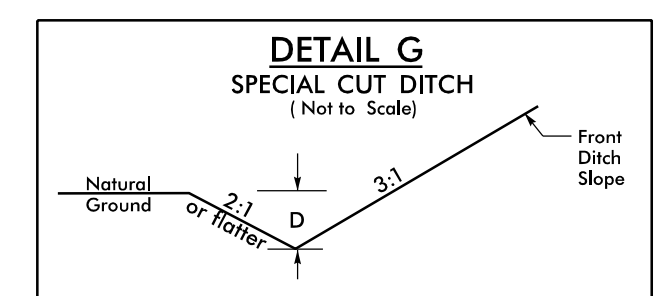

FROM -L- STA. 189+01 TO -L- STA. 193+00 LT Min. D=1.5 Ft.
 FROM -L- STA. 193+00 TO -L- STA. 199+00 LT Min. D=2.0 Ft.

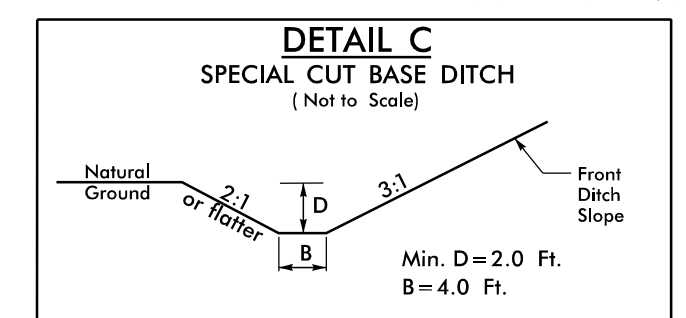

FROM -L- STA. 199+15 TO -L- STA. 204+00 LT

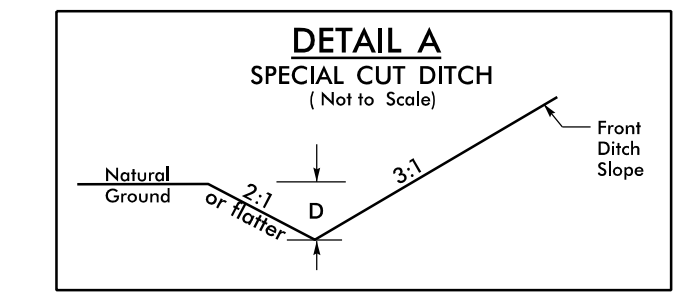

FROM -L- STA. 188+42 TO -L- STA. 199+16 RT Min. D=1.5 Ft.
 FROM -L- STA. 199+17 TO -L- STA. 205+00 RT Min. D=1.0 Ft.
 FROM -L- STA. 205+00 TO -L- STA. 211+53 RT Min. D=1.5 Ft.

NOTE: SEE SHEET 28 FOR -L- PROFILE

R18-DEC-2019 10:08 R5740-L-rdy_PSH-18.dgn