

5/14/99

PROJECT REFERENCE NO. R-5740	SHEET NO. 10
RW SHEET NO.	
ROADWAY DESIGN ENGINEER	HYDRAULICS ENGINEER
DOCUMENT NOT CONSIDERED FINAL UNLESS ALL SIGNATURES COMPLETED	

-L-

PI Sta 97+21.60
 $\Delta = 50' 47' 19.7''$ (RT)
 $D = 4' 18' 28.6''$
 $L = 1,178.95'$
 $T = 631.37'$
 $R = 1,330.00'$
 $SE = 0.06$

-Y3-

PI Sta 11+82.36
 $\Delta = 32' 33' 31.0''$ (RT)
 $D = 9' 10' 31.2''$
 $L = 354.85'$
 $T = 182.36'$
 $R = 624.45'$
 $SE = 0.02$

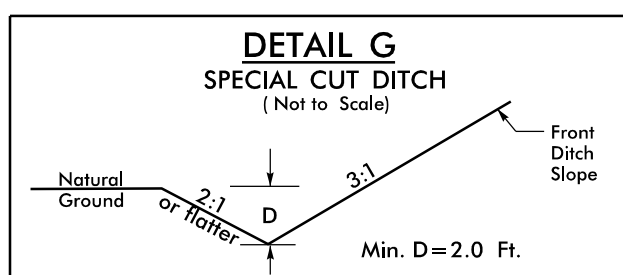
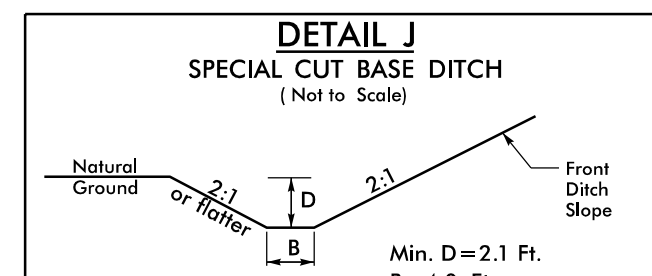
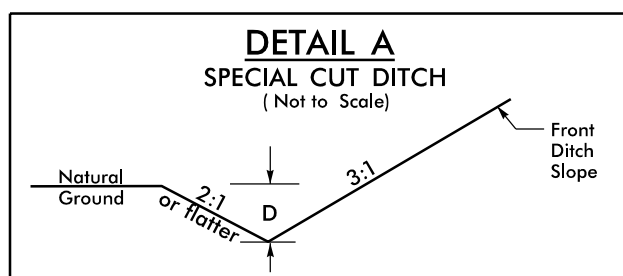
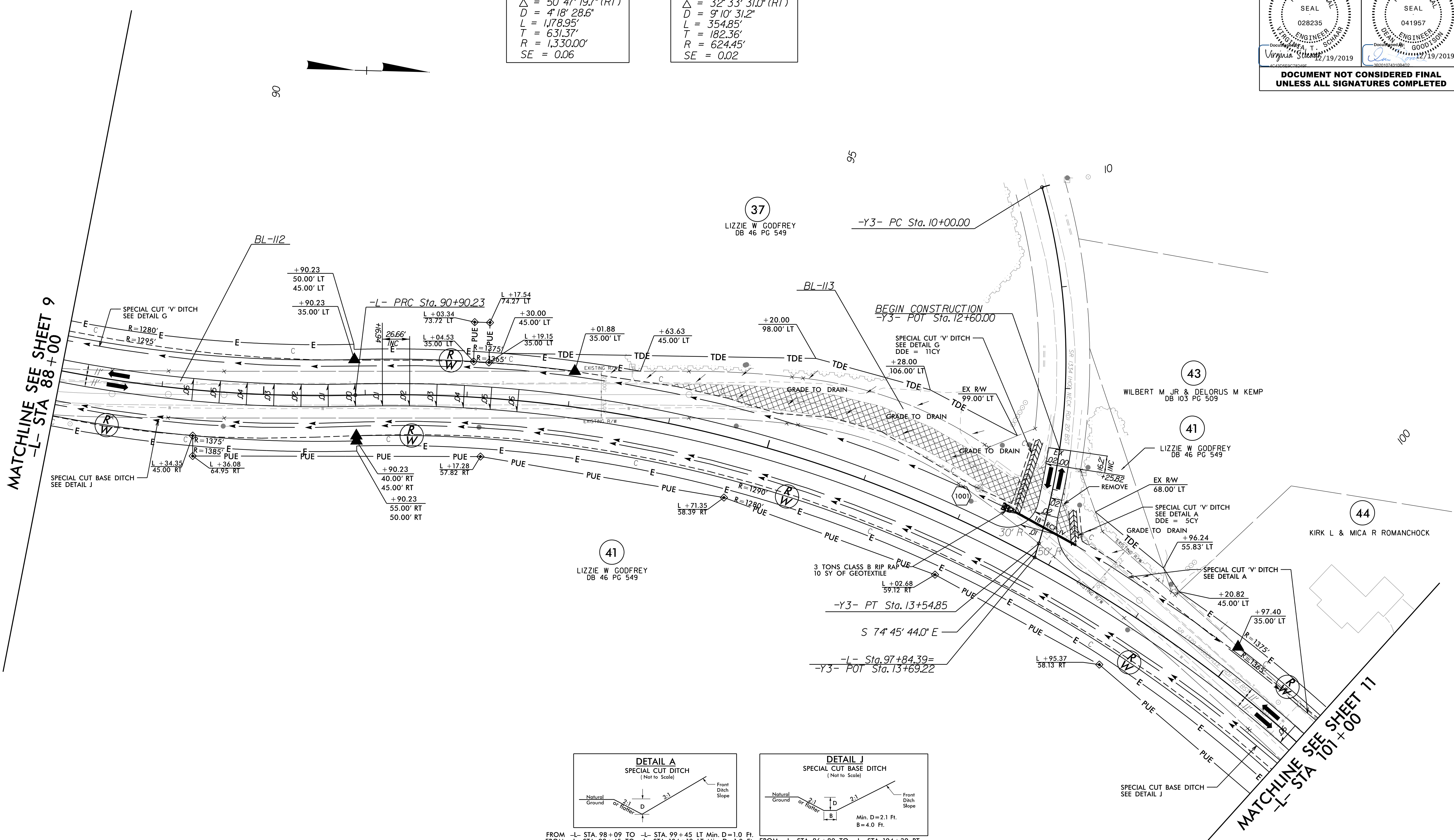

FROM -L- STA. 98+09 TO -L- STA. 99+45 LT Min. D=1.0 Ft.
 FROM -L- STA. 99+45 TO -L- STA. 104+19 LT Min. D=1.0 Ft.
 FROM -Y3- STA. 13+16 TO -Y3- STA. 13+47 LT Min. D=1.0 Ft.

FROM -L- STA. 82+70 TO -L- STA. 97+45 LT
 FROM -Y3- STA. 12+60 TO -Y3- STA. 13+31 RT

NOTE: SEE SHEETS 24 & 25 FOR -L- PROFILE
 SEE SHEET 31 FOR -Y3- PROFILE

R16-DEC-2019 15:52 R5740-L-rd-PSH-10.dgn