

PROJECT REFERENCE NO. R-5740	SHEET NO. 4
RW SHEET NO.	
ROADWAY DESIGN ENGINEER	HYDRAULICS ENGINEER
<p>DOCUMENT NOT CONSIDERED FINAL UNLESS ALL SIGNATURES COMPLETED</p>	

-L-	
PI Sta 12+81.40 Δ = 0° 57' 00.7" (LT) D = 0° 49' 19.3" L = 115.59' T = 57.80' R = 6,970.00' SE = N.C.	PI Sta 19+35.80 Δ = 0° 30' 35.4" (LT) D = 0° 34' 22.6" L = 88.98' T = 44.49' R = 10,000.00' SE = EXIST

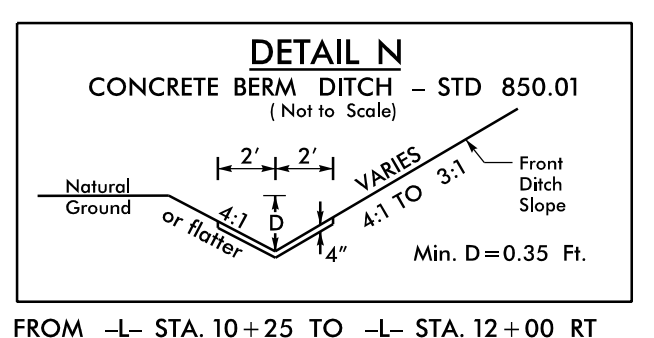

FROM -L- STA. 10+25 TO -L- STA. 12+00 RT

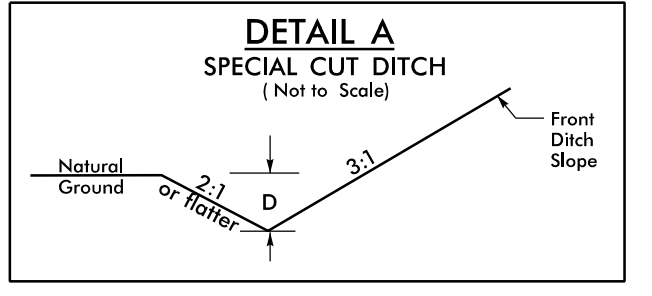

FROM -L- STA. 11+05 TO -L- STA. 12+60 LT Min. D=0.5 Ft.
 FROM -L- STA. 12+60 TO -L- STA. 14+00 LT Min. D=1.0 Ft.
 FROM -L- STA. 14+00 TO -L- STA. 18+58 LT Min. D=1.5 Ft.
 FROM -L- STA. 18+59 TO -L- STA. 23+50 LT Min. D=1.0 Ft.
 FROM -L- STA. 12+60 TO -L- STA. 18+56 RT Min. D=1.0 Ft.
 FROM -L- STA. 18+57 TO -L- STA. 19+83 RT Min. D=0.5 Ft.
 FROM -L- STA. 20+17 TO -L- STA. 23+49 RT Min. D=1.0 Ft.

NOTE: SEE SHEET 22 FOR -L- PROFILE

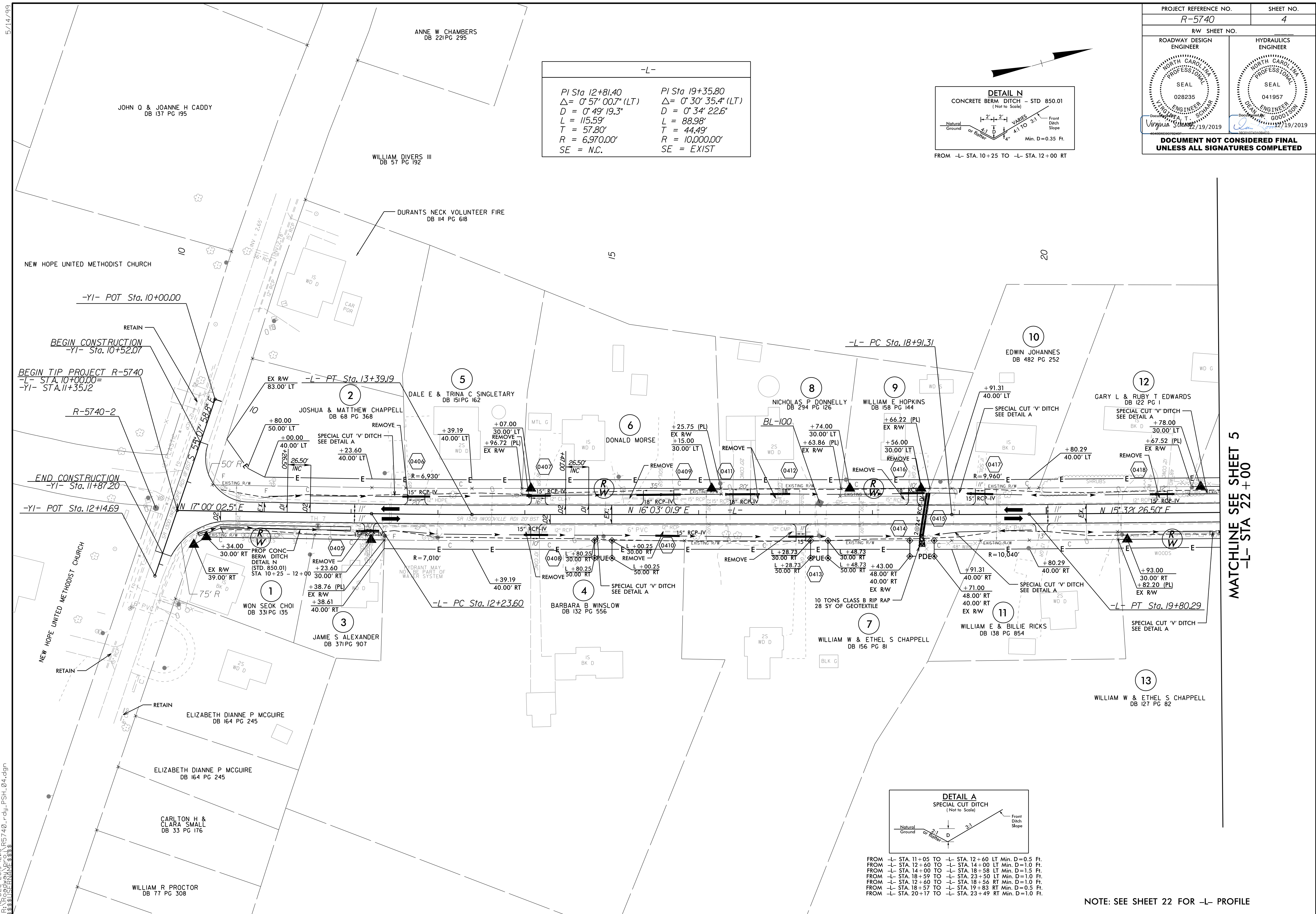

MATCHLINE SEE SHEET 5
-L- STA 22+00

16-DEC-2019 12:15 RE740_rdu_psh_04.dgn