

TRAFFIC CONTROL STAGING NOTES:

STAGE I (I-40 WBL):

1. USE TMP-5, TMP-6, TMP-7, ROADWAY STANDARD DRAWINGS (RSD) 1101.02 SHEET 4 OF 14 AND RSD 1101.01 SHEET 1 OF 3, TO PLACE ADVANCED WARNING SIGNS AND TRAFFIC CONTROL DEVICES.
2. RECORD EXISTING PAVEMENT MARKINGS.
3. COMPLETE STAGE I BRIDGE WORK.
4. REPLACE ANY EXISTING PAVEMENT MARKINGS THAT WERE OBLITERATED DURING CONSTRUCTION.
5. REMOVE ALL TRAFFIC CONTROL DEVICES. COVER OR REMOVE ALL ADVANCED WARNING SIGNS AND RETURN TRAFFIC TO ITS EXISTING PATTERN.

STAGE II (I-40 WBL):

1. USE TMP-5, TMP-8, TMP-9, ROADWAY STANDARD DRAWINGS (RSD) 1101.02 SHEET 4 OF 14 AND RSD 1101.01 SHEET 1 OF 3, TO PLACE ADVANCED WARNING SIGNS AND TRAFFIC CONTROL DEVICES.
2. RECORD EXISTING PAVEMENT MARKINGS.
3. COMPLETE STAGE II BRIDGE WORK.
4. REPLACE ANY EXISTING PAVEMENT MARKINGS THAT WERE OBLITERATED DURING CONSTRUCTION.
5. REMOVE ALL TRAFFIC CONTROL DEVICES. COVER OR REMOVE ALL ADVANCED WARNING SIGNS AND RETURN TRAFFIC TO ITS EXISTING PATTERN.

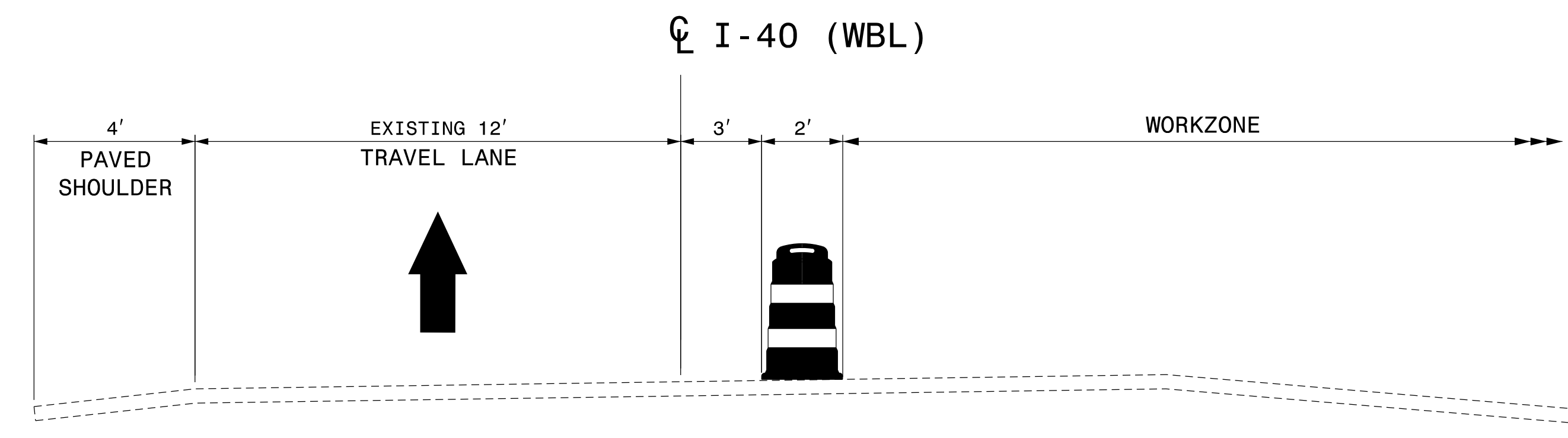

TYPICAL SECTION - STAGE I (I-40 WBL)

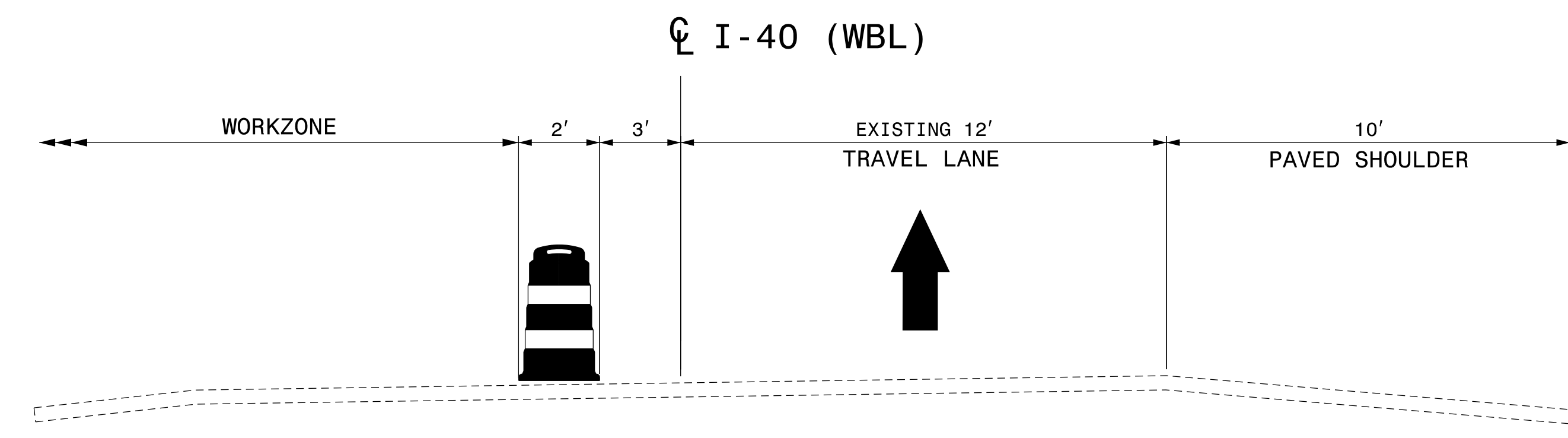

TYPICAL SECTION - STAGE II (I-40 WBL)

VOLKERT
 5430 Wade Park Blvd., Suite 410
 Raleigh, NC 27607
 Tel. 919-854-0344 Fax. 919-854-0355
 NC License No. F-0765

APPROVED: _____
 DATE: _____

SEAL
 DocuSigned by:
 Patrick Holder
 31822236FC7473...
 12/18/2020

**DOCUMENT NOT CONSIDERED FINAL
 UNLESS ALL SIGNATURES COMPLETED**

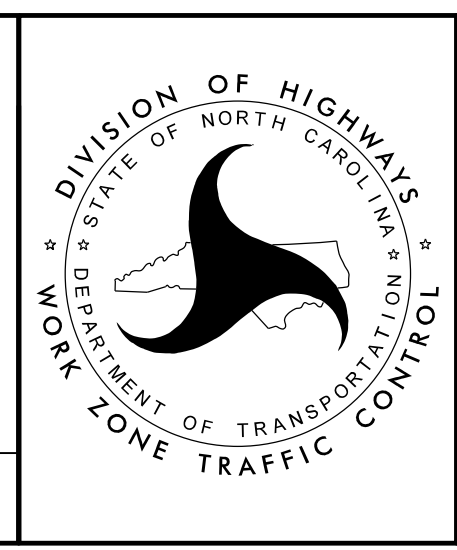

**DUPLIN COUNTY
 BRIDGE 433**

**TRAFFIC CONTROL
 STAGING (I-40 WBL)**