

LAYOUT FOR COMPUTING AREA OF REINFORCED CONCRETE SLAB
(SQ. FT. = 4,470)

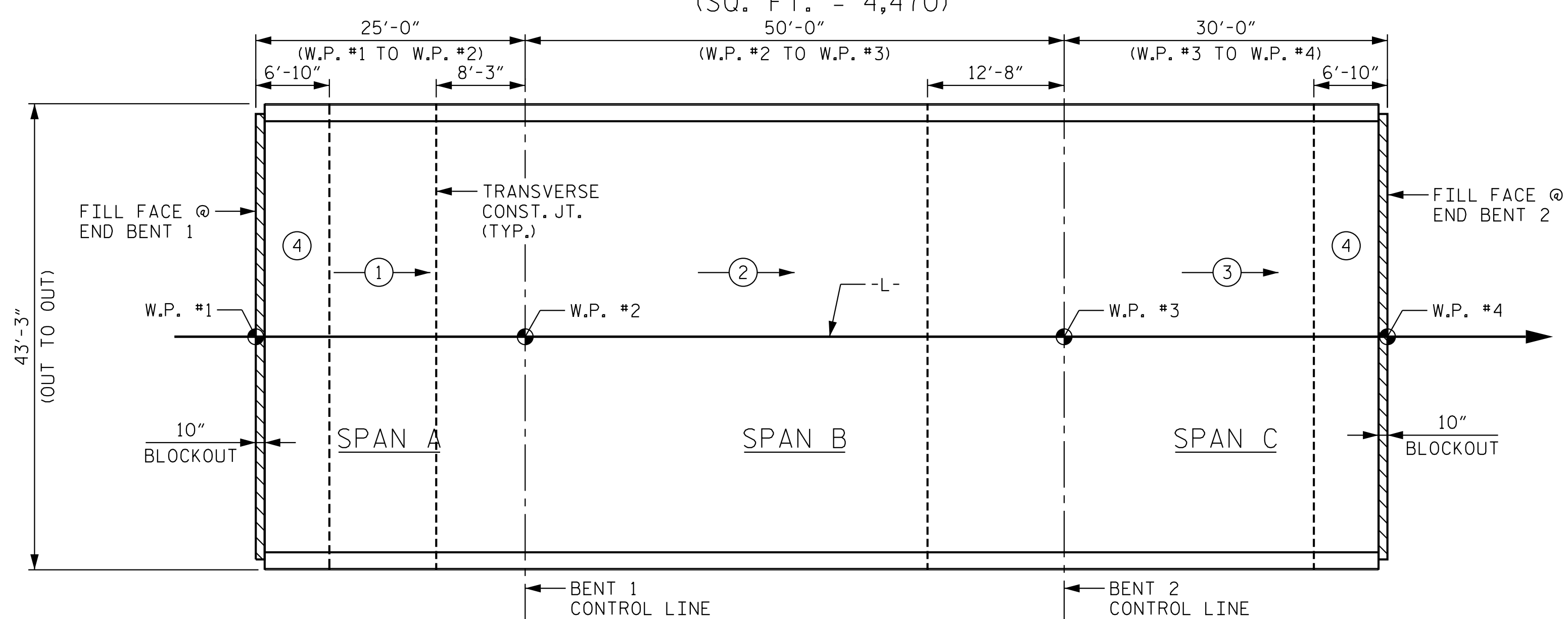

POUR SEQUENCE

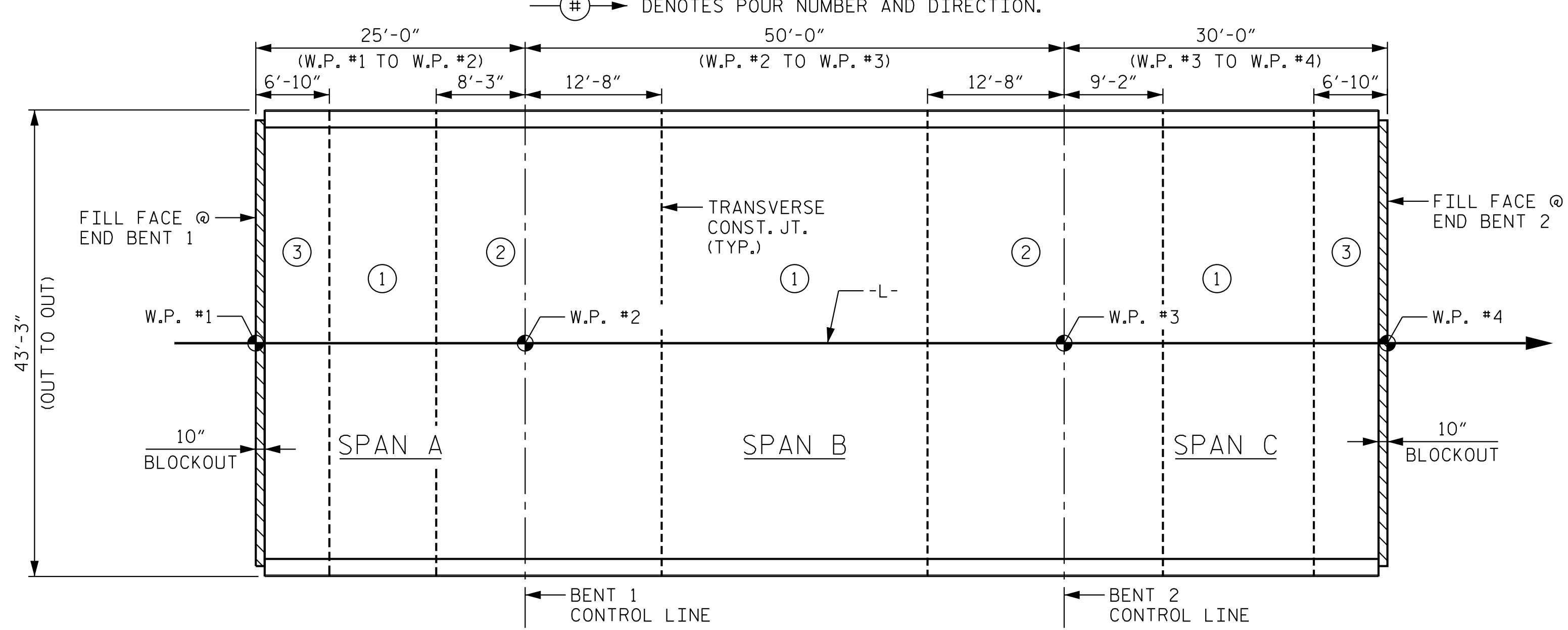

OPTIONAL POUR SEQUENCE

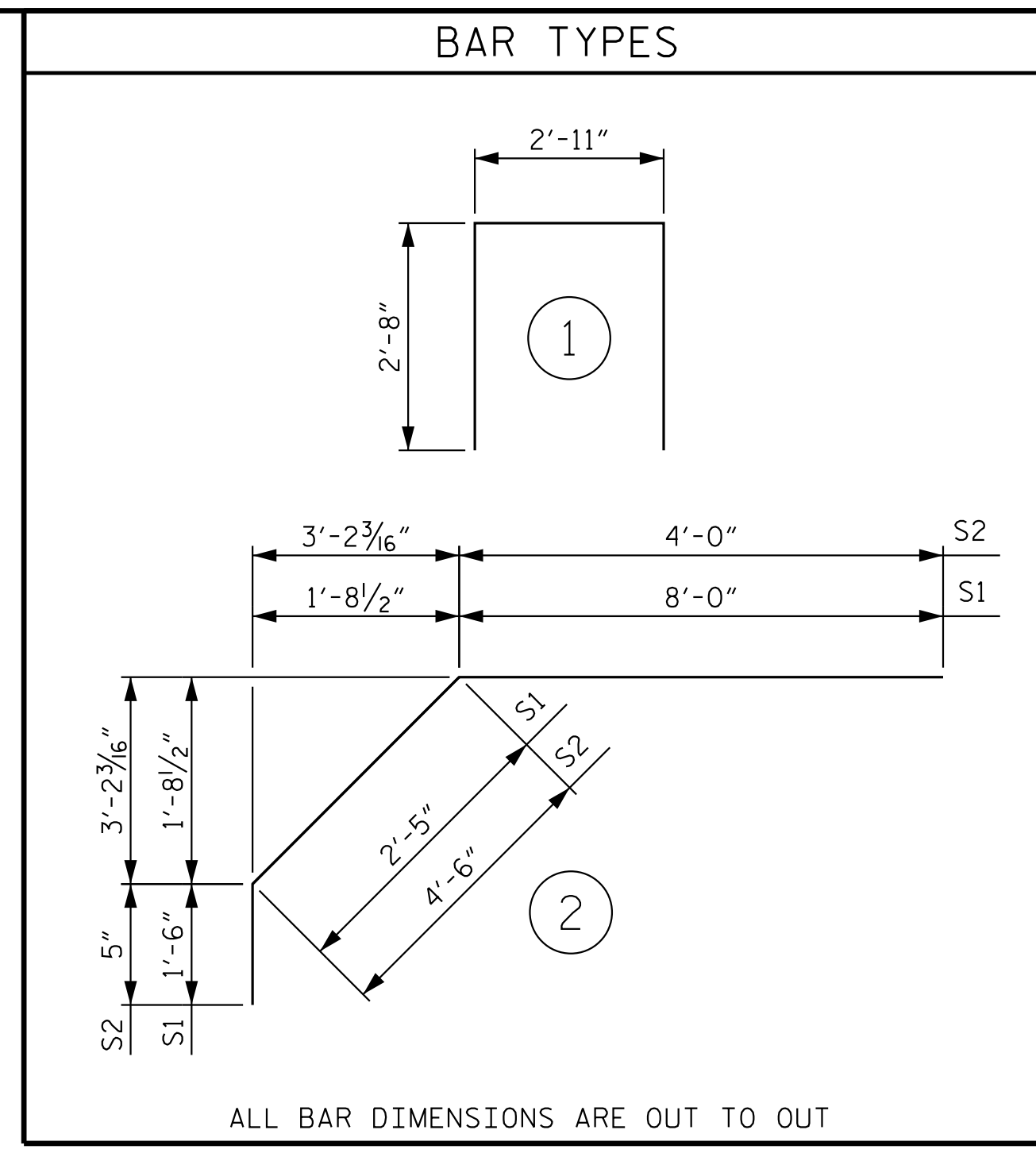

ALL BAR DIMENSIONS ARE OUT TO OUT

REINFORCING STEEL SCHEDULE					
BAR	NO.	SIZE	TYPE	LENGTH	WEIGHT
* A1	206	5	STR	42'-11"	9,221
A2	206	5	STR	42'-11"	9,221
* B1	31	4	STR	16'-8"	345
* B2	31	4	STR	32'-8"	676
* B3	31	4	STR	20'-9"	430
* B4	174	6	STR	5'-0"	1,307
* B5	87	6	STR	16'-9"	2,189
* B6	87	6	STR	17'-8"	2,309
B7	112	5	STR	52'-6"	6,133
K1	16	4	STR	22'-3"	238
K2	8	4	STR	7'-5"	40
K3	16	4	STR	8'-5"	90
K4	8	4	STR	7'-11"	42
K5	4	4	STR	2'-0"	5
K6	8	4	STR	2'-6"	13
K7	4	4	STR	2'-3"	6
* S1	72	4	2	11'-11"	573
* S2	72	4	2	8'-11"	429
U1	76	4	1	8'-3"	419
REINFORCING STEEL					16,207 LBS.
* EPOXY COATED REINFORCING STEEL					17,479 LBS.

SUPERSTRUCTURE REINFORCING STEEL LENGTHS ARE BASED ON THE FOLLOWING MINIMUM SPLICE LENGTHS

BAR SIZE	SUPERSTRUCTURE EXCEPT APPROACH SLABS, PARAPET, AND BARRIER RAIL		APPROACH SLABS		PARAPET AND BARRIER RAIL
	EPOXY COATED	UNCOATED	EPOXY COATED	UNCOATED	
#4	1'-11"	1'-7"	1'-11"	1'-7"	2'-6"
#5	2'-5"	2'-0"	2'-5"	2'-0"	3'-1"
#6	2'-10"	2'-5"	3'-7"	2'-5"	3'-8"
#7	4'-2"	2'-9"			
#8	4'-9"	3'-2"			

GROOVING BRIDGE FLOORS

APPROACH SLABS	1,813 SQ.FT.
BRIDGE DECK	3,824 SQ.FT.
TOTAL	5,637 SQ.FT.

SUPERSTRUCTURE BILL OF MATERIAL

	CLASS AA CONCRETE (CU. YDS.)	REINFORCING STEEL (LBS.)	* EPOXY COATED REINFORCING STEEL (LBS.)
POUR 1	12.4		
POUR 2	56.9		
POUR 3	44.8		
POUR 4	46.7		
TOTALS **	160.8	16,207	17,479

** QUANTITIES FOR CONCRETE BARRIER RAIL NOT INCLUDED.

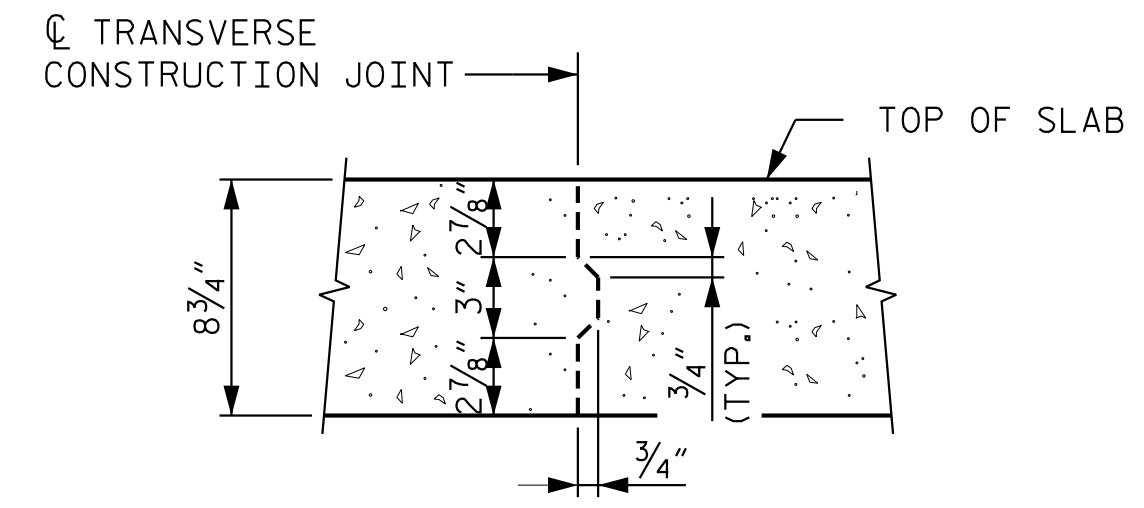

TRANSVERSE CONSTRUCTION JOINT IN DECK SLAB

REINFORCING STEEL IN SLAB NOT SHOWN, LONGITUDINAL REINFORCING STEEL SHALL BE CONTINUOUS THRU JOINT.

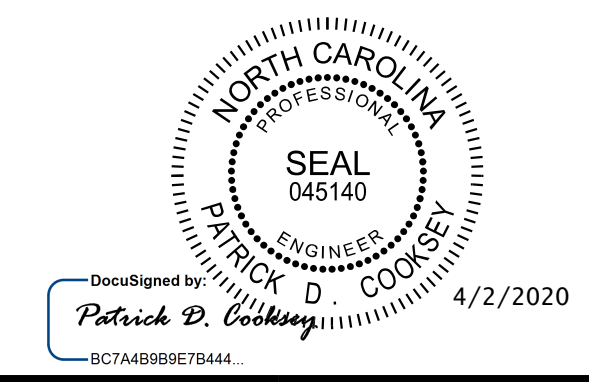

Kimley»Horn
421 Fayetteville Street, Suite 600
Raleigh, NC 27601-1772
Phone (919) 677-2000
NC LICENSE # F-0102

PROJECT NO. B-5534
DUPLIN COUNTY
STATION: 21+68.50 -L-

STATE OF NORTH CAROLINA
DEPARTMENT OF TRANSPORTATION
RALEIGH
SUPERSTRUCTURE
BILL OF MATERIAL

REVISIONS						SHEET NO. S-21
NO.	BY:	DATE:	NO.	BY:	DATE:	
1			3			TOTAL SHEETS 34
2			4			

K:\BIDI_Structures\Bridges\NC\01036500 - B-5534\Gcn\Dgn\B5534-SMU-BM1-300082.dgn

DRAWN BY: D. D. LOWERY DATE: 02/2020
CHECKED BY: J. C. WILSON DATE: 02/2020
DESIGN ENGINEER OF RECORD: P. D. COOKSEY DATE: 02/2020

**DOCUMENT NOT CONSIDERED FINAL
UNLESS ALL SIGNATURES COMPLETED**

This document, together with the concepts and designs presented herein, is an integral part of the project. It is intended only for the specific project and shall be used without authorization and adoption by Kimley-Horn and Associates, Inc. shall be without liability to Kimley-Horn and Associates, Inc.
Copyright Kimley-Horn and Associates, Inc., 2020