

09/08/2019

See Sheet 1A For Index of Sheets
See Sheet 1B For Conventional Symbols

STATE OF NORTH CAROLINA
DIVISION OF HIGHWAYS

CRAVEN COUNTY

LOCATION: REPLACE BRIDGES NO. 138 & 139 OVER NEUSE RIVER AND NEUSE RIVER OVERFLOW ON SR 1470 (MAPLE CYPRESS ROAD)

TYPE OF WORK: GRADING, DRAINAGE, PAVING, RETAINING WALLS, AND STRUCTURES

STATE	STATE PROJECT REFERENCE NO.	SHEET NO.	TOTAL SHEETS
N.C.	B-4484	1	
STATE PROJ. NO.	F.A. PROJ. NO.	DESCRIPTION	
33723.1.2	N/A	PE	
33723.2.1	N/A	ROW, UTIL	
33723.3.1	N/A	CONST	

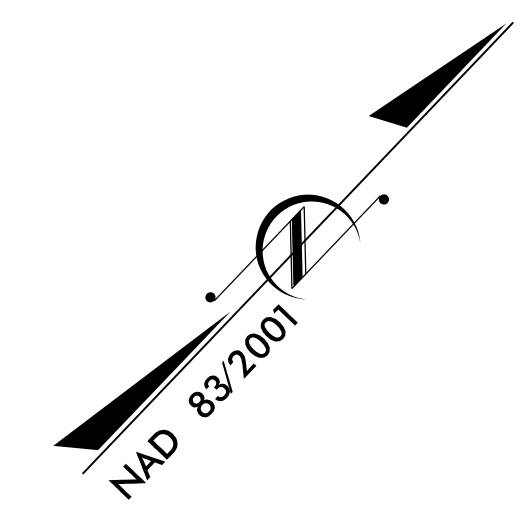
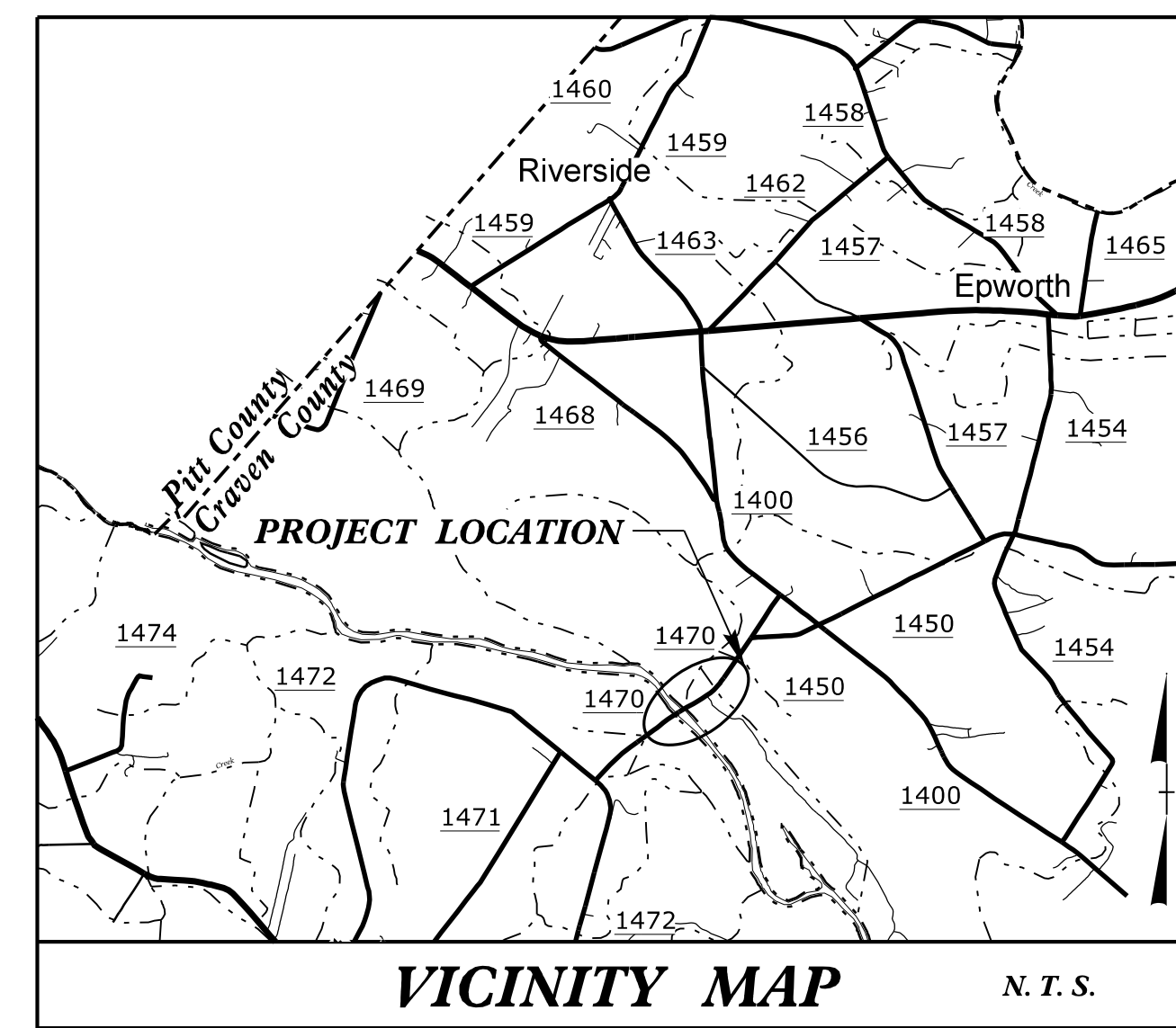

TIP PROJECT: B-4484

CONTRACT: C204434

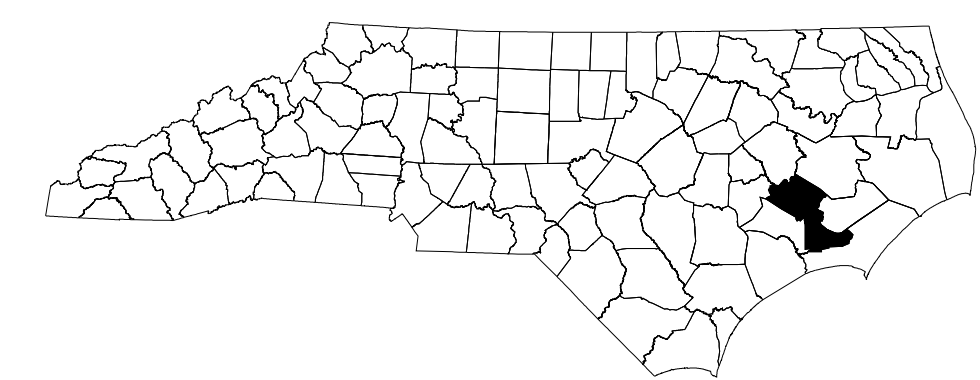
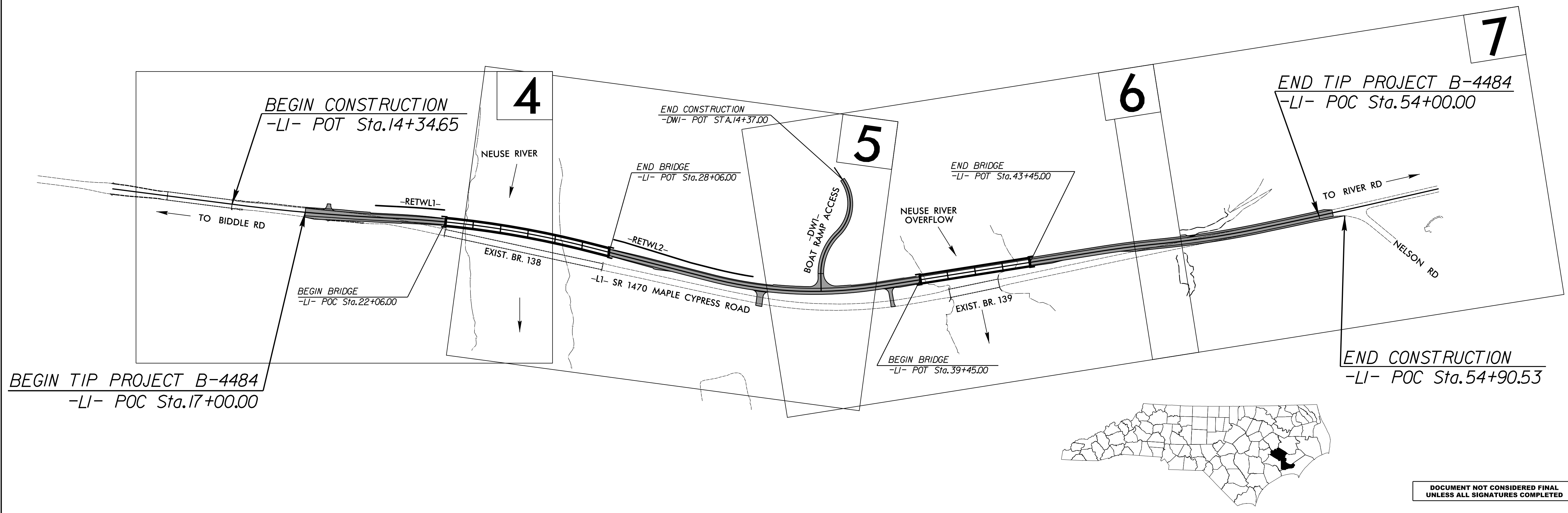

DOCUMENT NOT CONSIDERED FINAL
UNLESS ALL SIGNATURES COMPLETED

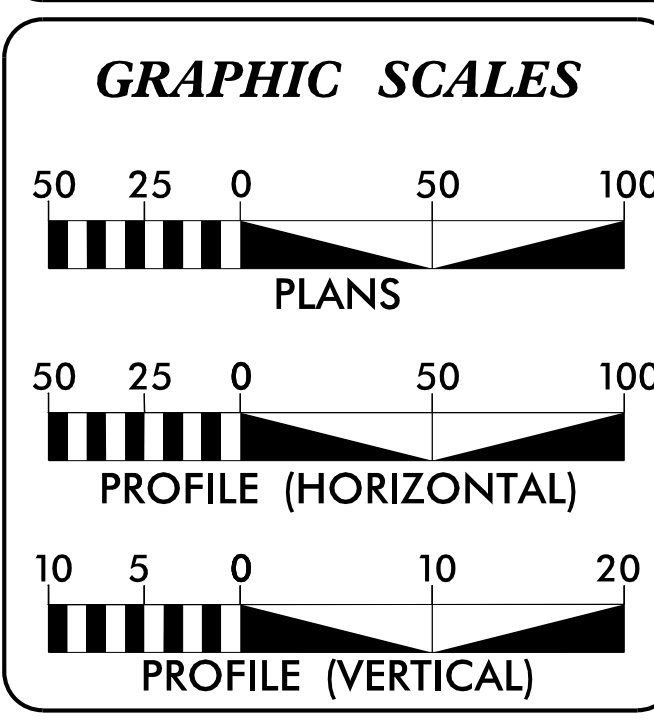

DESIGN DATA

ADT 2020 =	1,884
ADT 2039 =	2,279
K =	12 %
D =	60 %
T =	10 % *
V =	60 MPH
*(TTST=3% + DUAL=7%)	
FUNC CLASS =	MAJOR
COLLECTOR	SUB-REGIONAL TIER

PROJECT LENGTH

LENGTH ROADWAY TIP PROJECT B-4484	=	0.512 MILE
LENGTH STRUCTURE TIP PROJECT B-4484	=	0.189 MILE
TOTAL LENGTH TIP PROJECT B-4484	=	0.701 MILE

PREPARED IN THE OFFICE OF:

RS&H 1520 SOUTH BOULEVARD, SUITE 200
CHARLOTTE, NC 28203
NC FIRM LICENSE No: F-0493

FOR THE NORTH CAROLINA DEPARTMENT OF TRANSPORTATION
2018 STANDARD SPECIFICATIONS

RIGHT OF WAY DATE:
MARCH 7, 2019

LETTING DATE:
FEBRUARY 16, 2021

JENNIFER FARINO, PE
PROJECT ENGINEER

DREW MORROW, PE
PROJECT DESIGN ENGINEER

HON YEUNG, PE
NCDOT CONTACT

HYDRAULICS ENGINEER

DocuSigned by:
[Signature]
SIGNATURE: P.E. 12/9/2020

ROADWAY DESIGN ENGINEER

DocuSigned by:
[Signature]
SIGNATURE: P.E. 12/9/2020

