

8/17/99

REVISIONS

PC-MNH-2020-1615 BR00009_Rdy_psh.dgn
RD:Roads\VP\PC\BR00009_Rdy_psh.dgn

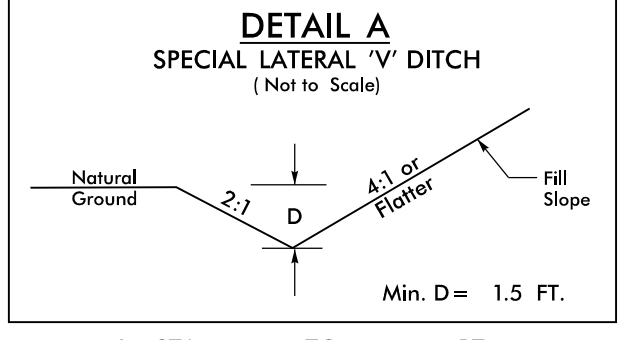

-L- STA. 15+15 TO 15+75 RT.

-L- CURVE DATA
 PI Sta 11+96.27
 $\Delta = 39^\circ 24' 14.1''$ (RT)
 $D = 22^\circ 55' 05.9''$
 $L = 1719.3'$
 $T = 89.52'$
 $R = 250.00'$
 $SE = 04$

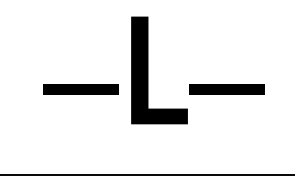

PROJECT REFERENCE NO. <i>BR-0009</i>		SHEET NO. 4	
RW SHEET NO.		HYDRAULICS	
ROADWAY DESIGN ENGINEER		ENGINEER	
DOCUMENT NOT CONSIDERED FINAL UNLESS ALL SIGNATURES COMPLETED			
<small>100 REGENCY FOREST DRIVE, SUITE 130 CARY, NORTH CAROLINA 27518 919-341-9418 http://www.atcsplc.com/</small>			
<small>ENGINEERING PLANNING SURVEYING ENVIRONMENTAL</small>			

TEMPORARY SHORING REQUIRED, SEE TMP PLANS FOR DETAILS

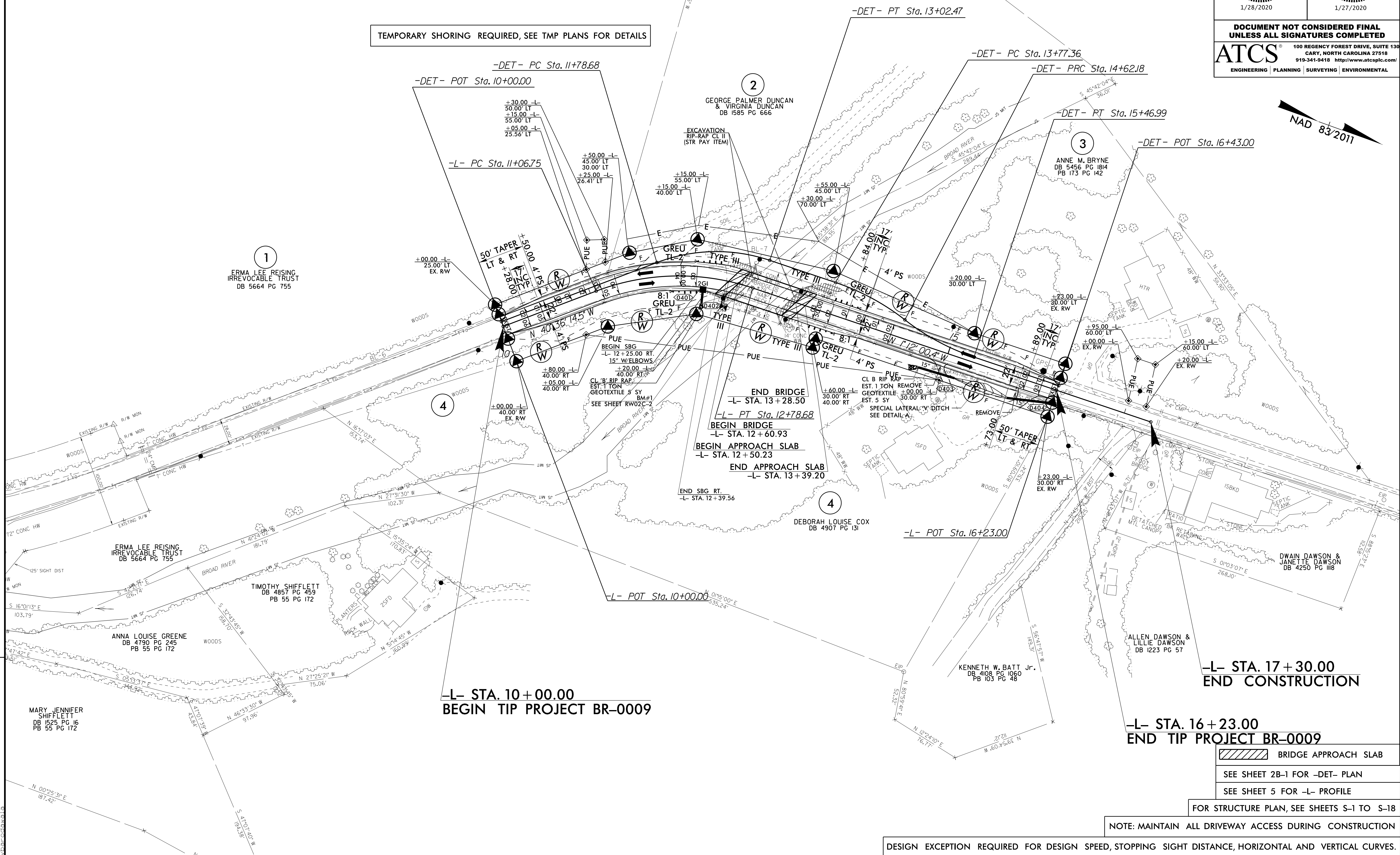

-L- STA. 10+00.00
BEGIN TIP PROJECT BR-0009

-L- STA. 17+30.00
END CONSTRUCTION

-L- STA. 16+23.00
END TIP PROJECT BR-0009

- BRIDGE APPROACH SLAB
- SEE SHEET 2B-1 FOR -DET- PLAN
- SEE SHEET 5 FOR -L- PROFILE

FOR STRUCTURE PLAN, SEE SHEETS S-1 TO S-18

NOTE: MAINTAIN ALL DRIVEWAY ACCESS DURING CONSTRUCTION

DESIGN EXCEPTION REQUIRED FOR DESIGN SPEED, STOPPING SIGHT DISTANCE, HORIZONTAL AND VERTICAL CURVES.