

TIP PROJECT: BR-0113

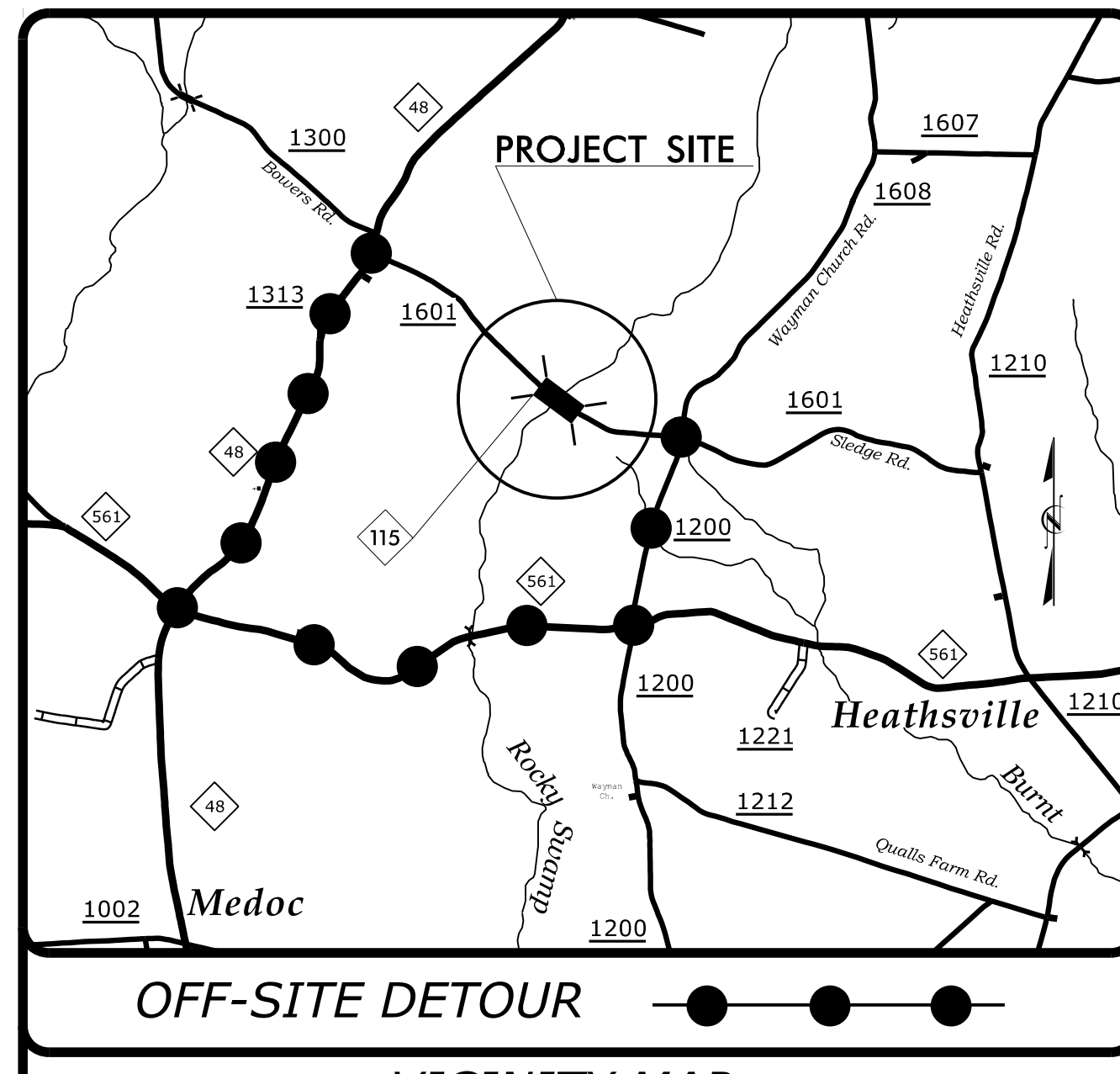

STATE OF NORTH CAROLINA
DIVISION OF HIGHWAYS
**PLAN FOR PROPOSED
HIGHWAY EROSION CONTROL**
HALIFAX COUNTY

**LOCATION: BRIDGE NO. 410115 OVER ROCKY SWAMP
ON SR 1601 (SLEDGE RD.)**

TYPE OF WORK: GRADING, DRAINAGE, PAVING & STRUCTURE

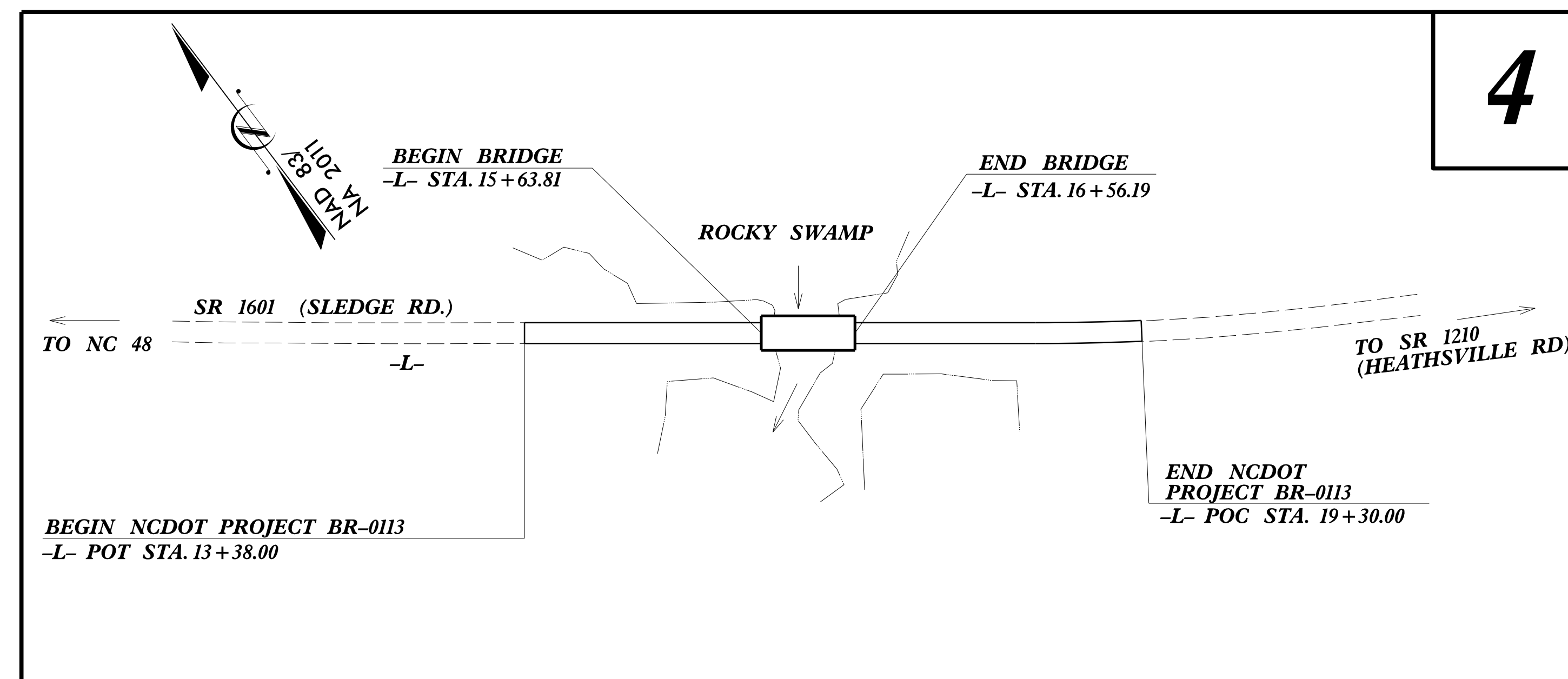

4

STATE	STATE PROJECT REFERENCE NO.	SHEET NO.	TOTAL SHEETS
N.C.	BR-0113	EC-1	
STATE PROJ. NO.	F.A. PROJ. NO.	DESCRIPTION	
48822.1.1		PE	
48822.2.1		ROW, UTIL.	

EROSION AND SEDIMENT CONTROL MEASURES

Std. #	Description	Symbol
1630.03	Temporary Silt Ditch	
1630.05	Temporary Diversion	
1605.01	Temporary Silt Fence	
1606.01	Special Sediment Control Fence	
1622.01	Temporary Berms and Slope Drains	
1650.02	Silt Basin Type B	
1633.01	Temporary Rock Silt Check Type-A	
	Temporary Rock Silt Check Type-A with Matting and Polyacrylamide (PAM)	
1633.02	Temporary Rock Silt Check Type-B	
	Wattle / Coir Fiber Wattle	
	Wattle / Coir Fiber Wattle with Polyacrylamide (PAM)	
1634.01	Temporary Rock Sediment Dam Type-A	
1634.02	Temporary Rock Sediment Dam Type-B	
1655.01	Rock Pipe Inlet Sediment Trap Type-A	
1655.02	Rock Pipe Inlet Sediment Trap Type-B	
1630.04	Stillling Basin	
1630.06	Special Stillling Basin	
	Rock Inlet Sediment Trap:	
1632.01	Type A	
1652.02	Type B	
1632.03	Type C	
	Skimmer Basin	
	Tiered Skimmer Basin	
	Infiltration Basin	

**THIS PROJECT CONTAINS
EROSION CONTROL PLANS
FOR CLEARING AND
GRUBBING PHASE OF
CONSTRUCTION.**

GRAPHIC SCALE

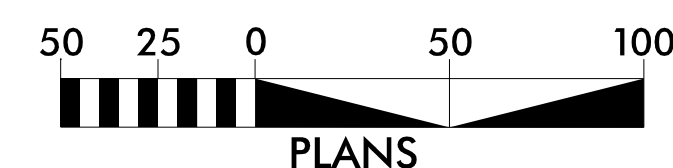

**THESE EROSION AND SEDIMENT CONTROL PLANS COMPLY WITH
THE APPLICABLE REGULATIONS SET FORTH BY THE NCG-010000
GENERAL CONSTRUCTION PERMIT EFFECTIVE APRIL 1, 2019
AND ISSUED BY THE NORTH CAROLINA DEPARTMENT OF
ENVIRONMENTAL QUALITY DIVISION OF WATER RESOURCES.**

1223 Jones Franklin Rd.
Raleigh, N.C. 27606
License No. F-0377
Bus: 919 851 8077
Fax: 919 851 8107

TRANSPORTATION PLANNING/DESIGN - BRIDGE/STRUCTURE DESIGN
CIVIL/SITE DESIGN - GIS/GPS - CONSTRUCTION OBSERVATION

Prepared in the Office of:
WETHERILL ENGINEERING
1223 JONES FRANKLIN RD.,
RALEIGH, NC 27606

Designed by:
FORREST BROOKS **4039**
NAME LEVEL III CERTIFICATION NO.

Roadway Standard Drawings

The following roadway english standards as appear in "Roadway Standard Drawings"- Roadway Design Unit - N. C. Department of Transportation - Raleigh, N. C., dated January 2018 and the latest revision thereto are applicable to this project and by reference hereby are considered a part of these plans.

1604.01 Railroad Erosion Control Detail	1632.01 Rock Inlet Sediment Trap Type A
1605.01 Temporary Silt Fence	1632.02 Rock Inlet Sediment Trap Type B
1606.01 Special Sediment Control Fence	1632.03 Rock Inlet Sediment Trap Type C
1607.01 Gravel Construction Entrance	1633.01 Temporary Rock Silt Check Type A
1622.01 Temporary Berms and Slope Drains	1633.02 Temporary Rock Silt Check Type B
1630.01 Riser Basin	1634.01 Temporary Rock Sediment Dam Type A
1630.02 Silt Basin Type B	1634.02 Temporary Rock Sediment Dam Type B
1630.03 Temporary Silt Ditch	1635.01 Rock Pipe Inlet Sediment Trap Type A
1630.04 Stillling Basin	1635.02 Rock Pipe Inlet Sediment Trap Type B
1630.05 Temporary Diversion	1640.01 Coir Fiber Baffle
1630.06 Special Stillling Basin	1645.01 Temporary Stream Crossing
1631.01 Matting Installation	

DIVISION OF HIGHWAYS
STATE OF NORTH CAROLINA

PROJECT REFERENCE NO. <i>BR-0113</i>	SHEET NO. <i>EC-2</i>
ROADWAY DESIGN ENGINEER	HYDRAULICS ENGINEER

SOIL STABILIZATION TIMEFRAMES

<i>SITE DESCRIPTION</i>	<i>STABILIZATION TIME</i>	<i>TIMEFRAME EXCEPTIONS</i>
PERIMETER DIKES, SWALES, DITCHES AND SLOPES	7 DAYS	NONE
HIGH QUALITY WATER (HQW) ZONES	7 DAYS	NONE
SLOPES STEEPER THAN 3:1	7 DAYS	IF SLOPES ARE 10' OR LESS IN LENGTH AND ARE NOT STEEPER THAN 2:1, 14 DAYS ARE ALLOWED.
SLOPES 3:1 OR FLATTER	14 DAYS	7 DAYS FOR SLOPES GREATER THAN 50' IN LENGTH.
ALL OTHER AREAS WITH SLOPES FLATTER THAN 4:1	14 DAYS	NONE, EXCEPT FOR PERIMETERS AND HQW ZONES.

PROJECT REFERENCE NO. BR-0113	SHEET NO. EC-3/CONST.4
RW SHEET NO.	
ROADWAY DESIGN ENGINEER	HYDRAULICS ENGINEER

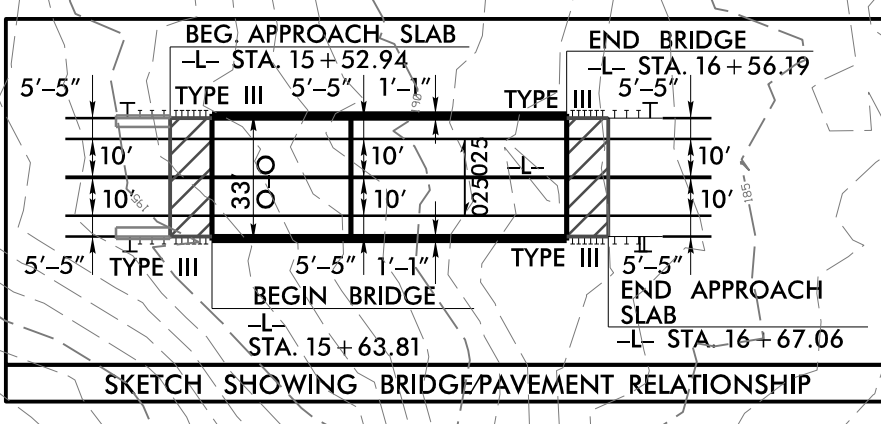

NOTE:
 BEGIN SBG STA. 15+68.81 LT. & RT.
 END SBG STA. 15+52.94 LT. & RT.

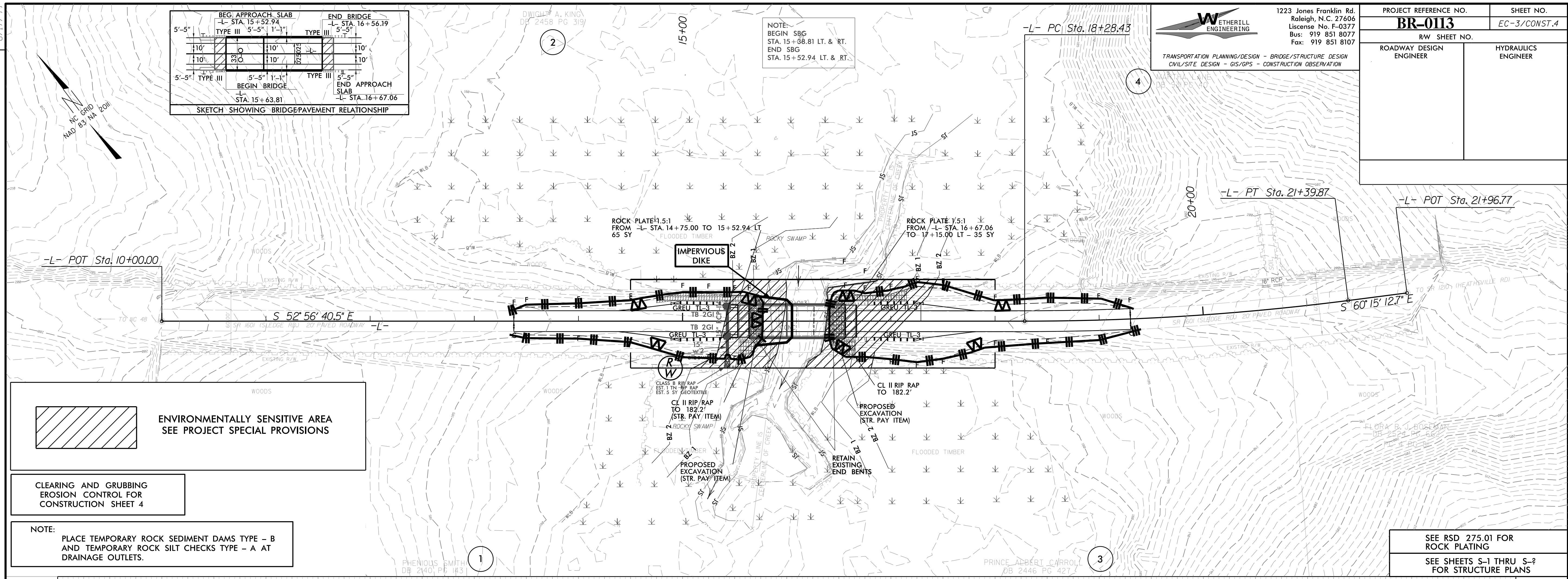

ENVIRONMENTALLY SENSITIVE AREA
 SEE PROJECT SPECIAL PROVISIONS

CLEARING AND GRUBBING
 EROSION CONTROL FOR
 CONSTRUCTION SHEET 4

NOTE:
 PLACE TEMPORARY ROCK SEDIMENT DAMS TYPE - B
 AND TEMPORARY ROCK SILT CHECKS TYPE - A AT
 DRAINAGE OUTLETS.

SEE RSD 275.01 FOR
 ROCK PLATING
 SEE SHEETS S-1 THRU S-2
 FOR STRUCTURE PLANS

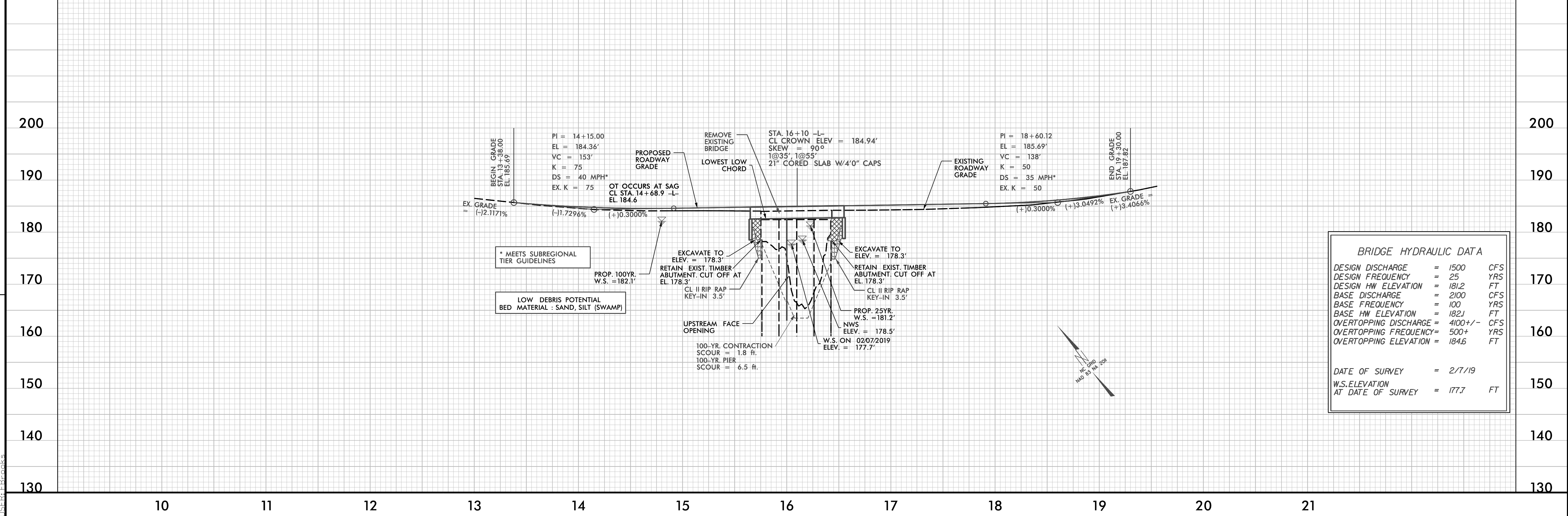

BRIDGE HYDRAULIC DATA

DESIGN DISCHARGE	= 1500	CFS
DESIGN FREQUENCY	= 25	YRS
DESIGN HW ELEVATION	= 181.2	FT
BASE DISCHARGE	= 2100	CFS
BASE FREQUENCY	= 100	YRS
BASE HW ELEVATION	= 182.1	FT
OVERTOPPING DISCHARGE	= 4100 +/-	CFS
OVERTOPPING FREQUENCY	= 500+	YRS
OVERTOPPING ELEVATION	= 184.6	FT

DATE OF SURVEY = 2/7/19
 W.S. ELEVATION AT DATE OF SURVEY = 177.7 FT

REVISIONS

I:\2019\2019\106.01 BR-0113\Erosion Control\BR-0113_EC.CG.drn.dgn
 USER: FPCOCKS

10/28/2019 10:06:01 BR-0113\Erosion Control\BR-0113_EC_final.dwg
 USER: EFCOCKS

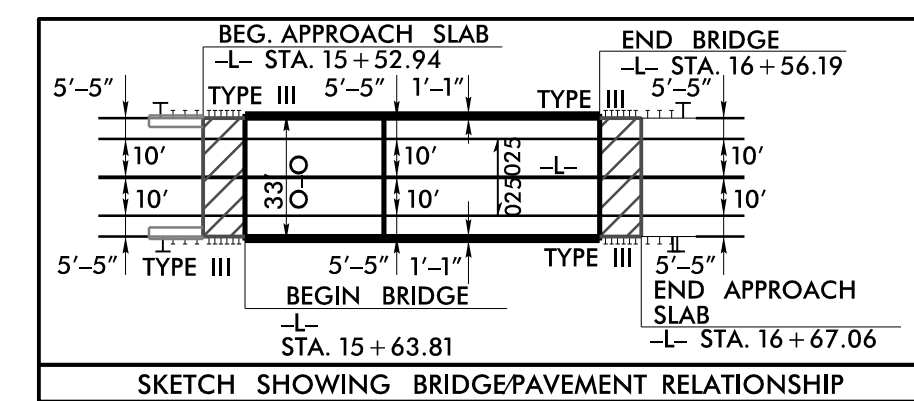
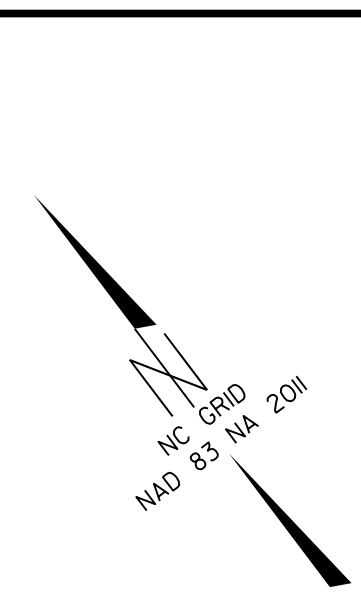

DWIGHT A. KING
DB 2458 PG 3/9

NOTE:
BEGIN S/BG
STA. 15+38.81 LT. & RT.
END S/BG
STA. 15+52.94 LT. & RT.



1223 Jones Franklin Rd.
Raleigh, N.C. 27606
License No. F-0377
Bus: 919 851 8077
Fax: 919 851 8107

PROJECT REFERENCE NO. BR-0113	SHEET NO. EC-4/CONST.4
RW SHEET NO.	
ROADWAY DESIGN ENGINEER	HYDRAULICS ENGINEER

MARTHA LANE
DB 931 PG 40

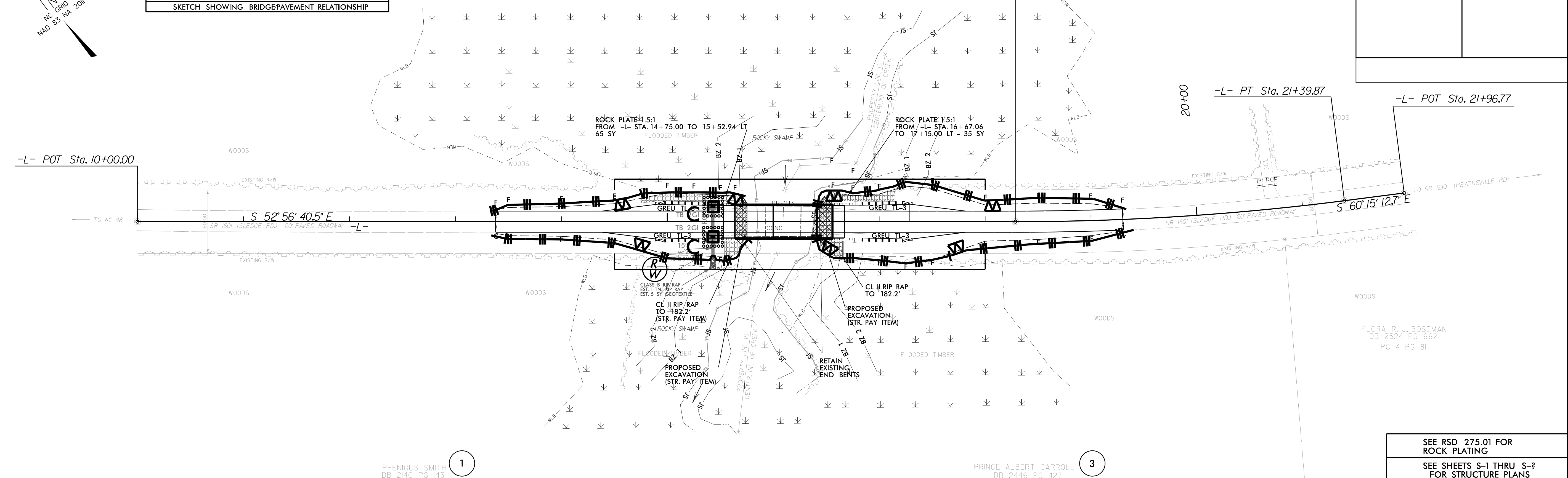

PHENIQUIS SMITH
DB 2140 PG 143

PRINCE ALBERT CARROLL
DB 2446 PG 427

SEE RSD 275.01 FOR
ROCK PLATING
SEE SHEETS S-1 THRU S-2
FOR STRUCTURE PLANS

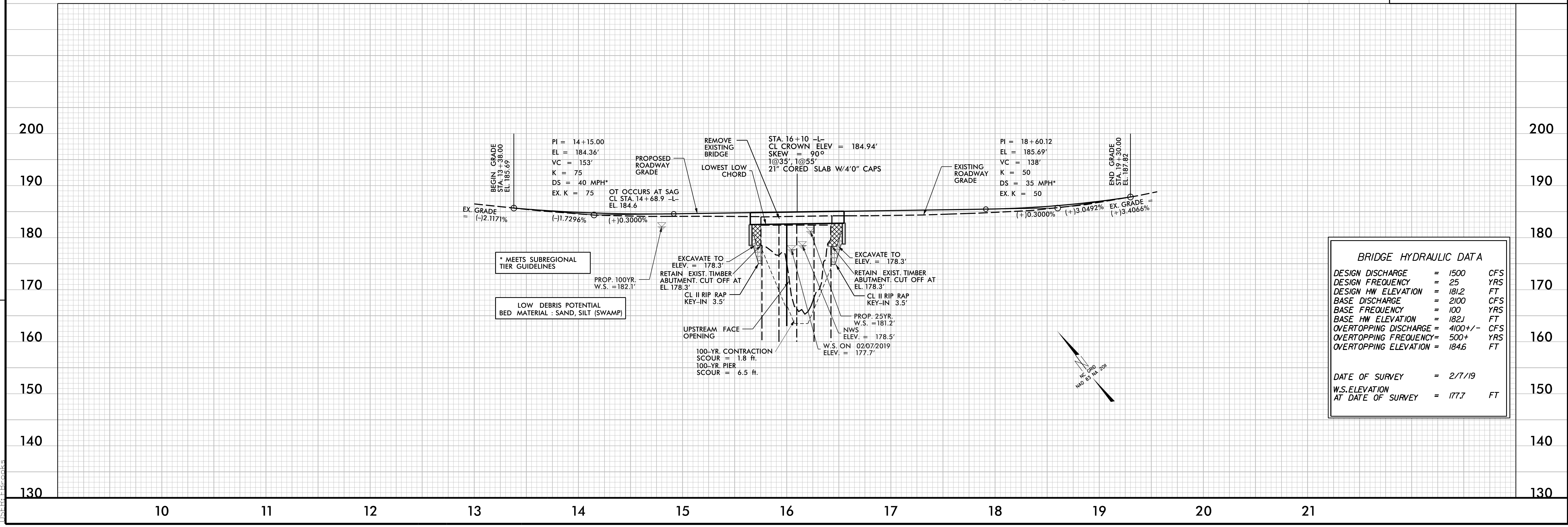

DESIGN DISCHARGE	= 1500	CFS
DESIGN FREQUENCY	= 25	YRS
DESIGN HW ELEVATION	= 181.2	FT
BASE DISCHARGE	= 2100	CFS
BASE FREQUENCY	= 100	YRS
BASE HW ELEVATION	= 182.1	FT
OVERTOPPING DISCHARGE	= 4100 +/-	CFS
OVERTOPPING FREQUENCY	= 500+	YRS
OVERTOPPING ELEVATION	= 184.6	FT
DATE OF SURVEY	= 2/7/19	
W.S. ELEVATION AT DATE OF SURVEY	= 177.7	FT

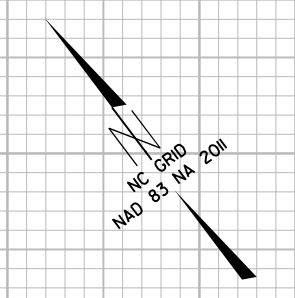

REVISIONS