

2021 FRANKLIN CHIP



5/14/2021
SYSTEMS
MISCELLANEOUS

PAVEMENT SCHEDULE

PROJECT REFERENCE NO.

SHEET NO.

2021CPT.05.12.20352.1

2

F1	PROP. ASPHALT SURFACE TREATMENT, DOUBLE SEAL
F2	PROP. FOG SEAL TO BE APPLIED WITHIN 5 DAYS OF DOUBLE SEAL ROADWAY SURFACE TO BE SWEEPED PRIOR TO FOG SEAL APPLICATION
U	EXISTING PAVEMENT

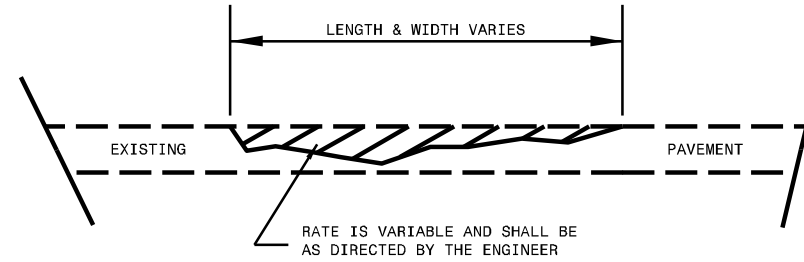

ASPHALT CONCRETE SURFACE COURSE
(LEVELING COURSE)

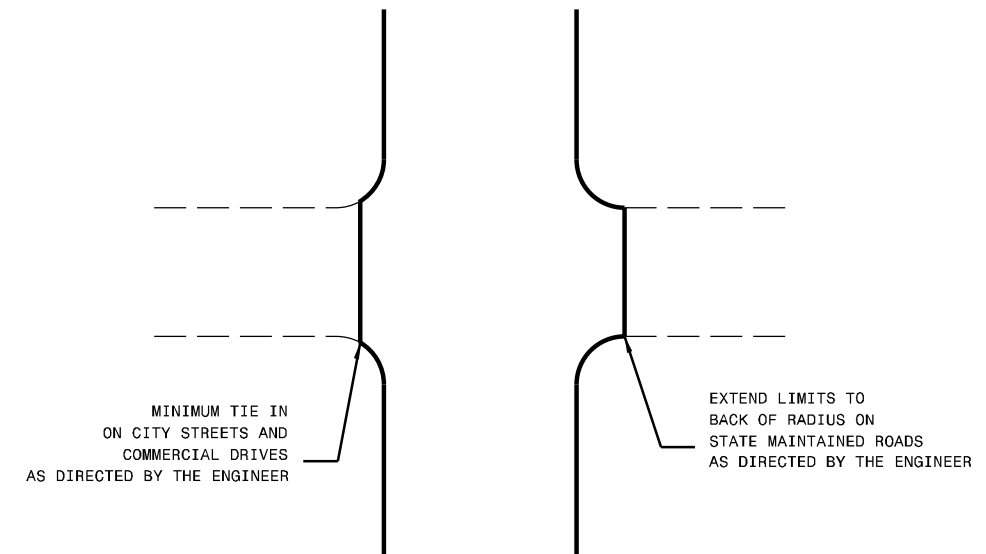

DETAIL OF PROJECT LIMITS AT
Y LINES

SEAL TYPES AND MATERIAL APPLICATION RATES					
MAP #	TYPE OF SEAL	LAYER	AGGREGATE TYPE	AGGREGATE TARGET RATES (LBS/SY)	EMULSION TARGET RATES (GAL/SY)
ALL MAPS	DOUBLE	BOTTOM	78M	18	0.30
		TOP	9M	9	0.25
			EMULSION TYPE		
ALL MAPS	FOG SEAL	WITHIN 5 DAYS OF DOUBLE SEAL	CSS-1H		0.12

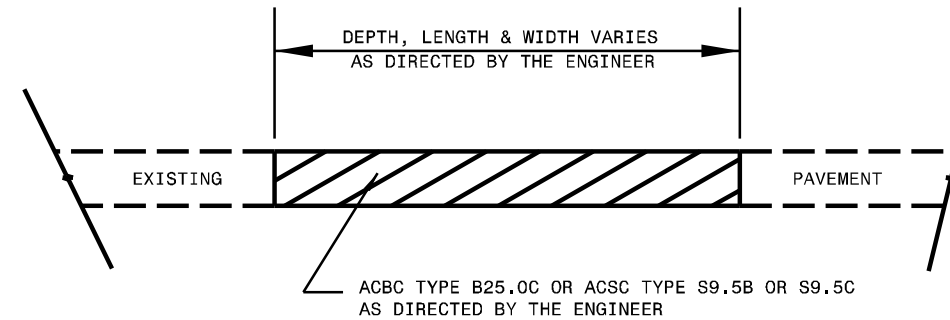

PATCHING EXISTING PAVEMENT
MILLING (IF REQUIRED BY TYPICAL) TO BE PERFORMED PRIOR TO PATCHING

* SEE SP06 R054 FOR TOLERANCE LIMITS

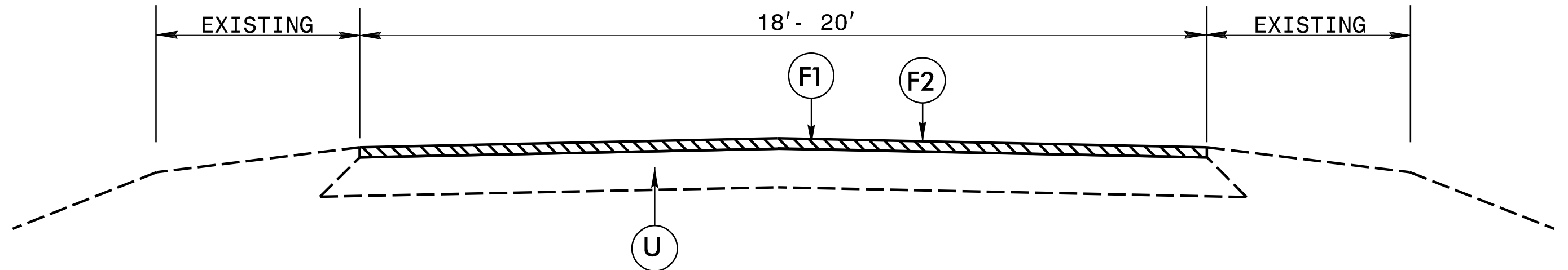

TYPICAL SECTION 1

PROJECT NO.	SHEET NO.	TOTAL NO.
2021CPT.05.12.20352.1	3	

SUMMARY OF QUANTITIES

PROJECT NO	COUNTY	MAP NO	ROUTE	DESCRIPTION	TYP NO	LANES	FINAL SURFACE TESTING REQUIRED	WARM MIX ASPHALT REQUIRED	LENGTH	WIDTH	1520000000-E	1575000000-E	1704000000-E	1803500000-E	1820000000-E	1838000000-E	4413000000-E	4457000000-N	4890000000-E
									MI	FT	TON	TON	TONS	SY	SY	GAL	SF	LS	LF
2021CPT.05.12.20352.1	Franklin	1	SR 1622 - COLLIE RD	NC 56 TO NASH CO	1	2	NO	NO	0.59	20	2	0.1	22	6,923	6,923	3,808	66		12,460
		2	SR 1639 - DUKE MEMORIAL RD	NC 581 TO NASH CO	1	2	NO	NO	3.84	18				40,550	40,550	22,303	430		81,100
		3	SR 1617 - GARDNER RD	NC 56 TO SR 1639 - DUKE MEMORIAL RD	1	2	NO	NO	3.87	20	28	2.0	145	45,408	45,408	24,974	433		81,734
		4	SR 1624 - LAYTON STORE RD	SR 1617 - GARDNER RD TO NASH CO	1	2	NO	NO	1.38	18	46	3.1	2	14,573	14,573	8,015	155		29,146
		5	SR 1625 - MATTHEWS RD	SR 1624 - LAYTON STORE RD TO SR 1624 - LAYTON STORE RD	1	2	NO	NO	0.39	20			39	4,576	4,576	2,517	44		8,236
		6	SR 1642 - MITCHELL RD	NC 581 TO END MAINT	1	2	NO	NO	0.79	20	21	1.5	186	9,269	9,269	5,098	88		15,628
		7	SR 1620 - NASH COUNTY LINE RD	SR 1619 - INSCOE RD TO NASH CO	1	2	NO	NO	0.74	20			378	8,683	8,683	4,776	83		31,680
		8	SR 1621 - RICK BOONE RD	NC 56 TO NASH CO	1	2	NO	NO	1.5	18				15,840	15,840	8,712	168		43,508
		9	SR 1618 - ROMMIE DANIELS RD	SR 1617 - GARDNER RD TO NASH CO	1	2	NO	NO	2.06	20				24,171	24,171	13,294	231		17,318
		10	SR 1616 - STALLINGS MILL RD	NC 56 TO BIG PEACHTREE CREEK	1	2	NO	NO	0.824	18				8,701	8,701	4,786	92		40,128
		11	SR 1631 - VICK RD	NC 581 TO SR 1630- COLLIE RD	1	2	NO	NO	1.9	20			3	22,293	22,293	12,261	213		360,938
TOTAL FOR PROJ NO. 2020CPT.05.21.20352.1									17.884		97	6.7	775	200,987	200,987	110,544	2,003	1	360,938
GRAND TOTAL									17.884		97	6.7	775	200,987	200,987	110,544	2,003	1	360,938

SIGNING FOR ASPHALT SURFACE TREATMENT

LEGEND

- PORTABLE SIGN
- STATIONARY SIGN
- DIRECTION OF TRAFFIC FLOW

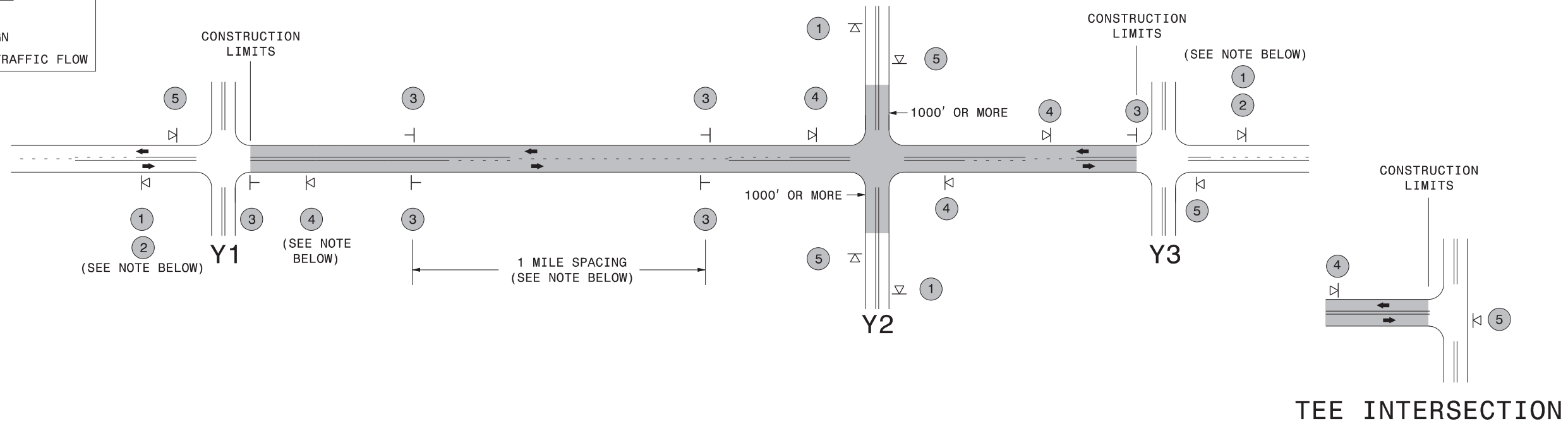

MAINLINE (-L-) SIGNING

-Y- LINE SIGNING

SIGNING NOTES AND PLACEMENT PER DIRECTION	 	<ul style="list-style-type: none"> - PLACE 1000' PRIOR TO BEGINNING OF CONSTRUCTION LIMITS. ONLY USED ON -Y- LINES IF RESURFACING LIMITS EXTEND 1000' ALONG -Y- LINE. - SIGN #2 ONLY USED WHEN RESURFACING LIMITS ARE 2 OR MORE MILES IN LENGTH. ROUND UP TO THE NEAREST WHOLE NUMBER. DO NOT USE FRACTIONAL OR DECIMAL NUMBERS. 	<p>STATIONARY SIGNING NOT REQUIRED FOR THE FOLLOWING -Y- LINE CONDITIONS:</p> <ol style="list-style-type: none"> 1) LESS THAN 1000' OF RESURFACING ALONG -Y- LINE 2) SUBDIVISION ROADS 3) DEAD END ROADS <p>WHEN PAVING/CONSTRUCTION ACTIVITIES PROCEED ACROSS AN UNSIGNED -Y- LINE, PORTABLE ADVANCE WARNING SIGNS SHALL BE USED ALONG THE -Y- LINE AS SHOWN BELOW. REMOVE UPON COMPLETION OF WORK.</p> <div style="display: flex; justify-content: space-around;"> <div style="text-align: center;"> PLACED 500' IN ADVANCE OF FLAGGER. </div> <div style="text-align: center;"> PLACED 250' IN ADVANCE OF FLAGGER. </div> </div>
	 	<ul style="list-style-type: none"> - ALTERNATE THE FOLLOWING TWO SIGNS: - STARTING WITH "LOOSE GRAVEL" (W8-7) FOLLOWED BY "UNMARKED PAVEMENT". - PLACE INITIALLY AT THE CONSTRUCTION LIMITS AND SPACED 1 MILE APART THEREAFTER. - AT TEE INTERSECTIONS INSTALL INITIALLY 0.5 MILE FROM INTERSECTION AND SPACE 1 MILE APART THEREAFTER. 	
		<ul style="list-style-type: none"> - THESE ARE FOR -Y- LINES THAT ARE "THROUGH" ROADWAYS. DEAD END AND SUBDIVISION ROADS ARE NOT "THROUGH" ROADWAYS. - INSTALL 500' +/- FROM EACH -Y- LINE APPROACH AS SHOWN ABOVE. - FOR MULTIPLE -Y- LINES THAT ARE SEPARATED BY 0.25 MILES OR LESS, TREAT AS A SINGLE UNIT AND INSTALL WITHIN 500' OF EACH APPROACH. - A MAXIMUM OF 2 SIGN SETS PER MILE. DO NOT INSTALL WHEN -Y- LINES ARE WITHIN 0.5 MILES FROM "END ROAD WORK" SIGN. 	
		<ul style="list-style-type: none"> - PLACE 500' FOLLOWING THE END OF CONSTRUCTION LIMITS OR AS SHOWN WHEN WORK ENDS AT A 3-WAY TEE INTERSECTION. 	

THE ABOVE SIGNS ARE ALL THAT ARE REQUIRED FOR A CONTRACTOR TO BEGIN A RESURFACING CONTRACT. ANY ADDITIONAL SIGNS REQUESTED BY NCDOT DIVISIONS SHALL BE INSTALLED WITHIN 7 BUSINESS DAYS OF THE START OF CONTRACT WORK.

MAPS LESS THAN 2 MILES

FOR AST RESURFACING MAPS WITH CONSTRUCTION LIMITS LESS THAN 2 MILES IN LENGTH, USE A STATIONARY "LOOSE GRAVEL" SIGN AT THE BEGINNING CONSTRUCTION LIMIT FOLLOWED BY AN "UNMARKED PAVEMENT" SIGN MIDWAY THROUGH AND AN "END ROAD WORK" SIGN AT THE END CONSTRUCTION LIMIT.

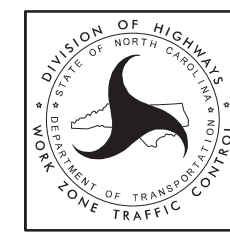

ADVANCE WARNING SIGNS FOR 2-LANE ROADWAY ASPHALT SURFACE TREATMENT

5/12/2017 S:\TUXWZTC\Resurfacing\2L2W & AST Resurfacing Details\Resurfacing_AdvWarn_2Ln - AST.dgn User:kedais