

LOAD AND RESISTANCE FACTOR RATING (LRFD) SUMMARY FOR PRESTRESSED CONCRETE GIRDERS

LEVEL	VEHICLE	WEIGHT (W) (TONS)	CONTROLLING LOAD RATING	MINIMUM RATING FACTORS (RF)	TONS = W X RF	STRENGTH I LIMIT STATE										SERVICE III LIMIT STATE					COMMENT NUMBER			
						MOMENT					SHEAR					MOMENT								
						LIVELOAD FACTORS	DISTRIBUTION FACTORS (DF)	RATING FACTOR	SPAN	GIRDER LOCATION	DISTANCE FROM LEFT END OF SPAN (FF)	DISTRIBUTION FACTORS (DF)	RATING FACTOR	SPAN	GIRDER LOCATION	DISTANCE FROM LEFT END OF SPAN (FF)	LIVELOAD FACTORS	DISTRIBUTION FACTORS (DF)	RATING FACTOR	SPAN		GIRDER LOCATION	DISTANCE FROM LEFT END OF SPAN (FF)	
DESIGN LOAD RATING	HL-93(Inv)	N/A	1	1.133	--	1.75	0.249	1.48	60'	EL	29.423	0.649	1.13	60'	EL	5.885	0.80	0.249	1.52	60'	EL	29.423		
	HL-93(Opr)	N/A	--	1.468	--	1.35	0.249	1.91	60'	EL	29.423	0.649	1.47	60'	EL	5.885	N/A	--	--	--	--	--		
	HS-20(Inv)	36.000	2	1.364	49.098	1.75	0.249	1.87	60'	EL	29.423	0.649	1.36	60'	EL	5.885	0.80	0.249	1.92	60'	EL	29.423		
	HS-20(Opr)	36.000	--	1.768	63.645	1.35	0.249	2.42	60'	EL	29.423	0.649	1.77	60'	EL	5.885	N/A	--	--	--	--	--		
LEGAL LOAD RATING	SV	SNSH	13.500	--	3.938	53.159	1.4	0.249	5.03	60'	EL	29.423	0.649	3.94	60'	EL	5.885	0.80	0.249	4.13	60'	EL	29.423	
		SNGARBS2	20.000	--	2.837	56.744	1.4	0.249	3.85	60'	EL	29.423	0.649	2.84	60'	EL	5.885	0.80	0.249	3.17	60'	EL	29.423	
		SNAGRIS2	22.000	--	2.648	58.256	1.4	0.249	3.69	60'	EL	29.423	0.649	2.65	60'	EL	5.885	0.80	0.249	3.03	60'	EL	29.423	
		SNCOTTS3	27.250	--	1.97	53.671	1.4	0.249	2.5	60'	EL	29.423	0.649	1.97	60'	EL	5.885	0.80	0.249	2.06	60'	EL	29.423	
		SNAGGRS4	34.925	--	1.661	58.001	1.4	0.249	2.13	60'	EL	29.423	0.649	1.66	60'	EL	5.885	0.80	0.249	1.75	60'	EL	29.423	
		SNS5A	35.550	--	1.696	60.293	1.4	0.249	2.08	60'	EL	29.423	0.649	1.7	60'	EL	5.885	0.80	0.249	1.71	60'	EL	29.423	
		SNS6A	39.950	--	1.558	62.257	1.4	0.249	1.93	60'	EL	29.423	0.649	1.56	60'	EL	5.885	0.80	0.249	1.58	60'	EL	29.423	
	TTST	TNAGRIT3	33.000	--	1.846	60.907	1.4	0.249	2.36	60'	EL	29.423	0.649	1.85	60'	EL	5.885	0.80	0.249	1.94	60'	EL	29.423	
		TNT4A	33.075	--	1.787	59.108	1.4	0.249	2.37	60'	EL	29.423	0.649	1.79	60'	EL	5.885	0.80	0.249	1.95	60'	EL	29.423	
		TNT6A	41.600	--	1.607	66.863	1.4	0.249	1.96	60'	EL	29.423	0.649	1.67	60'	EL	5.885	0.80	0.249	1.61	60'	EL	29.423	
		TNT7A	42.000	--	1.598	67.1	1.4	0.249	1.97	60'	EL	29.423	0.649	1.6	60'	EL	5.885	0.80	0.249	1.62	60'	EL	29.423	
		TNT7B	42.000	--	1.499	62.942	1.4	0.249	2.06	60'	EL	29.423	0.649	1.5	60'	EL	5.885	0.80	0.249	1.69	60'	EL	29.423	
		TNAGRIT4	43.000	--	1.447	62.223	1.4	0.249	1.95	60'	EL	29.423	0.649	1.45	60'	EL	5.885	0.80	0.249	1.60	60'	EL	29.423	
		TNAGT5A	45.000	--	1.455	65.474	1.4	0.249	1.83	60'	EL	29.423	0.649	1.45	60'	EL	5.885	0.80	0.249	1.50	60'	EL	29.423	
TNAGT5B	45.000	3	1.374	61.845	1.4	0.249	1.8	60'	EL	29.423	0.649	1.37	60'	EL	5.885	0.80	0.249	1.48	60'	EL	29.423			

LOAD FACTORS:

DESIGN LOAD RATING FACTORS	LIMIT STATE	γ_{DC}	γ_{DW}
	STRENGTH I	1.25	1.50
	SERVICE III	1.00	1.00

NOTES:

MINIMUM RATING FACTORS ARE BASED ON THE STRENGTH I AND SERVICE III LIMIT STATES.
ALLOWABLE STRESSES FOR SERVICE III LIMIT STATE ARE AS REQUIRED FOR DESIGN.

COMMENTS:

- 1.
- 2.
- 3.
- 4.

CONTROLLING LOAD RATING

1 DESIGN LOAD RATING (HL-93)

2 DESIGN LOAD RATING (HS-20)

3 LEGAL LOAD RATING **

** SEE CHART FOR VEHICLE TYPE

GIRDER LOCATION

I - INTERIOR GIRDER
EL - EXTERIOR LEFT GIRDER
ER - EXTERIOR RIGHT GIRDER

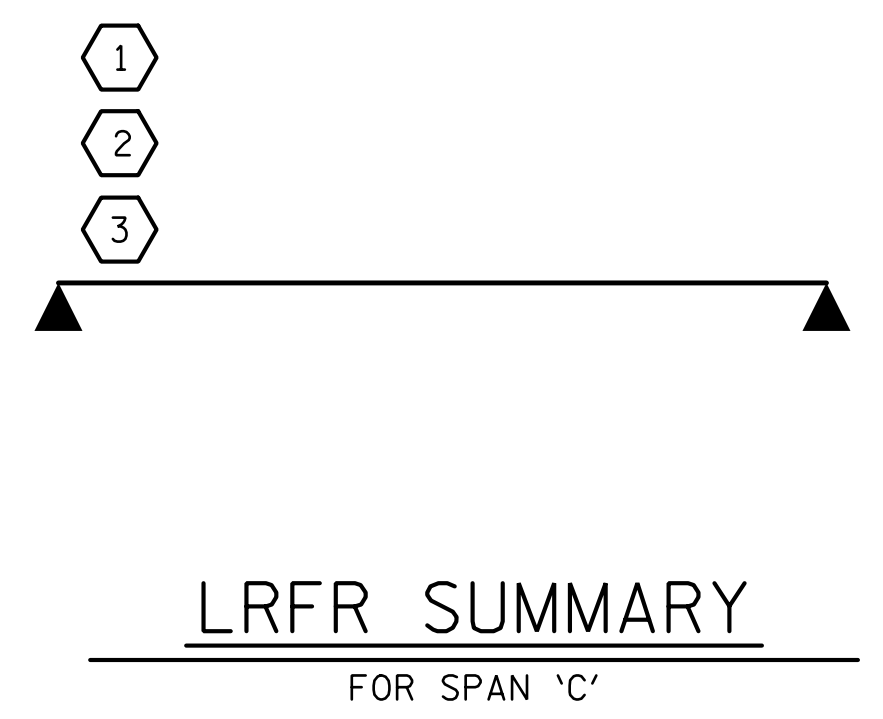

PROJECT NO. BR-0125
WILKES COUNTY
STATION: 15+36.00 -L-

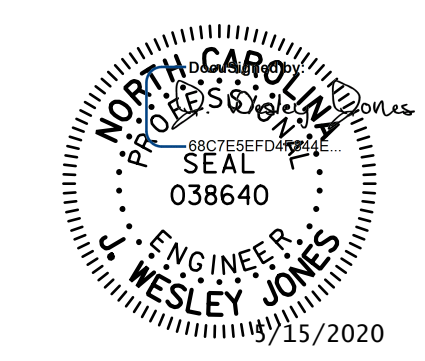

STV 100 YEARS
STV ENGINEERS, INC.
900 West Trade St., Suite 715
Charlotte, NC 28202
NC License Number F-0991

DOCUMENT NOT CONSIDERED
FINAL UNLESS ALL
SIGNATURES COMPLETED

STATE OF NORTH CAROLINA
DEPARTMENT OF TRANSPORTATION
RALEIGH
STANDARD
LRFR SUMMARY FOR
60' CORED SLAB UNIT
120° SKEW
(NON-INTERSTATE TRAFFIC)

REVISIONS					SHEET NO.
NO.	BY:	DATE:	NO.	BY:	DATE:
1			3		
2			4		
					S-5
					TOTAL SHEETS 23

R:\Structures\ustation\Finals\40L_009_BR-0125_SML_LRFR3_005_960663.dgn 5/4/2020 3:11:59 PM Jones

DRAWN BY : WAW DATE : 10-19
CHECKED BY : JWJ DATE : 01-20
DESIGN ENGINEER OF RECORD : JWJ DATE : 04-20
DRAWN BY : CVC 6/10
CHECKED BY : DNS 6/10