

### LOAD AND RESISTANCE FACTOR RATING (LRFD) SUMMARY FOR PRESTRESSED CONCRETE GIRDERS

LEVEL	VEHICLE	WEIGHT (W) (TONS)	CONTROLLING LOAD RATING	MINIMUM RATING FACTORS (RF)	TONS = W X RF	STRENGTH I LIMIT STATE										SERVICE III LIMIT STATE					COMMENT NUMBER			
						LIVELOAD FACTORS	MOMENT					SHEAR					LIVELOAD FACTORS	MOMENT						
							DISTRIBUTION FACTORS (DF)	RATING FACTOR	SPAN	GIRDER LOCATION	DISTANCE FROM LEFT END OF SPAN (ft)	DISTRIBUTION FACTORS (DF)	RATING FACTOR	SPAN	GIRDER LOCATION	DISTANCE FROM LEFT END OF SPAN (ft)		DISTRIBUTION FACTORS (DF)	RATING FACTOR	SPAN		GIRDER LOCATION	DISTANCE FROM LEFT END OF SPAN (ft)	
DESIGN LOAD RATING	HL-93(Inv)	N/A	1	1.352	--	1.75	0.252	1.95	40'	EL	19.423	0.653	<b>1.35</b>	40'	EL	<b>7.769</b>	0.80	0.252	1.72	40'	EL	19.423		
	HL-93(Opr)	N/A	--	1.753	--	1.35	0.252	2.52	40'	EL	19.423	0.653	1.75	40'	EL	7.769	N/A	--	--	--	--	--		
	HS-20(Inv)	36.000	2	1.544	55.583	1.75	0.252	2.45	40'	EL	19.423	0.653	<b>1.54</b>	40'	EL	<b>7.769</b>	0.80	0.252	2.14	40'	EL	19.423		
	HS-20(Opr)	36.000	--	2.001	72.053	1.35	0.252	3.17	40'	EL	19.423	0.653	2	40'	EL	7.769	N/A	--	--	--	--	--		
LEGAL LOAD RATING	SV	SNSH	13.500	--	3.929	53.037	1.4	0.252	5.64	40'	EL	19.423	0.653	3.93	40'	EL	7.769	0.80	0.252	3.99	40'	EL	19.423	
		SNGARBS2	20.000	--	2.985	59.708	1.4	0.252	4.63	40'	EL	15.538	0.653	2.99	40'	EL	7.769	0.80	0.252	3.28	40'	EL	19.423	
		SNAGRIS2	22.000	--	2.852	62.746	1.4	0.252	4.53	40'	EL	15.538	0.653	2.85	40'	EL	7.769	0.80	0.252	3.23	40'	EL	15.538	
		SNCOTTS3	27.250	--	1.98	53.947	1.4	0.252	2.82	40'	EL	19.423	0.653	1.98	40'	EL	7.769	0.80	0.252	1.99	40'	EL	19.423	
		SNAGGRS4	34.925	--	1.782	62.222	1.4	0.252	2.54	40'	EL	19.423	0.653	1.78	40'	EL	7.769	0.80	0.252	1.79	40'	EL	19.423	
		SNS5A	35.550	--	1.746	62.059	1.4	0.252	2.47	40'	EL	19.423	0.653	1.89	40'	EL	7.769	0.80	0.252	1.75	40'	EL	19.423	
		SNS6A	39.950	--	1.662	66.381	1.4	0.252	2.35	40'	EL	19.423	0.653	1.79	40'	EL	7.769	0.80	0.252	1.66	40'	EL	19.423	
	TTST	TNAGRIT3	33.000	--	2.045	67.476	1.4	0.252	2.89	40'	EL	19.423	0.653	2.07	40'	EL	7.769	0.80	0.252	2.04	40'	EL	19.423	
		TNT4A	33.075	--	1.951	64.52	1.4	0.252	2.93	40'	EL	19.423	0.653	1.95	40'	EL	7.769	0.80	0.252	2.07	40'	EL	19.423	
		TNT6A	41.600	--	1.757	73.106	1.4	0.252	2.49	40'	EL	19.423	0.653	1.91	40'	EL	7.769	0.80	0.252	1.76	40'	EL	19.423	
		TNT7A	42.000	--	1.795	75.386	1.4	0.252	2.55	40'	EL	19.423	0.653	1.79	40'	EL	7.769	0.80	0.252	1.80	40'	EL	19.423	
		TNT7B	42.000	--	1.729	72.638	1.4	0.252	2.61	40'	EL	19.423	0.653	1.73	40'	EL	7.769	0.80	0.252	1.84	40'	EL	19.423	
		TNAGRIT4	43.000	--	1.661	71.441	1.4	0.252	2.53	40'	EL	15.538	0.653	1.66	40'	EL	7.769	0.80	0.252	1.79	40'	EL	19.423	
		TNAGT5A	45.000	--	1.659	74.644	1.4	0.252	2.35	40'	EL	19.423	0.653	1.77	40'	EL	7.769	0.80	0.252	1.66	40'	EL	19.423	
TNAGT5B	45.000	3	1.568	70.561	1.4	0.252	2.28	40'	EL	19.423	0.653	<b>1.57</b>	40'	EL	<b>7.769</b>	0.80	0.252	1.61	40'	EL	19.423			

#### LOAD FACTORS:

DESIGN LOAD RATING FACTORS	LIMIT STATE	$\gamma_{DC}$	$\gamma_{DW}$
	STRENGTH I	1.25	1.50
	SERVICE III	1.00	1.00

#### NOTES:

MINIMUM RATING FACTORS ARE BASED ON THE STRENGTH I AND SERVICE III LIMIT STATES.  
ALLOWABLE STRESSES FOR SERVICE III LIMIT STATE ARE AS REQUIRED FOR DESIGN.

#### COMMENTS:

- 1.
- 2.
- 3.
- 4.

# CONTROLLING LOAD RATING

1 DESIGN LOAD RATING (HL-93)

2 DESIGN LOAD RATING (HS-20)

3 LEGAL LOAD RATING \*\*

\*\* SEE CHART FOR VEHICLE TYPE

---

GIRDER LOCATION

I - INTERIOR GIRDER  
EL - EXTERIOR LEFT GIRDER  
ER - EXTERIOR RIGHT GIRDER

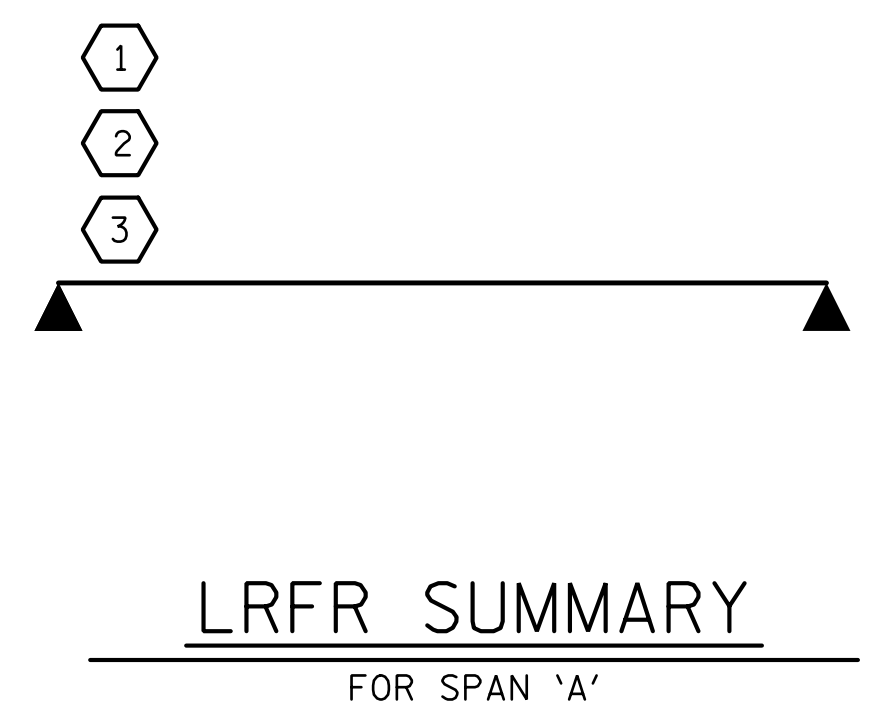

PROJECT NO. BR-0125  
WILKES COUNTY  
STATION: 15+36.00 -L-

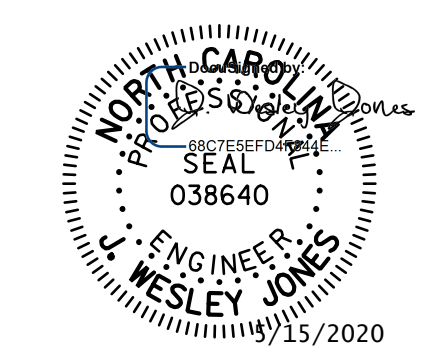

**STV** 100 YEARS  
STV ENGINEERS, INC.  
900 West Trade St., Suite 715  
Charlotte, NC 28202  
NC License Number F-0991

DOCUMENT NOT CONSIDERED  
FINAL UNLESS ALL  
SIGNATURES COMPLETED

STATE OF NORTH CAROLINA  
DEPARTMENT OF TRANSPORTATION  
RALEIGH  
STANDARD  
LRFR SUMMARY FOR  
40' CORED SLAB UNIT  
120° SKEW  
(NON-INTERSTATE TRAFFIC)

REVISIONS					SHEET NO.
NO.	BY:	DATE:	NO.	BY:	DATE:
1			3		
2			4		

TOTAL SHEETS: 23

R:\Structures\ustation\Finals\40L\_005\_BR-0125\_SML\_LRFR\_003\_960663.dgn 5/4/2020 3:11:56 PM Jones

DRAWN BY : WAW DATE : 10-19  
CHECKED BY : JWJ DATE : 01-20  
DESIGN ENGINEER OF RECORD : JWJ DATE : 04-20  
DRAWN BY : CVC 6/10  
CHECKED BY : DNS 6/10