

STATE OF NORTH CAROLINA
DIVISION OF HIGHWAYS

TRANSPORTATION MANAGEMENT PLAN

WILKES COUNTY

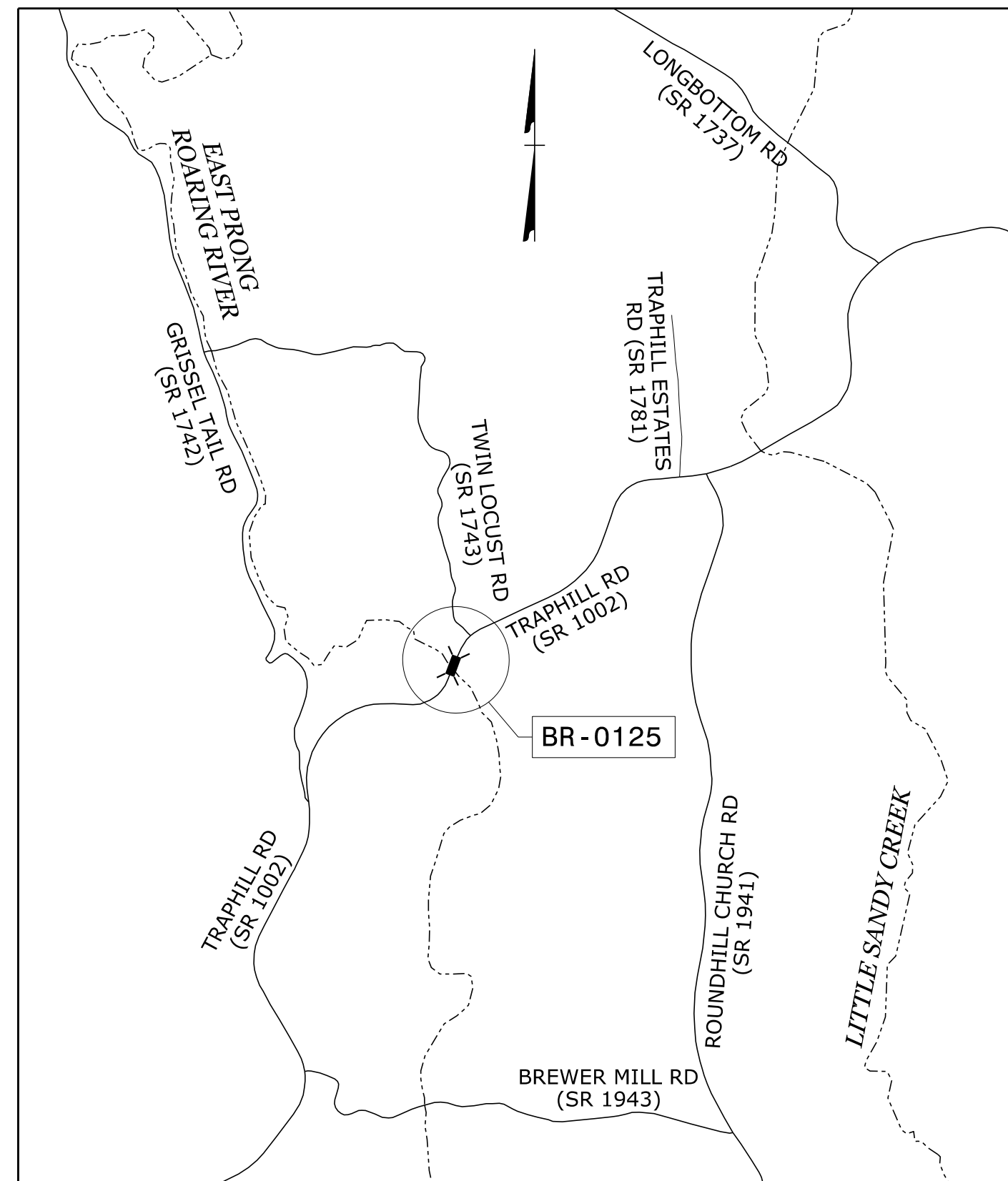
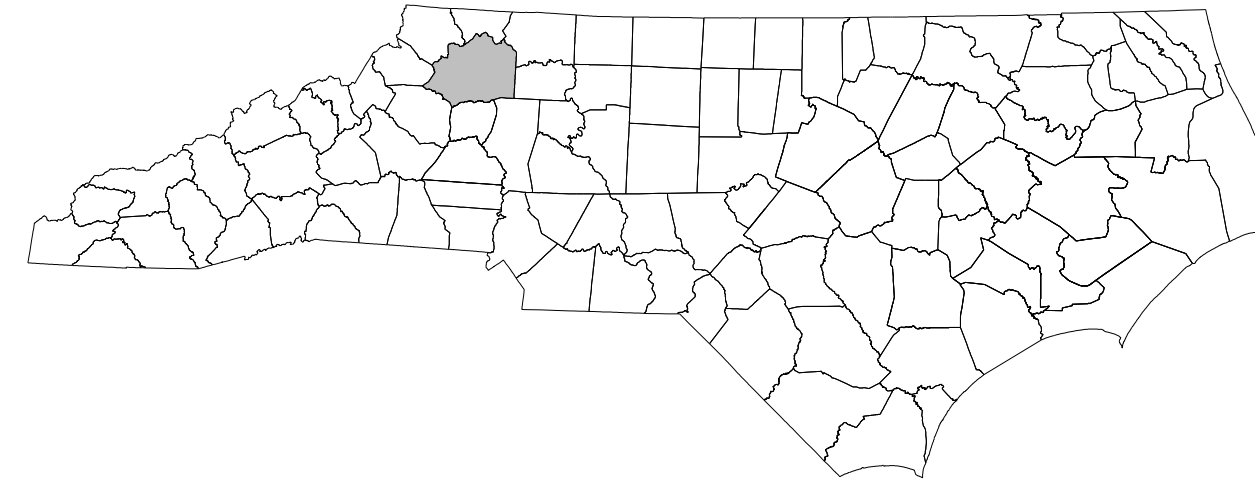

LOCATION - BRIDGE NO 663 OVER EAST PRONG ROARING RIVER ON SR 1002 (TRAPHILL RD)

TYPE OF WORK - GRADING, DRAINAGE, PAVING AND STRUCTURE

INDEX OF SHEETS

SHEET NO.	TITLE
TMP-1	TITLE SHEET, VICINITY MAP, AND INDEX OF SHEETS
TMP-1A	LIST OF APPLICABLE ROADWAY STANDARD DRAWINGS, LEGEND AND MANAGEMENT STRATEGIES
TMP-1B	GENERAL NOTES & LOCAL NOTE
TMP-2	OFF SITE DETOUR ROUTE
TMP-3	TEMPORARY TRAFFIC CONTROL PHASING
TMP-4	TEMPORARY TRAFFIC CONTROL STEP 2 DETAIL
TMP-5	TEMPORARY TRAFFIC CONTROL STEPS 3 & 4 DETAIL
TMP-6	TEMPORARY TRAFFIC CONTROL STEPS 5 THRU 7 DETAIL

SHEET NO.

TMP-1

BR-0125

TIP PROJECT:

**DOCUMENT NOT CONSIDERED FINAL
UNLESS ALL SIGNATURES COMPLETED**

APPROVED: *Kenneth C. Thornevell, Jr., P.E.*
1E991EF27373405

DATE: 11/5/2020

SEAL

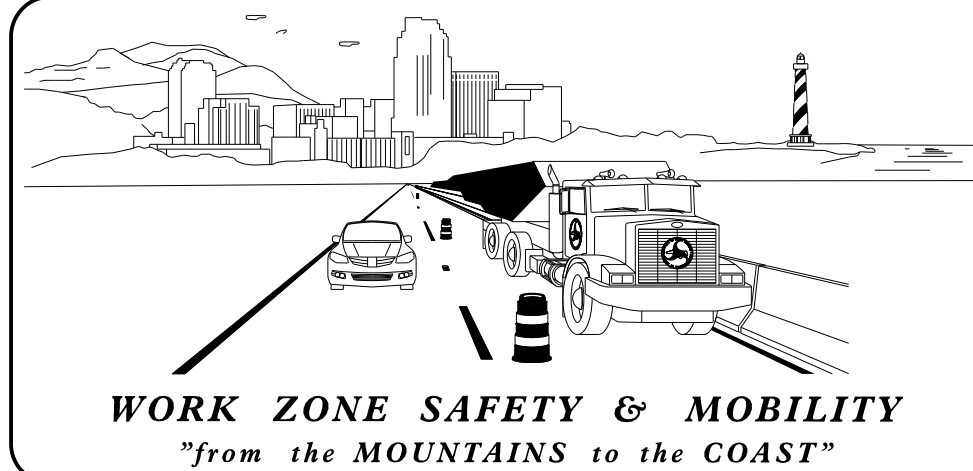

PLANS PREPARED BY:

D. E. RICHARDSON

NCDOT/WZTC

NCDOT CONTACTS:

K. C. THORNEWELL, PE
PROJECT ENGINEER

M. H. STEELMAN
PROJECT DESIGN ENGINEER

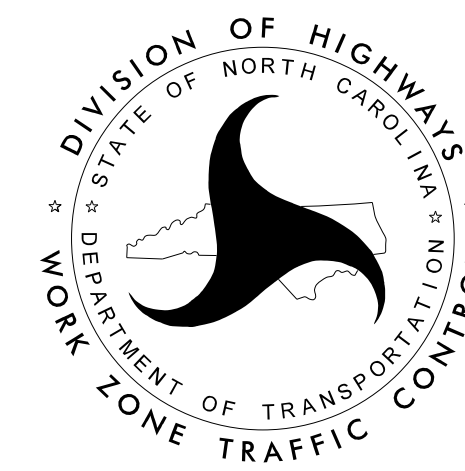

4/7/2020
S:\TMU\WZTC\DesignGroup2\062508\Richardson\BR0125\BR0125_TC_TMP01_tsh.dgn
User:derichardson