

09/08/19

See Sheet 1A For Index of Sheets
See Sheet 1B For Standard Symbology Sheet

STATE OF NORTH CAROLINA
DIVISION OF HIGHWAYS

WILKES COUNTY

LOCATION: BRIDGE #663 OVER EAST PRONG ROARING RIVER ON SR 1002 (TRAPHILL RD)
TYPE OF WORK: GRADING, DRAINAGE, PAVING, & STRUCTURE

STATE	STATE PROJECT REFERENCE NO.	SHEET NO.	TOTAL SHEETS
N.C.	BR-0125	1	
STATE PROJ. NO.	F.A. PROJ. NO.	DESCRIPTION	
48834.1.1		P.E.	
48834.1.1		R.O. UTILITIES	
48834.1.1	2020001	CONSTRUCTION	

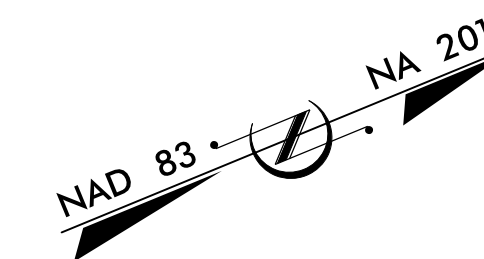
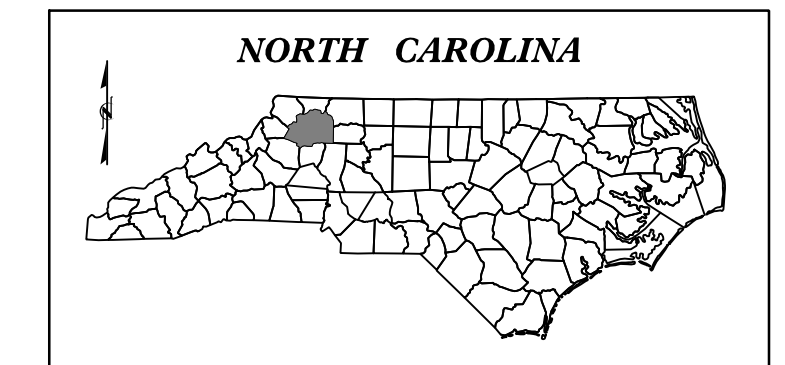

TIP PROJECT: BR-0125

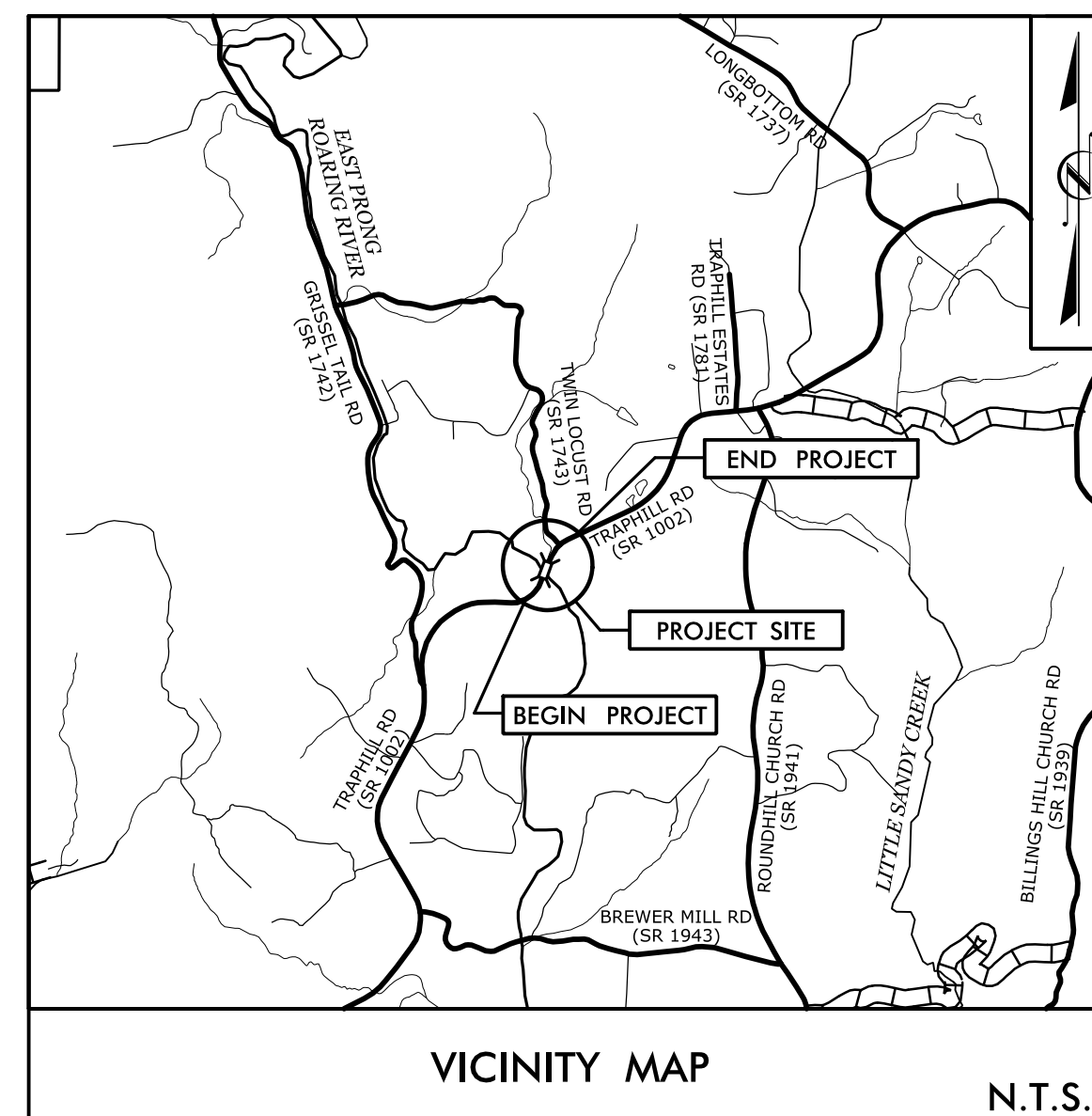

VICINITY MAP

N.T.S.

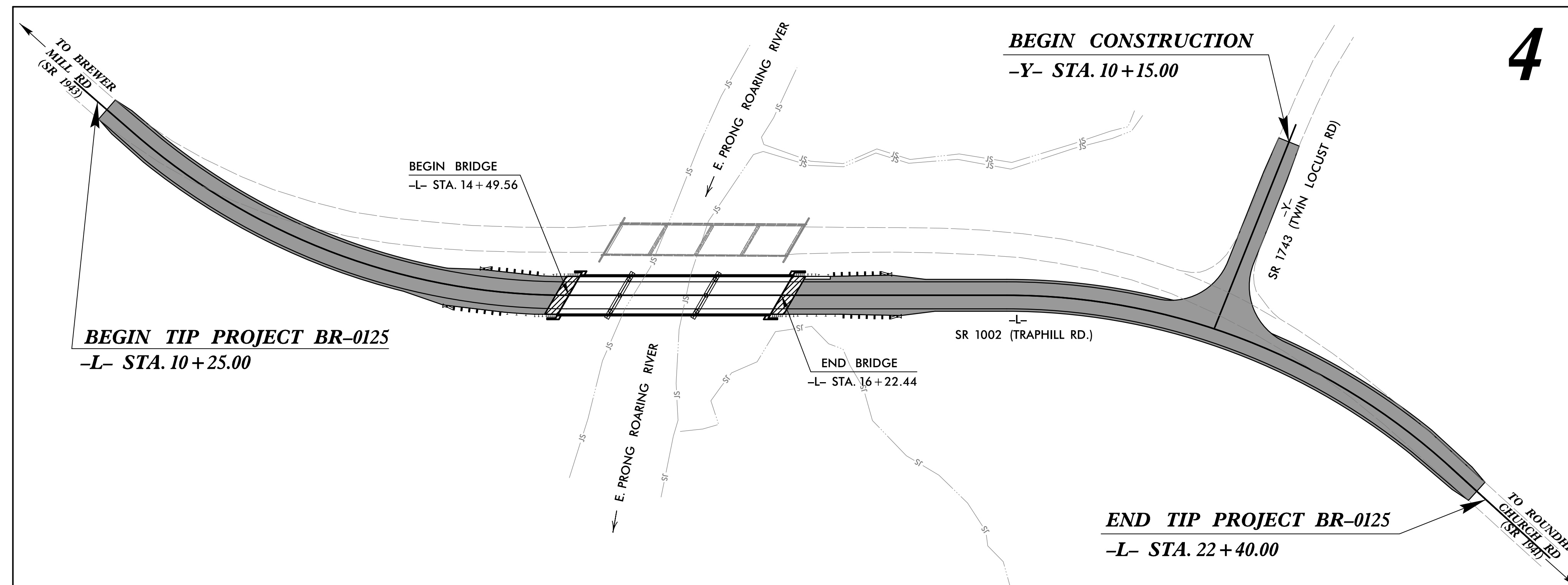

4

DESIGN EXCEPTION APPROVED FOR HORIZONTAL CURVE RADIUS AND VERTICAL CURVE K-VALUE & NIGHTTIME SSD. (11-06-2019)

DOCUMENT NOT CONSIDERED FINAL
UNLESS ALL SIGNATURES COMPLETED

CONTRACT: C204494

GRAPHIC SCALES

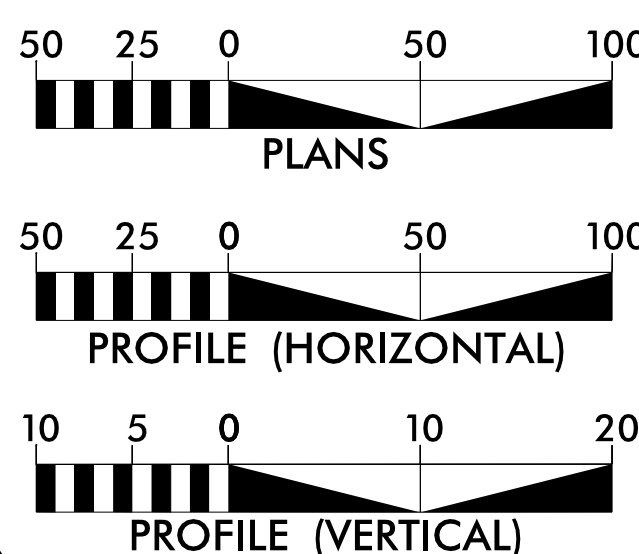

DESIGN DATA

ADT 2016 = 1500
ADT 2040 = 2000
DHV = N/A
D = N/A
T = N/A
V = 55 MPH

FUNC. CLASSIFICATION:
MAJOR COLLECTOR
SUB-REGIONAL TIER

PROJECT LENGTH

LENGTH OF ROADWAY TIP PROJECT BR-0125 = 0.197 MILES
LENGTH OF STRUCTURE TIP PROJECT BR-0125 = 0.033 MILES
TOTAL LENGTH OF TIP PROJECT BR-0125 = 0.230 MILES

NCDOT CONTACT: DAVID STUTTS, PE
Structures Management Unit

PLANS PREPARED FOR THE NCDOT BY:

STV 100 Years
STV Engineers, Inc.
900 West Trade St., Suite 715
Charlotte, NC 28202
NC License Number F-0991

2018 STANDARD SPECIFICATIONS

RIGHT OF WAY DATE:
JANUARY 22, 2020

LETTING DATE:
DECEMBER 15, 2020

J. ADAM FREEMAN, PE
PROJECT ENGINEER

NARONG PHAL, PE
PROJECT DESIGNER

HYDRAULICS ENGINEER

11/10/2020

DocuSigned by:
Edward J. Vance
0264F2B1B3DF494...
EDWARD J. VANCE
P.E.

ROADWAY DESIGN ENGINEER

11/10/2020

DocuSigned by:
Joseph A. Freeman
175E020B9B584424...
JOSEPH A. FREEMAN
P.E.

