

09/26/19

TIP PROJECT: BR-0124

CONTRACT: C204486

STATE OF NORTH CAROLINA
DIVISION OF HIGHWAYS

WILKES COUNTY

LOCATION: BRIDGE #166 OVER WEST PRONG ROARING RIVER ON SR 1745 (SHUMATE MOUNTAIN RD.)
TYPE OF WORK: GRADING, DRAINAGE, PAVING, & STRUCTURE

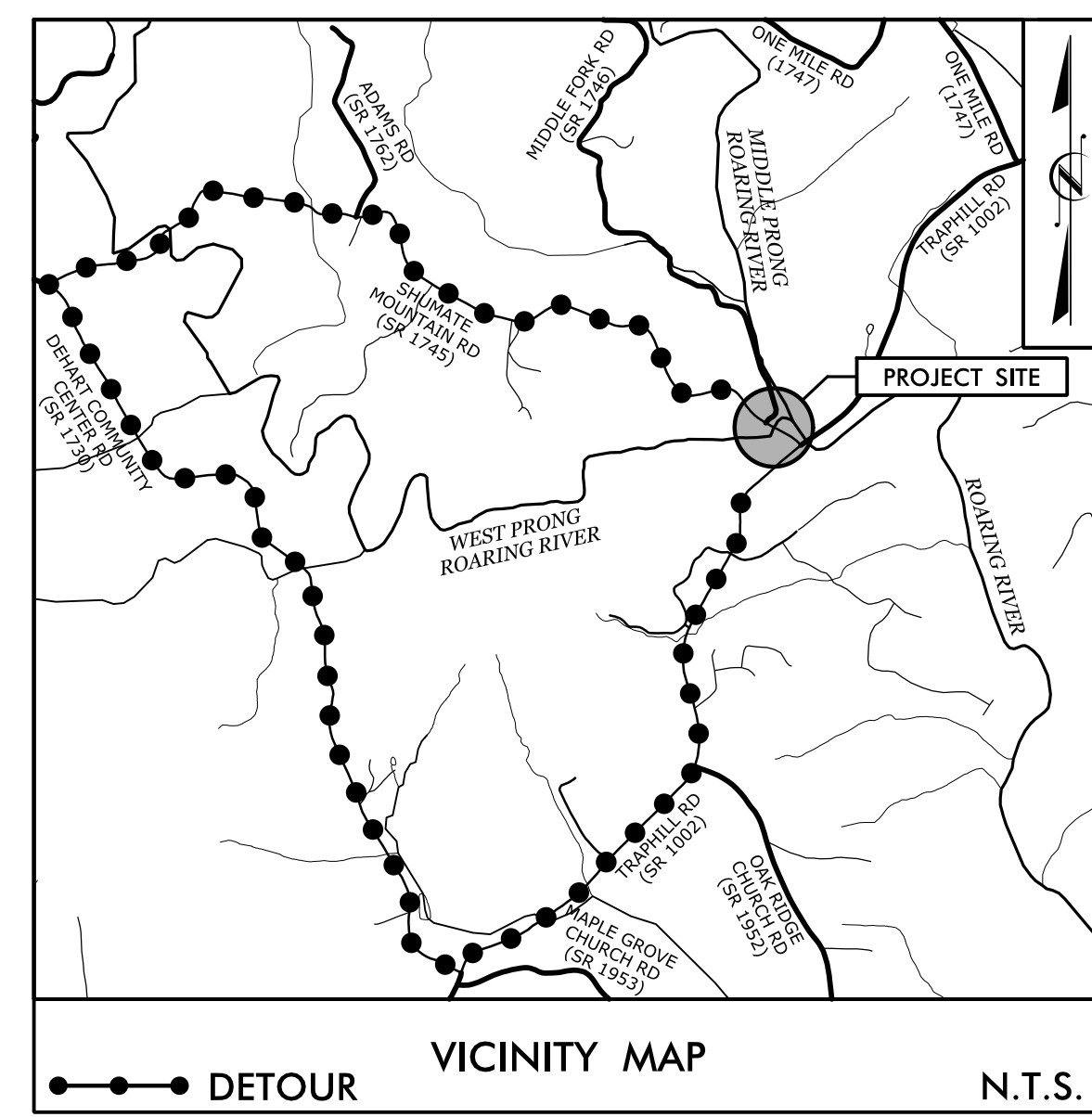

STATE	STATE PROJECT REFERENCE NO.	SHEET NO.	TOTAL SHEETS
N.C.	BR-0124		
STATE PROJ. NO.	F.A. PROJ. NO.	DESCRIPTION	
48833.1.1		P.E.	
48833.2.1		R.O. UTILITIES	
48833.3.1	2020001	CONSTRUCTION	

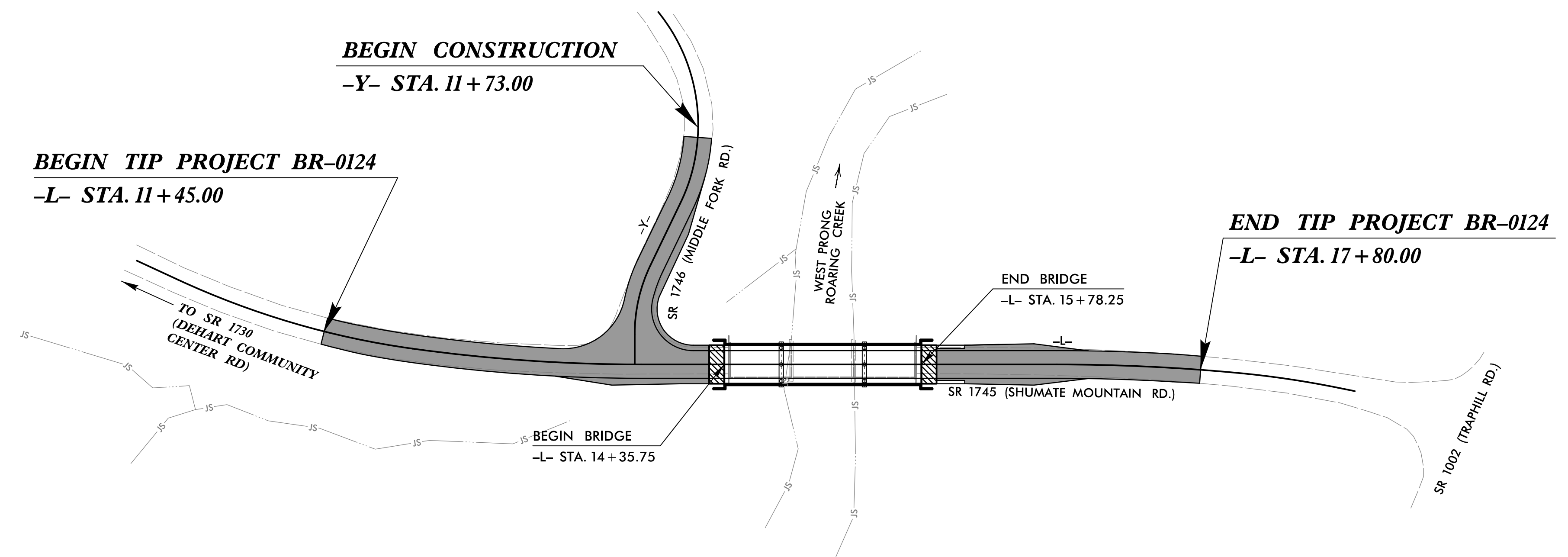
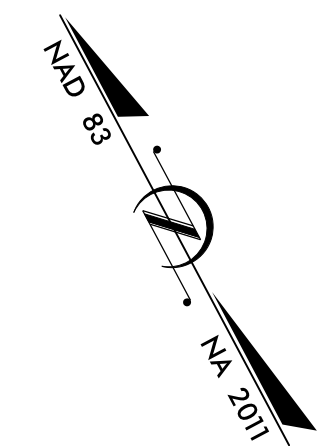
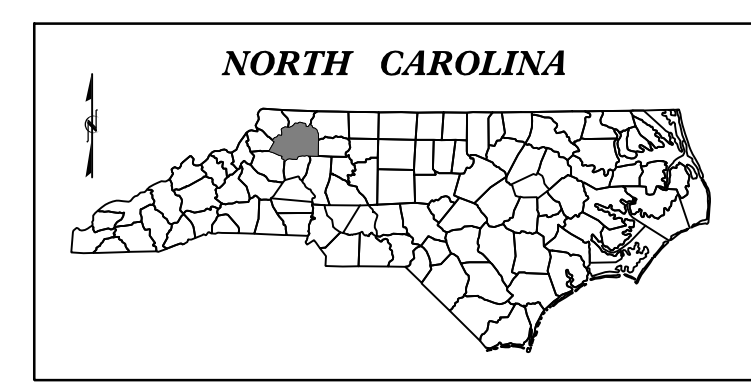

STRUCTURE

**DOCUMENT NOT CONSIDERED FINAL
UNLESS ALL SIGNATURES COMPLETED**

DESIGN DATA

ADT 2020 = 548
ADT 2040 = 940
DHV = N/A
D = N/A
T = N/A
V = 45 MPH

FUNC. CLASSIFICATION:
RURAL, LOCAL

SUB REGIONAL TIER

PROJECT LENGTH

LENGTH OF ROADWAY TIP PROJECT BR-0124 = 0.093 MILES
LENGTH OF STRUCTURE TIP PROJECT BR-0124 = 0.027 MILES
TOTAL LENGTH OF TIP PROJECT BR-0124 = 0.120 MILES

NCDOT CONTACT: DAVID STUTTS, PE
Structures Management Unit

PLANS PREPARED FOR THE NCDOT BY:

STV 100 Years
STV Engineers, Inc.
900 West Trade St., Suite 715
Charlotte, NC 28202
NC License Number F-0991

2018 STANDARD SPECIFICATIONS

RIGHT OF WAY DATE:
DECEMBER 19, 2019

LETTING DATE:
DECEMBER 15, 2020

J. WESLEY JONES, PE
PROJECT ENGINEER

LOGAN A. HEDRICK, EI
PROJECT DESIGNER

STRUCTURAL ENGINEER

J. WESLEY JONES
ENGINEER
SEAL
038640
10/23/2020

SIGNATURE: _____ P.E.

