

\*\* REFER TO RSD 1101.03, SHEETS 1 & 2, FOR WORK ZONE SIGN SPACING, REQUIRED ALONG SHUMATE MOUNTAIN RD AND MIDDLE FORK RD \*\*

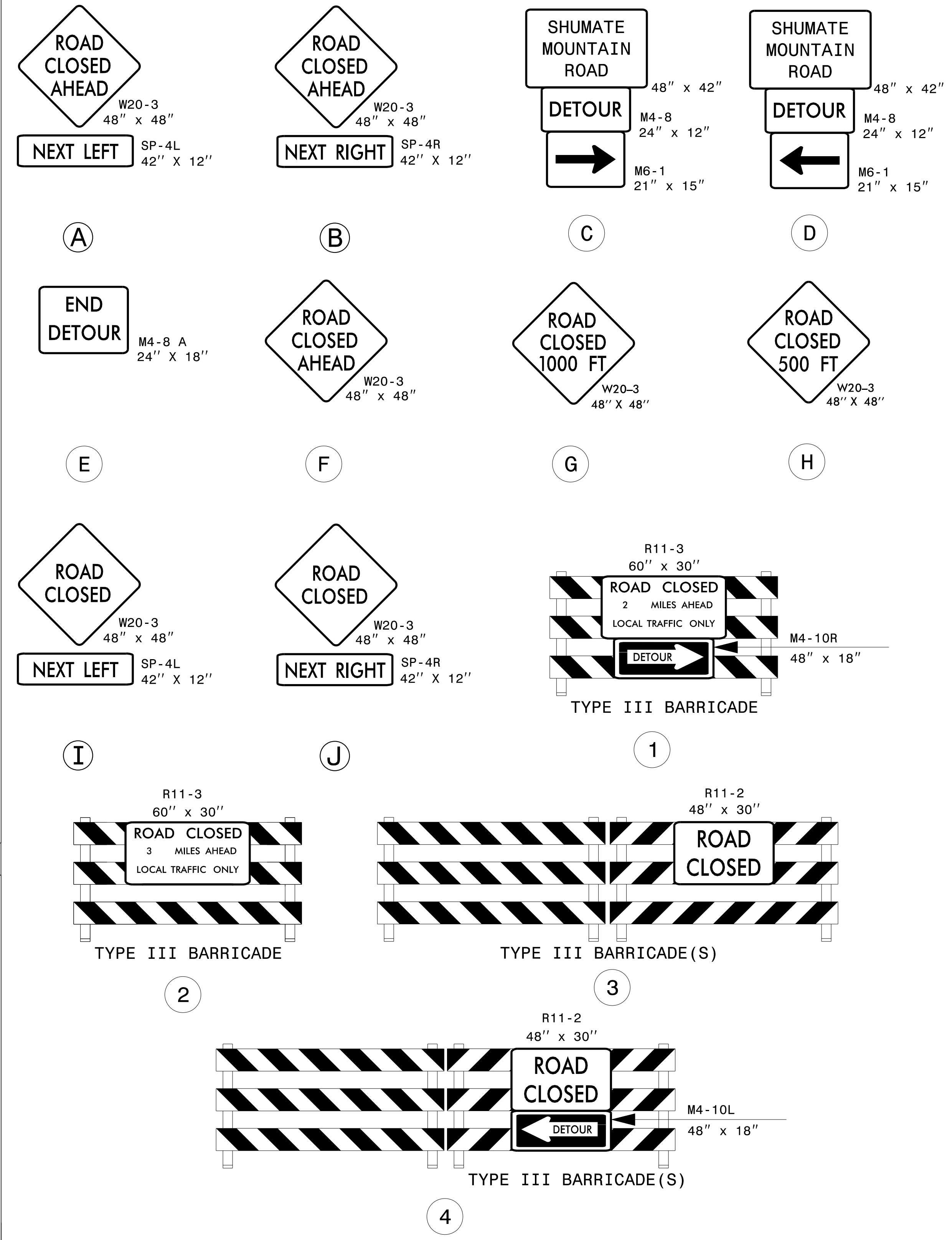

11/5/2020 pw:\ncdot-pw\bentley.com\ncdot-pw-01\Documents\BR-0124\Work Zone Traffic Control\CADD\BR-0124-TC-TMP-02 User:mackillu

APPROVED: DATE: 11/9/2020 SEAL:		<b>OFFSITE DETOUR ROUTE AND ROAD CLOSURE</b>
<b>DOCUMENT NOT CONSIDERED FINAL UNLESS ALL SIGNATURES COMPLETED</b>		