

Sampson County

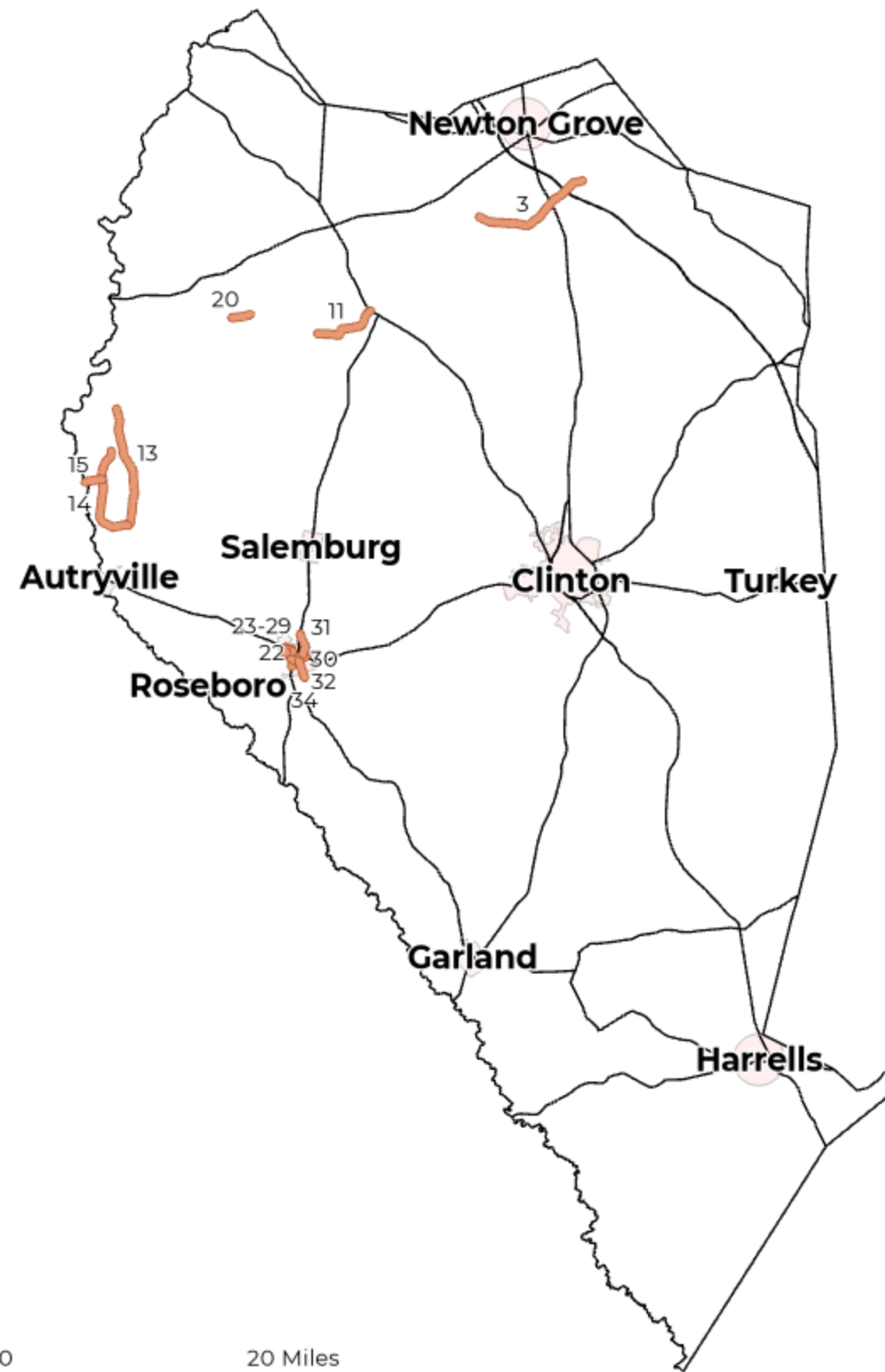
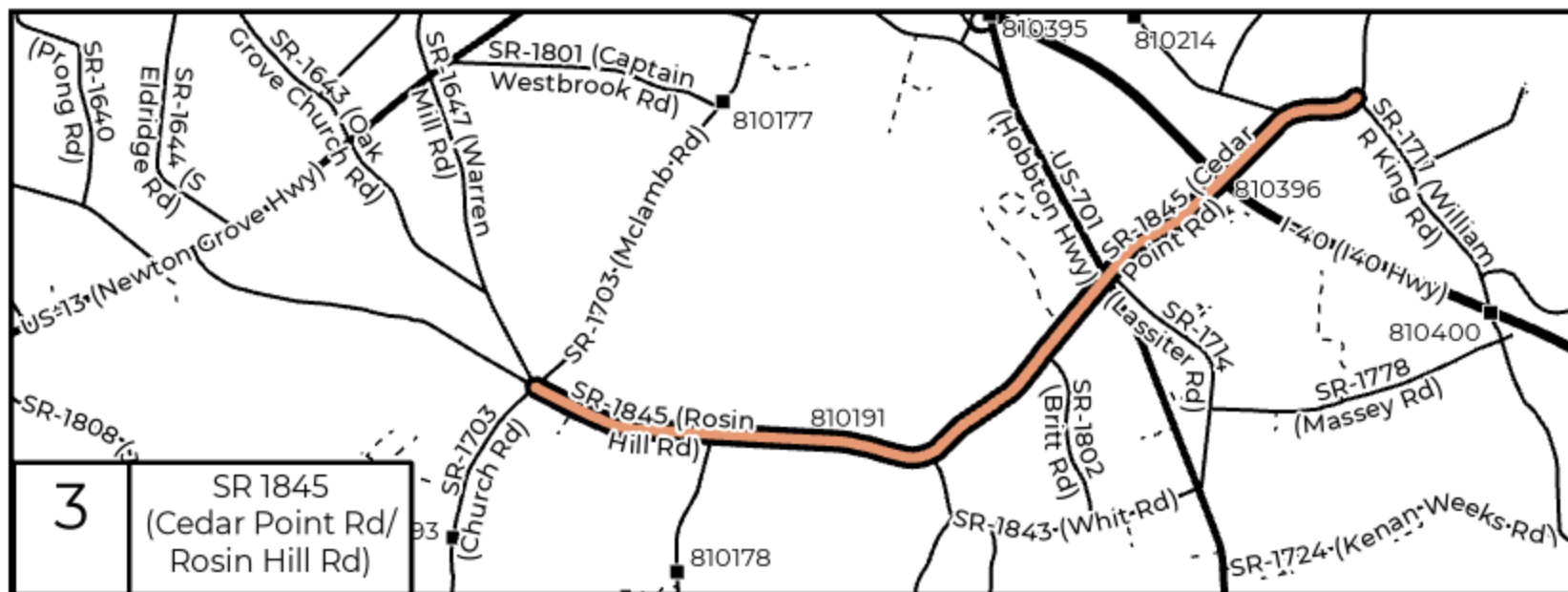
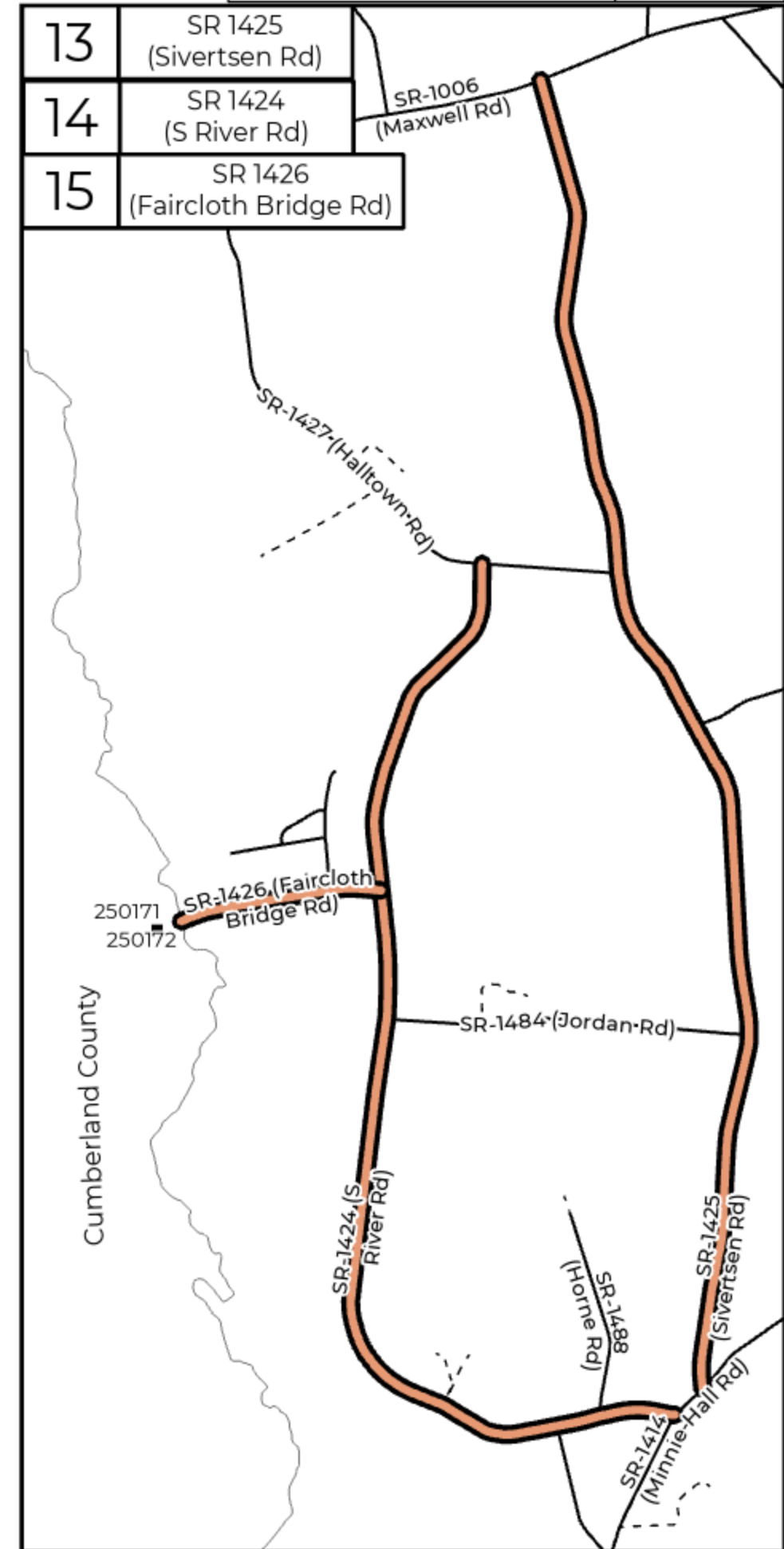
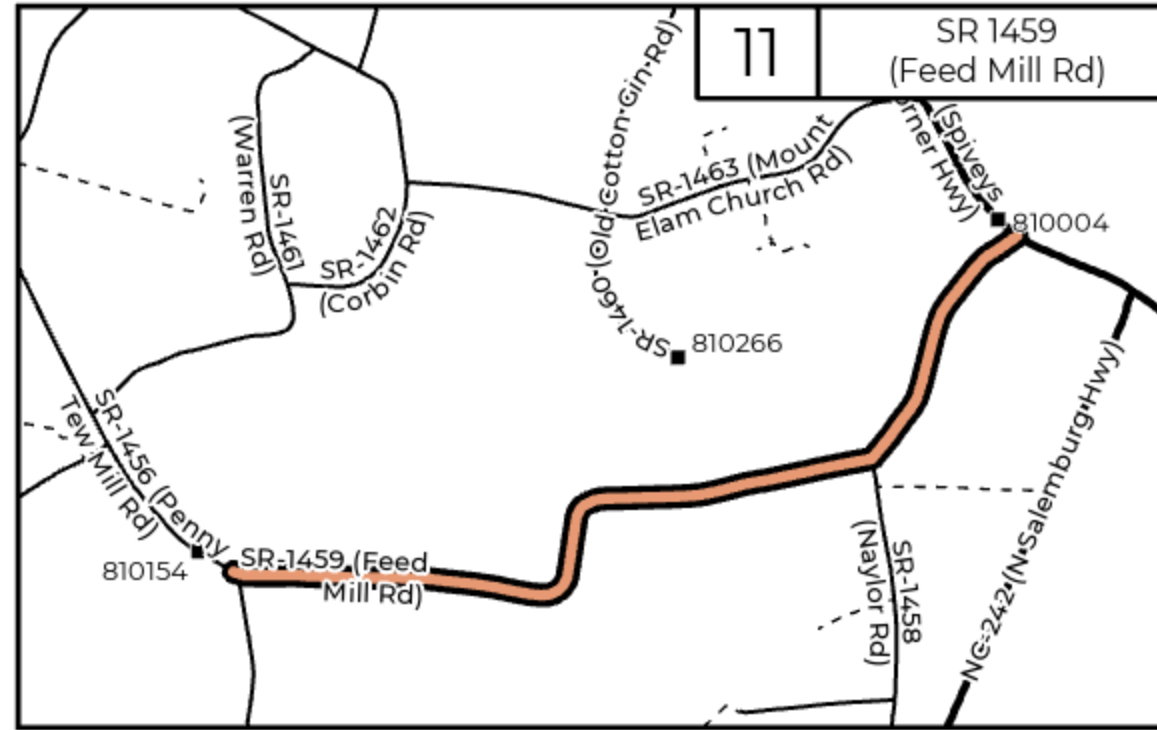
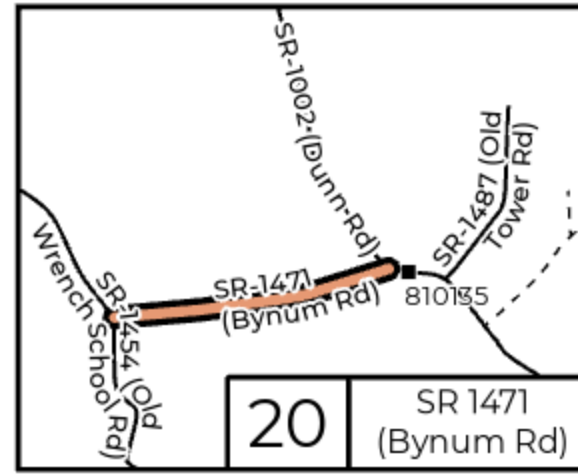
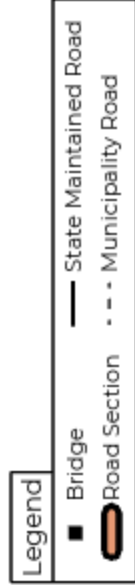
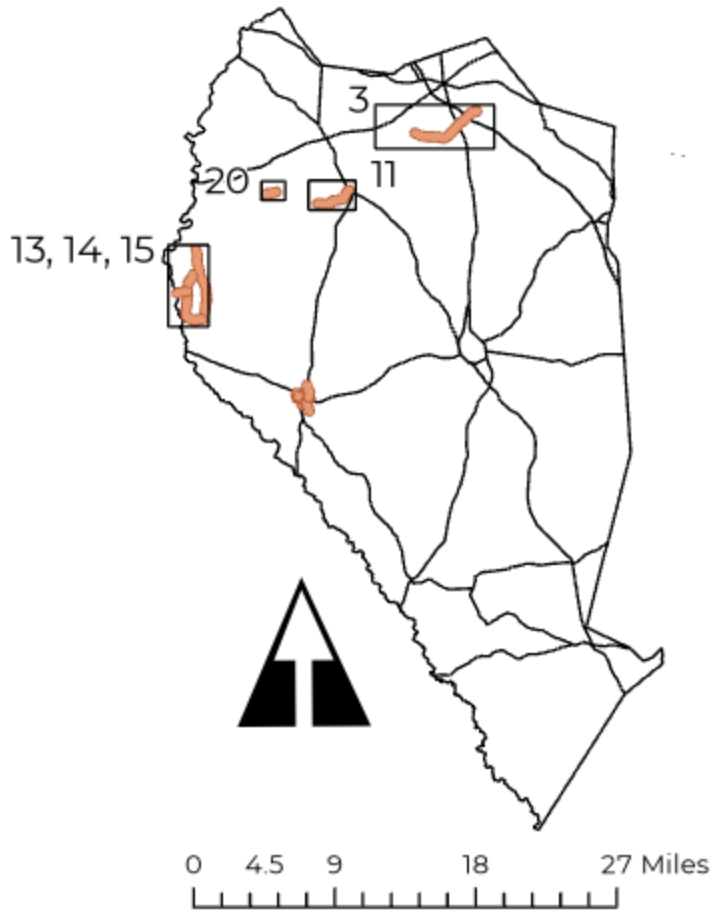

Table of Contents

Maps	Sheet No.
3, 11, 13-15, and 20	3
22-29, 30-32, and 34	4

Sampson County 3, 11, 13-15, and 20



Sampson County 22-29, 30-32, and 34

PROJECT REFERENCE NO. 2021CPT.03.11.20821, ETC.	SHEET NO. 3
----------------------------------------------------	----------------

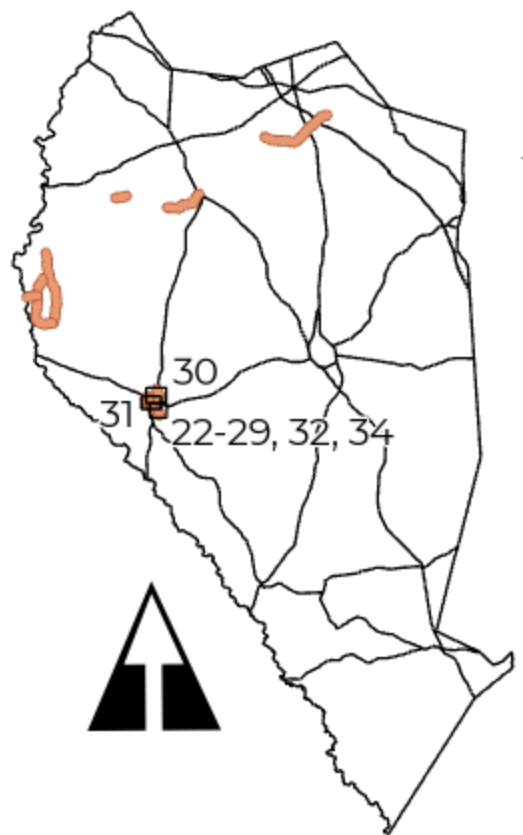

Legend

- Bridge
- State Maintained Road
- - - Municipality Road
- ▭ Road Section

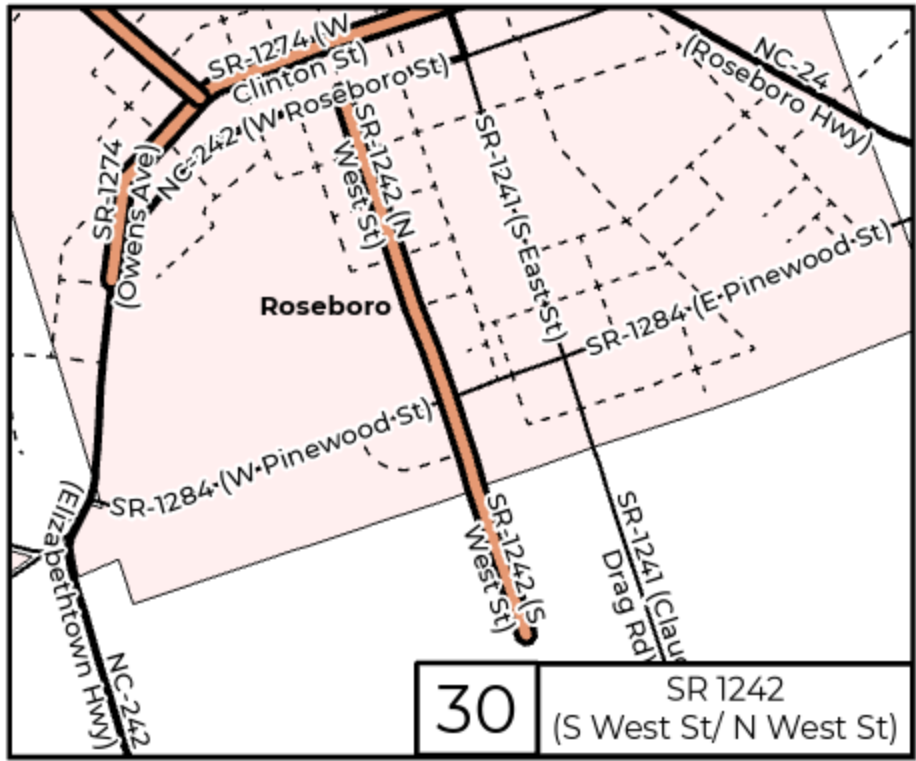

30	SR 1242 (S West St/ N West St)
----	-----------------------------------

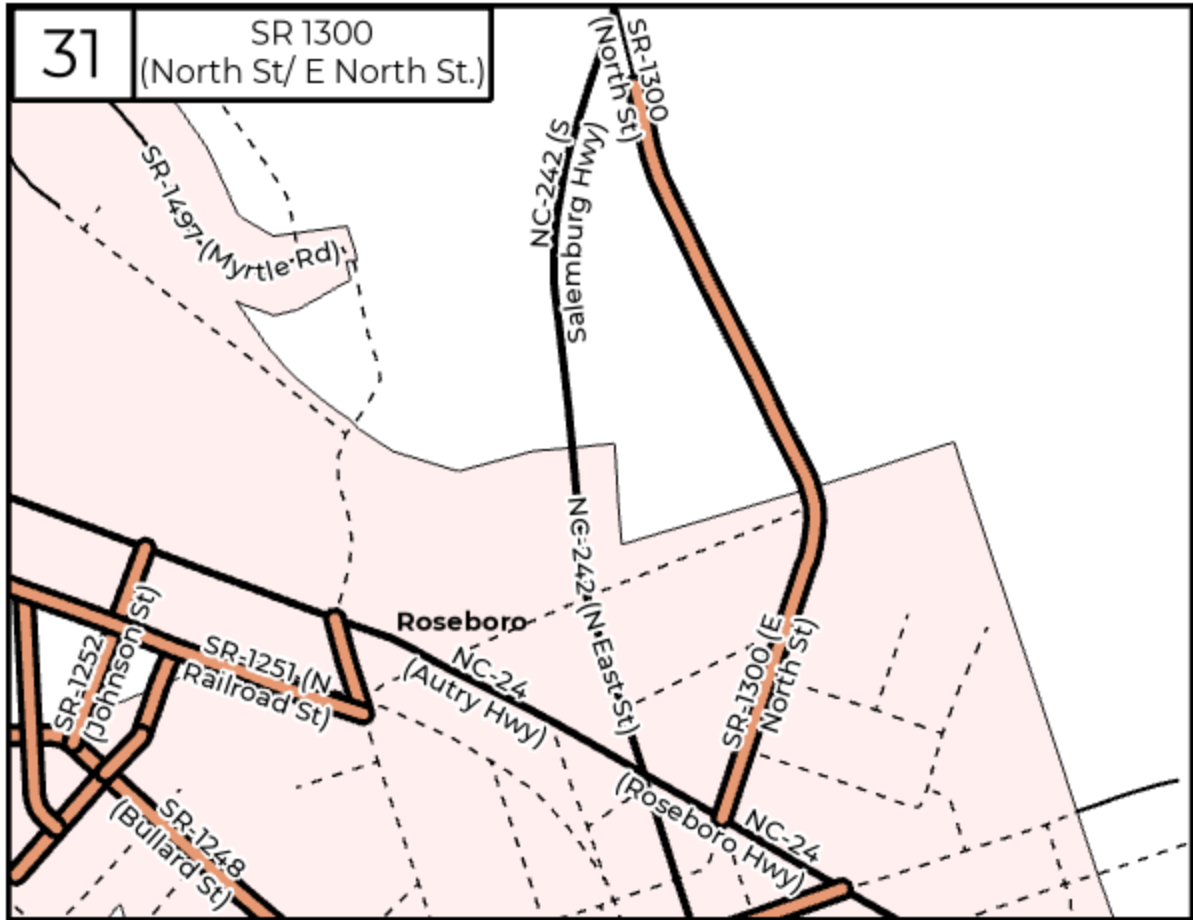

31	SR 1300 (North St/ E North St.)
----	------------------------------------

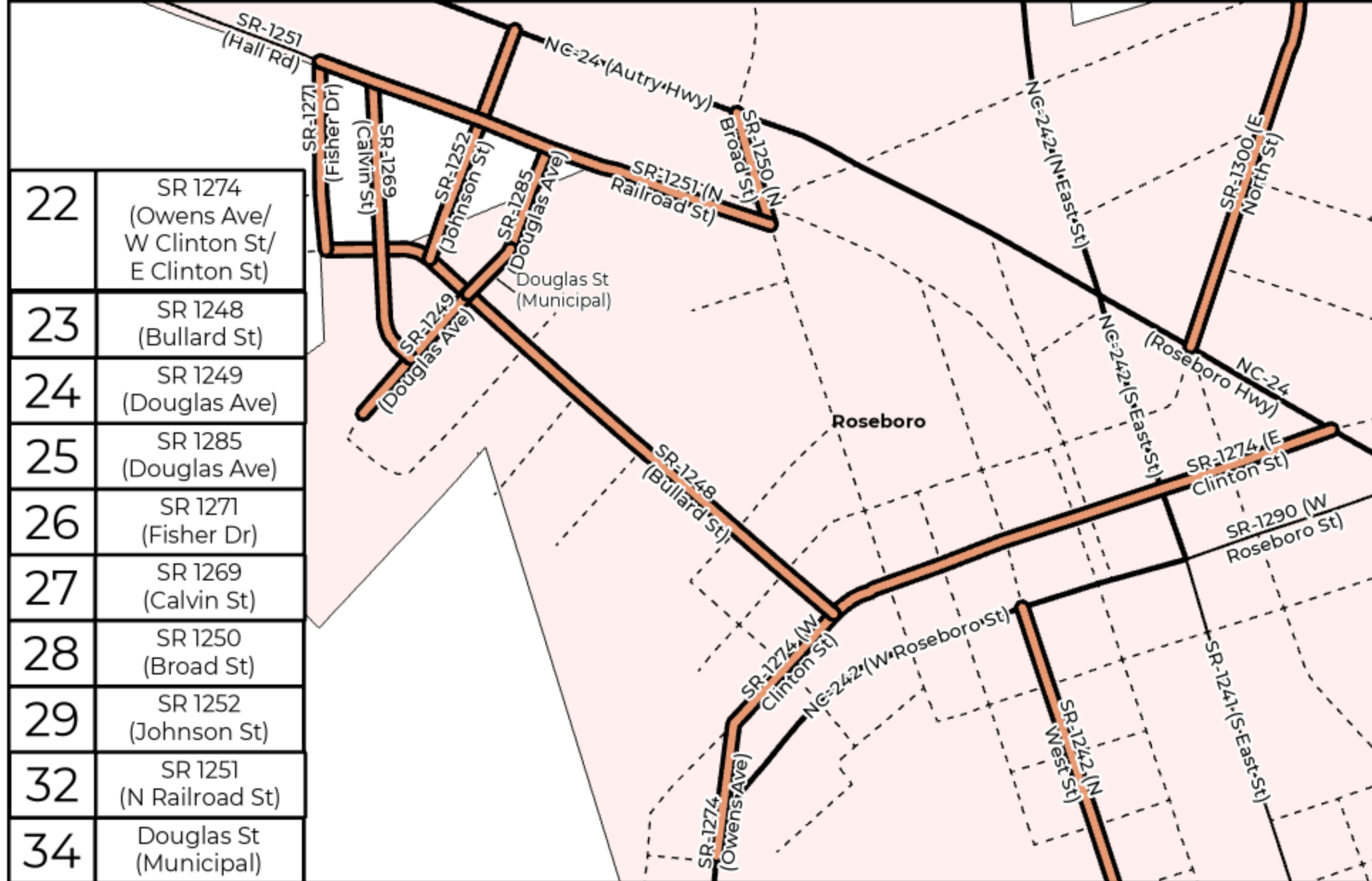

22	SR 1274 (Owens Ave/ W Clinton St/ E Clinton St)
23	SR 1248 (Bullard St)
24	SR 1249 (Douglas Ave)
25	SR 1285 (Douglas Ave)
26	SR 1271 (Fisher Dr)
27	SR 1269 (Calvin St)
28	SR 1250 (Broad St)
29	SR 1252 (Johnson St)
32	SR 1251 (N Railroad St)
34	Douglas St (Municipal)

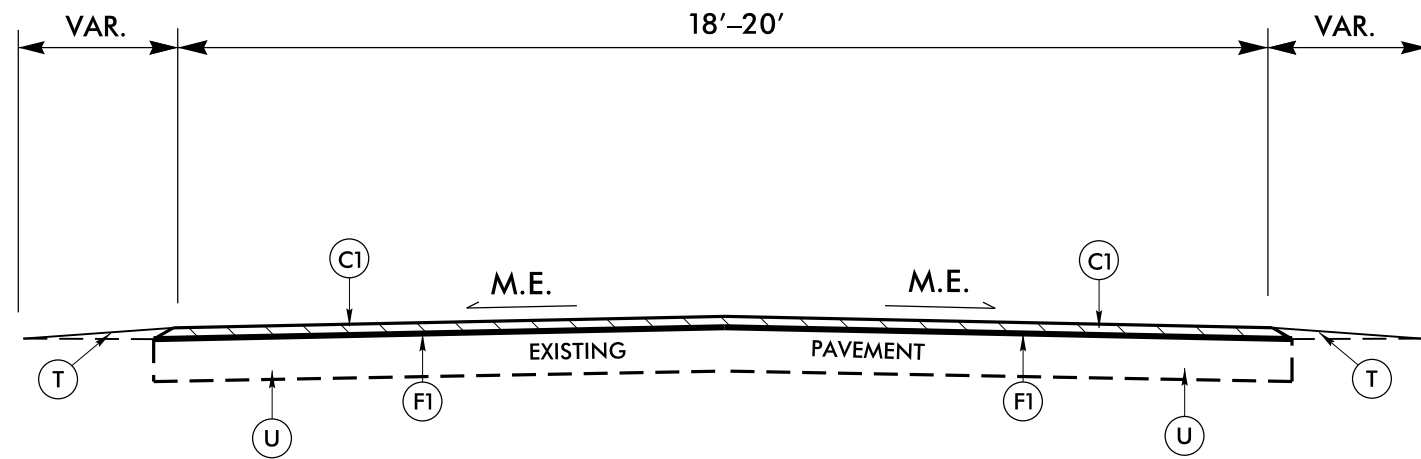

TYPICAL SECTION NO. 1

MAP NO. 3
SR 1845 (CEDAR POINT RD./ROSIN HILL RD.)
MP 0.00 – MP 0.33
MP 0.37 – MP 3.33
MP 3.36 – MP 4.72
NO ASPHALT WORK BRIDGE #396 (MP 0.78 – MP 0.82)
SEE ALSO TYPICAL NO. 2 & NO. 3

MAP NO. 11
SR 1459 (FEED MILL RD.)
MP 0.00 – MP 2.56

MAP NO. 13
SR 1425 (SIVERTSEN RD.)
MP 0.00 – MP 4.56

MAP NO. 14
SR 1424 (SOUTH RIVER RD.)
MP 0.00 – MP 3.92

MAP NO. 15
SR 1426 (FAIRCLOTH BRIDGE RD.)
MP 0.00 – MP 0.68

VI NOTES: MAP NO. 3 MILL 1½" FOR FLOODPLAIN FROM MP 3.05 - MP 3.60.

MILL A SINGLE LANE AND PAVE BACK BY THE END OF EACH WORK DAY.

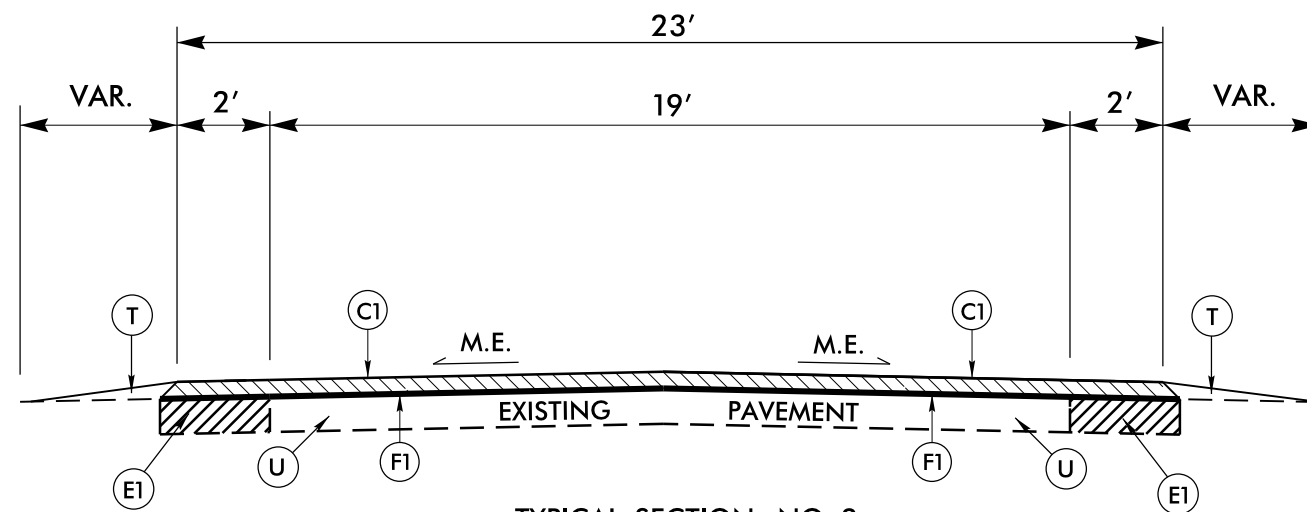

TYPICAL SECTION NO. 2

MAP NO. 3
SR 1845 (CEDAR POINT RD./ROSIN HILL RD.)
MP 0.33 – MP 0.37
SEE ALSO TYPICAL NO. 1 & NO. 3
SEE ALSO ROADWAY PLAN SHEET NO. 6

NOTES: INTERSECTION WIDENING - STATE FORCES WILL LOCATE RADIAL WIDENING.

PAVEMENT SCHEDULE	
C1	PROP. APPROX. 1½" DEPTH ASPHALT CONCRETE SURFACE COURSE, TYPE S9.5B, AT AN AVERAGE RATE OF 165 LBS. PER SQ.YD.
C2	PROP. APPROX. 1" DEPTH ASPHALT CONCRETE SURFACE COURSE, TYPE S9.5B, AT AN AVERAGE RATE OF 110 LBS. PER SQ.YD.
C3	PROP. APPROX. 1" DEPTH ASPHALT CONCRETE SURFACE COURSE, TYPE S4.75A, AT AN AVERAGE RATE OF 100 LBS. PER SQ.YD.
E1	PROP. APPROX. 4" DEPTH ASPHALT CONCRETE BASE COURSE, TYPE B25.0C, AT AN AVERAGE RATE OF 456 LBS. PER SQ.YD.
F1	ASPHALT SERVICE TREATMENT - #67 MAT COAT (GRANITE) STONE
R1	EXISTING CONCRETE BRIDGE RAIL
T	EARTH MATERIAL (SHOULDER RECONSTRUCTION)
U	EXISTING PAVEMENT
V1	MILLING ASPHALT PAVEMENT, 1.5" DEPTH
V2	MILLING ASPHALT PAVEMENT, 1" DEPTH

PAVEMENT EDGE SLOPES ARE 1:1, EXCEPT FINAL SURFACE COURSE. SEE SHOULDER WEDGE DETAIL.

REVISIONS

8/17/99

Resurfacing\SAMPSON\PALEIGH REVISIONS\NEW TYPICALS\Sampson B - Typical.s.dgn

27-OCT-2020 15:12
S:\Division\Resurfacing\Resurfacing_Data\2021

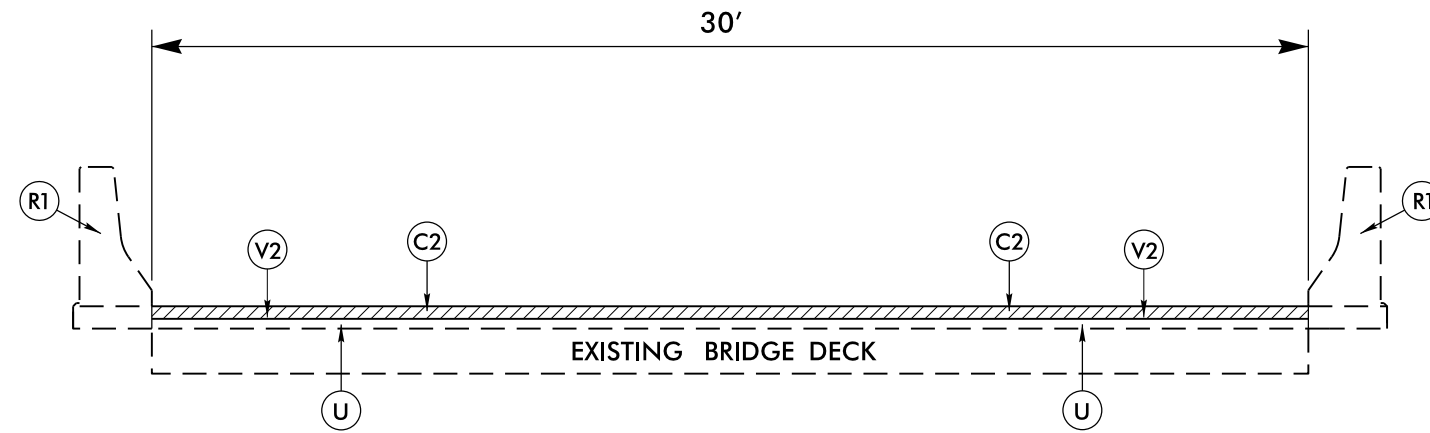

TYPICAL SECTION NO. 3

NOTES: MILL A SINGLE LANE AND PAVE BACK BY THE END OF EACH WORK DAY

MAP NO. 3
SR 1845 (CEDAR POINT RD./ROSIN HILL RD.)
SAMPSON BRIDGE #191
MP 3.33 – MP 3.36
SEE ALSO TYPICAL NO. 1 & NO. 2

PAVEMENT SCHEDULE	
C2	1" S9.5B
C3	1" S4.75A
R1	EXISTING CONCRETE BRIDGE RAIL
U	EXISTING PAVEMENT
V2	MILLING 1" DEPTH

PAVEMENT EDGE SLOPES ARE 1:1, EXCEPT FINAL SURFACE COURSE. SEE SHOULDER WEDGE DETAIL.

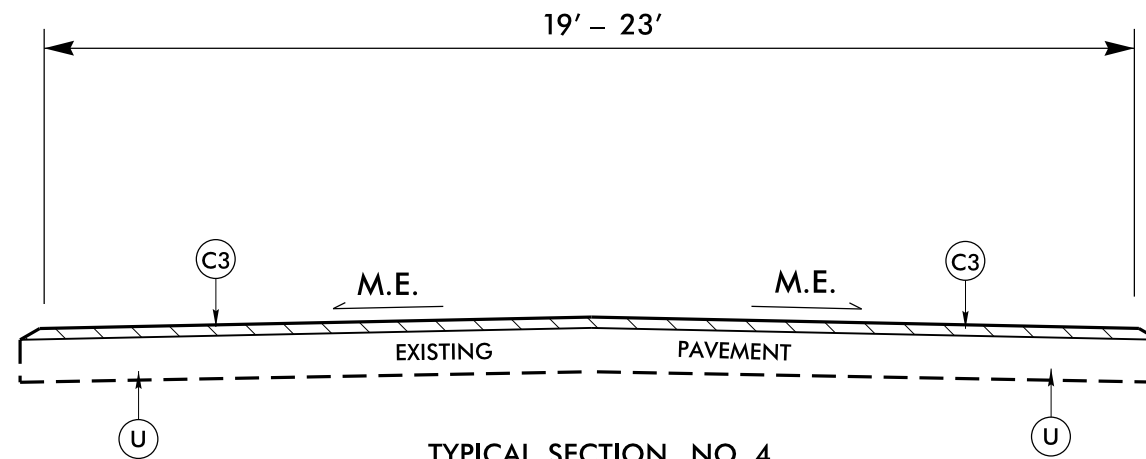

TYPICAL SECTION NO. 4

MAP NO. 20
SR 1471 (BYNUM RD.)
MP 0.00 – MP 0.72

MAP NO. 24
SR 1249 (DOUGLAS AVE.)
MP 0.00 – MP 0.15

MAP NO. 27
SR 1269 (CALVIN ST.)
MP 0.00 – MP 0.26

MAP NO. 30
SR 1242 (S. WEST ST./N. WEST ST.)
MP 0.00 – MP 0.69

MAP NO. 34
DOUGLAS ST. (MUNICIPAL ROSEBORO)
FROM 0.06 MILES SW. OF SR 1285 (DOUGLAS AVE.)
TO SR 1285 (DOUGLAS AVE.)

MAP NO. 22
SR 1274 (OWENS AVE /
E. CLINTON ST./W. CLINTON ST.)
MP 0.00 – MP 0.72

MAP NO. 25
SR 1285 (DOUGLAS AVE.)
MP 0.00 – MP 0.10

MAP NO. 28
SR 1250 (BROAD ST.)
MP 0.00 – MP 0.11

MAP NO. 31
SR 1300 (NORTH ST./E. NORTH ST.)
MP 0.00 – MP 0.81

MAP NO. 23
SR 1248 (BULLARD ST.)
MP 0.00 – MP 0.58

MAP NO. 26
SR 1271 (FISHER DR.)
MP 0.00 – MP 0.17

MAP NO. 29
SR 1252 (JOHNSON ST.)
MP 0.00 – MP 0.22

MAP NO. 32
SR 1251 (N. RAILROAD ST.)
MP 1.35 – MP 1.79

REVISIONS

8/17/99

Resurfacing\SAMPSON\RALEIGH_REVISIONS\NEW_TYPICAL\S\Sampson_B - Typical.dgn

27-OCT-2020 15:13
S:\Division\Resurfacing\Resurfacing_Data\2021

**MAP 3:
SR 1845 (CEDAR POINT RD.)
INTERSECTION WIDENING**

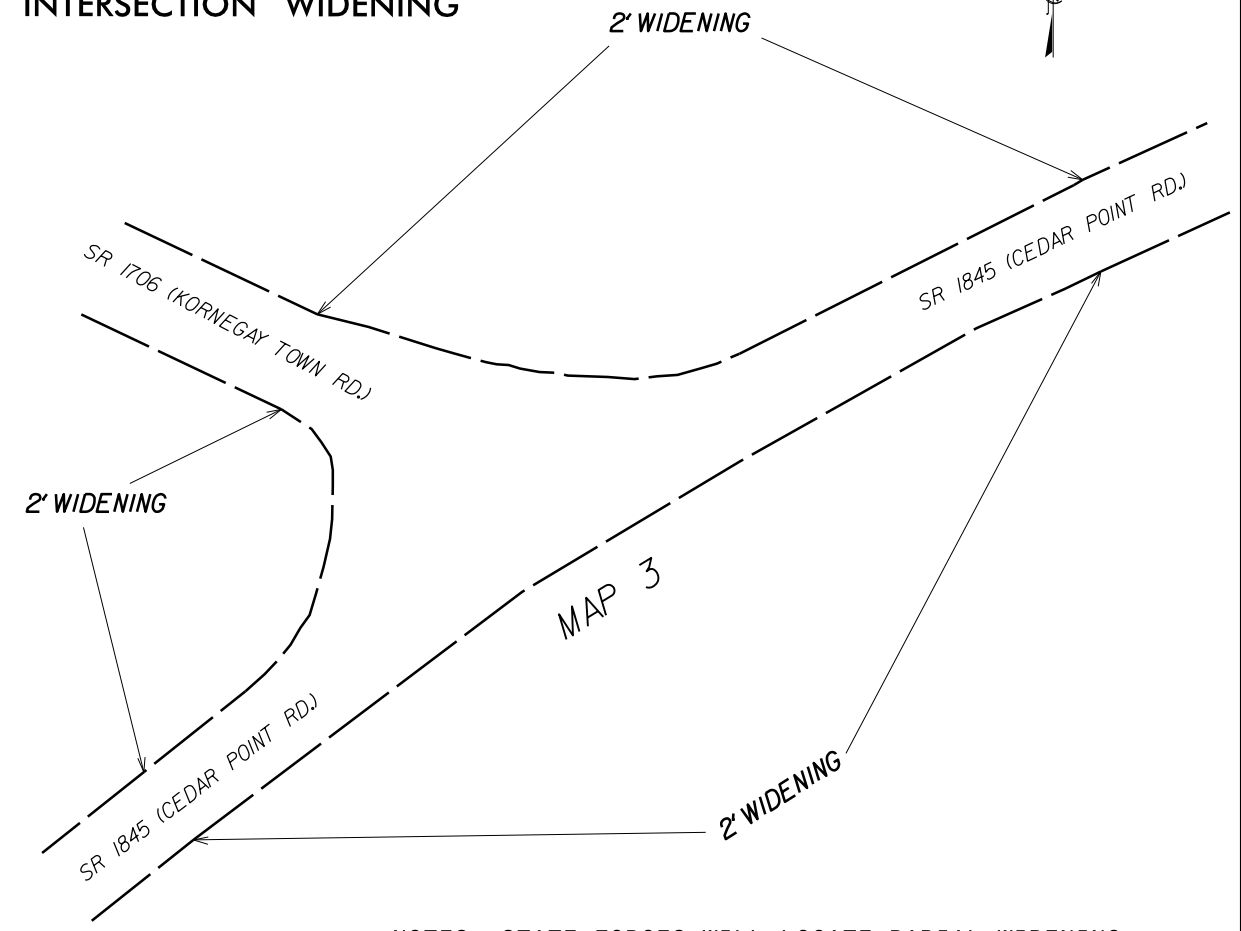

NOTES: STATE FORCES WILL LOCATE RADIAL WIDENING.

MAP N.T.S.

**MAP 3:
SR 1845 (CEDAR POINT RD.)
MP 0.33 – MP 0.37
SEE ALSO TYPICAL NO. 2**

2018 ROADWAY ENGLISH STANDARD DRAWINGS EFF.01-16-2018
REV.

The following Roadway Standards as appear in "Roadway Standard Drawings" Highway Design Branch – N.C. Department of Transportation – Raleigh, N.C., Dated January, 2018 are applicable to this project and by reference hereby are considered a part of these plans:

STD.NO.	TITLE
DIVISION 12	PVMT MARKING, MARKERS AND DELINEATION
1205.08	Pavement Markings – Symbols & Word Messages

REVISIONS

28-OCT-2020 10:01
 S:\Division of Resurfacing\Resurfacing Data\2021\Resurfacing\SAMPSON\RALEIGH_REVISIONS\NEW_TYPICALS\Sampson_B - Typical.s.dgn
 \$\$\$USERNAME\$\$\$

DETAILS OF PATCHING EXISTING PAVEMENT PRIOR TO RESURFACING FOR FULL DEPTH AND MILLING

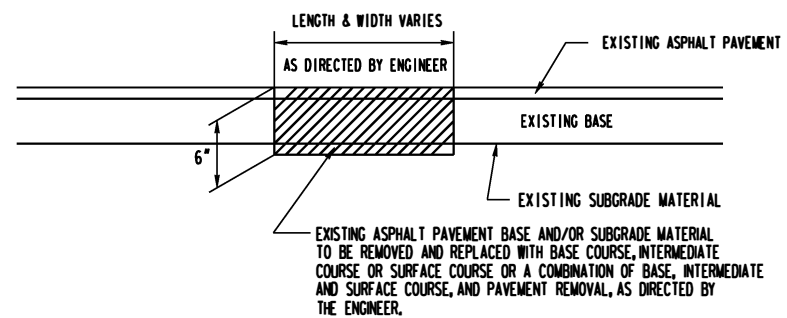

DETAIL NO. 1

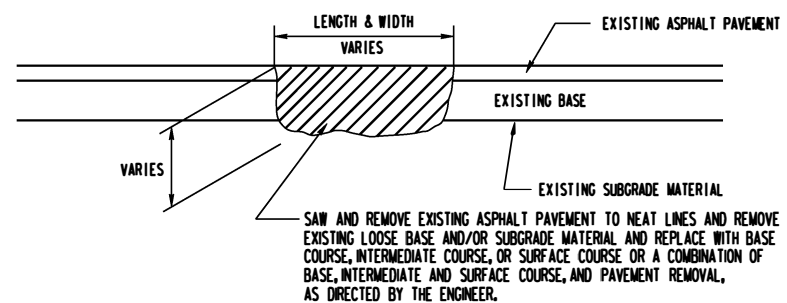

DETAIL NO. 2

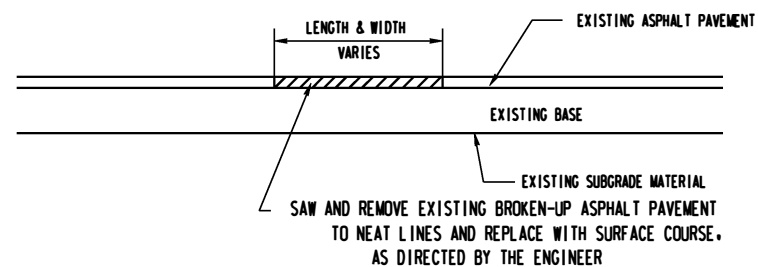

DETAIL NO. 3

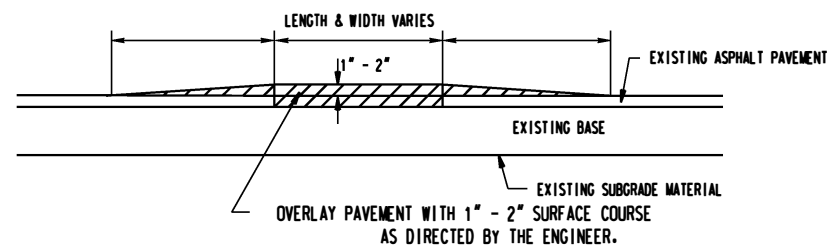

DETAIL NO. 4

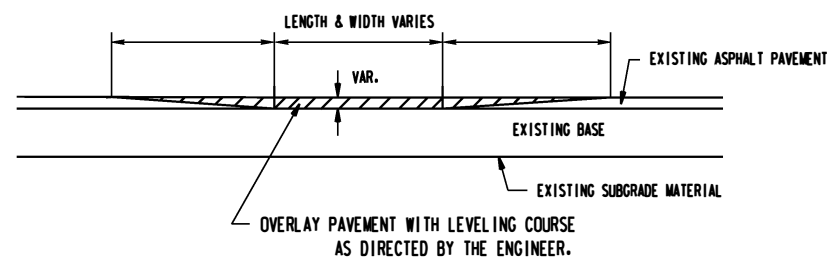

DETAIL NO. 5

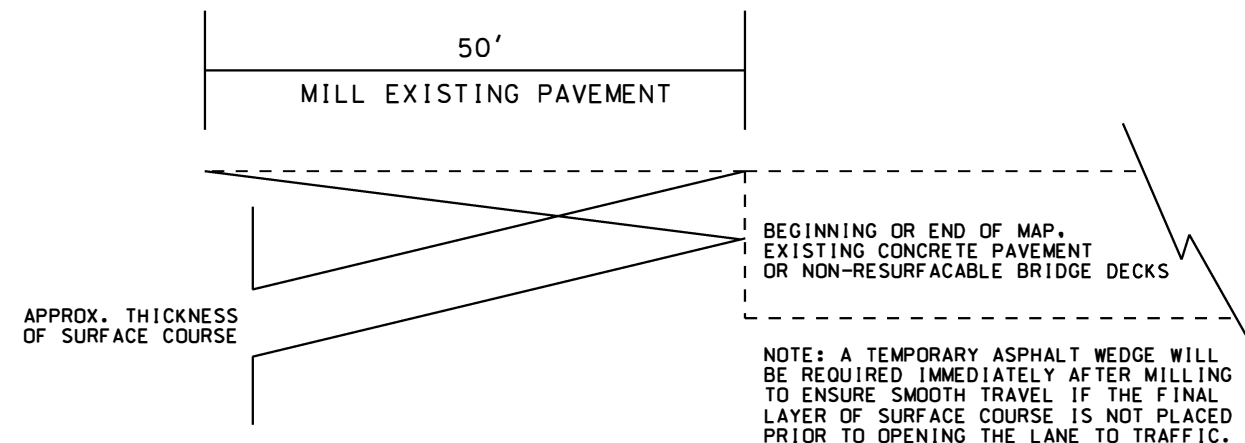

DETAIL FOR MILLING & INCIDENTAL MILLING PAY ITEMS:
MAY BE USED AT THE BEGINNING & END OF MAPS
AND AT APPROACH & TRAILING ENDS OF BRIDGES

5/14/19 28-SEP-2018 12:50 c:\pwworkspace\2021\2021CPT.03.11.20821\2021CPT.03.11.20821.dwg

STATE OF NORTH CAROLINA
 DEPT. OF TRANSPORTATION
 DIVISION OF HIGHWAYS
 RALEIGH, N.C.

ENGLISH DETAIL DRAWING FOR
MANHOLE AND VALVE BOX ADJUSTMENTS
 SHEET 1 OF 1
840D55

GENERAL NOTES:

1. USE RAPID SET GROUT, MORTAR, OR CONCRETE THAT WILL TAKE FULL SET AND BECOME LOAD BEARING WITHIN SIXTY MINUTES OF PLACEMENT WITH A MINIMUM COMPRESSIVE STRENGTH OF 4000 PSI.
2. REMOVE ALL FAULTY EXISTING BRICKWORK AND REPLACE WITH NEW BRICK MASONRY.
3. SHEER CUT EXCAVATION FOR THE ADJUSTMENT ON ALL SIDES.
4. FILL AREA BELOW 8" DEPTH WITH 78M OR NO. 57 CLEAN STONE.
5. MIX MORTAR TO NCDOT SPECIFICATIONS.
6. MORTAR JOINTS $\frac{1}{2}$ " +/- $\frac{1}{8}$ "
7. CONSTRUCT AN ASPHALT RAMP IN ACCORDANCE WITH SECTION 858-3 OF THE 2018 STANDARD SPECIFICATIONS.

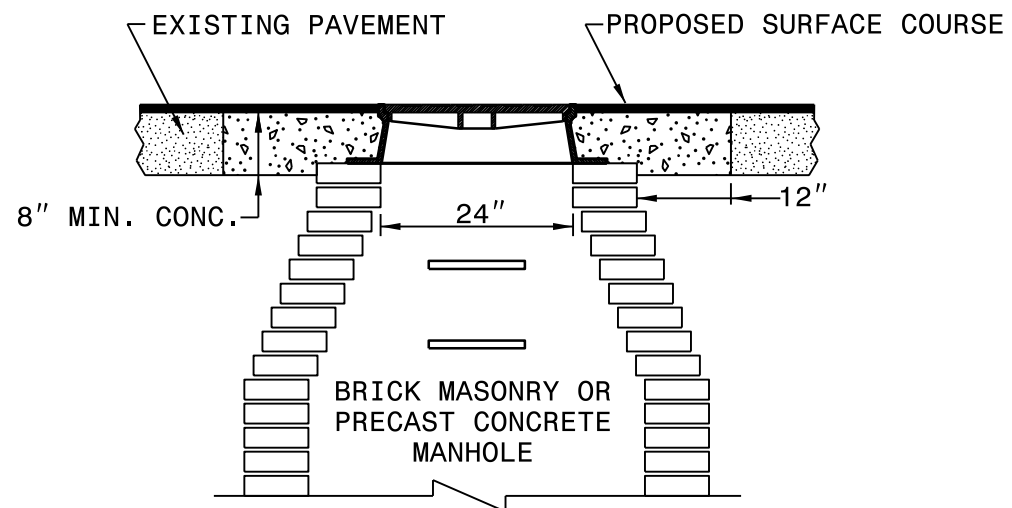

MANHOLE CONCRETE ENCASEMENT

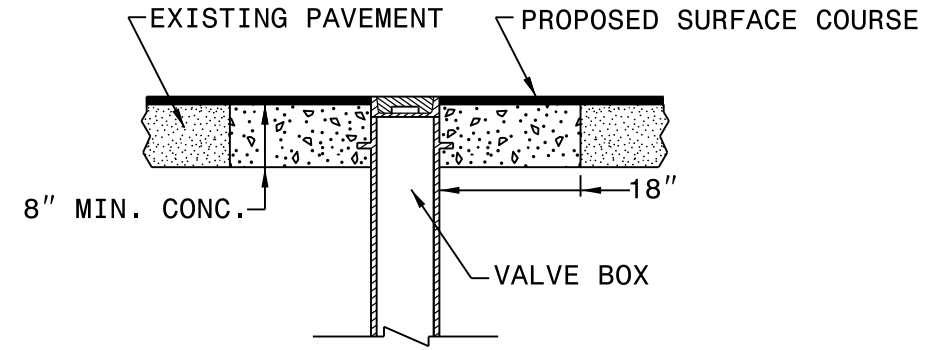

VALVE BOX CONCRETE ENCASEMENT

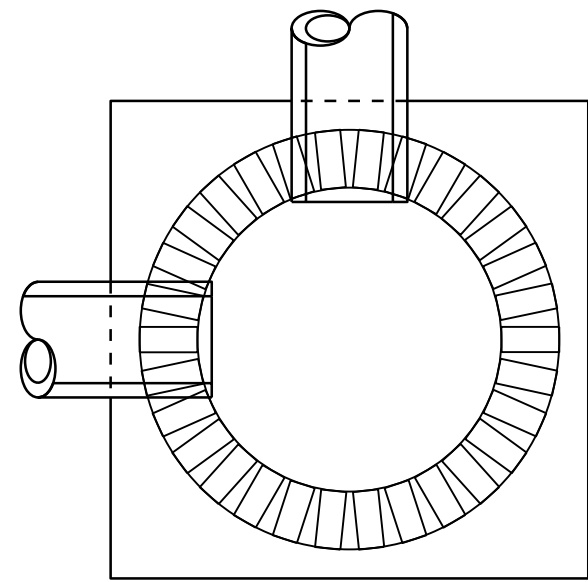

ELEVATION VIEW

PLACE BRICK ACCORDING TO ELEVATION VIEW

ENGLISH DETAIL DRAWING FOR
MANHOLE AND VALVE BOX ADJUSTMENTS

SHEET 1 OF 1
840D55

REVISIONS

28-NOV-2017 10:49
 S:\Division Resurfacing\z Design Standards & Specifications\Drawings\Tutorials\Curb, Etc.rwdgn
 \$\$\$SUSPENSE\$\$\$

- NOTES:
 1) DETAIL DOES NOT APPLY TO OGAFC AND ULTRA-THIN BONDED WEARING COURSE.
 2) BACKFILL SHOULDER WITH APPROVED MATERIAL.
 3) THE SHOULDER WEDGE DEVICE MAY BE DISENGAGED AT PAVED DRIVEWAYS, SIDE STREETS, HIGH SHOULDERS, AND OTHER LOCATIONS NOT FEASIBLE TO CONSTRUCT AS APPROVED BY THE ENGINEER.

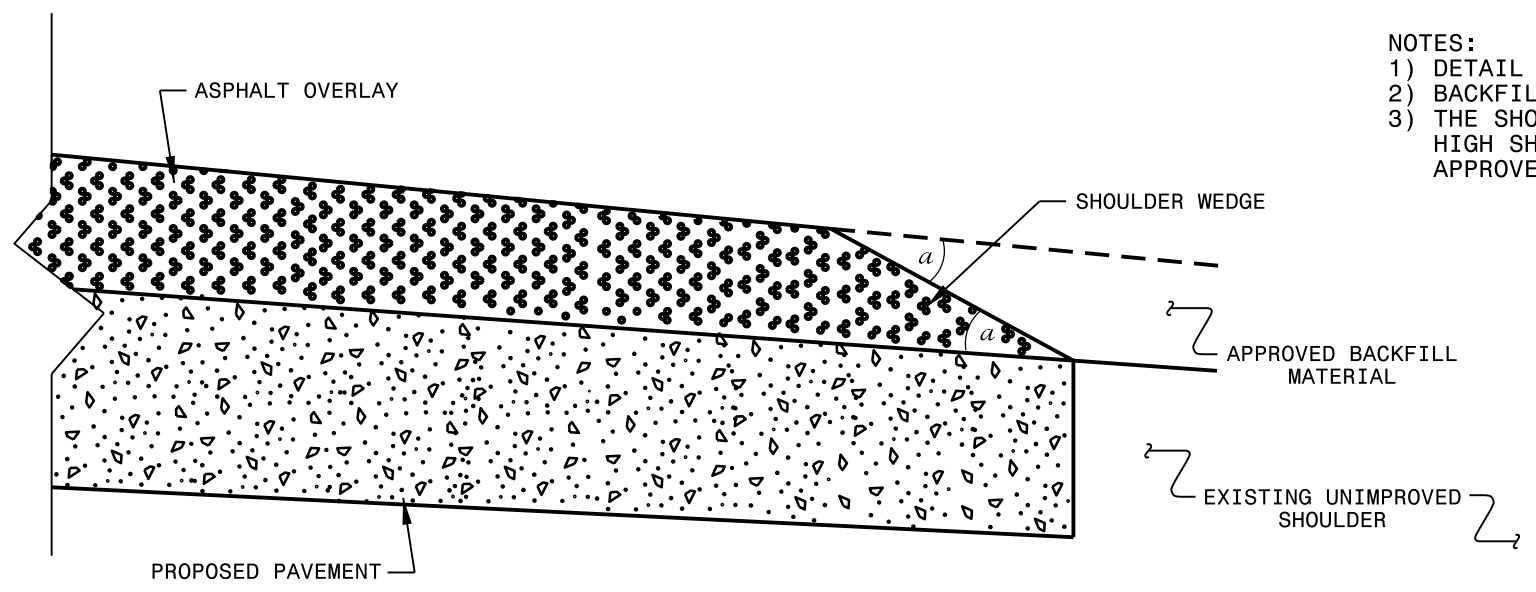

SHOULDER WEDGE DETAIL
 (Resurfacing Projects w/ Widening or with Existing Paved Shoulder having no dropoffs)

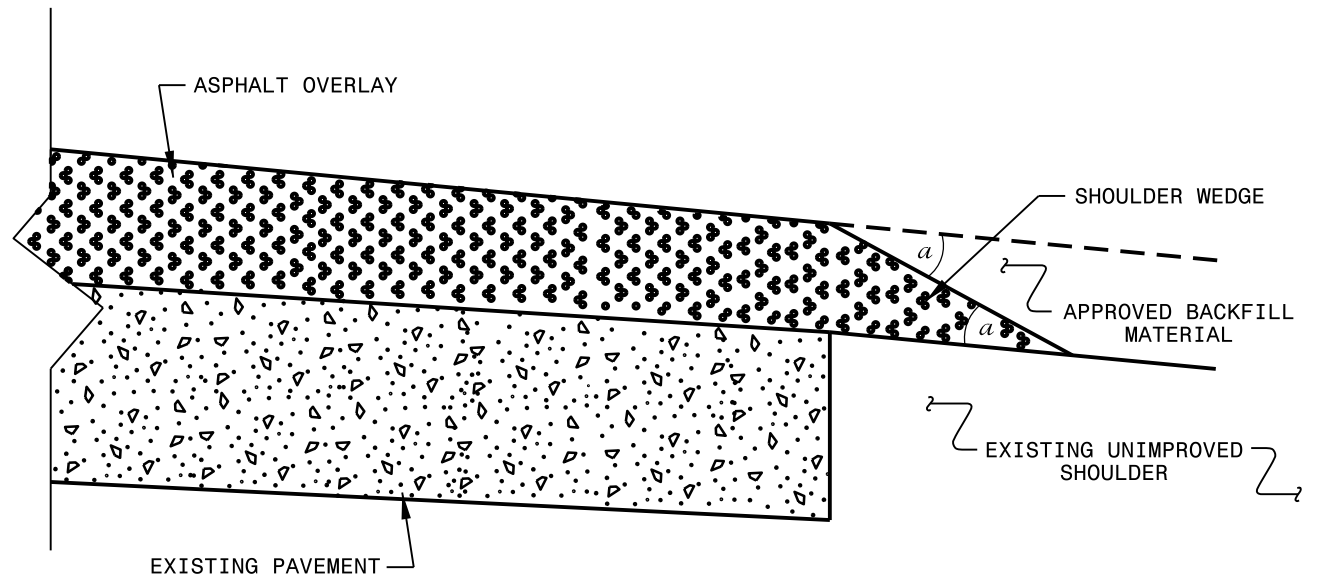

SHOULDER WEDGE DETAIL
 (Resurfacing Projects w/ NO Widening)

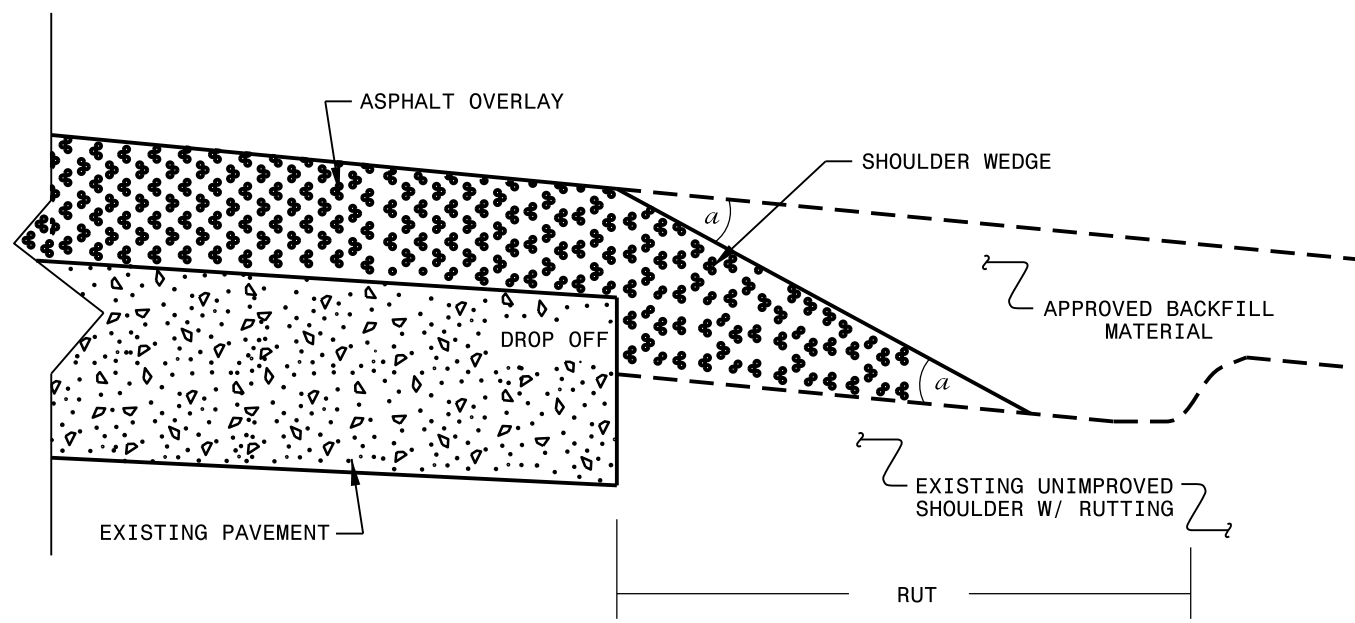

SHOULDER WEDGE DETAIL
 (Resurfacing Adjacent to Rutted Shoulder)

- SHOULDER WEDGE ANGLE = 30°

CONTRACT STANDARDS AND DEVELOPMENT UNIT			
Office 919-707-6950		FAX 919-250-4119	
SHOULDER WEDGE DETAILS			
ORIGINAL BY: T.SPELL	DATE: 7-19-11		
MODIFIED BY:	DATE: 2/2/16		
CHECKED BY:	DATE:		
FILE SPEC.: s:\usr\details\stand\shoulderwedgedetail.dgn			

27 JUN 2018 13:22:41
 s:\usr\details\stand\shoulderwedgedetail.dgn
 3\Sampson August 2018 Revised Shoulder Wedge Detail.dgn
 2021CPT.03.11.20821. ETC

PROJECT NO.	SHEET NO.
2021CPT.03.11.20821 ETC.	13

SUMMARY OF QUANTITIES

PROJECT NO	COUNTY	MAP NO	ROUTE	DESCRIPTION	TYP NO	LANES	LANE TYPE	FINAL SURFACE TESTING REQUIRED	WARM MIX ASPHALT REQUIRED	LENGTH	WIDTH	2830000000-N	2845000000-N	6000000000-E	6009000000-E	6012000000-E	6015000000-E	6018000000-E	6021000000-E	6036000000-E	6042000000-E	6071010000-E	6084000000-E	6090000000-E	6093000000-E	6117000000-N						
												ADJUSTMENT OF MANHOLES	ADJUSTMENT OF METER OR VALVE BOX	TEMPORARY SILT FENCE	STONE FOR EC CLASS B	SEDIMENT CONTROL STONE	TEMPORARY MULCHING	SEED FOR TEMPORARY SEEDING	FERTILIZER FOR TEMPORARY SEEDING	MATTING FOR EROSION CONTROL	1/4" HARDWARE CLOTH	WATTLE	SEED & MULCHING	SEED FOR REPAIR SEEDING	FERTILIZER FOR REPAIR SEEDING	RESPONSE FOR EROSION CONTROL						
											EA	EA	LF	TON	TON	ACK	LBS	TON	SY	LF	LF	AL	LB	TON	EA							
2021CPT.03.11.20822	Sampson	32	SR 1251 (N RAILROAD ST.)	FROM SR 1271 (FISHER DR.) TO SR 1250 (N. BROAD ST.) [MP 1.35 - MP 1.79]	4	2	2WU	NO	NO	0.44	20																					
TOTAL FOR MAP NO. 32																																
TOTAL FOR PROJ NO. 2021CPT.03.11.20822																																
36248.108	Sampson	34	DOUGLAS ST. (MUNICIPAL ROSEBORO)	FROM 0.06 MILES SOUTHWEST OF SR 1285 (DOUGLAS AVE.) TO SR 1285 (DOUGLAS AVE.)	4	2	2WU	NO	NO	0.1	20																					
TOTAL FOR MAP NO. 34																																
TOTAL FOR PROJ NO. 36248.108																																
GRAND TOTAL																																
											21.51		23	18	1,347	330	330	13.20	660	3.30	100	660	210	14.85	660	3.30	10					

THERMOPLASTIC AND PAINT QUANTITIES

PROJECT NO	COUNTY	MAP NO	ROUTE	DESCRIPTION	TYP NO	LANES	LANE TYPE	LENGTH		WIDTH	441300000-E	445700000-N	481000000-E		483500000-E	484000000-N	485000000-E	490000000-N	
								MI	FT		WORK ZONE ADVANCE/GENERAL WARNING SIGNING	TEMPORARY TRAFFIC CONTROL	4" WHITE PAINT	4" YELLOW PAINT	24" WHITE PAINT	PAINT MSG SCHOOL	REMOVAL OF PAVEMENT MARKING LINES (4")	YELLOW & YELLOW MARKERS	
											SF	LS	LF	LF	LF	EA	LF	EA	
2021CPT.03.11.20821	Sampson	3	SR 1845 (CEDAR POINT RD. / ROSIN HILL RD.)	FROM SR 1711 (WILLIAM R. KING RD.) TO SR 1703 (CHURCH RD./MCLAMB RD.) [MP 0.00 - MP 4.72]	1-3	2	2WU	4.72	19-23		480			49,843	62,306			784	312
TOTAL FOR MAP NO. 3											480		49,843	62,306			784	312	
2021CPT.03.11.20821	Sampson	11	SR 1459 (FEED MILL RD.)	FROM SR 1456 (PENNY TEW MILL RD.) TO US 421 [MP 0.00 - MP 2.56]	1	2	2WU	2.56	18		48			54,068	33,792			169	
TOTAL FOR MAP NO. 11											48		54,068	33,792			169	169	
2021CPT.03.11.20821	Sampson	13	SR 1425 (SIVERTSEN RD.)	FROM SR 1414 (MINNIE HALL RD.) TO SR 1006 (WAXWELL RD.) [MP 0.00 - MP 4.56]	1	2	2WU	4.56	19		512			98,131	72,230			301	
TOTAL FOR MAP NO. 13											512		98,131	72,230			301	301	
2021CPT.03.11.20821	Sampson	14	SR 1424 (SOUTH RIVER RD.)	FROM SR 1414 (MINNIE HALL RD.) TO SR 1427 (HALLTOWN RD.) [MP 0.00 - MP 3.92]	1	2	2WU	3.92	20		448			84,358	51,744			259	
TOTAL FOR MAP NO. 14											448		84,358	51,744			259	259	
2021CPT.03.11.20821	Sampson	15	SR 1426 (FAIRCLOTH BRIDGE RD.)	FROM SR 1424 (S. RIVER RD.) TO CUMBERLAND COUNTY LINE [MP 0.00 - MP 0.68]	1	2	2WU	0.68	18		48			14,634	8,976			45	
TOTAL FOR MAP NO. 15											48		14,634	8,976			45	45	
TOTAL FOR PROJ NO. 2021CPT.03.11.20821											1,488		301,034	229,048			784	1,086	
													530,082						
2021CPT.03.11.20822	Sampson	20	SR 1471 (BYNUM RD.)	FROM SR 1002 (DUNN RD.) TO SR 1454 (OLD WRENCH SCHOOL RD.) [MP 0.00 - MP 0.72]	4	2	2WU	0.72	19					15,494	9,504			48	
TOTAL FOR MAP NO. 20													15,494	9,504			48	48	
2021CPT.03.11.20822	Sampson	22	SR 1274 (OWENS AVE. / W. CLINTON ST. / E. CLINTON ST.)	FROM NC 242 (WEST ROSEBORO ST.) TO NC 24 (ROSEBORO HWY.) [MP 0.00 - MP 0.72]	4	2	2WU	0.72	22					15,494	9,504			48	
TOTAL FOR MAP NO. 22													15,494	9,504			48	48	
2021CPT.03.11.20822	Sampson	23	SR 1248 (BULLARD ST.)	FROM SR 1274 (WEST CLINTON ST.) TO SR 1271 (FISHER DR.) [MP 0.00 - MP 0.58]	4	2	2WU	0.58	21					12,482	7,656			38	
TOTAL FOR MAP NO. 23													12,482	7,656			38	38	
2021CPT.03.11.20822	Sampson	24	SR 1249 (DOUGLAS AVE.)	FROM BEGIN OF MAINTENANCE TO SR 1248 (BULLARD ST.) [MP 0.00 - MP 0.15]	4	2	2WU	0.15	21						84	12			
TOTAL FOR MAP NO. 24															84	12			
2021CPT.03.11.20822	Sampson	25	SR 1285 (DOUGLAS AVE.)	FROM 0.06 MILES NE OF SR 1248 (BULLARD ST.) TO SR 1251 (N. RAILROAD ST.) [MP 0.00 - MP 0.10]	4	2	2WU	0.1	21										
TOTAL FOR MAP NO. 25																			
2021CPT.03.11.20822	Sampson	26	SR 1271 (FISHER DR.)	FROM SR 1248 (BULLARD ST.) TO SR 1251 (HALL RD.) [MP 0.00 - MP 0.17]	4	2	2WU	0.17	21										
TOTAL FOR MAP NO. 26																			
2021CPT.03.11.20822	Sampson	27	SR 1269 (CALVIN ST.)	FROM SR 1251 (HALL RD.) TO SR 1249 (DOUGLAS AVE.) [MP 0.00 - MP 0.26]	4	2	2WU	0.26	20										
TOTAL FOR MAP NO. 27																			
2021CPT.03.11.20822	Sampson	28	SR 1250 (BROAD ST.)	FROM NC 24 (AURTY HWY.) TO SR 1251 (N. RAILROAD ST.) [MP 0.00 - MP 0.11]	4	2	2WU	0.11	23										
TOTAL FOR MAP NO. 28																			
2021CPT.03.11.20822	Sampson	29	SR 1252 (JOHNSON ST.)	FROM NC 24 (AURTY HWY.) TO SR 1248 (BULLARD ST.) [MP 0.00 - MP 0.22]	4	2	2WU	0.22	19										
TOTAL FOR MAP NO. 29																			
2021CPT.03.11.20822	Sampson	30	SR 1242 (S. WEST ST. / N. WEST ST.)	FROM END MAINTENANCE TO NC 242 (W. ROSEBORO ST.) [MP 0.00 - MP 0.69]	4	2	2WU	0.69	19					14,849	9,108			46	
TOTAL FOR MAP NO. 30													14,849	9,108			46	46	
2021CPT.03.11.20822	Sampson	31	SR 1300 (NORTH ST. / E. NORTH ST.)	FROM BEGIN OF MAINTENANCE (0.07 MILES SOUTH OF NC 242) TO NC 24 (ROSEBORO HWY.) [MP 0.00 - MP 0.81]	4	2	2WU	0.81	19					20,014	12,276			62	
TOTAL FOR MAP NO. 31													20,014	12,276			62	62	
2021CPT.03.11.20822	Sampson	32	SR 1251 (N RAILROAD ST.)	FROM SR 1271 (FISHER DR.) TO SR 1250 (N. BROAD ST.) [MP 1.35 - MP 1.79]	4	2	2WU	0.44	20					9,469	5,808			29	
TOTAL FOR MAP NO. 32													9,469	5,808			29	29	
TOTAL FOR PROJ NO. 2021CPT.03.11.20822											4.97		87,802	53,856	84	12		271	
													141,658						
36248.108	Sampson	34	DOUGLAS ST. (MUNICIPAL ROSEBORO)	FROM 0.06 MILES SOUTHWEST OF SR 1285 (DOUGLAS AVE.) TO SR 1285 (DOUGLAS AVE.)	4	2	2WU	0.1	20										
TOTAL FOR MAP NO. 34																			
TOTAL FOR PROJ NO. 36248.108																			
GRAND TOTAL											21.51	1,488	1	388,836	282,904	84	12	784	1,357
													671,740						

SIGNING FOR RESURFACING PROJECTS

LEGEND
 ┆ STATIONARY SIGN
 ← DIRECTION OF TRAFFIC FLOW

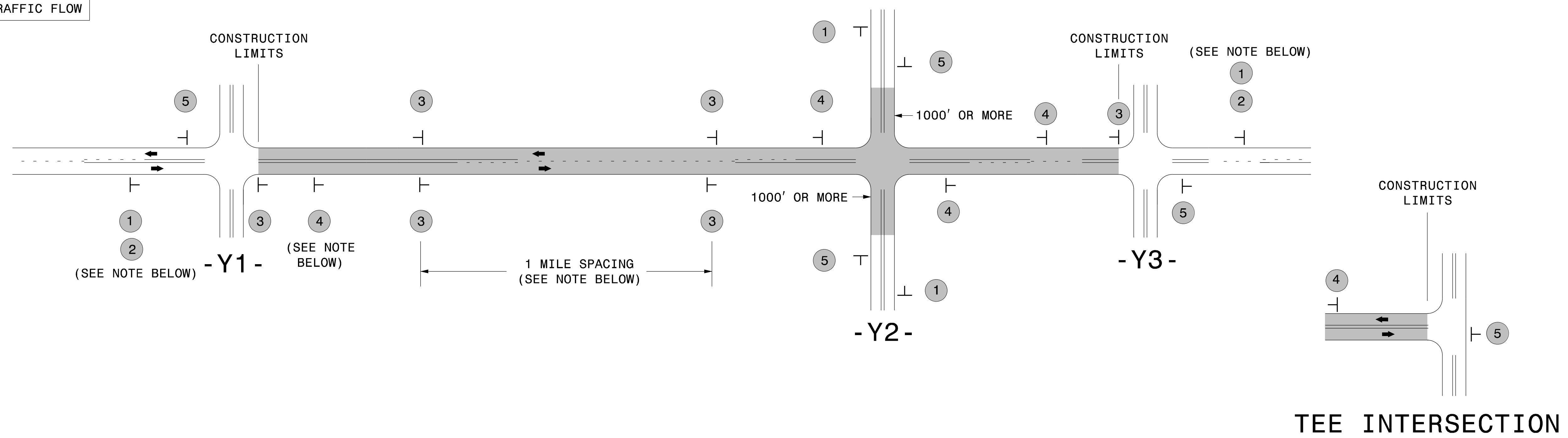

MAINLINE (-L-) SIGNING

-Y- LINE SIGNING

SIGNING NOTES AND PLACEMENT PER DIRECTION	1		PLACE 1000' PRIOR TO BEGINNING OF CONSTRUCTION LIMITS. ONLY USED ON -Y- LINES IF RESURFACING LIMITS EXTEND 1000' ALONG -Y- LINE.	<p>NO REQUIRED STATIONARY SIGNING FOR THE FOLLOWING -Y- LINE CONDITIONS:</p> <ol style="list-style-type: none"> 1) LESS THAN 1000' OF RESURFACING ALONG -Y- LINE 2) SUBDIVISION ROADS 3) DEAD END ROADS <p>WHEN PAVING/CONSTRUCTION ACTIVITIES PROCEED ACROSS AN UNSIGNED -Y- LINE, PORTABLE ADVANCE WARNING SIGNS SHALL BE USED ALONG THE -Y- LINE AS SHOWN BELOW. REMOVE UPON COMPLETION OF WORK.</p> <div style="display: flex; justify-content: space-around;"> <div style="text-align: center;"> W20-1 48" X 48" PLACED 500' IN ADVANCE OF FLAGGER. </div> <div style="text-align: center;"> W20-7 A 48" X 48" PLACED 250' IN ADVANCE OF FLAGGER. </div> </div>
	2		#2 SIGN ONLY USED WHEN CONSTRUCTION LIMITS ARE 2 OR MORE MILES IN LENGTH. ROUND UP TO NEXT WHOLE NUMBER. (NO FRACTIONAL OR DECIMAL NUMBERS)	
	3		- PLACE INITIALLY AT THE CONSTRUCTION LIMITS AND SPACE 1 MILE APART THEREAFTER. - AT TEE INTERSECTIONS INSTALL INITIALLY 1/2 MILE FROM INTERSECTION AND SPACE 1 MILE APART THEREAFTER.	
	4		- THESE ARE FOR -Y- LINES THAT ARE "THROUGH" ROADWAYS. - DEAD END AND SUBDIVISION ROADS ARE NOT "THROUGH" ROADWAYS. - INSTALL 500' +/- FROM EACH -Y- LINE APPROACH AS SHOWN ABOVE. - FOR MULTIPLE -Y- LINES THAT ARE SEPARATED BY 0.25 MILES OR LESS, TREAT AS A SINGLE UNIT AND INSTALL WITHIN 500' OF EACH APPROACH. - A MAXIMUM OF 2 SIGN SETS PER MILE. DO NOT INSTALL WHEN -Y- LINES ARE WITHIN 0.5 MILES FROM "END ROAD WORK" SIGN. - FOR TEE INTERSECTIONS, INSTALL WITHIN 500' +/- OF THE INTERSECTION ALONG -L- LINE.	
	5		PLACE 500' FOLLOWING THE END OF CONSTRUCTION LIMITS OR AS SHOWN WHEN WORK ENDS AT A 3-WAY TEE INTERSECTION.	

THE ABOVE SIGNS ARE ALL THAT ARE REQUIRED FOR A CONTRACTOR TO BEGIN A RESURFACING CONTRACT. ANY ADDITIONAL SIGNS REQUESTED BY NCDOT DIVISIONS SHALL BE INSTALLED WITHIN 7 BUSINESS DAYS OF THE START OF CONTRACT WORK.

MAPS LESS THAN 2 MILES

FOR RESURFACING MAPS WITH CONSTRUCTION LIMITS LESS THAN 2 MILES IN LENGTH, NO STATIONARY SIGNS ARE REQUIRED. USE PORTABLE "ROAD UNDER CONSTRUCTION" OR "ROAD WORK AHEAD" SIGNS IN LIEU OF STATIONARY ADVANCE WARNINGS SIGNS.

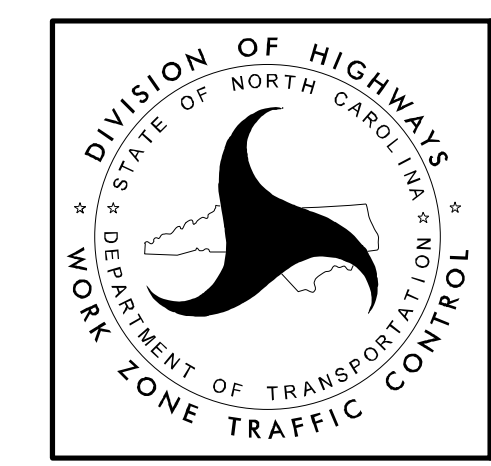

ADVANCE WARNING SIGNS FOR RURAL AND SUBURBAN 2-LANE ROADWAY RESURFACING

SIGNING FOR ASPHALT SURFACE TREATMENT

LEGEND

- ⏏ PORTABLE SIGN
- ┆ STATIONARY SIGN
- ← DIRECTION OF TRAFFIC FLOW

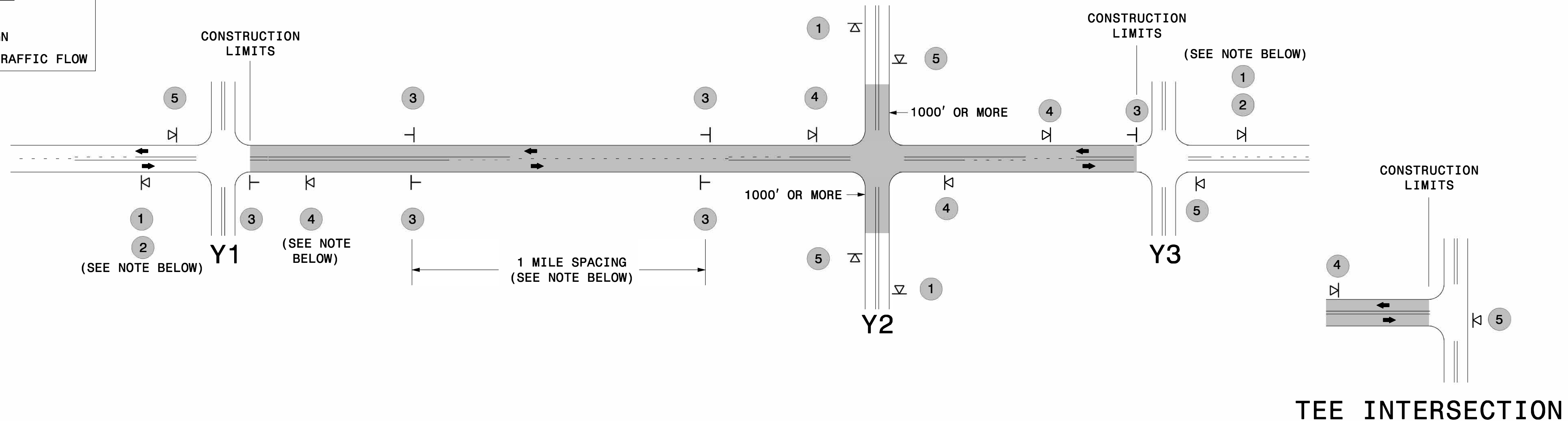

MAINLINE (-L-) SIGNING

-Y- LINE SIGNING

SIGNING NOTES AND PLACEMENT PER DIRECTION	1	 	<ul style="list-style-type: none"> - PLACE 1000' PRIOR TO BEGINNING OF CONSTRUCTION LIMITS. ONLY USED ON -Y- LINES IF RESURFACING LIMITS EXTEND 1000' ALONG -Y- LINE. - SIGN #2 ONLY USED WHEN RESURFACING LIMITS ARE 2 OR MORE MILES IN LENGTH. ROUND UP TO THE NEAREST WHOLE NUMBER. DO NOT USE FRACTIONAL OR DECIMAL NUMBERS. 	<p>STATIONARY SIGNING NOT REQUIRED FOR THE FOLLOWING -Y- LINE CONDITIONS:</p> <ol style="list-style-type: none"> 1) LESS THAN 1000' OF RESURFACING ALONG -Y- LINE 2) SUBDIVISION ROADS 3) DEAD END ROADS <p>WHEN PAVING/CONSTRUCTION ACTIVITIES PROCEED ACROSS AN UNSIGNED -Y- LINE, PORTABLE ADVANCE WARNING SIGNS SHALL BE USED ALONG THE -Y- LINE AS SHOWN BELOW. REMOVE UPON COMPLETION OF WORK.</p> <div style="display: flex; justify-content: space-around; align-items: center;"> <div style="text-align: center;"> <small>W20-1 48" X 48"</small> PLACED 500' IN ADVANCE OF FLAGGER. </div> <div style="text-align: center;"> <small>W20-7 A 48" X 48"</small> PLACED 250' IN ADVANCE OF FLAGGER. </div> </div>
	2			
	3	 	<ul style="list-style-type: none"> - ALTERNATE THE FOLLOWING TWO SIGNS: - STARTING WITH "LOOSE GRAVEL" (W8-7) FOLLOWED BY "UNMARKED PAVEMENT". - PLACE INITIALLY AT THE CONSTRUCTION LIMITS AND SPACED 1 MILE APART THEREAFTER. - AT TEE INTERSECTIONS INSTALL INITIALLY 0.5 MILE FROM INTERSECTION AND SPACE 1 MILE APART THEREAFTER. 	
	4		<ul style="list-style-type: none"> - THESE ARE FOR -Y- LINES THAT ARE "THROUGH" ROADWAYS. DEAD END AND SUBDIVISION ROADS ARE NOT "THROUGH" ROADWAYS. - INSTALL 500' +/- FROM EACH -Y- LINE APPROACH AS SHOWN ABOVE. - FOR MULTIPLE -Y- LINES THAT ARE SEPARATED BY 0.25 MILES OR LESS, TREAT AS A SINGLE UNIT AND INSTALL WITHIN 500' OF EACH APPROACH. - A MAXIMUM OF 2 SIGN SETS PER MILE. DO NOT INSTALL WHEN -Y- LINES ARE WITHIN 0.5 MILES FROM "END ROAD WORK" SIGN. 	
	5		<ul style="list-style-type: none"> - PLACE 500' FOLLOWING THE END OF CONSTRUCTION LIMITS OR AS SHOWN WHEN WORK ENDS AT A 3-WAY TEE INTERSECTION. 	

THE ABOVE SIGNS ARE ALL THAT ARE REQUIRED FOR A CONTRACTOR TO BEGIN A RESURFACING CONTRACT. ANY ADDITIONAL SIGNS REQUESTED BY NCDOT DIVISIONS SHALL BE INSTALLED WITHIN 7 BUSINESS DAYS OF THE START OF CONTRACT WORK.

MAPS LESS THAN 2 MILES

FOR AST RESURFACING MAPS WITH CONSTRUCTION LIMITS LESS THAN 2 MILES IN LENGTH, USE A STATIONARY "LOOSE GRAVEL" SIGN AT THE BEGINNING CONSTRUCTION LIMIT FOLLOWED BY AN "UNMARKED PAVEMENT" SIGN MIDWAY THROUGH AND AN "END ROAD WORK" SIGN AT THE END CONSTRUCTION LIMIT.



**ADVANCE WARNING SIGNS
FOR
2-LANE ROADWAY
ASPHALT SURFACE TREATMENT**

DIVISION OF HIGHWAYS
STATE OF NORTH CAROLINA

SOIL STABILIZATION TIMEFRAMES

<i>SITE DESCRIPTION</i>	<i>STABILIZATION TIME</i>	<i>TIMEFRAME EXCEPTIONS</i>
PERIMETER DIKES, SWALES, DITCHES AND SLOPES	7 DAYS	NONE
HIGH QUALITY WATER (HQW) ZONES	7 DAYS	NONE
SLOPES STEEPER THAN 3:1	7 DAYS	IF SLOPES ARE 10' OR LESS IN LENGTH AND ARE NOT STEEPER THAN 2:1, 14 DAYS ARE ALLOWED.
SLOPES 3:1 OR FLATTER	14 DAYS	7 DAYS FOR SLOPES GREATER THAN 50' IN LENGTH.
ALL OTHER AREAS WITH SLOPES FLATTER THAN 4:1	14 DAYS	NONE, EXCEPT FOR PERIMETERS AND HQW ZONES.

NOTES: Less than 5' - 10' undisturbed buffer from ROW, ditchline, water feature, or drainage inlet, add BMP.

BMP Options: Wattle or Silt Fence

EROSION CONTROL DETAIL

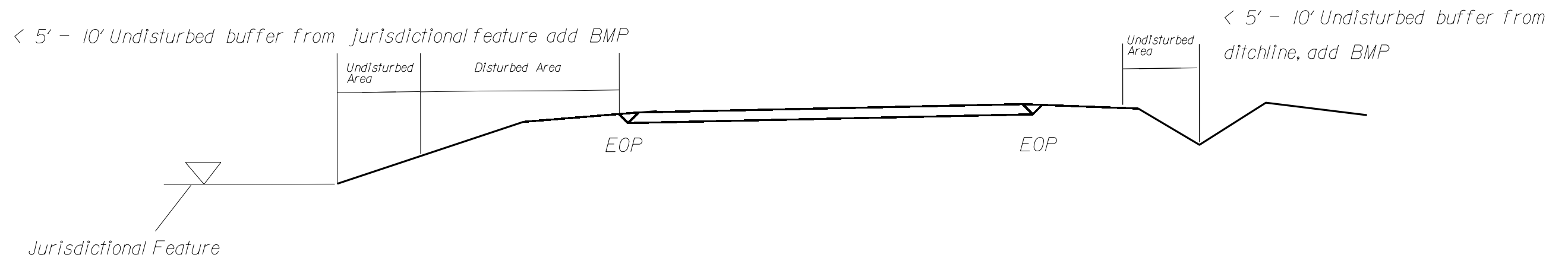
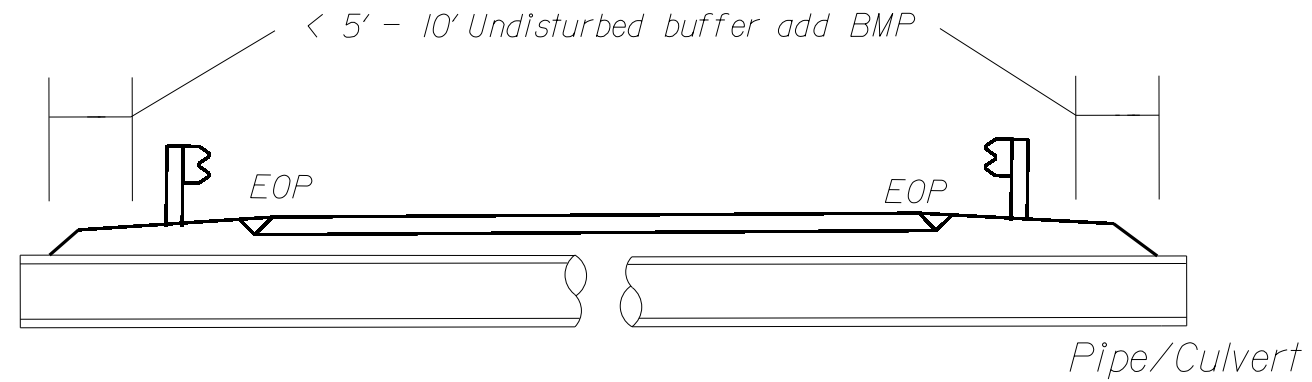

Use BMP's if shoulders and/or frontslopes and/or ditchline and/or backslopes are disturbed



< 5' - 10' Undisturbed buffer from inlet, add wattle

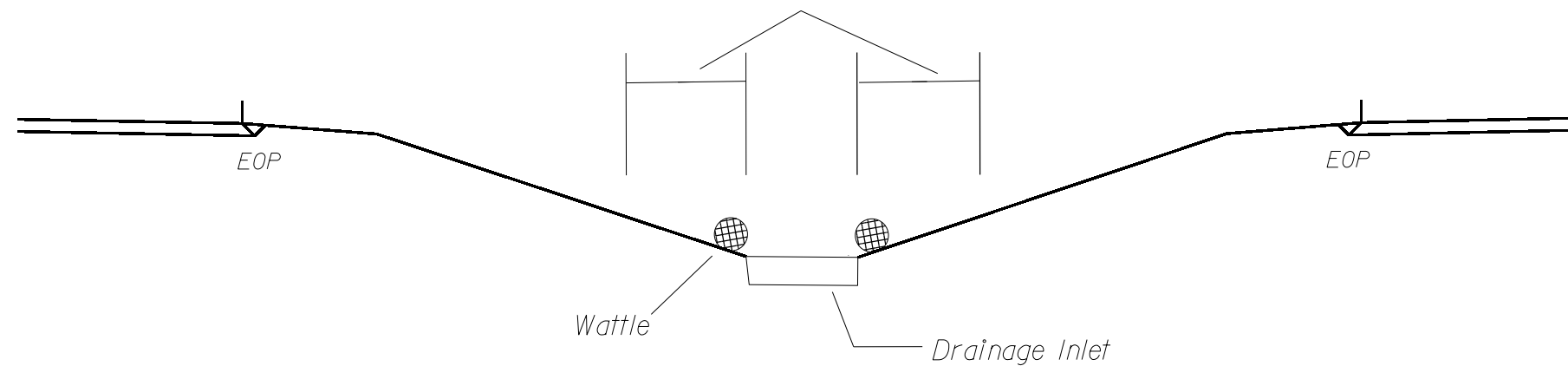

NOT TO SCALE

WATTLE DETAIL

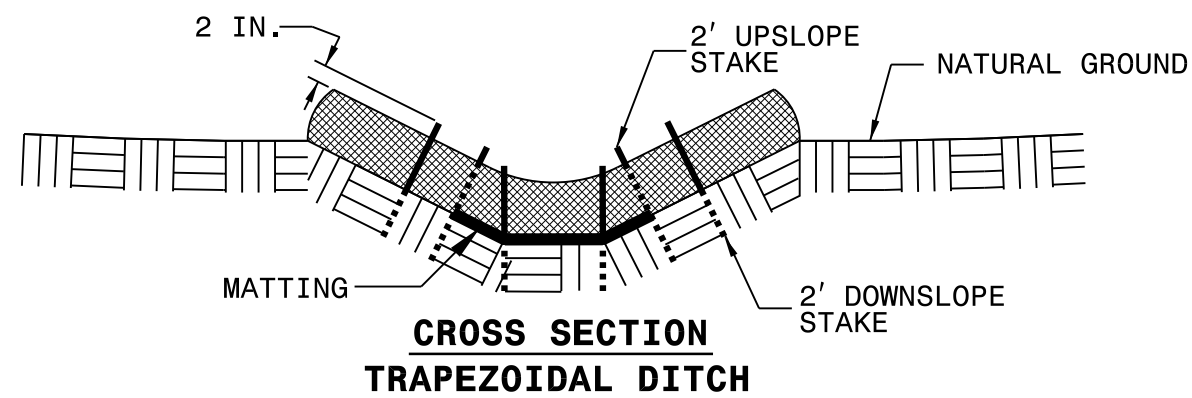
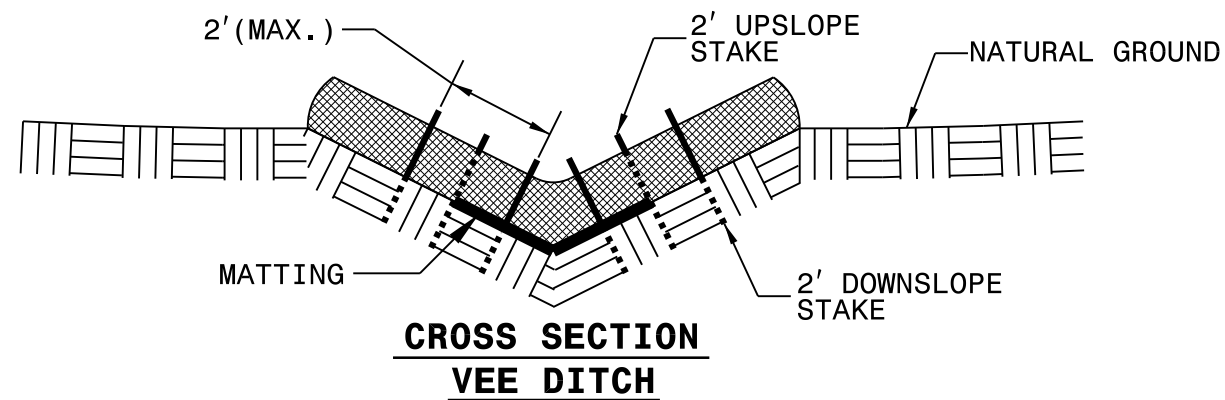
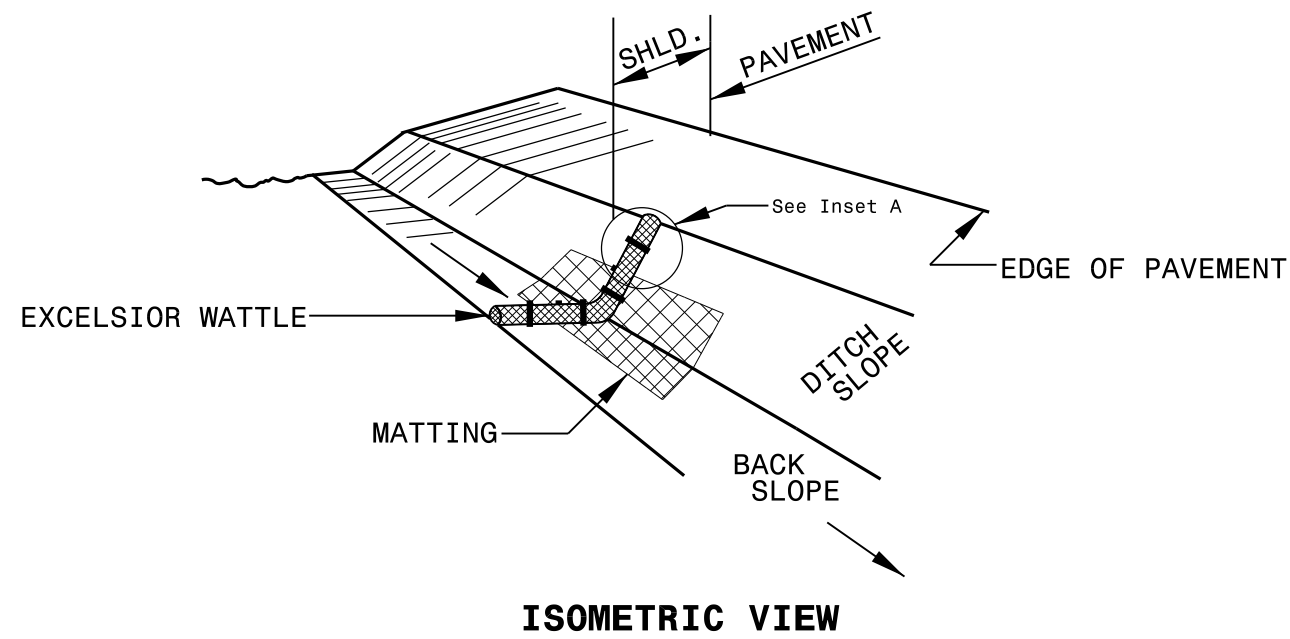

NOTES:

USE MINIMUM 12 IN. DIAMETER EXCELSIOR WATTLE.

USE 2 FT. WOODEN STAKES WITH A 2 IN. BY 2 IN. NOMINAL CROSS SECTION.

ONLY INSTALL WATTLE(S) TO A HEIGHT IN DITCH SO FLOW WILL NOT WASH AROUND WATTLE AND SCOUR DITCH SLOPES AND AS DIRECTED.

INSTALL A MINIMUM OF 2 UPSLOPE STAKES AND 4 DOWNSLOPE STAKES AT AN ANGLE TO WEDGE WATTLE TO BOTTOM OF DITCH.

PROVIDE STAPLES MADE OF 0.125 IN. DIAMETER STEEL WIRE FORMED INTO A U SHAPE NOT LESS THAN 12" IN LENGTH.

INSTALL STAPLES APPROXIMATELY EVERY 1 LINEAR FOOT ON BOTH SIDES OF WATTLE AND AT EACH END TO SECURE IT TO THE SOIL.

INSTALL MATTING IN ACCORDANCE WITH SECTION 1631 OF THE STANDARD SPECIFICATIONS.

